

# 12 HP 38" TRACTOR - MODEL NUMBER YF1238A

## SCHEMATIC

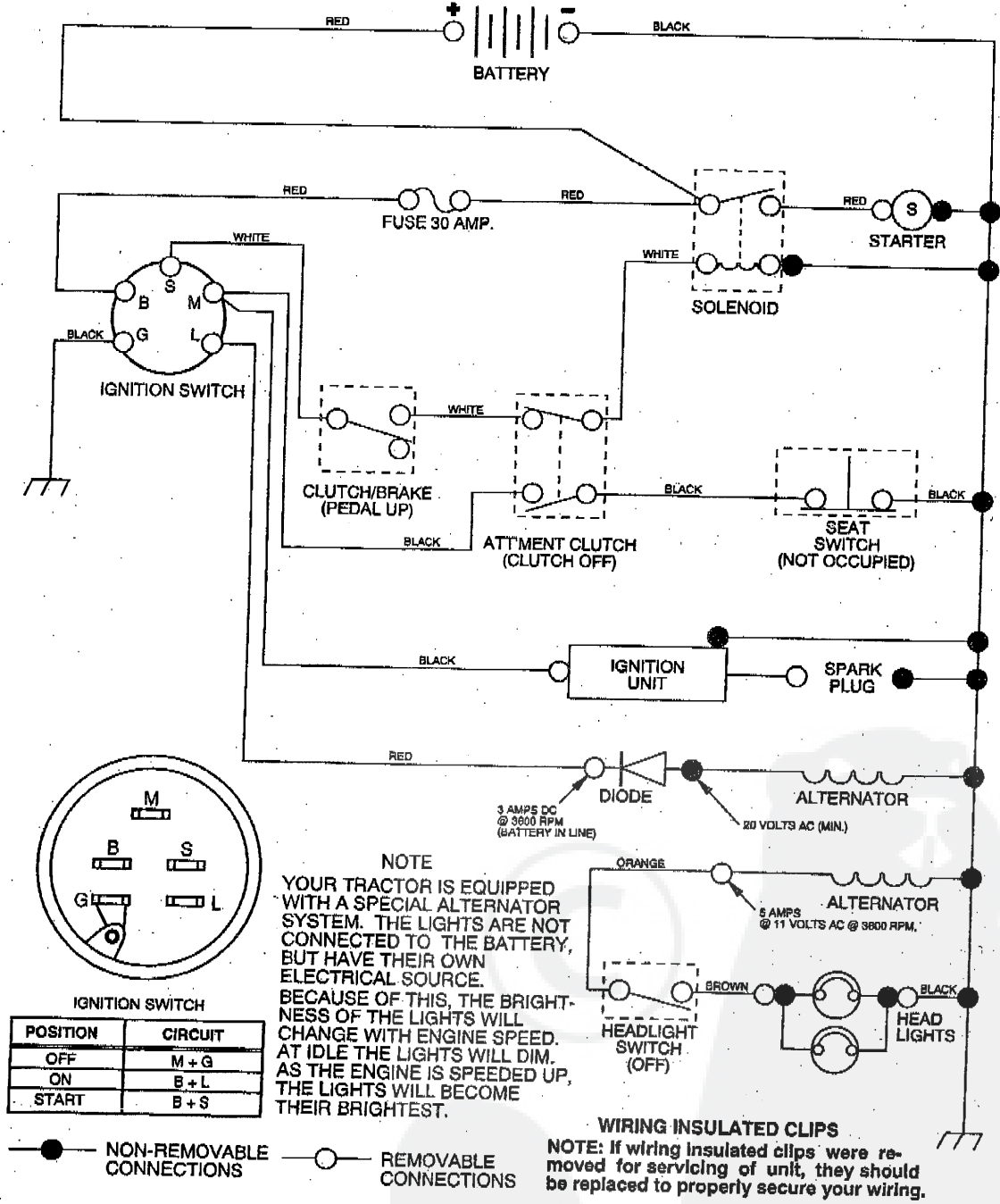

**NOTE**  
 YOUR TRACTOR IS EQUIPPED WITH A SPECIAL ALTERNATOR SYSTEM. THE LIGHTS ARE NOT CONNECTED TO THE BATTERY, BUT HAVE THEIR OWN ELECTRICAL SOURCE. BECAUSE OF THIS, THE BRIGHTNESS OF THE LIGHTS WILL CHANGE WITH ENGINE SPEED. AT IDLE THE LIGHTS WILL DIM. AS THE ENGINE IS SPEEDED UP, THE LIGHTS WILL BECOME THEIR BRIGHTEST.

IGNITION SWITCH

POSITION	CIRCUIT
OFF	M + G
ON	B + L
START	B + S

**WIRING INSULATED CLIPS**  
 NOTE: If wiring insulated clips were removed for servicing of unit, they should be replaced to properly secure your wiring.

**12 HP 38" TRACTOR - MODEL NUMBER YF1238A**

**DECALS**

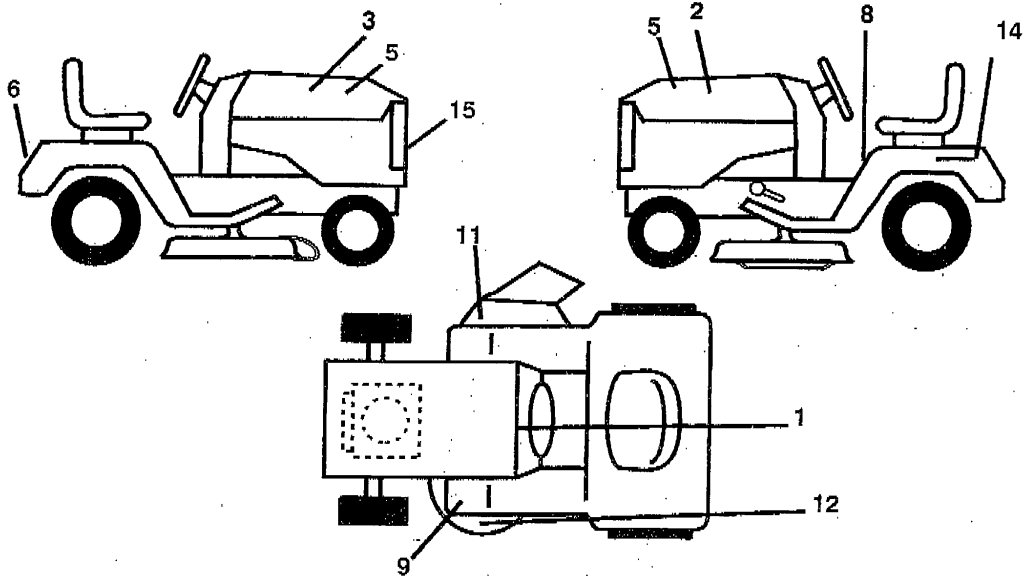

KEY NO.	PART NO.	DESCRIPTION
1	109821X	Decal, Instruction, Operating (Eng./ Fr.)
2	124152X	Decal, Hood, Stripe L.H.
3	124151X	Decal, Hood, Stripe R.H.
5	124051X	Decal, Side Panel
6	123689X	Decal, Fender
8	133795	Decal, Caution

KEY NO.	PART NO.	DESCRIPTION
9	101892X	Decal, Clutch/Brake
11	121349X	Decal, Danger
12	109820X	Decal, Rotating Blades
14	121549X	Decal, Caution, Battery
15	105807X	Decal, Stripe, Grill
—	136809	Manual, Parts
—	132704	Manual, Operators

**WHEELS & TIRES**

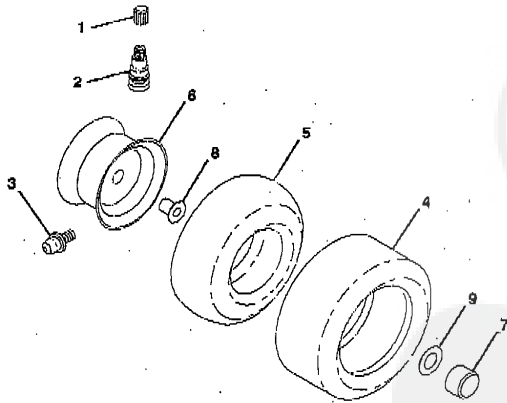









KEY NO.	PART NO.	DESCRIPTION
1	59192	Cap, Valve
2	65139	Stem, Valve
3	278H	Fitting, Grease
4	124635X	Tire, Rear
4	106222X	Tire, Front
5	7152J	Tube, Rear (Opt. Serv. Items Only)
5	59904	Tube, Front (Opt. Serv. Items Only)
6	106108X361	Rim, Assembly, Rear
6	106732X361	Rim, Assembly, Front
7	104757X	Cap, Axle
8	9040H	Bearing, Flange (Front Wheels Only)
9	121748X	Washer 25/32 x 1-5/8 x 16 Ga.

# REPAIR PARTS

## 12 HP 38" TRACTOR - MODEL NUMBER YF1238A

### ELECTRICAL

- |  |  |  |  |
|--|--|--|--|
| <b>A</b>   | <b>B</b>   | <b>C</b>   | <b>D</b>   |
|  11 |  13 |  36 |  35 |
|  12 |  |  |  |
|  |  16 |  37 |  |
|  |  14 |  |  |

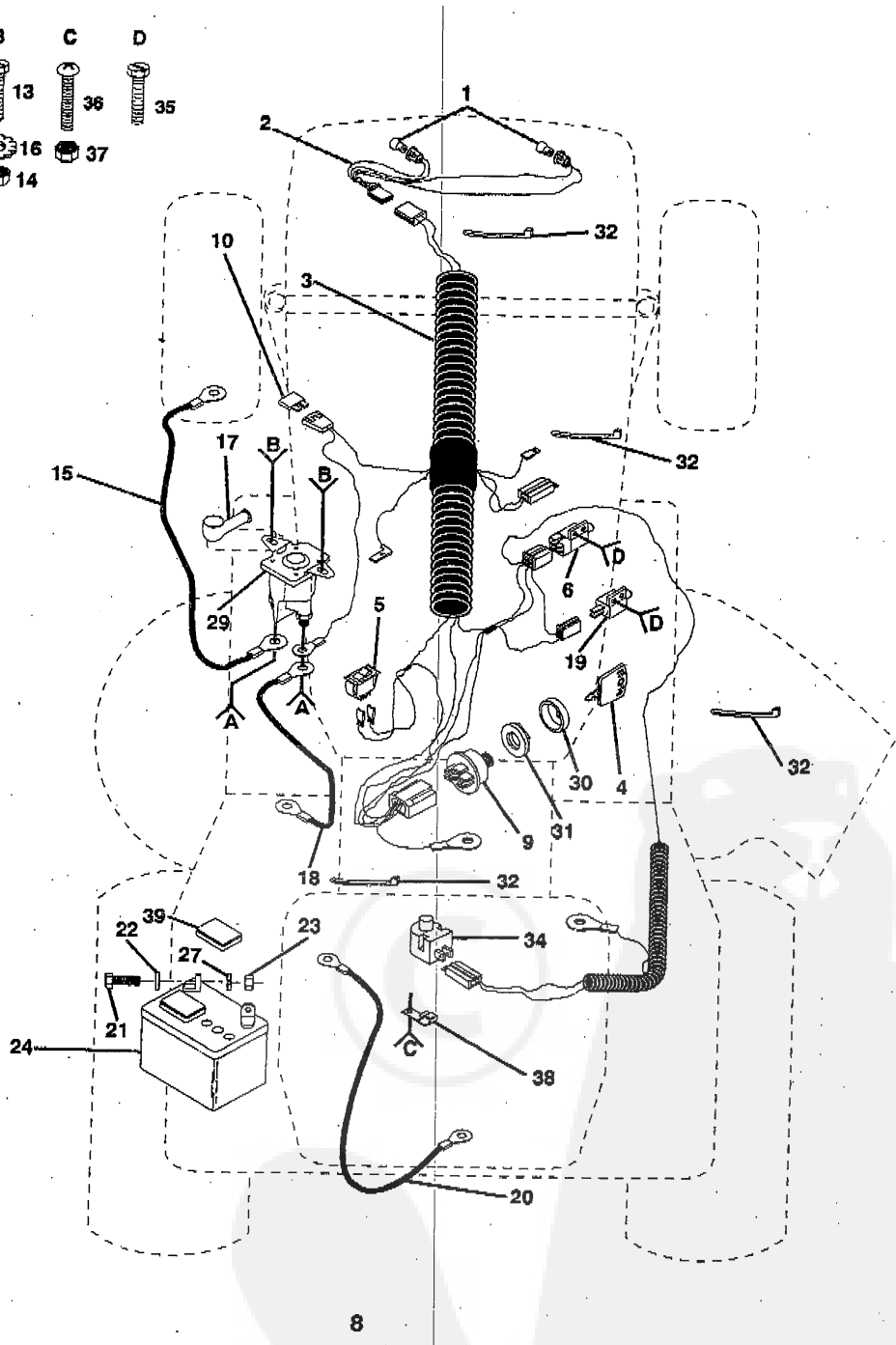

**REPAIR PARTS****12 HP 38" TRACTOR - MODEL NUMBER YF1238A****ELECTRICAL**

KEY NO.	PART NO.	DESCRIPTION
1	7662J	Bulb, Light
2	110859X	Harness, Light Socket
3	132017	Harness, Ignition
4	122147X	Key, Molded
5	110712X	Switch, Light
6	109553X	Switch, Interlock
9	4406R	Switch, Ignition
10	108824X	Fuse, 30 Amp
11	10090400	Washer, Lock 1/4
12	73350400	Nut, Hex Jam 1/4-20
13	74780408	Bolt, Hex 1/4-20 x 1/2 Grade 5
14	73510400	Nut, Keps 1/4-20
15	4799J	Cable Assembly
16	11050400	Washer, Lock, Ext. Tooth 1/4
17	131563	Cover, Terminal
18	132202	Cable, Battery
19	104445X	Switch, interlock
20	4207J	Cable, Battery
21	74760412	Bolt, Hex 1/4-20 x 3/4
22	19091016	Washer 9/32 x 5/8 x 16 Gauge
23	73220400	Nut, Hex 1/4-20
24	121265X	Battery, 12 Volt, 25 Amp.
27	10040400	Washer, Lock, Heavy Helical Spring
29	109081X	Solenoid
30	123620X	Cover, Switch Key
31	124211X	Nut, Ignition
32	7192J	Cable Tie
34	121305X	Switch, Seat
35	17021008	Screw, Hex Tapping #10-24 UNC x 1/2
36	74641008	Screw, Slotted Pan Head #10-32 x 1/2
37	73951000	Nut, Keps #10-32 x 1/2
38	4171R	Clip, Insulated
39	121264X	Caps, Battery

**NOTE:** All component dimensions given in U.S. inches  
1 inch = 25.4 mm

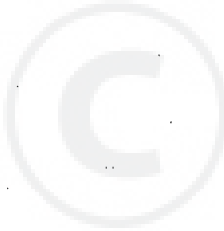

# REPAIR PARTS

## 12 HP 38" TRACTOR - MODEL NUMBER YF1238A

### CHASSIS AND ENCLOSURE

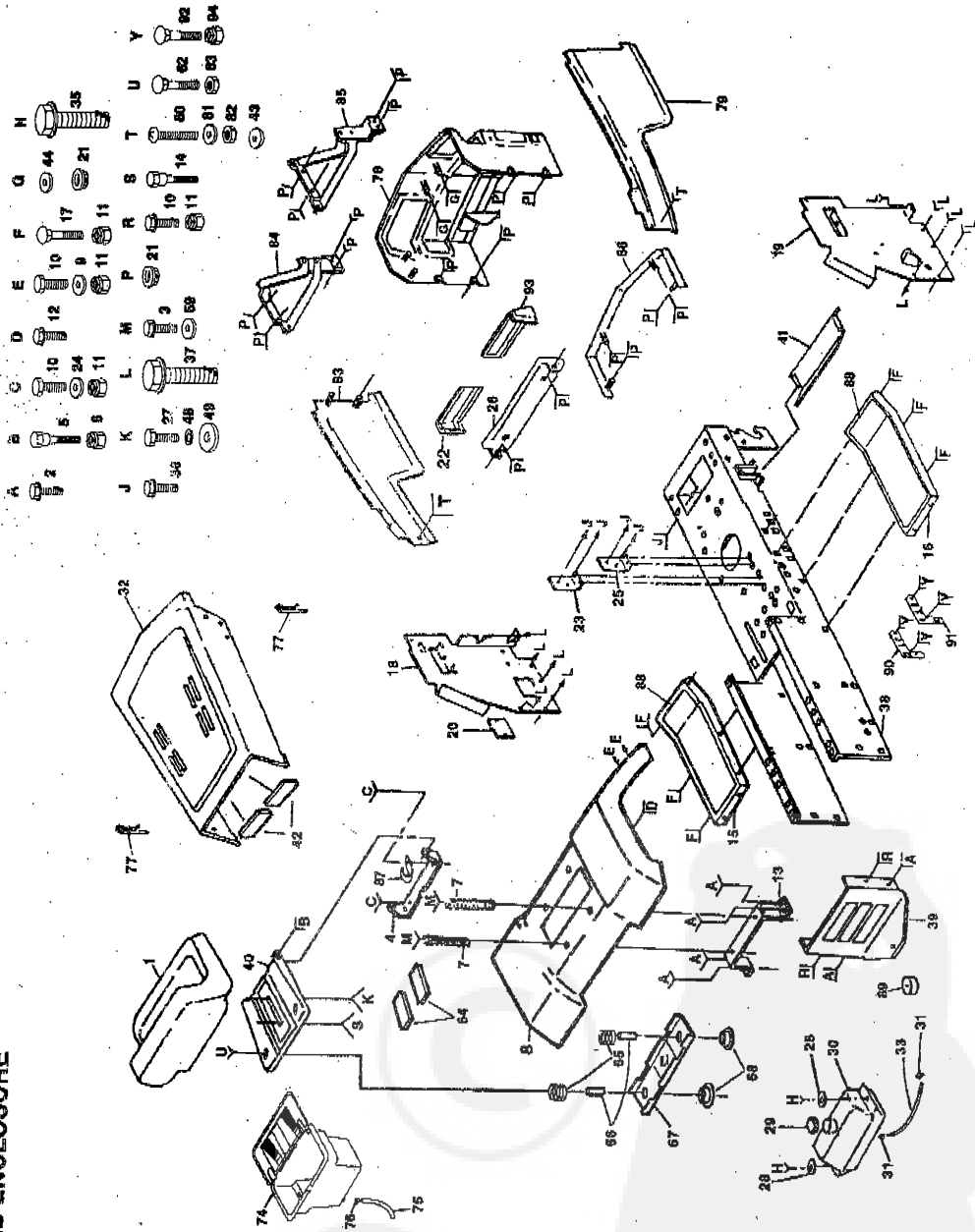

# REPAIR PARTS

## 12 HP 38" TRACTOR - MODEL NUMBER YF1238A

### CHASSIS AND ENCLOSURE

KEY NO.	PART NO.	DESCRIPTION	KEY NO.	PART NO.	DESCRIPTION
1	127428X	Seat	38	135034	Chassis Assembly
2	17490612	Screw, Hex, Washer, Thread Rolling 3/8-16 x 3/4 Type TT	39	127866	Drawbar
3	17490616	Screw, Hex, Washer, Thread Rolling 3/8-16 x 1	40	131451	Pan, Seat
4	126866X	Bracket, Pivot, Seat	41	128953	Shield, Heat Browning
5	105529X	Bolt, Shoulder 5/16-18	42	126938X	Bumper, Hood
6	73689500	Nut, Crownlock 5/16-18	43	127318X	Grommet, Plastic
7	124181X	Spring, Seat	44	19091216	Washer 9/32 x 3/4 x 16 Ga.
8	109872X505	Fender	48	10040800	Washer, Lock 1/2
9	19131312	Washer 13/32 x 13/16 x 12 Ga.	49	19171912	Washer 17/32 x 1-3/16 x 12 Ga.
10	74760612	Bolt, Hex, Washer, Thread Rolling 3/8	59	19131614	Washer 13/32 x 1 x 14 Ga.
11	73680600	Nut, Crownlock 3/8-16	62	72050411	Bolt, Carriage 1/4-20 x 1-3/8
12	17490608	Screw, Hex, Washer, Thread Rolling 3/8-16 x 12	63	123976X	Nut, Hex Flange 1/4-20
13	109873X	Bracket, Fender	64	121251X	Strip, Foam
14	127018X	Bolt, Shoulder	65	121250X	Spring, Compression
15	105465X505	Footrest, L.H.	66	121249X	Spacer, Split
16	105464X505	Footrest, R.H.	67	121246X	Bracket, Switch Mount
17	72110808	Bolt, Carriage 3/8-16 x 3/4	68	121248X	Bushing, Snap
18	122795X	Panel, Dash, L.H.	74	129965	Case, Battery
19	124031X	Panel, Dash, R.H.	75	109238X	Tube, Battery Drain
20	121794X	Cover, Access	76	109596X	Clamp, Hose
21	108067X	Pal Nut 1/4-20	77	4921H	Retainer, Spring
22	108361X	Lens, L.H.	78	128313	Grille Asm.
23	130890	Bracket, Switch, Interlock	79	106927X505	Side Panel Asm. R.H.
24	19131210	Washer 13/32 x 3/4 x 10 Ga.	80	127317X	Screw, Special
25	108236X	Bracket, Switch	81	129964	Washer, Nylon 5/8 x 5/16 x .047
26	132257	Bezel, Light	82	127316X	Retainer
27	74780814	Bolt, Hex 1/2-13 x 7/8	83	106929X505	Side Panel Asm. L.H.
28	19091416	Washer 9/32 x 7/8 x 16 Ga.	84	105797X	Hinges, Hood L.H.
29	123549X	Cap, Fuel	85	105792X	Hinges, Hood R.H.
30	109202X	Tank, Fuel	86	109745X505	Strap Asm. Grille
31	123487X	Clamp, Hose	87	2751R	Clip, Line Fuel
32	105682X505	Hood Assembly	88	133671	Pad, Footrest
33	8548R	Line, Fuel	89	124028X	Bushing, Snap
35	17490412	Screw, Thdrol. 1/4-20 x 3/4	90	134618	Bracket, Asm. Pivot L.H.
36	17021008	Screw, Hex Tapping #10-24 x 1/2	91	134617	Bracket, Asm. Pivot R.H.
37	17490608	Screw, Hex Washer Head, Thread Rolling 3/8-16 x 1/2	92	72140606	Bolt, Carriage 3/8-16 x 3/4
			93	108360X	Lens, R.H.
			94	7380060	Nut, Lock Hex w/wsh 3/8 -16

NOTE: All component dimensions given in U. S. inches. 1 inch = 25.4 mm

# REPAIR PARTS

## 12 HP 38" TRACTOR - MODEL NUMBER YF1238A

### DRIVE

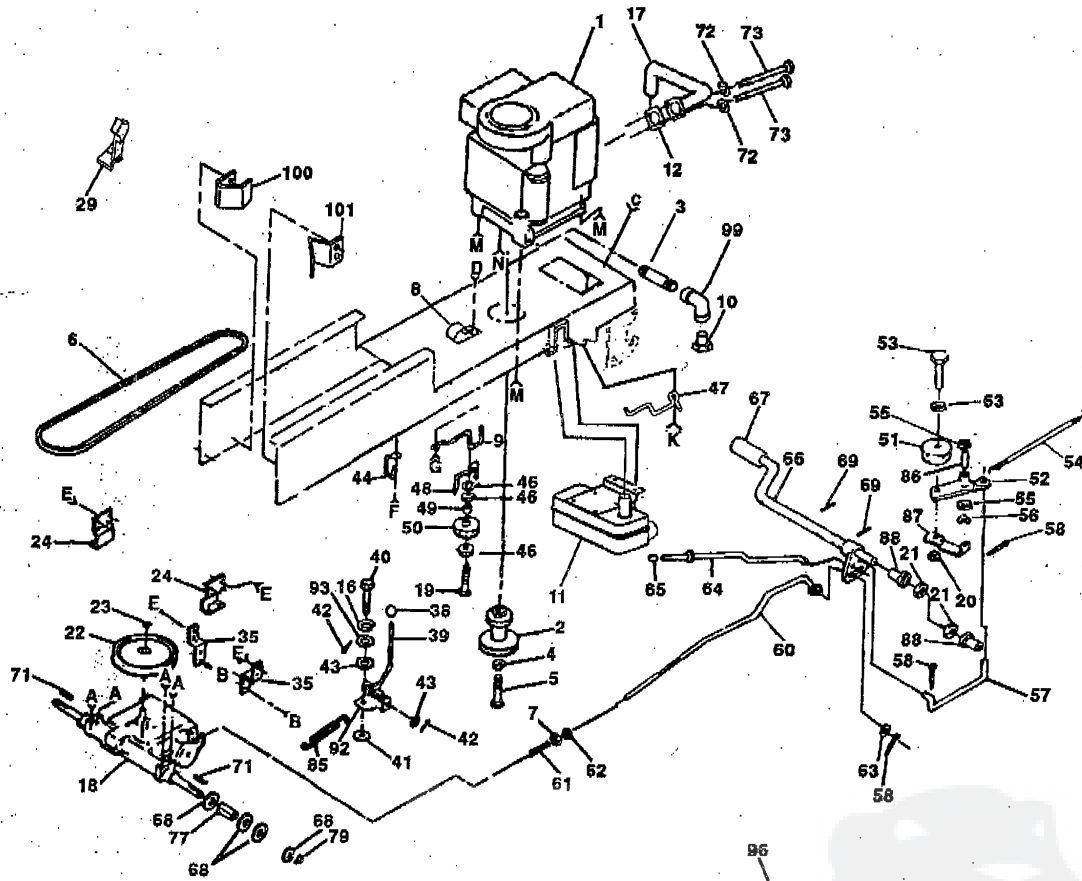

96  
**OPTIONAL EQUIPMENT**  
**Spark Arrester**

- |          |          |          |          |          |          |          |          |          |          |
|----------|----------|----------|----------|----------|----------|----------|----------|----------|----------|
| <b>A</b> | <b>B</b> | <b>C</b> | <b>D</b> | <b>E</b> | <b>F</b> | <b>G</b> | <b>K</b> | <b>M</b> | <b>N</b> |
| 19       | 26       | 28       | 20       | 36       | 45       | 25       | 25       | 15       | 15       |
| 20       |          | 72       |          | 20       | 46       | 46       | 32       |          | 94       |
|          | 28       |          |          |          |          | 20       | 20       |          |          |

**REPAIR PARTS****12 HP 38" TRACTOR - MODEL NUMBER YF1238A****DRIVE**

KEY NO.	PART NO.	DESCRIPTION	KEY NO.	PART NO.	DESCRIPTION
1	-----	Engine, Briggs & Stratton, Model No. 283707	44	104777X	Belt, Retainer
2	134825	Pulley, Engine	45	17490612	Screw, Hex Washer Thread Rolling 3/8-16 x 3/4
3	13280324	Nipple, Pipe 3/8 NPT x 3"	46	19131312	Washer, 13/32 x 13/16 x 12 Ga.
4	10040700	Washer, Lock 7/16	47	134683	Keeper, Belt, Engine
5	71170764	Bolt, Hex 7/16-20 x 1-1/4	48	109070X	Retainer, Belt
6	125907X	V-Belt, Drive	49	4470J	Spacer
7	73800800	Locknut, Hex 3/8-16 UNC ZN	50	123674X	Idler, Flat
8	2751R	Clip, Fuel Line	51	127783	Pulley, Idler
9	129921	Keeper, Belt, Engine	52	123789X	Arm, Idler
10	-----	Plug, Drain Oil (Order From Engine Mfg.)	53	74780824	Bolt, Hex. 3/8-16 x 1-1/2
11	123075X	Muffler	54	105709X	Spring, Return Clutch
12	125593X	Gasket	55	110812X	Washer, Hardened
15	17490620	Screw, Hex Washer Thread Rolling 3/8-16 x 1-1/4	56	12000039	Ring, Clip
16	10040400	Washer, Lock 1/4	57	105710X	Link, Clutch
17	123074X	Pipe, Exhaust 180 Degrees	58	76020412	Pin, Cotter 1/8 x 3/4
18	120898X	Transaxle Dana, 6 Speed, Model No. 4360-7	60	131867	Rod, Brake
19	74760644	Bolt, Hex 3/8-16 x 2-3/4	61	106888X	Spring, Rod, Brake
20	73680600	Nut, Crownlock 3/8-16	62	73350600	Nut, Jam 3/8-16
21	19211616	Washer 21/32 x 1 x 16 Ga.	63	19131316	Washer 13/32 x 13/16 x 16 Ga.
22	123666X	Pulley, Transaxle	64	128904	Rod, Brake, Parking
23	12000028	Ring, Retainer	65	71673	Cap, Plunger
24	109167X	Bracket, Transaxle	66	122424X	Shaft, Foot Pedal
25	74780616	Bolt, Hex 3/8-16 x 1	67	8883R	Cover, Pedal
26	17490512	Screw, Hex Washer Thread Rolling 5/16-18 x 3/4	68	121749X	Washer 25/32 x 1-1/4 x 16
28	19112016	Washer 11/32 x 1-1/4 x 16 Ga.	69	1572H	Pin, Roll 3/16 x 1
29	133097	Stop, Throttle 2700 RPM	71	123583X	Key, Square 2.5 x .1845/.1865
32	19132012	Washer 13/32 x 1-1/4 x 12 Ga.	72	10040500	Washer, Lock Hvy Helical Spr. 5/16
35	121520X	Strap, Torque, Transaxle	73	71070510	Screw, Hexhd. Cap 5/16 - 18 x 5/8
36	74780612	Bolt, Hex 3/8-16 x 3/4	77	109502X	Spacer
38	106933X	Knob, Shift	79	12000001	E-Ring
39	124461X	Rod, Shift	85	110422X	Spring, Brake
40	71040412	Bolt, Fin Hex 1/4-28 UNF x 3/4 Gr. 8	86	105706X	Bearing
41	105701X	Washer, Shift Plate	87	123205X	Retainer, Belt
42	76020416	Pin, Cotter 1/8 x 1	88	120183X	Bearing, Nylon
43	19151216	Washer 15/32 x 3/4 x 16 Ga.	92	106919X	Plate, Shift
			93	19091210	Washer 9/32 x 3/4 x 10 Ga.
			94	11050600	Washer, Lock, External Tooth 3/8
			96	121851X	Spark Arrester
			99	13200300	Elbow, STD 90° 3/8-18 NPT
			100	127275X	Keeper, Belt, L.H.
			101	127274X	Keeper, Belt, R.H.

NOTE: All component dimensions given in U. S. inches.  
1 inch = 25.4 mm



# REPAIR PARTS

## 12 HP 38" TRACTOR - MODEL NUMBER YF1238A

### STEERING AND FRONT AXLE

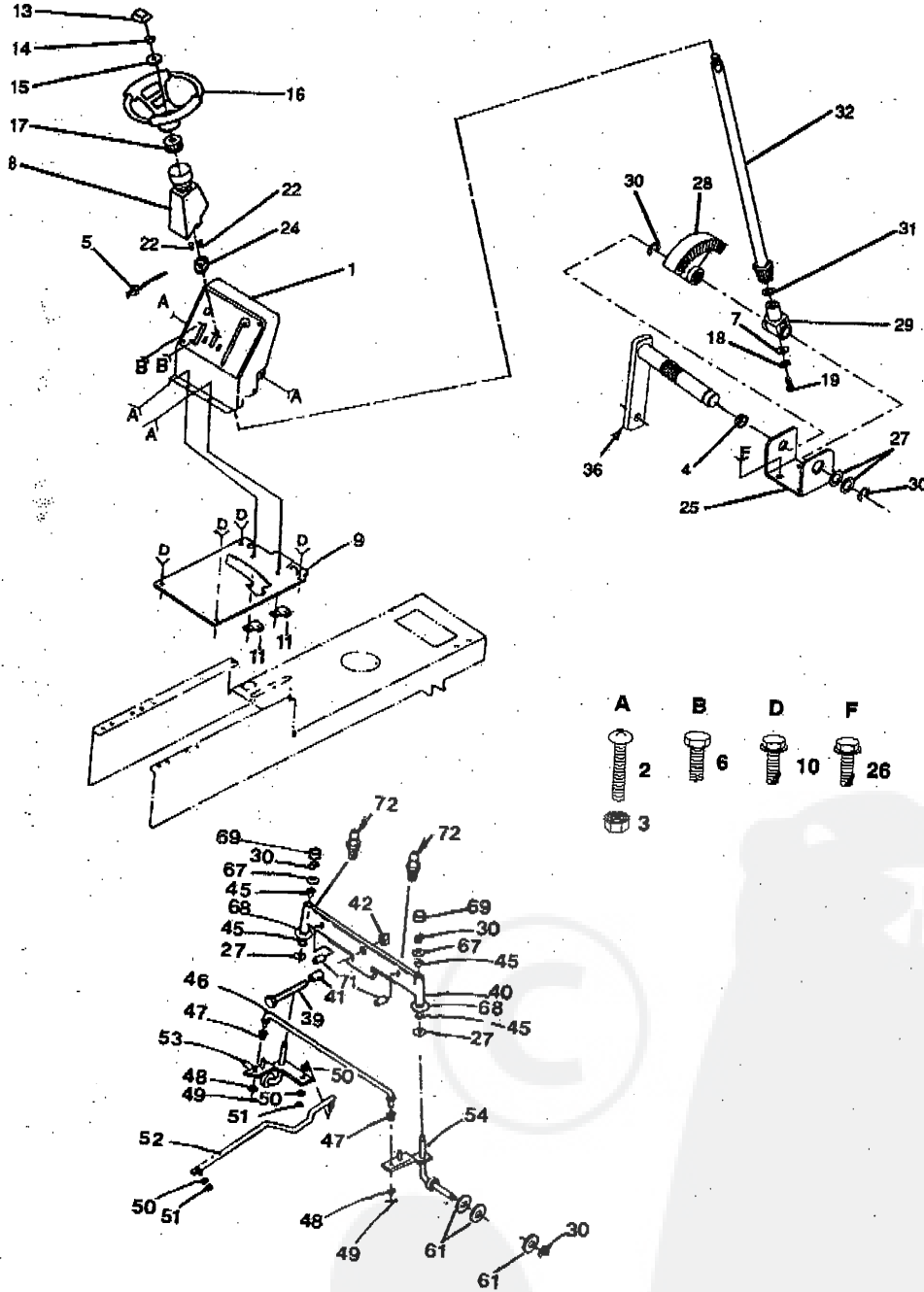

**REPAIR PARTS****12 HP 38" TRACTOR - MODEL NUMBER YF1238A****STEERING AND FRONT AXLE**

KEY NO.	PART NO.	DESCRIPTION	KEY NO.	PART NO.	DESCRIPTION
1	123042X013	Dash	28	124034X	Gear, Sector
2	74180512	Screw, Truss Head 5/16 -18 x 3/4	29	124035X	Shaft, Support
3	73510500	Nut, Keps 5/16 -18	30	12000029	Ring, Klip
4	109816X	Nyliner, Snap-in	31	57079	Washer
5	132771	Control, Throttle	32	132614	Shaft, Steering
6	17720410	Screw, Hex, Thread Cutting 1/4 - 20 x 5/8 TY23	36	127501	Shaft, Pitman
7	126684X	Washer 5/8 x 1/4 x 16 Ga.	39	74011056	Bolt, Hex 5/8-11 x 3-1/2
8	124418X	Boot, Steering	40	133988	Axle, Front
9	124464X011	Saddle	41	110438X	Spacer, Bearing, Front Axle
10	17490608	Screw, Hex, Washer Head Thread Rolling 3/8-16 x 1/2	42	73601000	Nut, Hex Jam 5/8-11
11	2751R	Clip, Fuel Line	45	3366R	Bearing
13	121584X	Insert, Steering Wheel	46	130465	Rod, Tie
14	7810H	Locknut, Center 3/8-24	47	126847X	Bushing
15	19133808	Washer 13/32 x 2-3/8 x 8 Ga.	48	19131416	Washer 13/32 x 7/8 x 16 Ga.
16	121472X	Wheel, Steering	49	76020412	Pin, Cotter 1/8 x 3/4
17	104820X	Adapter, Steering Wheel	50	10040600	Washer, Lock 3/8
18	10040400	Lock Washer 1/4	51	73610600	Nut, Hex 3/8-24
19	71070410	Screw, Socket Hex 1/4 x 20 x 5/8	52	130468	Link, Drag
22	17431008	Screw, Hex Tapping #10-16 x 1/2 Type ABTPS	53	135227	Spindle, L.H.
24	132196	Bushing, Steering	54	135228	Spindle, R.H.
25	124036X	Bracket, Steering	61	121749X	Washer 25/32 x 1-1/4 x 16 Ga.
26	17490612	Screw, Hex Washer Head, Thread Rolling 3/8-16 x 3/4 Type TT	67	121748X	Washer 27/32 x 1-1/4 x 16 Ga.
27	6266H	Bearing, Thrust	68	19272016	Washer 27/32 x 1-1/4 x 16 Ga.
			69	121232X	Cap, Spindle
			71	132624	Pin, Axle 5/8 x 1.55/1.54 Lg.
			72	6855M	Fitting, Grease

**NOTE:** All component dimensions given in U.S. inches.  
1 inch = 25.4 mm



**REPAIR PARTS****12 HP 38" TRACTOR - MODEL NUMBER YF1238A****38" MOWER**

KEY NO.	PART NO.	DESCRIPTION	KEY NO.	PART NO.	DESCRIPTION
1	129365	Mower Asm.	45	73680600	Nut, Crownlock 3/8-16
2	73680500	Nut, Crownlock 5/16-18	46	131290	Belt
3	72140506	Bolt, Carriage 5/16-18 x 3/4	47	133502	Spacer, Retainer
4	7631J	Runner, L. H.	48	133503	Stiffener, Arm Idler
5	110485X	Bearing, Ball, Mandrel	49	120183X	Bearing, Nylon
6	126774	Housing Asm., Mandrel Vented (machd)	50	122507X	Shaft Asm., Lift
7	129895	Bearing, Ball	51	105767X	Pin, Groove
8	133172	Shaft and Bearing Asm. (Includes Key No. 7)	52	109413X	Grip, Handle
9	127842	Blade, Mower, High Performance	53	124526X	Button, Plunger
10	129962	Washer, Hard, Mower, Vented	54	122364X	Plunger, Lever
11	10030600	Washer, Lock Hvy 3/8	55	122512X	Spring
12	850857	Bolt, Blade 3/8-24 x 1-1/4 Gr. 8	56	122514X	Rod, Lever
13	128961	Stripper, Mower, Vented	57	12000002	Ring, E
14	106736X	Shield, Deflector	58	19211416	Washer 21/32 x 7/8 x 16 Ga.
15	106735X	Rod, Hinge	59	131288	Rod, Brake, R. H.
16	105896X	Bracket, Deflector, Mower	60	131289	Rod, Brake, L. H.
17	110452X	Nut, Push	61	76020312	Pin, Cotter 3/32 x 3/4
18	106734X	Spring, Deflector	62	133551	Rod, Pivot
19	19111016	Washer 11/32 x 3/4 x 16 Ga.	63	133504	Rod, Clutch, Secondary
20	105304X	Cap, Sleeve	64	72110614	Bolt, Carriage 3/8-16 x 1-3/4
21	128772	Runner, R. H.	65	133550	Rod, Clutch, Primary
22	19111216	Washer 11/32 x 3/4 x 16 Ga.	66	73350600	Nut, Hex Jam 3/8-16
23	78158	Bolt, Mandrel	67	133205	Trunnion 3/8-16
24	4939M	Retainer, Spring	68	4497H	Retainer, Spring
25	74600636	Bolt, Hex Hd. 3/8-16 x 2.25	69	127498	Bushing
26	19131612	Washer 13/32 x 1 x 12 Ga.	70	128759	Spring
27	127218	Link, Front	71	133573	Arm, Clutch Primary Asm.
28	73350800	Nut, Jam Hex 1/2-13	72	106933X	Knob
29	130171	Trunnion	73	121748X	Washer 25/32 x 1-5/8 x 16 Ga.
30	73800800	Locknut W/Wsh 1/2-13 unc	74	12000029	Ring, Klip
31	135388	Lift, Link, R. H.	75	128903	Bolt, Shoulder
32	135563	Pin, Roll 5/16-1-1/4	76	127845	Keeper, Spring
33	130832	Arm, Suspension, Rear	77	127847	Arm, Clutch, Secondary
34	134619	Link, Lift, L. H.	78	131870	Spring, Return
38	133840	Idler Arm Asm.	79	130840	Brake Asm., Mower, Vented
39	129963	Washer, Spacer Mower, Vented	80	17490512	Screw, Hex, Thd. Rol. 5/16-18 x 3/4
40	129206	Pulley, Mandrel, Single	—	131455	Deck, Complete Mower
41	73050900	Nut, Flangelock 9/16	—	130794	Mandrel Ass. (Includes Key #'s 5-8, 10-12, 39 and 41)
42	131494	Pulley, Idler, Flat			
43	122052X	Spacer, Retainer 1-3/4			
44	19131612	Washer 13/32 x 1 x 12 Ga.			

**NOTE:** All component dimensions given in U.S. inches.  
1 inch = 25.4 mm.

# REPAIR PARTS

12 HP 38" TRACTOR - MODEL NUMBER YF1238A  
TRANSAXLE DANA-MODEL NUMBER 4360-7

## TRANSAXLE

ALL WARRANTY REPAIRS MUST BE PERFORMED BY AN AUTHORIZED DANA DEALER.

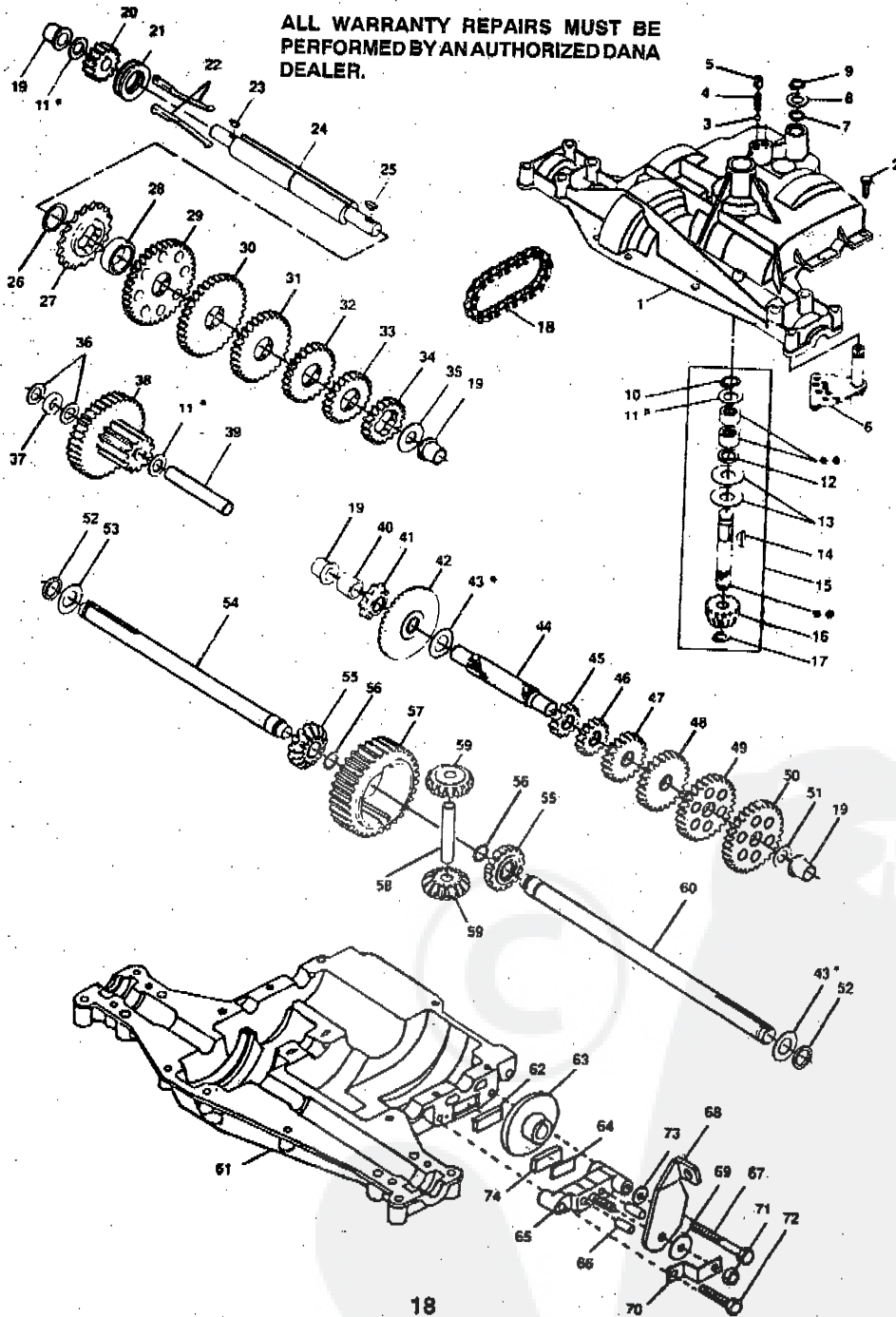

**REPAIR PARTS****12 HP 38" TRACTOR - MODEL NUMBER YF1238A  
TRANSAXLE DANA-MODEL NUMBER 4360-7****TRANSAXLE**

KEY PART NO. NO.	DESCRIPTION	KEY PART NO. NO.	DESCRIPTION
1 3865	Housing, Upper	41 3645	Sprocket, 9 Teeth
2 1919	Screw, Tapping, Large 1/4-20 x .734	42 3853	Gear, Bevel, 42 Teeth
3 1151	Ball, Detent	43 3749	* Washer, Plain .758 x 1.12 x .010
4 3626	Spring, Detent	3652	* Washer, Plain .758 x 1.12 x .015
5 3623	Screw, Set	3693	* Washer, Plain .758 x 1.12 x .020
6 4336	Assembly, Shifter	3653	* Washer, Plain .758 x 1.12 x .025
7 3884	O-Ring	3408	* Washer, Plain .758 x 1.25 x .020
8 3885	* Washer, Plain .505 x .942 x .006	3732	* Washer, Plain .758 x 1.25 x .025
3886	* Washer, Plain .505 x .942 x .010	3184	* Washer, Plain .758 x 1.25 x .031
3887	* Washer, Plain .505 x .942 x .015	3733	* Washer, Plain .758 x 1.25 x .035
3888	* Washer, Plain .505 x .942 x .020	3198	* Washer, Plain .758 x 1.25 x .040
3889	* Washer, Plain .505 x .942 x .026	3734	* Washer, Plain .758 x 1.25 x .045
3121	* Washer, Plain .505 x .942 x .030	3735	* Washer, Plain .758 x 1.25 x .050
3890	* Washer, Plain .505 x .942 x .040	3736	* Washer, Plain .758 x 1.25 x .055
9 1100	Ring, Retaining	3180	* Washer, Plain .758 x 1.25 x .062
10 1099	Ring, Retaining	44 3882	Shaft, Drive
11 1959	* Washer, Plain .632 x 1.00 x .010	45 3646	Gear, Spur, 12 Teeth
1441	* Washer, Plain .632 x 1.00 x .020	46 3707	Gear, Spur, 15 Teeth
1423	* Washer, Plain .632 x 1.00 x .026	47 3866	Gear, Spur, 20 Teeth
1082	* Washer, Plain .632 x 1.00 x .031	48 3719	Gear, Spur, 25 Teeth
1424	* Washer, Plain .632 x 1.00 x .036	49 3868	Gear, Spur, 28 Teeth
1068	* Washer, Plain .632 x 1.00 x .041	50 3683	Gear, Spur, 31 Teeth
1425	* Washer, Plain .632 x 1.00 x .046	51 1145	Washer, Plain .632 x 1.00 x .060
1368	* Washer, Plain .632 x 1.00 x .050	52 3191	Seal, Felt
1145	* Washer, Plain .632 x 1.00 x .060	53 3180	Washer, Plain .758 x 1.25 x .062
1319	* Washer, Plain .632 x 1.00 x .082	54 3880	Axle, Left Hand
12 3312	O-Ring	55 3780	Gear, Miter, 15 Teeth
13 3876	Washer, Plain .632 x 1.38 x .046	56 3656	Ring, Retaining
14 1374	Key, Woodruff #9	57 3839	Gear, Spur, 32 Teeth
15 4134	Assembly, Kit, Input Shaft	58 3919	Shaft, Cross
16 3590	Pinion, Bevel, 14 Teeth	59 3781	Gear, Miter, 15 Teeth
17 3624	Ring, Retaining	60 3881	Axle, Right Hand
18 3625	Chain, 24 Pitches	61 3864	Housing, Lower
19 1542	Bearing, Flange	62 3920	Puck, Friction
20 3773	Gear, Spur, 14 Teeth	63 3276	Disc, Brake
21 3631	Collar, Clutch	64 3758	Spacer
22 3828	Key, Clutch	65 3916	Jaw, Brake
23 1369	Key, Woodruff	66 3843	Pin, Dowel
24 3883	Shaft, Intermediate	67 3915	Screw, Tapping, Large 5/16-18 x 2.25
25 1375	Key, Woodruff #61	68 3768	Lever, Actuating
26 3627	Ring, Retaining	69 3760	Washer, Plain .321 x 1.00 x .055
27 3830	Sprocket, 18 Teeth	70 3917	Bracket, Anti-Rotation
28 3841	Spacer	71 3847	Locknut 5/16-24
29 3786	Gear, Spur, 37 Teeth	72 3724	Screw, Tapping, Large 5/16-18 x 1.44
30 3785	Gear, Spur, 35 Teeth	73 3906	Washer, Plain .343 x .81 x .059
31 3867	Gear, Spur, 30 Teeth	74 3907	Puck, Friction
32 3783	Gear, Spur, 25 Teeth	75 4300	Grease
33 3869	Gear, Spur, 22 Teeth		
34 3741	Gear, Spur, 19 Teeth		
35 3628	Washer, Plain .640 x 1.37 x .061		
36 1423	Washer, Plain .632 x 1.00 x .026		
37 3422	Spacer .630 x 1.00 x .169		
38 4286	Assembly, Gear, Combination of 12 Teeth and 35 Teeth		
39 3877	Shaft, Idler		
40 3901	Spacer .635 x .875 x .755		

\* Use In Various Combinations To Maintain Proper Clearances.

\*\* Order Key Number 15

NOTE: All component dimensions given in U.S. inches  
1 inch = 25.4 mm