

brand **Flymo**

date **20.08.2002** Sheet **1/2**

Publication No. **P0208001**

**Model**

Gardenvac 1600 Plus UK  
 Gardenvac 1600 Plus CH  
 Gardenvac 1600 Plus EU

**Product Number**

9648628-01  
 9648628-22  
 9648628-62

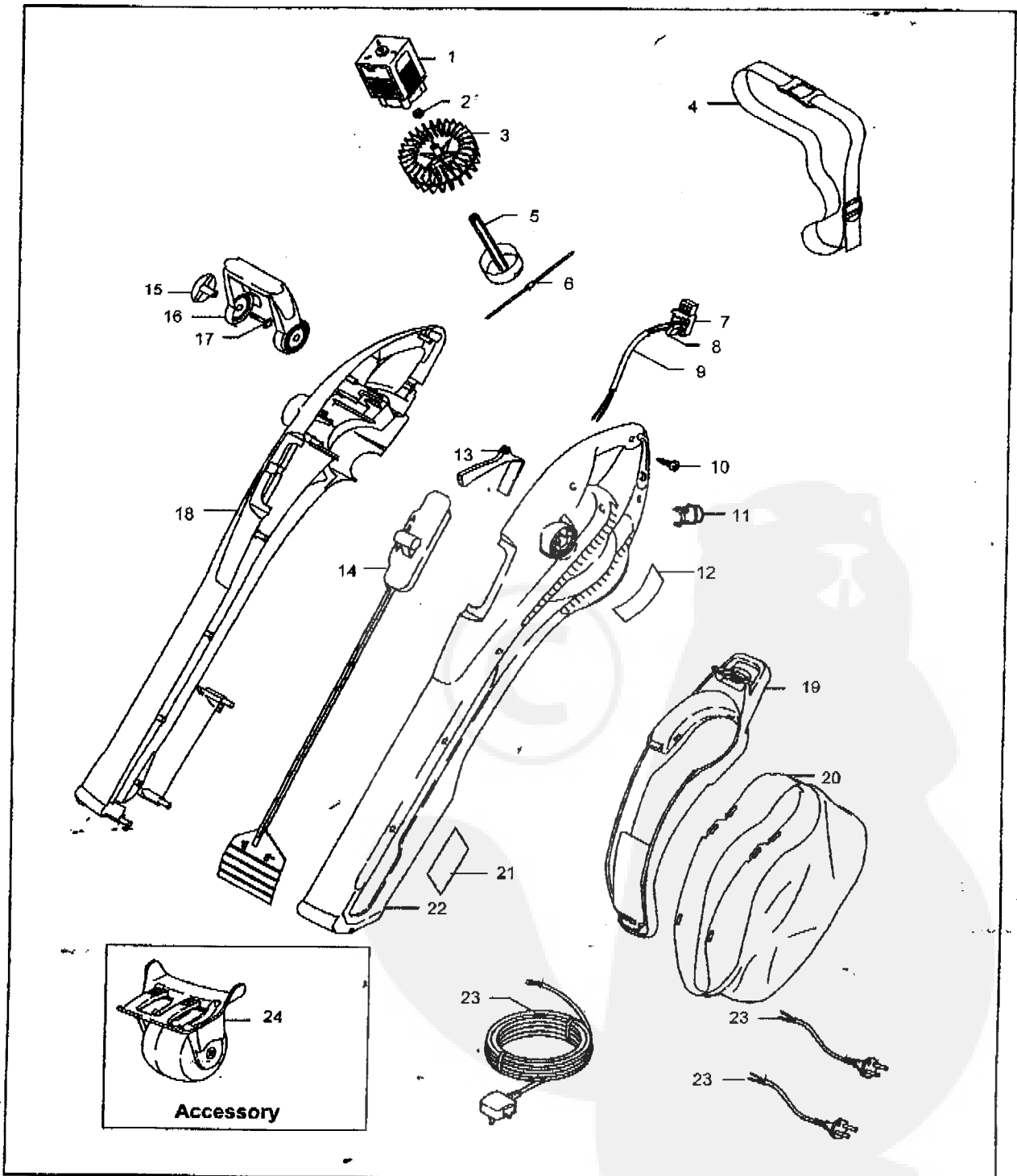

brand Flymo

date 20.08.2002 Sheet 2/2

Gardenvac 1600 Plus

| pos | Part No         | Description                      | Qty | pos | Part No | Description | Qty |
|-----|-----------------|----------------------------------|-----|-----|---------|-------------|-----|
| 1   | 5117930-21/3    | Motor assembly                   | 1   |     |         |             |     |
| 2   | 5149164-00/5    | Washer                           | 1   |     |         |             |     |
| 3   | 5118017-67/1    | Fan                              | 1   |     |         |             |     |
| 4   | 5139366-00/8    | Strap                            | 1   |     |         |             |     |
| 5   | 5119308-68/1    | Cutting Head                     | 1   |     |         |             |     |
| 6   | 5138593-80/0    | Shredding Line<br>Pre Pack (x5)  | 1   |     |         |             |     |
| 7   | 5130872-00/4    | Switch                           | 1   |     |         |             |     |
| 8   | 5148397-01/0    | Capacitor                        | 1   |     |         |             |     |
| 9   | 5138179-04/8    | Internal Lead<br>Assembly        | 1   |     |         |             |     |
| 10  | 5146672-00/0    | Screw                            | 12  |     |         |             |     |
| 11  | 5127732-68/2    | Cord Anchor                      | 1   |     |         |             |     |
| 12  | 5138370-00/1    | Warning Label                    | 1   |     |         |             |     |
| 13  | 5128037-68/5    | Switch actuator                  | 1   |     |         |             |     |
| 14  | 5106674-68/1    | Valve Mechanism                  | 1   |     |         |             |     |
| 15  | 5127577-68/1    | Wing Knob                        | 2   |     |         |             |     |
| 16  | 5118099-68/7    | Handle Front                     | 1   |     |         |             |     |
| 17  | 5148859-01/9    | Bolt                             | 2   |     |         |             |     |
| 18  | 5149382-07/8    | Clamshell Kit                    | 1   |     |         |             |     |
| 19  | 5130587-68/5    | Bag Frame/<br>Assembly           | 1   |     |         |             |     |
| 20  | 5106916-00/9    | Debris Bag                       | 1   |     |         |             |     |
| 21  | 5130941-00/7    | Model Label                      | 1   |     |         |             |     |
| 22  | 5149382-07/8    | Clamshell Kit                    | 1   |     |         |             |     |
| 23  | UK 5127251-10/5 | Extension Cable                  | 1   |     |         |             |     |
|     | CH 5147000-03/7 | Lead                             | 1   |     |         |             |     |
|     | EU 5147000-36/7 | Lead                             | 1   |     |         |             |     |
| 24  | 5118400-00/0    | Wheel Assembly<br>(not included) | 1   |     |         |             |     |