

brand **Flymo**

date **20.08.2002** Sheet **1/2**

Publication No. **P0208001**

Model

Gardenvac 1600 Plus UK
 Gardenvac 1600 Plus CH
 Gardenvac 1600 Plus EU

Product Number

9648628-01
 9648628-22
 9648628-62

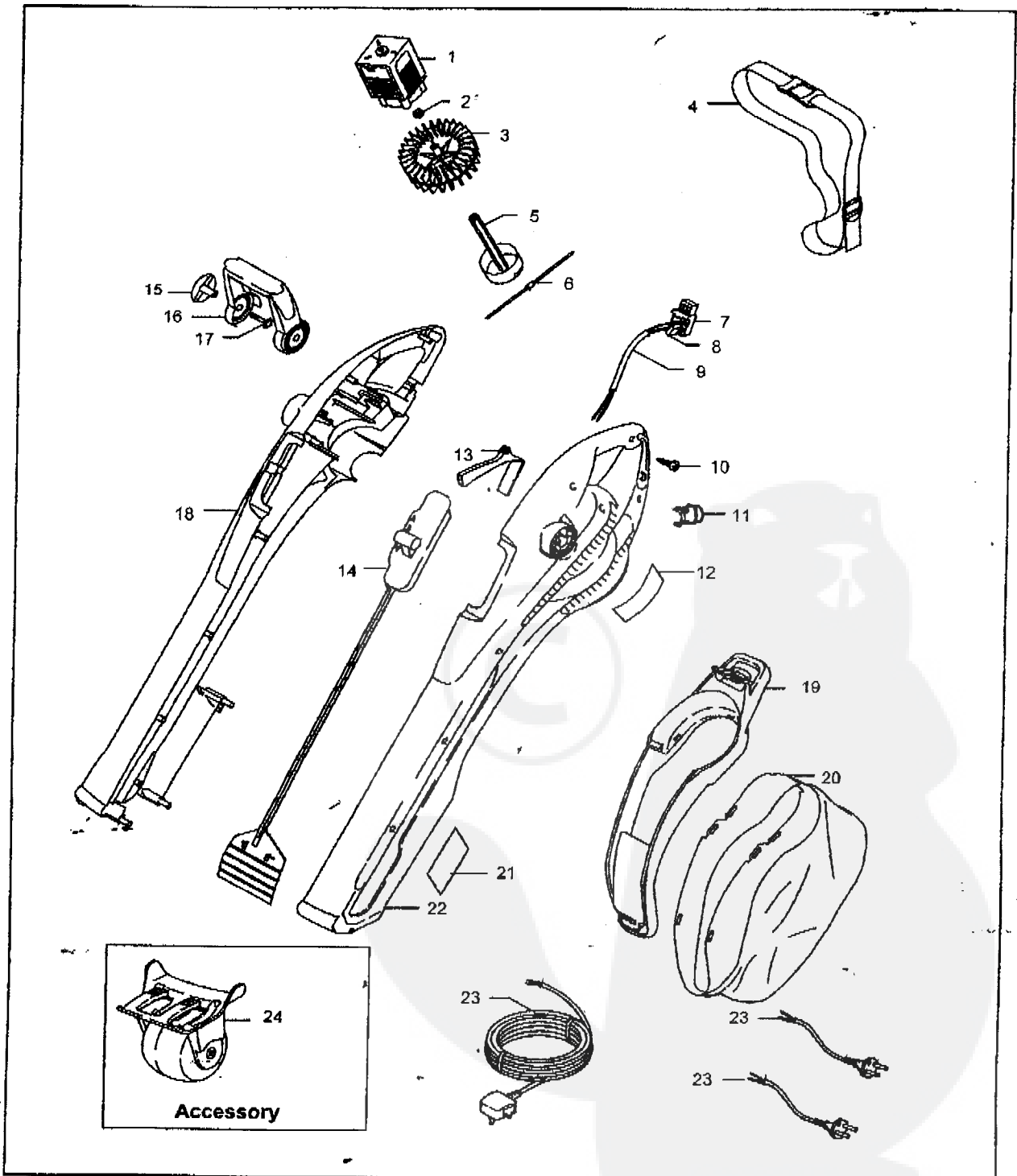

brand Flymo

date 20.08.2002 Sheet 2/2

Gardenvac 1600 Plus

| pos | Part No | Description | Qty | pos | Part No | Description | Qty |
|-----|-----------------|----------------------------------|-----|-----|---------|-------------|-----|
| 1 | 5117930-21/3 | Motor assembly | 1 | | | | |
| 2 | 5149164-00/5 | Washer | 1 | | | | |
| 3 | 5118017-67/1 | Fan | 1 | | | | |
| 4 | 5139366-00/8 | Strap | 1 | | | | |
| 5 | 5119308-68/1 | Cutting Head | 1 | | | | |
| 6 | 5138593-80/0 | Shredding Line Pre Pack (x5) | 1 | | | | |
| 7 | 5130872-00/4 | Switch | 1 | | | | |
| 8 | 5148397-01/0 | Capacitor | 1 | | | | |
| 9 | 5138179-04/8 | Internal Lead Assembly | 1 | | | | |
| 10 | 5146672-00/0 | Screw | 12 | | | | |
| 11 | 5127732-68/2 | Cord Anchor | 1 | | | | |
| 12 | 5138370-00/1 | Warning Label | 1 | | | | |
| 13 | 5128037-68/5 | Switch actuator | 1 | | | | |
| 14 | 5106674-68/1 | Valve Mechanism | 1 | | | | |
| 15 | 5127577-68/1 | Wing Knob | 2 | | | | |
| 16 | 5118099-68/7 | Handle Front | 1 | | | | |
| 17 | 5148859-01/9 | Bolt | 2 | | | | |
| 18 | 5149382-07/8 | Clamshell Kit | 1 | | | | |
| 19 | 5130587-68/5 | Bag Frame/ Assembly | 1 | | | | |
| 20 | 5106916-00/9 | Debris Bag | 1 | | | | |
| 21 | 5130941-00/7 | Model Label | 1 | | | | |
| 22 | 5149382-07/8 | Clamshell Kit | 1 | | | | |
| 23 | UK 5127251-10/5 | Extension Cable | 1 | | | | |
| | CH 5147000-03/7 | Lead | 1 | | | | |
| | EU 5147000-36/7 | Lead | 1 | | | | |
| 24 | 5118400-00/0 | Wheel Assembly (not included) | 1 | | | | |