



IPL XL500, 9638508-59, 2005-12

# XL500



**Factory:**  
**Product Group:**  
**Sub Group:**  
**Publication Date:**  
**Publication Number:**

**FLM - Newton Aycliffe**  
**ON 107**  
**Petrol Hover: 1072**  
**01/12/05**  
**AP0512001**

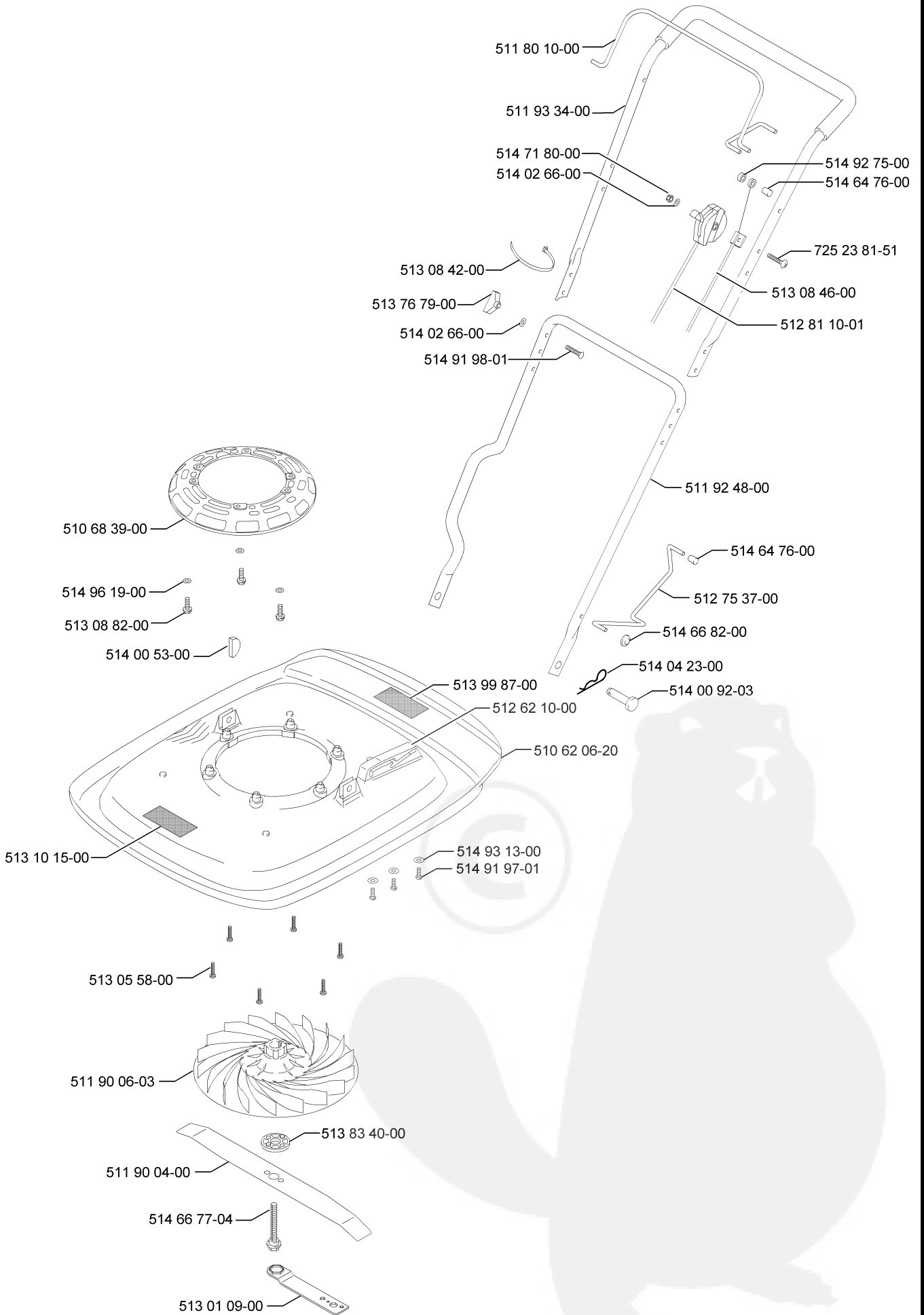

Part Number	Description	Qty	Note
510 62 06-20	HOOD 47CM	1	
510 68 39-00	ADAPTOR PLATE SAE ENGINE MOU	1	
511 80 10-00	BAIL ARM	1	
511 90 04-00	BLADE 51cm	1	
511 90 06-03	IMPELLER GT500	1	
511 92 48-00	HANDLE LOWER(PET HOVER)	1	
511 93 34-00	HANDLE UPPER ASSEMBLY	1	
512 62 10-00	SLOTTED GUIDE	1	
512 75 37-00	HOOK SLOTTED GUIDE	1	
512 81 10-01	CABLE CHOKE PETROL HOVER	1	
513 01 09-00	SPANNER (PETROL)	1	
513 05 58-00	SCREW HEX FLANGE HEAD 10UNC	6	
513 08 42-00	TIE WRAP (3.5 X 150)	3	
513 08 46-00	CABLE ENGINE BRAKE PETROL HO	1	
513 08 82-00	SOCKET CAP SCREW 3/8X16 UNCT	3	
513 10 15-00	LABEL XL500	1	
513 76 79-00	PLASTIC WING NUT M6 ORANGE	2	
513 83 40-00	BLADE SPACER	2	
513 99 87-00	WARNING LABEL (PETROL YELLOW	1	
514 00 53-00	KEY(WOODRUFF)	1	
514 00 92-03	PIVOT PIN	2	
514 02 66-00	WASHER 6.4-6.7 IDX12.1-12.3	1	
514 02 66-00	WASHER 6.4-6.7 ID x 12.1-12.3	2	
514 04 23-00	SPRING CLIP SMALL	2	
514 64 76-00	KNOB	2	
514 66 77-04	BOLT BLADE 75 O/A LG.	1	
514 66 82-00	STARLOCK WASHER	1	
514 71 80-00	NUT M6 NYLOC GME/D	1	
514 91 97-01	SCREW No10-13x19LG SD PAN HD	3	
514 91 98-01	BOLT M6 X 50 SQUARE CUP	2	
514 92 75-00	SPACER (BAIL ARM)	1	
514 93 13-00	2-BA LARGE BRIGHT WASHER	3	
514 96 19-00	M10 WASHER	3	
725 23 81-51	SCREW M6 X 55	1	

