

TF022D-□ D10

1

CYLINDER/CRANKCASE

E0110-2058A

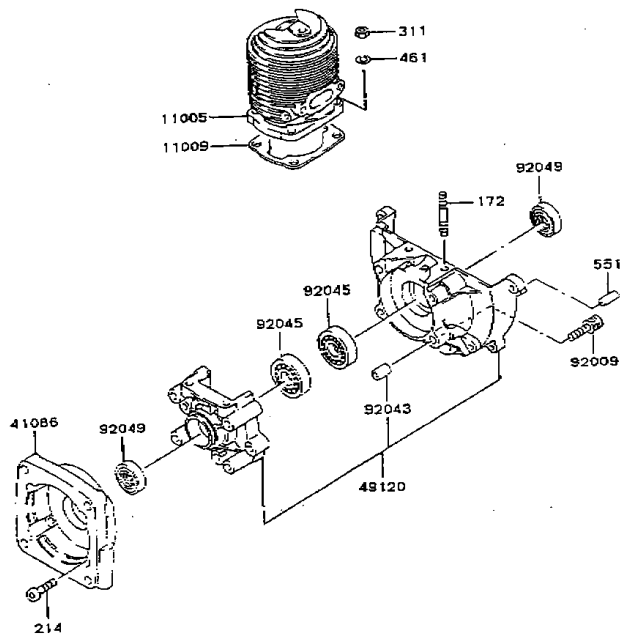

| Ref. No. | Parts No.    | Description         | Quantity |
|----------|--------------|---------------------|----------|
| 11005    | 11005-2100   | CYLINDER-ENGINE     | 1        |
| 11009    | 11009-2286   | GASKET,CYLINDER     | 1        |
| 41086    | 41086-2090   | FLANGE              | 1        |
| 49120    | 49120-6040   | CRANKCASE-COMP      | 4        |
| 92009    | 92009-2115   | SCREW               | 4        |
| 92043    | 92043-1302   | PIN                 | 2        |
| 92045    | 311501-4211A | BEARING-BALL,6001V3 | 2        |
| 92049    | 92049-2108   | SEAL-OIL            | 2        |
| 172      | 172G0514     | BOLT-STUD           | 4        |
| 214      | 214B0516     | SCREW-PAN+-         | 4        |
| 311      | 311B0500     | NUT-HEX             | 4        |
| 461      | 461P0500     | WASHER-SPRING       | 4        |
| 551      | 551A0410     | PIN-DOWEL           | 2        |

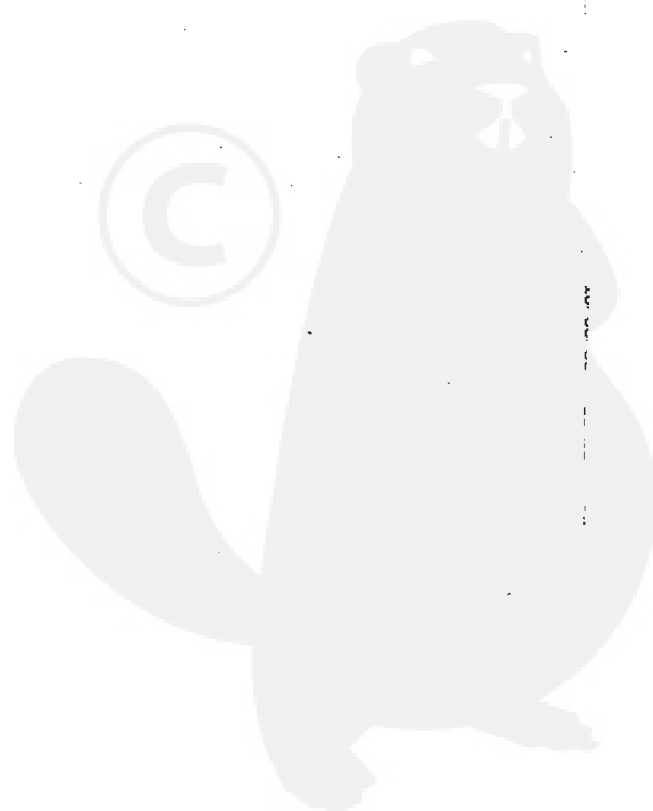

TF022D-□ D10

3 COOLING-EQUIPMENT

E0150-2119A

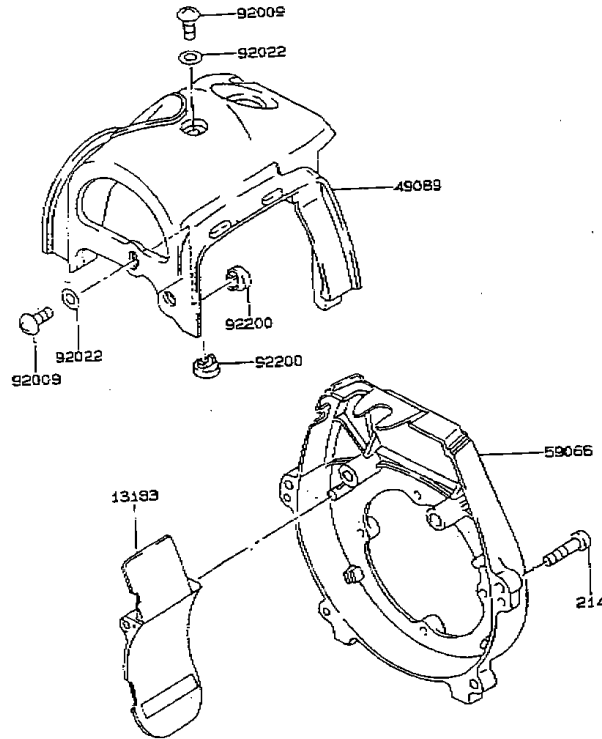

| Ref. No. | Parts No.     | Description        | Quantity |
|----------|---------------|--------------------|----------|
| 13183    | 13183-2080    | PLATE              | 1        |
| 49089    | 49089-2236    | SHROUD-ENGINE      | 1        |
| 59066    | 59066-2408-9B | HOUSING-FAN        | 1        |
| 92009    | 92009-2236    | SCREW, 4X16        | 2        |
| 92022    | 92022-2230    | WASHER, 4.5X10X1.2 | 2        |
| 92200    | 92200-2008    | WASHER             | 2        |
| 214      | 214B0416      | SCREW-PAN+-        | 4        |

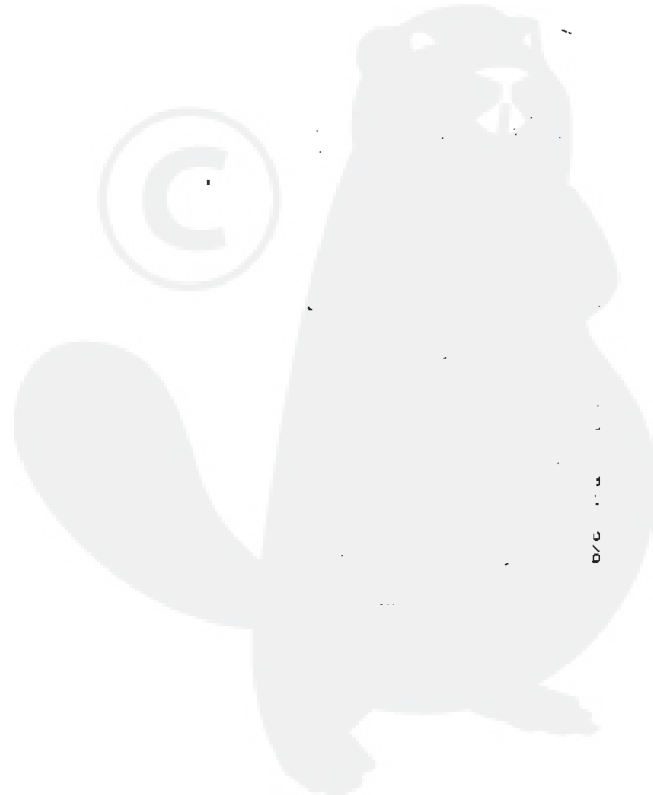

TF022D-D10

4 ELECTRIC-EQUIPMENT

E0160-2527A

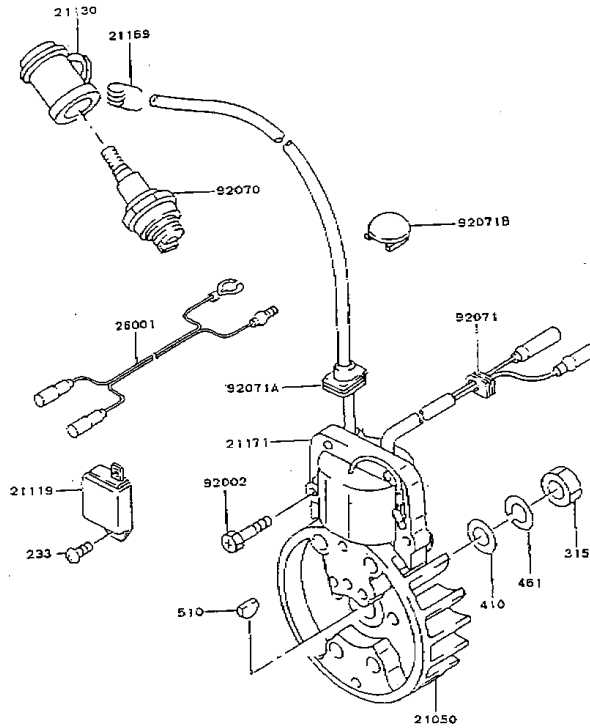

| Ref. No. | Parts No.    | Description           | Quantity |
|----------|--------------|-----------------------|----------|
| 21050    | 21050-2194   | FLYWHEEL              | 1        |
| 21119    | 21119-2134   | IGNITER               | 1        |
| 21130    | 3119AA-8418D | CAP-SPARK PLUG        | 1        |
| 21169    | 311509-8419B | TERMINAL              | 1        |
| 21171    | 21171-2182   | COIL-ASSY-IGNITION    | 1        |
| 26001    | 26001-2397   | HARNESS               | 1        |
| 92002    | 311510-8127A | BOLT-4X20             | 2        |
| 92070    | 92070-2056   | PLUG-SPARK.BM4A (NGK) | 1        |
| 92071    | 310702-8164A | GROMMET               | 1        |
| 92071A   | 92071-2115   | GROMMET               | 1        |
| 92071B   | 92071-2118   | GROMMET               | 1        |
| 233      | 233B0408     | SCREW-PAN-WP+-        | 1        |
| 315      | 315B0800     | NUT-HEX-FINE          | 1        |
| 410      | 410B0800     | W-PLAIN-S             | 1        |
| 461      | 461F0800     | WASHER-SPRING         | 1        |
| 510      | 510A3100     | KEY-WOODRUFF          | 1        |

TF022D-□ D10

6 CARBURETOR

E0180-2275A

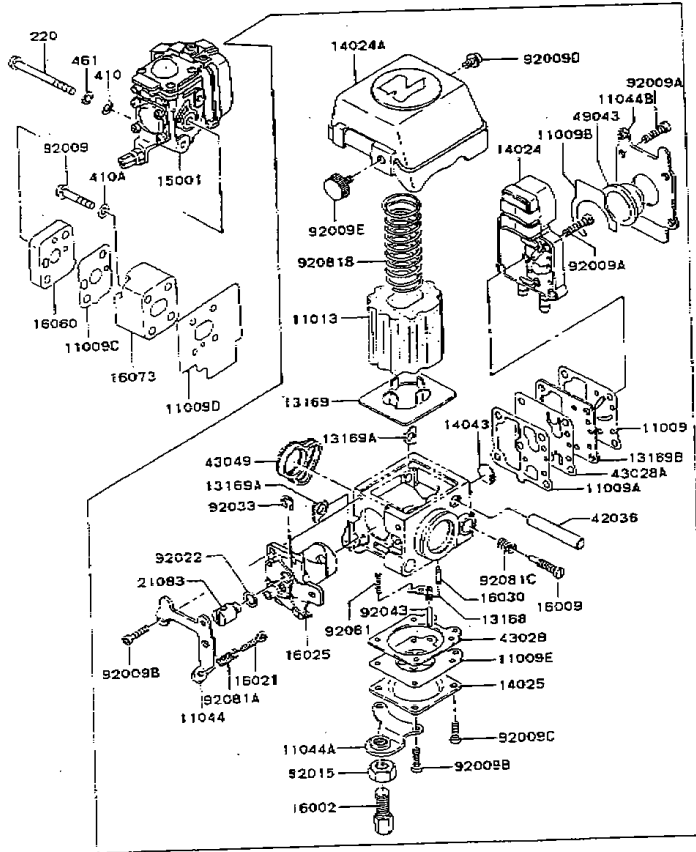

| Ref. No. | Parts No.    | Description         | Quantity |
|----------|--------------|---------------------|----------|
| 11009    | 11009-2440   | GASKET              | 1        |
| 11009A   | 11009-2441   | GASKET              | 1        |
| 11009B   | 11009-2442   | GASKET              | 1        |
| 11009C   | 11009-2458   | GASKET              | 1        |
| 11009D   | 11009-2715   | GASKET, INSULATOR   | 1        |
| 11009E   | 310370-6171A | GASKET              | 1        |
| 11013    | 11013-2099   | ELEMENT-AIR FILTER  | 1        |
| 11044    | 11044-2086   | BRACKET             | 1        |
| 11044A   | 11044-2087   | BRACKET             | 1        |
| 11044B   | 11044-2088   | BRACKET             | 1        |
| 13168    | 310370-6178A | LEVER               | 1        |
| 13169    | 13169-2418   | PLATE               | 2        |
| 13169A   | 13169-2419   | PLATE               | 1        |
| 13169B   | 13169-2420   | PLATE               | 1        |
| 14024    | 14024-2024   | COVER               | 1        |
| 14024A   | 14024-2026   | COVER               | 1        |
| 14025    | 310370-6165A | COVER               | 1        |
| 14043    | 310370-6168A | FILTER              | 1        |
| 15001    | 15001-2405   | CARBURETOR-ASSY     | 1        |
| 16002    | 16002-2053   | ADJUSTER-CABLE      | 1        |
| 16009    | 16009-2081   | NEEDLE-JET          | 1        |
| 16021    | 16021-2057   | SCREW-THROTTLE STOP | 1        |
| 16025    | 16025-2094   | VALVE-THROTTLE      | 1        |
| 16030    | 16030-2078   | VALVE-FLOAT         | 1        |
| 16060    | 16060-2118   | PIPE-INTAKE         | 1        |
| 16073    | 16073-2100   | INSULATOR           | 1        |
| 21083    | 21083-2059   | ARM                 | 1        |
| 42036    | 42036-2062   | SLEEVE              | 1        |
| 43028    | 310370-6160A | DIAPHRAGM           | 1        |
| 43028A   | 43028-2061   | DIAPHRAGM           | 1        |
| 43049    | 43049-2051   | PACKING             | 1        |
| 49043    | 49043-2064   | PUMP-PRIMING        | 2        |
| 92009    | 92009-2115   | SCREW               | 5        |
| 92009A   | 92009-2185   | SCREW               | 4        |
| 92009B   | 92009-2186   | SCREW               | 4        |
| 92009C   | 92009-2187   | SCREW               | 2        |
| 92009D   | 92009-2188   | SCREW               | 1        |
| 92009E   | 92009-2189   | SCREW               | 1        |
| 92015    | 92015-2145   | NUT                 | 1        |
| 92022    | 92022-2210   | WASHER              | 1        |

TF022D-□ D10

6 CARBURETOR

E0180-2275A

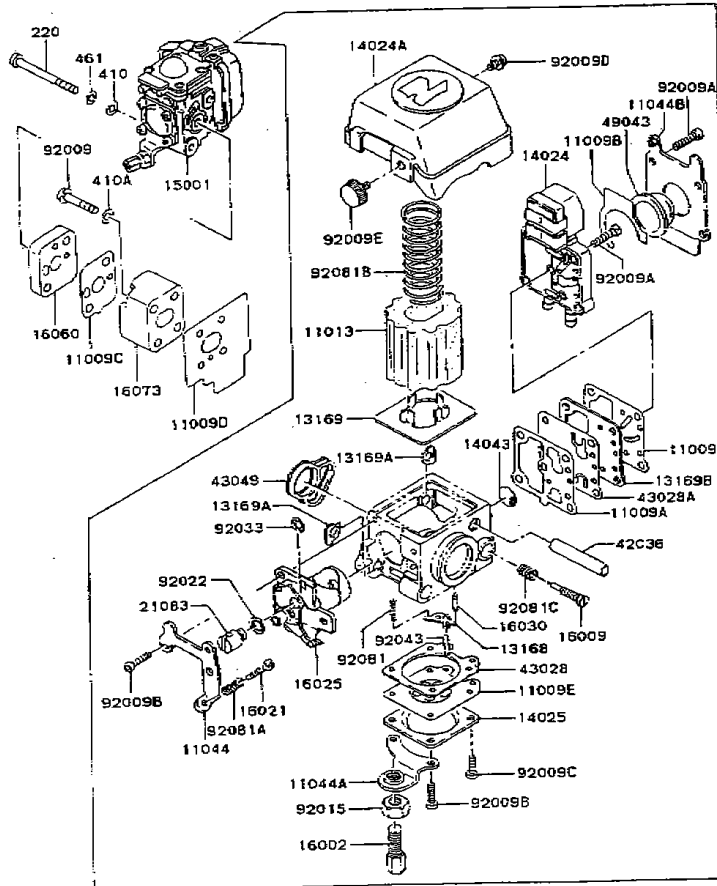

| Ref. No. | Parts No.    | Description    | Quantity |
|----------|--------------|----------------|----------|
| 92033    | 92033-2078   | RING-SNAP      | 1        |
| 92043    | 310370-6127A | PIK            | 1        |
| 92081    | 92081-2308   | SPRING         | 1        |
| 92081A   | 92081-2309   | SPRING         | 1        |
| 92081B   | 92081-2310   | SPRING         | 1        |
| 92081C   | 92081-2311   | SPRING         | 1        |
| 220      | 220B0455     | SCREW-PAN-CROS | 2        |
| 410      | 410B0400     | W-PLAIN-S      | 2        |
| 410A     | 410B0500     | W-PLAIN-S      | 2        |
| 461      | 461F0400     | WASHER-SPRING  | 2        |

NV EUROGARDEN SA  
 Sint-Truidensesteenweg 252  
 B-3300 Tienen - Belgium  
 Tel. ++32 (0)16 80 54 32  
 Fax ++32 (0)16 80 54 38

NV EUROGARDEN SA  
 Sint-Truidensesteenweg 252  
 B-3300 Tienen - Belgium  
 Tel. ++32 (0)16 80 54 32  
 Fax ++32 (0)16 80 54 38

TF022D-D10

E0190-2336A

AIR-FILTER/MUFFLER

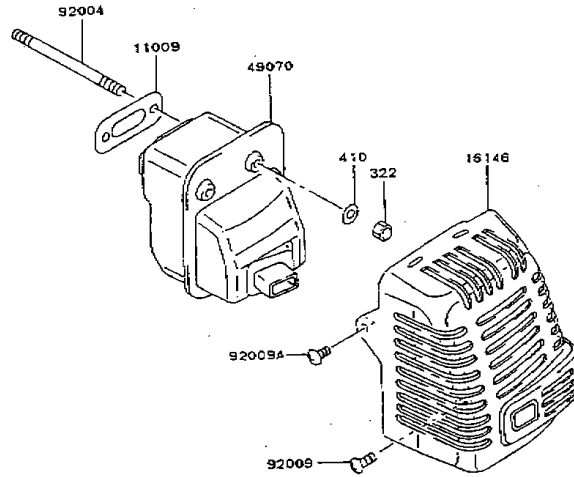

| Ref. No. | Parts No.    | Description     | Quantity |
|----------|--------------|-----------------|----------|
| 11009    | 11009-2513   | GASKET, MUFFLER | 1        |
| 16146    | 16146-2130   | COVER-ASSY      | 1        |
| 49070    | 49070-2405   | MUFFLER-COMP    | 1        |
| 92004    | 310780-1483A | STUD            | 2        |
| 92009    | 92009-2234   | SCREW, 4X10     | 1        |
| 92009A   | 92009-2236   | SCREW, 4X16     | 1        |
| 322      | 322B0500     | NUT             | 2        |
| 410      | 410B0500     | V-PLAIN-S       | 2        |

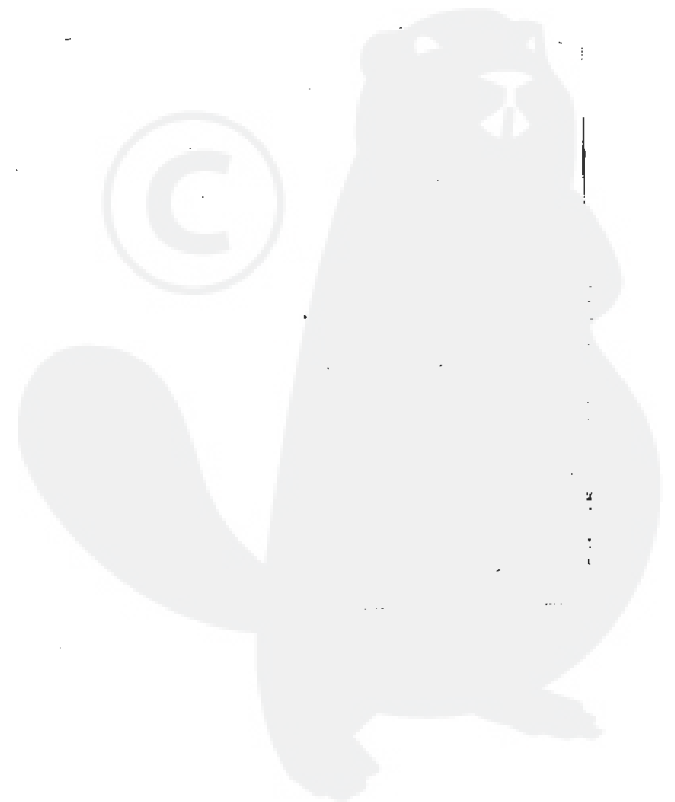

TFO22D-D10

8

FUEL-TANK/FUEL-VALVE

E0200-2307A

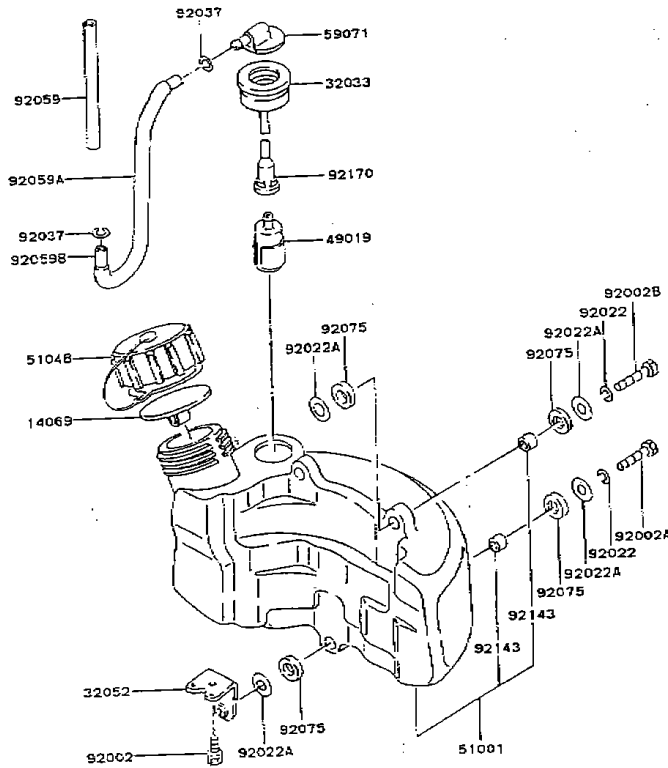

| Ref. No. | Parts No.    | Description        | Quantity |
|----------|--------------|--------------------|----------|
| 14069    | 311409-6646B | BREATHER           | 1        |
| 32033    | 310370-6816A | PIPE               | 1        |
| 32052    | 32052-2157   | BRACKET-TANK       | 1        |
| 49019    | 49019-2097   | FILTER-FUEL        | 1        |
| 51001    | 51001-2184   | TANK-COMP-FUEL     | 1        |
| 51048    | 51048-2066   | CAP-ASSY-TANK      | 1        |
| 59071    | 59071-2066   | JOINT              | 1        |
| 92002    | 92002-2313   | BOLT               | 1        |
| 92002A   | 92002-2322   | BOLT               | 2        |
| 92002B   | 92002-2324   | BOLT               | 2        |
| 92022    | 31153S-6787A | WASHER             | 3        |
| 92022A   | 92022-2238   | WASHER, 5.2X15X1.2 | 3        |
| 92037    | 310117-6812A | CLAMP              | 1        |
| 92059    | 92059-2172   | TUBE, 3X5X40       | 1        |
| 92059A   | 92059-2242   | TUBE               | 1        |
| 92059B   | 92059-2243   | TUBE               | 1        |
| 92075    | 92075-2116   | DAMPER             | 1        |
| 92143    | 92143-2159   | COLLAR             | 1        |
| 92170    | 92170-2055   | CLAMP              | 1        |

TF022D-□ D10

1 O - P.T.O.-EQUIPMENT

E0220-2008C

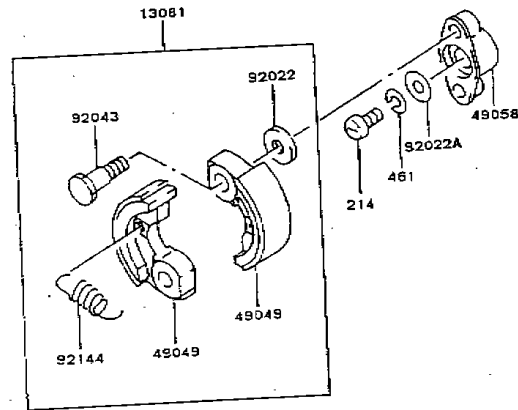

| Ref. No. | Parts No.    | Description         | Quantity |  |
|----------|--------------|---------------------|----------|--|
|          |              |                     | B        |  |
| 13081    | 13081-2150   | CLUTCH-ASSY         | 1        |  |
| 49049    | 49049-2070   | SHOE-CLUTCH         | 2        |  |
| 49058    | 49058-2053   | WHEEL-CLUTCH        | 1        |  |
| 92022    | 31154E-3595A | WASHER              | 2        |  |
| 92022A   | 92022-2374   | WASHER,6.5X14.5X1.0 | 1        |  |
| 92043    | 31154E-3544A | PIN                 | 2        |  |
| 92144    | 92144-2086   | SPRING-CLUTCH       | 1        |  |
| 214      | 214B0612     | SCREW-PAN+-         | 1        |  |
| 461      | 461F0600     | WASHER-SPRING       | 1        |  |

