

RICAMBI
 PIECES
 SPARE PARTS
 ERSATZTEILE
 REPUESTOS

4LD640
4LD640/L

4LD705

4LD820
4LD820/L

LC
 FAB
 REC
 MZ

LON
 FABBI
 REGG
 MAC

SER
 POC
 GAS
 DICH
 SER
 RICH
 PIEC
 MAI
 WAJ
 REPU

SERI
 POCI
 GASI
 DICH
 SERIE
 RICAT
 PIECE
 MAIN
 WAR
 REPU

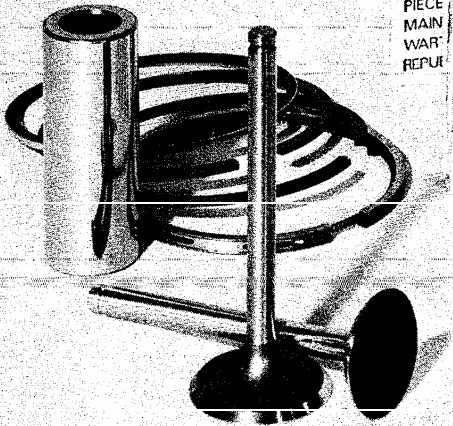

SERVICE

LOMBARDINI
 FABBRICA ITALIANA MOTORI s.p.a.
 REGGIO EMILIA, ITALIA
MADE IN ITALY

SERIE GUARNIZIONI
 POCHETTE JOINTS
 GASKET SET
 DICHTUNGSATZ
 SERIE JUNTAS

RICAMBI PRIMO IMPIEGO
 PIECES POUR L'ENTRETIEN
 MAINTENANCE SPARE PARTS
 WARTUNG - ERSATZTEILE
 REPUESTOS DE PRONTO EMPLEO

REPUESTOS ORIGINALES
ORIGINAL ERSATZTEILE
GENUINE SPARE PARTS
PIECES D'ORIGINE
RICAMBI ORIGINALI

LOMBARDINI MOTORI

LOMBARDINI MOTORI

SERVICE

Per assistenza, rivolgetevi alle stazioni di servizio autorizzate Lombardini. N. tel. su libro verde 800-010000. Per vendite e riparazioni, rivolgetevi alle stazioni di servizio autorizzate Lombardini. N. tel. su libro verde 800-010000. Adressez-vous aux stations de service autorisées Lombardini. N. tel. sur livre vert 800-010000. Para asistencia, diríjase a las estaciones de servicio autorizadas Lombardini. N. tel. en libro verde 800-010000.

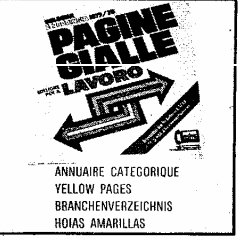
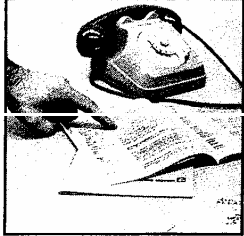
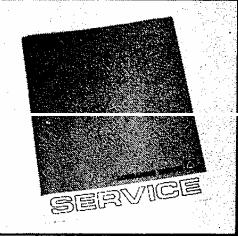

**ORDINI RICAMBI
COMMANDES PIECES
PART ORDERS
E-TEIL BESTELLUNG
PEDIDOS DE REPUESTO**

**TIPO MOTORE
TYPE DE MOTEUR
ENGINE TYPE
MOTORTYP
TIPO DEL MOTOR**

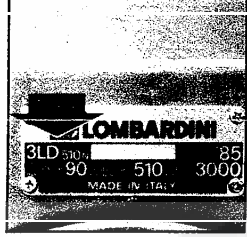
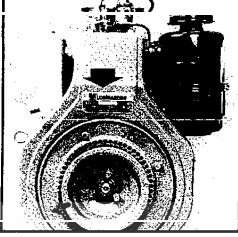

**MATRICOLA
MATRICULE
SERIAL NUMBER
MOTORENNUMMER
NUMERO DEL MOTOR**

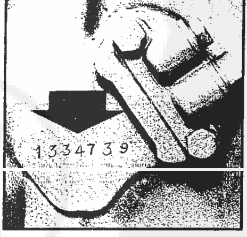
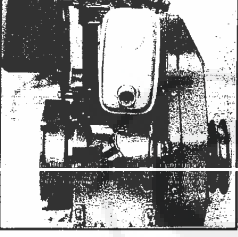
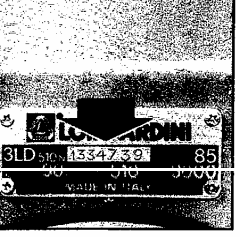
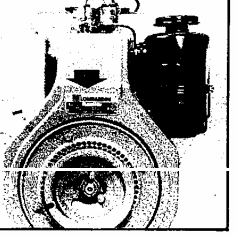

**TIPO DELLA MACCHINA
TYPE DE MACHINE
EQUIPMENT TYPE
MASCHINENTYP
MODELO DE LA MAQUINA**

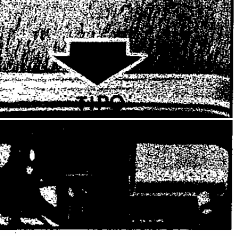
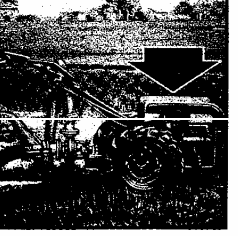

**MATRICOLA del ricambio
REFERENCE de la pièce
SPARE PART number
BESTELNUMMER des Teiles
REFERENCIA dei repuesto**

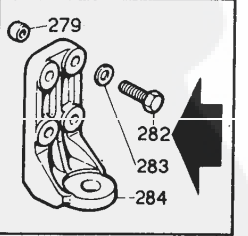
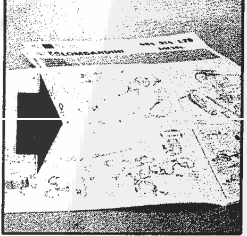

LOMBARDINI ENGINE
LOMBARDINI FRANCE
LOMBARDINI MOTORI
LOMBARDINI MOTORS

RICAMBI PER MOTORE STANDARD.
PER APPLICAZIONI SPECIALI CONSULTARE
IL CATALOGO PRESSO I CENTRI ASSISTENZA
E RICAMBI.

PIECES POUR DES MOTEURS STANDARD.
POUR LES ADAPTATIONS CONSULTER
LE CATALOGUE AUPRES
DES AGENTS SERVICE.

SPARE PARTS FOR STAN
FOR SPECIAL APPLICATI
CATALOG AT SERVICE CE

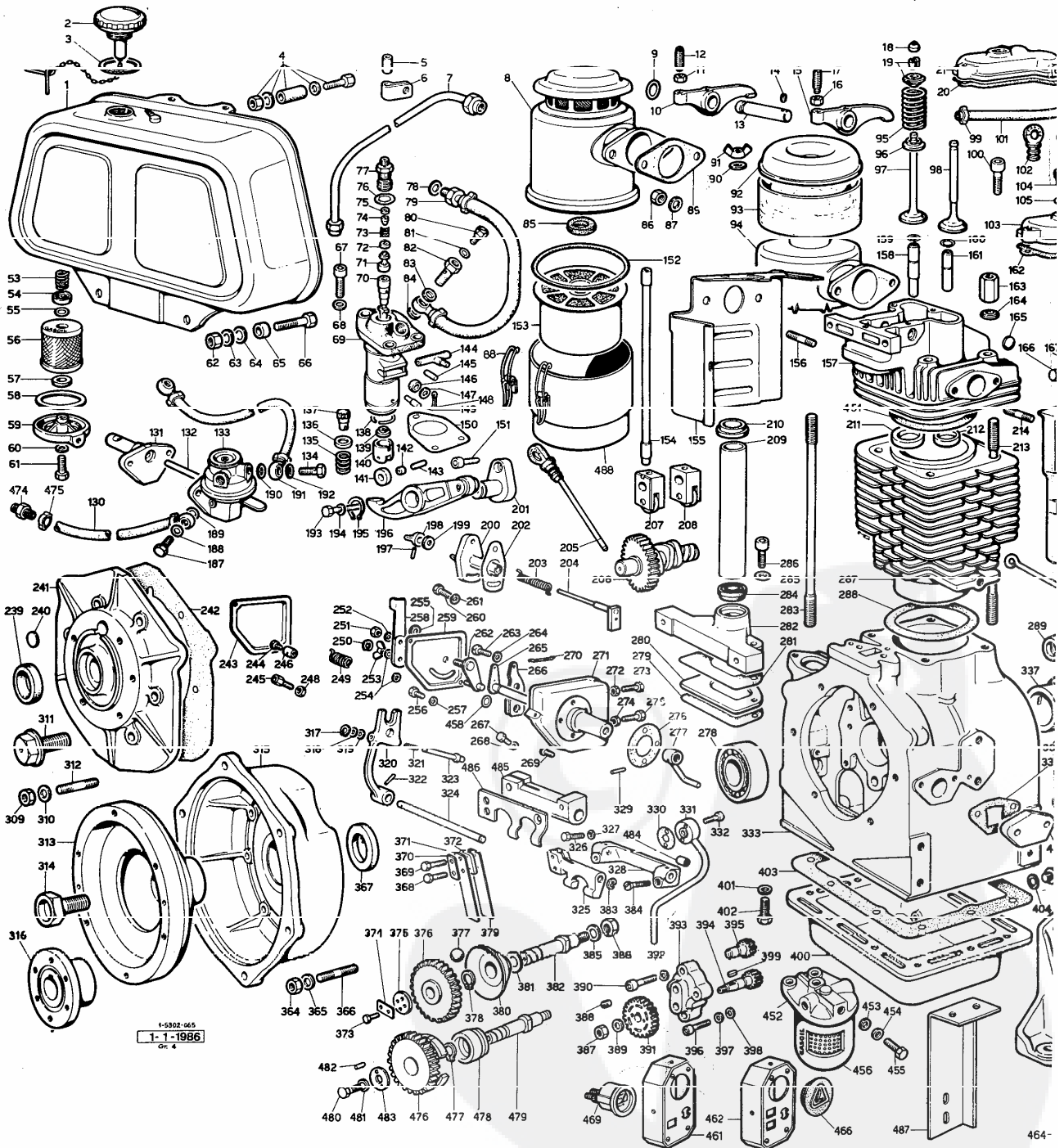

STANDARD ENGINE.
APPLICATIONS SEE MASTER
LISTING CENTERS.

ERSATZTEILE FÜR STANDARD-MOTOREN.
FÜR SONDERANFERTIGUNGEN SIEHE
ERSATZTEILKATALOG BEI SERVICE
WERKSTÄTTEN.

REPUESTOS PARA MOTORES STANDARD.
PARA APLICACIONES VEASE CATALOGO
EN LAS ESTACIONES SERVICE.

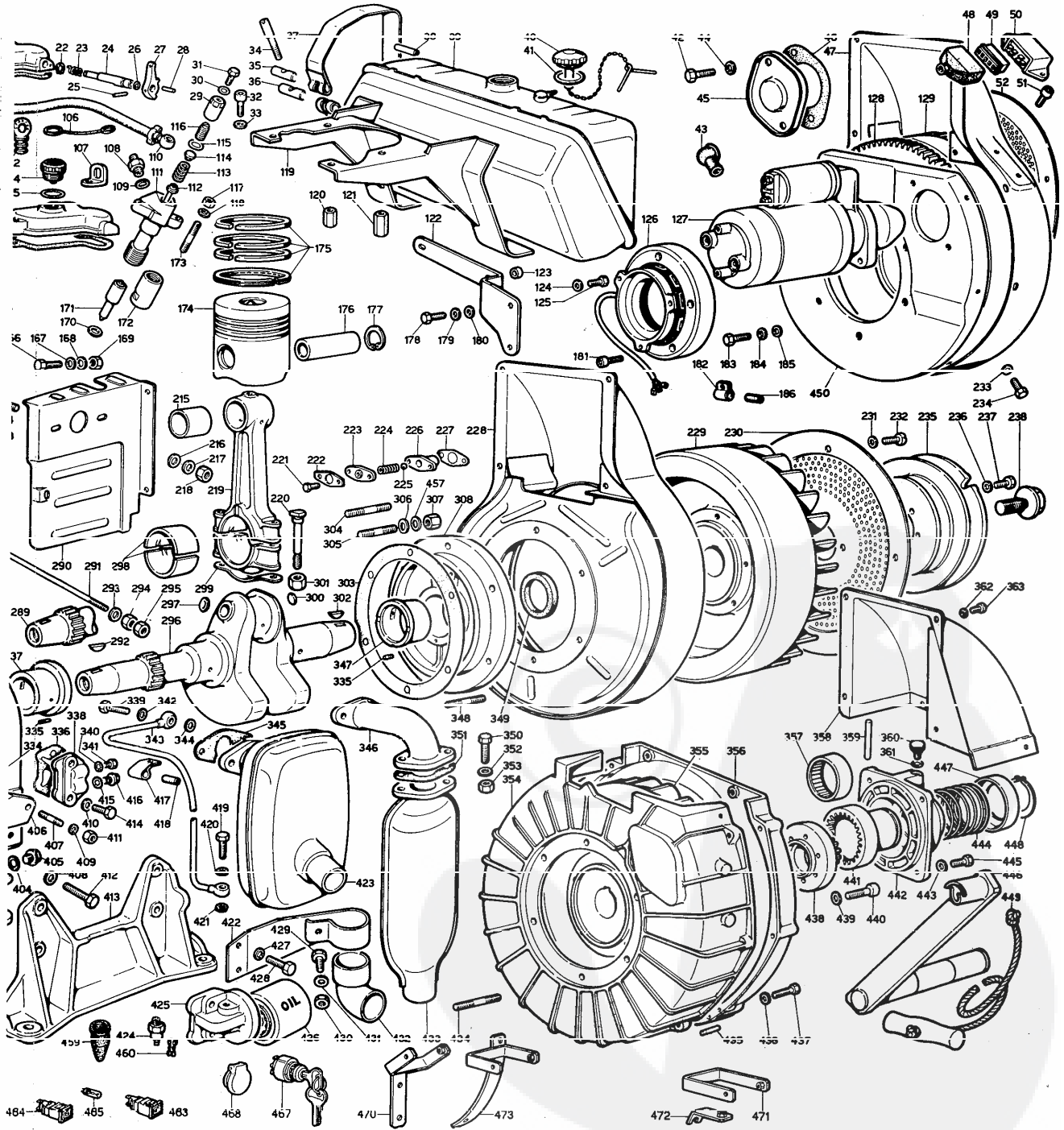

9345-33
Tubo 2

6184-6727-03
Pre-filtro

271-3334-34
Decalcomania

8060-3700-96
Filtro aria

270-4115-29
Gancio 2

5330-05
Spessore

8740-17
Supporto

261-3615-26
Fascetta

260-3690-24
Fascetta 4

263-9425-05
Tubo

30-7555-08
Rondella 2

236-3240-37
Dado (6x1,5) 2

3750-41
Plangia

270-4500-05
Guarnizione 2

890-2200-50
Prigionero (6x1,5) 2

261-3615-20
FASCETTA COMPL.

260-9730-36
Vite (6x1,25)

254-1557-07
Bioschermo

254-1557-18
Bioschermo

NOTE - REMARQUES - REMARKS
-In ambiente polveroso.
-Dans une atmosphère poussiéreuse.
-Under dusty conditions,
-Fornito separato.
-Livré séparé
-Separately supplied.

* NON FORNITO SEPARATO
NON LIVRÉ SEPARÉMENT
NOT SUPPLIED SEPARATELY

COMPLESSIVO - GROUPE - ASSEMBLY	FILTRO ARIA PREDIS. PREFILTRO A CICLONE FILTRE A AIR ADAPT. POUR PREFILTRE CYCL. AIR CLEANER SUITABLE FOR CYCL. PREFILTER	TAVOLA TABLE 4 41 14
MOTORE O VERSIONE MOTEUR OU ADAPTATION ENGINE OR VERSION	LDA 96-97-100 (K.9954.32)	FOGLIO FEUILLE PAGE -
		DATE 2-73

370.167

6184-9545-79
Tubo

270-4500-50
Prigionero (6x1,5) 2

5630-24
Fascetta 2

270-4500-05
Guarnizione 2

6184-9545-41
Filtro aria

271-3334-34
Decalcomania

270-4115-29
Gancio 3

270-3525-80
Spessore

270-5496-08
Massa filtrante

1002-9731-22
Vite (2x1,5) 1

205-7625-26
Rondella 3

6184-6727-03
Pre-filtro

8104-8301-71
Supporto

8021-3206-20
Dado 2

8021-3206-19
Dado 2

30-7555-08
Rondella 2

236-3240-37
Dado (6x1,5) 2

270-4450-16
Guarnizione

NOTE - REMARQUES - REMARKS
-In ambiente polveroso.
-Dans une atmosphère poussiéreuse.
-Under dusty conditions,
-Con presa aria laterale.
-Avec prise d'air latérale.
-With side air inlet.

* NON FORNITO SEPARATO
NON LIVRÉ SEPARÉMENT
NOT SUPPLIED SEPARATELY

COMPLESSIVO - GROUPE - ASSEMBLY	FILTRO ARIA FILTRE A AIR AIR CLEANER	TAVOLA TABLE 4 41 15
MOTORE O VERSIONE MOTEUR OU ADAPTATION ENGINE OR VERSION	LDA 96-97-100 (K.9954.45)	FOGLIO FEUILLE PAGE -
		DATE 2-73



4

LDA 91	
LDA 96	4 LD 640
LDA 97	4 LD 640*
LDA 100	4 LD 705
LDA 820	4 LD 820
L 10	4 LD 640/L
L 14	4 LD 820/L

Gr. 4

LEGENDA TAVOLA RICAMBI MATR.
 SPARE PARTS TABLE P.NO. 1.5302.065
 TABLEAU PIECES DETACHEES REF.

 01.01.1986

MOTORI TIPO/ENGINES TYPE/MOTEURS TYPE

4LD 640	4LD 705	4LD 820
4LD 640/L		4LD 820/L

Vedi/See/Voir

Libretto Uso e Manutenzione	
Use-Maintenance booklet	1.5302.075
Livret Emploi-Entretien	
Libretto Service	
Service directory	1.7968.002
Reseau S.A.V.	
Serie accessori	
Accessory set	283.8140.080
Jeu accessoires	

note/remarks/remarques

- F - alta movimentazione/fast moving part/haut mouvement.
- S - media movimentazione/medium moving part/moyen mouvement.
- D - bassa movimentazione/slow moving part/bas mouvement.
- E - ad esaurimento/exhausting part/piece en epuisement.
- N - particolare nuovo o fornito su richiesta/
 -new part or part supplied upon request/
 -piece nouvelle ou fournie sur demande.
- A - valido dal motore.../from eng.S.No.../a partir du moteur...
 (vedi Circolare Tecnica/see Service Letter/voir Circ.Techn.)
- B - valido fino al motore.../up to eng.S.No.../jusqu'au moteur...
 (vedi circolare tecnica/see Service Letter/voir circ.techn.)
- I - intercambiabile/interchangeable.
 (vedi Circolare Tecnica/see Service Letter/voir Circ.Techn.)
- V - stock vitale per Officine Service.
 vital stock for Service Dealer.
 stock vital pour Stations Service.
- C - stock vitale per Costruttori,Esportatori,Enti di Stato.
 vital stock for Producers,Exporters,State Companies.
 stock vital pour Constructeurs,Export.,Institut.de L'Etat.
- R - stock vitale per Rettifica.
 vital stock for Grinding Workshops.
 stock vital pour Usines de Rectification.
- 10/50/2-q.ta minima fornibile/min.supplied q.ty/q.te min.fournie.
- = gruppo completo/assembly/groupe complet.
- + componente del gruppo/assembly component/composant du groupe.

Serie guarnizioni/Gasket set	272.8180.024	4LD640
	279.8180.027	4LD705
	291.8180.038	4LD820

Tipo motore Engine type	Blocco motore Short block
4LD640 industr.	2720.1560.033
" automot.	2720.1560.034
4LD705 automot.	2790.1560.015
" industr.	2790.1560.016
4LD820 industr.	2910.1560.049
" automot.	2910.1560.050

FIG. NO.	MATRICOLA P.NO	Q.TA Q.TY	NOTE REMARKS	GR. 4 PAG.02
1+2+3=			SERBATOIO COMPLETO LATO DISTRIB. GEAR SIDE FUEL TANK	
	=270.8101.018 F C	1	std. capacity 1.7	
	=2790.8103.008 S IC	1	piatto /flat capacity 1.7,5	
2+3=			TAPPO/CAP	
	=285.9043.037 FV C	1	x serbatoio/f.tank 1.7	
	=2830.9043.025 FV C	1	x serbatoio/f.tank 1.7,5	
3+	9.1200.015 FV C 10	1	x serbatoio/f.tank 1.7	
"	2700.4650.056 DV C 10	1	x serbatoio/f.tank 1.7,5	
4	2830.9135.012 F C 10	2	tassello/cushion	
5	260.5390.006 S C 10	1	manicotto/rubber sheating	
6	2830.3617.016 S C 10	1	fascetta/strip fixing	
7	270.9370.009 FV C	1	tubo comb./fuel pipe	
8+85+88+152+153+ 488+489=			FILTRO ARIA CON CAPPELLOTTO AIR CLEANER WITH INLET COVER	
	=272.3700.139 FVIC	1	x 4LD640-640/L-705-820/L	
	=291.3702.016 E	1	x 4LD820	
	=291.3700.141 FV C	1	x 4LD820	
9+	9.1200.027 FV C 10	1	anello OR/rubber oil seal	
10+9+11+12+13+14+15+ 16+17=			GRUPPO BILANCIERI COMPLETO ROCKER ARM ASS.Y	
	=291.4330.023 F C	1	x 4LD640-705-820	
	=291.4330.038 D C	1	x 4LD640/L-820/L	
11+	9.3240.010 FV C 10	1	dado/nut	
12+	270.9850.002 F C 10	1	vite/screw	
13:	271.6045.029 FV C 10	1	perno bil./rocker shaft 4LD640-705-820	
"	291.6045.034 S C	1	" " 4LD640/L-820/L	
14+	9.9765.051 F C 10	1	vite/screw M 6 X 1 X 8	
15+		vedi/see fig.No. 10+...	
16+	9.3240.010 FV C 10	1	dado/nut	
17+	270.9850.002 F C 10	1	vite/screw	
18+	270.2135.067 FV C 10	1	cappellotto/cap	
19+	260.6410.010 F C 10	2	piattello/retainer wiht half-colletts	
20	270.4400.008 FV C 50	1	guarnizione/joint 0,30	
21+22+23+24+25+26+27+ 28+100+107=			CAPPELLO BILANC.CON DECOMPRESSIONE ROCKER BOX CAP WITH DECOMPRESSION	
	=272.2125.087 F IC	1		
22+	9.1165.004 FV C 10	1	anello/circlip	
23+	270.5680.024 FV C 10	1	molla/spring	
24+	270.1110.038 F	1	albero/decompression shaft	
25+	9.8430.023 S C 10	1	spina/taper pin	
26+	9.1200.034 FV C 10	1	anello OR/rubber oil seal	
27+	500.5270.078 F C	1	leva/lever	
28+	9.8430.023 S C 10	1	spina/taper pin	

FIG. NO.	MATRICOLA P.NO	Q.TA Q.TY	NOTE REMARKS	GR. 4 PAG.03
29+	260.4130.053	SV C	1 ghiera/ring nut	
30	9.4470.058	FV C 10	2 guarnizione/copper joint	
31+	9.1901.029	FVIC 10	1 bullone raccordo/connection bolt	
32	9.9731.023	F C 10	4 vite/screw M 12 X 1,5 X 16	
33	9.7565.013	S C 10	4 rondella/washer	
34+	45.1860.065	F C 10	2 bullone/bolt	
35+	45.1557.019	F C 10	2 blocchetto/nut	
36+	45.1557.020	F C 10	2 blocchetto/nut	
37+34+35+36=	=271.3616.009	F C 10	2 FASCETTA FISSAGGIO SERBATOIO fuel tank fixing clamp	
38	271.9600.057	FV C 10	2 tubetto/rubber sheathing	
39+40+41=	=273.8101.021	F C	1 SERBATOIO COMPLETO LATO VOLANO FLYWHELL SIDE FUEL TANK	
40+41=	=285.9043.037	FV C	1 TAPPO SERBATOIO FUEL TANK CAP	
41+	9.1200.015	FV C 10	1 anello OR/rubber oil seal	
42	9.6820.014	D 10	2 prigioniero/stud M 12 X 30 (48)	
43	2830.6491.005	FV C	1 pipetta/pipe elbow	
44	9.7625.026	S 10	2 rondella/washer	
45	270.6685.045	S	1 portina/cover	
46	422.4773.042	N 50	1 guarnizione/joint	
47	270.2565.070	F C	1 convogliatore/shroud	
48	276.2145.014	FVAC 10	1 cappuccio/rubber cap	
49	276.6740.088	FVAC 10	1 presa/inlet regolat./regul.Saprisa	
"	276.6740.089	SVAC 10	1 presa/inlet regolat./regul.Ducati	
"	276.6740.090	SVAC 10	1 x reg.Ducati con spia car.batteria with ch.battery light	
50	2760.7362.027	FVIC	1 regol.tens./voltage regul. 12 V 12 A	
"	9040.7362.066	FVIC	1 12 V 12 A con spia carica batteria with charg.battery light	
51	9.9731.092	S 10	2 vite/screw M 8 X 1,25 X 14	
52	291.5095.081	S C	1 lamiera/panel 4LD820	
53+	273.5575.006	FV C 10	1 molla/spring	
54+	273.3930.019	F C 10	1 fondello/cup	
55+	9.1200.032	FV C 10	1 anello OR/rubber oil seal	
56+53+54+55+57+58+59+	60+61=	=273.3730.015	FV C	1 FILTRO COMBUSTIBILE COMPLETO FUEL FILTER
56+	273.2175.009	FV C	1 cartuccia comb./f.filter element	
57+	273.4490.017	FV C 10	1 guarnizione/joint	
58+	260.4430.071	FV C 10	1 guarnizione/joint	
59+	273.2605.033	F AC	1 coperchio/filter cover	
60+	9.1202.052	FVAC 10	1 anello OR/rubber oil seal	
61+	9.1760.076	D A	1 bullone/bolt	
62	9.3240.018	FV 10	2 dado/nut	
63	9.7565.007	F C 10	2 rondella/washer	
64	9.7625.012	FV C 10	2 rondella/washer	
65	270.3525.093	S C 10	2 x serb./f.tank capacity 1.7.5	
66	9.1770.011	S C 10	2 bullone/bolt std. M 8 X 1,25 X 40	
"	9.1770.031	N 10	2 x avv.eletttr/elec.st.-M 8X1,25X50	
67	9.9730.100	F 10	3 vite/screw M 8 X 1,25 X 25	
68	9.7625.010	FV C 10	3 rondella/washer	

FIG. NO.	MATRICOLA P.NO	Q.TA Q.TY	NOTE REMARKS	GR. 4 PAG.04
	69+70+71+72+73+74+75+ 76+77+135+136+137+138+ 139+140+141+142+143+ 144+145+149=		POMPA INIEZIONE COMPLETA INJECTION PUMP	
	=283.6590.033 F C	1	std.	
	=283.6590.041 F C	1	Bosch type	
70+	283.6578.013 FV C	1	pompante/injection plunger std.	
"	283.6578.020 FV C	1	" " " " Bosch	
71+	273.9672.013 F C	1	valvolina mandata/delivery valve std.	
"	273.9672.016 F C	1	" " " " Bosch	
72+	271.4760.015 FV C 10	1	guarnizione/joint	
73+	271.5755.034 SV C 10	1	molla/spring	
74+	271.7470.003 FV C 10	1	riempitore/filler	
75+	271.8335.029 SV C 10	1	spessore/shim	
76+	9.1200.031 FV C 10	1	anello OR/rubber oil seal	
77+	271.7265.008 FV C 10	1	raccordo/connection	
78	9.4670.058 FV C 10	1	guarnizione/copper joint	
79	2830.9371.071 E	1	tubo da serb.lato.dist.a pompa in. mm 273 pipe from gear side f.tank to inj.pump x serb./f.tank capacity L.7	
"	273.9375.274 FVAC	1	" " " " mm 253	
"	7150.9375.116 E	1	x serb./f.tank capacity L.7,5 mm 370	
"	2830.9375.290 FVAC	1	" " " " mm 355	
"	2790.9371.086 F	1	tubo da serb.lato vol.a pompa in. mm 500 pipe for flywh.side f.tank to inj.pump	
"	2790.9375.289 D AC	1	" " " " mm 495	
80	9.9080.037 FV C 10	1	tappo/deaeration cap.	
81	9.4775.196 SV C 10	1	guarnizione/joint	
82	9.1901.031 FVIC 10	1	bullone raccordo/connection bolt	
83	9.4670.060 FV C 10	1	guarnizione/copper joint	
84	9.4670.060 FV C 10	1	guarnizione/copper joint	
85+	270.3525.000 F IC 10	1	distanziatore/spacer diam.= 61	
"	292.1261.073 DVAC 10	1	" " " " diam.= 62,5	
86	9.3240.037 F	10	dado/nut	
87	9.7555.008 FV C 10	2	rondella/washer	
88+	276.4115.048 F C 10	2	gancio/hook	
89+	710.4501.003 FV C 50	2	guarnizione/joint	
90+	9.7555.004 FV C 10	1	rondella/washer	
91+	9.3200.002 FV C 10	1	dado/nut	
92+	271.2125.056 F C	1	cappello/inlet air cap	
93+	2910.1301.069 FV C 10	1	prefiltro/cyclonic prefilter	
	94+85+88+90+91+92+ 93+94+152+153+488=		FILTRO ARIA CON PREFILTRO CYCLONIC TYPE AIR CLEANER	
	=272.3702.019 E	1	x 4LD640-640/L-705-820/L	
	=272.3700.140 SV C	1	x 4LD640-640/L-705-820/L	
	=291.3702.017 E	1	x 4LD820	
	=291.3700.142 DV C	1	x 4LD820	
95+	260.5755.004 FV C	2	molla/spring	
96+	291.6410.037 F IC 10	2	piattello/retainer	
97+	291.9652.019 FV CR10	1	valvola aspirazione/inlet valve	
98+	291.9685.031 FV CR10	1	valvola scarico/exhaust valve	
99+			
100+	9.9732.063 S AC 10	2	vite/screw M 8 X 1,25 X 35	
101	270.9570.067 FV C 10	1	tubo spurgo in./bleeding pipe x serb.l.distr./gear side f.tank	
"	2790.9570.044 D C	1	x serb.l.volano/flywh.side f.tank	
102	270.9055.003 FV C 10	1	tappo/starter cap	

FIG. NO.	MATRICOLA P.NO	Q.TA Q.TY	NOTE REMARKS	GR. 4 PAG.05
103+100+107=	=272.2125.003 S IC	1	CAPPELLO BILANCIERI std. ROCKER BOX CAP	
104+105=	=270.9050.021 FV C	1	TAPPO SFIATO/BREATHER CAP std.	
105+	9.1200.014 FVIC	10	1 anello OR/rubber oil seal	
106	500.3695.038 F C	10	1 filo/wire	
107+	904.8506.003 S AC	10	1 squadretta/angle bracket	
108	260.7300.033 E	1	1 raccordo/connection	
	500.7301.006 D I	1	1	
109	260.4650.037 DV C	10	1 guarnizione/joint	
110+	9.7270.020 SV C	10	1 raccordo/connection	
111+29+31+112+113+114+			PORTAPOLVERIZZATORE COMPLETO	
115+116+171+172=	=291.6615.015 F C	1	NOZZLE HOLDER std.	
	=291.6615.028 D C	1	Bosch type	
111+29+31+112+113+114+			CORPO POLVERIZZATORE	
115+116+172=	=260.6615.001 D	1	NOZZLE HOLDER BODY	
112+	260.1420.012 DV C	1	1 asta comando/control rod	
113+	260.5800.038 SV C	1	1 molla/spring	
114+	260.8010.002 DV C	1	1 sede/seat	
115+	260.4370.007 DV C	10	1 guarnizione/joint	
116+	260.1570.016 DV C	1	1 bocchettone/filler cap	
117	9.3240.018 FV	10	2 dado/nut	
118	9.7565.007 F C	10	2 rondella/washer	
119	2790.8865.053 D C	1	1 supporto/support	
120	2790.3206.020 DV C	10	2 dado/nut	
121	2790.3206.019 DV C	10	2 dado/nut	
122	2720.8545.085 S A	1	1 staffa/brace	
123	272.3526.079 D	10	2 distanziale/spacer	
124	9.7565.004 F C	10	3 rondella/washer	
125	9.1760.005 FV	10	3 bullone/bolt M 6 X 1 X 16	
126	283.1156.090 FVIC	1	1 alternatore/voltage altern.12V 12A	
127	272.5840.066 F I	1	1 mot.avv./start.eng.12 V Bosch type	
128	270.2816.011 F C	1	1 corona avviamento/crown gear	
129	270.9881.006 S C	1	1 volano avv.elett./el.starting flywheel	
130	5000.9375.240 S AC	1	1 tubo da serbatoio a pompa aliment. mm 377 pipe from fuel tank to feed pump	
131	271.8901.080 S IC	1	1 supporto/support	
132	270.6495.012 D C	1	1 pistoncino/plunger	
133	283.6585.031 FV C	1	1 pompa alimentazione/feed pump	
134	9.1901.030 FVIC	10	1 bullone raccordo/connection bolt	
135+	260.5625.002 SV C	1	1 molla/spring	
136+	260.7980.020 SV C	1	1 scodellino/cup	
137+	260.4850.009 FV C	1	1 guida/guide	
138+	9.1260.084 DV C	10	1 anello/ring	
139+	260.6400.024 D	1	1 piattello/retainer	
140+	260.7215.017 FV C	1	1 punteria/tappet	
141+	260.7770.020 SV C	1	1 rullo/roller	
142+	260.1970.054 DV C	1	1 bussola/sleeve	
143+	260.6230.068 SV C	1	1 perno/pin	
144+	270.1415.007 DV C	1	1 asta comando/control rod	
145+	277.6230.075 S	10	1 perno/pin	
146	270.1580.016 F C	10	1 boccia/bushing	
147	9.7626.017 D C	10	1 rondella/washer	
148	9.2800.003 F C	10	1 copiglia/cotter pin	

FIG. NO.	MATRICOLA P.ND	Q.TA Q.TY	NOTE REMARKS	GR. 4 PAG.06
149+	260.6230.069 DV C	1	perno/pin	
150+	283.4580.001 D	50	1 guarnizione/joint 0,10	
"	283.4580.008 N	50	" " 0,50	
"	283.4580.012 N	50	" " 0,30	
"	283.4580.039 N	10	" " 0,05	
151	9.9732.092 F C	10	1 vite/screw M 8 X 1,25 X 18	
152+	291.4776.032 FV C	10	1 guarnizione/joint	
153+	292.5496.111 FVIC	1	1 x 4LD640-640/L-705-820/L	
"	291.5496.051 E	1	1 x 4LD820	
"	291.5496.118 FVIC	1	"	
154	270.1410.011 FV C	2	2 asta punteria/push rod	
155	270.5065.009 F C	1	1 lamiera/airtight plate	
156+	9.6800.050 S I	10	2 prigioniero/stud M 10 X 23 (38)	
157+9+10+11+12+13+14+			TESTA COMPLETA	
15+16+17+18+19+95+96+			CYLINDER HEAD	
97+98+156+158+159+160+				
161+165+173+211+212+				
214=	=291.9201.003 F C	1		
157+156+158+159+160+			TESTA CON SEDI E GUIDE	
161+173+211+212+214=	=291.9201.004 F C	1	CYLINDER HEAD WITH SEATS AND GUIDES	
158+	291.4845.054 FV CR10	1	1 guida v.aspir./inlet v.guide std.	
"	291.4845.060 FV CR10	1	" " +0,50	
159+	291.1160.013 FV C 10	1	1 anello/circlip	
160+	291.1160.013 FV C 10	1	1 anello/circlip	
161+	291.4845.055 FV CR10	1	1 guida v.scar./exhaust v.guide std.	
"	291.4845.061 FV CR10	1	" " +0,50	
162+	270.4400.007 FV C 50	1	1 guarnizione/joint 0,50	
163	270.3206.015 FV C 10	1	1 dado/nut	
164	9.7625.055 SV C 10	4	4 rondella/washer	
165+	9.8990.017 F C 10	1	1 tappo/plug	
166	9.1760.003 F 10	4	4 bullone/bolt M 6 X 1 X 12	
167	9.7565.004 F C 10	4	4 rondella/washer	
168	9.7625.007 S C 10	3	3 rondella/washer	
169	9.3240.008 FV 10	3	3 dado/nut	
170	9.4670.009 FV C 10	1	1 guarnizione/copper joint 0,50	
"	9.4670.010 FV C 10	1	" " 1,00	
"	9.4670.011 FV C 10	1	" " 1,50	
171+	710.6531.033 FVIC	1	1 polverizzatore/nozzle	
172+	260.4130.052 SV C	1	1 ghiera/ring nut	
173+	9.6780.018 FV C 10	2	2 prigioniero/stud M 8 X 28 (43)	
174+175+176+177=			PISTONE COMPLETO/PISTON SET	
=272.6500.070 FV C	1	1	1 std. x 4LD640-640/L	
=272.6500.071 F CR	1	1	+0,50	
=272.6500.072 F CR	1	1	+1,00	
=279.6501.021 FV C	1	1	1 std. x 4LD705	
=279.6501.022 F CR	1	1	+0,50	
=279.6501.023 F CR	1	1	+1,00	
=291.6501.070 FV C	1	1	1 std. x 4LD820-820/L	
=291.6501.071 F CR	1	1	+0,50	
=291.6501.072 F CR	1	1	+1,00	

FIG. NO.	MATRICOLA P.NO	Q.TA Q.TY	NOTE REMARKS	GR. 4 PAG.07
175+	276.8210.052	FV C 10	1 serie segm./ring set std. 4LD640-640/L	
"	276.8210.053	F CR10	1 " " +0,50	
"	276.8210.054	F CR10	1 " " +1,00	
"	279.8210.049	FV C 10	1 " " std. 4LD705	
"	279.8210.050	F CR10	1 " " +0,50	
"	279.8210.051	F CR10	1 " " +1,00	
"	291.8210.058	FV C 10	1 " " std. 4LD820-820/L	
"	291.8210.059	F CR10	1 " " +0,50	
"	291.8210.060	F CR10	1 " " +1,00	
176+	272.8480.010	F C	1 spinotto/gudgeon pin 4LD640-640/L	
"	279.8480.021	S C	1 " " 4LD705	
"	291.8480.025	D C	1 " " 4LD820-820/L	
177+	9.1240.026	FV C 10	2 anello seeger/snap ring	
178	9.1760.048	D 10	2 bullone/bolt	
179	9.7565.004	F C 10	2 rondella/washer	
180	9.7625.070	D C 10	2 rondella/washer	
181	9.9730.015	F C 10	5 vite/screw M 6 X 1 X 30	
182	2790.3617.017	D 10	1 fascetta/strip fixing	
183	9.1790.025	F C 10	1 bullone/bolt M 12 X 1,25 X 30	
184	9.7565.013	S C 10	1 rondella/washer	
185	9.7625.026	S 10	1 rondella/washer	
186	260.5390.006	D 10	1 manicotto/rubber sheathing	
187	9.1901.030	FVIC 10	1 bullone raccordo/connection bolt	
188	9.4670.059	FVIC 10	1 guarnizione/copper joint	
189	9.4670.059	FVIC 10	1 guarnizione/copper joint	
190	9.4670.059	FVIC 10	1 guarnizione/copper joint	
191	2790.9372.001	DV C	1 tubo da pompa alim. a pompa iniezione pipe from feed pump to injection pump	
192	9.4670.059	FVIC 10	1 guarnizione/copper joint	
193	9.1770.015	F 10	1 bullone/bolt M 8 X 1,25 X 55	
194	9.7565.007	F C 10	1 rondella/washer	
195	9.1240.013	D 10	1 anello seeger/snap ring	
196	270.4330.028	F IC	1 bilanc.pompa iniez./inj.pump rocker	
197+	9.6420.001	D C 10	1 spina/locating pin	
198+		vedi/see fig.No. 200+...	
199+	9.1200.041	FV 10	1 anello OR/rubber oil seal	
200+197+198+199+203+			COMANDO SUPPLEMENTO	
204=			DEVICE CONTROL	
	=272.2516.045	F IC	1	
201	271.6045.009	F U	1 perno/pin	
202+	270.4700.070	N 50	1-3 guarnizione/joint 0,50	
203+	270.5550.007	SV C 10	1 molla/spring	
204+		vedi/see fig.No. 200+...	
205	270.1400.005	F C 10	1 asta liv./dipstick std. 4LD640-640/L-705	
"	291.1400.045	F C 10	1 " " std. 4LD820-820/L	
206	291.1010.060	F C	1 albero a camme/camshaft	
207	270.4887.002	FV C	1 punteria/tappet	
208	270.4887.001	FV C	1 punteria/tappet	
209	270.9520.023	S C	1 tubo prot./guard tube	
210	292.4740.017	FV C 10	1 guarnizione/joint	
211+	291.8000.046	FV CR10	1 sede v.aspirazione/inlet v.seat	
212+	291.8000.047	FV CR10	1 sede v.scarico/exhaust v.seat	
213+	270.6850.040	S C	2 prigioniero/stud	
214+	9.6800.050	S I 10	2 prigioniero/stud M 10 X 23 (38)	
215+	270.1630.006	FV CR10	1 bronz.piede biella/small end bearing	
216	9.7625.019	S 10	2 rondella/washer	
217	9.7565.011	F C 10	2 rondella/washer	
218	9.3240.053	FV C 10	2 dado/nut	

FIG. NO.	MATRICOLA P.NO	Q.TA Q.TY	NOTE REMARKS	GR. 4 PAG.08
219+215+220+301= =270.1526.002	F C	1	BIELLA COMPLETA CONNECTING ROD ASS.Y	
220+	270.1860.007 FV	C 10	2 bullone/bolt	
221+	9.1760.003 F	10	2 bullone/bolt M 6 X 1 X 12	
222+	271.5110.084 D	C 10	1 lamierino/tabwasher	
223+	271.3895.005 D	C	1 flangia/flange	
224+		vedi/see fig.No. 226+...	
225+	9.8245.005 D	C 10	1 sfera/ball	
226+221+222+223+224+ 225+227= =273.9680.010	FV C	1	VALVOLINA DI PRESSIONE COMPLETA PRESSURE OIL VALVE ASS.Y	
227+	271.4760.007 DV	C 10	1 guarnizione/joint	
228	270.2565.076 F	IC	1 convogliatore/shroud	
229	270.9881.006 S	C	1 volano/flywheel std.	
230	270.5095.057 F	C	1 lamiera/panel guard 4LD640-640/L-705	
231	9.7540.006 D	C 10	4 rondella/washer std.	
"	9.7540.004 D	C 10	4 x avv.elettrico/electric starting	
232	9.9810.012 S	10	4 vite/screw std.	
"	9.9810.007 S	C 10	4 x avv.elettrico/electric starting	
233	271.7500.018 SV	C 10	7 rondella/washer	
234	9.1755.001 FV	10	7 bullone/bolt M 5 X 0,8 X 8	
235	270.4960.041 FV	C	1 puleggia avv./st.pulley std.	
"	2790.6960.054 FV	C	1 x pompa oleodinam./hydraulic pump	
"	2790.6960.078 S		1 puleggia 2 gole/2 grooves pulley	
236	9.7555.007 DV	C 10	6 rondella/washer	
237	9.1770.006 S	10	6 x puleggia/pulley std. MBX1,25X25	
"	9.1770.015 F	10	6 x puleggia per pompa oleodinamica pulley for hydr.pump MBX1,25X55	
"	9.1770.017 S	10	6 x pul. 2 gole/grooves MBX1,25X60	
238	270.1860.011 S	C	1 bullone/bolt	
239	9.1210.031 FV	C 10	1 anello tenuta/seal ring	
240+	9.8990.008 S	10	1 tappo/plug	
241+240= =272.6646.091	D IC	1	PORTINA LATO DISTRIBUZIONE GEAR SIDE CASE COVER	
242+	270.4431.004 SV	C 50	1 guarnizione/joint 0,30	
"	270.4431.010 N	50	1 " " " 0,10	
243+244+245+246+248+ 249+256+257+263+264+ 265+266+270+271+272+ 273+274+275+277+329+ 458= =273.2515.027	F IC	1	COMANDO A DISTANZA REMOTE CONTROL	
243+	270.2690.042 F	C 10	1 coperchio/cover	
244+	9.9790.003 F	C 10	1 vite/screw M 4 X 0,7 X 6	
245+	2760.9180.042 S	C 10	1 terminale/cable-end	
246+	45.6000.016 FV	C 10	1 pastiglia/nut	
248+	9.3240.019 FV	C 10	1 dado/nut	
249+	270.5680.025 SV	C 10	1 molla/spring	
250+	9.1165.001 S	10	1 anello/circlip	
251+	9.3240.004 FV	C 10	1 dado/nut	
252+	90.6330.057 F	C 10	1 piastrina/safety plate	
253+	9.3200.015 FVIC	10	1 dado/nut	
254+	9.7626.054 S	AC 10	2 rondella/washer	
255+	9.7625.019 S	10	1 rondella/washer	

FIG. NO.	MATRICOLA P.NO	Q.TA Q.TY	NOTE REMARKS	GR. - 4 PAG.09
256+	9.9790.037	FV C 10	2	vite/screw M 6 X 1 X 8
257			
258+	283.5200.159	F AC 10	1	leva/lever
259+249+250+251+252+				COMANDO A MANO HAND CONTROL
253+254+255+256+258+				
262+263+264+265+266				
267+268+270+271+272+				
273+274+275+277+329+				
436-				
	=273.2515.029	F C	1	
259+	283.2690.122	F AC 10	1	coperchio/cover std.
260	9.1760.005	FV 10	2	bullone/bolt M 6 X 1 X 16
261	9.7625.059	D C 10	2	rondella/washer
262+	283.6370.114	S AC 10	1	piastra/plate
263+	270.9820.073	D BC 10	1	vite/screw
"	272.9820.109	D AC 10	1	"
264+	9.7625.007	S C 10	1	rondella/washer
265+			vedi/see fig.No. 277+...
266+	270.5200.086	S BC 10	1	leva/lever
"	272.5200.254	D AC	1	"
267+	9.1770.042	D C 10	1	bullone/bolt M 8 X 1,25 X 10
268+	9.7555.007	DV C 10	1	rondella/washer
269	9.9800.061	F C 10	3	vite/screw M 6 X 1 X 16
270+	270.9245.031	S C 10	1	tirante/tie rod
271+	270.7865.018	D BC	1	scatola/housing
"	272.7865.088	D AC	1	"
272+	9.3240.008	FV 10	1	dado/nut
273+	9.1760.029	D A 10	1	bullone/bolt M 6 X 1 X 30
274+	9.3240.008	FV 10	1	dado/nut
275+	9.1760.029	D C 10	1	bullone/bolt M 6 X 1 X 30
276+	270.4700.069	N 50	1	guarnizione/joint
277+265+329=				
	=283.5200.292	S C	1	LEVA COMPLETA/LEVER ASS.Y std.
277+	272.5204.023	N	1	solo per gr.elettrog./only for gen.sets
278	9.3021.029	FVIC	1	cuscinetto/ball bearing
279+	270.4535.013	FV C 10	1	guarnizione/joint
280	270.5168.005	D C 10	1	lamierino/tabwasher
281+	270.4535.013	FV C 10	1	guarnizione/joint
282	270.4840.008	FV C	1	guida/guide
283+	270.6850.024	SV C	2	prigioniero/stud
284	292.4740.017	FV C 10	1	guarnizione/joint
285			
286	9.9730.028	F 10	2	vite/screw M 8 X 1,25 X 30
287	272.2380.010	FV C	1	cilindro/cylinder 4LD640-640/L
"	279.2380.055	FV C	1	" " 4LD705
"	291.2380.082	FV C	1	" " 4LD820-820/L
288+	272.4410.061	D A 50	1	guarnizione/joint 4LD640-640/L
"	279.4410.062	D A 50	1	" " 4LD705
"	291.4410.063	D A 50	1	" " 4LD820-820/L
289+292+297+300+302=				ALBERO GOMITO/CRANKSHAFT
	=270.1050.005	F C	1	autotraz./automot. 4LD640-640/L-705
	=291.1051.012	F C	1	" " 4LD820-820/L
290	270.5065.012	F C	1	lamiera/airtight plate
291	270.9245.025	S C 10	1	tirante/tie rod
292+	9.2280.049	FV 10	1	chiavetta/key

FIG. NO.	MATRICOLA P.NO	Q.TA Q.TY	NOTE REMARKS	GR. 4 PAG.10
293	9.7625.005 FV C 10	1	rondella/washer	
294	9.3240.003 FV C 10	1	dado/nut	
295	9.3240.003 FV C 10	1	dado/nut	
296+292+297+300+302=			ALBERO GOMITO industr.& motopompe	
	=272.1051.091 F IC	1	CRANKSHAFT industr.& pumping units	
	=291.1051.092 F IC	1	x 4LD640-640/L-705	
297+	9.8990.019 S C 10	1	tappo/plug	
298	262.1640.024 FV C	1	br.biella/bearing std.4LD640-640/L-705	
"	262.1640.025 FV CR10	1	" " -0,25	
"	262.1640.026 FV CR10	1	" " -0,50	
"	291.1640.045 FV C	1	" " std.4LD820-820/L	
"	291.1640.048 F CR	1	" " -0,25	
"	291.1640.049 F CR	1	" " -0,50	
299	*****			
300+	9.8990.002 F C 10	1	tappo/plug	
301+	9.3203.034 FVIC 10	2	dado/nut	
302+	9.2280.056 FV C 10	1	chiavetta/key	
303+	270.4700.008 FV C 50	1	guarnizione/joint 0,30	
"	279.4700.074 N 50	1	" " 0,10	
304+	9.6800.059 D 10	1	prigioniero/stud M 10 X 30 (39)	
305+	9.6800.018 D 10	2	x 4LD820-820/L - M 10 X 32 (47) & avv.elettrico/electric starting	
306	9.7565.011 F C 10	6	rondella/washer	
307	9.3240.033 FV 10	6	dado/nut	
308	270.8675.067 F C	1	supporto/support	
309	9.3240.033 FV 10	6	dado/nut	
310	9.7565.011 F C 10	6	rondella/washer	
311	291.1862.012 S C	1	bullone/bolt	
312	9.6800.053 S C 10	6	prigioniero/stud M 10 X 18 (33)	
313	2830.2052.022 D I	1	camp.autotraz./automot.bell MA	
"	270.2050.060 S	1	autotr./autom. MU x 4LD640-705	
"	291.2052.040 N	1	autotr./autom. MU (B) x 4LD820	
"	2720.2052.004 S	1	& industr. x 4LD640-705-820	
314	2910.1862.013 S	1	campana/bell industr. SAE 6 1/2	
"	2790.1862.032 D IC	1	bullone/bolt industr. SAE	
315+240=			CAMPANA/FLANGING BELL	
	=270.2031.096 D I	1	autotrazione/automotive MU-MB	
	=2720.2032.001 S I	1	autotr./autom. MA (4 FORI/HOLES)	
	=2790.2031.009 S	1	industr.	
	=2830.2032.044 S	1	industr. SAE 5	
	=2830.2032.049 D I	1	industr. SAE 6	
316	2830.5855.002 S	1	mozzo/hub	
317+	9.1165.001 S 10	1	anello/circlip	
318+	9.7625.074 N 10	1	rondella/washer std.	
"	9.7625.089 N 10	1	x gruppi elettrogeni/gen.sets	
319	9.7555.001 N 10	1	x gruppi elettrogeni/gen.sets	
320+317+318+321+322+			GRUPPO FORCELLA REGOLATORE	
323+324+325+328+368+			GOVERNOR SPEED YOKE ASS.Y	
369+370+371+372+379+				
383=				
	=270.4882.001 S C	1	std.	

FIG. NO.	MATRICOLA P.NO	Q.TA Q.TY	NOTE REMARKS	GR. 4 PAG.11
320+317+318+319+322+ 323+324+328+368+369+ 370+371+372+383+384+ 484+485+486=			GRUPPO FORCELLA REGOLATORE GOVERNOR SPEED YOKE ASS.Y	
	=272.4882.019 N	1	x gruppi elettr./gen.sets 1500/	
	=291.4882.024 N	1	x gruppi elettr./gen.sets 1800/	
	=270.4882.014 N	1	x gruppi elettr./gen.sets 3000/	
320+	270.5199.008 S C	1	leva/lever	
321+	270.5800.015 D C 10	1	molla/spring std.	
322+	9.8420.012 D C 10	1	spina/locating pin	
323+	270.6231.037 D AC 10	1	perno/pin	
324+	270.6140.013 D C 10	1	perno/pin	
325+	270.3945.027 S C	1	forcella/yoke std.	
326	9.1760.012 D C 10	1	bullone/bolt M 6 X 1 X 35	
327	9.7540.004 D C 10	1	rondella/washer	
328+	270.8615.020 D C	1	supporto/support	
329+	9.0420.012 D C 10	1	spina/locating pin	
330	270.7700.014 D C 10	1	rondella/washer	
331	270.9320.046 S C	1	tubo/pipe	
332	9.9730.010 S 10	2	vite/screw M 6 X 1 X 16	
333+213+283+304+305+ 334+335+336+338+340+ 341+348+366+406+407+ 409+410+411+414+415+ 416=			BASAMENTO COMPLETO predisposto pompa alim. CRANKCASE preset for fuel pump	
	=272.1511.069 D IC	1	x 4LD640-640/L	
	=279.1511.081 S IC	1	x 4LD705	
	=291.1512.004 D IC	1	x 4LD820-820/L	
334+	560.4580.047 FVIC 10	1	guarnizione/joint 1,00	
"	560.4580.049 FV C 10	1	" " 0,50	
"	560.4580.050 FV C 10	1	" " 0,80	
335+	9.8430.055 S IC 10	1	spina/locking needle	
336+	270.4730.021 SV C 10	1	guarnizione/joint	
337	270.1610.009 FV C	1	bronz.l.distr./gear side bear. std.	
"	270.1610.058 FV CR10	1	" " -0,50	
"	270.1610.010 F CR	1	" " -1,00	
338+336+340+341+410+ 414+415+416=			FLANGIA FILTRO OLIO ESTERNO FLANGE FOR EXTERNAL OIL FILTER	
	=270.3901.041 S C	1		
339	9.1901.054 FVIC 10	1	bullone raccordo/connection bolt	
340+	9.4670.058 FV C 10	1	guarnizione/copper joint	
341+	9.1770.001 FV 10	1	bullone/bolt M 8 X 1,25 X 12	
342	9.4670.058 FV C 10	1	guarnizione/copper joint	
343	2790.9455.036 S C	1	tubo lubr./lub.pipe	
344	9.4670.058 FV C 10	1	guarnizione/copper joint	
345+	710.4500.097 FV C 10	2	guarnizione/joint	
346	2790.2941.002 F C	1	curva/elbow 4LD820	
"	2790.2942.036 S C	1	curva/elbow 4LD640/L-820/L	
347	272.1610.025 FV C	1	bronz.l.volano/flywh.side bear. std.	
"	272.1610.057 FV CR10	1	" " -0,50	
"	272.1610.026 F CR	1	" " -1,00	
348+	9.6800.010 S C 10	5	x 4LD640-640/L-705 - M 10 X 25 (40)	
"	9.6800.010 S C 10	3	x 4LD820-820/L - M 10 X 25 (40)	
349	9.1210.078 FV C 10	1	anello tenuta/seal ring std.	
"	9.1210.083 FV CR10	1	" " -1,00	
350	9.1770.006 S 10	2	bullone/bolt M 8 X 1,25 X 25	

FIG. NO.	MATRICOLA P.NO	Q.TA Q.TY	NOTE REMARKS	GR. 4 PAG.12
351	276.4500.079	FV C 10	1 guarnizione/joint	
352	9.7565.007	F C 10	2 rondella/washer	
353	9.3240.019	FV C 10	2 dado/nut	
354	272.2568.054	D C	1 convogliatore/shroud	
355	2790.9884.045	N	1 volano avv.manov./handle start.flywheel	
356	272.2568.045	D C	1 convogliatore/shroud	
357	9.1585.058	S A	2 boccolo/bushing	
358	272.2920.072	D C	1 cuffia/hood	
359	9.8430.051	D B 10	1 spina/locking needle	
"	9.8430.019	D A 10	1	
360	5000.8965.031	D A	1 tappo/plug	
361	9.1202.016	SVAC 10	1 anello OR/rubber oil seal	
362	271.7500.018	SV C 10	3 rondella/washer	
363	9.9790.010	D 10	3 vite/screw M 5 X 0,8 X 10	
364	9.3240.033	FV 10	6 dado/nut	
365	9.7565.011	F C 10	6 rondella/washer	
366+	9.6800.004	F 10	6 prigioniero/stud M 10 X 20 (35)	
367	9.1213.058	FVIC 10	1 anello tenuta/seal ring	
368+	9.1755.002	D 10	1 bullone/bolt M 5 X 0,8 X 12	
369+	9.1755.004	D C 10	1 bullone/bolt M 5 X 0,8 X 18	
370+	285.6330.061	D 10	1 piastrina/safety plate	
371+	270.5655.005	FV C 10	1 molla/spring std.& gr.el./gen.sets 3000/'	
"	272.5655.051	N 10	1 x gruppi elettrog./gen.sets 1500/'	
"	2720.5655.067	N 10	1 x gruppi elettrog./gen.sets 1800/'	
372+	270.1557.021	D C 10	1 blocchetto/spacer	
373	9.1750.035	S C 10	2 bullone/bolt M 4 X 0,7 X 12	
374	270.6275.038	DV C 10	1 piastra/plate	
375	270.6370.038	D C 10	1 piastrina/safety plate	
376	270.4935.068	F C	1 ingranaggio/gearwheel	
377	9.8245.011	F C 10	6 sfera/ball	
378	9.1240.006	FV C 10	1 anello seeger/snap ring	
379+	270.5655.005	FV C 10	1 molla/spring std.& gr.el./gen.sets 3000/'	
380	270.2085.029	F	1 campana regol./governor bell	
381	270.7700.069	S C 10	1 rondella/washer	
382	271.6130.016	S C	1 perno/governor shaft	
383+	9.1165.006	D C 10	1 anello/circlip	
384	9.9800.013	S C 10	1 vite/screw std. M 6 X 1 X 35	
"	9.9800.049	N 10	1 x gruppi elettr./gen.sets M 4 X 14	
385	9.7625.019	S 10	1 rondella/washer	
386	9.3240.033	FV 10	1 dado/nut	
387	9.3203.014	FV C 10	1 dado/nut	
388+	9.9765.001	S C 10	1 vite/screw M 6 X 1 X 8	
389	9.7625.010	FV C 10	1 rondella/washer	
390	9.9730.030	S C 10	2 vite/screw M 8 X 1,25 X 35	
391	272.4975.018	F IC	1 ingranaggio/gearwheel	
392	9.7565.007	F C 10	2 rondella/washer	
393+388+394+395=			GRUPPO POMPA OLIO	
=272.4336.023	F IC	1	LUB. PUMP OIL ASS.Y	
394+		vedi/see fig.No. 393+...	
395+		vedi/see fig.No. 393+...	
396	9.9730.015	F C 10	1 vite/screw M 6 X 1 X 30	
397	9.7565.004	F C 10	1 rondella/washer	
398	9.7625.007	S C 10	1 rondella/washer	
399	9.2200.001	F C 10	1 chiavetta/key	
400	270.6645.040	S C	1 portina/oil pan	
401	9.7625.010	FV C 10	10 rondella/washer	
402	9.1770.002	FV 10	10 bullone/bolt M 8 X 1,25 X 16	
403+	270.4600.091	FV C 10	1 guarnizione/joint	
404	9.4670.016	FV C 10	1 guarnizione/copper joint	

FIG. NO.	MATRICOLA P.NO	Q.TA Q.TY	NOTE REMARKS	GR. 4 PAG.13
405	9.8965.005	FV C 10	1 tappo/oil drain plug	
406+	255.6700.012	S C	1 portina/pan	
407+	9.6780.012	DV C 10	2 prigioniero/stud M 8 X 25 (37)	
408	9.7565.011	F C 10	8 rondella/washer	
409+	9.7555.007	DV C 10	2 rondella/washer	
410+	9.7555.007	DV C 10	2 rondella/washer	
411+	9.3240.018	FV	10 dado/nut	
412	9.1780.005	FV	10 bullone/bolt M 10 X 1,5 X 28	
413	270.6426.010	D C	2 piede/engine mount	
414+	9.1770.007	F C 10	2 bullone/bull M 8 X 1,25 X 30	
415+	9.4670.060	FV C 10	1 guarnizione/copper joint	
416+	9.8965.003	FV C 10	1 tappo/plug	
417	9.3630.037	D C	1 fascetta/clamp	
418	710.5401.011	D C 10	1 manicotto/rubber sheating	
419	9.1901.055	FVIC 10	1 bullone raccordo/connection bolt	
420	9.4670.058	FV C 10	1 guarnizione/copper joint	
421	9.4670.058	FV C 10	1 guarnizione/copper joint	
422	2790.8545.040	D	1 staffa/brace 4LD640-705-820	
"	2790.8545.091	S C	1 staffa/brace 4LD640/L-820/L	
423	270.5460.090	F C	1 marmitta/muffler std.	
"	2830.5461.090	F C	1 x avv.elettrico/electric starting	
424+459+460=			PRESSOSTATO COMPLETO	
=9040.6745.031	FVAC	1	OIL PRESSURE SWITCH	
425+426=			FILTRO OLIO COMPLETO	
=270.3740.024	FV C	1	OIL FILTER	
426+	270.2175.028	FV C	1 cartuccia olio/oil filter element	
427	9.7565.011	F C 10	2 rondella/washer	
428	9.1780.007	S	10 bullone/bolt M 10 X 1,5 X 35	
429	9.1780.031	FV	10 bullone/bolt M 10 X 1,5 X 25	
430	9.3240.033	FV	10 dado/nut	
431	9.7565.011	F C 10	1 rondella/washer	
432	2910.9170.028	F C	1 terminale/muffler end	
433	2830.5461.047	F C	1 marmitta/muffler	
434	9.6800.020	F	10 prigioniero/stud M 10 X 35 (50)	
435	90.8460.083	D	10 spina/taper pin	
436	9.7565.007	F C 10	8 rondella/washer	
437	9.1770.014	D C 10	8 bullone/bolt M 8 X 1,25 X 45	
438	2790.6480.029	D	1 pianone/pinion gear	
439	9.7565.007	F C 10	6 rondella/washer	
440	9.9730.026	F	10 vite/screw M 8 X 1,25 X 20	
441	272.4970.008	D B	1 ingranaggio/gearwheel	
"	2790.4970.014	S A	1 " "	
442	2790.3835.061	D BC	1 flangia/flange	
"	2790.7885.019	D A	1 scatola/housing	
443	9.7565.007	F C 10	4 rondella/washer	
444	270.5800.071	F BC 10	1 molla/spring	
"	7150.5801.028	S A	4 " "	
445	9.1770.007	F C 10	1 bullone/bolt M 8 X 1,25 X 30	
446	270.5455.006	S	1 manovella/starting hand-crank	
447	500.7980.044	D BC	1 scodellino/cup	
"	500.7980.045	S A	1 " "	
448	9.1240.046	D B 10	1 anello seeger/snap ring	
"	9.1240.041	D A 10	1 " "	
449	203.4055.003	F C	1 fune avviamento/rope starting	
450	291.6371.039	F C	1 piastra avv.elett./electric start.plate	

FIG. NO.	MATRICOLA P. NO	Q. TA Q. TY	NOTE REMARKS	GR. 4 PAG. 14
451	272.4730.107	SVAC 10 1	guarn./head joint 0,70 4LD640-640/L	
"	272.4730.108	SVAC 10 1	" " 0,80 " "	
"	272.4730.109	DVAC 10 1	" " 0,90 " "	
"	272.4730.110	DVAC 10 1	" " 1,00 " "	
"	272.4730.111	DVAC 10 1	" " 1,10 " "	
"	279.4730.112	S A 50 1	" " 0,70 4LD705-820-820/L	
"	279.4730.113	S A 50 1	" " 0,80 " "	
"	279.4730.114	S A 50 1	" " 0,90 " "	
"	279.4730.115	S A 50 1	" " 1,00 " "	
"	279.4730.116	S A 50 1	" " 1,10 " "	
452+456=	=2830.3730.036	FV C 1	FILTRO COMBUSTIBILE ESTERNO EXTERNAL FUEL FILTER	
453	9.4670.016	FV C 10 2	guarnizione/copper joint	
454	9.4670.016	FV C 10 2	guarnizione/copper joint	
455	9.1901.032	FVIC 10 2	bullone raccordo/connection bolt	
456+	2830.2175.045	FVAC 1	cartuccia comb./f.filter element	
457	9.7625.019	S 10 6	rondella/washer	
458+	9.1200.041	FV 10 1	anello OR/rubber oil seal	
459+	3600.6491.013	FVAC 1	pipetta/pipe elbow	
460+	5000.9180.056	FVAC 10 1	terminale/gaston	
461	9040.2900.069	F C 1	cruscotto/dashboard	
462	9040.2900.070	F C 1	dashboard	
463	9040.6612.063	S AC 1	spia olio/oil warning	
464	9040.6612.064	S AC 1	spia batteria/battery warning	
465	9040.5175.119	F AC 10 1-2	lampadina/lamp	
466	9040.2615.021	F C 1	coperchio/cover	
467	2830.5040.004	SV C 1	interruttore/key switch	
"	2760.5041.020	FV C 1	" " Bosch	
468	2760.2750.111	F C 1	coperchio/switch cover	
469	2760.5450.009	FV C 1	manometro olio/pressure gauge	
470	2790.8506.010	D C 1	squadretta/angle bracket	
471	2790.8506.011	N 1	squadretta/angle bracket	
472	2790.8506.012	N 1	squadretta/angle bracket	
473	2790.8506.038	N 1	squadretta/angle bracket	
474	273.7300.057	FV C 10 1	raccordo/connection	
475	9.3630.008	F C 10 1	fascetta/clamp	
476	2920.7362.158	S C 1	regol.gr.elettrog./gen.sets governor	
477	9.1240.005	DV C 10 1	anello seeger/snap ring	
478	270.4894.003	N 1	campana reg.gr.elettr./gen.sets ball	
479	270.6130.036	D C 1	perno gr.elettr./gen.sets shaft	
480	9.1760.005	FV 10 1	bullone/bolt M 6 X 1 X 16	
481	9.7701.014	D C 10 1	rondella/washer	
482	9.8400.056	D C 10 1	spina/taper pin	
483	270.6371.081	N 10 1	piastra/plate	
484+	9.3030.051	S 2	cuscin.gr.elettrog./gen.sets ball bear.	
485+	270.8785.040	D C 1	supp.gr.elettrog./gen.sets support	
486+	270.5202.007	N 10 1	leva gr.elettrog./gen.sets lever	

FIG. NO.	MATRICOLA P.NO	Q.TA Q.TY	NOTE REMARKS	GR. 4 PAG.15
487	2830.8760.037 S IC	1	supporto/support	
488+		vedi/see fig. 9+.../94+...	
489+	292.5496.110 SVAC	1	massa filtrante/upper filtering element	
490	9.3203.059 N	10 2	dado/nut	
89+150+162+202+227+ 242+276+279+281+288+ 303+334+336+345+403+ 451=			SERIE GUARNIZIONI GASKET SET	
	=272.8180.024 FV CR	1	x 4LD640-640/L	
	=279.8180.027 FV CR	1	x 4LD705	
	=291.8180.038 FV CR	1	x 4LD820-820/L	

DISVI/RICA

01.01.1986

DESCRIZIONI NON IMPEGNATIVE
SUBJECT TO MODIFICATIONS

aggiornata al 21.11.1986

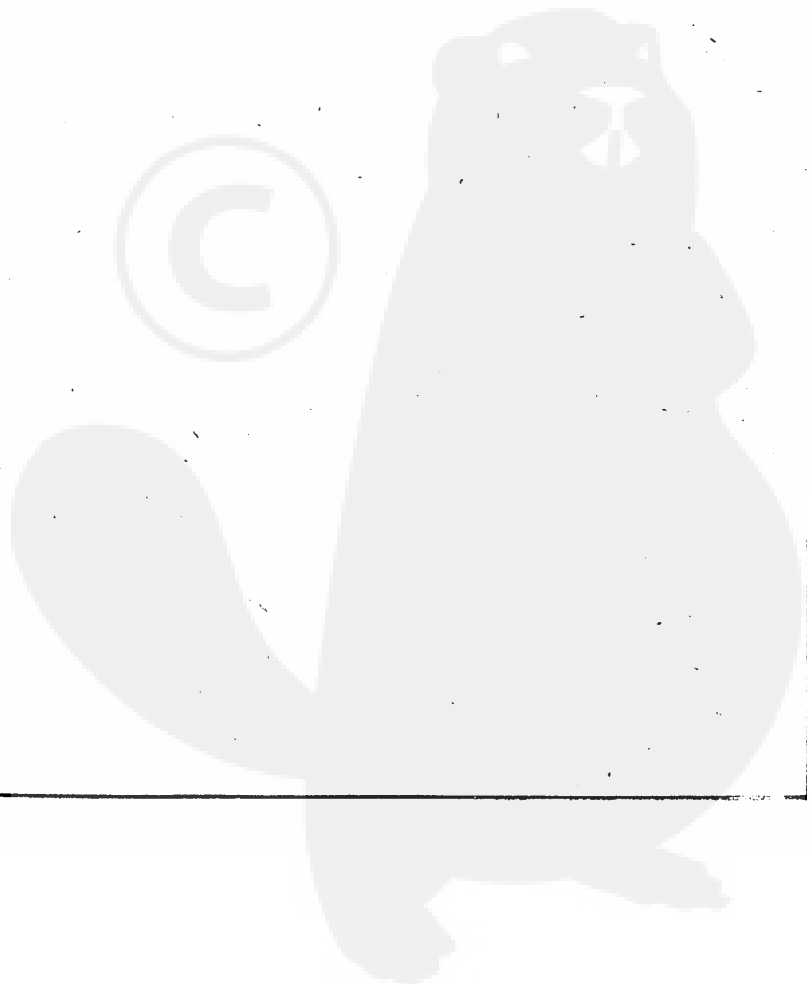
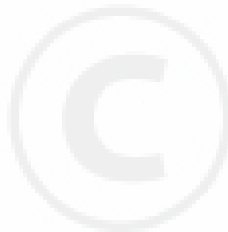

MATERIALE DI RETTIFICA
GRINDING WORKSHOP PARTS LIST
MATERIEL POUR RECTIFIEUR

GR. 04
PAG.16

MOTORI-ENGINES-MOTEURS GR. 4

FIG. NO.	MATRICOLA PART NO.	Q.TA Q.TY	NOTE REMARKS
97+	291.9652.019 FV CR10	1	valvola aspirazione/inlet valve
98+	291.9685.031 FV CR10	1	valvola scarico/exhaust valve
158+	291.4845.054 FV CR10	1	guida v.aspir./inlet v.guide std.
"	291.4845.060 FV CR10	1	" " +0,50
161+	291.4845.055 FV CR10	1	guida v.scar./exhaust v.guide std.
"	291.4845.061 FV CR10	1	" " +0,50
174+175+176+177=			PISTONE COMPLETO/PISTON SET
	=272.6500.071 F CR	1	+0,50 x 4LD640-640/L
	=272.6500.072 F CR	1	+1,00
	=279.6501.022 F CR	1	+0,50 x 4LD705
	=279.6501.023 F CR	1	+1,00
	=291.6501.071 F CR	1	+0,50 x 4LD820-820/L
	=291.6501.072 F CR	1	+1,00
175+	276.8210.053 F CR10	1	serie segm./ring set +0,50 4LD640-640/L
"	276.8210.054 F CR10	1	" " +1,00
"	279.8210.050 F CR10	1	" " +0,50 4LD705
"	279.8210.051 F CR10	1	" " +1,00
"	291.8210.059 F CR10	1	" " +0,50 4LD820-820/L
"	291.8210.060 F CR10	1	" " +1,00
211+	291.8000.046 FV CR10	1	sede v.aspirazione/inlet v.seat
212+	291.8000.047 FV CR10	1	sede v.scarico/exhaust v.seat
215+	270.1630.006 FV CR10	1	bronz.piede biella/small end bearing
298	262.1640.025 FV CR10	1	br.biella/bearing -0,25 4LD640-640/L-705
"	262.1640.026 FV CR10	1	" " -0,50
"	291.1640.048 F CR	1	" " -0,25 4LD820-820/L
"	291.1640.049 F CR	1	" " -0,50
337	270.1610.058 FV CR10	1	bronz.l.distr./gear side bear. -0,50
"	270.1610.010 F CR	1	" " -1,00
347	272.1610.057 FV CR10	1	bronz.l.volano/flywh.side bear.-0,50
"	272.1610.026 F CR	1	" " -1,00
349	9.1210.083 FV CR10	1	anello tenuta/seal ring -1,00
89+150+162+202+227+ 242+276+279+281+288+ 303+334+336+345+403+ 451=			SERIE GUARNIZIONI GASKET SET
	=272.8180.024 FV CR	1	x 4LD640-640/L
	=279.8180.027 FV CR	1	x 4LD705
	=291.8180.038 FV CR	1	x 4LD820-820/L