

RICAMBI  
 PIECES  
 SPARE PARTS  
 ERSATZTEILE  
 REPUESTOS

**4LD640**  
**4LD640/L**

**4LD705**

**4LD820**  
**4LD820/L**

LC  
 FAB  
 REC  
 MA

LOM  
 FABBI  
 REGG  
 MAC

SER  
 POC  
 GAS  
 DIC  
 SER  
 RIC  
 PIEC  
 MAI  
 WAI  
 REPI

SERI  
 POCI  
 GASI  
 DICHI  
 SERIE  
 RICAM  
 PIECE  
 MAIN  
 WAI  
 REPI

**SERVICE**

**LOMBARDINI**  
 FABBRICA ITALIANA MOTORI s.p.a.  
 REGGIO EMILIA, ITALIA  
**MADE IN ITALY**

SERIE GUARNIZIONI  
 POCLETTE JOINTS  
 GASKET SET  
 DICHTUNGSATZ  
 SERIE JUNTAS

RICAMBI PRIMO IMPIEGO  
 PIECES POUR L'ENTRETIEN  
 MAINTENANCE SPARE PARTS  
 WARTUNG - ERSATZTEILE  
 REPUESTOS DE PRONTO EMPLEO

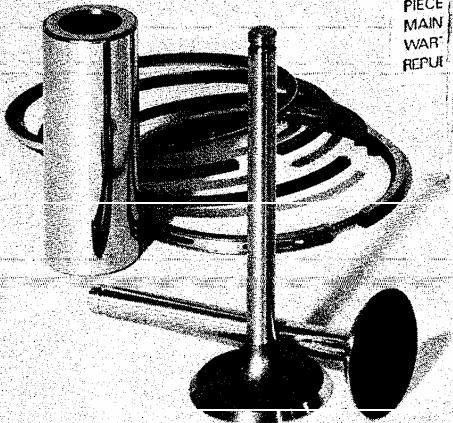

**REPUESTOS ORIGINALES**  
**ORIGINAL ERSATZTEILE**  
**GENUINE SPARE PARTS**  
**PIECES D'ORIGINE**  
**RICAMBI ORIGINALI**

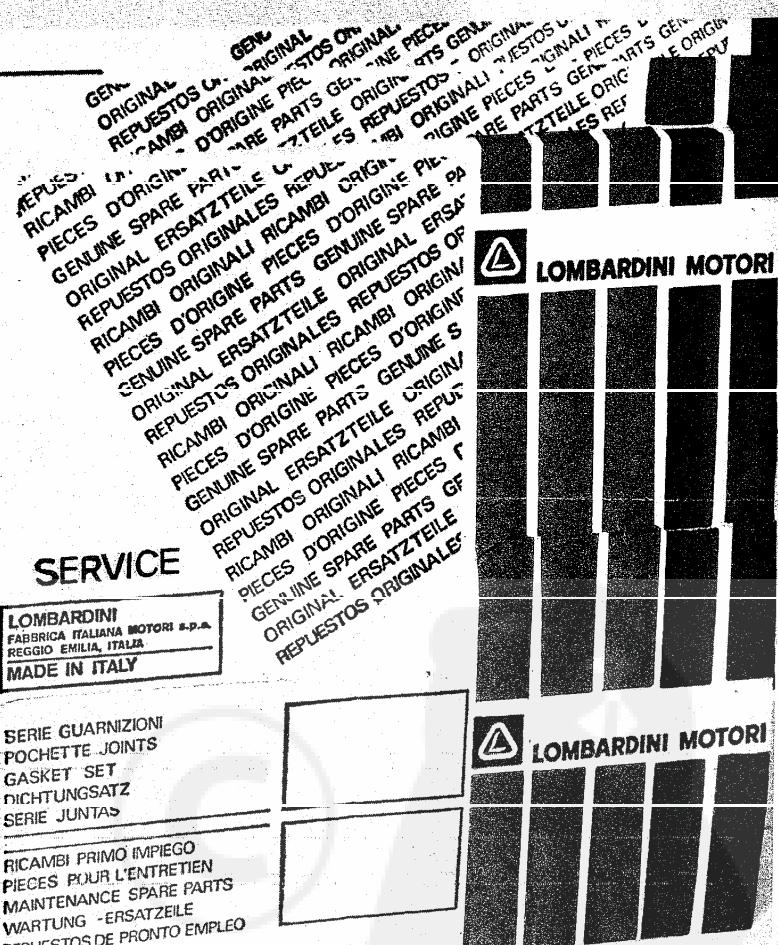

**SERVICE**

Per assistenza, rivolgetevi alle stazioni di servizio autorizzate Lombardini. N. tel. su libro verde 800-010000. Per vendite e riparazioni, rivolgetevi alle stazioni di servizio autorizzate Lombardini. N. tel. su libro verde 800-010000. Adressez-vous aux stations de service autorisées Lombardini. N. tel. sur livre vert 800-010000. Para asistencia, diríjase a las estaciones de servicio autorizadas Lombardini. N. tel. en libro verde 800-010000.

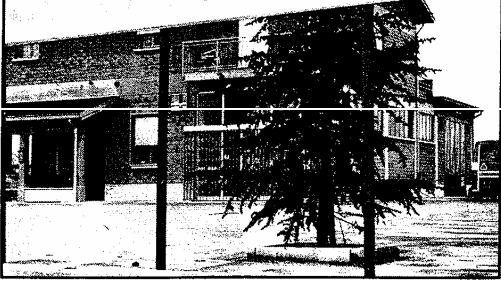
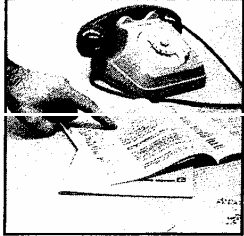
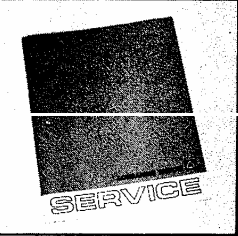

**ORDINI RICAMBI  
COMMANDES PIECES  
PART ORDERS  
E-TEIL BESTELLUNG  
PEDIDOS DE REPUESTO**

**TIPO MOTORE  
TYPE DE MOTEUR  
ENGINE TYPE  
MOTORTYP  
TIPO DEL MOTOR**

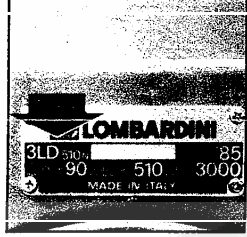
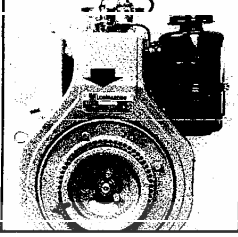

**MATRICOLA  
MATRICULE  
SERIAL NUMBER  
MOTORENNUMMER  
NUMERO DEL MOTOR**

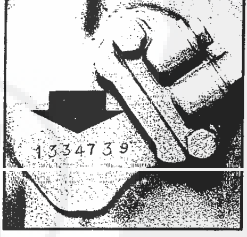
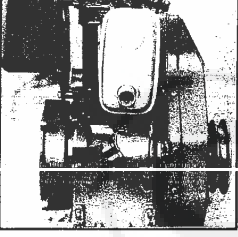
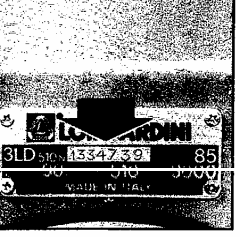
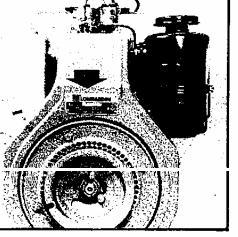

**TIPO DELLA MACCHINA  
TYPE DE MACHINE  
EQUIPMENT TYPE  
MASCHINENTYP  
MODELO DE LA MAQUINA**

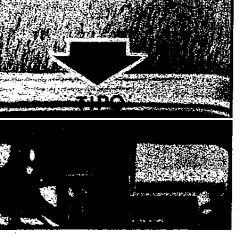
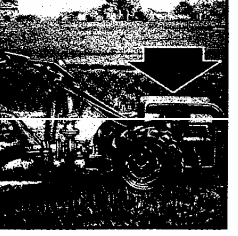

**MATRICOLA del ricambio  
REFERENCE de la pièce  
SPARE PART number  
BESTELNUMMER des Teiles  
REFERENCIA dei repuesto**

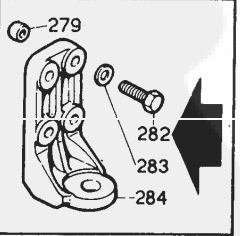
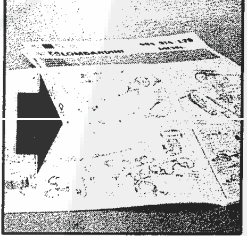

LOMBARDINI ENGINE  
LOMBARDINI FRANCE  
LOMBARDINI MOTORS  
LOMBARDINI MOTOR



**RICAMBI PER MOTORE STANDARD.**  
**PER APPLICAZIONI SPECIALI CONSULTARE**  
**IL CATALOGO PRESSO I CENTRI ASSISTENZA**  
**E RICAMBI.**

**PIECES POUR DES MOTEURS STANDARD.**  
**POUR LES ADAPTATIONS CONSULTER**  
**LE CATALOGUE AUPRES**  
**DES AGENTS SERVICE.**

**SPARE PARTS FOR STAN**  
**FOR SPECIAL APPLICATI**  
**CATALOG AT SERVICE CE**

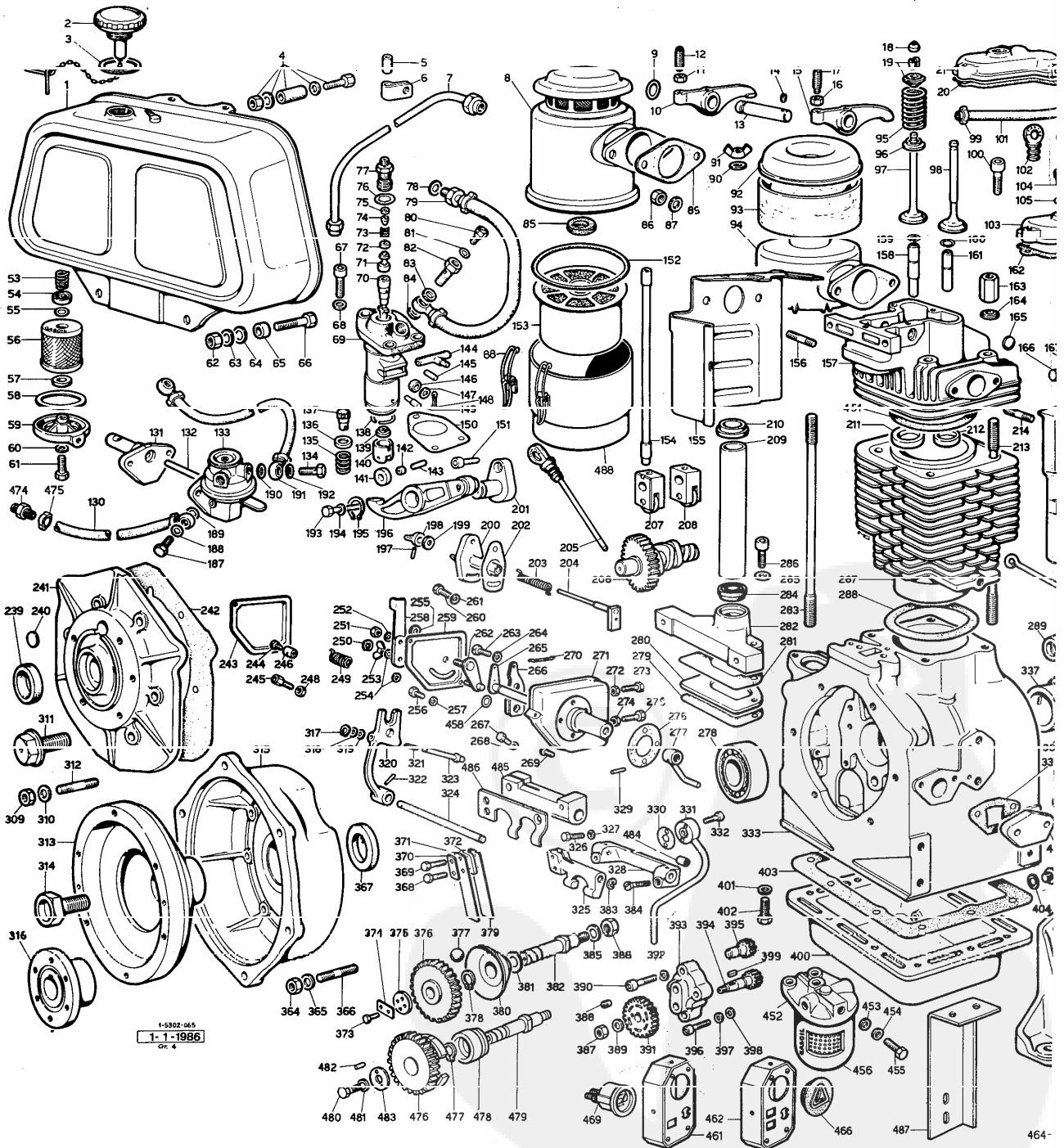

STANDARD ENGINE.  
APPLICATIONS SEE MASTER  
LISTING CENTERS.

ERSATZTEILE FÜR STANDARD-MOTOREN.  
FÜR SONDERANFERTIGUNGEN SIEHE  
ERSATZTEILKATALOG BEI SERVICE  
WERKSTÄTTEN.

REPUESTOS PARA MOTORES STANDARD.  
PARA APLICACIONES VEASE CATALOGO  
EN LAS ESTACIONES SERVICE.

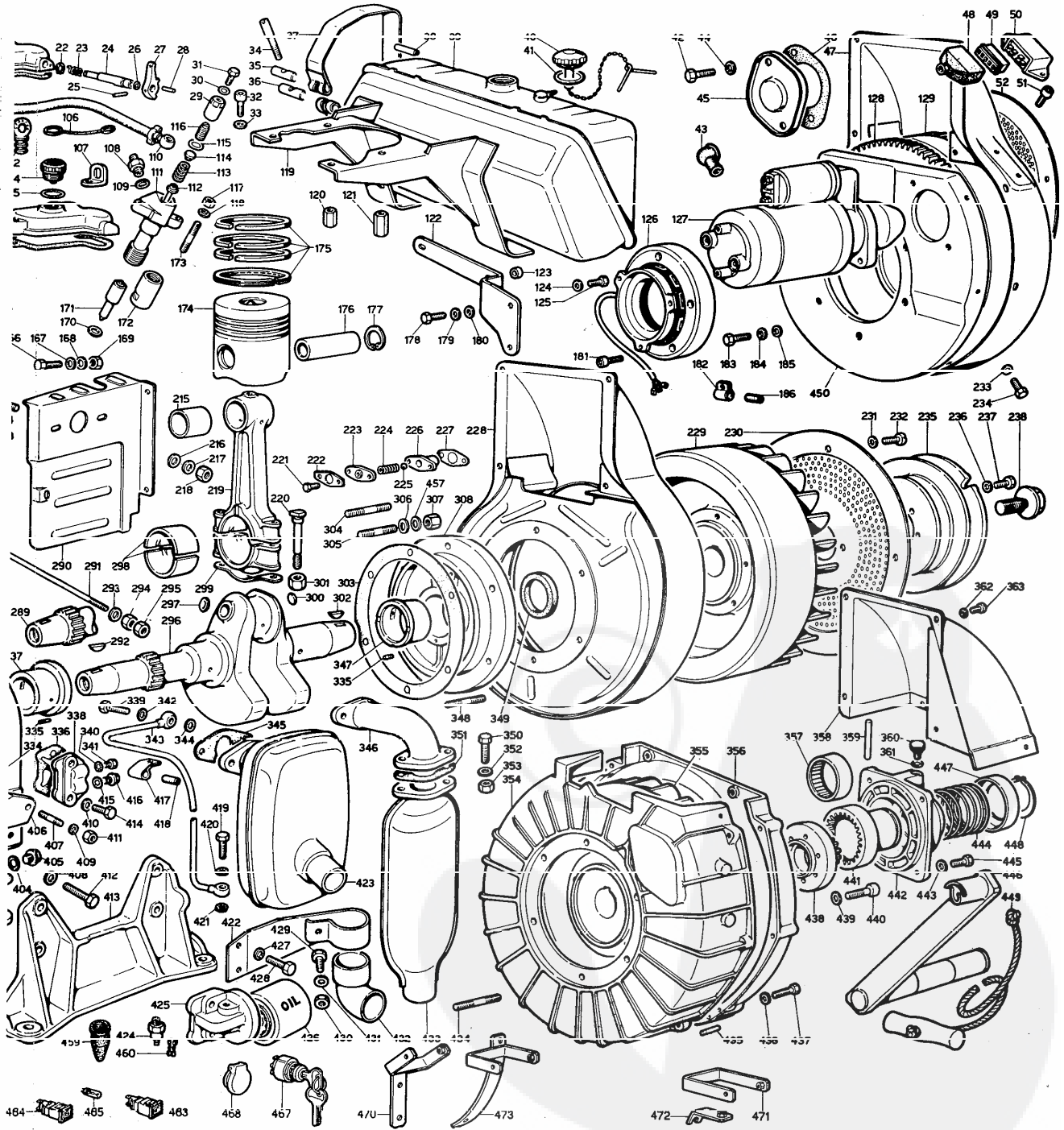

**9345-33**  
Tubo 2

**6184-6727-03**  
Pre-filtro

**271-3334-34**  
Decalcomania

**8060-3700-96**  
Filtro aria

**270-4115-29**  
Gancio 2

**5330-05**  
Spessore

**8740-17**  
Supporto

**261-3615-26**  
Fascetta

**260-3690-24**  
Fascetta 4

**263-9425-05**  
Tubo

**30-7555-08**  
Rondella 2

**236-3240-37**  
Dado (6x1,5) 2

**3750-41**  
Plangia

**270-4500-05**  
Guarnizione 2

**890-2200-50**  
Prigionero (6x1,5) 2

**261-3615-20**  
FASCETTA COMPL.

**260-9730-36**  
Vite (6x1,25)

**254-1557-07**  
Bioschermo

**254-1557-18**  
Bioschermo

**NOTE - REMARQUES - REMARKS**  
-In ambiente polveroso.  
-Dans une atmosphère poussiéreuse.  
-Under dusty conditions,  
-Fornito separato.  
-Livré séparé  
-Separately supplied.

\* NON FORNITO SEPARATO  
NON LIVRÉ SEPARÉMENT  
NOT SUPPLIED SEPARATELY

COMPLESSIVO - GROUPE - ASSEMBLY	FILTRO ARIA PREDIS. PREFILTRO A CICLONE FILTRE A AIR ADAPT. POUR PREFILTRE CYCL. AIR CLEANER SUITABLE FOR CYCL. PREFILTER	TAVOLA TABLE 4 41 14
MOTORE O VERSIONE MOTEUR OU ADAPTATION ENGINE OR VERSION	LDA 96-97-100 (K.9954.32)	FOGLIO FEUILLE PAGE DATE 2-73

370.167

**6184-9545-79**  
Tubo

**270-4500-50**  
Prigionero (6x1,5) 2

**5630-24**  
Fascetta 2

**270-4500-05**  
Guarnizione 2

**6184-6727-03**  
Pre-filtro

**271-3334-34**  
Decalcomania

**270-4115-29**  
Gancio 3

**270-3525-80**  
Spessore

**270-5496-08**  
Massa filtrante

**1002-9731-22**  
Vite (2x1,5) 1

**205-7625-26**  
Rondella 3

**8104-8301-71**  
Supporto

**8021-3206-20**  
Dado 2

**8021-3206-19**  
Dado 2

**30-7555-08**  
Rondella 2

**236-3240-37**  
Dado (6x1,5) 2

**270-4450-16**  
Guarnizione

**NOTE - REMARQUES - REMARKS**  
-In ambiente polveroso.  
-Dans une atmosphère poussiéreuse.  
-Under dusty conditions,  
-Con presa aria laterale.  
-Avec prise d'air latérale.  
-With side air inlet.

\* NON FORNITO SEPARATO  
NON LIVRÉ SEPARÉMENT  
NOT SUPPLIED SEPARATELY

COMPLESSIVO - GROUPE - ASSEMBLY	FILTRO ARIA FILTRE A AIR AIR CLEANER	TAVOLA TABLE 4 41 15
MOTORE O VERSIONE MOTEUR OU ADAPTATION ENGINE OR VERSION	LDA 96-97-100 (K.9954.45)	FOGLIO FEUILLE PAGE DATE 2-73





Tipo motore	Blocco motore
Engine type	Short block
4LD640 industr.	2720.1560.033
" automot.	2720.1560.034
4LD705 automot.	2790.1560.015
" industr.	2790.1560.016
4LD820 industr.	2910.1560.049
" automot.	2910.1560.050

FIG. NO.	MATRICOLA P.NO	Q.TA Q.TY	NOTE REMARKS	GR. 4 PAG.02
1+2+3=			SERBATOIO COMPLETO LATO DISTRIB. GEAR SIDE FUEL TANK	
	=270.8101.018 F C	1	std. capacity 1.7	
	=2790.8103.008 S IC	1	piatto /flat capacity 1.7,5	
2+3=			TAPPO/CAP	
	=285.9043.037 FV C	1	x serbatoio/f.tank 1.7	
	=2830.9043.025 FV C	1	x serbatoio/f.tank 1.7,5	
3+	9.1200.015 FV C 10	1	x serbatoio/f.tank 1.7	
"	2700.4650.056 DV C 10	1	x serbatoio/f.tank 1.7,5	
4	2830.9135.012 F C 10	2	tassello/cushion	
5	260.5390.006 S C 10	1	manicotto/rubber sheating	
6	2830.3617.016 S C 10	1	fascetta/strip fixing	
7	270.9370.009 FV C	1	tubo comb./fuel pipe	
8+85+88+152+153+ 488+489=			FILTRO ARIA CON CAPPELLOTTO AIR CLEANER WITH INLET COVER	
	=272.3700.139 FVIC	1	x 4LD640-640/L-705-820/L	
	=291.3702.016 E	1	x 4LD820	
	=291.3700.141 FV C	1	x 4LD820	
9+	9.1200.027 FV C 10	1	anello OR/rubber oil seal	
10+9+11+12+13+14+15+ 16+17=			GRUPPO BILANCIERI COMPLETO ROCKER ARM ASS.Y	
	=291.4330.023 F C	1	x 4LD640-705-820	
	=291.4330.038 D C	1	x 4LD640/L-820/L	
11+	9.3240.010 FV C 10	1	dado/nut	
12+	270.9850.002 F C 10	1	vite/screw	
13:	271.6045.029 FV C 10	1	perno bil./rocker shaft 4LD640-705-820	
"	291.6045.034 S C	1	" " 4LD640/L-820/L	
14+	9.9765.051 F C 10	1	vite/screw M 6 X 1 X 8	
15+	.....		vedi/see fig.No. 10+...	
16+	9.3240.010 FV C 10	1	dado/nut	
17+	270.9850.002 F C 10	1	vite/screw	
18+	270.2135.067 FV C 10	1	cappelotto/cap	
19+	260.6410.010 F C 10	2	piattello/retainer wiht half-colletts	
20	270.4400.008 FV C 50	1	guarnizione/joint 0,30	
21+22+23+24+25+26+27+ 28+100+107=			CAPPELLO BILANC.CON DECOMPRESSIONE ROCKER BOX CAP WITH DECOMPRESSION	
	=272.2125.087 F IC	1		
22+	9.1165.004 FV C 10	1	anello/circlip	
23+	270.5680.024 FV C 10	1	molla/spring	
24+	270.1110.038 F	1	albero/decompression shaft	
25+	9.8430.023 S C 10	1	spina/taper pin	
26+	9.1200.034 FV C 10	1	anello OR/rubber oil seal	
27+	500.5270.078 F C	1	leva/lever	
28+	9.8430.023 S C 10	1	spina/taper pin	

FIG. NO.	MATRICOLA P.NO	Q.TA Q.TY	NOTE REMARKS	GR. 4 PAG.03
29+	260.4130.053	SV C	1 ghiera/ring nut	
30	9.4470.058	FV C 10	2 guarnizione/copper joint	
31+	9.1901.029	FVIC 10	1 bullone raccordo/connection bolt	
32	9.9731.023	F C 10	4 vite/screw M 12 X 1,5 X 16	
33	9.7565.013	S C 10	4 rondella/washer	
34+	45.1860.065	F C 10	2 bullone/bolt	
35+	45.1557.019	F C 10	2 blocchetto/nut	
36+	45.1557.020	F C 10	2 blocchetto/nut	
37+34+35+36=	=271.3616.009	F C 10	2 FASCETTA FISSAGGIO SERBATOIO fuel tank fixing clamp	
38	271.9600.057	FV C 10	2 tubetto/rubber sheathing	
39+40+41=	=273.8101.021	F C	1 SERBATOIO COMPLETO LATO VOLANO FLYWHELL SIDE FUEL TANK	
40+41=	=285.9043.037	FV C	1 TAPPO SERBATOIO FUEL TANK CAP	
41+	9.1200.015	FV C 10	1 anello OR/rubber oil seal	
42	9.6820.014	D 10	2 prigioniero/stud M 12 X 30 (48)	
43	2830.6491.005	FV C	1 pipetta/pipe elbow	
44	9.7625.026	S 10	2 rondella/washer	
45	270.6685.045	S	1 portina/cover	
46	422.4773.042	N 50	1 guarnizione/joint	
47	270.2565.070	F C	1 convogliatore/shroud	
48	276.2145.014	FVAC 10	1 cappuccio/rubber cap	
49	276.6740.088	FVAC 10	1 presa/inlet regolat./regul.Saprisa	
"	276.6740.089	SVAC 10	1 presa/inlet regolat./regul.Ducati	
"	276.6740.090	SVAC 10	1 x reg.Ducati con spia car.batteria with ch.battery light	
50	2760.7362.027	FVIC	1 regol.tens./voltage regul. 12 V 12 A	
"	9040.7362.066	FVIC	1 12 V 12 A con spia carica batteria with charg.battery light	
51	9.9731.092	S 10	2 vite/screw M 8 X 1,25 X 14	
52	291.5095.081	S C	1 lamiera/panel 4LD820	
53+	273.5575.006	FV C 10	1 molla/spring	
54+	273.3930.019	F C 10	1 fondello/cup	
55+	9.1200.032	FV C 10	1 anello OR/rubber oil seal	
56+53+54+55+57+58+59+	60+61=	=273.3730.015	FV C	1 FILTRO COMBUSTIBILE COMPLETO FUEL FILTER
56+	273.2175.009	FV C	1 cartuccia comb./f.filter element	
57+	273.4490.017	FV C 10	1 guarnizione/joint	
58+	260.4430.071	FV C 10	1 guarnizione/joint	
59+	273.2605.033	F AC	1 coperchio/filter cover	
60+	9.1202.052	FVAC 10	1 anello OR/rubber oil seal	
61+	9.1760.076	D A	1 bullone/bolt	
62	9.3240.018	FV 10	2 dado/nut	
63	9.7565.007	F C 10	2 rondella/washer	
64	9.7625.012	FV C 10	2 rondella/washer	
65	270.3525.093	S C 10	2 x serb./f.tank capacity 1.7.5	
66	9.1770.011	S C 10	2 bullone/bolt std. M 8 X 1,25 X 40	
"	9.1770.031	N 10	2 x avv.eletttr/elec.st.-M 8X1,25X50	
67	9.9730.100	F 10	3 vite/screw M 8 X 1,25 X 25	
68	9.7625.010	FV C 10	3 rondella/washer	



FIG. NO.	MATRICOLA P.NO	Q.TA Q.TY	NOTE REMARKS	GR. 4 PAG.04
	69+70+71+72+73+74+75+ 76+77+135+136+137+138+ 139+140+141+142+143+ 144+145+149=		POMPA INIEZIONE COMPLETA INJECTION PUMP	
	=283.6590.033 F C	1	std.	
	=283.6590.041 F C	1	Bosch type	
70+	283.6578.013 FV C	1	pompante/injection plunger std.	
"	283.6578.020 FV C	1	" " " " Bosch	
71+	273.9672.013 F C	1	valvolina mandata/delivery valve std.	
"	273.9672.016 F C	1	" " " " Bosch	
72+	271.4760.015 FV C 10	1	guarnizione/joint	
73+	271.5755.034 SV C 10	1	molla/spring	
74+	271.7470.003 FV C 10	1	riempitore/filler	
75+	271.8335.029 SV C 10	1	spessore/shim	
76+	9.1200.031 FV C 10	1	anello OR/rubber oil seal	
77+	271.7265.008 FV C 10	1	raccordo/connection	
78	9.4670.058 FV C 10	1	guarnizione/copper joint	
79	2830.9371.071 E	1	tubo da serb.lato.dist.a pompa in. mm 273 pipe from gear side f.tank to inj.pump x serb./f.tank capacity L.7	
"	273.9375.274 FVAC	1	" " " " mm 253	
"	7150.9375.116 E	1	x serb./f.tank capacity L.7,5 mm 370	
"	2830.9375.290 FVAC	1	" " " " mm 355	
"	2790.9371.086 F	1	tubo da serb.lato vol.a pompa in. mm 500 pipe for flywh.side f.tank to inj.pump	
"	2790.9375.289 D AC	1	" " " " mm 495	
80	9.9080.037 FV C 10	1	tappo/deaeration cap.	
81	9.4775.196 SV C 10	1	guarnizione/joint	
82	9.1901.031 FVIC 10	1	bullone raccordo/connection bolt	
83	9.4670.060 FV C 10	1	guarnizione/copper joint	
84	9.4670.060 FV C 10	1	guarnizione/copper joint	
85+	270.3525.000 F IC 10	1	distanziatore/spacer diam.= 61	
"	292.1261.073 DVAC 10	1	" " " " diam.= 62,5	
86	9.3240.037 F	10	dado/nut	
87	9.7555.008 FV C 10	2	rondella/washer	
88+	276.4115.048 F C 10	2	gancio/hook	
89+	710.4501.003 FV C 50	2	guarnizione/joint	
90+	9.7555.004 FV C 10	1	rondella/washer	
91+	9.3200.002 FV C 10	1	dado/nut	
92+	271.2125.056 F C	1	cappello/inlet air cap	
93+	2910.1301.069 FV C 10	1	prefiltro/cyclonic prefilter	
	94+85+88+90+91+92+ 93+94+152+153+488=		FILTRO ARIA CON PREFILTRO CYCLONIC TYPE AIR CLEANER	
	=272.3702.019 E	1	x 4LD640-640/L-705-820/L	
	=272.3700.140 SV C	1	x 4LD640-640/L-705-820/L	
	=291.3702.017 E	1	x 4LD820	
	=291.3700.142 DV C	1	x 4LD820	
95+	260.5755.004 FV C	2	molla/spring	
96+	291.6410.037 F IC 10	2	piattello/retainer	
97+	291.9652.019 FV CR10	1	valvola aspirazione/inlet valve	
98+	291.9685.031 FV CR10	1	valvola scarico/exhaust valve	
99+	.....			
100+	9.9732.063 S AC 10	2	vite/screw M 8 X 1,25 X 35	
101	270.9570.067 FV C 10	1	tubo spurgo in./bleeding pipe x serb.l.distr./gear side f.tank	
"	2790.9570.044 D C	1	x serb.l.volano/flywh.side f.tank	
102	270.9055.003 FV C 10	1	tappo/starter cap	

FIG. NO.	MATRICOLA P.NO	Q.TA Q.TY	NOTE REMARKS	GR. 4 PAG.05
103+100+107=	=272.2125.003 S IC	1	CAPPELLO BILANCIERI std. ROCKER BOX CAP	
104+105=	=270.9050.021 FV C	1	TAPPO SFIATO/BREATHER CAP std.	
105+	9.1200.014 FVIC	10	1 anello OR/rubber oil seal	
106	500.3695.038 F C	10	1 filo/wire	
107+	904.8506.003 S AC	10	1 squadretta/angle bracket	
108	260.7300.033 E	1	1 raccordo/connection	
	500.7301.006 D I	1	1	
109	260.4650.037 DV C	10	1 guarnizione/joint	
110+	9.7270.020 SV C	10	1 raccordo/connection	
111+29+31+112+113+114+			PORTAPOLVERIZZATORE COMPLETO	
115+116+171+172=	=291.6615.015 F C	1	NOZZLE HOLDER std.	
	=291.6615.028 D C	1	Bosch type	
111+29+31+112+113+114+			CORPO POLVERIZZATORE	
115+116+172=	=260.6615.001 D	1	NOZZLE HOLDER BODY	
112+	260.1420.012 DV C	1	1 asta comando/control rod	
113+	260.5800.038 SV C	1	1 molla/spring	
114+	260.8010.002 DV C	1	1 sede/seat	
115+	260.4370.007 DV C	10	1 guarnizione/joint	
116+	260.1570.016 DV C	1	1 bocchettone/filler cap	
117	9.3240.018 FV	10	2 dado/nut	
118	9.7565.007 F C	10	2 rondella/washer	
119	2790.8865.053 D C	1	1 supporto/support	
120	2790.3206.020 DV C	10	2 dado/nut	
121	2790.3206.019 DV C	10	2 dado/nut	
122	2720.8545.085 S A	1	1 staffa/brace	
123	272.3526.079 D	10	2 distanziale/spacer	
124	9.7565.004 F C	10	3 rondella/washer	
125	9.1760.005 FV	10	3 bullone/bolt M 6 X 1 X 16	
126	283.1156.090 FVIC	1	1 alternatore/voltage altern.12V 12A	
127	272.5840.066 F I	1	1 mot.avv./start.eng.12 V Bosch type	
128	270.2816.011 F C	1	1 corona avviamento/crown gear	
129	270.9881.006 S C	1	1 volano avv.elett./el.starting flywheel	
130	5000.9375.240 S AC	1	1 tubo da serbatoio a pompa aliment. mm 377 pipe from fuel tank to feed pump	
131	271.8901.080 S IC	1	1 supporto/support	
132	270.6495.012 D C	1	1 pistoncino/plunger	
133	283.6585.031 FV C	1	1 pompa alimentazione/feed pump	
134	9.1901.030 FVIC	10	1 bullone raccordo/connection bolt	
135+	260.5625.002 SV C	1	1 molla/spring	
136+	260.7980.020 SV C	1	1 scodellino/cup	
137+	260.4850.009 FV C	1	1 guida/guide	
138+	9.1260.084 DV C	10	1 anello/ring	
139+	260.6400.024 D	1	1 piattello/retainer	
140+	260.7215.017 FV C	1	1 punteria/tappet	
141+	260.7770.020 SV C	1	1 rullo/roller	
142+	260.1970.054 DV C	1	1 bussola/sleeve	
143+	260.6230.068 SV C	1	1 perno/pin	
144+	270.1415.007 DV C	1	1 asta comando/control rod	
145+	277.6230.075 S	10	1 perno/pin	
146	270.1580.016 F C	10	1 boccia/bushing	
147	9.7626.017 D C	10	1 rondella/washer	
148	9.2800.003 F C	10	1 copiglia/cotter pin	

FIG. NO.	MATRICOLA P.ND	Q.TA Q.TY	NOTE REMARKS	GR. 4 PAG.06
149+	260.6230.069 DV C	1	perno/pin	
150+	283.4580.001 D	50	1 guarnizione/joint 0,10	
"	283.4580.008 N	50	1 " " 0,50	
"	283.4580.012 N	50	1 " " 0,30	
"	283.4580.039 N	10	1 " " 0,05	
151	9.9732.092 F C	10	1 vite/screw M 8 X 1,25 X 18	
152+	291.4776.032 FV C	10	1 guarnizione/joint	
153+	292.5496.111 FVIC	1	1 x 4LD640-640/L-705-820/L	
"	291.5496.051 E	1	1 x 4LD820	
"	291.5496.118 FVIC	1	1 "	
154	270.1410.011 FV C	2	2 asta punteria/push rod	
155	270.5065.009 F C	1	1 lamiera/airtight plate	
156+	9.6800.050 S I	10	2 prigioniero/stud M 10 X 23 (38)	
157+9+10+11+12+13+14+			TESTA COMPLETA	
15+16+17+18+19+95+96+			CYLINDER HEAD	
97+98+156+158+159+160+				
161+165+173+211+212+				
214=	=291.9201.003 F C	1		
157+156+158+159+160+			TESTA CON SEDI E GUIDE	
161+173+211+212+214=	=291.9201.004 F C	1	CYLINDER HEAD WITH SEATS AND GUIDES	
158+	291.4845.054 FV CR10	1	1 guida v.aspir./inlet v.guide std.	
"	291.4845.060 FV CR10	1	1 " " +0,50	
159+	291.1160.013 FV C 10	1	1 anello/circlip	
160+	291.1160.013 FV C 10	1	1 anello/circlip	
161+	291.4845.055 FV CR10	1	1 guida v.scar./exhaust v.guide std.	
"	291.4845.061 FV CR10	1	1 " " +0,50	
162+	270.4400.007 FV C 50	1	1 guarnizione/joint 0,50	
163	270.3206.015 FV C 10	1	1 dado/nut	
164	9.7625.055 SV C 10	4	4 rondella/washer	
165+	9.8990.017 F C 10	1	1 tappo/plug	
166	9.1760.003 F 10	4	4 bullone/bolt M 6 X 1 X 12	
167	9.7565.004 F C 10	4	4 rondella/washer	
168	9.7625.007 S C 10	3	3 rondella/washer	
169	9.3240.008 FV 10	3	3 dado/nut	
170	9.4670.009 FV C 10	1	1 guarnizione/copper joint 0,50	
"	9.4670.010 FV C 10	1	1 " " 1,00	
"	9.4670.011 FV C 10	1	1 " " 1,50	
171+	710.6531.033 FVIC	1	1 polverizzatore/nozzle	
172+	260.4130.052 SV C	1	1 ghiera/ring nut	
173+	9.6780.018 FV C 10	2	2 prigioniero/stud M 8 X 28 (43)	
174+175+176+177=			PISTONE COMPLETO/PISTON SET	
=272.6500.070 FV C	1	1	1 std. x 4LD640-640/L	
=272.6500.071 F CR	1	1	1 +0,50	
=272.6500.072 F CR	1	1	1 +1,00	
=279.6501.021 FV C	1	1	1 std. x 4LD705	
=279.6501.022 F CR	1	1	1 +0,50	
=279.6501.023 F CR	1	1	1 +1,00	
=291.6501.070 FV C	1	1	1 std. x 4LD820-820/L	
=291.6501.071 F CR	1	1	1 +0,50	
=291.6501.072 F CR	1	1	1 +1,00	



FIG. NO.	MATRICOLA P.NO	Q.TA Q.TY	NOTE REMARKS	GR. 4 PAG.07
175+	276.8210.052	FV C 10	1 serie segm./ring set std. 4LD640-640/L	
"	276.8210.053	F CR10	1 " " +0,50	
"	276.8210.054	F CR10	1 " " +1,00	
"	279.8210.049	FV C 10	1 " " std. 4LD705	
"	279.8210.050	F CR10	1 " " +0,50	
"	279.8210.051	F CR10	1 " " +1,00	
"	291.8210.058	FV C 10	1 " " std. 4LD820-820/L	
"	291.8210.059	F CR10	1 " " +0,50	
"	291.8210.060	F CR10	1 " " +1,00	
176+	272.8480.010	F C	1 spinotto/gudgeon pin 4LD640-640/L	
"	279.8480.021	S C	1 " " 4LD705	
"	291.8480.025	D C	1 " " 4LD820-820/L	
177+	9.1240.026	FV C 10	2 anello seeger/snap ring	
178	9.1760.048	D 10	2 bullone/bolt	
179	9.7565.004	F C 10	2 rondella/washer	
180	9.7625.070	D C 10	2 rondella/washer	
181	9.9730.015	F C 10	5 vite/screw M 6 X 1 X 30	
182	2790.3617.017	D 10	1 fascetta/strip fixing	
183	9.1790.025	F C 10	1 bullone/bolt M 12 X 1,25 X 30	
184	9.7565.013	S C 10	1 rondella/washer	
185	9.7625.026	S 10	1 rondella/washer	
186	260.5390.006	D 10	1 manicotto/rubber sheathing	
187	9.1901.030	FVIC 10	1 bullone raccordo/connection bolt	
188	9.4670.059	FVIC 10	1 guarnizione/copper joint	
189	9.4670.059	FVIC 10	1 guarnizione/copper joint	
190	9.4670.059	FVIC 10	1 guarnizione/copper joint	
191	2790.9372.001	DV C	1 tubo da pompa alim. a pompa iniezione pipe from feed pump to injection pump	
192	9.4670.059	FVIC 10	1 guarnizione/copper joint	
193	9.1770.015	F 10	1 bullone/bolt M 8 X 1,25 X 55	
194	9.7565.007	F C 10	1 rondella/washer	
195	9.1240.013	D 10	1 anello seeger/snap ring	
196	270.4330.028	F IC	1 bilanc.pompa iniez./inj.pump rocker	
197+	9.6420.001	D C 10	1 spina/locating pin	
198+	.....		vedi/see fig.No. 200+...	
199+	9.1200.041	FV 10	1 anello OR/rubber oil seal	
200+197+198+199+203+			COMANDO SUPPLEMENTO	
204=			DEVICE CONTROL	
	=272.2516.045	F IC	1	
201	271.6045.009	F U	1 perno/pin	
202+	270.4700.070	N 50	1-3 guarnizione/joint 0,50	
203+	270.5550.007	SV C 10	1 molla/spring	
204+	.....		vedi/see fig.No. 200+...	
205	270.1400.005	F C 10	1 asta liv./dipstick std. 4LD640-640/L-705	
"	291.1400.045	F C 10	1 " " std. 4LD820-820/L	
206	291.1010.060	F C	1 albero a camme/camshaft	
207	270.4887.002	FV C	1 punteria/tappet	
208	270.4887.001	FV C	1 punteria/tappet	
209	270.9520.023	S C	1 tubo prot./guard tube	
210	292.4740.017	FV C 10	1 guarnizione/joint	
211+	291.8000.046	FV CR10	1 sede v.aspirazione/inlet v.seat	
212+	291.8000.047	FV CR10	1 sede v.scarico/exhaust v.seat	
213+	270.6850.040	S C	2 prigioniero/stud	
214+	9.6800.050	S I 10	2 prigioniero/stud M 10 X 23 (38)	
215+	270.1630.006	FV CR10	1 bronz.piede biella/small end bearing	
216	9.7625.019	S 10	2 rondella/washer	
217	9.7565.011	F C 10	2 rondella/washer	
218	9.3240.053	FV C 10	2 dado/nut	

FIG. NO.	MATRICOLA P.NO	Q.TA Q.TY	NOTE REMARKS	GR. 4 PAG.08
219+215+220+301= =270.1526.002	F C	1	BIELLA COMPLETA CONNECTING ROD ASS.Y	
220+	270.1860.007 FV	C 10	2 bullone/bolt	
221+	9.1760.003 F	10	2 bullone/bolt M 6 X 1 X 12	
222+	271.5110.084 D	C 10	1 lamierino/tabwasher	
223+	271.3895.005 D	C	1 flangia/flange	
224+	.....		vedi/see fig.No. 226+...	
225+	9.8245.005 D	C 10	1 sfera/ball	
226+221+222+223+224+ 225+227= =273.9680.010	FV C	1	VALVOLINA DI PRESSIONE COMPLETA PRESSURE OIL VALVE ASS.Y	
227+	271.4760.007 DV	C 10	1 guarnizione/joint	
228	270.2565.076 F	IC	1 convogliatore/shroud	
229	270.9881.006 S	C	1 volano/flywheel std.	
230	270.5095.057 F	C	1 lamiera/panel guard 4LD640-640/L-705	
231	9.7540.006 D	C 10	4 rondella/washer std.	
"	9.7540.004 D	C 10	4 x avv.elettrico/electric starting	
232	9.9810.012 S	10	4 vite/screw std.	
"	9.9810.007 S	C 10	4 x avv.elettrico/electric starting	
233	271.7500.018 SV	C 10	7 rondella/washer	
234	9.1755.001 FV	10	7 bullone/bolt M 5 X 0,8 X 8	
235	270.4960.041 FV	C	1 puleggia avv./st.pulley std.	
"	2790.6960.054 FV	C	1 x pompa oleodinam./hydraulic pump	
"	2790.6960.078 S		1 puleggia 2 gole/2 grooves pulley	
236	9.7555.007 DV	C 10	6 rondella/washer	
237	9.1770.006 S	10	6 x puleggia/pulley std. MBX1,25X25	
"	9.1770.015 F	10	6 x puleggia per pompa oleodinamica pulley for hydr.pump MBX1,25X55	
"	9.1770.017 S	10	6 x pul. 2 gole/grooves MBX1,25X60	
238	270.1860.011 S	C	1 bullone/bolt	
239	9.1210.031 FV	C 10	1 anello tenuta/seal ring	
240+	9.8990.008 S	10	1 tappo/plug	
241+240= =272.6646.091	D IC	1	PORTINA LATO DISTRIBUZIONE GEAR SIDE CASE COVER	
242+	270.4431.004 SV	C 50	1 guarnizione/joint 0,30	
"	270.4431.010 N	50	1 " " " " 0,10	
243+244+245+246+248+ 249+256+257+263+264+ 265+266+270+271+272+ 273+274+275+277+329+ 458= =273.2515.027	F IC	1	COMANDO A DISTANZA REMOTE CONTROL	
243+	270.2690.042 F	C 10	1 coperchio/cover	
244+	9.9790.003 F	C 10	1 vite/screw M 4 X 0,7 X 6	
245+	2760.9180.042 S	C 10	1 terminale/cable-end	
246+	45.6000.016 FV	C 10	1 pastiglia/nut	
248+	9.3240.019 FV	C 10	1 dado/nut	
249+	270.5680.025 SV	C 10	1 molla/spring	
250+	9.1165.001 S	10	1 anello/circlip	
251+	9.3240.004 FV	C 10	1 dado/nut	
252+	90.6330.057 F	C 10	1 piastrina/safety plate	
253+	9.3200.015 FVIC	10	1 dado/nut	
254+	9.7626.054 S	AC 10	2 rondella/washer	
255+	9.7625.019 S	10	1 rondella/washer	

FIG. NO.	MATRICOLA P.NO	Q.TA Q.TY	NOTE REMARKS	GR. - 4 PAG.09
256+	9.9790.037	FV C 10	2	vite/screw M 6 X 1 X 8
257	.....			
258+	283.5200.159	F AC 10	1	leva/lever
259+249+250+251+252+				COMANDO A MANO
253+254+255+256+258+				HAND CONTROL
262+263+264+265+266				
267+268+270+271+272+				
273+274+275+277+329+				
436-				
	=273.2515.029	F C	1	
259+	283.2690.122	F AC 10	1	coperchio/cover std.
260	9.1760.005	FV 10	2	bullone/bolt M 6 X 1 X 16
261	9.7625.059	D C 10	2	rondella/washer
262+	283.6370.114	S AC 10	1	piastra/plate
263+	270.9820.073	D BC 10	1	vite/screw
"	272.9820.109	D AC 10	1	"
264+	9.7625.007	S C 10	1	rondella/washer
265+	.....			vedi/see fig.No. 277+...
266+	270.5200.086	S BC 10	1	leva/lever
"	272.5200.254	D AC	1	"
267+	9.1770.042	D C 10	1	bullone/bolt M 8 X 1,25 X 10
268+	9.7555.007	DV C 10	1	rondella/washer
269	9.9800.061	F C 10	3	vite/screw M 6 X 1 X 16
270+	270.9245.031	S C 10	1	tirante/tie rod
271+	270.7865.018	D BC	1	scatola/housing
"	272.7865.088	D AC	1	"
272+	9.3240.008	FV 10	1	dado/nut
273+	9.1760.029	D A 10	1	bullone/bolt M 6 X 1 X 30
274+	9.3240.008	FV 10	1	dado/nut
275+	9.1760.029	D C 10	1	bullone/bolt M 6 X 1 X 30
276+	270.4700.069	N 50	1	guarnizione/joint
277+265+329=				
	=283.5200.292	S C	1	LEVA COMPLETA/LEVER ASS.Y std.
277+	272.5204.023	N	1	solo per gr.elettrog./only for gen.sets
278	9.3021.029	FVIC	1	cuscinetto/ball bearing
279+	270.4535.013	FV C 10	1	guarnizione/joint
280	270.5168.005	D C 10	1	lamierino/tabwasher
281+	270.4535.013	FV C 10	1	guarnizione/joint
282	270.4840.008	FV C	1	guida/guide
283+	270.6850.024	SV C	2	prigioniero/stud
284	292.4740.017	FV C 10	1	guarnizione/joint
285	.....			
286	9.9730.028	F 10	2	vite/screw M 8 X 1,25 X 30
287	272.2380.010	FV C	1	cilindro/cylinder 4LD640-640/L
"	279.2380.055	FV C	1	" " 4LD705
"	291.2380.082	FV C	1	" " 4LD820-820/L
288+	272.4410.061	D A 50	1	guarnizione/joint 4LD640-640/L
"	279.4410.062	D A 50	1	" " 4LD705
"	291.4410.063	D A 50	1	" " 4LD820-820/L
289+292+297+300+302=				ALBERO GOMITO/CRANKSHAFT
	=270.1050.005	F C	1	autotraz./automot. 4LD640-640/L-705
	=291.1051.012	F C	1	" " 4LD820-820/L
290	270.5065.012	F C	1	lamiera/airtight plate
291	270.9245.025	S C 10	1	tirante/tie rod
292+	9.2280.049	FV 10	1	chiavetta/key



FIG. NO.	MATRICOLA P.NO	Q.TA Q.TY	NOTE REMARKS	GR. 4 PAG.10
293	9.7625.005 FV C 10	1	rondella/washer	
294	9.3240.003 FV C 10	1	dado/nut	
295	9.3240.003 FV C 10	1	dado/nut	
296+292+297+300+302=			ALBERO GOMITO industr.& motopompe	
	=272.1051.091 F IC	1	CRANKSHAFT industr.& pumping units	
	=291.1051.092 F IC	1	x 4LD640-640/L-705	
			x 4LD820-820/L	
297+	9.8990.019 S C 10	1	tappo/plug	
298	262.1640.024 FV C	1	br.biella/bearing std.4LD640-640/L-705	
"	262.1640.025 FV CR10	1	" " -0,25	
"	262.1640.026 FV CR10	1	" " -0,50	
"	291.1640.045 FV C	1	" " std.4LD820-820/L	
"	291.1640.048 F CR	1	" " -0,25	
"	291.1640.049 F CR	1	" " -0,50	
299	*****			
300+	9.8990.002 F C 10	1	tappo/plug	
301+	9.3203.034 FVIC 10	2	dado/nut	
302+	9.2280.056 FV C 10	1	chiavetta/key	
303+	270.4700.008 FV C 50	1	guarnizione/joint 0,30	
"	279.4700.074 N 50	1	" " 0,10	
304+	9.6800.059 D 10	1	prigioniero/stud M 10 X 30 (39)	
305+	9.6800.018 D 10	2	x 4LD820-820/L - M 10 X 32 (47) & avv.elettrico/electric starting	
306	9.7565.011 F C 10	6	rondella/washer	
307	9.3240.033 FV 10	6	dado/nut	
308	270.8675.067 F C	1	supporto/support	
309	9.3240.033 FV 10	6	dado/nut	
310	9.7565.011 F C 10	6	rondella/washer	
311	291.1862.012 S C	1	bullone/bolt	
312	9.6800.053 S C 10	6	prigioniero/stud M 10 X 18 (33)	
313	2830.2052.022 D I	1	camp.autotraz./automot.bell MA	
"	270.2050.060 S	1	autotr./autom. MU x 4LD640-705	
"	291.2052.040 N	1	autotr./autom. MU (B) x 4LD820	
"	2720.2052.004 S	1	& industr. x 4LD640-705-820	
314	2910.1862.013 S	1	campana/bell industr. SAE 6 1/2	
"	2790.1862.032 D IC	1	bullone/bolt industr. SAE	
315+240=			CAMPANA/FLANGING BELL	
	=270.2031.096 D I	1	autotrazione/automotive MU-MB	
	=2720.2032.001 S I	1	autotr./autom. MA (4 FORI/HOLES)	
	=2790.2031.009 S	1	industr.	
	=2830.2032.044 S	1	industr. SAE 5	
	=2830.2032.049 D I	1	industr. SAE 6	
316	2830.5855.002 S	1	mozzo/hub	
317+	9.1165.001 S 10	1	anello/circlip	
318+	9.7625.074 N 10	1	rondella/washer std.	
"	9.7625.089 N 10	1	x gruppi elettrogeni/gen.sets	
319	9.7555.001 N 10	1	x gruppi elettrogeni/gen.sets	
320+317+318+321+322+			GRUPPO FORCELLA REGOLATORE	
323+324+325+328+368+			GOVERNOR SPEED YOKE ASS.Y	
369+370+371+372+379+				
383=				
	=270.4882.001 S C	1	std.	

FIG. NO.	MATRICOLA P.NO	Q.TA Q.TY	NOTE REMARKS	GR. 4 PAG.11
320+317+318+319+322+ 323+324+328+368+369+ 370+371+372+383+384+ 484+485+486=			GRUPPO FORCELLA REGOLATORE GOVERNOR SPEED YOKE ASS.Y	
	=272.4882.019 N	1	x gruppi elettr./gen.sets 1500/	
	=291.4882.024 N	1	x gruppi elettr./gen.sets 1800/	
	=270.4882.014 N	1	x gruppi elettr./gen.sets 3000/	
320+	270.5199.008 S C	1	leva/lever	
321+	270.5800.015 D C 10	1	molla/spring std.	
322+	9.8420.012 D C 10	1	spina/locating pin	
323+	270.6231.037 D AC 10	1	perno/pin	
324+	270.6140.013 D C 10	1	perno/pin	
325+	270.3945.027 S C	1	forcella/yoke std.	
326	9.1760.012 D C 10	1	bullone/bolt M 6 X 1 X 35	
327	9.7540.004 D C 10	1	rondella/washer	
328+	270.8615.020 D C	1	supporto/support	
329+	9.0420.012 D C 10	1	spina/locating pin	
330	270.7700.014 D C 10	1	rondella/washer	
331	270.9320.046 S C	1	tubo/pipe	
332	9.9730.010 S 10	2	vite/screw M 6 X 1 X 16	
333+213+283+304+305+ 334+335+336+338+340+ 341+348+366+406+407+ 407+410+411+414+415+ 416=			BASAMENTO COMPLETO predisposto pompa alim. CRANKCASE preset for fuel pump	
	=272.1511.069 D IC	1	x 4LD640-640/L	
	=279.1511.081 S IC	1	x 4LD705	
	=291.1512.004 D IC	1	x 4LD820-820/L	
334+	560.4580.047 FVIC 10	1	guarnizione/joint 1,00	
"	560.4580.049 FV C 10	1	" " 0,50	
"	560.4580.050 FV C 10	1	" " 0,80	
335+	9.8430.055 S IC 10	1	spina/locking needle	
336+	270.4730.021 SV C 10	1	guarnizione/joint	
337	270.1610.009 FV C	1	bronz.l.distr./gear side bear. std.	
"	270.1610.058 FV CR10	1	" " -0,50	
"	270.1610.010 F CR	1	" " -1,00	
338+336+340+341+410+ 414+415+416=			FLANGIA FILTRO OLIO ESTERNO FLANGE FOR EXTERNAL OIL FILTER	
	=270.3901.041 S C	1		
339	9.1901.054 FVIC 10	1	bullone raccordo/connection bolt	
340+	9.4670.058 FV C 10	1	guarnizione/copper joint	
341+	9.1770.001 FV 10	1	bullone/bolt M 8 X 1,25 X 12	
342	9.4670.058 FV C 10	1	guarnizione/copper joint	
343	2790.9455.036 S C	1	tubo lubr./lub.pipe	
344	9.4670.058 FV C 10	1	guarnizione/copper joint	
345+	710.4500.097 FV C 10	2	guarnizione/joint	
346	2790.2941.002 F C	1	curva/elbow 4LD820	
"	2790.2942.036 S C	1	curva/elbow 4LD640/L-820/L	
347	272.1610.025 FV C	1	bronz.l.volano/flywh.side bear. std.	
"	272.1610.057 FV CR10	1	" " -0,50	
"	272.1610.026 F CR	1	" " -1,00	
348+	9.6800.010 S C 10	5	x 4LD640-640/L-705 - M 10 X 25 (40)	
"	9.6800.010 S C 10	3	x 4LD820-820/L - M 10 X 25 (40)	
349	9.1210.078 FV C 10	1	anello tenuta/seal ring std.	
"	9.1210.083 FV CR10	1	" " -1,00	
350	9.1770.006 S 10	2	bullone/bolt M 8 X 1,25 X 25	

FIG. NO.	MATRICOLA P.NO	Q.TA Q.TY	NOTE REMARKS	GR. 4 PAG.12
351	276.4500.079	FV C 10	1 guarnizione/joint	
352	9.7565.007	F C 10	2 rondella/washer	
353	9.3240.019	FV C 10	2 dado/nut	
354	272.2568.054	D C	1 convogliatore/shroud	
355	2790.9884.045	N	1 volano avv.manov./handle start.flywheel	
356	272.2568.045	D C	1 convogliatore/shroud	
357	9.1585.058	S A	2 boccolo/bushing	
358	272.2920.072	D C	1 cuffia/hood	
359	9.8430.051	D B 10	1 spina/locking needle	
"	9.8430.019	D A 10	1	
360	5000.8965.031	D A	1 tappo/plug	
361	9.1202.016	SVAC 10	1 anello OR/rubber oil seal	
362	271.7500.018	SV C 10	3 rondella/washer	
363	9.9790.010	D 10	3 vite/screw M 5 X 0,8 X 10	
364	9.3240.033	FV 10	6 dado/nut	
365	9.7565.011	F C 10	6 rondella/washer	
366+	9.6800.004	F 10	6 prigioniero/stud M 10 X 20 (35)	
367	9.1213.058	FVIC 10	1 anello tenuta/seal ring	
368+	9.1755.002	D 10	1 bullone/bolt M 5 X 0,8 X 12	
369+	9.1755.004	D C 10	1 bullone/bolt M 5 X 0,8 X 18	
370+	285.6330.061	D 10	1 piastrina/safety plate	
371+	270.5655.005	FV C 10	1 molla/spring std.& gr.el./gen.sets 3000/'	
"	272.5655.051	N 10	1 x gruppi elettrog./gen.sets 1500/'	
"	2720.5655.067	N 10	1 x gruppi elettrog./gen.sets 1800/'	
372+	270.1557.021	D C 10	1 blocchetto/spacer	
373	9.1750.035	S C 10	2 bullone/bolt M 4 X 0,7 X 12	
374	270.6275.038	DV C 10	1 piastra/plate	
375	270.6370.038	D C 10	1 piastrina/safety plate	
376	270.4935.068	F C	1 ingranaggio/gearwheel	
377	9.8245.011	F C 10	6 sfera/ball	
378	9.1240.006	FV C 10	1 anello seeger/snap ring	
379+	270.5655.005	FV C 10	1 molla/spring std.& gr.el./gen.sets 3000/'	
380	270.2085.029	F	1 campana regol./governor bell	
381	270.7700.069	S C 10	1 rondella/washer	
382	271.6130.016	S C	1 perno/governor shaft	
383+	9.1165.006	D C 10	1 anello/circlip	
384	9.9800.013	S C 10	1 vite/screw std. M 6 X 1 X 35	
"	9.9800.049	N 10	1 x gruppi elettr./gen.sets M 4 X 14	
385	9.7625.019	S 10	1 rondella/washer	
386	9.3240.033	FV 10	1 dado/nut	
387	9.3203.014	FV C 10	1 dado/nut	
388+	9.9765.001	S C 10	1 vite/screw M 6 X 1 X 8	
389	9.7625.010	FV C 10	1 rondella/washer	
390	9.9730.030	S C 10	2 vite/screw M 8 X 1,25 X 35	
391	272.4975.018	F IC	1 ingranaggio/gearwheel	
392	9.7565.007	F C 10	2 rondella/washer	
393+388+394+395=			GRUPPO POMPA OLIO	
=272.4336.023	F IC	1	LUB. PUMP OIL ASS.Y	
394+	.....		vedi/see fig.No. 393+...	
395+	.....		vedi/see fig.No. 393+...	
396	9.9730.015	F C 10	1 vite/screw M 6 X 1 X 30	
397	9.7565.004	F C 10	1 rondella/washer	
398	9.7625.007	S C 10	1 rondella/washer	
399	9.2200.001	F C 10	1 chiavetta/key	
400	270.6645.040	S C	1 portina/oil pan	
401	9.7625.010	FV C 10	10 rondella/washer	
402	9.1770.002	FV 10	10 bullone/bolt M 8 X 1,25 X 16	
403+	270.4600.091	FV C 10	1 guarnizione/joint	
404	9.4670.016	FV C 10	1 guarnizione/copper joint	



FIG. NO.	MATRICOLA P.NO	Q.TA Q.TY	NOTE REMARKS	GR. 4 PAG.13
405	9.8965.005	FV C 10	1 tappo/oil drain plug	
406+	255.6700.012	S C	1 portina/pan	
407+	9.6780.012	DV C 10	2 prigioniero/stud M 8 X 25 (37)	
408	9.7565.011	F C 10	8 rondella/washer	
409+	9.7555.007	DV C 10	2 rondella/washer	
410+	9.7555.007	DV C 10	2 rondella/washer	
411+	9.3240.018	FV 10	2 dado/nut	
412	9.1780.005	FV 10	8 bullone/bolt M 10 X 1,5 X 28	
413	270.6426.010	D C	2 piede/engine mount	
414+	9.1770.007	F C 10	2 bullone/bull M 8 X 1,25 X 30	
415+	9.4670.060	FV C 10	1 guarnizione/copper joint	
416+	9.8965.003	FV C 10	1 tappo/plug	
417	9.3630.037	D C	1 fascetta/clamp	
418	710.5401.011	D C 10	1 manicotto/rubber sheating	
419	9.1901.055	FVIC 10	1 bullone raccordo/connection bolt	
420	9.4670.058	FV C 10	1 guarnizione/copper joint	
421	9.4670.058	FV C 10	1 guarnizione/copper joint	
422	2790.8545.040	D	1 staffa/brace 4LD640-705-820	
"	2790.8545.091	S C	1 staffa/brace 4LD640/L-820/L	
423	270.5460.090	F C	1 marmitta/muffler std.	
"	2830.5461.090	F C	1 x avv.elettrico/electric starting	
424+459+460=			PRESSOSTATO COMPLETO	
=9040.6745.031	FVAC	1	OIL PRESSURE SWITCH	
425+426=			FILTRO OLIO COMPLETO	
=270.3740.024	FV C	1	OIL FILTER	
426+	270.2175.028	FV C	1 cartuccia olio/oil filter element	
427	9.7565.011	F C 10	2 rondella/washer	
428	9.1780.007	S 10	2 bullone/bolt M 10 X 1,5 X 35	
429	9.1780.031	FV 10	1 bullone/bolt M 10 X 1,5 X 25	
430	9.3240.033	FV 10	1 dado/nut	
431	9.7565.011	F C 10	1 rondella/washer	
432	2910.9170.028	F C	1 terminale/muffler end	
433	2830.5461.047	F C	1 marmitta/muffler	
434	9.6800.020	F 10	6 prigioniero/stud M 10 X 35 (50)	
435	90.8460.083	D 10	2 spina/taper pin	
436	9.7565.007	F C 10	8 rondella/washer	
437	9.1770.014	D C 10	8 bullone/bolt M 8 X 1,25 X 45	
438	2790.6480.029	D	1 pignone/pinion gear	
439	9.7565.007	F C 10	6 rondella/washer	
440	9.9730.026	F 10	6 vite/screw M 8 X 1,25 X 20	
441	272.4970.008	D B	1 ingranaggio/gearwheel	
"	2790.4970.014	S A	1	
442	2790.3835.061	D BC	1 flangia/flange	
"	2790.7885.019	D A	1 scatola/housing	
443	9.7565.007	F C 10	4 rondella/washer	
444	270.5800.071	F BC 10	1 molla/spring	
"	7150.5801.028	S A	4	
445	9.1770.007	F C 10	1 bullone/bolt M 8 X 1,25 X 30	
446	270.5455.006	S	1 manovella/starting hand-crank	
447	500.7980.044	D BC	1 scodellino/cup	
"	500.7980.045	S A	1	
448	9.1240.046	D B 10	1 anello seeger/snap ring	
"	9.1240.041	D A 10	1	
449	203.4055.003	F C	1 fune avviamento/rope starting	
450	291.6371.039	F C	1 piastra avv.elett./electric start.plate	

FIG. NO.	MATRICOLA P. NO	Q.TA Q.TY	NOTE REMARKS	GR. 4 PAG. 14
451	272.4730.107	SVAC 10	1	guarn./head joint 0,70 4LD640-640/L
"	272.4730.108	SVAC 10	1	" " 0,80 " "
"	272.4730.109	DVAC 10	1	" " 0,90 " "
"	272.4730.110	DVAC 10	1	" " 1,00 " "
"	272.4730.111	DVAC 10	1	" " 1,10 " "
"	279.4730.112	S A 50	1	" " 0,70 4LD705-820-820/L
"	279.4730.113	S A 50	1	" " 0,80 " "
"	279.4730.114	S A 50	1	" " 0,90 " "
"	279.4730.115	S A 50	1	" " 1,00 " "
"	279.4730.116	S A 50	1	" " 1,10 " "
452+456=	=2830.3730.036	FV C	1	FILTRO COMBUSTIBILE ESTERNO EXTERNAL FUEL FILTER
453	9.4670.016	FV C 10	2	guarnizione/copper joint
454	9.4670.016	FV C 10	2	guarnizione/copper joint
455	9.1901.032	FVIC 10	2	bullone raccordo/connection bolt
456+	2830.2175.045	FVAC	1	cartuccia comb./f.filter element
457	9.7625.019	S	10	6 rondella/washer
458+	9.1200.041	FV	10	1 anello OR/rubber oil seal
459+	3600.6491.013	FVAC	1	1 pipetta/pipe elbow
460+	5000.9180.056	FVAC 10	1	1 terminale/gaston
461	9040.2900.069	F C	1	1 cruscotto/dashboard
462	9040.2900.070	F C	1	1 dashboard
463	9040.6612.063	S AC	1	1 spia olio/oil warning
464	9040.6612.064	S AC	1	1 spia batteria/battery warning
465	9040.5175.119	F AC 10	1-2	1 lampadina/lamp
466	9040.2615.021	F C	1	1 coperchio/cover
467	2830.5040.004	SV C	1	1 interruttore/key switch
"	2760.5041.020	FV C	1	" " " Bosch
468	2760.2750.111	F C	1	1 coperchio/switch cover
469	2760.5450.009	FV C	1	1 manometro olio/pressure gauge
470	2790.8506.010	D C	1	1 squadretta/angle bracket
471	2790.8506.011	N	1	1 squadretta/angle bracket
472	2790.8506.012	N	1	1 squadretta/angle bracket
473	2790.8506.038	N	1	1 squadretta/angle bracket
474	273.7300.057	FV C 10	1	1 raccordo/connection
475	9.3630.008	F C 10	1	1 fascetta/clamp
476	2920.7362.158	S C	1	1 regol.gr.elettrog./gen.sets governor
477	9.1240.005	DV C 10	1	1 anello seeger/snap ring
478	270.4894.003	N	1	1 campana reg.gr.elettr./gen.sets ball
479	270.6130.036	D C	1	1 perno gr.elettr./gen.sets shaft
480	9.1760.005	FV	10	1 bullone/bolt M 6 X 1 X 16
481	9.7701.014	D C 10	1	1 rondella/washer
482	9.8400.056	D C 10	1	1 spina/taper pin
483	270.6371.081	N	10	1 piastra/plate
484+	9.3030.051	S	2	2 cuscin.gr.elettrog./gen.sets ball bear.
485+	270.8785.040	D C	1	1 supp.gr.elettrog./gen.sets support
486+	270.5202.007	N	10	1 leva gr.elettrog./gen.sets lever

FIG. NO.	MATRICOLA P.NO	Q.TA Q.TY	NOTE REMARKS	GR. 4 PAG.15
487	2830.8760.037 S IC	1	supporto/support	
488+	.....		vedi/see fig. 9+.../94+...	
489+	292.5496.110 SVAC	1	massa filtrante/upper filtering element	
490	9.3203.059 N	10 2	dado/nut	
89+150+162+202+227+ 242+276+279+281+288+ 303+334+336+345+403+ 451=			SERIE GUARNIZIONI GASKET SET	
	=272.8180.024 FV CR	1	x 4LD640-640/L	
	=279.8180.027 FV CR	1	x 4LD705	
	=291.8180.038 FV CR	1	x 4LD820-820/L	

DISVI/RICA

\*\*\*\*\*

01.01.1986

\*\*\*\*\*

DESCRIZIONI NON IMPEGNATIVE  
SUBJECT TO MODIFICATIONS

aggiornata al 21.11.1986

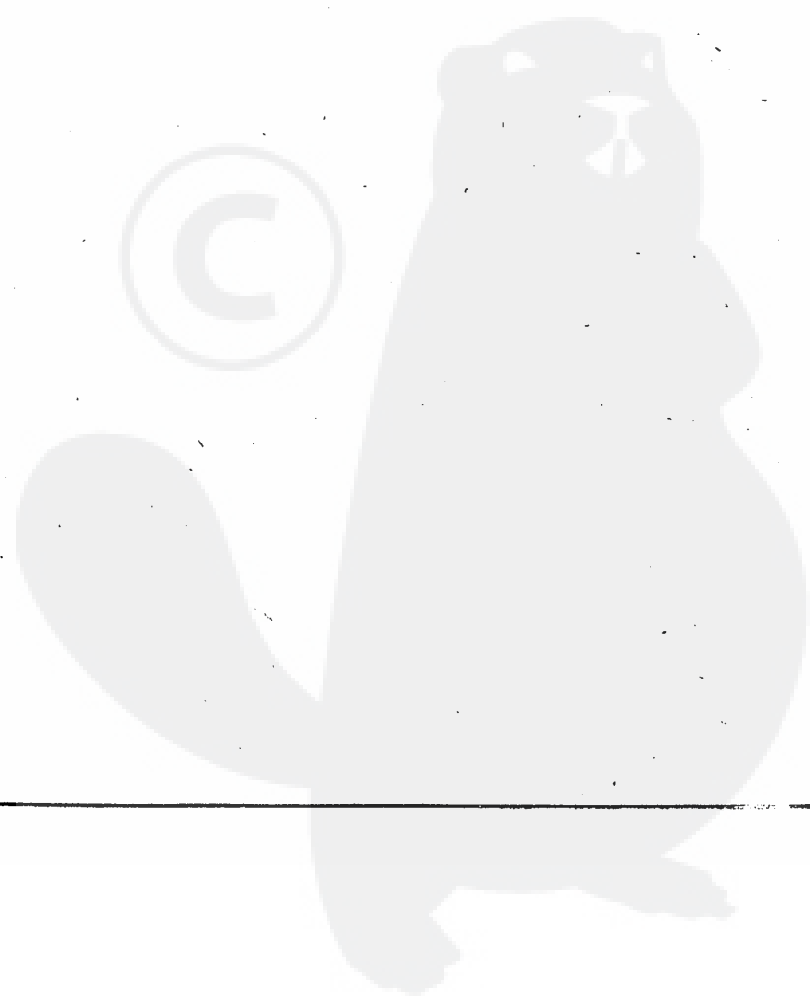



MATERIALE DI RETTIFICA  
GRINDING WORKSHOP PARTS LIST  
MATERIEL POUR RECTIFIEUR

GR. 04  
PAG.16

MOTORI-ENGINES-MOTEURS GR. 4

FIG. NO.	MATRICOLA PART NO.	Q.TA Q.TY	NOTE REMARKS
97+	291.9652.019 FV CR10	1	valvola aspirazione/inlet valve
98+	291.9685.031 FV CR10	1	valvola scarico/exhaust valve
158+	291.4845.054 FV CR10	1	guida v.aspir./inlet v.guide std.
"	291.4845.060 FV CR10	1	" " +0,50
161+	291.4845.055 FV CR10	1	guida v.scar./exhaust v.guide std.
"	291.4845.061 FV CR10	1	" " +0,50
174+175+176+177=			PISTONE COMPLETO/PISTON SET
	=272.6500.071 F CR	1	+0,50 x 4LD640-640/L
	=272.6500.072 F CR	1	+1,00
	=279.6501.022 F CR	1	+0,50 x 4LD705
	=279.6501.023 F CR	1	+1,00
	=291.6501.071 F CR	1	+0,50 x 4LD820-820/L
	=291.6501.072 F CR	1	+1,00
175+	276.8210.053 F CR10	1	serie segm./ring set +0,50 4LD640-640/L
"	276.8210.054 F CR10	1	" " +1,00
"	279.8210.050 F CR10	1	" " +0,50 4LD705
"	279.8210.051 F CR10	1	" " +1,00
"	291.8210.059 F CR10	1	" " +0,50 4LD820-820/L
"	291.8210.060 F CR10	1	" " +1,00
211+	291.8000.046 FV CR10	1	sede v.aspirazione/inlet v.seat
212+	291.8000.047 FV CR10	1	sede v.scarico/exhaust v.seat
215+	270.1630.006 FV CR10	1	bronz.piede biella/small end bearing
298	262.1640.025 FV CR10	1	br.biella/bearing -0,25 4LD640-640/L-705
"	262.1640.026 FV CR10	1	" " -0,50
"	291.1640.048 F CR	1	" " -0,25 4LD820-820/L
"	291.1640.049 F CR	1	" " -0,50
337	270.1610.058 FV CR10	1	bronz.l.distr./gear side bear. -0,50
"	270.1610.010 F CR	1	" " -1,00
347	272.1610.057 FV CR10	1	bronz.l.volano/flywh.side bear.-0,50
"	272.1610.026 F CR	1	" " -1,00
349	9.1210.083 FV CR10	1	anello tenuta/seal ring -1,00
89+150+162+202+227+ 242+276+279+281+288+ 303+334+336+345+403+ 451=			SERIE GUARNIZIONI GASKET SET
	=272.8180.024 FV CR	1	x 4LD640-640/L
	=279.8180.027 FV CR	1	x 4LD705
	=291.8180.038 FV CR	1	x 4LD820-820/L