

V262W/V282W temporary ver.

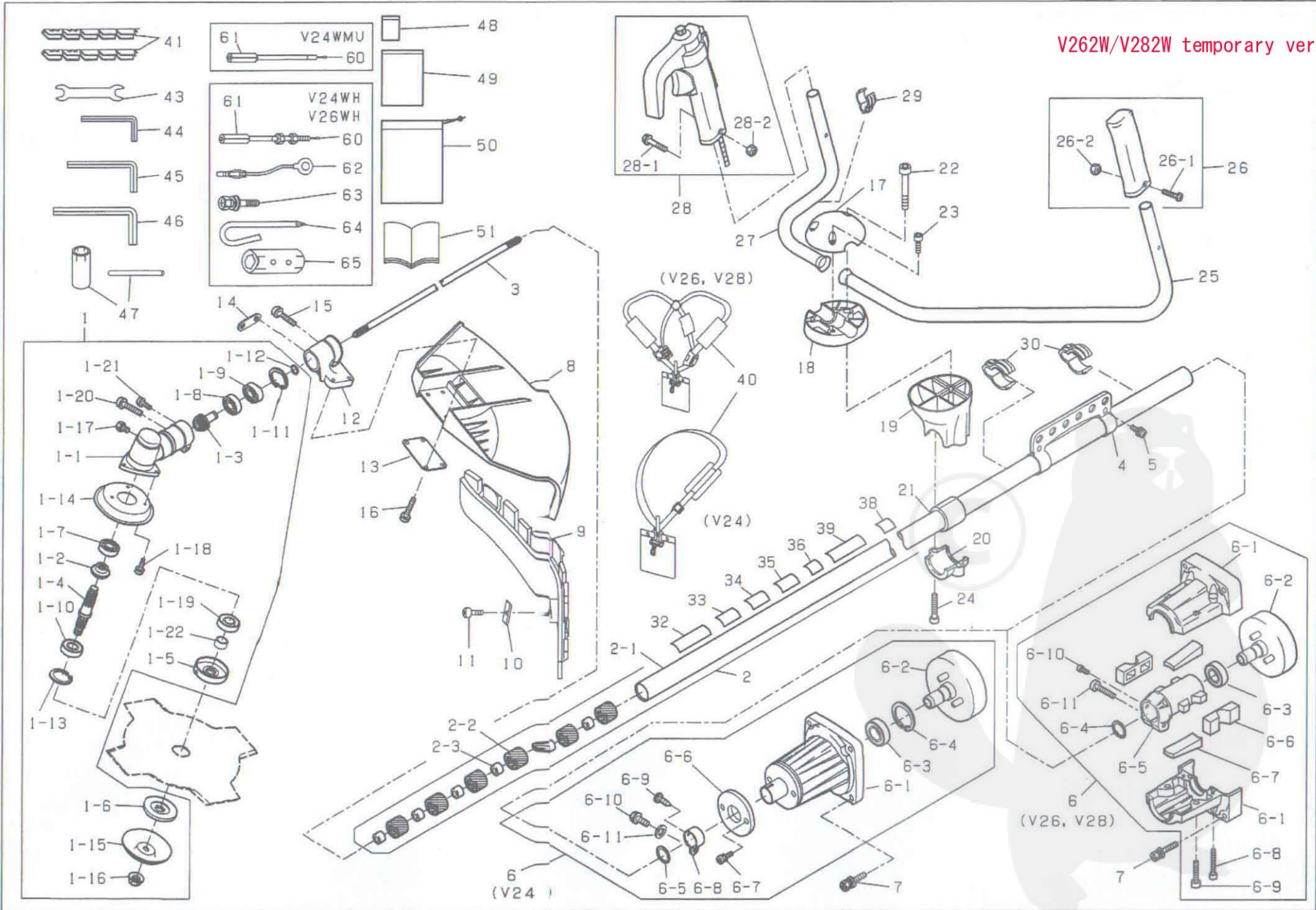

| PARTS LIST MODEL:V262W,V282W | | | | | | |
|------------------------------|-----------|-----------------|------|------|----------|----------------|
| REF No. | CODE | NAME | QTY | | REMARKS | |
| | | | 262W | 282W | SIZE | ORIGINAL MODEL |
| 1 | 801675707 | GEAR CASE ASS'Y | 1 | | 26 | V26W |
| | 801675726 | | | 1 | 28 | V28W |
| 1-1 | 801676365 | GEAR CASE | 1 | | 26 | V26W |
| | 801676377 | | | 1 | 28 | V28W |
| 1-2 | 801676366 | BEVEL GEAR | 1 | | | V26W |
| | 801676378 | | | 1 | | V28W |
| 1-3 | 801676367 | PINION | 1 | | | V26W |
| | 801676379 | | | 1 | | V28W |
| 1-4 | 801676368 | GEAR SHAFT | 1 | | | V26W |
| | 801676380 | | | 1 | | V28W |
| 1-5 | 801676369 | HOLDER(A) | 1 | | | V26W |
| | 801676381 | | | 1 | | V28W |
| 1-6 | 801676370 | HOLDER(B) | 1 | | | V26W |
| | 801676382 | | | 1 | | V28W |
| 1-7 | 800045020 | BEARING | 1 | | 6000 | |
| | 800045130 | | | 1 | 6001 | |
| 1-8 | 800045020 | BEARING | 1 | | 6000 | |
| | 800045130 | | | 1 | 6001 | |
| 1-9 | 800045500 | BEARING | 1 | | 6000Z | |
| | 800045510 | | | 1 | 6001Z | |
| 1-10 | 801676371 | BEARING | 1 | | 6201 | |
| | 801676383 | | | 1 | 6202 | |
| 1-11 | 800083160 | STOP RING | 1 | | 26 | |
| | 800083170 | | | 1 | 28 | |
| 1-12 | 800082010 | STOP RING | 1 | | 10 | |
| | 800082030 | | | 1 | 12 | |
| 1-13 | 800083190 | STOP RING | 1 | | 32 | |
| | 801668111 | | | 1 | 35 | |
| 1-14 | 801676372 | GEAR CASE COVER | 1 | | φ40×φ88 | V26W |
| | 801676385 | | | 1 | φ44×φ88 | V28W |
| 1-15 | 801676373 | NUT COVER | 1 | 1 | φ10×φ73 | V26W |
| 1-16 | 801676374 | NUT | 1 | 1 | M10×1.25 | |
| | | | | | | |
| | | | | | | |

| PARTS LIST MODEL:V262W,V282W | | | | | | |
|------------------------------|-----------|----------------------------------|------|------|-------------|----------------|
| REF No. | CODE | NAME | QTY | | REMARKS | |
| | | | 262W | 282W | SIZE | ORIGINAL MODEL |
| 2 | 801675727 | DRIVE SHAFT HOUSING ASS'Y | | 1 | 28 | V28W |
| 2-1 | 801675709 | DRIVE SHAFT HOUSING | 1 | | 26 | V26W |
| | 801675728 | | | 1 | 28 | V28W |
| 2-2 | 802031050 | METAL CUSHION | 6 | | | F-4 |
| | 802041200 | | | 6 | | F-5 |
| 2-3 | 800200029 | OIL METAL | 6 | 6 | φ8×φ14×10 | F-5 |
| 3 | 801666942 | DRIVE SHAFT | 1 | 1 | | H26 |
| 4 | 801675710 | HANGER STRAP STEM | 1 | | 26 | V26W |
| | 801675729 | | | 1 | 28 | V28W |
| 5 | 800200001 | SCREW | 2 | 2 | M6×12 (+)2P | |
| 6 | 800200030 | CLUTCH HOUSING ASS'Y | 1 | | | |
| | 800200079 | | | 1 | | H28 |
| 6-1 | 801667108 | CLUTCH HOUSING SET (UPPER/LOWER) | 1 | 1 | | H26 |
| 6-2 | 800200031 | CLUTCH DRUM | 1 | 1 | | F-4 |
| 6-3 | 800200004 | BEARING | 1 | 1 | 6002ZZ | |
| 6-4 | 800200006 | STOP RING | 1 | 1 | 15 | |
| 6-5 | 801667109 | CLUTCH HOUSING CORE | 1 | | 26 | F-18 |
| | 801666949 | | | 1 | 28 | F-19 |
| 6-6 | 801652132 | HOUSING DAMPER | 2 | 2 | | F-18 |
| 6-7 | 801652258 | HOUSING DAMPER | 2 | 2 | | F-18 |
| 6-8 | 800200032 | CAP BOLT | 2 | 2 | M5×30 | |
| 6-9 | 800200033 | CAP BOLT | 2 | 2 | M6×25 | |
| 6-10 | 800200034 | SCREW | 1 | 1 | M5×10 (+)2P | |
| 6-11 | 800200035 | BOLT | 1 | 1 | M6×30 (+)3P | |
| 7 | 800200035 | BOLT | 4 | 4 | M6×30 (+)3P | |
| 8 | 800201970 | SAFETY GUARD(prev.1675697) | 1 | 1 | | V26W |
| 9 | 800201974 | SAFETY GUARD ASSY | 1 | 1 | | |
| 9-1 | 800201971 | SAFETY GUARD(prev.1675698) | 1 | 1 | | |
| 9-2 | 800201973 | SCREW | 1 | 1 | | |
| 9-3 | 800200553 | NUT | 1 | 1 | | |
| 10 | 800201972 | CUTTER(prev.1675699) | 1 | 1 | | |
| 11 | 801675700 | SCREW | 2 | 2 | 4×12(+) | |
| 12 | 801675711 | SAFETY GUARD HOLDER | 1 | | 26 | V26W |
| 12 | 801675730 | SAFETY GUARD HOLDER | | 1 | 28 | V28W |
| 13 | 801675702 | SAFETY GUARD HOLDER | 1 | 1 | | V26W |
| 14 | 801675703 | CONNECTOR | 1 | 1 | | V26W |
| 15 | 800200012 | CAP BOLT | 1 | 1 | M5×20 | |
| 16 | 800200013 | CAP BOLT | 4 | 4 | M5×16 | |
| 17 | 801675712 | HANDLE HOLDER | 1 | 1 | | J28 |
| 18 | 801675713 | HANDLE HOLDER | 1 | 1 | | J28 |
| 19 | 801675714 | HANDLE HOLDER | 1 | 1 | | V26W |

| PARTS LIST MODEL:V262W,V282W | | | | | | |
|------------------------------|-----------|----------------------------------|------|------|----------|----------------|
| REF No. | CODE | NAME | QTY | | REMARKS | |
| | | | 262W | 282W | SIZE | ORIGINAL MODEL |
| 20 | 801675715 | HANDLE HOLDER | 1 | 1 | | V26W |
| 21 | 800200036 | HANDLE DAMPER | 1 | | | F-4 |
| | 800200069 | | | 1 | | F-5 |
| 22 | 800200037 | CAP BOLT | 1 | 1 | M8×50 | |
| 23 | 800200038 | CAP BOLT | 2 | 2 | M6×20 | |
| 24 | 800200039 | CAP BOLT | 2 | 2 | M6×25 | |
| 25 | 801675716 | HANDLE | 1 | 1 | | V26W |
| 26 | 801655825 | GRIP ASS'Y | 1 | 1 | | H26W |
| 26-1 | 801655775 | SCREW | 1 | 1 | M5×30(+) | |
| 26-2 | 800030080 | NUT | 1 | 1 | M5 | |
| 27 | 801675717 | HANDLE | 1 | 1 | | V26W |
| 28 | 801695932 | THROTTLE LEVER ASS'Y V262W/V282W | 1 | 1 | | V262W |
| 28-1 | 801655775 | SCREW | 1 | 1 | M5×30(+) | |
| 28-2 | 800030080 | NUT | 2 | 2 | M5 | |
| 29 | 801675722 | WIRE GUIDE | 1 | 1 | 19 | V28W |
| 30 | 801675723 | WIRE GUIDE | 2 | | 26 | V26W |
| | 801675731 | | | 2 | 28 | V28W |
| 32 | | LABEL | | | | |
| 33 | | LABEL | | | | |
| 34 | | LABEL | | | | |
| 35 | | LABEL | | | | |
| | | LABEL | | | | |
| 36 | | LABEL | | | | |
| 38 | | LABEL | | | | |
| | | LABEL | | | | |
| 39 | | LABEL | | | | |
| 40 | 801668671 | HARNESS ASS'Y | 1 | 1 | | J28 |
| 41 | 801666953 | PROTECTOR | 1 | 1 | | H28 |
| 43 | 800200023 | SPANNER | 1 | 1 | 10×8 | |
| 44 | 800200022 | SPANNER | 1 | 1 | 4 | |
| 45 | 800200042 | SPANNER | 1 | 1 | 5 | |
| 46 | 800200043 | SPANNER | 1 | 1 | 6 | |
| 48 | 801689082 | BAG | 1 | 1 | | |
| 49 | 800200025 | BAG | 1 | 1 | | |
| 50 | 800200026 | BAG | 1 | 1 | | |
| 51 | | MANUAL | | | | |
| 60 | | WIRE | | | | |
| 61 | | CONNECTOR | | | | |
| 62 | | CORD□ASS'Y | | | | |
| 63 | | SCREW | | | | |
| 64 | 800200112 | DRIVER | | | | H26WH |

| PARTS LIST MODEL:V262W,V282W | | | | | | |
|------------------------------|-----------|---------|------|------|---------|----------------|
| REF No. | CODE | NAME | QTY | | REMARKS | |
| | | | 262W | 282W | SIZE | ORIGINAL MODEL |
| 65 | 800200113 | SPANNER | | | 16×19 | H26WH |

