

REPAIR PARTS MANUAL
32" - 8 H.P. RIDING MOWER
MODEL 3554-50

WARRANTY

ONE YEAR LIMITED WARRANTY

For one (1) year from date of purchase by the first consumer for residential use (thirty (30) days commercial use), Western International Incorporated warrants that it will replace free of charge, including labor, any original part of any Western International Incorporated product found to be defective by any authorized Service Dealer or the factory, except the battery which is warranted for ninety (90) days from date of purchase.

This warranty does not cover engine, transmission, transaxle or differential (these items are covered by their manufacturer's own warranty). This warranty does not cover parts that have failed due to normal wear or parts that have failed subject to misuse or abuse. Transportation of the unit or part to and from an authorized Service Dealer or the factory is the responsibility of the owner.

A step by step explanation as to what procedure should be followed for this Warranty is:

1. If a part becomes defective, contact the store where the unit was purchased for the name and address of the authorized Service Dealer nearest to you.
2. If you cannot locate an authorized Service Dealer, write Service Department of Western International Incorporated for the name and address of the authorized Service Dealer in your area or call the Service Department at 1-800-247-7464 (outside Iowa), 1-515-265-3461 (Iowa).
3. Return the defective product, along with proof of purchase to such authorized Service Dealer for replacement of any defective part where covered by this warranty.

There is no other express warranty. Implied warranties, including those of merchantability and fitness for a particular purpose are limited to one (1) year from date of purchase. Liability for incidental or consequential damages are excluded.

Some states do not allow limitations on how long an implied warranty lasts, so the above limitation may not apply to you. Some states do not allow the exclusion of incidental or consequential damages, so the above exclusion may not apply to you. This warranty gives you specific legal rights, and you may have other rights which vary from state to state.

Western International Incorporated

P.O. Box 377

Des Moines, Iowa 50302

UNIT PARTS AND SERVICE

This manual contains repair parts information and instructions for safety. Read the operator's manual carefully and completely so that you will know proper assembly, use and care of your unit. Fill in and mail the registration card packed with the unit. For service other than covered in operator's manual, contact an authorized service dealer. A nationwide parts and service organization has been established to provide locally available parts and service. A list of authorized parts distributors has been included in this manual. When ordering repair parts, always give the following information: 1. The Part Name; 2. The Part Number; 3. The Quantity desired; 4. The Full (eight digit) Model Number of the unit. The model number will be found on a plate attached to the unit.



Look for this symbol. It means - ATTENTION! BECOME ALERT! A HAZARD TO OPERATOR, BYSTANDERS, PROPERTY OR EQUIPMENT MAY EXIST.

WESTERN INTERNATIONAL INCORPORATED
P.O. BOX 377
DES MOINES, IOWA 50302

Part No. 63054

0287

Price \$2.00

Printed in U.S.A.



OPERATIONAL PRECAUTIONS

THESE INSTRUCTIONS ARE FOR YOUR PROTECTION. PLEASE READ THEM CAREFULLY.



1. Know the controls and how to stop quickly. READ THIS OPERATOR'S MANUAL and instructions furnished with attachments.
2. Wear safety glasses or eye shields when assembling or operating riding mower.
3. Do not allow children to operate the machine. Do not allow adults to operate it without proper instruction.
4. Do not carry passengers. Do not mow when children and others are around. Disengage power to blade(s) or attachment(s) and stop the engine while others are in the vicinity of the mower.
5. Battery fluid (electrolyte) is an ACID and is extremely dangerous. Do not smoke while servicing the battery. Do not service battery near an open flame or spark.
6. Handle gasoline with care, it is highly flammable.
 - A. Use approved gasoline container.
 - B. Never remove the fuel cap of, or add gasoline to, a running or hot engine, or an engine that has not been allowed to cool for several minutes after running. Never fill the tank indoors and always clean up spilled gasoline immediately.
 - C. Do not smoke while filling fuel tank.
 - D. Do not run the engine indoors. Open doors if engine must be run in garage. Exhaust fumes contain CARBON MONOXIDE, an ODORLESS and DEADLY GAS.
7. Check fuel supply before each use allowing space for expansion as the heat of the engine and/or sun can cause gasoline to expand.
8. Do not operate mower when barefooted. Always wear substantial footwear, preferably steel-toed shoes. Do not wear loose fitting clothing that could get caught in moving parts.
9. Clear the work area of objects (wire, rocks, etc.) which might be picked up and thrown. Check all controls for proper function.
10. Disengage all attachment clutches, shift to neutral, and set parking brake before attempting to start the engine (motor). When starting engine equipped with a pull starter, stand firm and make sure your feet are well away from the blade(s).
11. Disengage power to blade(s) or other attachment(s) and stop the engine (motor) before leaving the operator's position. Always dismount from left side.
12. Disengage power to blade(s) or other attachment(s) and stop the engine (motor) before making any repairs or adjustments.
13. Disengage power to blade(s) or other attachment(s) when transporting or not in use.
14. Take all possible precautions when leaving the vehicle unattended, such as disengaging power to blade(s) or attachment(s), lower the attachment(s), setting the parking brake, stopping the engine (motor), and removing the key.
15. Do not stop or start suddenly when going uphill or downhill. Mow up and down the face of steep slopes; never across the face.
16. Reduce speed and exercise extreme caution on slopes and in sharp turns to prevent tipping or loss of control. Be especially cautious when changing direction on slopes.
17. Stay alert for holes, rocks, and roots in the terrain and other hidden hazards. Keep away from drop-offs. Never operate your riding mower on wet or slippery grass or at a speed which could cause a skid. Exercise care when mowing around a fixed object to prevent the blade(s) from striking it. Never deliberately run over any foreign object.
18. Always disengage blade control lever before attempting to remove the mower from a hole or other obstruction.
19. Use care when pulling loads or using heavy equipment.
 - A. Use only approved drawbar hitch points.
 - B. Limit loads to those you can safely control.
 - C. Do not turn sharply. Use care when backing.
 - D. Use counterweight(s), wheel weights or tire chains when suggested in attachment(s) instructions.
20. Watch for traffic when crossing or near roadways.
21. When using attachment(s), never direct discharge of material toward bystanders nor allow anyone near the vehicle while in operation.
22. Keep the vehicle and attachments in good operating condition, and keep safety devices in place and in working condition.
23. Keep all nuts, bolts, and screws tight to be sure the equipment is in safe working condition.
24. Never store the equipment with gasoline in the tank inside a building where fumes may reach an open flame or spark. Allow the engine to cool before storing in any enclosure.
25. To reduce fire hazard, keep the engine free of grass, leaves, or excessive grease.
26. The vehicle and attachments should be stopped and inspected for damage after striking a foreign object, and the damage should be repaired before restarting and operating the equipment.
27. Do not change the engine governor settings or overspeed engine.
28. When using the vehicle with mower, proceed as follows:
 - A. Mow only in daylight or in good artificial light.
 - B. Never make a cutting height adjustment while the engine (motor) is running if the operator must dismount to do so.
 - C. Shut the engine (motor) off when removing the grass catcher or unclogging chute.
 - D. Check the blade mounting bolts for proper tightness at frequent intervals.
29. Under normal usage, the grass catcher bag material is subject to deterioration and wear. Check bag frequently for deterioration and wear and replace worn bags. Check that replacement bags comply with the original manufacturer's recommendations or specifications.
30. Disengage power to mower before backing up. Do not mow in reverse unless absolutely necessary and then only after careful observation of the entire area behind the mower.

OWNER'S INFORMATION

Record the following information about your unit so that you will be able to provide it in case of loss or theft.

MODEL NUMBER: - (Enter complete 8 digit model number from model plate on unit)

PURCHASE DATE: ___/___/___ CODE NO. _____ SERIAL NO. _____

DEALER'S NAME AND ADDRESS _____

CITY _____ STATE _____ TELEPHONE _____

CONTENTS OF SHIPPING CARTON

- 1 - 32 inch Riding Mower
- 1 - Engine Manual (French)
- 1 - Owners Manual (French)
- 1 - Operators Manual (English)
- 1 - Repair Parts Manual (English)
- 1 - Steering Wheel (with roll pin partially installed)
- 1 - Seat
- 1 - Bag of Assembly Parts Containing:
 - 1 - Trough (oil drain)
 - 1 - Battery Hold-Down Bracket
- 2 - Battery Hold-Down Rods
- 1 - Bag of Battery Installation Parts Containing:
 - 2 - 1/4 inch Hex Nuts
 - 2 - 1/4 inch Split Lockwashers
 - 2 - 1/4 inch Flatwashers
- 1 - Bag of Battery Cable Installation Parts Containing:
 - 2 - 1/4 x 5/8 inch Hex Head Screws
 - 2 - 1/4 inch Keps Nuts
- 1 - Bag of Seat Assembly Parts Containing:
 - 4 - 5/16 x 1/2 inch Hex Head Screws
 - 4 - 5/16 inch Split Lockwashers

TOOLS REQUIRED FOR ASSEMBLY

- 1 - 1/2 inch Wrench (or adjustable wrench)
- 1 - 7/16 inch Wrench (or adjustable wrench)
- 1 - Hammer (plastic or rawhide preferred)

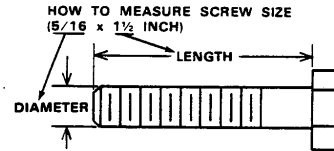

⚠ DANGER ⚠

This riding mower can be dangerous if carelessly used.

Read Owner's Manual thoroughly before operating riding mower.

Always wear safety glasses or eye shields while assembling or operating riding mower.

DO NOT carry passengers at any time.

Keep hands, feet, hair and loose clothing away from discharge area, underside of mower deck or any moving parts while engine is running.

DO NOT allow children or young teenagers to operate or be near riding mower while it is operating.

32" RIDING MOWER MODEL 3554-50

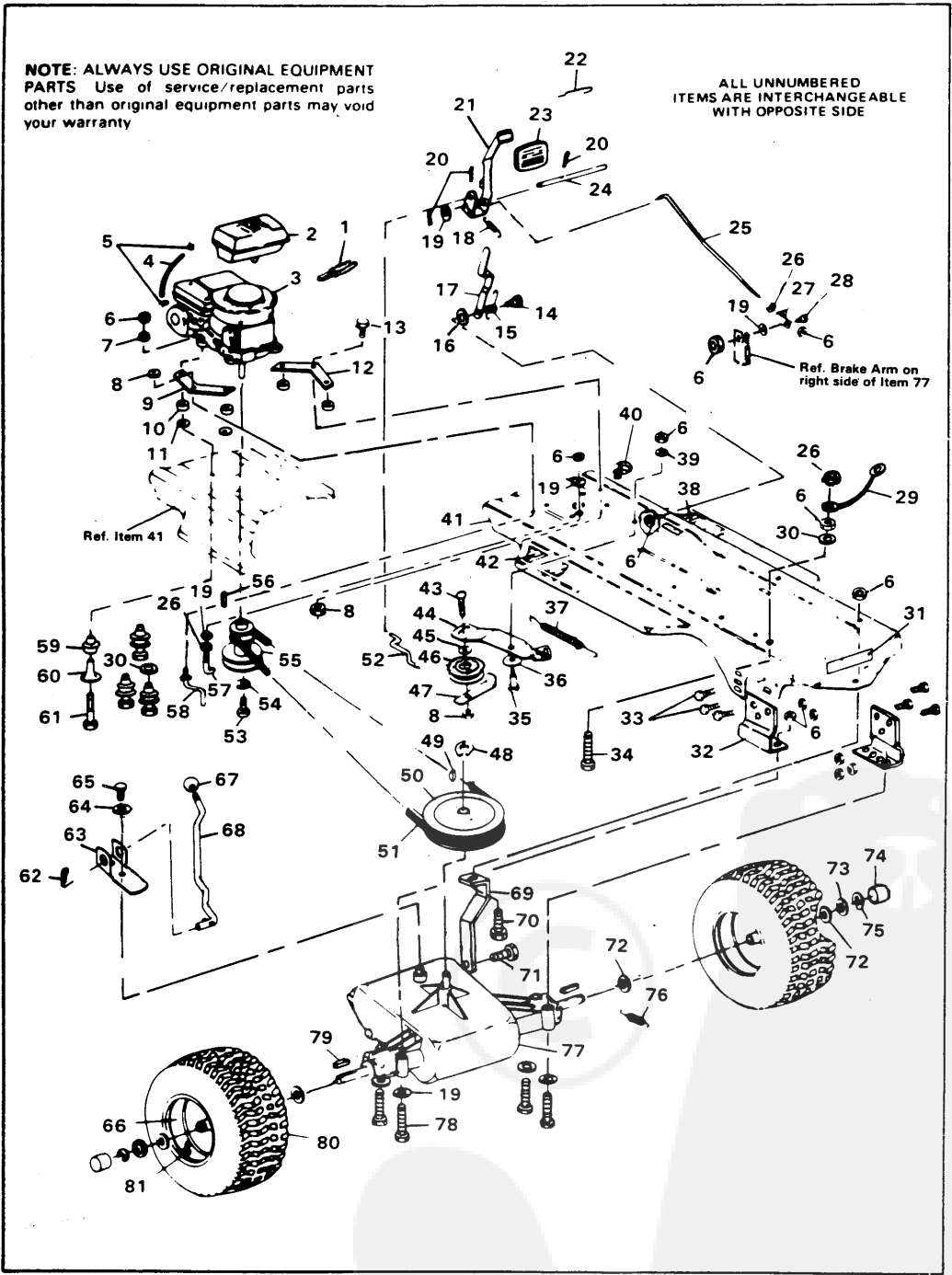

32" RIDING MOWER MODEL 3554-50

ALWAYS GIVE THE FOLLOWING INFORMATION WHEN ORDERING REPAIR PARTS

1 The PART NUMBER. 2 The PART NAME. 3 QUANTITY DESIRED. 4 The MODEL NUMBER (As shown on Model Plate)

SEND PART ORDERS AS PER INSTRUCTIONS ON THE FRONT PAGE

YOUR UNIT IS RIGHT HAND (RH) OR LEFT HAND (LH) AS YOU STAND BEHIND IT

DO NOT USE KEY NUMBERS WHEN ORDERING REPAIR PARTS. ALWAYS USE PART NUMBERS.

All replacement parts will be supplied in current production colors or in a neutral color.

A handling fee is applicable to small parts orders.

Key No.	Part No.	Description	Key No.	Part No.	Description
1	54873	Trough, Oil Drain	44	53762	Idler Arm
2	48812	Gas Tank	45	274517	Flatwasher, 25/64 In.
3	Engine	§See Footnote Below	46	35374	Pulley, Idler
4	48049	Gas Line	47	39659	Belt Retainer
5	41008	Clip, Gas Line	48	22053	Retaining Ring
6	9413447	Locknut, Hex 5/16-18 Thd.	49	3021	Key, Woodruff, No. 606
7	120638	Lockwasher, Split, 5/16 In.	50	55520	Pulley, Transaxle
8	9413534	Locknut, Hex, 3/8-16 Thd.	51	54758	V-Belt
9	43955	Vibration Bracket, L.H.	52	43980	Rod, Clutch
10	44015	Mount, Upper	53	123567	Screw, Hex Hd, 7/16-20 x 1 In.
11	138542	Washer, Shakeproof	54	120383	Lockwasher, Split, 7/16 In.
12	43954	Vibration Bracket, R.H.	55	55795	Pulley, Engine
13	180120	Screw, Hex Hd, 3/8-16 x 3/4 In.	56	33200	Key, Engine Pulley
14	40974	Shoulder Bolt, Parking Brake	57	49896	Belt Guide, Trans. Drive Belt
15	43968	Spring, Parking Brake	58	50653	Belt Guide, Blade Drive
16	32327	Wave Washer	59	44016	Mount, Lower
17	50980	Arm, Parking Brake	60	42273	Sleeve
18	50562	Spring, Clutch Pedal	61	180112	Screw, Hex Hd, 5/16-18 x 2 3/4 In.
19	120386	Flatwasher, 1/4 In.	62	137185	Pin, Cotter, 1/8 x 1 In.
20	121222	Pin, Cotter, 3/32 x 3/4 In.	63	56256	Shift Bracket
21	55722	Brake Pedal Assembly	64	57157	Washer
22	55025	Retainer, Brake Pad	65	56255	Screw, Nylock, 1/4-28 x 3/4 In.
23	53979	Rubber Pad, Brake Pedal	66	36182	Wheel
24	43956	Shaft, Brake-Clutch Pedal	67	55514	Knob, Gear Shift
25	54715	Rod, Brake	68	55526	Shift Lever
26	271184	Nut, Hex, Keps, 5/16-18 Thd.	69	54713	Bracket, Stabilizer
27	54723	Bracket, Brake Rod	70	122007	Screw, Hex Hd, 5/16-18 x 3/4 In.
28	20507	Shoulder Bolt	71	35498	Screw, Hex Wa. Tap, 5/16-18 x 3/4 In.
29	55511	Ground Wire	72	642	Flatwasher
30	138485	Washer, Shakeproof	73	42815	Flatwasher
31	68542	Decal, Caution	74	40394	Hub Cap
32	53768	Bracket, Axle	75	36625	"E" Ring
33	120228	Screw, Hex Hd, 5/16-18 x 5/8 In.	76	35410	Spring, Brake Return
34	122017	Screw, Hex Hd, 5/16-18 x 1 1/4 In.	77	Transaxle	†Peerless 3 speed Model 900
35	41890	Shoulder Bolt	78	180112	Screw, Hex Hd, 5/16-18 x 2 3/4 In.
36	4107	Washer	79	39628	Key, 3/16 x 3/16 x 2 1/2 In.
37	49276	Spring, Main Drive	80	42091	Tire
38	54618	Foot Pad, Right	81	24167	Valve Stem
39	45602	Washer	82	63019	Parts Manual (Not Illust.) (English)
40	54888	Retainer, Wire	83	63054	Operators Manual (Not Illust.) (English)
41	54749	Main Frame	84	63055	Owners Manual (Not Illust.) (French)
42	54955	Foot Pad, Left			
43	45892	Carriage Bolt, 3/8-16 x 1 1/2 In.			

32" RIDING MOWER MODEL 3554-50

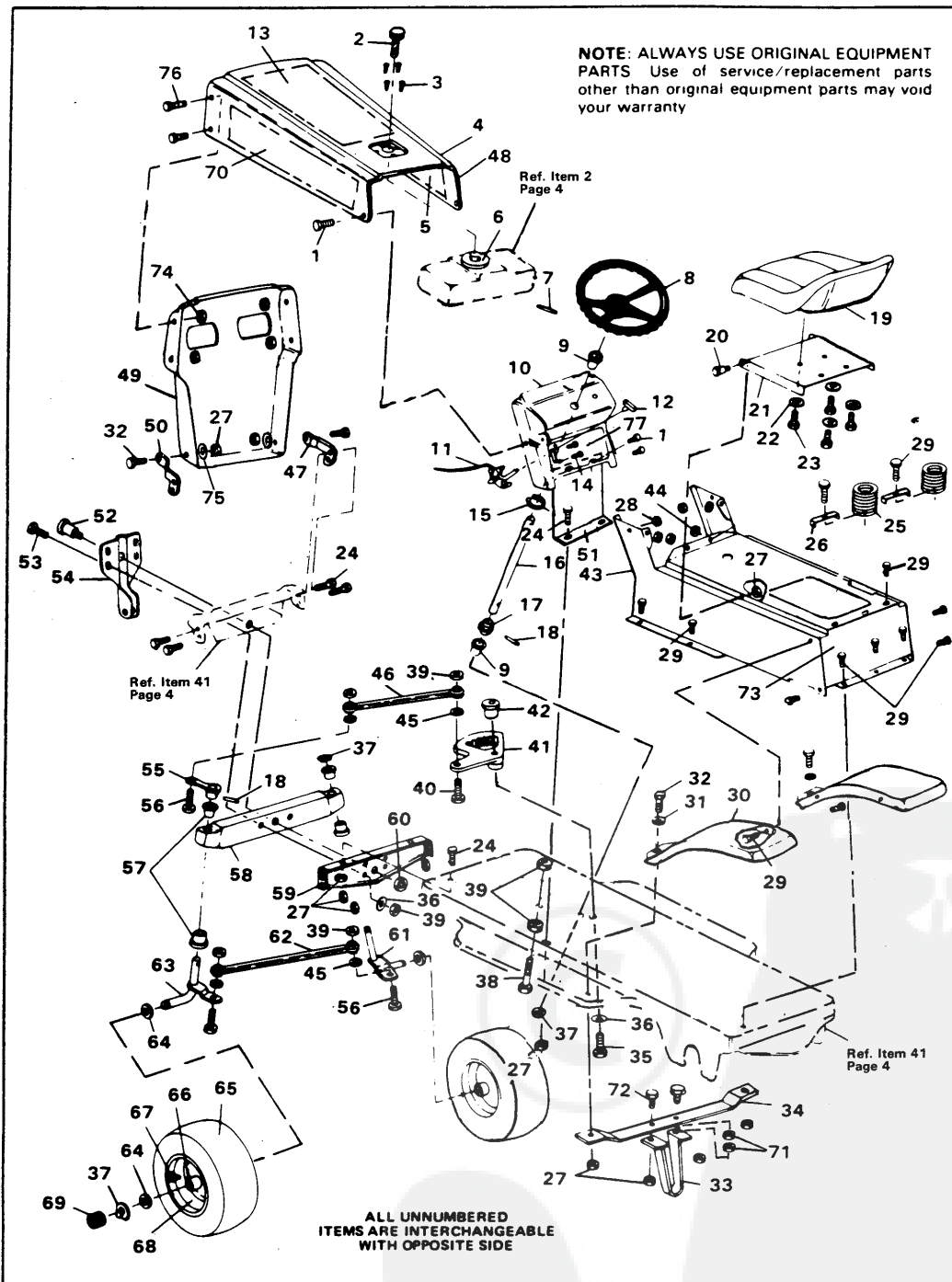

32" RIDING MOWER MODEL 3554-50

Key No.	Part No.	Description	Key No.	Part No.	Description
1	274672	Screw, Hex Hd, ¼-20 x ½ In.	39	9413534	Locknut, ¾-16 Thd.
2	50988	Gas Gauge	40	120918	Screw, Hex Hd, ¾-16 x 1½ In.
3	49050	Screw, Plastite, ¼-10 x ¾ In.	41	44010	Sector Gear
4	49615	Hood	42	44011	Shoulder Bolt, Sector Gear
5	55932	Foam Pad, Hood, R.H.	43	56226	Console Assembly
6	54885	Pad, Vibration	44	9424215	Locknut, Hex, ¼-20 Thd.
7	456836	Spring Pin, ¼ x 2¼ In.	45	120382	Lockwasher, Split, ¾ In.
8	55633	Steering Wheel	46	55513	Drag Link Assembly
9	54902	Bearing, Steering	47	49040	Bracket, Grille Support, R.H.
10	55564	Dash Assembly	48	45608	Edging, Hood
11	50117	Lever, Throttle Control	49	56672	Grille
12	39486	Knob, Throttle Control Lever	50	49041	Bracket, Grille Support, L.H.
13	55930	Foam Pad, Hood, Top	51	55537	Bulkhead, Console
14	35287	Screw, Taptite, No. 8-32 x ¾ In.	52	50720	Shoulder Bolt Axle Pivot
15	39492	Retaining Ring	53	122201	Screw, Hex Hd, ¾-16 x 2¾ In.
16	44008	Shaft, Steering	54	56261	Bracket, Deck Hanger
17	44009	Pinion Gear	55	49447	Arm, Steering
18	454565	Roll Pin	56	122145	Screw, Hex Hd, ¾-16 x 1¼ In.
19	57500	Seat	57	50546	Bearing, Spindle
20	20507	Shoulder Bolt	58	56400	Front Axle Assembly
21	57417	Seat Bracket	59	56362	Bracket, Front Axle Support
22	120638	Lockwasher, Split, 5/16 In.	60	274654	Locknut, Hex, ¼-20 Thd.
23	120834	Screw, Hex Hd, 5/16-18 x 1½ In.	61	55870	Spindle, Right
24	120228	Screw, Hex Hd, 5/16-18 x ¾ In.	62	55512	Tie Rod
25	56220	Spring, Seat	63	55869	Spindle, Left
26	56060	Clip, Seat Spring	64	642	Flatwasher, ¾ In.
27	9413447	Locknut, Hex, 3/16-18 Thd.	65	41096	Tire
28	51335	Locknut, Wide Flange, ¼-20 Thd.	66	39979	Bearing
29	995346	Screw, Taptite, ¼-20 x ½ In.	67	24167	Valve Stem
30	43970	Fender	68	39937	Wheel w/Bearing
31	446363	Flatwasher, 5/16 In.	69	40394	Hub Cap
32	122017	Screw, Hex Hd, 5/16-18 x 1 In.	70	55931	Foam Pad, Hood, L.H.
33	44500	Bracket, Deck Guide	71	120377	Nut, Hex, ¾-16 Thd.
34	43964	Bracket, Deck Guide Support	72	122040	Screw, Hex Hd, 5/16-18 x 1½ In.
35	39573	Screw, Hex Hd, Lock, ¾-24 x 1 In.	73	56235	Cover, Console, Rear
36	2483	Spring Washer	74	50352	Locknut, Flange, ¼-20 Thd.
37	36625	"E" Ring	75	120386	Flatwasher, 5/16 In.
38	49930	Upstop Bolt	76	273243	Screw, Hex Hd, ¼-20 x ¾ In.
			77	70600	Decal, Dash, Lower

32" RIDING MOWER MODEL 3554-50

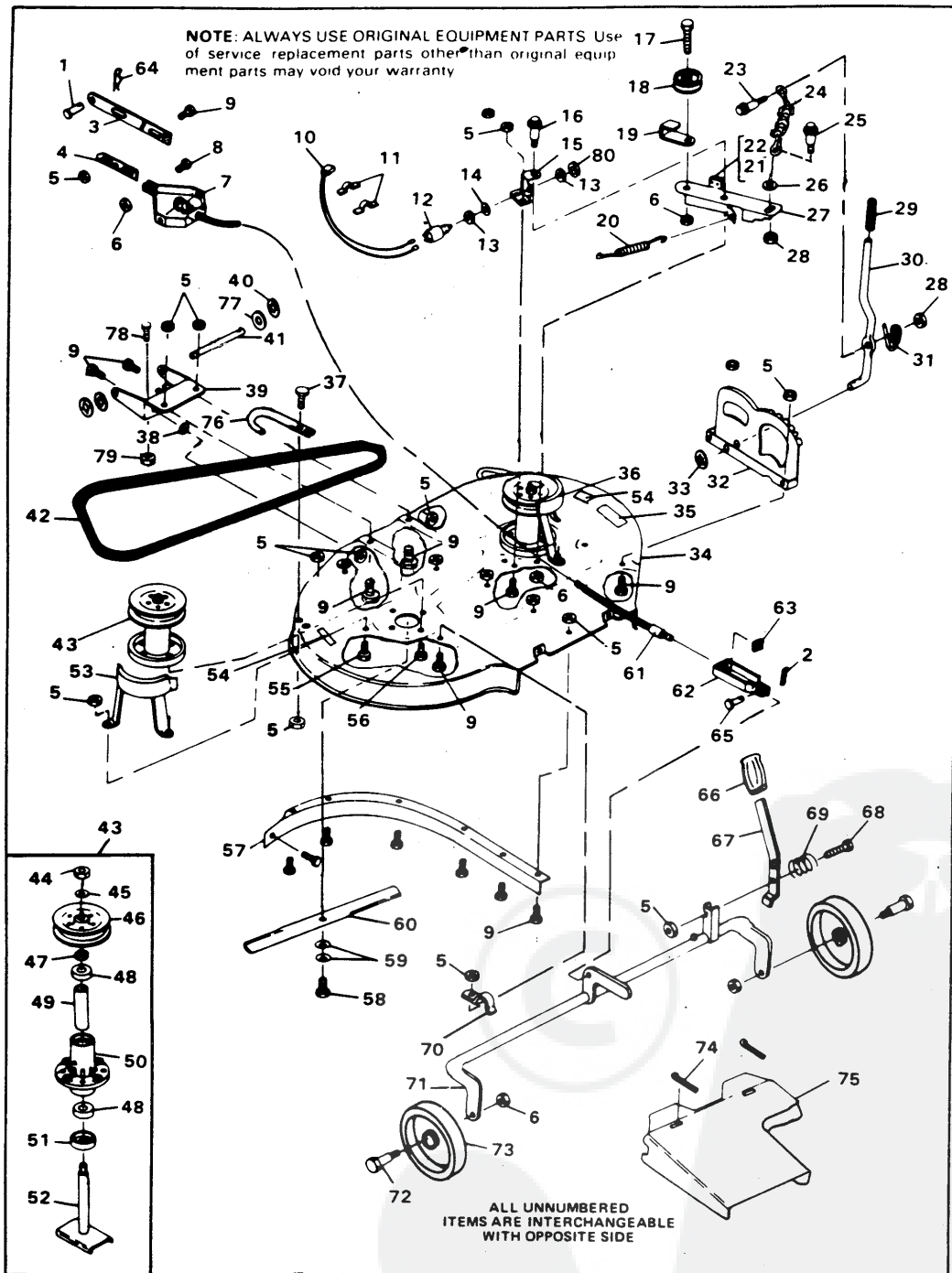

32" RIDING MOWER MODEL 3554-50

Key No.	Part No.	Description	Key No.	Part No.	Description
1	47816	Pull Pin	41	55724	Pin, Pivot
2	8260	Hairpin Cotter	42	47390	V-Belt
3	49059	Bar Hitch	43	56283	†Quill Assy. (Incl. Nos. 44-52)
4	49058	Lock Bracket	44	51445	Locknut, Flange
5	9413447	Locknut, 5/16-18 Thd.	45	56365	Flatwasher
6	9413534	Locknut, 3/8-16 Thd.	46	56391	Pulley
7	50613	Pivot Bracket	47	56280	Spacer
8	120918	Screw, Hex Hd, 3/8-16 x 1 1/2 In.	48	49562	Bearing
9	120228	Screw, Hex Hd, 5/16-18 x 3/8 In.	49	50818	Spacer, Tube
10	43038	Assembly	50	55547	Quill
11	41482	Clip, Press	51	50616	Dust Shield
12	41204	Switch, Lockout	52	56623	Saddle and Shaft Assembly
13	45877	Nut (Lockout Switch Part)	53	47353	Cover, Pulley, L.H.
14	45878	Lockwasher (Lockout Switch Part)	54	68542	Decal, Caution
15	47517	Bracket, Idler Arm	55	122017	Screw Hex Hd, 5/16-18 x 1 In.
16	47516	Shoulder Bolt	56	50634	Screw, Tapite, 5/16-18 x 3/8 In.
17	122168	Screw, Hex Hd, 3/8-16 x 1 3/8 In.	57	47354	Baffle, L.H.
18	52694	Pulley, Idler	58	39573	Screw, Hex Hd, 3/8-24 x 1 In.
19	52695	Belt Retainer	59	2483	Formed Washer
20	35410	Spring	60	56820	Blade, 16 In.
21	41601	Rivet, Brake Pad	61	55880	Lift Cable
22	41471	Brake Pad	62	39404	Clevis, Lift Cable
23	53696	Shoulder Bolt	63	120372	Nut, Square, 1/4-20 Thd.
24	47357	Spring, Clutch Lever	64	56180	Hairpin Cotter
25	46563	Shoulder Bolt	65	39522	Pin, Clevis
26	120392	Flatwasher, 9/32 In.	66	20250	Hand Grip
27	53055	Idler Arm Assy. (Incl. Nos. 21 & 22)	67	49131	Lever, Height Adjustment
28	9424215	Locknut, 1/4-20 Thd.	68	120696	Screw, Hex Hd, 5/16-18 x 2 1/4 In.
29	46478	Grip, Clutch Lever	69	53246	Spring
30	53693	Lever, Clutch	70	51985	Support, Pivot Tube
31	46561	Spring, Clutch Lever	71	54606	Pivot Tube Assembly
32	53247	Quadrant	72	23763	Wheel Axle
33	53697	Push Nut	73	52584	Wheel Assy., Deck
34	51948	Mower Deck	74	120123	Pin, Cotter, 1/8 x 1 1/4 In.
35	68882	Decal, Height Adjust	75	54528	Chute Extension
36	47352	Cover, Pulley, R.H.	76	51921	Skid
37	122007	Screw, Hex Hd, 5/16-18 x 3/4 In.	77	996425	Flatwasher
38	996416	Flatwasher, 3/8 In.	78	55686	Screw, Mach., 1/4-20 x 3/8 In.
39	48676	Lift Support, Plate Assembly	79	271172	Keys Nut, 1/4-20 Thd.
40	20864	"E" Ring	80	56635	Nut, Hex

32" RIDING MOWER MODEL 3554-50

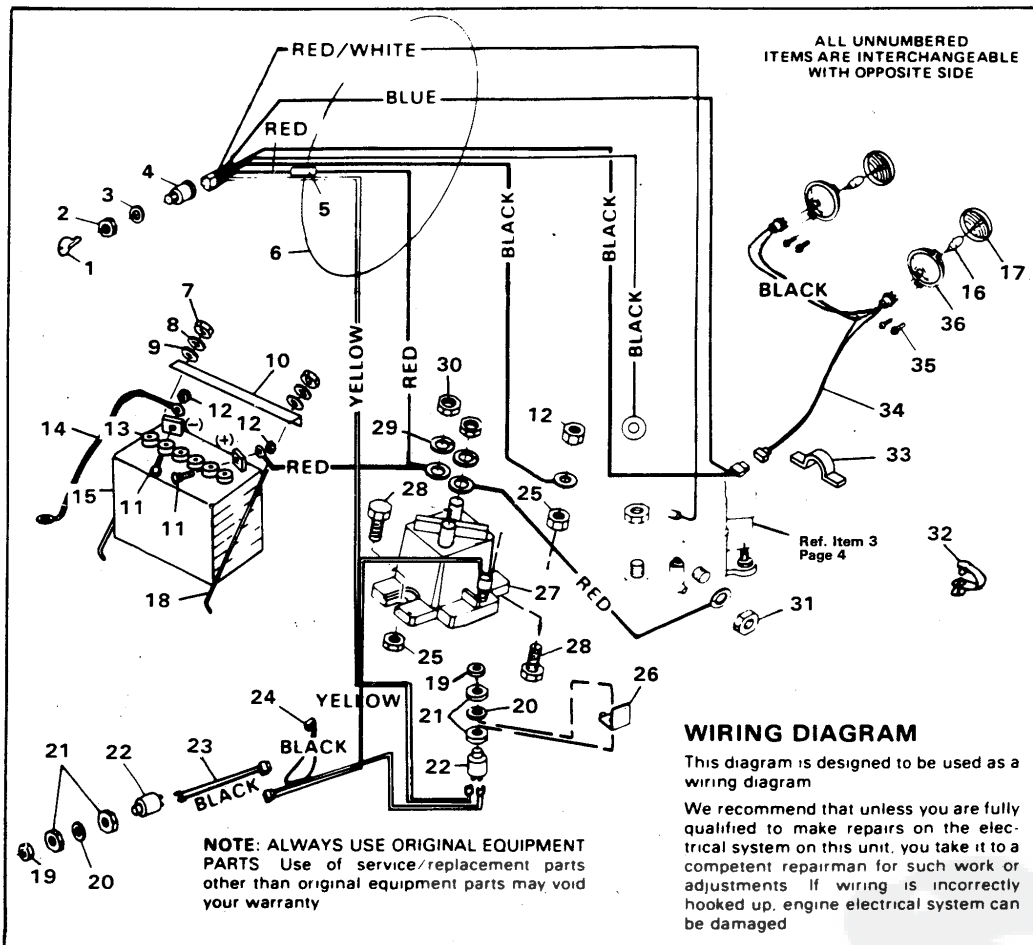

Key No.	Part No.	Description	Key No.	Part No.	Description
1	49643	Key, Ignition	20	45878	Lockwasher (Lockout Switch Part)
2	48140	Locknut (Switch Part)	21	45877	Nut (Lockout Switch Part)
3	138557	Lockwasher (Switch Part)	22	41204	Switch, Lockout
4	52583	Switch, Ignition w/Keys	23	43038	Wire Assembly, Deck Switch
5	49211	Fuse	24	42071	Wire Assembly, By-Pass
6	55528	Wire Harness Assembly	25	9424215	Locknut, Hex, 1/4-20 Thd.
7	120375	Nut, Hex, 1/4-20 Thd.	26	49734	Bracket, Switch Mounting
8	120380	Lockwasher, Split	27	53716	Solenoid
9	120392	Flatwasher	28	187745	Screw, Hex Hd, 1/4-20 x 3/4 In.
10	56360	Bracket, Battery, Hold-Down	29	138485	Washer, Shakeproof, 5/16 In.
11	120854	Screw, Hex Hd, 1/4-20 x 5/8 In.	30	120368	Locknut, Hex, 5/16-24 Thd.
12	271172	Nut, Keps, 1/4-20 Thd.	31		Engine Part
13	40892	Cap. Battery	32	54888	Retainer, Wire
14	55511	Ground Wire	33	41482	Wire Clip, Press
15	52936	Battery	34	56189	Lead Wire, Headlight
16	52572	Bulb, Headlight	35	50668	Screw, Hex Wa. Tap, No. 10-14 x 1/2 In.
17	52570	Lens, Headlight	36	52571	Bezel, Headlight
18	40234	Battery Rod			
19	56635	Nut, Hex			