

## REPAIR PARTS MANUAL 39" - 12 H.P. RIDING MOWER MODEL 3560-2200

### ONE YEAR LIMITED WARRANTY

For one (1) year from date of purchase by the first consumer for residential use (thirty (30) days commercial use) NOMA Outdoor Products Incorporated warrants that it will replace free of charge, including labor, any original part of any NOMA Outdoor Products Incorporated product found to be defective by any authorized Service Dealer or the factory, except the battery which is warranted for ninety (90) days from date of purchase.

This warranty does not cover engine, transmission, transaxle or differential (these items are covered by their manufacturer's own warranty). This warranty does not cover parts that have failed due to normal wear or parts that have failed subject to misuse or abuse. Transportation of the unit or part to and from an authorized Service Dealer or factory is the responsibility of the owner.

A step by step explanation as to what procedure should be followed for this Warranty is:

1. If a part becomes defective, contact the store where the unit was purchased for the name and address of the authorized Service Dealer nearest to you.
2. If you cannot locate an authorized Service Dealer, write Service Department of NOMA Outdoor Products Incorporated for the name and address of the authorized Service Dealer in your area or call the Service Department at 1-901-422-1690.
3. Return the defective product, along with proof of purchase to such authorized Service Dealer for replacement of any defective part where covered by this warranty.

There is no other express warranty. Implied warranties, including those of merchantability and fitness for a particular purpose are limited to one (1) year from date of purchase. Liability for incidental or consequential damages are excluded.

Some states do not allow limitations on how long an implied warranty lasts, so the above limitation may not apply to you. Some states do not allow the exclusion of incidental or consequential damages, so the above exclusion may not apply to you. This warranty gives you specific legal rights, and you may have other rights which vary from state to state.

NOMA Outdoor Products Incorporated      Caller 8000      Jackson, TN 38308-8000

### UNIT PARTS AND SERVICE

This manual contains instructions for safety, assembly and maintenance. Read this manual carefully and completely so that you will know proper assembly, use and care of your unit. Also fill in and mail the registration card packed with the unit. For service other than covered in this manual, contact an authorized service dealer. A nationwide parts and service organization has been established to provide locally available parts and service. A list of authorized parts distributors has been included in this manual. When ordering repair parts, always give the following information: 1. The Part Name; 2. The Part Number; 3. The Quantity desired; 4. The Full (eight digit) Model Number of the unit. The model number will be found on a plate attached to the unit.

Look for this symbol.



It means - ATTENTION! BECOME ALERT! A HAZARD TO OPERATOR, BYSTANDER, PROPERTY OR EQUIPMENT MAY EXIST.

NOMA Outdoor Products Incorporated  
Caller 8000  
Jackson, TN 38308-8000

Part No. 311246

3889



## OPERATIONAL PRECAUTIONS



THESE INSTRUCTIONS ARE FOR YOUR PROTECTION. PLEASE READ THEM CAREFULLY.

1. Know the controls and how to stop quickly. READ THIS OPERATOR'S MANUAL and instructions furnished with attachments.
2. Wear safety glasses or eye shields when assembling or operating riding mower.
3. Do not allow children to operate the machine. Do not allow adults to operate it without proper instruction.
4. Do not carry passengers. Do not mow when children and others are around. Disengage power to blades(s) or attachment(s) and stop the engine while others are in the vicinity of the mower.
5. Battery fluid (electrolyte) is an ACID and is extremely dangerous. Do not smoke while servicing the battery. Do not service the battery near a open flame or spark.
6. Handle gasoline with care, it is highly flammable.
  - A. Use approved gasoline container.
  - B. Never remove the fuel cap or, or add gasoline to, a running or hot engine, or an engine that has not been allowed to cool for several minutes after running. Never fill the tank indoors and always clean up spilled fuel immediately.
  - C. Do not smoke while filling fuel tank.
  - D. Do not run the engine indoors. Open doors if engine must be run in garage. Exhaust fumes contain CARBON MONOXIDE, an ODORLESS and DEADLY GAS.
7. Check fuel supply before each use allowing space for expansion as the heat of the engine and/ or sun can cause gasoline to expand.
8. Do not operate mower when barefooted. Always wear substantial footwear, preferably steel-toed shoes. Do not wear loose fitting clothing that could get caught in moving parts.
9. Clear the work area of objects (wire, rocks, etc.) which might be picked up and thrown. Check all controls for proper function.
10. Disengage all attachment clutches, shift to neutral, and set parking brake before attempting to start the engine (motor). When starting engine equipped with a pull starter, stand firm and make sure your feet are well away from the blade(s).
11. Disengage power to blade(s) or other attachment(s) and stop the engine (motor) before leaving the operator's position. Always dismount from the left side.
12. Disengage power to blade(s) or other attachment(s) and stop the engine (motor) before making any repairs or adjustments.
13. Disengage power to blade(s) or other attachment(s) when transporting or not in use.
14. Take all possible precautions when leaving the vehicle unattended, such as disengaging power to blade(s) or attachment(s), lower the attachment(s), setting the parking brake, stopping the engine (motor), and removing the key.
15. Do not stop or start suddenly when going uphill or downhill. Mow up and down the face of steep slopes; never across the face.
16. Reduce speed and exercise extreme caution on slopes and in sharp turns to prevent tipping or loss of control. Be especially cautious when changing direction on slopes.
17. Stay alert for holes, rocks, and roots in the terrain and other hidden hazards. Keep away from drop-off. Never operate your riding mower on wet or slippery grass or at a speed which could cause a skid. Exercise care when mowing around a fixed object to prevent the blade(s) from striking it. Never deliberately run over any foreign object.
18. Always disengage blade control lever before attempting to remove the mower from a hole or other obstruction.
19. Use care when pulling loads or using heavy equipment.
  - A. Use only approved drawbar hitch points.
  - B. Limit loads to those that you can safely control.
  - C. Do not turn sharply. Use care when backing.
  - D. Use counterweight(s), wheel weights or tire chains when suggested in attachment(s) instructions.
20. Watch for traffic when crossing or near roadways.
21. When using attachment(s), never direct discharge of material toward bystanders nor allow anyone near the vehicle while in operation.
22. Keep the vehicle and attachments in good operating condition, and keep safety devices in place and in working condition.
23. Keep all nuts, bolts, and screws tight to be sure the equipment is in safe working condition.
24. Never store the equipment with gasoline in the tank inside a building where fumes may reach an open flame or spark. Allow the engine to cool before storing in any enclosure.
25. To reduce fire hazard, keep the engine free of grass, leaves or excessive grease.
26. The vehicle and attachments should be stopped and inspected for damage after striking a foreign object, and the damage should be repaired before restarting and operating the equipment.
27. Do not change the engine governor settings or over-speed engine.
28. When using the vehicle with mower, proceed as follows:
  - A. Mow only in daylight or in good artificial light.
  - B. Never make a cutting height adjustment while the engine (motor) is running if the operator must dismount to do so.
  - C. Shut the engine (motor) off when removing the grass catcher or unclogging chute.
  - D. Check the blade mounting bolts for proper tightness at frequent intervals.
29. Under normal usage, the grass catcher bag material is subject to deterioration and wear. Check the bag frequently for deterioration and wear and replace worn bags. Check that replacement bags comply with the original manufacturer's recommendations or specifications.
30. Disengage power to mower before backing up. Do not mow in reverse unless absolutely necessary and then only after careful observation of the entire area behind the mower.

### OWNER'S INFORMATION

Record the following information about your unit so that you will be able to provide it in case of loss or theft.

MODEL NUMBER:     -     (Enter complete 8 digit number from model plate on unit)

PURCHASE DATE: \_\_\_ / \_\_\_ / \_\_\_ CODE NO.: \_\_\_\_\_ SERIAL NO.: \_\_\_\_\_

DEALER'S NAME AND ADDRESS: \_\_\_\_\_

CITY: \_\_\_\_\_ STATE: \_\_\_\_\_ TELEPHONE: \_\_\_\_\_

### CONTENTS OF SHIPPING CARTON

- 1 - 39 inch Riding Mower
- 1 - Operator's Manual
- 1 - Repair Parts Manual
- 1 - Engine Manual
- 1 - Steering Wheel
- 1 - Seat
- 1 - Chute Deflector
- 1 - Battery
- 1 - Bag of Assembly Parts Containing:
  - 1 - Torsion Spring
  - 1 - Oil Trough
- 1 - Bag of Battery Hold-Down Parts Containing:
  - 1 - Flatwasher
  - 1 - Split Lockwasher
  - 1 - 1/4 inch Hex Nut
- 1 - Bag of Battery Cable Installation Parts Containing:
  - 2 - 1/4 x 5/8 inch Hex Head Screws
  - 2 - 1/4 inch Keys, Nuts (star washer attached)
  - 1 - Chute Pivot Rod
  - 1 - Battery Rod
  - 1 - Battery Rod Top
- 1 - Bag of Seat Mounting Parts Containing:
  - 4 - 5/16 x 3/4 inch Hex Head Screws
  - 4 - 5/16 inch Split Lockwashers
  - 4 - 11/32 inch Flatwashers

### TOOLS REQUIRED FOR ASSEMBLY

- 1 - 1/4 inch Wrench (or adjustable wrenches)
- 1 - 5/16 inch Wrench (or adjustable wrench)
- 1 - 11/32 inch Wrench (or adjustable wrench)
- 1 - Hammer (plastic or rawhide preferred)

### HOW TO MEASURE SCREW SIZE (5/16 x 1 1/2 INCH)

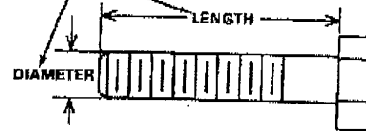

**! DANGER !**

This riding mower can be dangerous if carelessly used.

Read Owner's Manual thoroughly before operating riding mower.

Always wear safety glasses or eye shields while assembling or operating riding mower.

**DO NOT** carry passengers at any time.

Keep hands, feet, hair and loose clothing away from discharge area, underside of mower deck or any moving parts while engine is running.

**DO NOT** allow children or young teenagers to operate or be near riding mower while it is operating.

**NOTICE**

For packaging purposes, the knob was removed from the mower clutch lever and placed in parts bag.

Please screw knob onto mower clutch lever and tighten securely.

# REPAIR PARTS

## 39" RIDING MOWER MODEL A3560-2200

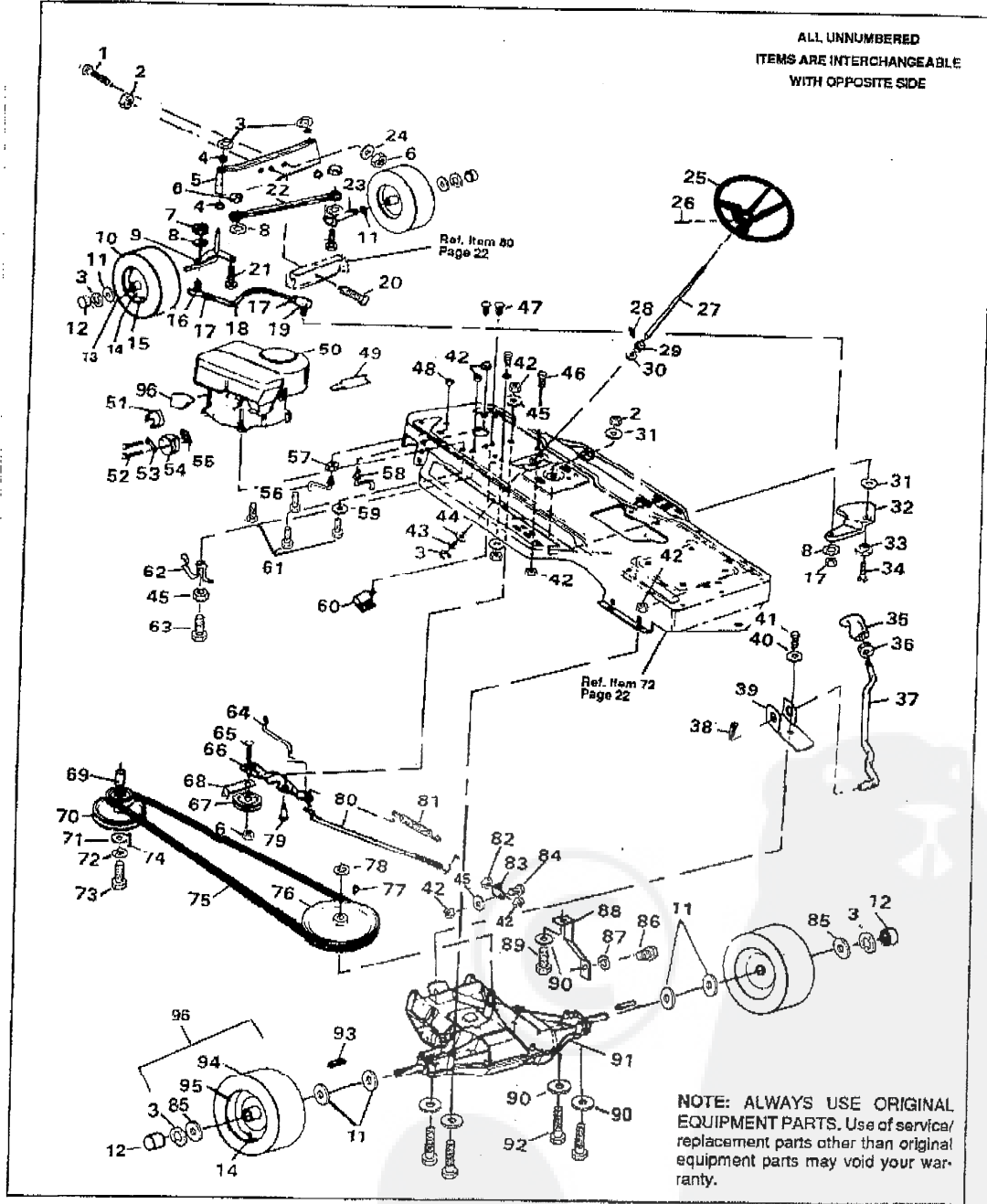

Mar 31 03 03:34p Murray, Inc.

6153736798

P.7

## 39" RIDING MOWER MODEL A3560-2200

Key No.	Part No.	Description	Key No.	Part No.	Description
1	122207	* Screw, Hx Hd, 3/8-16 x 3 In.	51	54767	Heat Shield, Muffler
2	1500	Locknut, 1/2-13 Thd.	52	173063	Screw, Hx Hd, 5/16-18 x 3-1/2 In.
3	38625	"E" Ring	53		Engine Part
4	52407	Bearing, Front Spindle	54	305367	Muffler
5	55730	Front Axle	55	46708	Gasket, Muffler
6	1499	Locknut, 3/8-16 Thd.	56	300635	Belt Guide
7	120369	* Nut, Hx, 3/8-24 Thd.	57	271190	* Nut, Keps, 3/8-16 Thd.
8	120382	* Lockwasher, Split, 3/8 In.	58	300440	Belt Guide
9	302925	Front Spindle Assembly, L. H.	59	138489	Star Washer
10	301140	Tire Assembly, Front	60	57476	Switch
11	642	Flatwasher, 3/4 In.	61	50947	Screw, Tapitite, 3/8-16 x 1-1/4 In.
12	40394	Hub Cap	62	58356	Belt Guide
13	39979	Bearing, Front Wheels	63	180079	* Screw, Hx Hd, 5/16-18 x 1 In.
14	24167	Valve Stem	64	57204	Rod, Clutch
15	39829	Wheel w/Bearing, Front	65	45892	Carriage Bolt, Rd Hd, 3/8-16x1-1/2 In.
16	21275	Ball Joint	66	300154	Idler Arm
17	46692	* Nut, Hx, 3/8-24 Thd.	67	303031	Pulley, Idler
18	58291	Steering Link	68	39659	Belt Retainer
19	57158	Ball Joint	69	304246	Spacer
20	58246	Shoulder Bolt, Front Axle Pivot	70	58361	Pulley
21	180128	* Screw, Hx Hd, 3/8-16 x 1-3/4 In.	71	56431	Washer, Pilot
22	304590	Tie Rod Assembly	72	120389	* Lockwasher, Split, 7/16 In.
23	302926	Front Spindle Assembly, R. H.	73	428644	* Screw, Hx Hd, 7/16-20 x 5 In.
24	2483	Spring Washer	74	57791	Key
25	301251	Steering Wheel	75	57214	V-Belt
26	456370	* Roll Pin, 1/4 x 2 In.	76	302745	Pulley
27	58243	Shaft, Steering	77	3021	Key, Woodruff
28	58274	Pin, Dowel	78	22053	Retaining Ring
29	58244	Pinion, Steering	79	300799	Shoulder Bolt
30	301410	Bushing	80	57203	Brake Rod
31	22265	Washer, 1/2 In.	81	58359	Spring, Clutch
32	58289	Sector Gear	82	271184	* Nut, Keps, 5/16-18 Thd.
33	52406	Eccentric	83	57217	Bracket, Brake Rod
34	180177	* Screw, Hx Hd, 1/2-13 x 1-1/2 In.	84	20507	Shoulder Bolt
35	304438	Knob, Gear Shift	85	42815	Flatwasher, 3/4 In.
36	120298	Jam Nut, 1/2-13 Thd.	86	35498	Screw, Tapitite, 5/16-18 x 3/4 In.
37	302743	Shift Lever	87	120386	* Lockwasher, Split, 5/16 In.
38	137185	* Pin, Cotter, 1/8 x 1 In.	88	12632	Stabilizing Bracket
39	57480	Shift Bracket	89	122017	* Screw, Hx Hd, 5/16-18 x 1 In.
40	57157	Washer	90	120393	* Flatwasher, 11/32 In.
41	56255	Screw, Hx Hd, 1/4-20 x 3/4 In.	91	Transaxle	* Peerless 5 speed, Model 920-019
42	1498	Locknut, 5/16-18 Thd.	92	180089	* Screw, Hx Hd, 5/16-18 x 2-1/4 In.
43	21682	Washer, 3/4 In.	93	39628	Key, 3/16 x 3/16 x 2-3/4 In.
44	301398	Washer	94	57164	Tire, Rear
45	45602	Washer, 5/16 In.	95	57165	Wheel, Rear
46	120229	* Screw, Hx Hd, 5/16-18 x 7/8 In.	96	302967	Speed Reducer
47	57220	Screw, Tapitite	97	12529	Owner's Manual (Not Illus.) (Eng.)
48	124824	Jam Nut, 5/16-18 x 5/8 In.	98	311246	Parts Manual
49	54873	Trough, Oil Drain			
50	Engine	See Engine Manual			

(\*) Standard hardware items - May Be Purchased Locally.

### 39" RIDING MOWER MODEL A3560-2200

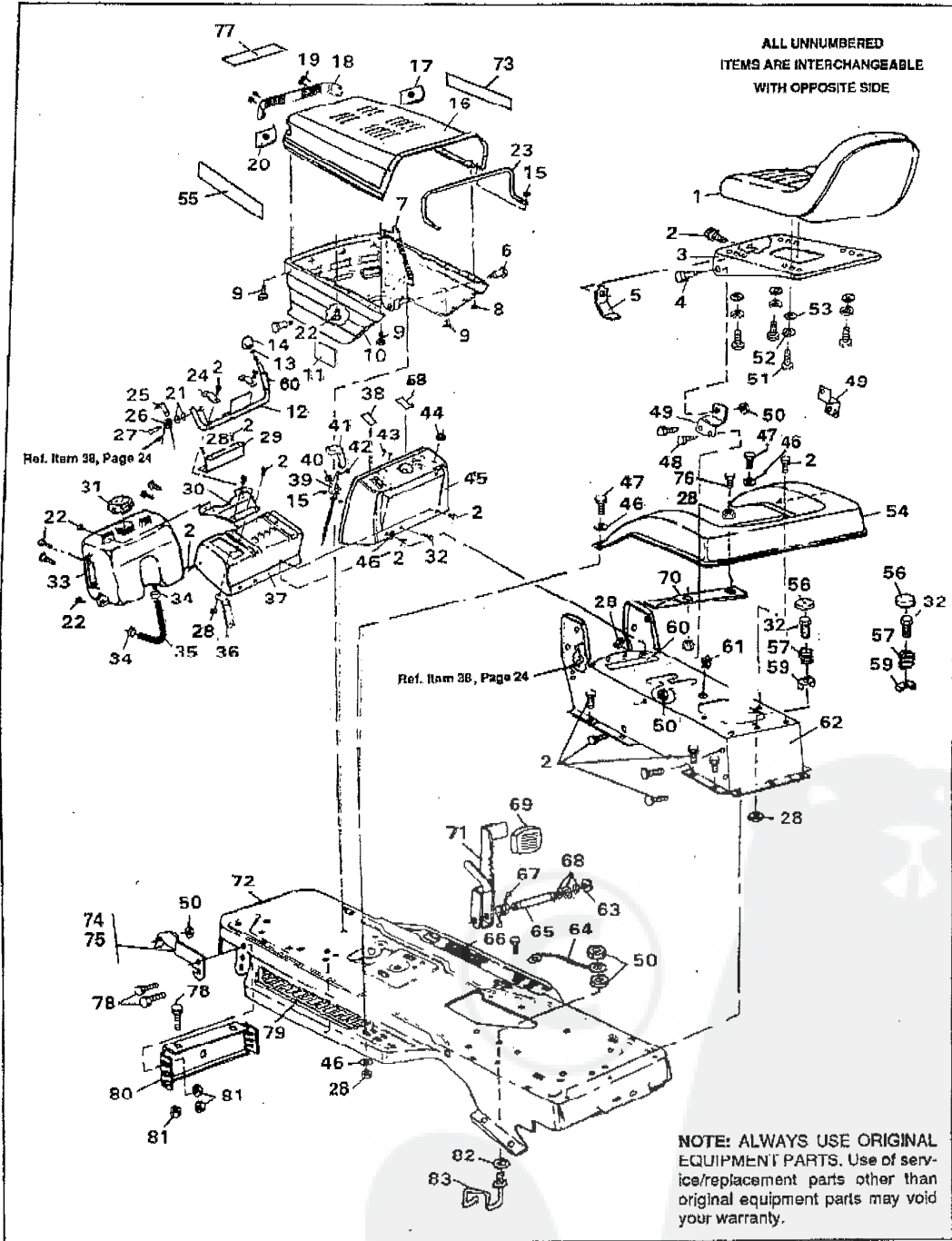



39" RIDING MOWER MODEL A3560-2200

Key No.	Part No.	Description	Key No.	Part No.	Description
1	307661	Seat	46	120386	Flatwasher
2	995346	* Screw, Tapite, 1/4-20 x 1/2 In.	47	122017	* Screw, Hex Hd, 5/16-18 x 1 In.
3	307024	Mounting Bracket, Seat	48	120228	* Screw, Hex Hd, 5/16-18 x 5/8 In.
4	20507	Shoulder Bolt	49	311249	Bracket, Support
5	58277	Bracket, Seat Switch	50	1498	Locknut, 5/16-18 Thd.
6	56676	Shoulder Bolt	51	122007	* Screw, Hex Hd, 5/16-18 x 3/4 In.
7	57478	Spring, Hood	52	120638	* Lockwasher, Split, 5/16 In.
8	301542	Screw, Hex Hd, No. 10-24 x 1 In.	53	120393	* Flatwasher, 11/32 In.
9	300302	Screw, Tapite No. 10-24 x 1/2 In.	54	307365	Fender Assembly
10	303037	Grille, Lower	55	305603	Foam Pad, L.H.
11	301452	Decal, Heat Reflector	56	56907	Cover, Spring
12	9752	Lever, Mower Drive Control	57	57153	Spring, Seat
13	120238	Jam Nut, 1/2-13 Thd.	58	300445	Decal, Dash R.H.
14	304438	Knob	59	1341	Clamp, Seat Spring
15	271166	Locknut, No. 10 24 Thd.	60	302445	Shift Tube
16	307035	Hood	61	57547	Switch
17	301540	Reflector, Headlight, R. H.	62	311242	Console
18	302333	Lens, Headlight	63	20664	Retaining Ring
19	57796	Screw, Plastite, No. 6 x 1/2 In.	64	55511	Ground Wire
20	301541	Reflector, Headlight, L.H.	65	57196	Rod, Brake-Clutch
21	120392	Flatwasher, 1/4 In.	66	310006	Foot Pad, R.H.
22	300303	Screw, Plastite, 1/4-20 x 3/4 In.	67	57847	Spring, Return
23	301425	Support, Hood	68	2968	Flatwasher
24	9129	Bracket, Retaining	69	52785	Pad Brake Pedal
25	1288	Retainer, Cable Bracket	70	304932	Fender Bracket
26	39298	Pulley	71	9243	Brake Pedal
27	57322	Shoulder bolt	72	311243	Main Frame
28	1502	Locknut, 1/4-20 1hd.	73	305602	Foam, R.H.
29	9197	Brace, Dash & Fuel Tank	74	9784	Bracket, Grille, R. H.
30	9744	Bracket, Fuel Tank	75	9785	Bracket, Grille, L. H.
31	300304	Cap, Fuel Tank	76	180022	Screw, 1/4 - 20 x 1 In.
32	44811	Screw, Tapite, 1/4-20 x 3/4 In.	77	305604	Foam, Top Hood (2)
33	303043	Fuel Tank	78	56030	Screw, Hex Hd, 5/16-18 x 3/4 In.
34	41008	Clamp, Fuel Line	79	310005	Foot Pad, L. H.
35	47452	Tubing, Fuel Line	80	56361	Bracket, Front Axle
36	9208	Brace, Dash	81	55273	Nut, Hex, 5/16-18 Thd.
37	9132	Dash, Metal Support	82	138538	Lockwasher, Internal Tooth
38	302049	Decal, Dash, L. H.	83	57259	Belt Guide
39	303159	Throttle Control			
40	120622	Nut, Hex, No. 8-32 Thd.			
41	300508	Knob, Throttle Control			
42	159585	Screw, Pan Hd, No. 8-32 x 3/8 In.			
43	159943	Screw, Pan Hd, No. 10-24 x 5/8 In.			
44	300194	Boot, Ignition Switch			
45	305428	Dash, Plastic Cover			

(\*) Standard Hardware Items - May Be Purchased Locally.

**39" RIDING MOWER MODEL A3560-2200**

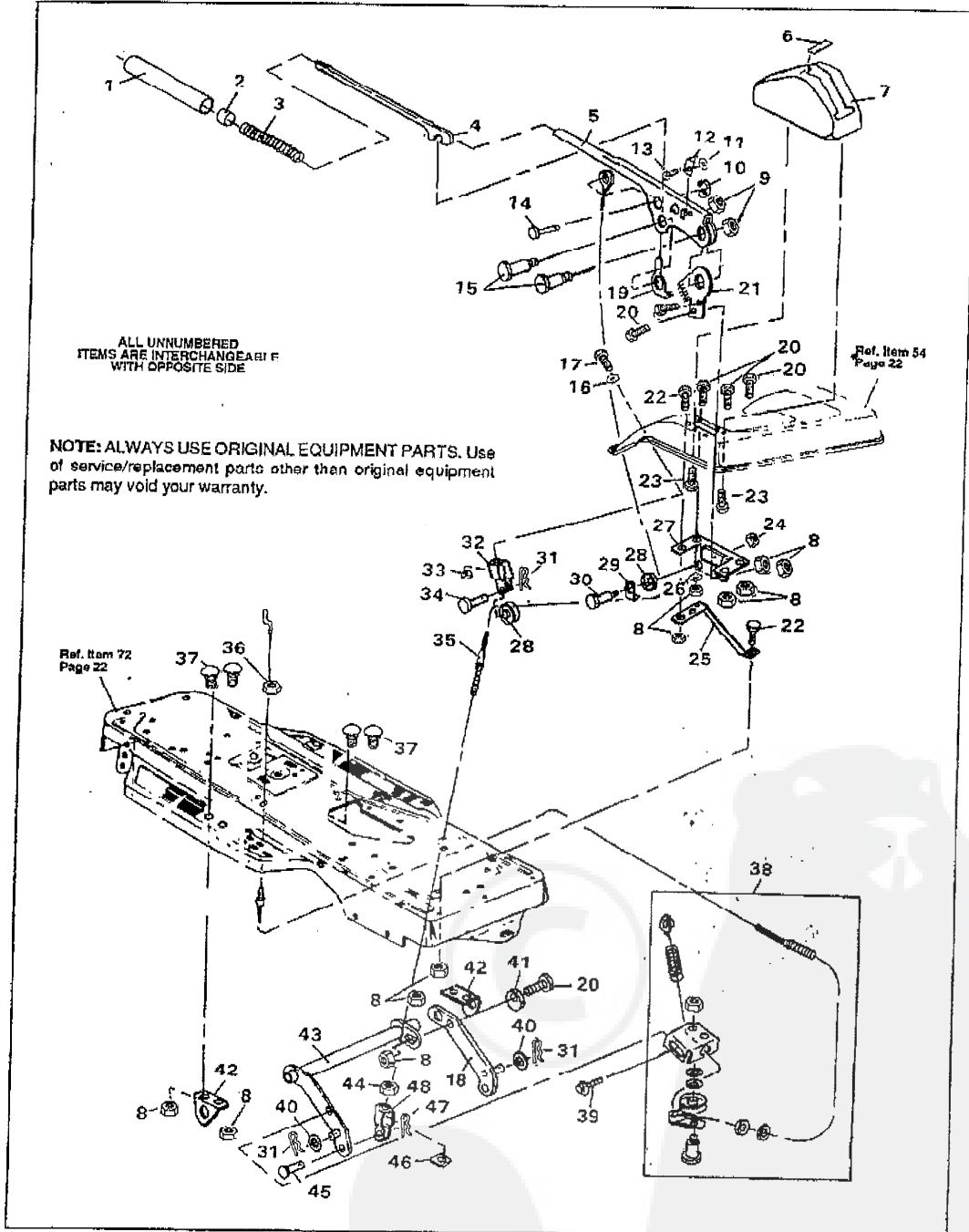



Mar 31 03 03:35p Murray, Inc.

6153736798

p. 11

## 39" RIDING MOWER MODEL A3560-2200

Key No.	Part No.	Description	Key No.	Part No.	Description
1	58329	Hand Grip, Height Adjust Lever	26	45802	Spacer Washer
2	58325	Knob, Height Adjust Lever	27	58333	Bracket, Support, Height Adjust Lever
3	58326	Spring, Height Adjust Lever	28	39298	Pulley
4	303027	Actuator Rod, Height Adjust Lever	29	9149	Bracket, Cable Retainer
5	9788	Lever, Height Adjust	30	58336	Shoulder Bolt
6	301897	Decal, Height Adjust	31	8260	Hair Pin Cotter
7	300339	Cover, Height Adjust Lever	32	9239	Clevis
8	1498	Locknut, Hex, 5/16-18 Thd.	33	120373	Nut, Square, 5/16-18 Thd.
9	44108	Wide Flange Locknut, 5/16-18 Thd.	34	300317	Pin, Clevis
10	300311	"E" Ring	35	300341	Cable, Deck Lift
11	138479	Lockwasher, Ext. Lock	36	120613	Nut, Hex, 1/4-28 Thd.
12	9435	Pointer, Height Adjust Lever	37	120211	Carriage Bolt, 5/16-18 x 5/8 In.
13	35287	Screw, Hex Wa Hd, No. 8-32 x 3/8 In.	38	301491	Cable Assy, Blade Engage/Disengage
14	300310	Pin, Clevis	39	35498	Screw, Taprite, 5/16-18 x 3/4 In.
15	300171	Shoulder Bolt	40	120396	Flatwasher, 17/32 In.
16	301551	Washer, Curved, 11/32 In.	41	58247	Nut, Adjusting
17	439455	Screw, Pan Hd, 5/16-18 x 9/16 In.	42	9117	Bracket, Rear Hanger
18	9186	Link Assembly, Right Side	43	9185	Rear Lift Assembly
19	301239	Pawl, Height Adjust	44	120375	Nut, Hex, 1/4-20 Thd.
20	180077	Screw, Hex Hd, 5/16-18 x 3/4 In.	45	39522	Clevis, Pin
21	301238	Quadrant	46	120372	Nut, Square, 1/4-20 Thd.
22	180079	Screw, Hex Hd, 5/16-18 x 1 In.	47	121222	Cotter Pin, 3/32 x 3/4 In.
23	300302	Screw, No. 10 x 1/2 In.	48	9405	Rear Clevis, Lift Cable
24	1502	Locknut, Hex, 1/4-20 Thd.			
25	307367	Brace, Fender			

(\*) Standard Hardware Items - May Be Purchased Locally.

**39" RIDING MOWER MODEL A3560-2200**

**NOTE: ALWAYS USE ORIGINAL EQUIPMENT PARTS.** Use of service/replacement parts other than original equipment parts may void your warranty.

ALL UNNUMBERED  
ITEMS ARE INTERCHANGEABLE  
WITH OPPOSITE SIDE

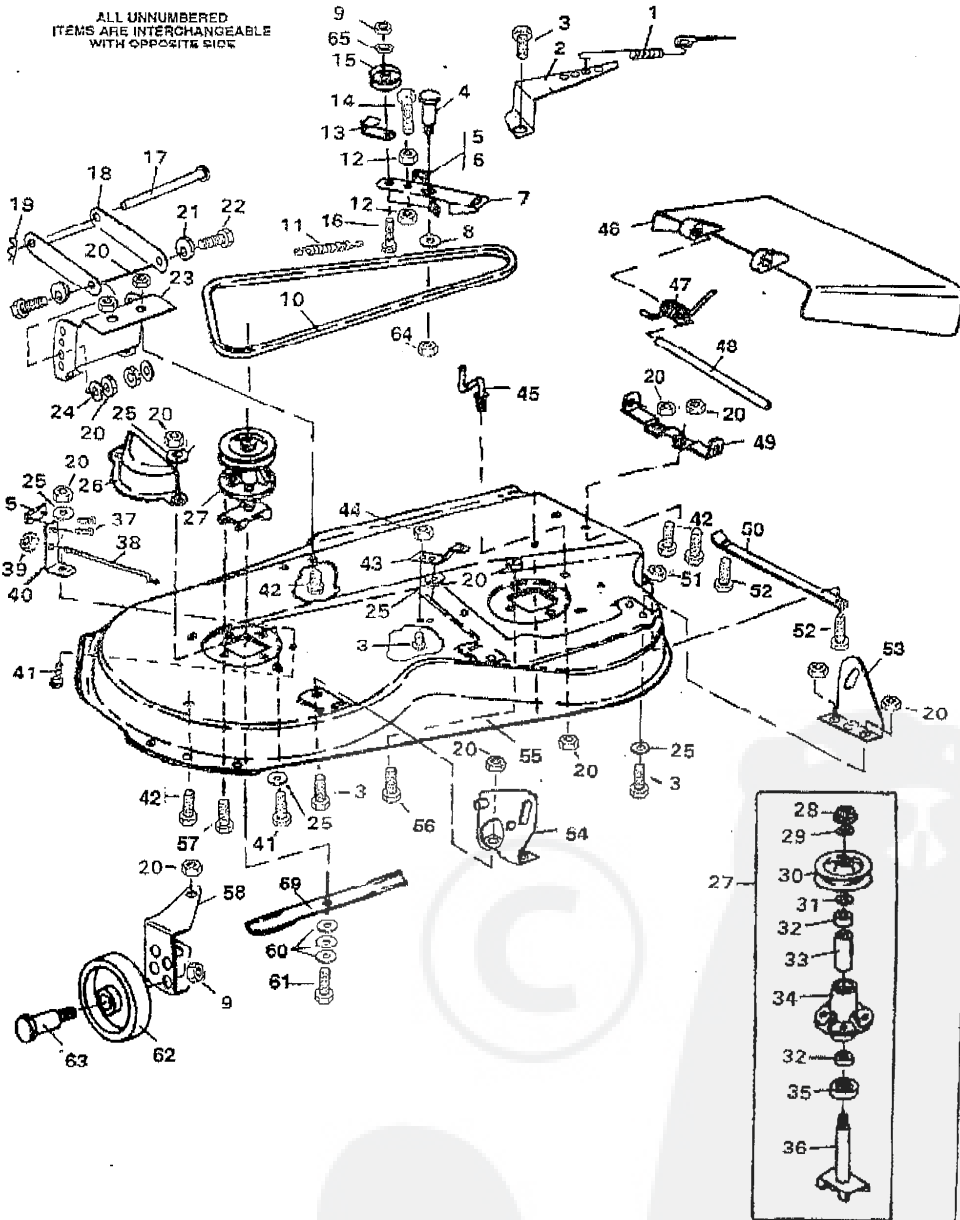

**39" RIDING MOWER MODEL A3560-2200**

Key No.	Part No.	Description	Key No.	Part No.	Description
1	300473	Spring	35	50618	Dust Shield
2	9401	Extension, Idler Arm	36	56425	Saddle & Shaft Assembly
3	180077	* Screw, Hex Hd, 5/16-18 x 3/4 In.	37	41601	Rivet, Brake Pad
4	300180	Shoulder Bolt	38	300316	Rod, Brake Release
5	306973	Brake Pad	39	1502	Locknut, 1/4-20 Thd.
6	135624	Rivet, Brake Pad	40	303246	Blade Brake
7	300491	Idler Arm Bracket	41	120228	* Screw, Hex Hd, 5/16-18 x 5/8 In.
8	996416	* Flatwasher, 3/8 In.	42	120834	* Screw, Hex Hd, 5/16-18 x 1/2 In.
9	1499	Locknut, 3/8-16 Thd.	43	300179	Bracket, Idler
10	300680	V-Belt	44	44108	Nut, Hex, Wide Flange, 5/16-18 Thd.
11	35410	Spring	45	57318	Retainer, Belt
12	271172	* Nut, Keps, 1/4-20 Thd.	46	57818	Discharge Chute
13	1348	Retainer, Belt	47	56767	Spring, Discharge Chute
14	121954	* Screw, Hex Hd, 1/4-20 x 2 In.	48	57317	Rod Pivot
15	303030	Pulley, Idler	49	57360	Bracket, Pivot
16	57325	Carriage Bolt, 3/8-16 x 2 In.	50	57314	Skid Bar
17	58306	Rod, Deck Hitch	51	271184	* Nut, Keps, 5/16-18 Thd.
18	58305	Bracket, Deck Front	52	126216	* Carriage Bolt, 5/16-18 x 3/4 In.
19	8260	Hair Pin Cottar	53	58250	Bracket, Lift, R.H.
20	1498	Locknut, 5/16-18 Thd.	54	58251	Bracket, Lift, L.H.
21	58247	Nut, Adjusting	55	306384	Mower Deck
22	122017	* Screw, Hex Hd, 5/16-18 x 1 In.	56	300345	Screw, Taprite, 5/16-18 x 1 3/8 In.
23	58315	Lift Support Plate	57	50634	Screw, Taprite, 5/16-18 x 7/8 In.
24	35214	Flatwasher, 21/64 In.	58	300103	Bracket, Wheel Mount
25	120393	* Flatwasher, 11/32 In.	59	57299	Blade
26	302833	Belt Guard, L.H. Pulley	60	2483	Formed Washer
27	56424	Quill Assembly (Incl. Nos. 28-36)	61	39573	Screw, Hex Hd, 3/8-24 x 1 In.
28	1282	Locknut, Flange	62	52584	Wheel, Deck
29	56365	Flatwasher	63	23763	Wheel Axle
30	56990	Pulley	64	45171	Locknut, Flange
31	51449	Spacer	65	120382	Split Lockwasher, 25/64 In.
32	49562	Bearing			
33	50818	Spacer Tube			
34	55547	Quill			

(\*) Standard Hardware Items - May Be Purchased Locally.

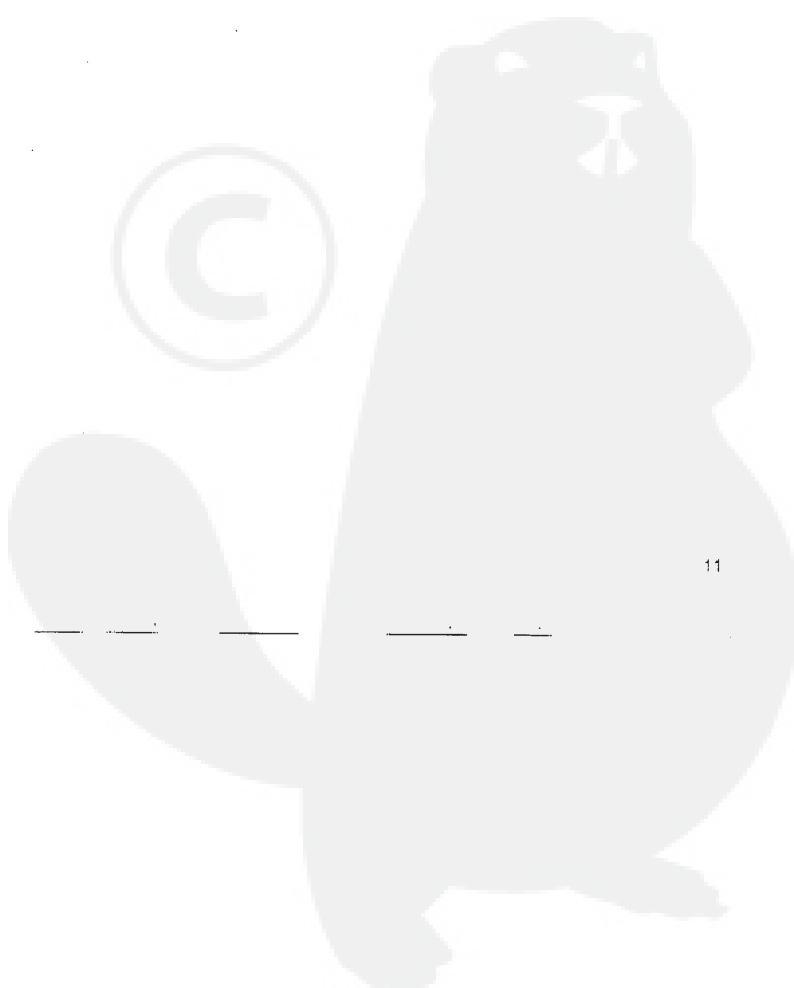

**39" RIDING MOWER MODEL A3560-2200**

Key No.	Part No.	Description	Key No.	Part No.	Description
1	120854	Screw, Hex Hd, 1/4-20 x 5/8 In.	18	300334	Switch, Headlight
2	302257	Battery	19	57769	Bulb, Indicator
3	57552	Bracket, Battery Hold-Down	20	300965	Wire Harness Assy, Indicator Light
4	120375	* Nut, Hex, 1/4-20 Thd.	21	300220	Switch, No Start
5	120380	Lockwasher, Split	22	302031	Fuse
6	120392	* Flatwasher, 9/32 In.	23	120368	* Nut, Hex, 5/16-24 Thd.
7	300626	Key, Ignition Switch	24	138485	Lockwasher, External Lock
8	271172	* Keys Nut, 1/4-20 Thd.	25	1502	Locknut, Hex, 1/4-20 Thd.
9	67561	Rod, Battery Hold-Down	26	187745	* Screw, Hex Hd, 1/4-20 x 3/4 In.
10	57289	Belt Guide	27	53716	Solenoid
11	138538	Lockwasher, Internal Tooth	28	57476	Switch, Clutch Interlock
12	1498	* Locknut, Hex, 5/16-18 Thd.	29	303064	Harness, Headlight
13	56277	Switch, Interlock System	30	52572	Bulb, Headlight
14	55511	Ground Wire	31	41482	Retainer, Harness, Press-On
15	300331	Wire Harness Assembly	32	54888	Retainer, Harness
16	300295	Switch, Ignition	33	305431	Pigtail Wire Assembly
17	300193	Nut, Plastic, Ignition Switch	34	305511	Connector Body

(\*) Standard Hardware Items - May Be Purchased Locally.

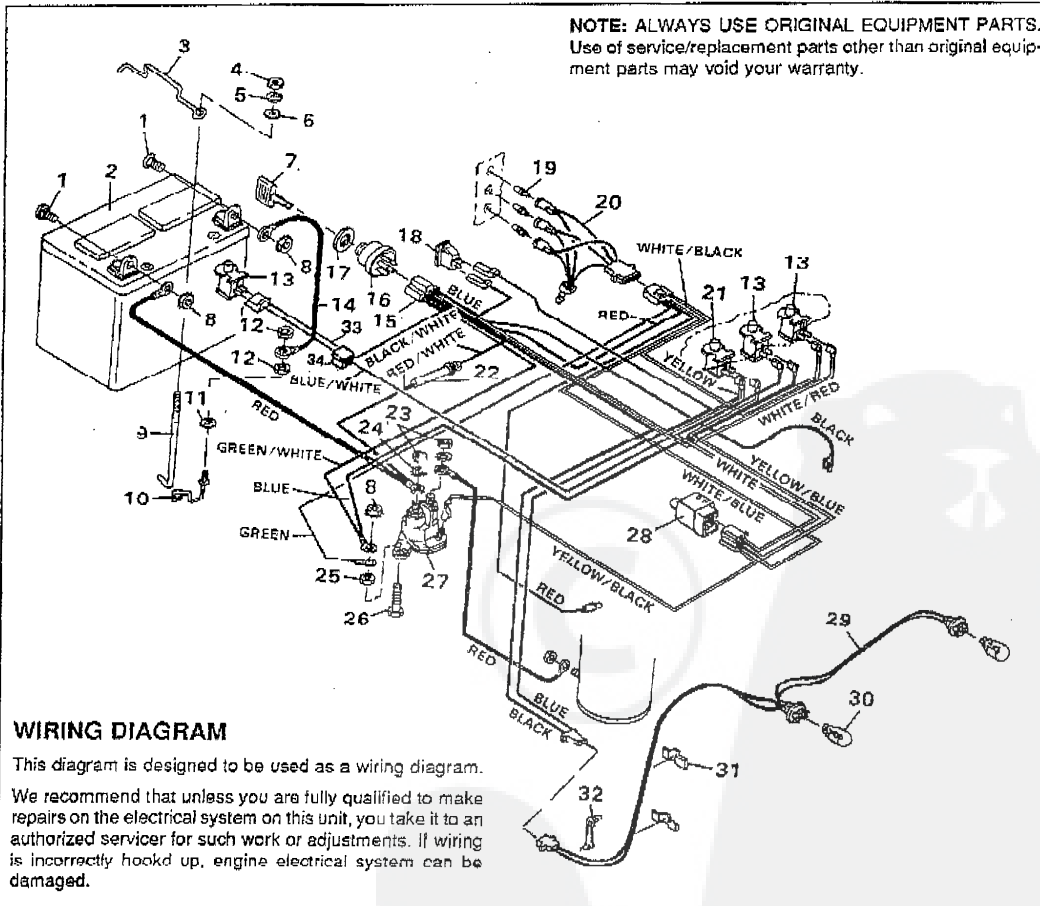

## ACCESSORIES

Contact the dealer where your tractor was purchased for the available accessories. If you are unable to contact the dealer, write to the address on the front cover of this manual.

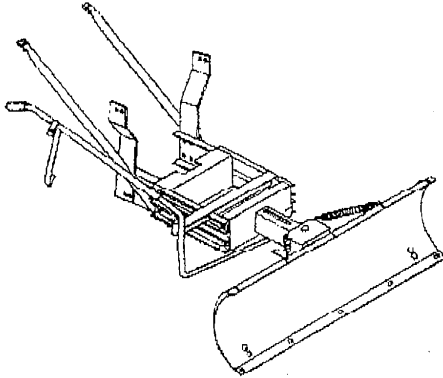

### 42" SNOW & GRADER BLADE

Rugged, heavy gauge steel blade. Spring loaded blade glides over uneven surfaces. Can be adjusted from seat for straight position, or 35 degrees left or right. Locks in raised position for traveling. Wheel and tire chains are recommended.

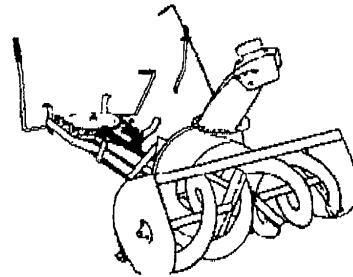

### TWO STAGE SNOW THROWER

A powerful two stage snow thrower with a 1/4 inch second stage impeller capable of moving more than 70 tons of snow per hour and throwing it accurately in any direction you choose. Driver controlled discharge chute turns a 160 degree arc. Wheel weights and tire chains are recommended.

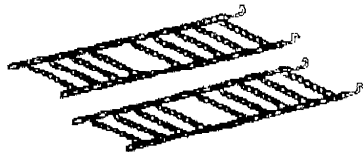

### TIRE CHAINS

Tire chains for added traction are available. Specify tire size when ordering.

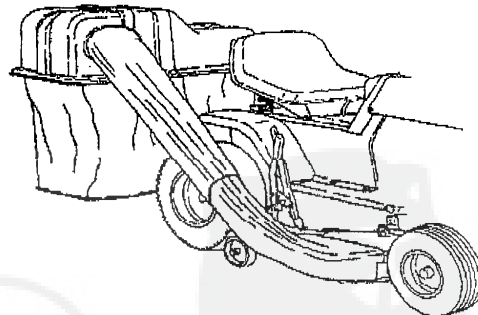

### REAR MOUNT GRASS CATCHER

For 40-inch side discharge mower decks. Easy-On Easy-Off chute extension. Includes Easy-To-Dump twin grass collection containers with a 6-bushel capacity.

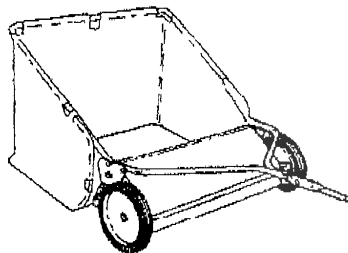

### LAWN SWEEPER

Features extra heavy duty wheels and heavy duty basket. Basket is water, shrink and mildew proof with 6 bushel capacity. Dump release and height adjuster can both be operated from the tractor seat.

### FRONT WHEEL WEIGHTS

One pair, 20 pounds each. Total weight 40 pounds. Includes mounting hardware.

### REAR WHEEL WEIGHTS

One pair, 50 pounds each. Total weight 100 pounds. Includes mounting hardware.