

NOTE: ALWAYS USE ORIGINAL EQUIPMENT PARTS.  
Use of service/replacement parts other than original  
equipment parts may void your warranty.

ALL UNNUMBERED  
ITEMS ARE INTERCHANGEABLE  
WITH OPPOSITE SIDE

# FRONT CHASSIS ASSEMBLY

KEY NO.	PART NO.	DESCRIPTION	QTY
1	94082-876	GRILL SUPPORT RH	1
2	94083-876	GRILL SUPPORT LH	1
3	711606	SCREW, 5/16-18 X.75	4
4	94074-876	DASH	1
5	711629	SCREW, 10-24 X.5	4
6	94075	STEERING BRACKET	1
7	710197	SCREW, 1/4-14 X.5	2
8	95366-876	ACCESS PANEL	1
9	711629	SCREW, 10-24 X.5	2
10	94078	FORMED CONSOLE	1
11	711606	SCREW, 5/16-18 X.75	4
12	95088-876	HOOD	1
13	94079	GRILLE	1
14	711629	SCREW, 10-24 X.5	4
15	94080	LENS, RH	1
16	94081	LENS, LH	1
17	94076	REFLECTOR, RH	1
18	94807	REFLECTOR, LH	1
19	711611	SHOULDER BOLT	2
20	711622	NUT, 3/8-16 WDFLLKMACK	2
21	95059	BELLOW, STEERING	1
22	94744	BUMPER	2
	712160	OPERATOR'S MANUAL (NOT SHOWN)	

**NOTE**  
APPLY KEY# 80 TO INSIDE OF KEY# 16.

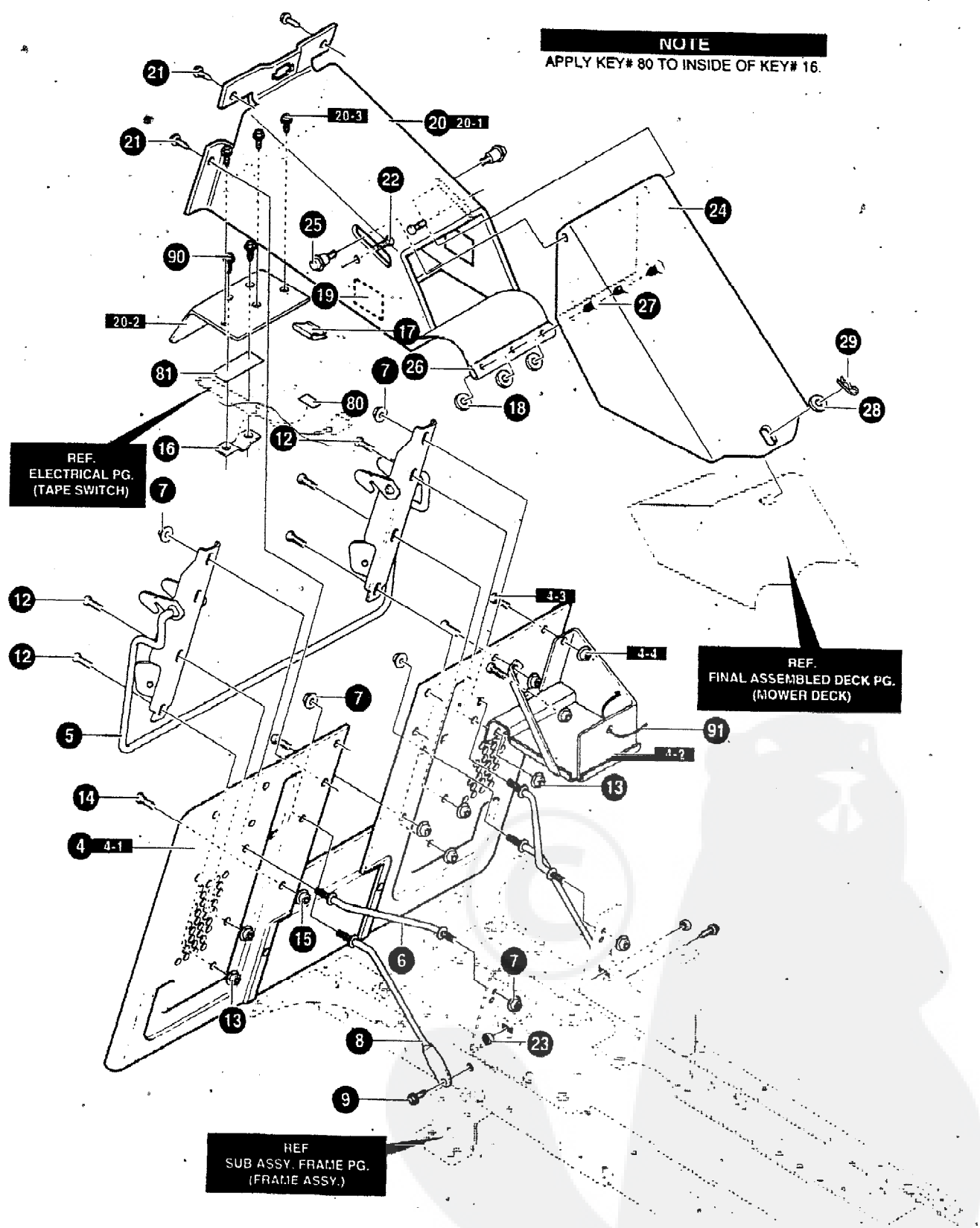

**NOTE:** ALWAYS USE ORIGINAL EQUIPMENT PARTS. Use of service/replacement parts other than original equipment parts may void your warranty..

ALL UNNUMBERED ITEMS ARE INTERCHANGEABLE WITH OPPOSITE SIDE

343664B

# REAR CHASSIS ASSEMBLY

KEY NO.	PART NO.	DESCRIPTION	QTY
4	<del>343678</del> -876	ASSY, BACK PLATE/BATTERY	1
4-1	9 5 1 6 2	ASM. BACKPLATE FLAT	1
4-2	94563	BATTERY TRAY ASM.	1
4-3	180073	SCREW, 5/16-18X.50 HHC	3
4-4	45174	NUT, 5/16-18 HEXWDFLLK WHIZ	3
5	95359-876	WELDMENT-LATCH LEVER	1
6	690097	ROD, BRACE	2
7	711906	NUT, 3/8-16 HWDFL WHIZ-LOCK	6
8	94231	ROD, BRACE	2
9	711606	SCREW, 5/16-18X.75 HHWATAP	2
12.	711907	SCREW 5/16-18X.75 HXWDFL	5
13	7 10026	NUT, 5/16-18 HEXWDFLLK WHIZ	5
14	711606	SCREW 5/16-18 Sk.75 HHWATAP	2
15	710026	NUT, 5/16-18 HEXWDFLLK WHIZ	2
1 6	95390	BRACKET, FLEX SWITCH MOUNTING	1
17	55939	WIRE CLIP, ADHESIVE	1
18	<del>120385</del>	WASHER, FLAT .203X .56 X 1040	3
19	318197	PAD, ADHESIVE 1.00X1.50X.12	2
20	690102-876	ASM., T/A SHIELD & UPPER CHUTE	
20-1	94350	CHUTE WELD ASM. UPPER	1
20-2	95367	SHIELD, TRANSAXLE	1
20-3	711642	SCREW, 1/4-20X.63 HHWATAP	4
21	711606	SCREW, 5/16-18X.75 HHC	4
22	711688	BOLT, 5/16-18X.75 CARR	2
23	710026	NUT, 5/16-18 HEXWDFLLK WHIZ	2
24	94296-876	MIDDLE CHUTE ASSY	1
25	711908	BOLT, .500X.453 3/8-16	2
26	94264	FLAP, CHUTE	1
27	309235	FASTENER, RATCHET	3
28	711617	FLATWASHER .550X1.00X11	1
29	711662	PIN, HAIR .38DIAX1.64LG	1
80	712009	TAPE, DOUBLE SIDED FOAM 3/4" WD	0.560
81	712009	TAPE, DOUBLE SIDED FOAM 3/4" WD	3
90	711642	SCREW, 1/4-20X.63 HHWATAP	2
91	57444	CABLE TIE	1

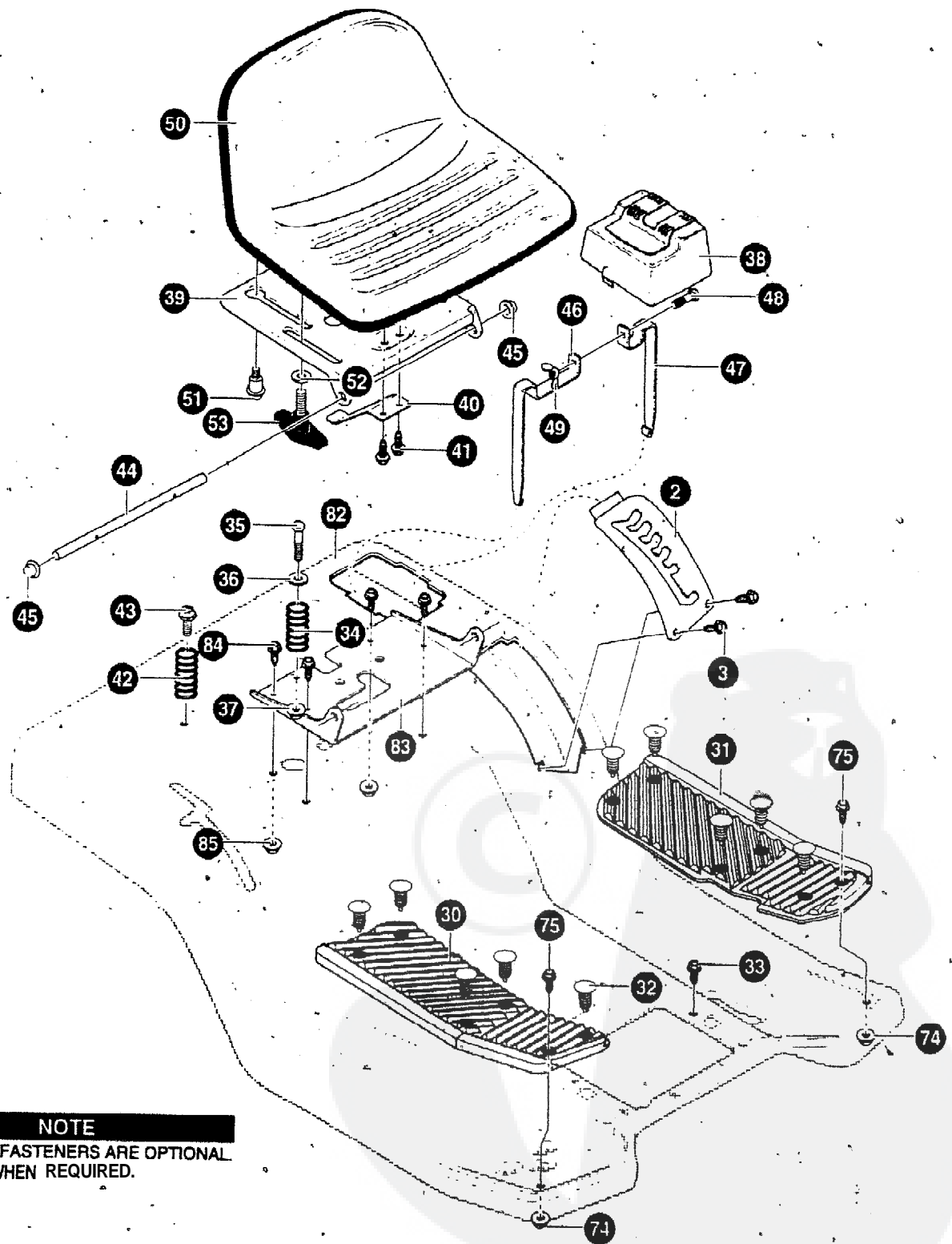

**NOTE**  
 FOOTPAD & FASTENERS ARE OPTIONAL  
 ONLY USE WHEN REQUIRED.

**NOTE: ALWAYS USE ORIGINAL EQUIPMENT PARTS.**  
 Use of service/replacement parts other than original  
 equipment parts may void your warranty.

**AU UNNUMBERED  
 ITEMS ARE INTERCHANGEABLE  
 WITH OPPOSITE SIDE**

343664B

# REAR CHASSIS ASSEMBLY

KEY NO.	PART NO.	DESCRIPTION	QTY
2	95190-876	PLATE, LIFT DETENT	1
3	711741	SCREW, #12X.50 PHPNHTAP	2
30	95409	FOOTREST PAD RH	1
31	95408	FOOTREST PAD LH	1
32	3 0 9 2 3 5	RATCHET HET FASTENER	10
33	711606	SCREW, 5/16-18X.75HHWATAP	3
34	710136	SPRING, COMPRESSION 4.57LGX1.17	1
35	7 1 1 6 1 0	BOLT SHOULDER 1/4-20	1
36	95293	ZINC WASHER CUP	1
37	46931	NUT, 1/4-20 WDFLLK	1
38	94200	COVER, BATTERY	1
39	94154-876	SUPPORT, SEAT	1
40	9 4 0 5 7	SPRING-LEAF	1
41	711592	SCREW, 1/4-20X.50 WAHHTAP	2
42	710109	SPRING, COMPRESSION 2.43LG164X30	2
43	711606	SCREW, 5/16-18X.75 HHWATAP	2
44	95294	ZINC HINGE SEAT PIVOT	1
45	711627	NUT, PUSH CAP .375	2
46	95393-876	BATTERY, BRACKET L.H.	1
47	95394-876	BATTERY BRACKET R.H.	1
48	711680	BOLT, 1/4-20X.63 CARR.	1
49	711636	NUT, WING 1/4-20 14X79	1
50	94161	SEAT	1
51	7 1 1 7 4 0	BOLT, SHOULDER 5/16-18	2
52	711644	WASHER, FLAT 344X.62X.06	2
53	711747	BOLT, WING 5/16-18X.50	2
74	710026	NUT, 5/16-18 HEXWDFLLK WHIZ	2
75	711891	BOLT, 5/16-18X.7A5 CARR.	2
82	341496-876	ASM., SEAT DECK PEDAL GEAR	1
83	94153-876	BRACKET, PIVOT SEAT	1
84	711606	SCREW, 5/16-18X.75 HHWATAP	2
85	717634	NUT, 5/16-18 WDFLLK	2

**NOTE**  
 CUT KEY# 100 IN TWO 11.0" LENGTHS  
 APPLY TO LEADING EDGE OF  
 COLLECTOR COVER.

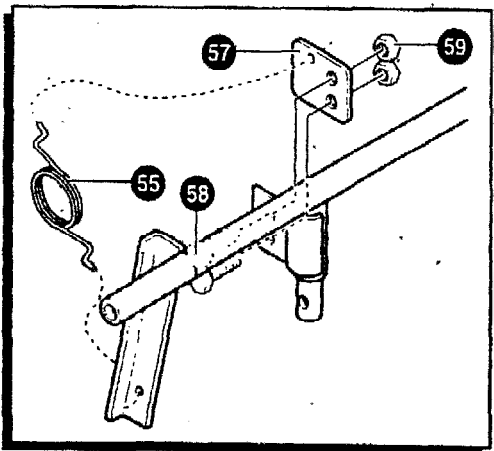
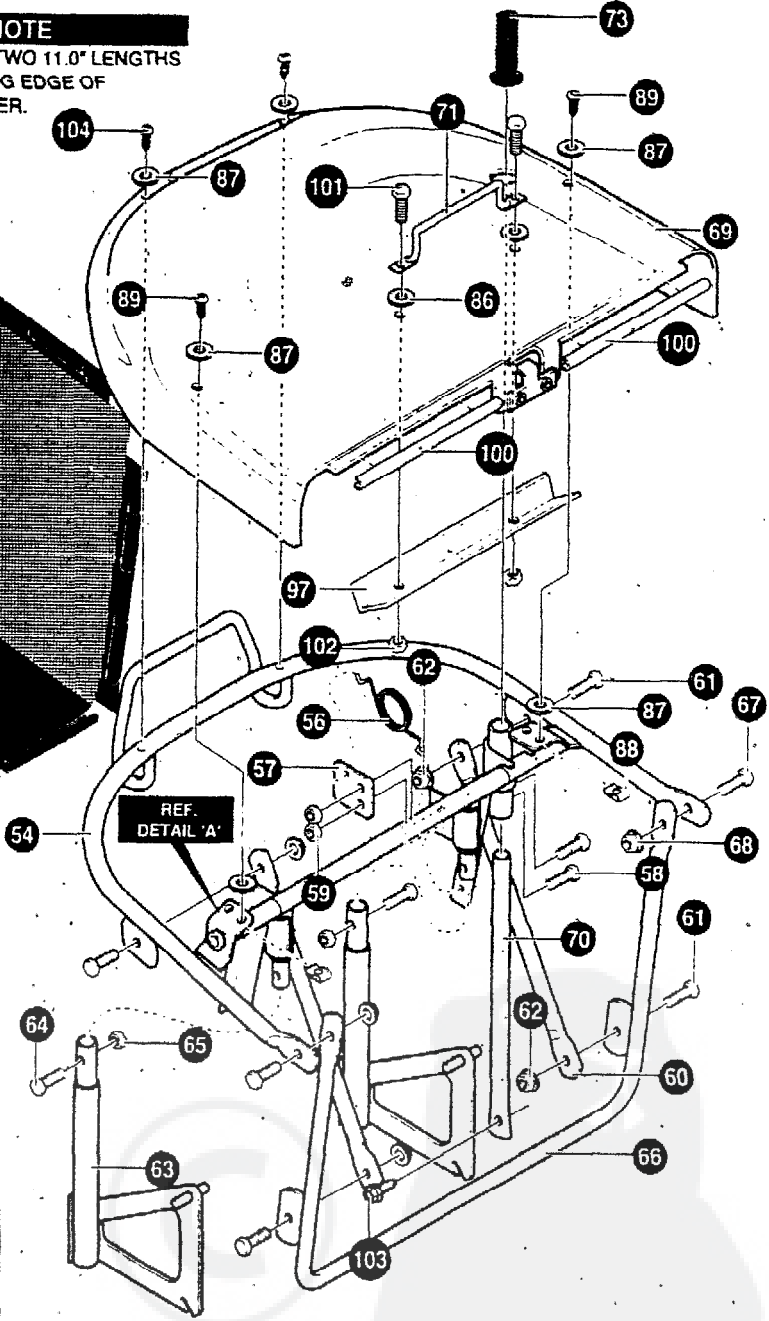
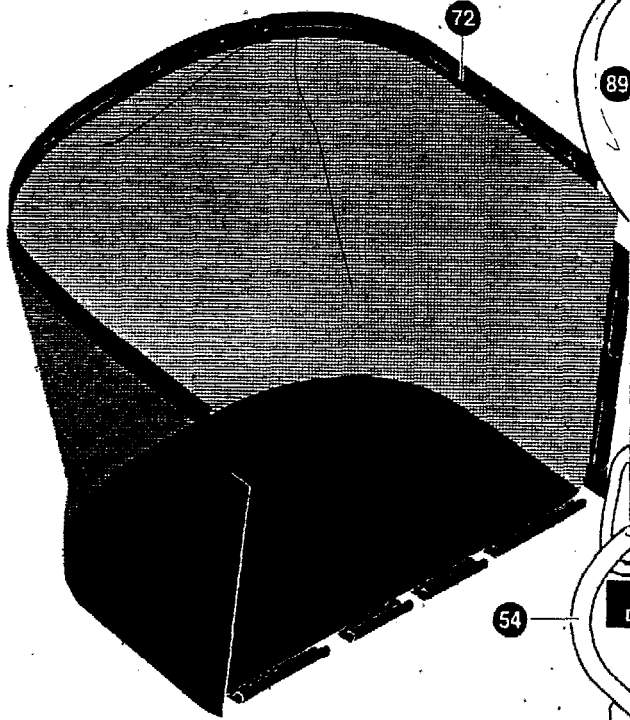

DETAIL 'A'

**NOTE**  
 1.) BRACKET, KEY# 57, FOR SPRING MUST SHOW SPRING HOLE AT THE TOP.  
 2.) LEFT HAND SPRING, KEY# 56, HAS A YELLOW TIP.  
 3.) LOOK FOR THE "F" STAMP ON THE BAGGER BRACE, KEY# 97, WHICH INDICATES THE FROM.

NOTE: ALWAYS USE ORIGINAL EQUIPMENT PARTS. Use of service/replacement parts other than original equipment parts may void your warranty.

ALL UNNUMBERED ITEMS ARE INTERCHANGEABLE WITH OPPOSITE SIDE

343664E



# REAR CHASSIS ASSEMBLY

KEY NO.	PART NO.	DESCRIPTION	QTY
54	690044-876	ASM. WELD UPPER FRAME	1
55	690003	SPRING, TORSION RH	1
56	690004	SPRING, TORSION LH	1
57	95339-876	BRACKET, SPRING COLLECTOR	2
58	180016	SCREW, 1/4-20X.50 HHC	4
59	782585	NUT, 1/4-20 REGHEXCTRLK	4
60	94850-876	BRACE, FRAME COLLECTOR	2
61	711909	SCREW, 1/4-20X.62 HHC	4
62	711632	NUT, 1/4-20HEXNYL	4
63	95343-876	WELD ASM., SUPPORT COLLECTOR	2
64	180034	SCREW, 1/4-20X1.50	2
65	782585	NUT, 1/4-20 REGHEXCTRLK	2
66	95349-876	WELD ASM., FRONT FRAME COLLECT.	1
67	711909	SCREW, 1/4-20X.62 HHC	2
68	711632	NUT, 1/4-20 HEXNYL	2
69	94908-876	TOP COLLECTOR ASM.	2
70	94853	HANDLE, DUMP COLLECTOR	1
71	94855-876	HANDLE, REBA COLLECTOR	1
72	95389	REBA COLLECTOR BAG	1
73	94854	RUBBER GRIP	1
86	712129	WASHER, .281 XI .25X.06	2
87	711921	WASHER, .328X1.06X.062	2
80	578107	NUT, 1/4-20 TINN U	2
89	711674	SCREW, 1/4-20X.63 PHPNHD	2
97	690010-876	BRACE, BAGGER	1
100	55023	TRIM 77.5 INCHES	2 2 I N .
101	712068	SCREW 1/4-20X1.50 PHPNHD	2
102	711632	NUT, 1/4-20 HEXNYL	2
103	710266	SCREW, 1/4-20X.38 SLHWATAP	1
104	711741	SCREW, #12X.50 PHPNHTAP	2



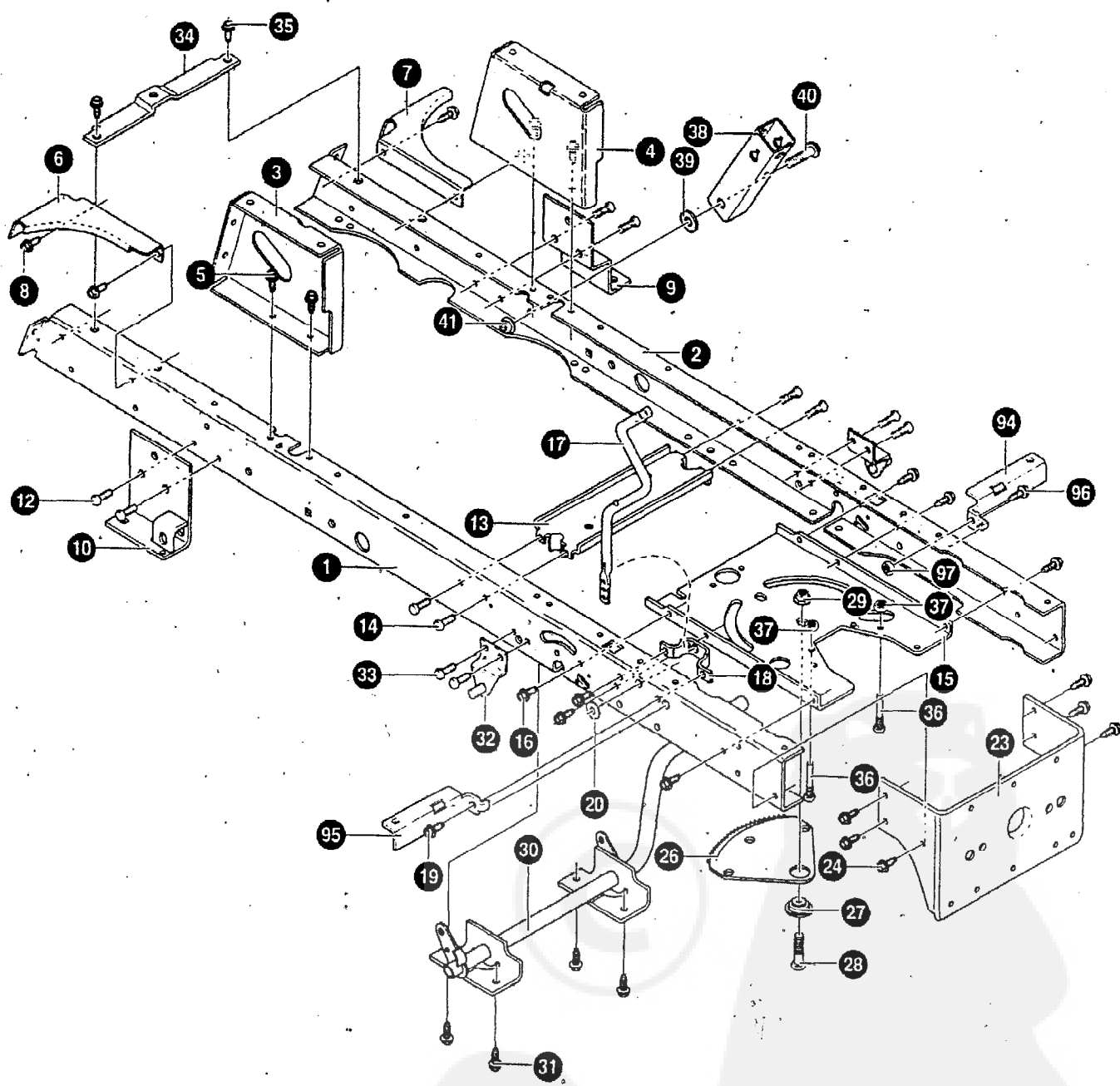

NOTE: ALWAYS USE ORIGINAL EQUIPMENT PARTS.  
Use of service/replacement parts other than original  
equipment parts may void *your* warranty.

ALL UNNUMBERED  
ITEMS ARE INTERCHANGEABLE  
WITH OPPOSITE SIDE

KEY NO.	PART NO.	DESCRIPTION	QTY
1	94564	FRAME, RAIL RH	1
2	94565	FRAME, RAIL LH	1
3	94634	SUPPORT, SEAT RH	1
4	94633	SUPPORT, SEAT LH	1
5	710079	SCREW 5/16-I 8X.75 HHWATAP	4
6	94561	BRACE, BACKPLATE RH	1
7	94562	BRACE, BACKPLATE LH	1
8	710079	SCREW 5/16-I 8X.75 HHWATAP	4
9	94235	BRACKET, TRANSAXLE	1
10	95396	WELD, ASSY SHIFT BRACE LEVER'	1
12	710079	SCREW, 5/16-I 8X.75 HHWATAP	4
13	9 4 2 3 7	ASM. IDLER MOUNT, FRONT	1
14	7 1 0 0 7 9	SCREW, 5/16-18X.75 HHWATAP	4
15	94003	PLATE, STEERING MOUNTING	1
16	710079	SCREW, 5/16-18X.75 HHWATAP	6
17	94019	CRANK, PTO	1
18	9 4 0 0 5	BRACKET, BELL CRANK	1
19	710079	SCREW, 5/16-18X.75 HHWATAP	2
20	120395	WASHER, FLAT .469X.92X.065	1
23	94013	BRACKET, HANGER REAR	1
24	710079	SCREW, 5/16-18X.75HHWATAP	6
26	94121	GEAR, SECTOR	1
27	94123	BEARING, SECTOR GEAR	1
28	710312'	SCREW, 5/16-18X1.00	1
29	710105	NUT, 5/16-18 HEXKEPS, 15X113	1
30	94241	ASM., CLUTCH/BRAKE PEDAL	1
31	710079	SCREW, 5/16-I 8X.75 HHWATAP	4
32	94285	BRACKET, SUSPENSIONASM.	2
33	710079	SCREW, 5/16-18X.75 HHWATAP	4
34	94566	BRACE, RAIL	1
35	710079	SCREW, 5/16-I 8X.75 HHWATAP	2
36	93349	ZINC SCREW GUIDE	2
37	710204	NUT, 5/16-18 HEXWDFLLK WHIZ	2
38	94015	BRACKET, PIVOT	1
39	845	WASHER, FLAT .390X1.25X.119	1
40	710000	BOLT, .562X1.563 HSSH 3/8-16	1
41	710140	NUT, 3/8-16 HWDFLLK. MACK 15X84	1
94	690036	BRACKET -SEAT DECK LH	1
95	690035	BRACKET-SEAT DECK RH	1
96	710079	SCREW, 5/16-18X.75 HHWATAP'	1
97	710204	NUT, 5/16-18 HEXWDFLLK WHIZ	1

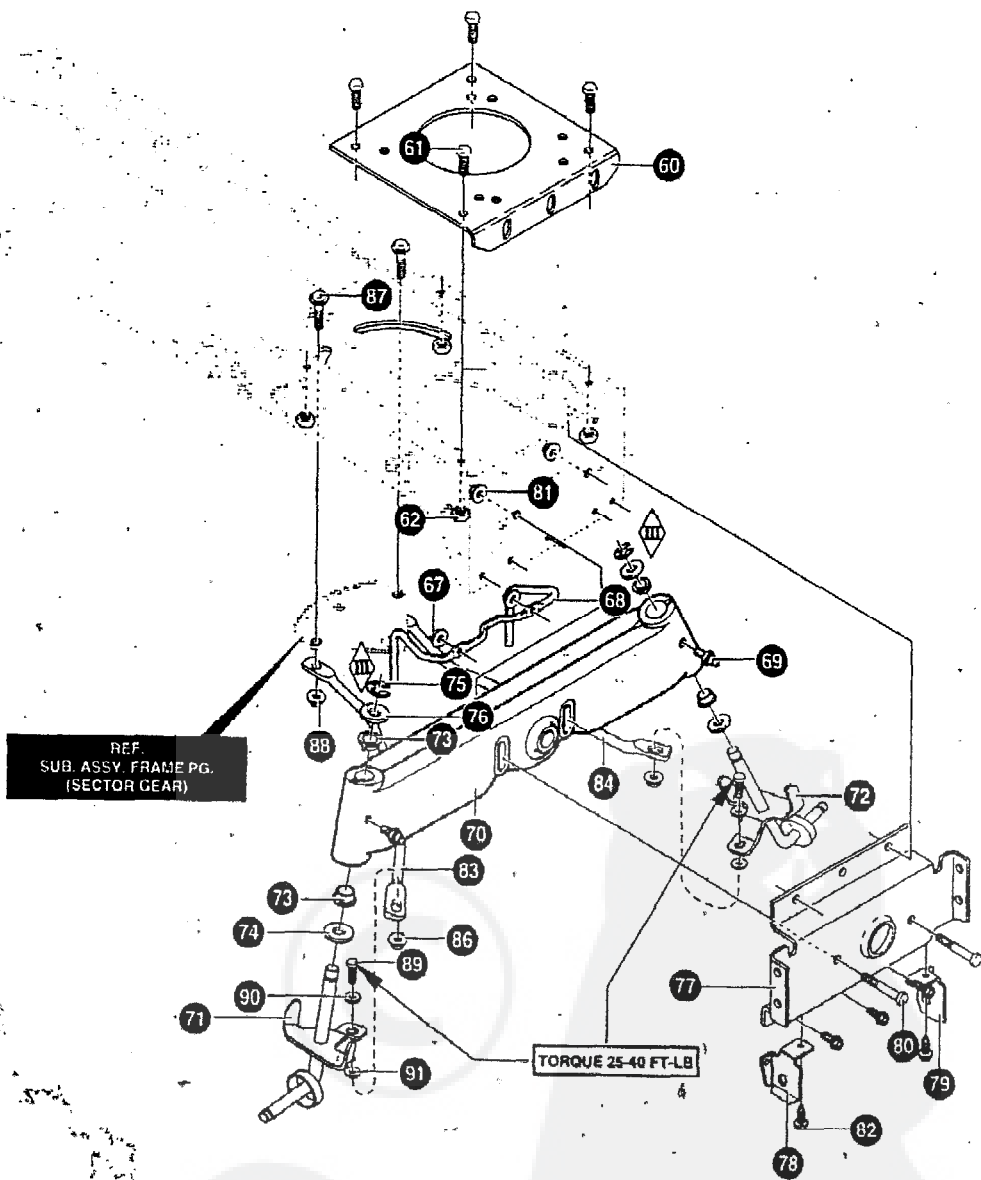

NOTE: ALWAYS USE ORIGINAL EQUIPMENT PARTS.  
 Use of service/replacement parts other than original equipment parts may void your warranty.

ALL UNNUMBERED  
 ITEMS ARE INTERCHANGEABLE  
 WITH OPPOSITE SIDE

343736A

# FRAMEASSEMBLY

KEY PART			
NO.	NO;	DESCRIPTION	QTY
60	94006	ENGINE PLATE	1
61	710079*	SCREW, 5/16-18X.75 HHWATAP	4
62	710205	NUT, 5/16-18 WDFLLK 15X88	4
67	45174	NUT, 5/16-18 HEXWDFLLK WHIZ	2
68	94310	GUIDE-STACK PULLEY BELT	1
69	706	ZERK, GREASE FITTING	2
70	95405	AXLE, CAST MACHINED REBA	1
71	95182	SPINDLE, LONG RH	1
72	95183	SPINDLE, LONG LH	1
73	92527	BEARING, SPINDLE	4
74	710129	WASHER, .766IDX1.62ID	2
75	710103	E-RING .574IDX.050/.750SH 11 X3	2
76	710088	WASHER, FLAT .765X1.81X.059	2
77	94007	HANGER, AXLE	1
78	94290	HANGER, DECK RH	1
79	94289	HANGER, DECK LH	1
80	180113	SCREW, 5/16-18X3.00	2
81	710205*	NUT, 5/16-18 WDFLLK 15X88	2
82	710079	SCREW, 5/16-18X.75 HHWATAP	5
83	95328	DRAG LINK RH	1
84	95329	DRAG LINK LH	1
86	710140	NUT, 3/8-16 HWDFLLK MACK 15X84	2
87	710440	SHOULDER BOLT 9X57	2
88	710140	NUT, 3/8-16 HWDFLLK MACK 15X84	2
89	710082	SCREW, 3/8-16X1.5	2
90	710083	WASHER FLAT .391X1.00X.083	2
91	710142	WASHER FLAT .406X.81X1.6GA	2

**NOTE**  
KEY# 33 & 43 ARE MOUNTED WITH  
HUB FACING DOWN.

REF.  
SUB. ASSY. FRAME PG.  
(FRAME ASSY.)

REF.  
ENGINE & CONTROL PG.  
(ENGINE PULLEY)

REF. KEY# 17

REF. KEY# 42

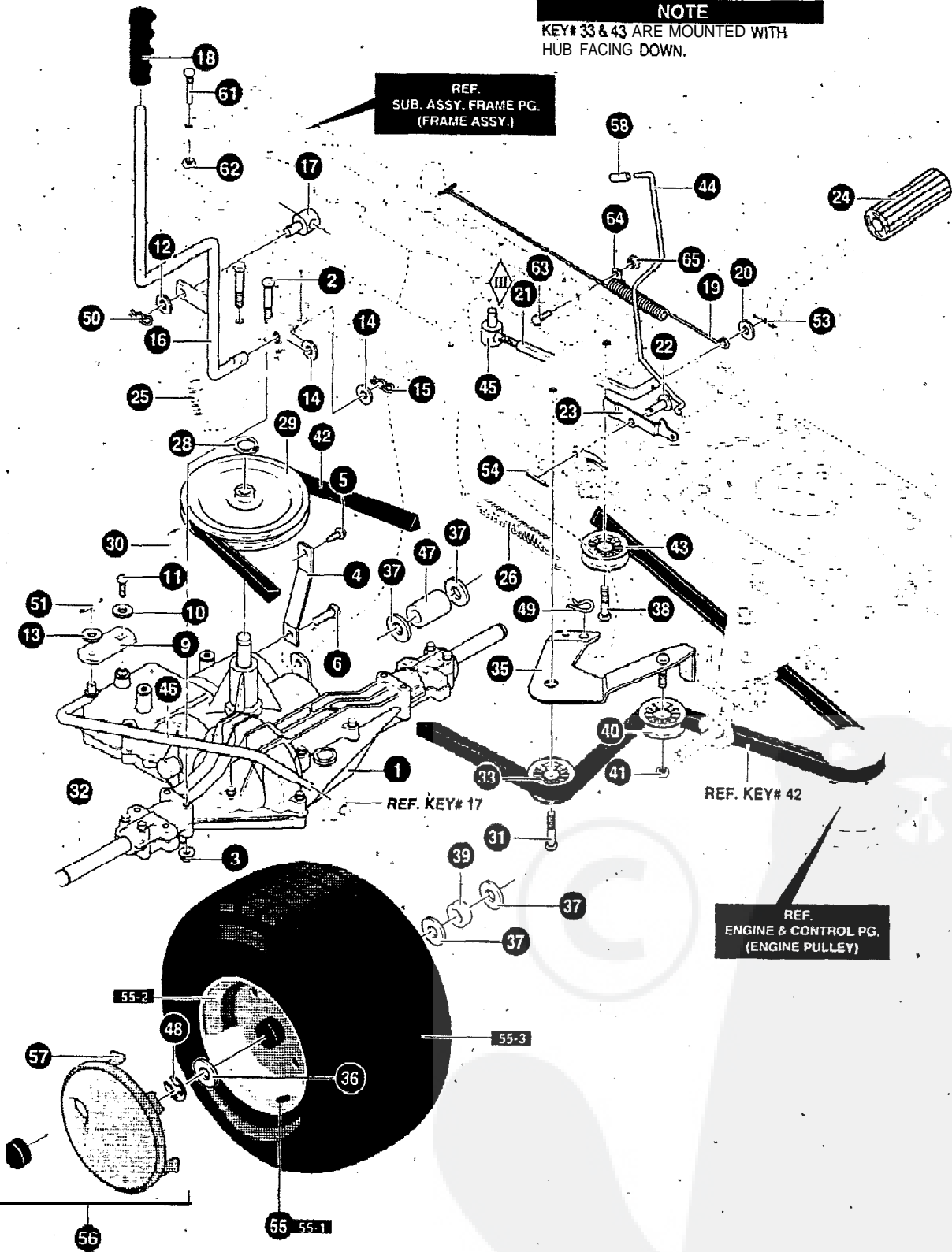

NOTE: ALWAYS USE ORIGINAL EQUIPMENT PARTS.  
Use of service/replacement parts other than original  
equipment parts may void your warranty.

ALL UNNUMBERED  
ITEMS ARE INTERCHANGEABLE  
WITH OPPOSITE SIDE

# MOTION DRIVE ASSEMBLY

KEY NO.	PART NO.	DESCRIPTION	QTY	
1		TRANSAXLE MST206-512A	1	
3	711669	SCREW, 5/16-18X2.50	4	
4	94620-876 711634	NUT, 5/16-18 WDFLLK	4	
		BRACKET, STABILIZER	1	
5	711606	SCREW, 5/16-18X.75	1	
6	710268	SCREW, 5/16-18X.75 WAHTAP	1	
9	94227	BRACKET, SHIFT	1	
10	711895	WASHER, .750X.250 TRANSAXLE	1	
11	710345	SCREW, 1/4-28X.75	1	
12	583409	WASHER, FLAT .391X1.00X.125	1	
13	71072	WASHER, FLAT .406X .81X.066	1	
14	711894	WASHER, FLAT .515X .88X.064	2	
15	711899	PIN, HAIR .53DIAX1.62LG	1	
16	690087	SHIFT LEVER	1	
17	711591	NUT, ADJ. 3/8-i 6	1	
18	94497	GRIP, LIFT 1/2"	1	
19	95424	SPRING, BRAKE	1	
20	711921	WASHER, FLAT.328X1.06X.062	1	
21	690016	ROD, CLUTCH	1	
22	711903	PIN, CLEVIS	1	
23	95290	LATCH, PARK BRAKE	1	
24	21544	PEDAL, BRAKE/CLUTCH	1	
25	762223	SPRING	1	
26	711522	SPRING, TENSION *	1	
28	22053	RING, RETEX	1	
29	690026	PULLEY, 9.0 OD V4L	1	
30	50795	KEY, HI-PRO 606	1	
31	711905	SCREW, 3/8-16X1.25	1	
32	52928	KEY, SQUARE	2	
33	95531	PULLEY, IDLER	1	
35	94238-876	ASSY, IDLER ARM TRACTION	1	
	710088	FLATWASHER	2	
	711904	WASHER, FLAT .755ID	6	
	711905	SCREW, 3/8-16X1.25	1	
	95418	SPACER, WHEEL	1	
	91179	PULLEY, IDLER 2.75 DIA	1	
	711920	NUT, 3/8-16 HWDFLLK	1	
	94608	BELT, V 4L 114.12	1	
	95531	PULLEY, IDLER V4L3.00X.710	1	
	690047	PARK BRAKE CONTROL ROD	1	
	711898	NUT, 5/16-18X3/8 ADJUSTING	1	
	690027	ROD, SHIFT LINK	1	
4	7	95419	1	
	48	710103	SPACER, 5/4IDX.050/.75	2
	49		PIN, HAIR .53DIAX1.62LG	1
	50	711899 711682	PIN, HAIR.38 DIAX1.64LG	1
	51	711897	PIN, COTTER .090 DIAX .75	1
	53	7.11897	PIN, COTTER .090 DIAX .75	1
	54	711897	PIN, COTTER .090 DIAX .75	1
	55	692290	TIRE & RIM	2
	55-i	338512	VALVE S T E M	1
	55-2	336524	RIM, CARL	1
	55-3	338526	TIRE, 20X8X8	1
	57	94618	HUBCAP, AXLE SHAFT	2
	58	335980	NOT USED ON THIS UNIT	
	58	335980	CAP, DUMP VALVE ROD	1
	61	712067	SCREW GUIDE	1
	62	711633	NUT, 5/16-18 HEXWDFLLK WHIZ	1
	63	180016	SCREW, 1/4-20X .50	1
	64	711742	RETAINER, WIRE	1
	65	780285	NUT, 1/4-20 WDFLWHIZ-LK	1

\* CONTACT YOUR NEAREST TRANSAXLE DEALER FOR PARTS AND SERVICE.

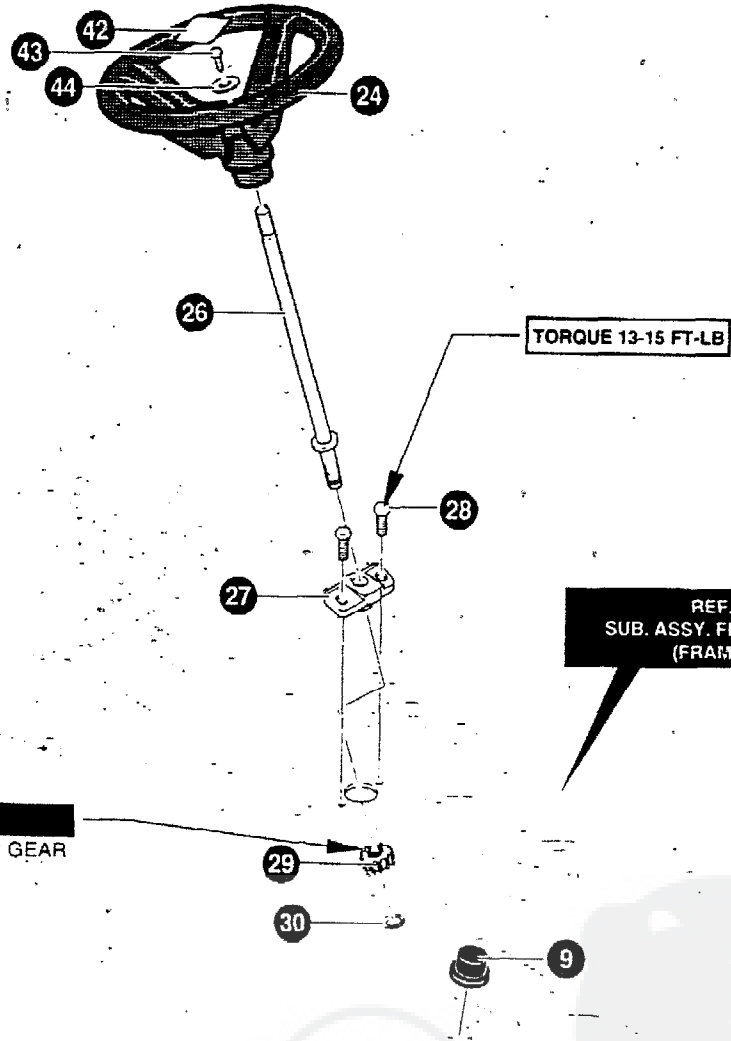

**NOTE**  
GREASE APPLIED TO TEETH ON GEAR

**NOTE**  
KEY# 32 8 33 ARE OPTIONAL. DEPENDS ON UNIT

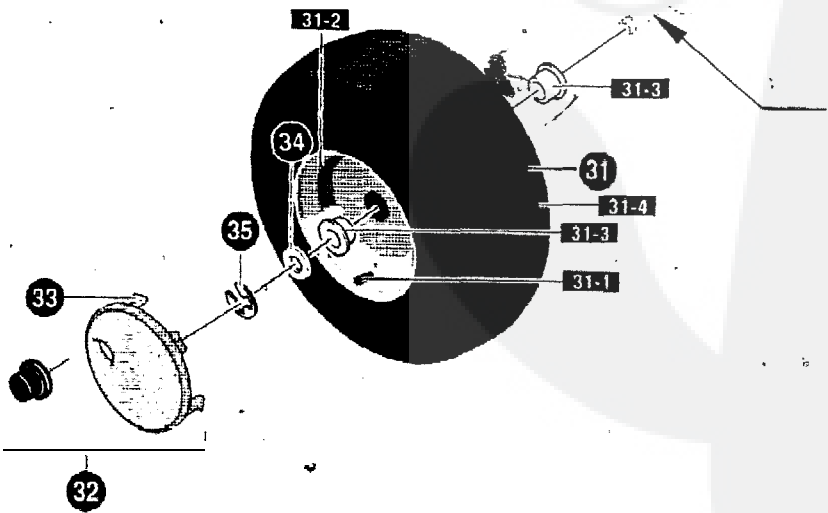

**NOTE**  
GREASE APPLIED TO SPINDLE SHAFT

**NOTE:** ALWAYS USE ORIGINAL EQUIPMENT PARTS. Use of service/replacement parts other than original equipment parts may void your warranty.

ALL UNNUMBERED ITEMS ARE INTERCHANGEABLE WITH OPPOSITE SIDE



# STEERING ASSEMBLY

KEY NO.	PART NO.	DESCRIPTION	QTY
9	94618	DUST HUB CAP	2
24	95185	STEERING WHEEL	1
26	94520	SHAFT, STEERING	1
27	94124	BEARING-LOWER	1
28	711606	SCREW, 5/16-18X.75	2
29	94122	GEAR PINNION	1
30	710102	RING, RET E.	1
31	690049	TIRE&RIM, 15X6.0-6	2
31-1	338512	VALVE STEM	1
31-2	338517	RIM	1
31-3	338513	BEARING	1
3 1 - 4	338516	TIRE, 15X6X6	1
32	94618	HUBCAP, AXLE SHAFT	2
34	710088	WASHER, FLAT .765X1.62X.065	2
35	710103	E-RING	2
42	711326	INSERT, STEERING WHEEL HUB	1
43	711719	SCRW, 1/4-20X.75 HHC	1
44	711663	WASHER, FLAT .281X1.25X.06	1

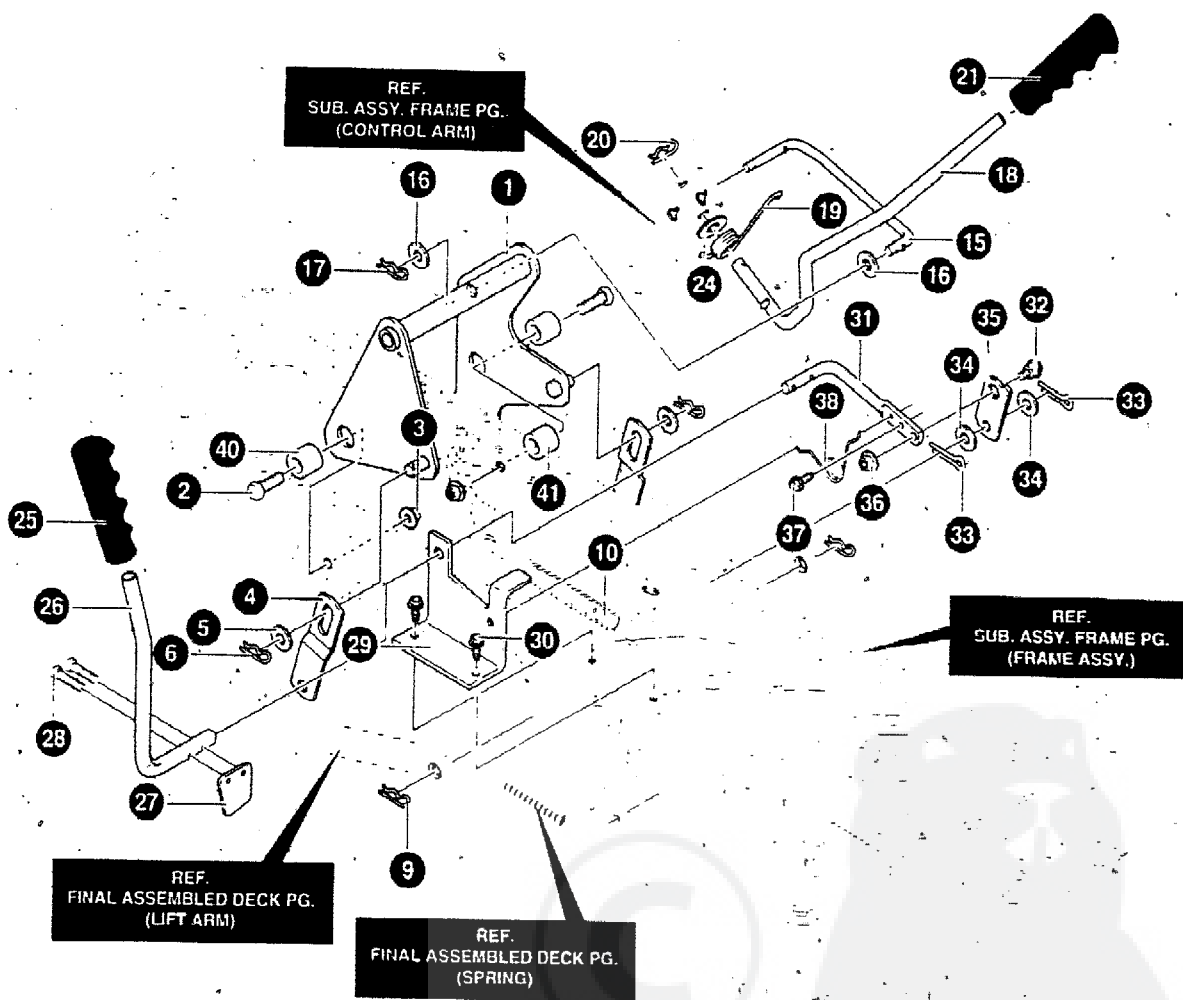

**NOTE: ALWAYS USE ORIGINAL EQUIPMENT PARTS.**  
 Use of service/replacement parts other than original equipment parts may void your warranty.

ALL UNNUMBERED  
 ITEMS ARE INTERCHANGEABLE  
 WITH OPPOSITE SIDE

343657A

# MOWER-SUSPENSION ASSEMBLY

KEY NO.	PART NO.	DESCRIPTION	QTY
1	95233-876	ASSEMBLY, LIFT ARM	1
2	711917	SCREW, 1/2-13X1.50	2
3	711916	NUT, 1/2-13 LOCK	2
4	94262-876	BRACKET, LIFT LINK	2
5	711617	WASHER&AT	2
6	711676	PIN, HAIR	2
9	711676	PIN, HAIR	2
19	710235	SPRING, EXTENSION 9.82X1.01OD	1
15	711981	LINK -LIFT HANDLE	1
16	711617	WASH&R, FLAT	2
17	711676	PIN,HAIR	1
18	95296	HANDLE, LIFT	1
19	710111	TORSION SPRING	1
20	711676	PIN, HAIR	1
21	94497	GRIP,LIFT	1
24	711616	WASHER, FLAT .550X1.00X11	1
25	94496	GRIP	1
26	712034	PTO HANDLE	1
27	95264	ZINC PADDLE, SWITCH	1
28	711621	SCREW, THREAD FORM	2
29	94018-876	BRACKET, PTO	1
30	711606	SCREW, 5/16-18X.75	2
31	95283	ZINC LEVER, PTO	1
32	711613	BOLT, .50X.75 HSSH 3/8-16	1
33	711659	PIN, HAIR	2
34	711615	WASHER, FLAT .518X.87X1 6	2
35	95282	ZINC LINK PTO	1
36	711622	NUT, 3/8-16 HWDFLLK MACK	1
37	711606	SCREW, 5/16-18X.75	1
38	710141	TORSION SPRING	1
40	94309	SPACER	2
41	56150	SPACER, SLEEVE	1

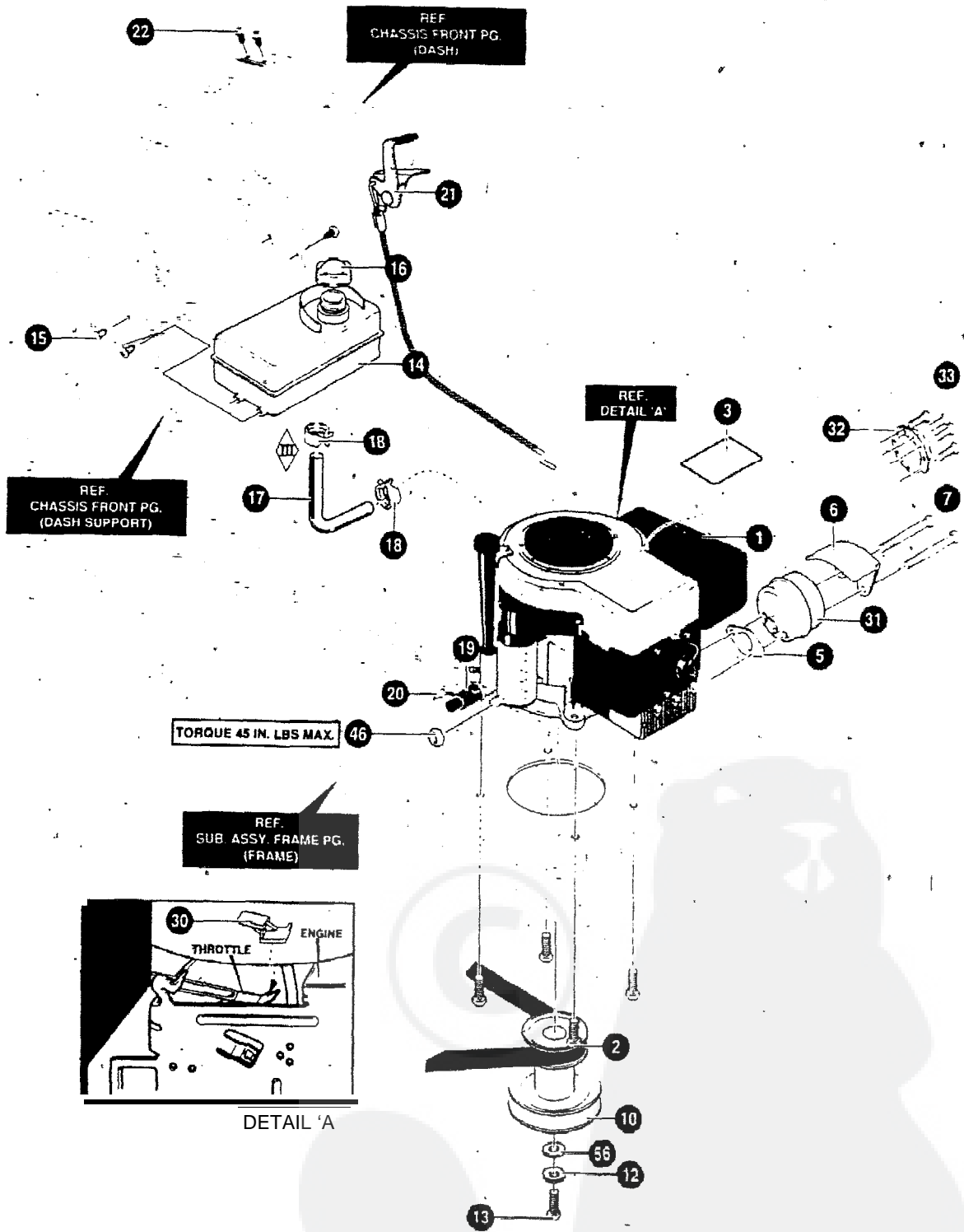

NOTE: ALWAYS USE ORIGINAL EQUIPMENT PARTS.  
 Use of service/replacement parts other than original  
 equipment parts may void your warranty.

ALL UNNUMBERED  
 ITEMS ARE INTERCHANGEABLE  
 WITH OPPOSITE SIDE

343697A

# ENGINE & CONTROL ASSEMBLY

KEY PART NO.	PART NO.	DESCRIPTION	QTY
1	.	ENGINE	1
2	710199	SCREW, 3/8-16X1.25	4
3	712108.	DECAL, ENGINE	1
5	91309	<b>GASKET, MUFFLER</b>	1
6	71277	HEAT SHIELD	1
7	712065	SCREW, 5/16-18 X 4.125	2
10	95383	STACK PULLEY	1
12	<b>120383</b>	WASHER, SPLITLOCK	<b>1</b>
13	710248	SCREW, 7/16-20 X 1.50	1
1	4 94073.	FUEL TANK	1
15	711681	<b>SCREW, 15TPIX PANHTAP</b>	4
16	92317.	FUEL CAP	1
1	7 41007	TUBING, 25 X .50	14.5
18	47345	CLAMP, FUEL LINE	2
19	325547	OIL DRAIN VALVE ASSEMBLY	1
20	327422	CAP, OIL DRAIN VALVE	1
21	94361'	<b>THROTTLE CONTROL</b>	<b>1</b>
22	711637.	SCREW, #8-16 X .38	2
30	94951	SPEED CLIP	1
31	<b>91271</b>	MUFFLER	1
32	<b>23740</b>	DEFLECTOR EXHAUST	1
33	712070	SCREW, #8-32X .38'	1
46	<b>711601</b>	NUT, 1/4-20 REGHJAM	1
56	710247	WASHER	1

. SEE ENGINE MANUAL

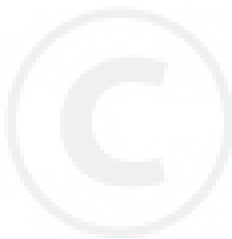

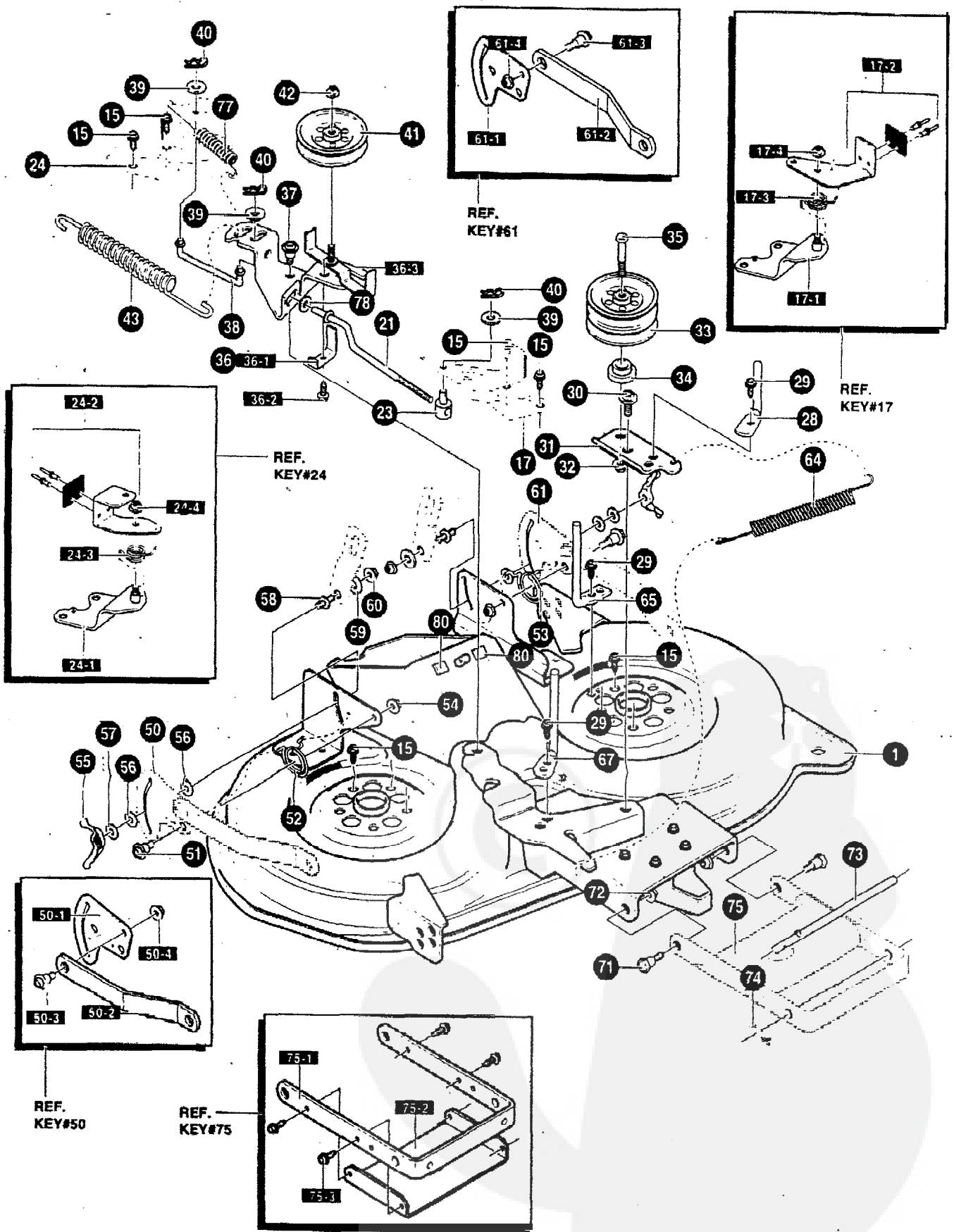

NOTE: ALWAYS USE ORIGINAL EQUIPMENT PARTS. Use of service/replacement parts other than original equipment parts may void your warranty.

ALL UNNUMBERED ITEMS ARE INTERCHANGEABLE WITH OPPOSITE SIDE

343840A

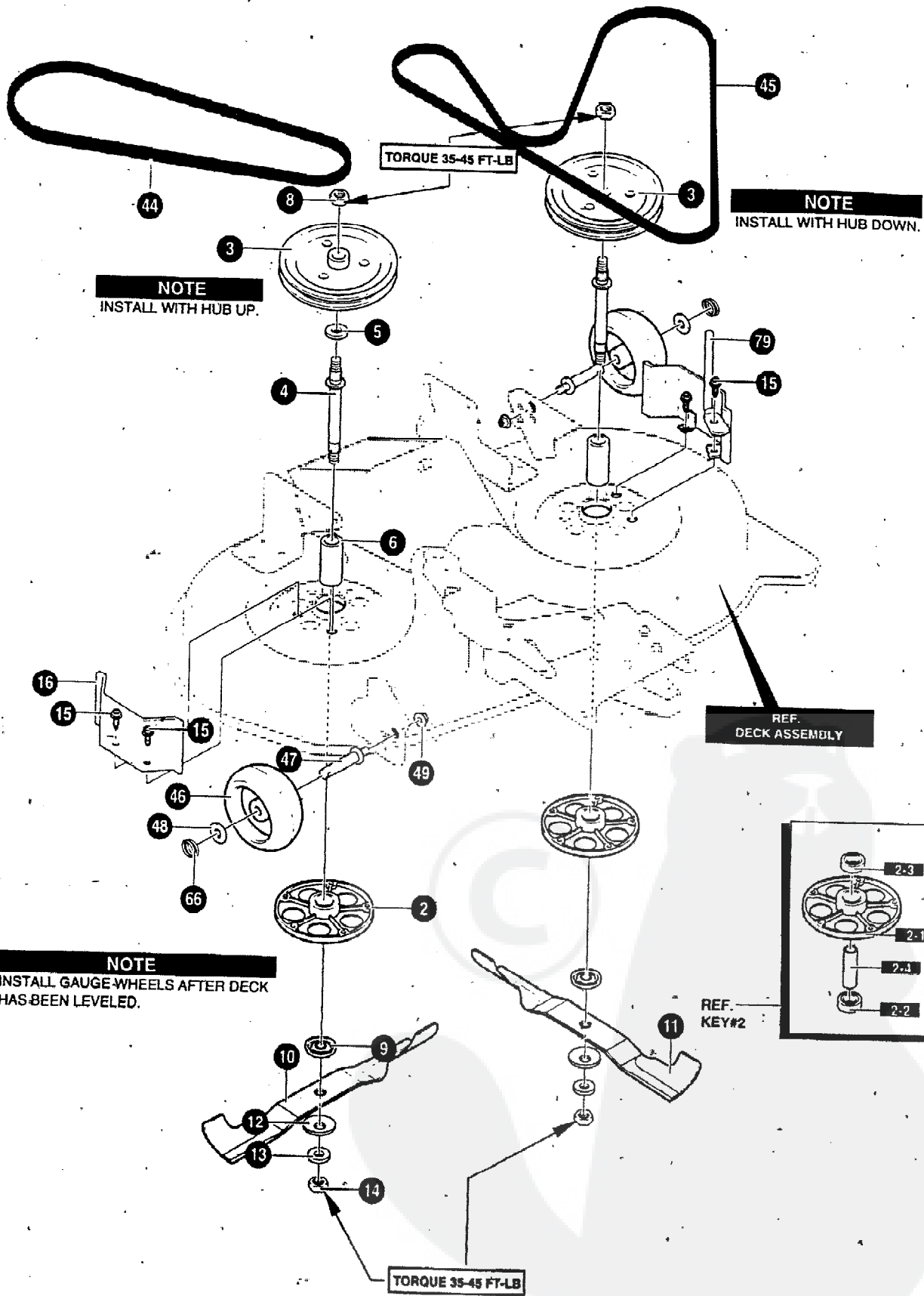

**NOTE:** ALWAYS USE ORIGINAL EQUIPMENT PARTS. Use of service/replacement parts other than original equipment parts may void your warranty.

ALL UNNUMBERED ITEMS ARE INTERCHANGEABLE WITH OPPOSITE SIDE



KEY NO.	PART NO.	DESCRIPTION	QTY
2	94305	ASSEMBLY, JACKSHAFT HOUSING	2
3	690020	PULLEY, DECK	2
4	91922	JACKSHAFT	2
5	710117	WASHER, FLAT	1
6	91903	SPACER, .625X.875X1.91	2
8	711910	NUT, 9/16-18	2
9	94207	ADAPTER, DECK/BLADE 40"	2
10	95096	BLADE, RH REBA HI-LIFT	1
11	95097	BLADE, LH REBA HI-LIFT	1
12	710118	WASHER, BELLVILLE	2
13	710117	WASHER, FLAT	2
14	711910	NUT, 9/16-18	2
15	711911	SCREW, 3/8-16X1.00	10
16	94288-876	COVER PULLEY	2
44	710231	BELT, V 46.5LG	1
45	690071	BELT, DECK	1
46	92683	GAUGE WHEEL	2
47	711746	BOLT, SHOULDER	2
4 8	711615	WASHER, FLAT	2
49	711622	NUT, 3/8-16	2
66	711764	PIN, CIRCLE	2
79	95280	ROD, BELT GUIDE	1

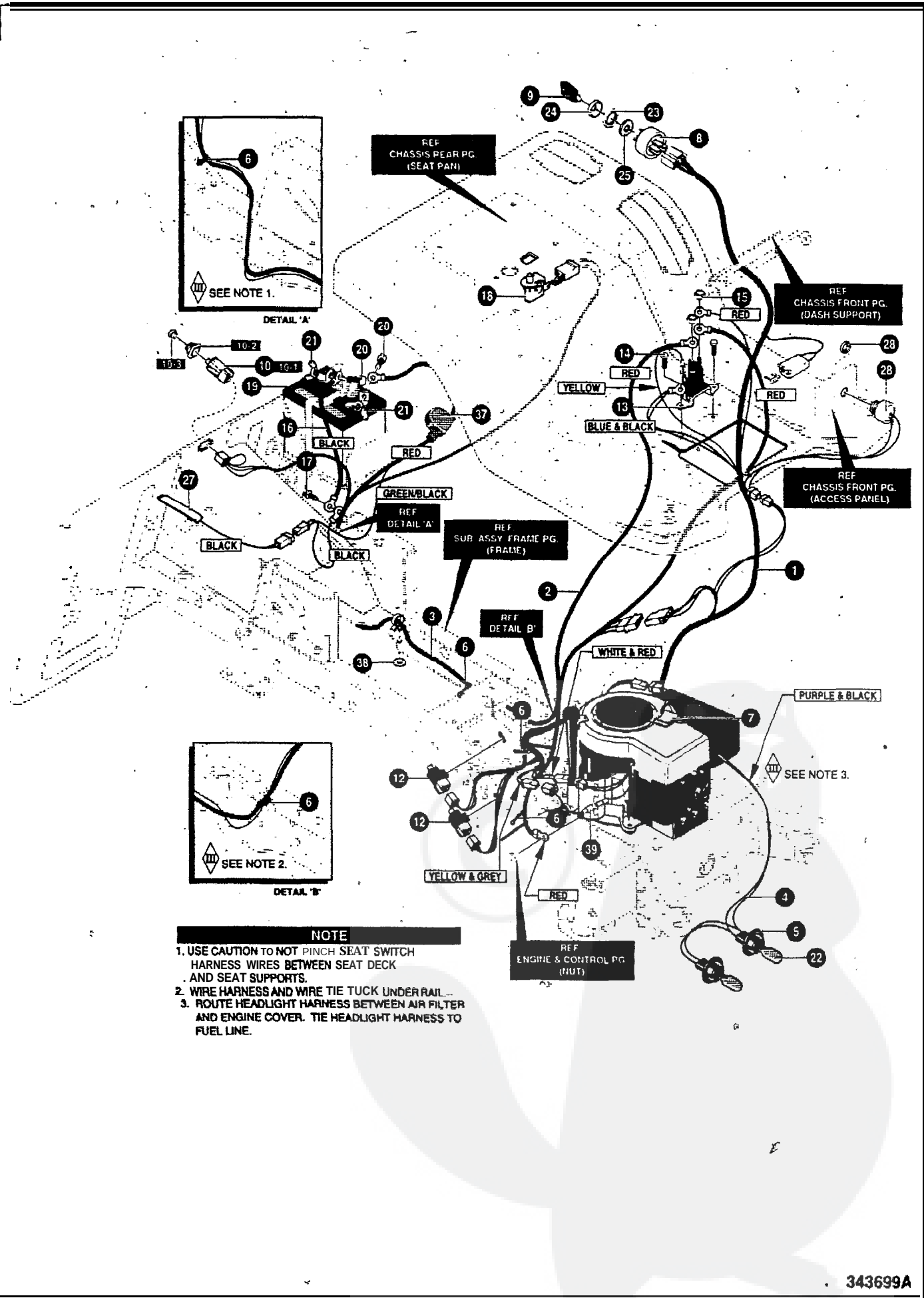

**NOTE**

1. USE CAUTION TO NOT PINCH SEAT SWITCH HARNESS WIRES BETWEEN SEAT DECK AND SEAT SUPPORTS.
2. WIRE HARNESS AND WIRE TIE TUCK UNDER RAIL.
3. ROUTE HEADLIGHT HARNESS BETWEEN AIR FILTER AND ENGINE COVER. TIE HEADLIGHT HARNESS TO FUEL LINE.

KEY NO.	PART NO.	DESCRIPTION	QTY
1	95380	WIRE HARNESS	1
2	711579	WIRE, LEAD	1
3	95381	REAR HARNESS	1
4	340513	WIRE HARNESS FOR HEADLIGHTS	1
5	92372	SOCKET, LAMP	2
6	57444	TIE; CABLE BLACK NYLON 5.62L	5
7	55939	WIRE CLIP, ADHESIVE	1
8	94878	SWITCH, IGNITION---	1
9	327350	KEY, IGNITION	1
10	690106	ASSY, SWITCH, DOUBLE	1
10-1	320082	SWITCH, DOUBLE	1
10-2	690074	BOOT, SWITCH	1
10-3	690075	CAP, SWITCH	1
12	94136	SWITCH LIMIT	2
13	94613	SOLENOID	1
14	711619	SCREW, 1/4X.50	2
15	711632	NUT, 1/4-20 HEXNYC	2
16	95420	WIRE, GROUND	1
17	711619	SCREW, 1/4X.50	1
18	94158	SWITCH, SEAT	1
19	302257	BATTERY 12V 7 PLATE	1
20	711660	BOLT, 1/4-20X.63	2
21	711636	NUT, WING 1/4-20	2
22	780216	BULB, HEADLIGHT	1
23	327352	NUT, 5/8-8	1
24	300194	BOOT; IGNITION SWITCH	1
25	136557	WASHER, REGINTLK	1
26	342126	CABLE- TIE	1
27	95330	TAPE SWITCH	1
28	95391	BUZZER, FOR BAG FULL	1
37	335417	BATTERY BOOT	1
36	303041	FIAT WASHER	1
39	94348	HARNESS ADAPTER	1
	302031	15 AMP FUSE	1

WIRING SCHEMATIC

