

REF.  
CHASSIS REAR PG.  
(SEAT DECK ASSY.)

NOTE: ALWAYS USE ORIGINAL EQUIPMENT PARTS.  
Use of service/replacement parts other than original  
equipment parts may void your warranty.

ALL UNNUMBERED  
ITEMS ARE INTERCHANGEABLE  
WITH OPPOSITE SIDE

KEY #	PART #	DESCRIPTION	QTY
1	95432-853	BRACKET/HOOD RH	1
2	95433-853	BRACKET/HOOD LH	1
3	710079	SCREW, 5/16-18X.75HHWATAPSGIBP	4
4	95427	DASH	1
5	710282	SCREW, 1/4-14X.75PHPANTAPABBL	2
8	180020	SCREW, 1/4-20X.75 HHC	2
9	120392	WASHER, FLAT .281X .63X.065	4
10	782585	NUT, 1/4-20 REG HEX CTRLK	2
11	341569-860	ASM. LOWER CONSOLE	1
11-1	95425	TOWER, LOWER DASH	1
11-2	95426	SUPPORT, STEERING/PTO NLT	1
114	710264	SCREW, 1/4-20X.50 WAHHTAP	4
11-4	9 5 4 0 6	ROD, DASH BRACE	1
11-5	710264	SCREW, 1/4-20X.50 WAHHTAP	2
12	710079	SCREW, 5/16-18X.75HHWATAPSGIBP	4
15	94638-860	PANEL; ACCESS	1
16	710196	SCREW, 1 O-24	2
17	328278	HOOD	1
18	302670	LEN&HEADLAMP	1
19	308492	FOIL, LENS HOOD REFLECTOR	1
20	322700	DECAL, TAPE	1
21	301452	FOIL, HEAT REFLECTOR	2
22	300317	CLEVIS PIN .375DIAX.81LG	2
23	710343	HAIR PIN .038DIAX1.64LG	2
24	6711	PLASTIC WASHER .315X.75X.064	4
25	95404	BUSHING, STEERING SHAFT	1
	711091	OPERATOR'S MANUAL	

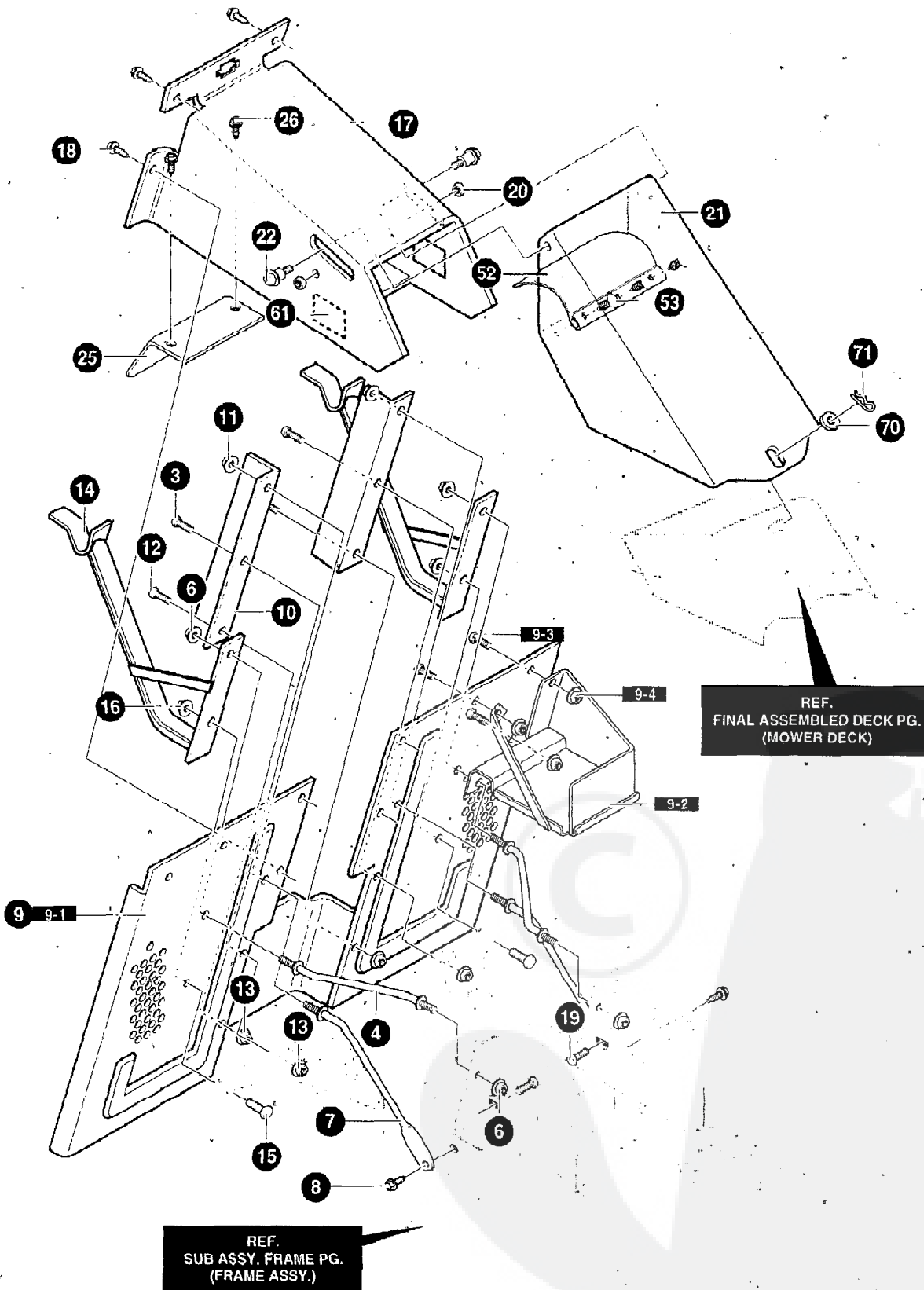

NOTE: ALWAYS USE ORIGINAL EQUIPMENT PARTS.  
 Use of service/replacement parts other than original  
 equipment parts may void your warranty.

ALL UNNUMBERED  
 ITEMS ARE INTERCHANGEABLE  
 WITH OPPOSITE SIDE

KEY N O .	PART NO.	DESCRIPTION	QTY
3	710079	SCREW, 5/16-18X.75HHWATAP	2
4	94625	ROD, BRACE	2
6	45171	NUT, 3/8-16 HWDFL WHIZ-LOCK	4
7	94231	ROD, BRACE	2
8	710079	SCREW, 5/16-18X.75HHWATAP	2
9	34-1493-853	BACK PLATE/BATTERY ASSEMBLY	1
9-1	94569	BACK PLATE ASSEMBLY REBA	1
9-2	94563	BATTERY TRAY WELD ASM.	1
9-3	180073'	SCREW, 5/16-18X.50 HHC	3
9-4	45174	NUT, 5/16-18 HEXWDFLLK WHIZ	3
10	94232-853	BRACE, BACK PLATE	2
11	45171	NUT, 3/8-16 HWDFLLK WHIZ	2
12	328154	SCREW, 5/16-18X1.0WDFLLK	4
13	45174	NUT, 5/16-18 WDFLLK (15X88)	4
14	94637' 853'	ASSY, COLLECTOR SUPPORT	2
15	328' 154	SCREW, 5/16-18X1.0WDFLLK	2
16	45174	NUT, 5/16-18HEXWDFLLK WHIZ	2
17	94295-853	CHUTE WELD ASM. UPPER	1
18	710079	SCREW, 5/16-18X.75HHWATAP	4
19	57101	BOLT, 5/16-18X.75 CARR	2
20	45174	NUT, 5/16-18 HEXWDFLLK WHIZ	2
21	94970-853	CHUTE WELD ASM. MIDDLE	1
22	51601	BOLT, .500X.453 HSH 3/8-16	2
25	94263-853	COVER, T-AXLE SHIELD	1
26	710264	SCREW, 1/4-20X.50 WAHHTAP	2
52	94264	FLAP, CHUTE REBA	1
53	309235	RATCHET FASTENER	3

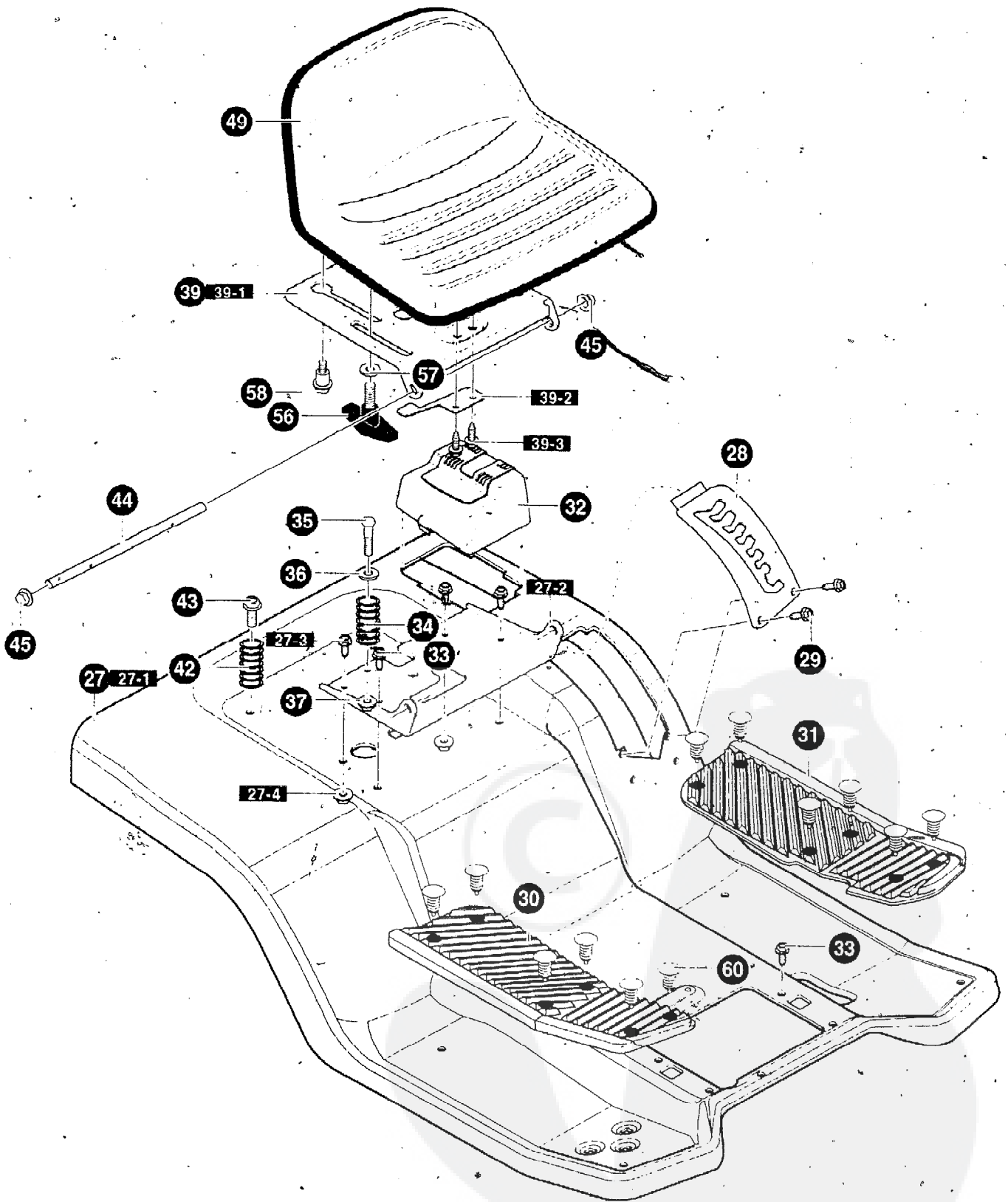

VOTE: ALWAYS USE ORIGINAL EQUIPMENT PARTS.  
 Use of service/replacement parts other than original  
 equipment parts may void your warranty.

ALL UNNUMBERED  
 ITEMS ARE INTERCHANGEABLE  
 WITH OPPOSITE SIDE

KEY NO.	PART NO.	DESCRIPTION"	QTY
27	341495-860	ASM.SEAT DECK PEDAL GEAR REBA	1
27-1	94311	S E A T DECK,GEAR DRIVE	1
27-2	94153	BRACKET; PIVOT SEAT	1
27-3	7 1 0 2 7 9	SCREW, 5/16-18X .625	2
27-4	7 1 0 2 0 5	NUT, 5/16-18WDFLLK (15X88)	2
28	94243-853	PLATE, LIFT DETENT	1
29	710196	SCREW, 1 0-24X.500TRSEGI	2
30	9 5 4 0 9	FOOTPAD RH	1
3 1	95408	FOOT PAD LH	1
32	94200	COVER, BATTERY	1
33	710079	SCREW,5416-18X.75HHWATAP	3
34	710136	SPRING, COMPRESS 4.57LG X 1.17	1
3 5	710093	BOLT,SHOULDER 1/4-20NC-2A(9X55)	1
36	94155'	WASHER CUP ZINC	1
37	71 0280	NUT, 1/4-20 WDFLLK (15X89)	1
3 9	341494-860	SUB ASM. SEAT SUPPORT REBA	1
39-1	94154	SUPPORT, SEAT	1
39-2	94057	SPRING - LEAF	1
39-3	-710264	SCREW, 1/4-20X .50 WAHHTAP	2
42	710109	SPRING,COMPRESS 2.43LG (164X30 )	2
43	7 1 0 0 7 9	SCREW, 5/16-18X.75HHWATAP	2
44	94156	ZINC HINGE SEAT PIVOT	1
45	710192	NUT, PUSH CAP .375 (28X23)	2
49'	95415	SEAT MSCV1500	1
56	94160	BOLT, WING 5/16-18	2
57	7102'81	WASHER, FLAT,344X.62X.06	2
58	710101	BOLT, SHOULDER 5/16-18NC (9X56)	2
60	309235	FASTENER,RATCHET	6
61-	318197'	FAD, ADHESIVE	3
70	710116	WASHER, FLAT	1
71	710343	PIN, HAIR	1

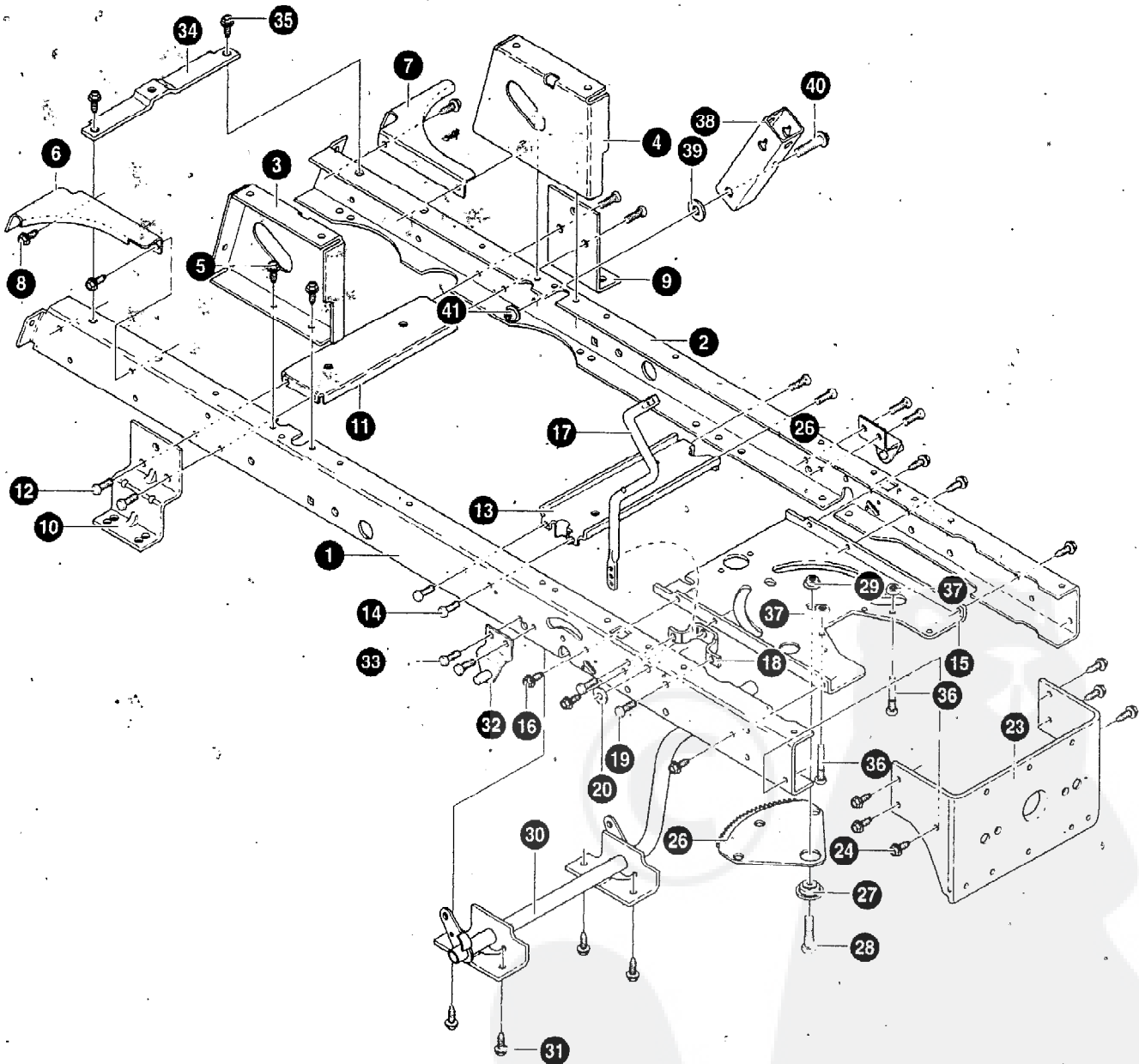

NOTE: ALWAYS USE ORIGINAL EQUIPMENT PARTS.  
Use of service/replacement parts other than original  
equipment parts may void your warranty.

ALL UNNUMBERED  
ITEMS ARE INTERCHANGEABLE  
WITH OPPOSITE SIDE

340370A

KEY PART NO.	PART NO.	DESCRIPTION	QTY
1	94564	FRAME,RAIL RH REBA	1
2	94565	FRAME,RAIL LH REBA	1
3	94634	SUPPORT,SEAT RH	1
4	94633	SUPPORT,SEAT LH	1
5	710079	SCREW,5/16-18X.75HHWATAP	4
6	94561	BRACE, BACKPLATE RH	1
7	94562	BRACE, BACKPLATE LH	1
8	710079	SCREW, 5/16-18X.75HHWATAP	4
9	94008	BRACKET, TRANS AXLE	1
10	94234	BRACKET,T/A RH-VST, LH-VST	1
11	94236	ASSY, IDLER MOUNT, REAR	1
12	710079	SCREW, 5/16-18X.75HHWATAP	4
13	94237	ASM. IDLER MOUNT,FRONT.	1
14	710079	SCREW, 5/16-18X.75HHWATAP	4
15	94003	PLATE,STEERING MOUNTING	1
16	710079	SCREW, 5/16-18X.75HHWATAP	-6
17	94019	CRANK, PTO (DRILLED)	1
18	94005	BRACKET, BELL CRANK	1
19	710079	SCREW, 5/16-18X.75HHWATAP	2
20	120395	WASHER, FIAT .469X .92X.065	1
23	94013	BRACKET, HANGER REAR	1
24	710079	SCREW, 5/16-18X.75HHWATAP	6
26	94121	GEAR, SECTOR	1
27	94123	BEARING, SECTOR GEAR	1
28	710312	SCREW, 5/16-18X1.00	1
29	710105	NUT, 5/16-18 HWDFLLK (15X113)	1
30	94241	ASM.CLUTCH/BRAKE PEDAL	1
31	710079	SCREW, 5/16-18X.75HHWATAP	4
32	94285	BRACKET SUSPENSION ASM.	2
33	710079	SCREW, 5/16-18X.75HHWATAP	4
34	94566	BRACE, RAIL	1
35	710079	SCREW, 5/16-18X.75HHWATAP	2
36	93349	SCREW GUIDE 5/16-18	2
37	710204	NUT,5/16-18 HEXWDFLLK WHIZ PL	2
38	94015	BRACKET, PIVOT	1
39	845	WASHER, FLAT .390X1.25X.119	1
40	710000	BOLT, .562X1.563 HSH 3/8-16	1
41	710140	NUT,3/8-16HWDFLLK MACK 15X84	1



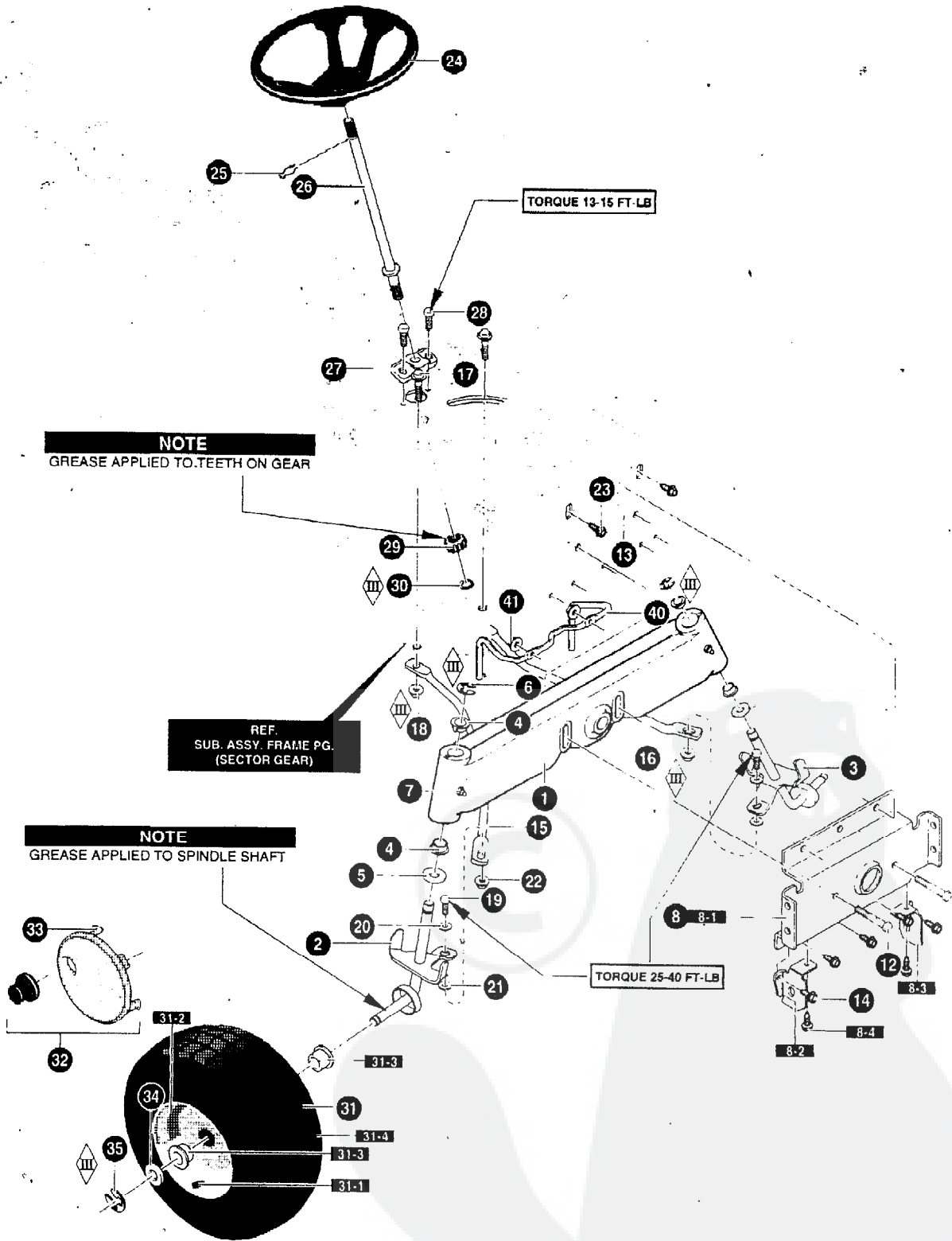

NOTE: ALWAYS USE ORIGINAL EQUIPMENT PARTS. Use of service/replacement parts other than original equipment parts may void your warranty.

ALL UNNUMBERED ITEMS ARE INTERCHANGEABLE WITH OPPOSITE SIDE

3405978

KEY NO.	PART NO.	DESCRIPTION	QTY
1	95405853	AXLE, CAST MACHINED	1
2	94178-853	SPINDLE,RH MO#94178	1
2-1	94014	SPINDLE AXLE	1
2-2	94125	ARM, STEERING RH	1
2-3	623168	DUST CUP	1
3	94179-853	SPINDLE LH,WELD ASSEMBLY	1
3-1	94014	SPINDLE AXLE	1
3-2	94126	ARM, STEERING RH	1
3-3	623168	DUST CUP	1
4	92527	BEARING, SPINDLE	4
5	710129	WASHER,.766 ID X 1.62ID16GA	2
6	710103	E-RING .574IDX.050/.750SH 11 X3	2
7	706	ZERK, GREASE FITTING	2
8	341491-853	ASM.FRONT AXLE/DECK HANGER	1
8-1	94007	HANGER, AXLE	1
8-2	94290	HANGER,DECK RH	1
8-3	94289	HANGER,DECK LH	1
8-4	710079	SCREW, 5/16-18X.75HHWATAPSGIBP	2
12	180113	SCREW, 5/16-18X3.00	2
13	710205	NUT, 5/16-18 WDFLLK (15X883 Z	2
14	710079	SCREW, 5/16-18X.75HHWATAPSGIBP	2
15	94020-853	DRAG LINK RH	1
16	9402 1-853	DRAGLINK, LH	1
17	710440	BOLT,HHSH (9X57)	2
18	710140	NUT,3/8-16HWDFLLK MACK 15X84	2
19	710082	SCREW, 3/8-16X1.5	2
20	710083	WASHER, FLAT .391X1.00X.083	2
21	710142	WASHER, FLAT.406X.81X16GA	2
2 2	710140	NUT,3/8-16HWDFLLK MACK 15X84 Z	2
23	710079	SCREW, 5/16-18X.75HHWATAPSGIBP	3
24	95441	STEERING WHEEL	1
26	94127	SHAFT, STEERING	1
27	94 124	BEARING-LOWER	1
28	710079	SCREW, 5/16-18X.75HHWATAPSGIBP	2
29	94122	GEAR PINNION	1
30	710102	RING, RET E.54ID.59SH (11X25)	1
31	692287	TIRE & RIM 15X6-6	2
31-1	3385 12	VALVE STEM	2
31-2	338517	RIM, CARLISLE	2
31-3	338513	BEARING	2
31-4	338516	TIRE, 15X6X6	2
32		NOT USED	
33		NOT USED	
34	710350	WASHER, FLAT .765X1.62X.065Z	2
35	36625	-RETAINING RING	2
40	94310	GUIDE-STACK PULLEY BELT	
41	45174	NUT, 5/16-18 HEXWDFLLK WHIZ	2

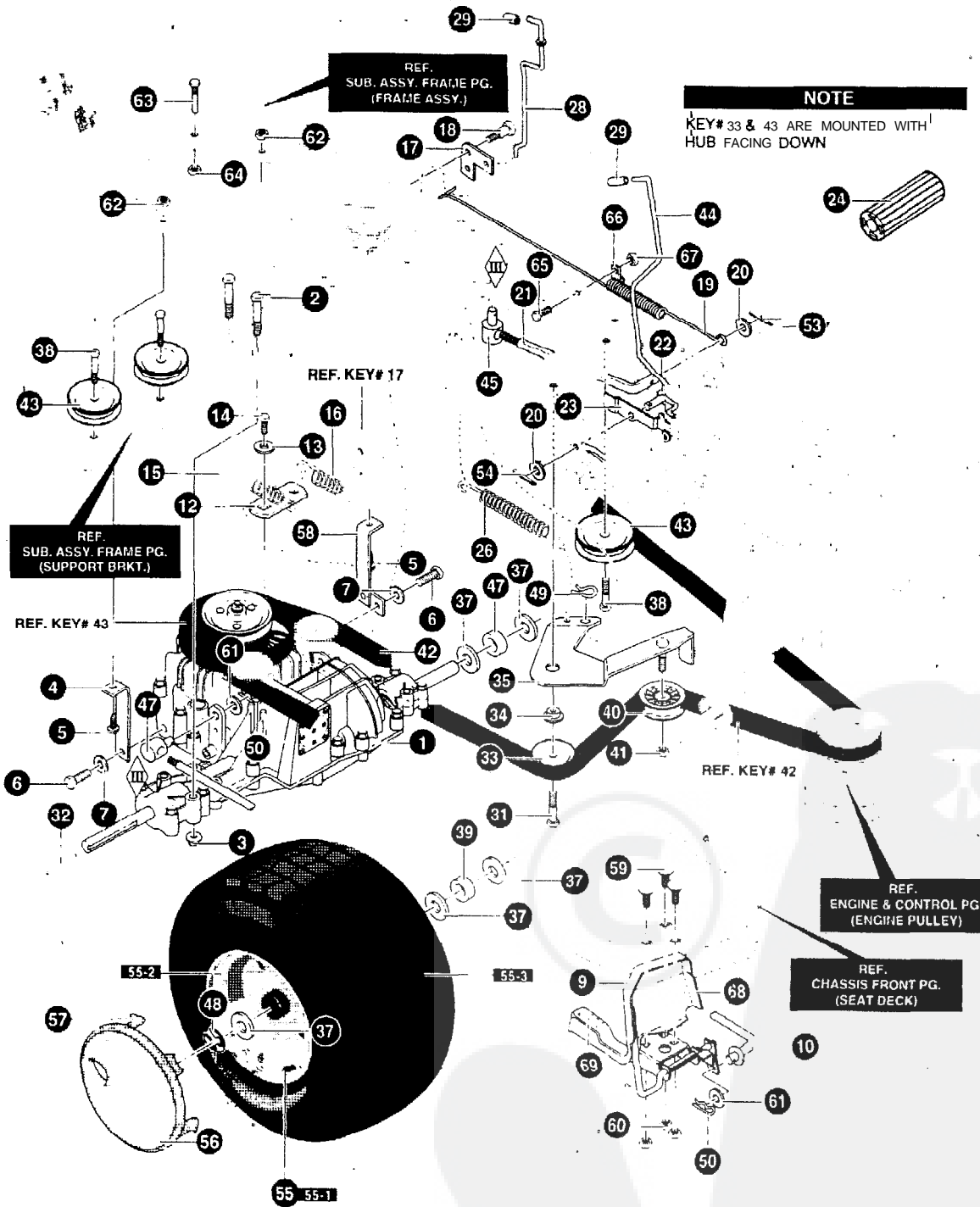

NOTE: ALWAYS USE ORIGINAL EQUIPMENT PARTS. Use of service/replacement parts other than original equipment parts may void your warranty.

ALL UNNUMBERED ITEMS ARE INTERCHANGEABLE WITH OPPOSITE SIDE

KEY NO.	PART NO.	DESCRIPTION	QTY
1		TRANSAXLE HYDRO VST205-025BM	1
2	180091	SCREW, 5/16-18X2.50 HHC	4
3	710205	NUT, 5/16-18 WDFLLK (15X88)	4
4	94224-853	BRACKET, STABILIZER	1
5	328154	SCREW, 5/16-18X1.0 WDFLLK	2
6	35498	SCREW, 5/16-18X.75 WAHHTAP	1
7	120638	WASHER, HVSPTLK .328X.60X.09	1
9	94422-853	PEDAL ASSEMBLY	
10	94304	FOOT CONTROL ROD	1
12	323212	SHIFT BRACKET	1
13	57157	WASHER, .750X.250SP-TRANSAXLE	
14	56255	SCREW, 1/4-28X.75NYLHH	
15	94622	SPRING, TRANSAXLE DISCONNECT	
16	326780	SPRING, TENSION 3/8ODX2.18X.055	1
17	9462 I-853	BRACKET, DISCONNECT LEVER	1
18	334126	BOLT, .437X.136 5/16-18	1
19	95424	SPRING, BRAKE 35.00	1
20	120394	WASHER, FIAT .406X.81 X.065	1
21	94573	ROD, CLUTCH	1
22	49332	PIN, CLEVIS.375DX.81LG	
23	94045	LATCH, PARK BRAKE	
24	21544	PEDAL, BRAKE/CLUTCH STD NLT	
26	710139	SPRING, TENS .09X .X5.	
27	782585	NUT, 1/4-20 REGHEXCTRLK	
28	94653	ROD, DISCONNECT CONTROL	1
29	335980	CAP, DUMP VALVE ROD .25IDX.75	1
31	710082	SCREW, 3/8-16X1.5HHCFLTHR5	1
32	52928	KEY, SQUARE.187SQX2.25LG	2
33	782964	PULLEY, IDLER #35374	
34	95423	SPACER, SHOULDER	1
35	94238-853	ASSY, IDLER ARM TRACTION	
36	310088	BOLT, .250X.312 HHSH 1/4-20	
37	710131	WASHER, FLAT .755X1.31X.075	6
38	180124	SCREW, 3/8-16X1.25	3
39	95421	SPACER, .87 X 1.78	2
40	91179	PULLEY, IDLER	1
41	45905	NUT, 3/8-16 HWDFLLK MACK	1
42	94609	BELT, V 4L 112.75	1
43	782964	PULLEY, IDLER #35374	3
44	94568	PARK BRAKE CONTROL ROD	1
45	710059	NUT, 5/16-18X3/8 ADJUSTING	1
47	92132	ADJUSTING NUT 1/2-13	1
48	36625	RING, RETEX .57X.05TRU5133-75	2
49	56180	PIN, HAIR .53DIAX1.62LG	
50	710343	PIN, HAIR .038DIAX1.64LG	1
53	121222	PIN, COTTER .090DIAX.75LG	1
54	121222	PIN, COTTER .090DIAX.75LG	1
55	692290	TIRE & RIM 20X8-8	2
55-1	338512	VALVE STEM	2
55-2	338524	RIM	2
55-3	338526	TIRE	2
56		NOT USED ON THIS UNIT	
57		NOT USED ON THIS UNIT	
58	94225-853	ASM. WELD, BKT STABILIZER LH	
59	57101	BOLT, 5/16-18X.75 CARR.	3
60	45174	NUT, 5/16-18 HXWDFLLK WHIZ	3
61	996425	FLATWASHER .515X.88X.064	2
62	45174	NUT, 5/16-18 HEXWDFLLK WHIZ	2
63	93349	SCREW GUIDE 5/16-18	1
64	710204	NUT, 5/16-18 HEXWDFLLK WHIZ	1
65	180016	SCREW, 1/4-20 X.50	
66	57569	RETAINER .31 IDX.62X.03 WIRE	
67	51335	NUT, 1/4-20 WDFLWHIZ-LK	
68	93248	PEDAL, SANDPAPER	1
69	93249	PAD, TOE SANDPAPER	

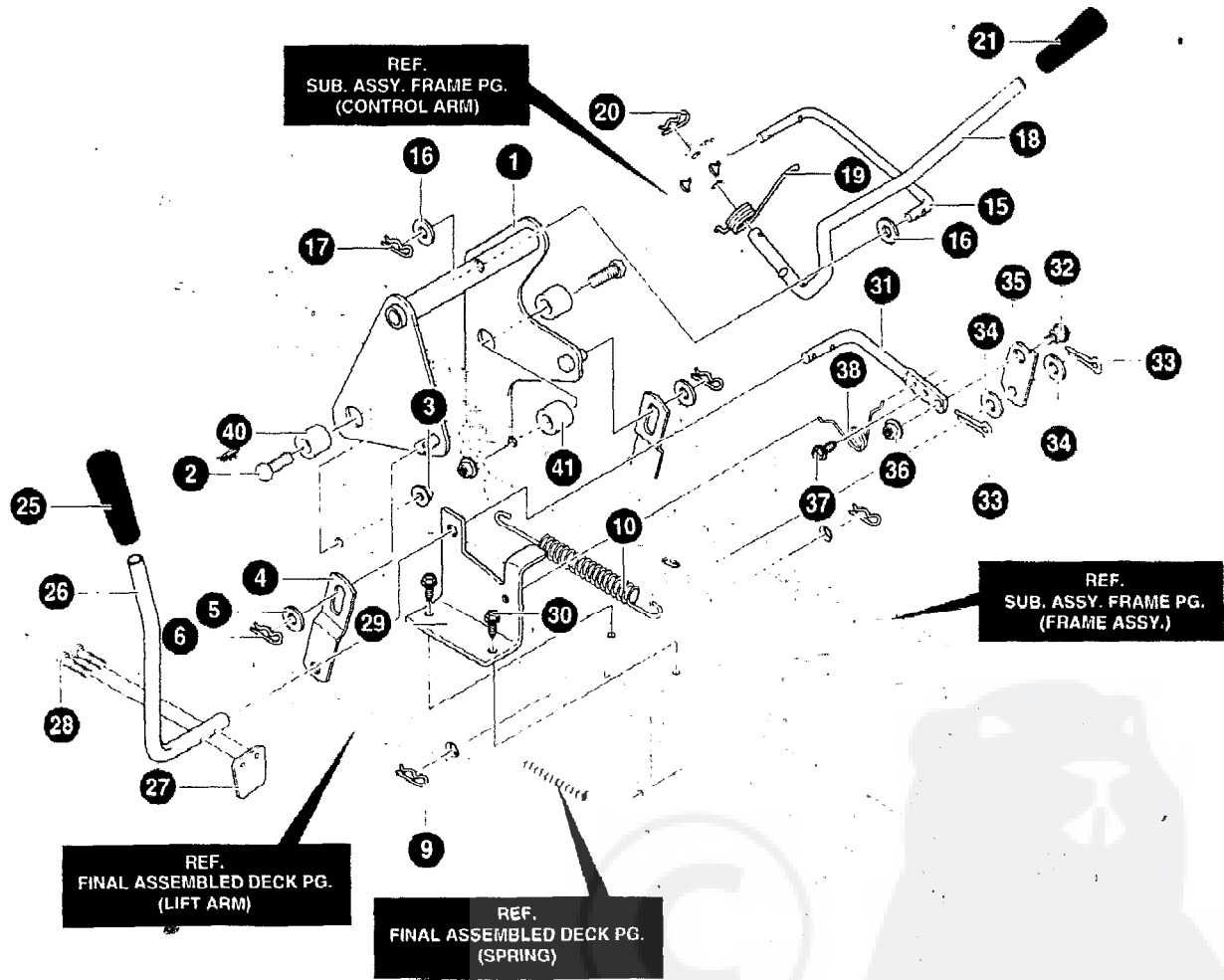

NOTE: ALWAYS USE ORIGINAL EQUIPMENT PARTS.  
Use of service/replacement parts other than original  
equipment parts may void your warranty.

ALL UNNUMBERED  
I-I-EMS ARE INTERCHANGEABLE  
WITH OPPOSITE SIDE

340859C

KEY NO.	PART NO.	DESCRIPTION	QTY
1	94299-853	LIFT ARM WELD ASSEMBLY	1
2	710222	SCREW, 1/2-13X1.50 (1X127)	2
3	710223	NUT, 1/2-13 LOCK (15X41)	2
4	94262-853	BRACKET, LIFT LINK	2
5	710119	FLATWASHER (17X91)	2
6	710343	PIN, HAIR .38DIA.X1.64LG	2
9	710108	PIN, HAIR (31X4)	2
10	710235	SPRING, EXTENSION 9.82X1 .01OD	1
15	94276	LINK, LIFT HANDLE	1
16	<b>710119</b>	FLATWASHER (17X91)	2
17	<b>710343</b>	PIN, HAIR .38DIA.X1.64LG	1
18	<b>94029</b>	HANDLE, LIFT	1
19	<b>710111</b>	TORSION SPRING .657LG(166X40)	1
20	<b>710108</b>	PIN:HAIR (31X4)	1
21	<b>92697</b>	GRIP, BLACK	1
24	<b>710116</b>	WASHER, FLAT.550X1.00X11 17X103	1
25	<b>92698</b>	GRIP, BLACK	1
26	<b>94826</b>	PTO LEVER	1
27	<b>94022</b>	PADDLE, SWITCH	1
28	<b>710137</b>	SCREW, THD FORMING	2
29	<b>94018-853</b>	BRACKET, PTO	1
30	<b>710079</b>	SCREW, 5/16-18X.75HHWATAP	2
31	<b>94017</b>	LEVER, PTO	1
32	<b>710098</b>	BOLT.50X.75 HSSH 3/8-16Z9X39	1
33	<b>36368</b>	PIN, HAIR .072DIA X1.13LG	2
34	<b>710115</b>	FLATWASHER .518X.87X16	2
35	<b>94004</b>	LINK PTO ZINC	1
36	<b>710140</b>	NUT, 3/8-16HWD FLLK MACK (15X84)	1
37	<b>710079'</b>	SCREW, 5/16-18X.75HHWATAP	1
38	<b>710141</b>	TORSION SPRING .33LG (166X39)	1
40	<b>94309</b>	SPACER.51 3 ID X .880 00	2
-41	<b>56159</b>	SPACER, SLEV .94X1.13X.531	1

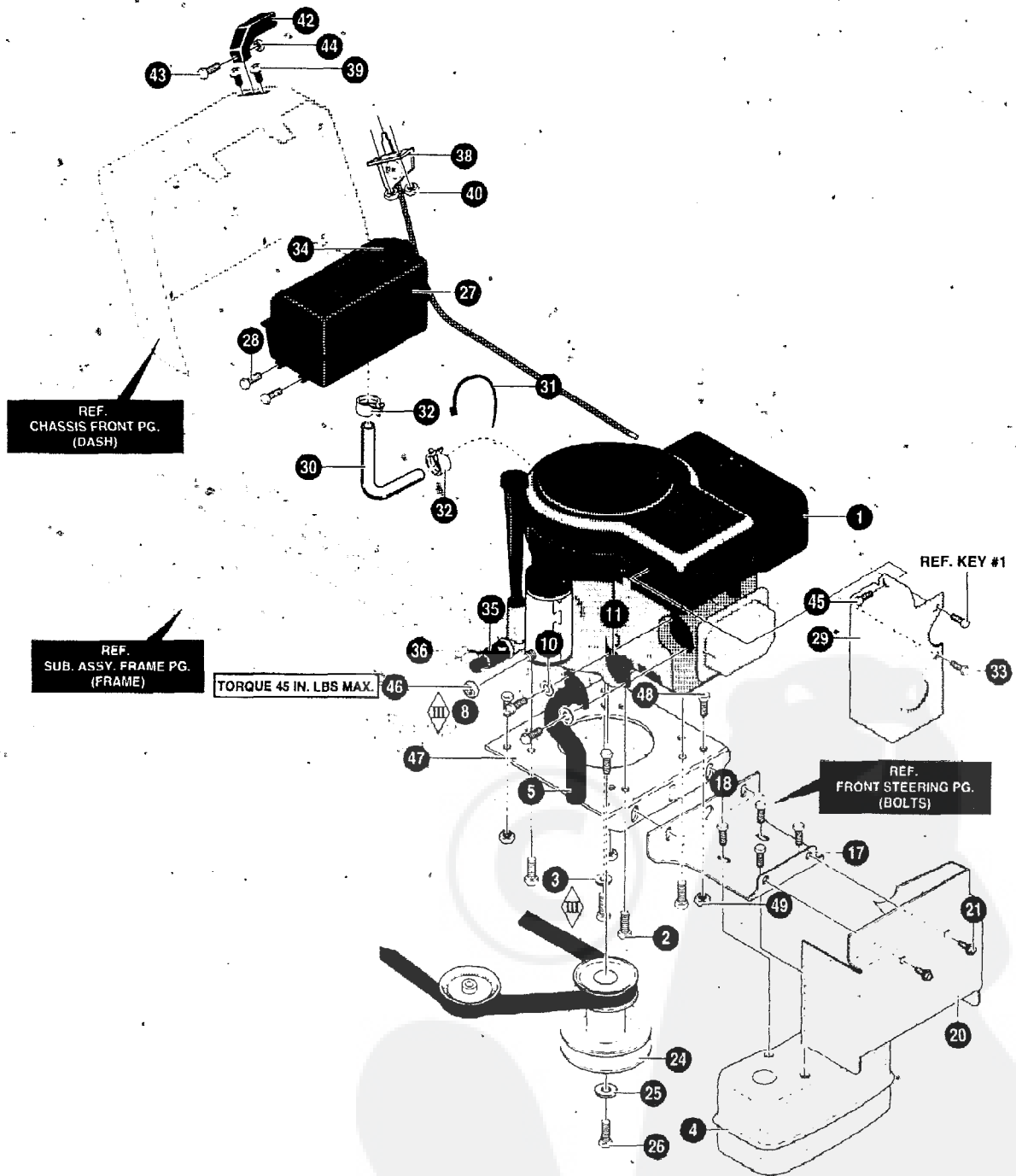

NOTE; ALWAYS USE ORIGINAL EQUIPMENT PARTS. Use of service replacement parts other than original equipment parts may void your warranty.

ALL UNNUMBERED ITEMS ARE INTERCHANGEABLE WITH OPPOSITE SIDE

341636A

KEY PART NO.	NO.	DESCRIPTION	QTY
1	(28N 707-D177-01) ENGINE	14.5HP B&S OHV(SEE ENGINE MANUAL)	1
2	50947	SCREW, 3/8-16X1.25 WAHHTAP	4
3	138489	WASHER, EXLK .384X.69X.04	1
4	94654	MUFFLER, SINGLE-CYLINDER	1
5	94657	EXHAUST TUBE	1
a	180077	SCREW, 5/16-18X.75	2
10	120638	WASHER, HVSP TLK.328X.60X.09	2
11	46708	GASKET, MUFFLER	1
17	94306-853	BRACKET, MUFFLER MOUNT	1
18	44811	SCREW 114-20X.75 WAHHTAP	4
20	95439-853	SHIELD, HEAT LOWER FRONT	1
21	710079	SCREW 5/16-18X.75HHWATAP	2
24	94308	PULLEY, ENGINE	1
25	1 2 0 3 8 3	WASHER, REGSPTLK	1
26	433146	SCREW 7/16-20X4.25	1
27	309853	FUEL TANK 1.5 GALWO/SENSOR	1
28	710246	SCREW, .15TPIX	4
29	333772-853	HEAT SHIELD	1
30	42258	TUBING, .25X.50 GAS LINE	72.00 IN.
31	57444	CABLE TIE	1
32	47345	CLAMP, FUEL LINE YELLOW	2
33	710264	SCREW, 1/4-20X.50 WAHHTAP	1
34	12501	FUEL CAP	1
35	325547	OIL DRAIN VALVE ASSEMBLY	1
36	327422	CAP,OIL DRAIN VALVE ASM.YELLOW	1
38	96906	THROTTLE CONTROL	1
39	155941	SCREW, 1 O-24X.63 PHFLTMA	2
40	308459	NUT #10-24 HXHDNYLK	2
42	300508	THROTTLE CONTROL KNOB	1
43	159585	SCREW, #8-32X.38 PHPNMA	1
44	120622	NUT, #8-32 REGHX	1
45	57366	SCREW 10-16X.50 DRILLTITE	1
-46	124818	NUT, 1/4-20 REGHXJAM	1
47	94006-853	PLATE, ENGINE	1
48	710079	SCREW, 5/16-18X.75 HHWATAP	4
49	710205	NUT, 5/16-18 WDFLLK (15X88)	4
50	94894	SPEED REDUCER	1



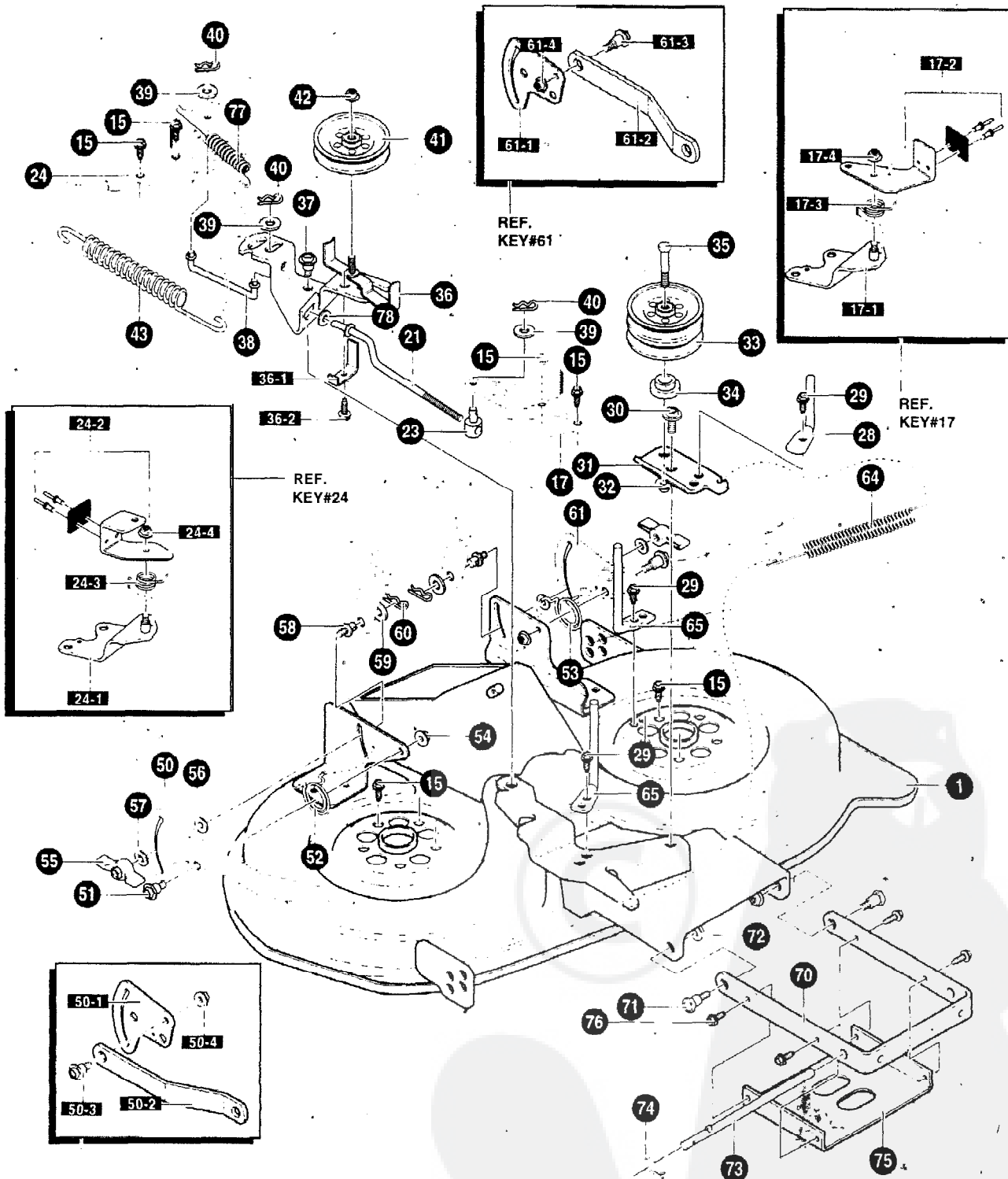

REF. KEY#61

REF. KEY#24

REF. KEY#17

REF. KEY #50

NOTE: ALWAYS USE ORIGINAL EQUIPMENT PARTS. Use of service replacement parts other than original equipment parts may void your warranty.

ALL UNNUMBERED ITEMS ARE INTERCHANGEABLE WITH OPPOSITE SIDE

KEY NO.	PART NO.	DESCRIPTION	QTY
	94303-853	WELD ASSEMBLY DECK	1
15	710265	SCREW, 3/8-16X1 .00 WAHHSPTAPPL	10
17	94665-853	BRAKE ARM ASSEMBLY LH	1
17-1	94293	BRAKE SUPPORT ASSEMBLY LH	1
17-2	94291	BRAKE ARM ASSEMBLY LH	1
17-3	710110	SPRING, TORSION (166X27)	1
17-4	710205	NUT, 5/16-18 WDFLLK (15X88)	1
21	94277	LINK, BRAKE LH	1
23	2 1 9 2 0	NUT,ADJ. 3/8-16TAP	1
24	94664-853	BRAKE ARM ASSEMBLY RH	1
24-1	94294	BRAKE SUPPORT ASSEMBLY RH	1
24-2	94292	BRAKE ARM ASSEMBLY RH	1
24-3	710077	SPRING, TORSION	1
24-4	710205	NUT, 5/16-18 WDFLLK (15X88)	1
28	94274	GUIDE, BELT REBA	1
29	710114	SCREW,5/16-18 .50HHTAP	3
30	7 1 0 0 9 8	BOLT.50X.75 HSH 3/8-16Z 9X39	1
31	94261-853	ARM, DOUBLE IDLER	1
32	710140	NUT,3/8-16HWDFLLK MACK 15X84	1
33	94279	PULLEY, IDLER DOUBLE VEE	1
34	94269	SPACER, REBA DECK	1
35	180138	SCREW, 3/8-16X3.00 HHC	1
36	94973-853	IDLER ARM ASSEMBLY	1
36-1	94312	SPRING,-GUIDE BELT	1
36-2	710264	SCREW, 1/4-20X.50 WAHHTAP	1
37	710098	BOLT.50X.75 HMSH 3/8-16Z 9X39	1
38	94278	LINK, BRAKE RH	1
39	316079	WASHER, FLAT .406X .82X.040	1
4 0	710343	PIN, HAIR .038-DIAX1.64LG	3
41	94280	PULLEY, V IDLER 4"	1
42	710140	NUT,3/8-16HWDFLLK MACK 15X84	1
43	710234	SPRING, EXTN 5.40X.71400	1
50	341593-853	PLATE - SUSPENSION ASSY	1
50-1	9 4 1 2 8	PLATE - SUSPENSION	1
50-2	94055	SUSPENSION BRKT REAR	1
50-3	710095	SHOULDER BOLT 3/8-16 (9X52)	1
50-4	710140	NUT, 3/8-16 MACK (15X84)	1
51	710094	BOLT, SHOULDER .375 (9X51)	2
52	710112	SPRING,TORSION .68LG RH (166X42)	1
53	710113	SPRING,TORSION .68LG LH (166X43)	1
54	710140	NUT,3/8-16HWDFLLK MACK (15X84)	2
55	94068	KNOB	2
56	94137	PAD, FRICTION	2
57	710195	WASHER (17X45)	2
58	94064	PIN, HANGER	2
59	710116	WASHER,FLAT.550X1.00X11 (17X103)	2
60	710343	PIN, HAIR	2
61	34 1594-853	ASM. PLATE REAR SUS BRKT LH	1
61-1	94128	PLATE - SUSPENSION	1
61-2	94055	SUSPENSION BRKT REAR	1
61-3	71 0095	SHOULDER BOLT 3/8-16 (9X52)	1
61-4	71'0140	NUT, 3/8-16 MACK (15X84)	1
64	710233	SPRING, EXTN 4.20X.750D	1
65	94275	GUIDE BELT	2
6 6	710930	PIN, CIRCLE	2
70	94058-853	BRACKET, FRT SUSPENSION	1
71	710094	BOLT, SHOULDER .375 (9X51)	2
72	710140	NUT,3/8-16HWDFLLK MACK (15X84)	2
73	94158	ZINC ROD, HANGER	1
74	710108	PIN, HAIR (31X4)	1
75	94604-853	STIFFNER,-FRONT HANGER	1
76	710079	SCREW,. 5/16-18X.75HHWATAPSGIB	4
77	710658	SPRING, EXTENSION	1
78	998416	WASHER, FLAT.391X1.OOX.125	1

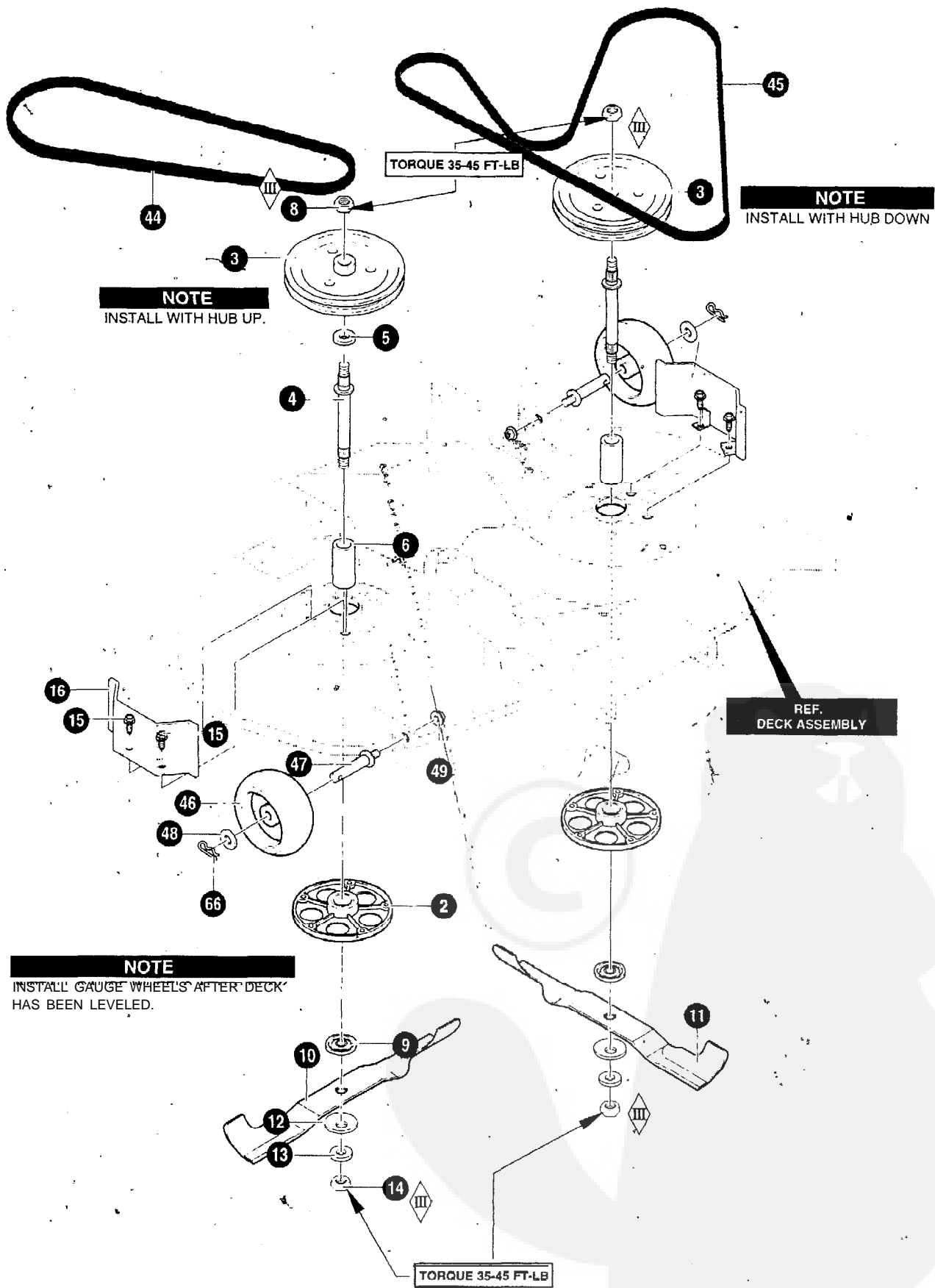

NOTE: ALWAYS USE ORIGINAL EQUIPMENT PARTS. Use of service/replacement parts other than original equipment parts may void your warranty.

ALL UNNUMBERED ITEMS ARE INTERCHANGEABLE WITH OPPOSITE SIDE

40362X76 C K A S S E M B L Y

KEY NO.	PART NO.	DESCRIPTION	QTY
2	94305	ASM.JACKSHAFT HOUSING W/VENTS	2
3	92425	PULLEY, DECK REBA	2
4	91922	JACKSHAFT, 7.76LG-9/16-18TH	2
5	710117	WASHER,FLAT .625X1.00X.188	1
6	91903	SPACER	2
8	710408	NUT, 9/16-18 CTLK (15X101)	2
9	94207	ADAPTER, DECK/BLADE	2
10	94208	BLADE, 40" RH REAR DISCHARGE	1
11	94209	BLADE, 40" LH REAR DISCHARGE	1
12	710118	WASHER, FLAT.625X1.75 17X166	2
13	710117	WASHER,FLAT .625X1.00X.188	2
14	710408	NUT, 9/16 REGHEX	2
15	710265	SCREW, 3/8-16X1 .00 WAHHSPTAPPL	10
16	94288-853	COVER PULLEY	2
44	710231	BELT, V	1
45	710232	BELT, V- 40" DECK	1
46	92683	GAUGE WHEEL,4.94 DIA.	2
4.7	9 4 0 2 5	BOLT, SPSH 3/8-16X.63SH3.00LG	2
48	710115	WASH ER,FLAT.518X.87X16 17X102	2
49	710140	NUT,3/8-16HWDFLK MACK 15X84	2

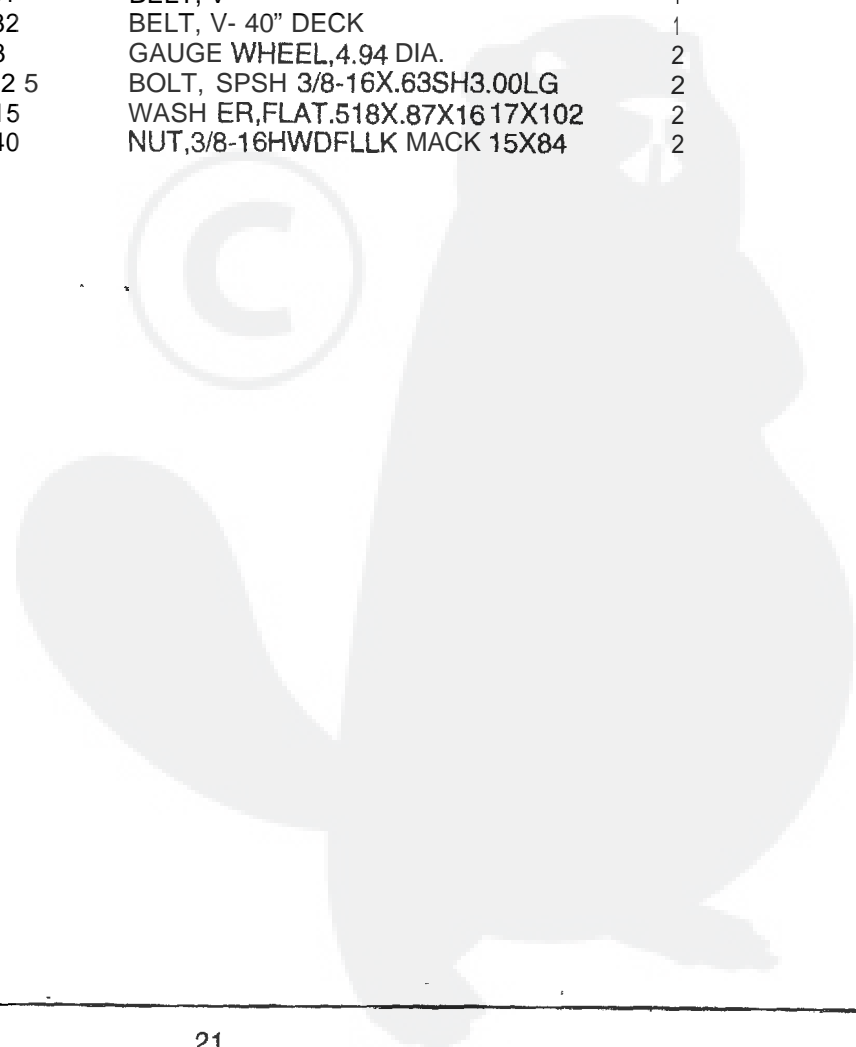

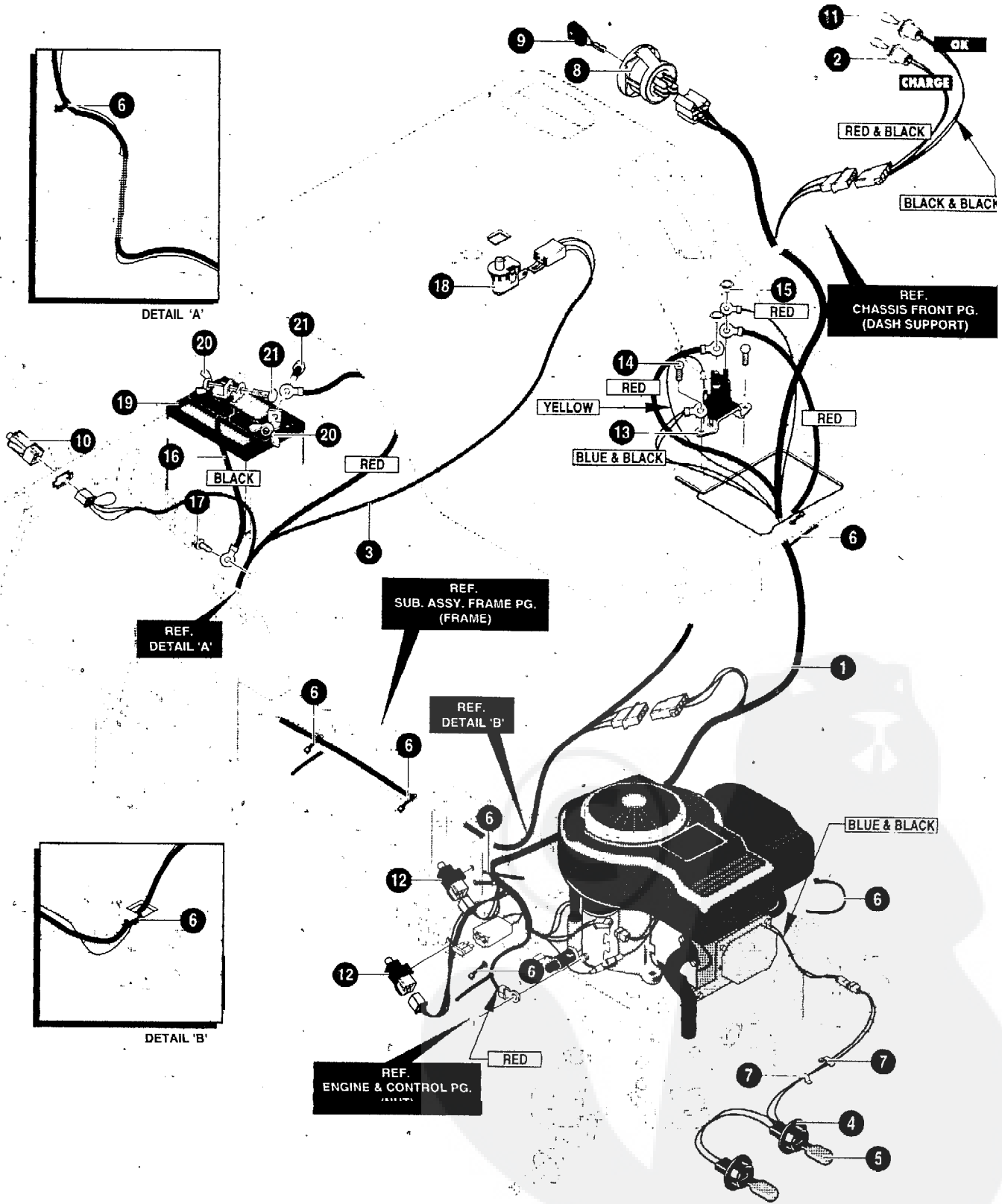

KEY NO.	PART NO.	DESCRIPTION	QTY
1	94745	HARNES 14BS OHVL,H25,REBA,SUS1	
2	94740	HARNES ADAPTER,OK/CHARGE IL I .	
3	94742	HARNES, REAR-BATTERY REBA 1	
4	303064	ASSY,LIGHT WIRE-114 TURN	1
5	52572	BULB, HEADLAMP	2
6	57444	TIE, CABLE BLACK NYLON 5.62L.	5
7	41482	PRESS CLIP,1.380LG .255ID	2
8	94762	SWITCH, IGNITION DELTA 7 TERM	1
9	327350	KEY,IGNITION GENERIC DELTA	1
10	320082	SWITCH,DOUBLE POLE NO/NC GRAY	1
11	57769	BULB, INDICATOR	2
12	94136	SWITCH LIMIT DELTA	2
13	94613	SOLENOID	1
14	710133	SCREW,HHWATAP 1/4X.50	2
15	710203	NUT, 1/4-20 HEXNYL 15X116	2
16	95420	WIRE, GROUND, 20.0"	1
17	710133	SCREW,HHWATAP 1/4X.50	1
18	94159	SWITCH, SEAT	1
19	302257	BATTERY 12V 7 PLATE	1
20	710225	NUT,WING 1/4-20 (14X79)	2
21	710226	BOLT, 1/4-20X.63 CARR. (2X82)	2

SCHEMATIC WIRING

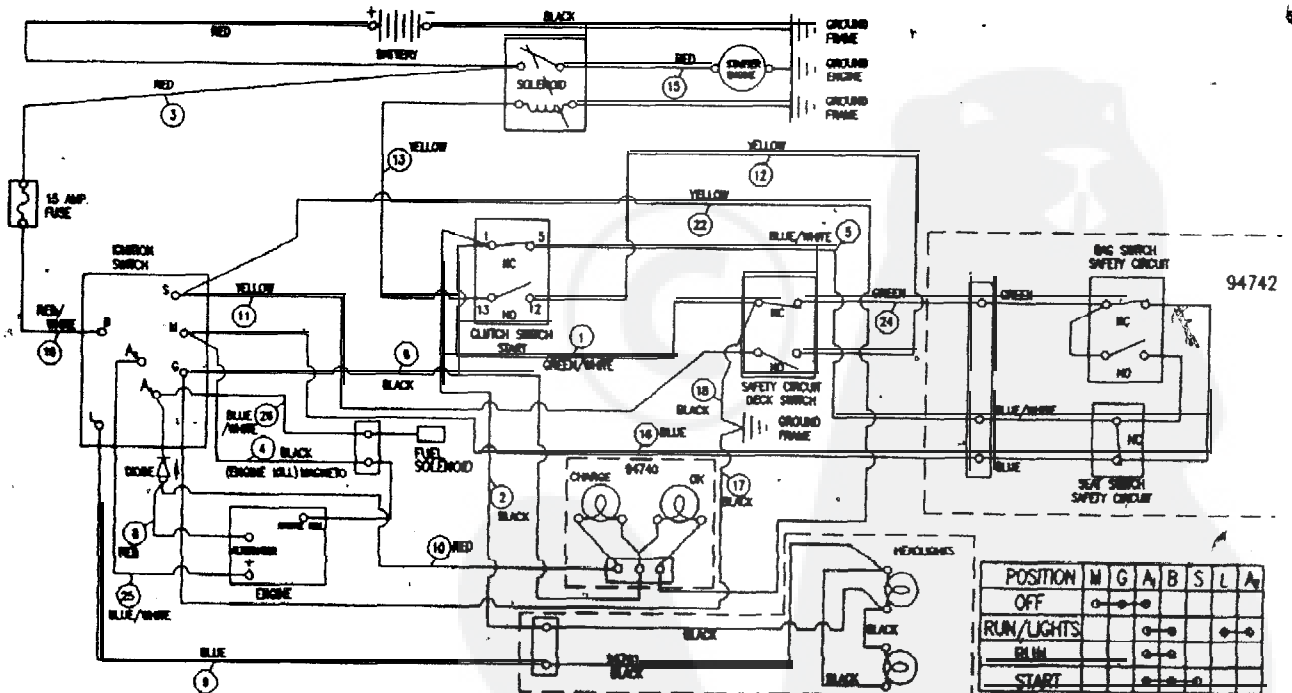

**NOTE**  
CUT KEY# 3 IN TWO 11 .0" LENGTHS  
APPLY TO LEADING EDGE OF  
COLLECTOR COVER

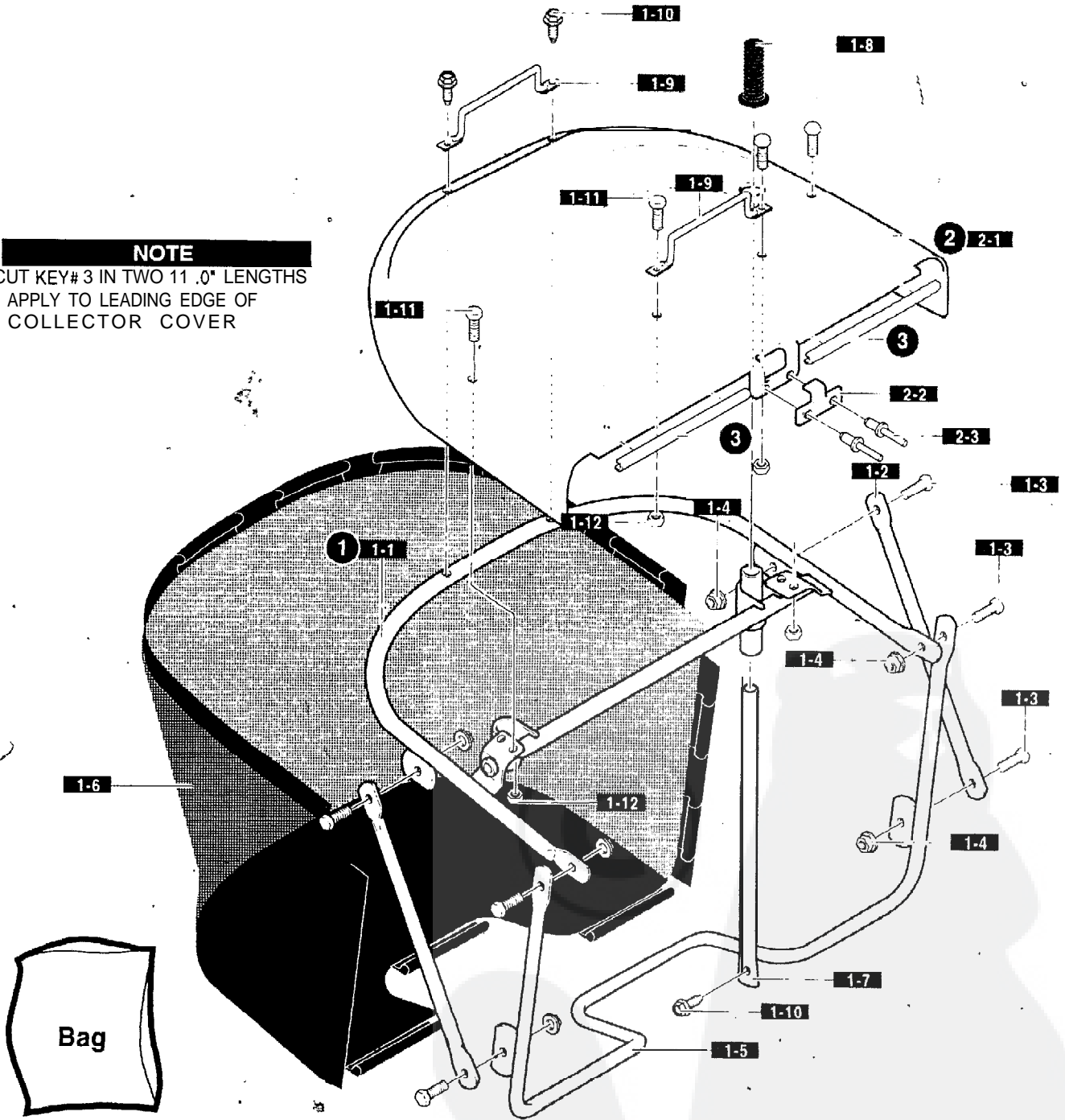



KEY NO.	PART NO.	DESCRIPTION	QTY
1	94560	ASM.GRASS COLLECTOR REBA	1
1-1	94849	ASSY.; UPPER FRAME	1
1-2	94850	BRACE, FRAME COLLECTOR REBA	2
1-3	180020	SCREW, 1/4-20X.75	6
1-4	780029	NUT, 1/4-20 HEX-NYLOCK #71035	6
1-5	94851	ASSY., FRONT FRAME REBA COLLECT	1
1-6	94852	BAG, REBA COLLECTOR	1
1-7	94853	HANDLE, DUMP REBA COLLECT.	1
1-8	94854	RUBBER GRIP 7/8" REBA	1
1-9	94855	HANDLE, REBA COLLECTOR	2
1-10	710266	SCREW, 10-24X.38 SLHWATAP,	3
1-11	318139	SCREW, 1/4-20X.63 PHPNHD	4
1-12	7 8 0 0 2 9	1/4-20 HEX NYLOCK NUT #71035	4
2	94908-860	TOP COLLECTOR ASSY	1
2-1	94206	TOP COVER, COLLECTOR REBA	1
2-2	94244	BRACKET, SWITCH	1
2-3		RIVET (NOT A SERVICEABLE PART	
3	55023	TRIM, 77.5"	22 IN.



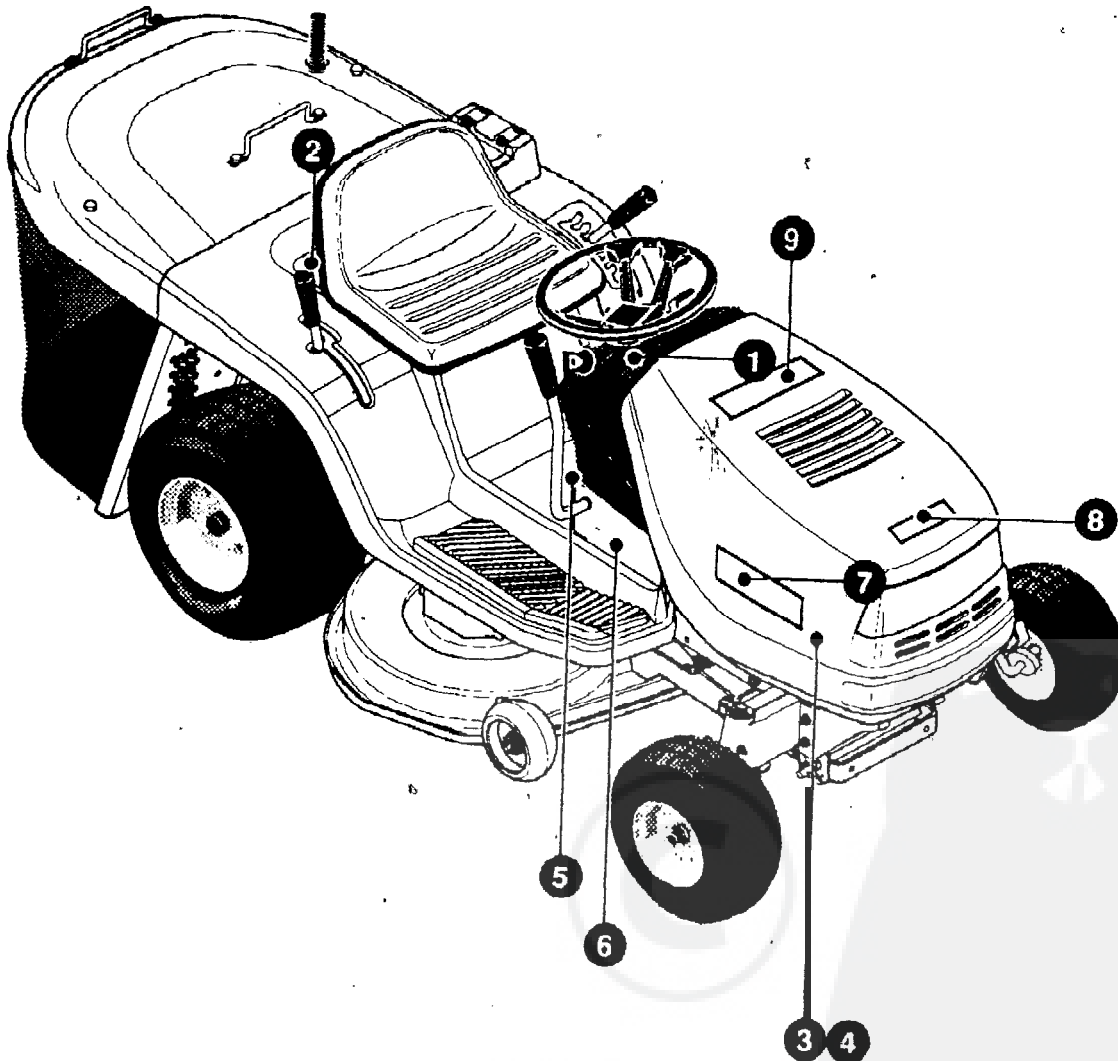

KEY NO.	PART NO.	DESCRIPTION	QTY
1	710615	DECAL, DASH CHOKE-A-MA	1
2		NOT A SERVICEABLE PART	
3	711019	DECAL, TURFMASTER LH	1
4	710020	DECAL, TURFMASTER RH	1
5	710691	DECAL, PARK BRAKE (P)	1
6	711022	DECAL, CONSOLE 15.5/40	2
7	305603	PAD, FOAM HOOD 18X6	2
8	307276	PAD, FOAM HOOD 15X7	1
	307277	PAD; FOAM HOOD 12X5	1

341876A

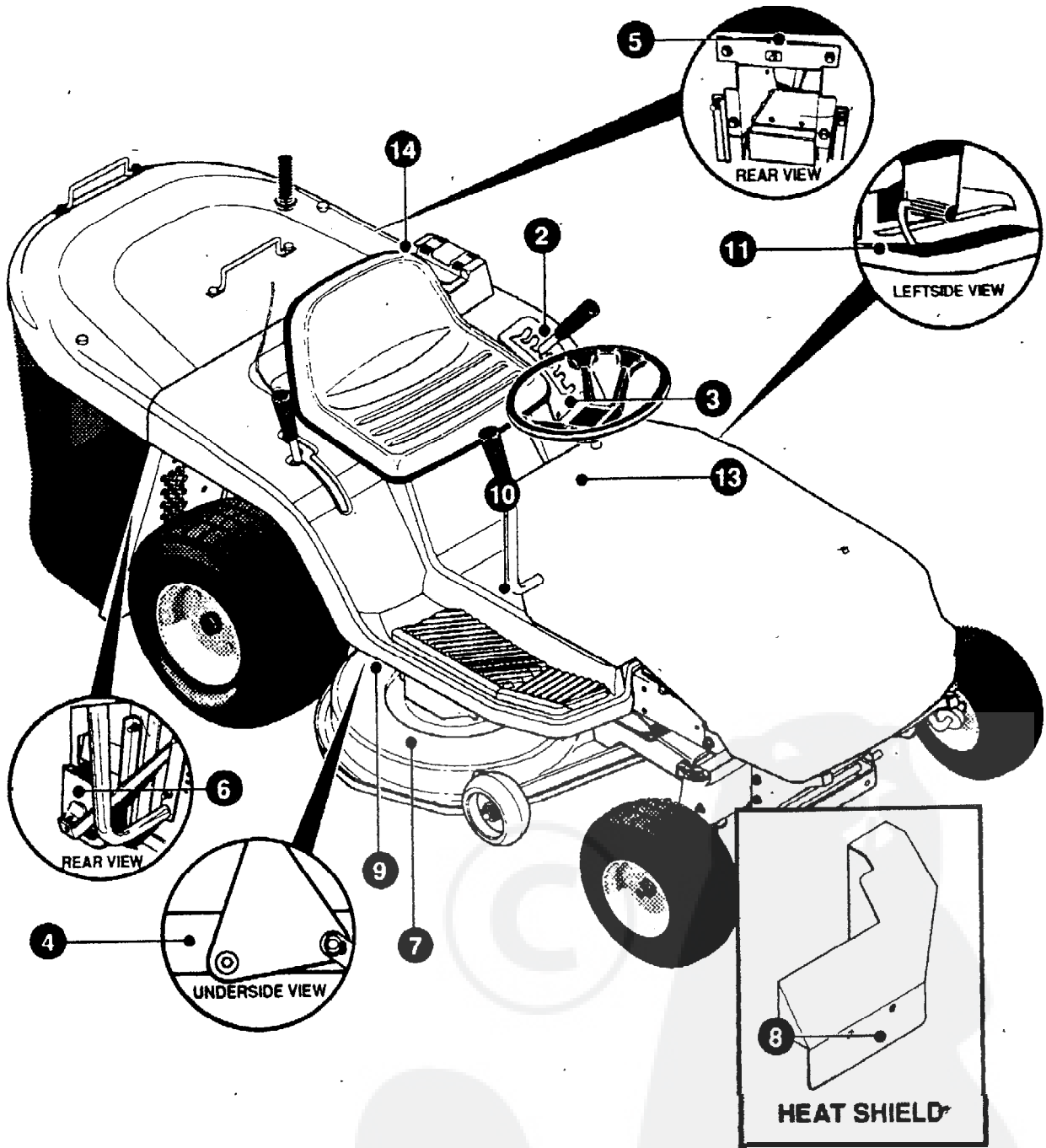

**KEY PART  
NO. NO.**

3	710638
4	710683 710523
5	
6	338541 338542
7	
8	338543 402700
9	710684
10	402702 710534
11	
13	710270
14	710771

**DESCRIPTION**

DECAL, HEIGHT ADJUST 1-6
DECAL, DECK PINCH LEVEL POINTS REBA/NLT EXP
DECAL, WARNING
DECAL, DECAL, BAGGER DRAWBAR "CE" WARN M344X5939 M#44X6138
DECAL, CAUTION HOT SURF DECK WARN LH M#44X5936
DECAL, DECK BELT ROUTE REBA
DECAL, CONS BRAKE/CLUTCH CAUT.M#44X6815 PICTOGRAM
DECAL, AUTODRIVE INSTR DASH RT
DECAL, REBA HYDRO DUMP VALVE

**QTY**

1
1
1
1
21
1
1
1
1