

NOTE: ALWAYS USE ORIGINAL EQUIPMENT PARTS
Use of service/replacement parts other than original
equipment parts may void your warranty

ALL UNNUMBERED
ITEMS ARE INTERCHANGEABLE
WITH OPPOSITE SIDE

KEY N O .	PART NO.	DESCRIPTION	QTY
1	95413-853	BRACKET/HOOD RH	1
2	95414-853	BRACKET/HOOD LH	1
3	710079	SCREW, 5/16-18X.75HHWATAPSGIBP	4
4	95427	DASH	1
5	710282	SCREW, 1/4-14X.75PHPANTAPABBL	2
8	180020	SCREW, 1/4-20X.75 HHC	2
9	120392	WASHER, FLAT .281X.63X.065	4
10	780029	1/4-20 HEX NYLOCK NUT #71035	1
11	34 1569-860	ASM. LOWER CONSOLE	1
11-1	95425	TOWER, LOWER DASH	1
11-2	95426	SUPPORT, STEERING/PTO NLT	1
11-3	710264	SCREW, 1/4-20X.50 WAHHTAP	4
11-4	95406	ROD, DASH BRACE	1
11-5	710264	SCREW, 1/4-20X.50 WAHHTAP	2
12	710079	SCREW, 5/16-18X.75HHWATAPSGIBP	4
15	94638-860	PANEL, ACCESS	1
16	710196	SCREW, 1/10-24X.500	2
17	304188	HOOD	1
18	302670	LENS, HEADLAMP	1
19	308492	FOIL, LENS REFLECTOR	1
20	3 2 2 7 0 0	DECAL, TAPE H14 8MIL VINYL	1
21	301452	FOIL, HEAT REFLECTOR	2
22	300317	PIN, CLEVIS .375DIA X1.64LG	2
23	710343	PIN, HAIR .38DIA X1.66LG	2
24	6711	WASHER, PLASTIC .315X.75X.064	4
25	95404	BUSHING, STEERING SHAFT	1
	711221	OPERATOR'S MANUAL (NOT SHOWN)	

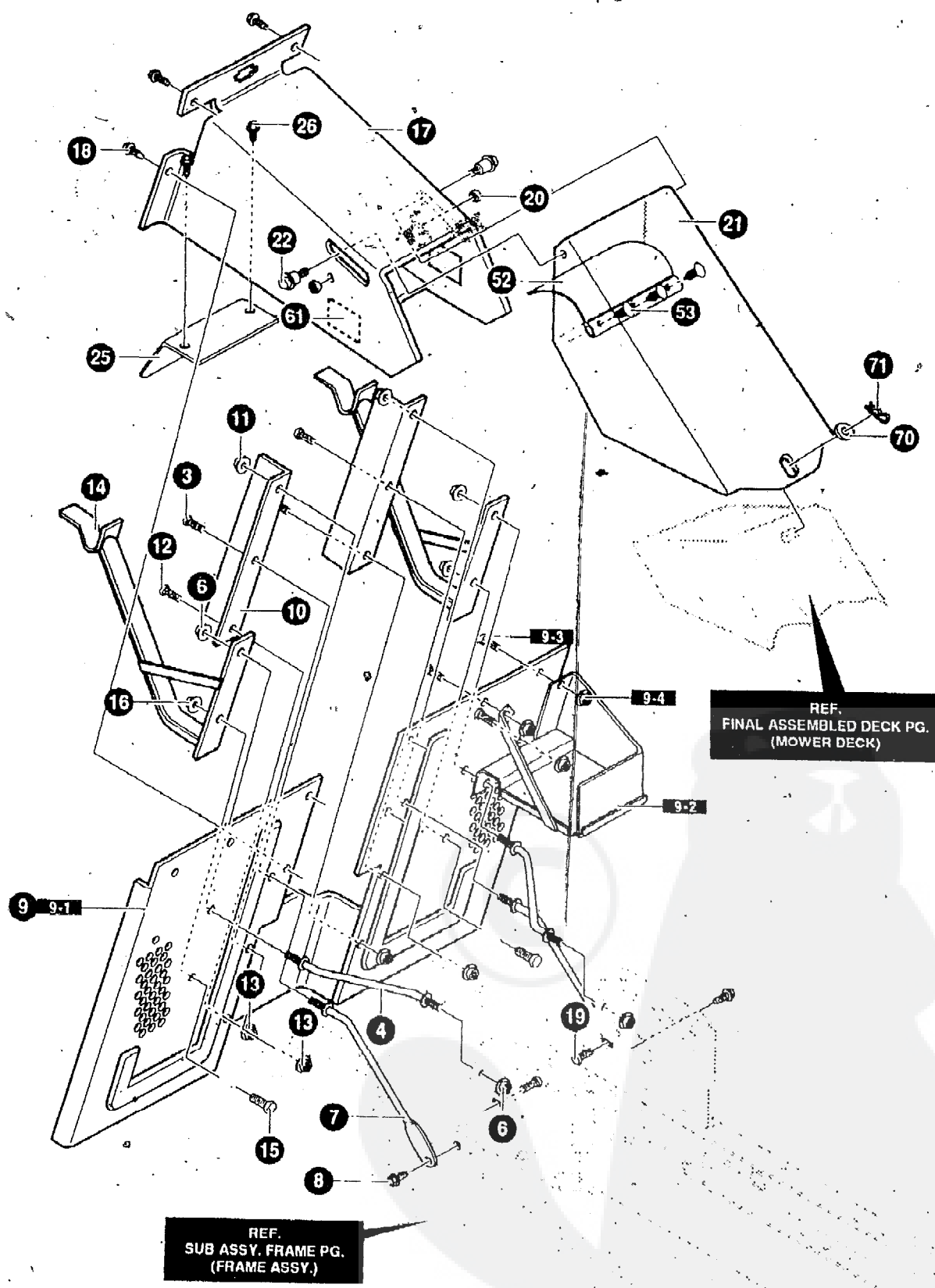

NOTE: ALWAYS USE ORIGINAL EQUIPMENT PARTS
Use of service/replacement parts other than original
equipment parts may void your warranty.

ALL UNNUMBERED
ITEMS ARE INTERCHANGEABLE
WITH OPPOSITE SIDE

KEY NO.	PART NO.	DESCRIPTION	QTY
3	710079	SCREW, 5/16-18X.75HHWATAP	2
4	94625	R O D , B R A C F	2
6	45171	NUT, 3/8-16 HWDFL WHIZ-LOCK	4
7	942.31	R O D , B R A C F	2
8	710079	SCREW, 5/16-18X.75HHWATAP	2
9	341493-853	BACK PLATE/BATTERY ASSEMBLY	1
9-1	94569	BACK PLATE ASSEMBLY REBA	1
9-2	94563	BATTERY TRAY WELD ASM.	1
9-3	1 8 0 0 7 3	SCREW, 5/16-18X.50 HHC	3
9-4	45174	NUT, 5/16-18 HEXWDFLLK WHIZ	3
10	94232-853	BRACE, BACK PLATE	2
11	45171	NUT, 3/8-16HWDFLLK WHIZ	2
12	328154	SCREW, 5/16-18X1.0WDFLLK	4
13	45174	NUT, 5/16-18 WDFLLK (15X88)	4
14	94637-853	ASSY, COLLECTOR SUPPORT	2
15	328154	SCREW, 5/16-18X1.0WDFLLK	2
16	45174	NUT, 5/16-18HEXWDFLLKWHIZ	2
17	94295-853	CHUTE WELD ASM. UPPER	1
18	710079	SCREW, 5/16-18X.75HHWATAP	4
19	57101	BOLT, 5/16-18X.75 CARR	2
20	45174	NUT, 5/16-18 HEXWDFLLK WHIZ	2
21	94970-853	CHUTE WELD ASM. MIDDLE.	1
22	51601	BOLT, .500X.453 HSH 3/8-16	2
25	94263-853	COVER, T-AXLE SHIELD	1
26	710264	SCREW, 1/4-20X.50 WAHHTAP	2
52	94264	FLAP,CHUTE REBA	1
53	309235	RATCHET FASTENER	3

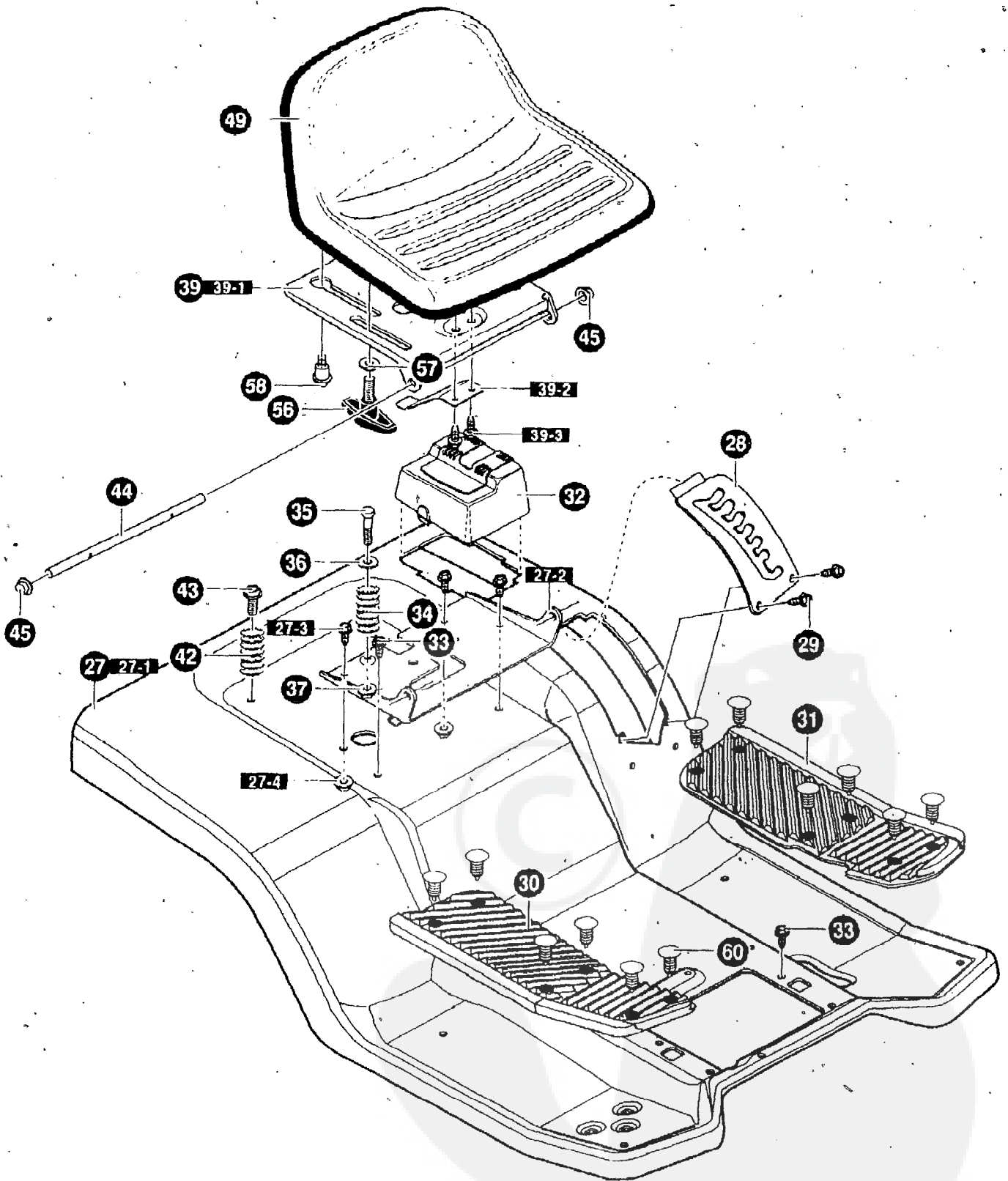

NOTE: ALWAYS USE ORIGINAL EQUIPMENT PARTS.
 Use of service/replacement parts other than original
 equipment parts may void your warranty

ALL UNNUMBERED
 ITEMS ARE INTERCHANGEABLE
 WITH OPPOSITE SIDE

3412508

KEY NO.	PART NO.	DESCRIPTION	QTY
27	341495-860	ASM.SEAT DECK PEDAL GEAR REBA	1
27-1	94311	SEAT DECK, GEAR DRIVE	1
27-2	94153	BRACKET, PIVOT SEAT	1
27-3	710279	SCREW, 5/16-18X.625	2
27-4	710205	NUT, 5/16-18 WDFLLK (15X88)	2
28	94243-853	PLATE, LIFT DETENT	1
29	710196	SCREW, 1 0-24X.500TRSEGI	2
30	95409	FOOTREST PAD RH	1
31	95498	FOOTREST PAD LH	1
32	94200	COVER, BATTERY	1
33	710079	SCREW, 5/16-18X.75HHWATAP	3
34	710136	SPRING, COMPRESS 4.57LG X 1.17	1
35	710093	BOLT, SHOULDER 1/4-20NC-2A(9X55)	1
36	94155	WASHER CUP ZINC	1
37	710280	NUT, 1/4-20 WDFLLK (15X89)	1
39	341494-860	SUB ASM. SEAT SUPPORT REBA	1
39-1	94154	SUPPORT, SEAT	1
39-2	94057	SPRING - LEAF	1
39-3	710264	SCREW, 1/4-20X.50WAHHTAP	2
42	710109	SPRING, COMPRESS 2.43LG (164X30)	2
43	710079	SCREW, 5/16-18X.75HHWATAP	2
44	94156	ZINC HINGE SEAT PIVOT	1
45	710192	NUT, PUSH CAP .375(28X23)	2
49	95415	SEAT	1
56	94160	BOLT, WING 5/16-18	2
57	710281	WASHER, FLAT.344X.62X.06	2
58	710101	BOLT, SHOULDER 5/16-18NC(9X56)	2
60	309235	FASTENER, RATCHET	6
61	318197	PAD, ADHESIVE	3
70	710116	WASHER, FLAT	1
71	710343	PIN, HAIR	1

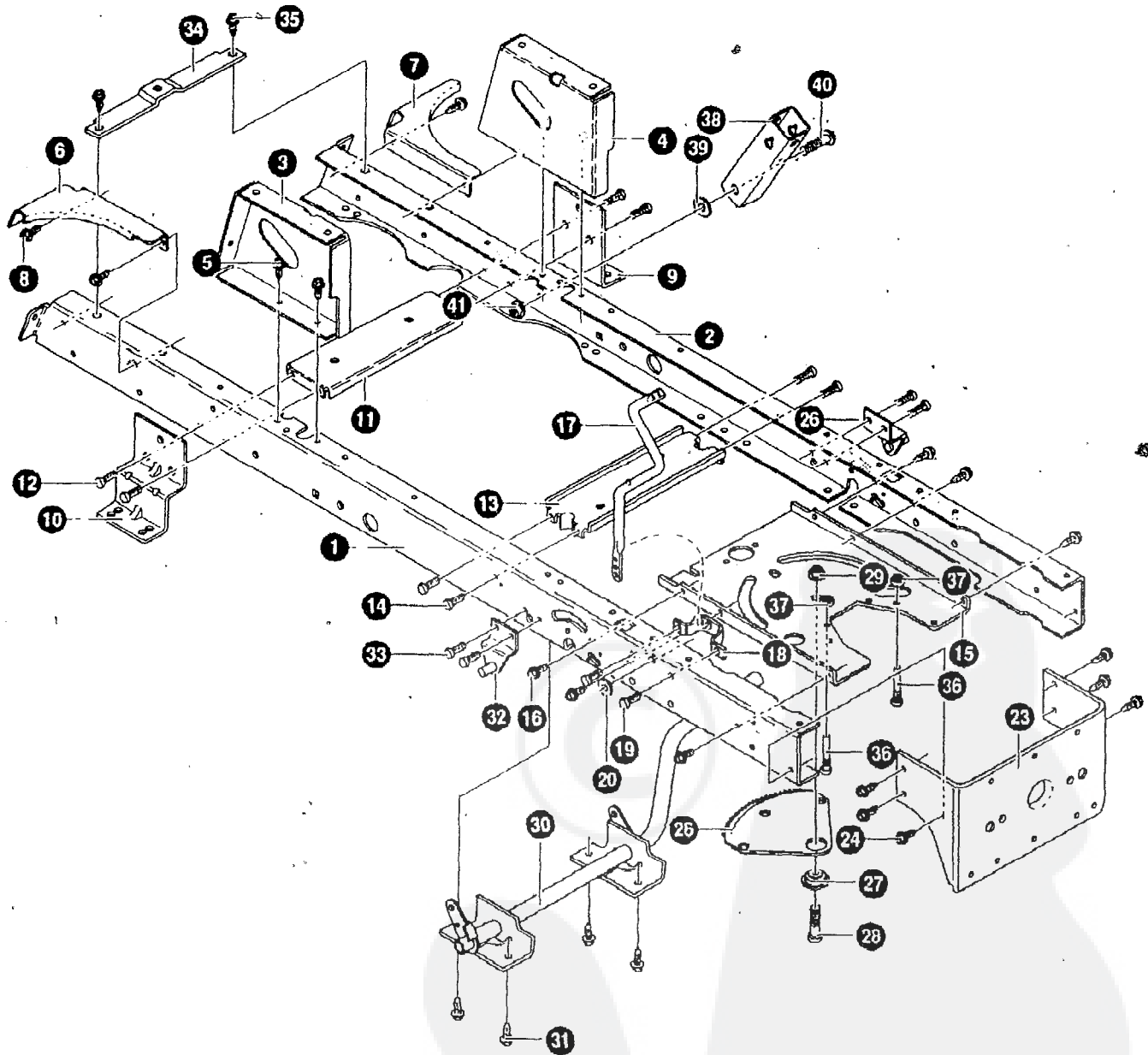

NOTE; ALWAYS USE ORIGINAL EQUIPMENT PARTS.
Use of service/replacement parts other than original
equipment parts may void your warranty

ALL UNNUMBERED
ITEMS ARE INTERCHANGEABLE
WITH OPPOSITE SIDE

340370A

KEY PART NO. NO.	DESCRIPTION	QTY
1 94564	FRAME,RAIL RH REBA	1
2 94565	FRAME,RAIL LH REBA	1
3 94634	SUPPORT,SEAT RH	1
4 94633	SUPPORT,SEAT LH	1
5 710079	SCREW, 5/16-18X.75HHWATAP	4
6 94561	BRACE, BACKPLATE RH	1
7 94562	BRACE, BACKPLATE LH	1
8 710079	SCREW, 5/16-18X.75HHWATAP	4
9 94008	BRACKET,TRANSAXLE	1
10 94234	BRACKET,T/A RH-VST, LH-VST	1
11 94236	ASSY, IDLER MOUNT, REAR	1
12 710079	SCREW, 5/16-18X.75HHWATAP	4
13 94237	ASM. IDLER MOUNT,FRONT	1
14 710079	SCREW, 5/16-18X.75HHWATAP	4
15 94003	PLATE,STEERING MOUNTING	1
16 710079	SCREW, 5/16-18X.75HHWATAP	6
17 94019	CRANK, PTO (DRILLED)	1
18 94005	BRACKET, BELL CRANK	1
19 710079	SCREW, 5/16-18X.75HHWATAP	2
20 120395	WASHER, FLAT .469X .92X.065	1
23 94013	BRACKET, HANGER REAR	1
24 710079	SCREW, 5/16-18X.75HHWATAP	6
26 94121	GEAR, SECTOR	1
27 94123	BEARING, SECTOR GEAR	1
28 710312	SCREW, 5/16-18X1.00	1
29 710105	NUT, 5/16-18 HWDFLLK (15X113)	1
30 94241	ASM.CLUTCH/BRAKE PEDAL	1
31 710079	SCREW, 5/16-18X.75HHWATAP	4
32 94285	BRACKET SUSPENSION ASM.	2
33 710079	SCREW, 5/16-18X.75HHWATAP	4
34 94566	BRACE, RAIL	1
35 710079	SCREW, 5/16-18X.75HHWATAP	2
36 93349	SCREW GUIDE 5/16-18	2
37 710204	NUT,5/16-18 HEXWDFLLK WHIZ PL	2
38 94015	BRACKET, PIVOT	1
39 845	WASHER, FLAT .390X1.25X.119	1
40 710000	BOLT, .562X1.563 HSSH 3/8-16	1
41 710140	NUT,3/8-16HWDFLLK MACK 15X84	1

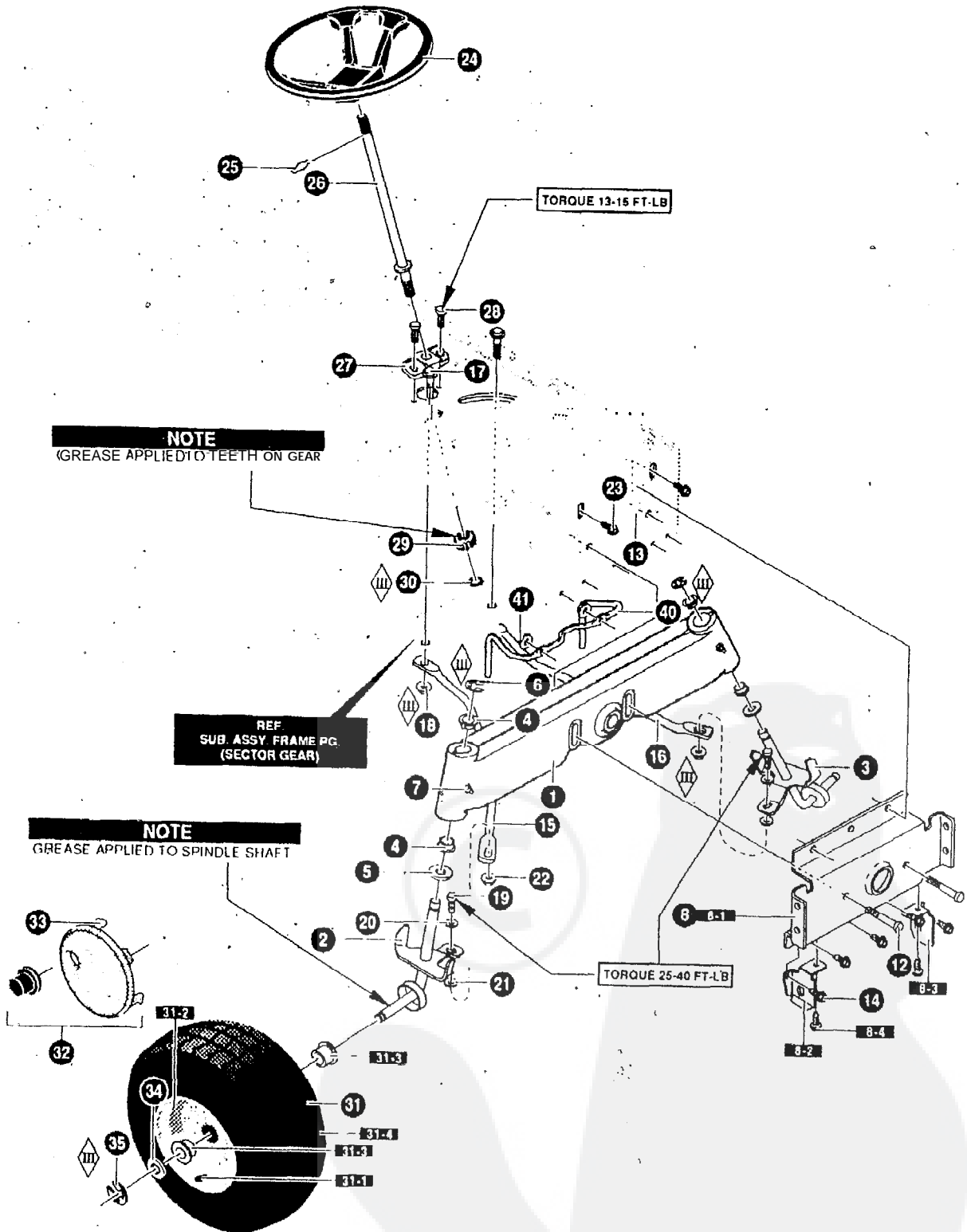

NOTE: ALWAYS USE ORIGINAL EQUIPMENT PARTS.
Use of service/replacement parts other than original
equipment parts may void your warranty.

ALL UNNUMBERED
ITEMS ARE INTERCHANGEABLE
WITH OPPOSITE SIDE

340597B

KEY NQ.	PART NO.	DESCRIPTION	QTY
1	95405-853	AXLE, CAST MACHINED	1
2	94178-853	SPINDLE,RH MO#94178	1
2-1	94014	SPINDLE AXLE	1
2-2	94 1.25	ARM, STEERING RH	1
2-3	623168	DUST CUP	1
3	94179-853	SPINDLE LH,WELD ASSEMBLY	1
3-1	94014	SPINDLE AXLE	1
3-2	94126	ARM, STEERING RH	1
3-3	623168	DUST CUP	1
4	92527	BEARING, SPINDLE	4
5	710129	WASHER,.766 ID X 1.62ID16GA	2
6	710103	E-RING .574IDX.050/.750SH11X3	2
7	706	ZERK, GREASE FITTING	2
a	341491-853	ASM.FRONT AXLE/DECK HANGER	1
8-1	94007	HANGER, AXLE	1
8-2	94290	HANGER,DECK RH	1
a-3	94289	HANGER,DECK LH	1
8-4	710079	SCREW, 5/16-18X.75HHWATAPSGIBP	2
12	180113	SCREW, 5/16-18X3.00	2
13	710205	NUT, 5/16-18 WDFLLK (15X88) Z	2
14	710079	SCREW, 5/16-18X.75HHWATAPSGIBP	2
15	94020-853	DRAG LINK RH	1
16	94021-853	DRAGLINK, LH	1
17	710440	BOLT,HSSH (9X57)	2
18	710140	NUT,3/8-16HWDFLLK MACK 15X84	2
19	710082	SCREW, 3/8-16X1.5	2
20	710083	WASHER, FLAT .391X1.00X.083	2
21	710142	WASHER, FLAT.406X.81 XI 6GA	2
22	710140	NUT,3/8-16HWDFLLK MACK 15X84 Z	2
23	710079	SCREW, 5/16-18X.75HHWATAPSGIBP	3
24.	95441	STEERING WHEEL	1
26	94127	SHAFT, STEERING	1
27	94124	BEARING-LOWER	1
28	710079	SCREW, 5/16-18X.75HHWATAPSGIBP	2
29	94122	GEAR PINION	1
30	710102	RING, RET E.54ID.59SH(11X25)	1
31	692287	TIRE & RIM 15X6-6	2
31-1	338512	VALVE STEM	2
31-2	338517	RIM, CARLISLE	2
31-3	338513	BEARING	2
31-4	338516	TIRE, 15X6X6	2
32		NOT USED	
33		NOT USED	
34	710350	WASHER, FLAT .765X1.62X.065Z	2
35	36625	RETAINING RING	2
40	94310	GUIDE-STACK PULLEY BELT	1
41	45174	NUT, 5/16-18 HEXWDFLLK WHIZ	2

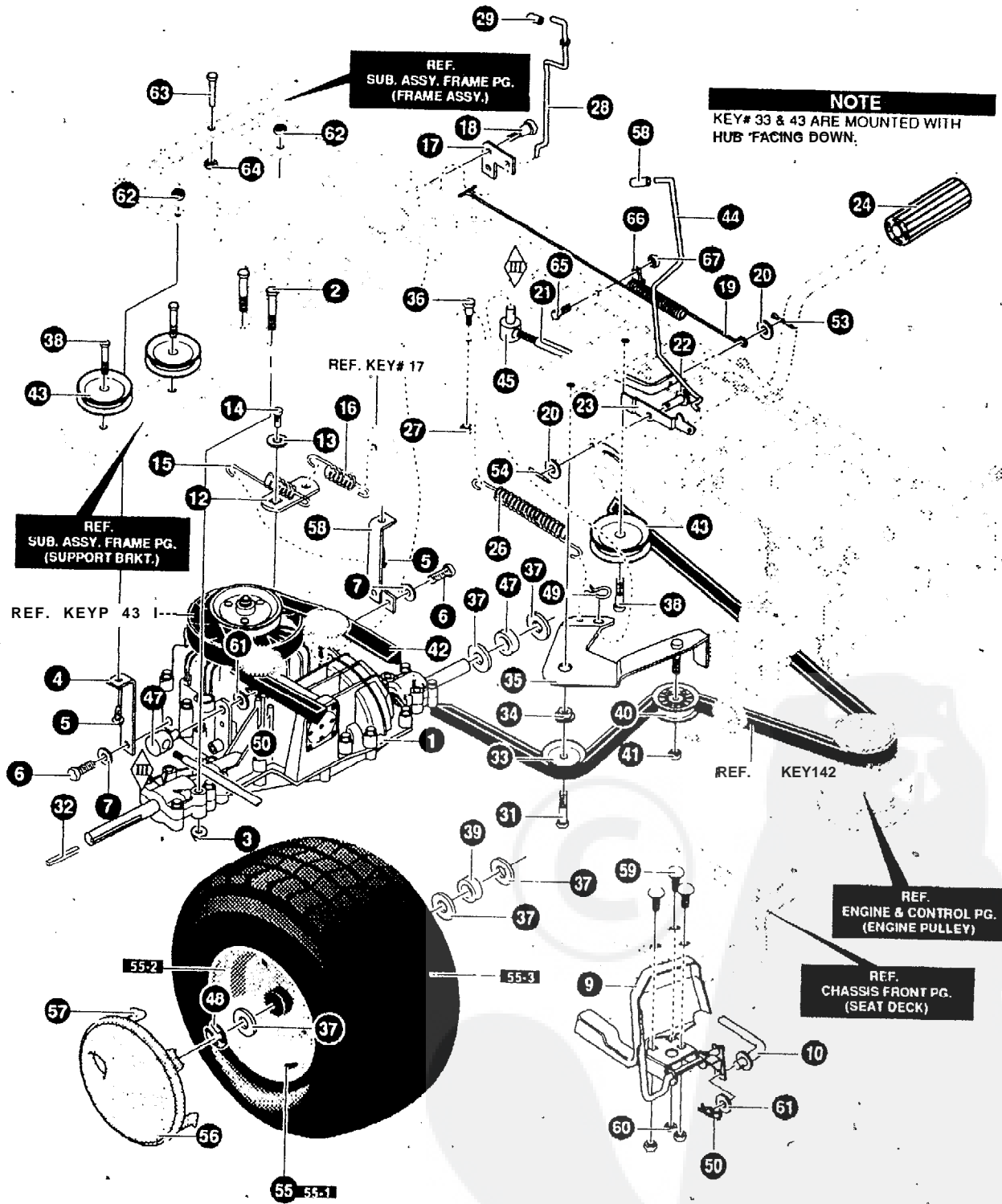

NOTE: ALWAYS USE ORIGINAL EQUIPMENT PARTS
 Use of service/replacement parts other than original
 equipment parts may void your warranty

ALL UNNUMBERED
 ITEMS ARE INTERCHANGEABLE
 WITH OPPOSITE SIDE

KEY PART NO.	NO.	DESCRIPTION	QTY
1	(205-025BM)	TRANSAXLE HYDRO VST205-025BM1	1
2	180091	SCREW, 5/16-18X2.50 HHC	4
3	710205	NUT, 5/16-18 WDFLLK (15X88)	4
6	71007953	BRACKET, ST5/16-18X.75HHWATAP	1
7	35498 120638	SCREW, 5/16-18X HVSPTLK.75 WAHTAP W A S H E R , . . . 328X.60X.09	11
90	94422-853	PEDAL ASSEMBLY	1
12	323212	SHIFT BRACKET	1
13	56255	SCREW,, 1/4-28X.75NYLHH	1
15	57157.	WASHER .750X.250 SP-TRANSAXLE	1
16	94622	SPRING, TRANSAXLE DISCONNECT	1
	326780	SPRING, TENSION 3/8ODX2.18X.055	1
17			
18	94621-853 334 126	BRACKET, BOLT, .437X.1 DISCONNECT 36 5/16-18 LEVER	11
19	95424	SPRING, BRAKE 35:00	1
20	12039	WASHER, FLAT .406X.81 X.065	1
21	94573	ROD, . . . CLUTCH.	1
23	49332	PIN, CLEVIS .375DX.81LG	1
24	94045	ZINC LATCH, PARK BRAKE	1
	21544	PEDAL BRAKE/CLUTCH STD NLT	1
26	710139	SPRING, TENS .09X . X5.	1
27	780029	NUT, 1/4-20 HEX NYLOCK #71035	1
28	94653	ROD, DISCONNECT CONTROL	1
29	335980	CAP, DUMP VALVE ROD .25IDX.75	1
31	7 1 0 0 8 2	SCREW, 3/8-16X1.5 HHCFLTHR5	1
32	52928	KEY, SQUARE .1875SQX2.25LG	2
33	3 5 3 7 4	PULLEY, IDLER V4L 3.06X .62	1
34	95423	SPACER, SHOULDER	1
36	94236	ASSY, IDLER ARM TRACTION	1
37	310088	BOLT, .250X.312 HSSH 1/4-20	1
	710131	WASHER, FLAT- .755X1.31X.075	6
38	180124	SCREW, 318-16X1.25	3
39	95421	SPACER, .87 X 1.78	2
40	91179	PULLEY	1
4 1	45905	NUT 3/8-16 DFLK MACK	1
42	94609	BELT, V 4L 112.75	1
43	35374	PULLEY, IDLER V4L 3.06X .62	3
44			
45	94568 710059	NUT, PARK 5/16-18X3/8 BRAKE CONTROL ADJUSTING ROD	11
48	92132	ADJUSTING NUT 1/2-13	1
49	36625	RING, RETEX .57X.05TRU5133-75	2
50	56180	PIN, HAIR .53DIA X1.62LG	1
53	710343 121222	PIN, PIN, COTTER HAIR .038.090DIA X1.64LGDIA X.75LG	1
54			1
55	692289 121222	TIRE PIN, COTTER & RIM 20X8-8 .090DIA X.75LG	21
55-1	3385 12	VALVE S T E M	2
55-2	338524	RIM	2
55-3	338549	TIRE 18X8.5-8	2
56		NOT USED ON THIS UNIT	
57		NOT USED ON THIS UNIT	
58	94225-853	ASM. WELD, BKT STABILIZER LH	1
			3
60	57101	BOLT, 5/16-18X.75 CARR.	3
61	996425 710204	NUT, FLATWASHER 5/16-18 WDFLLKWHIZ.515X.88X.064	2
63	45174	NUT, 5/16-18 HEXWDFLLK WHIZ	2
64	93349 710204	SCREW NUT, 5/16-18 GUIDE HEXWDFLLK 5/16-18 WHIZ	11
65			
66	57569 180016	SCREW, RETAINER 114-20 .311DX.62X.03X.50 WIRE	11
67	51335	NUT, 1/4-20 WDFLWHIZ-LK	1

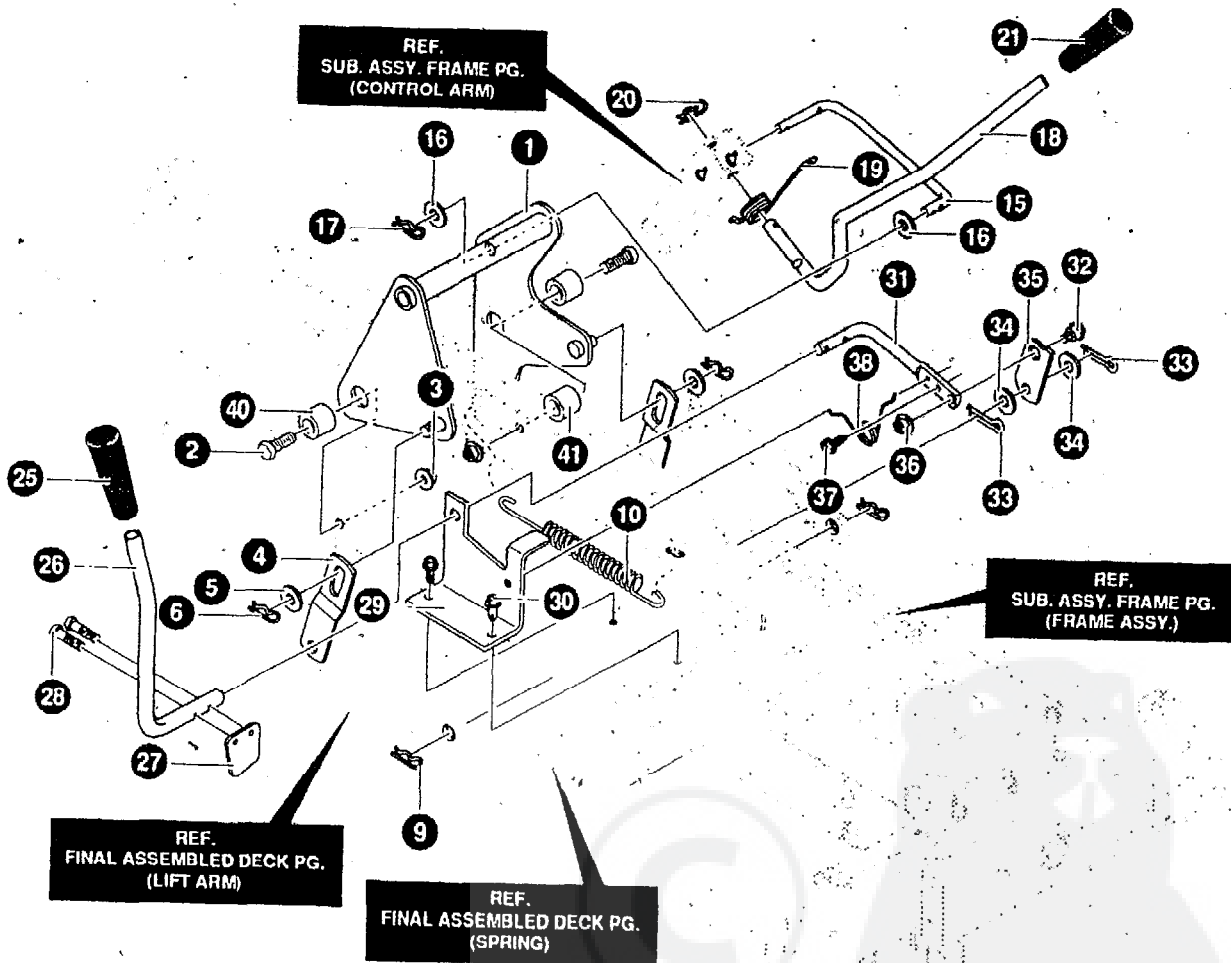

NOTE: ALWAYS USE ORIGINAL EQUIPMENT PARTS.
Use of service/replacement parts other than original
equipment parts may void your warranty

ALL UNNUMBERED
ITEMS ARE INTERCHANGEABLE
WITH OPPOSITE SIDE

340859C

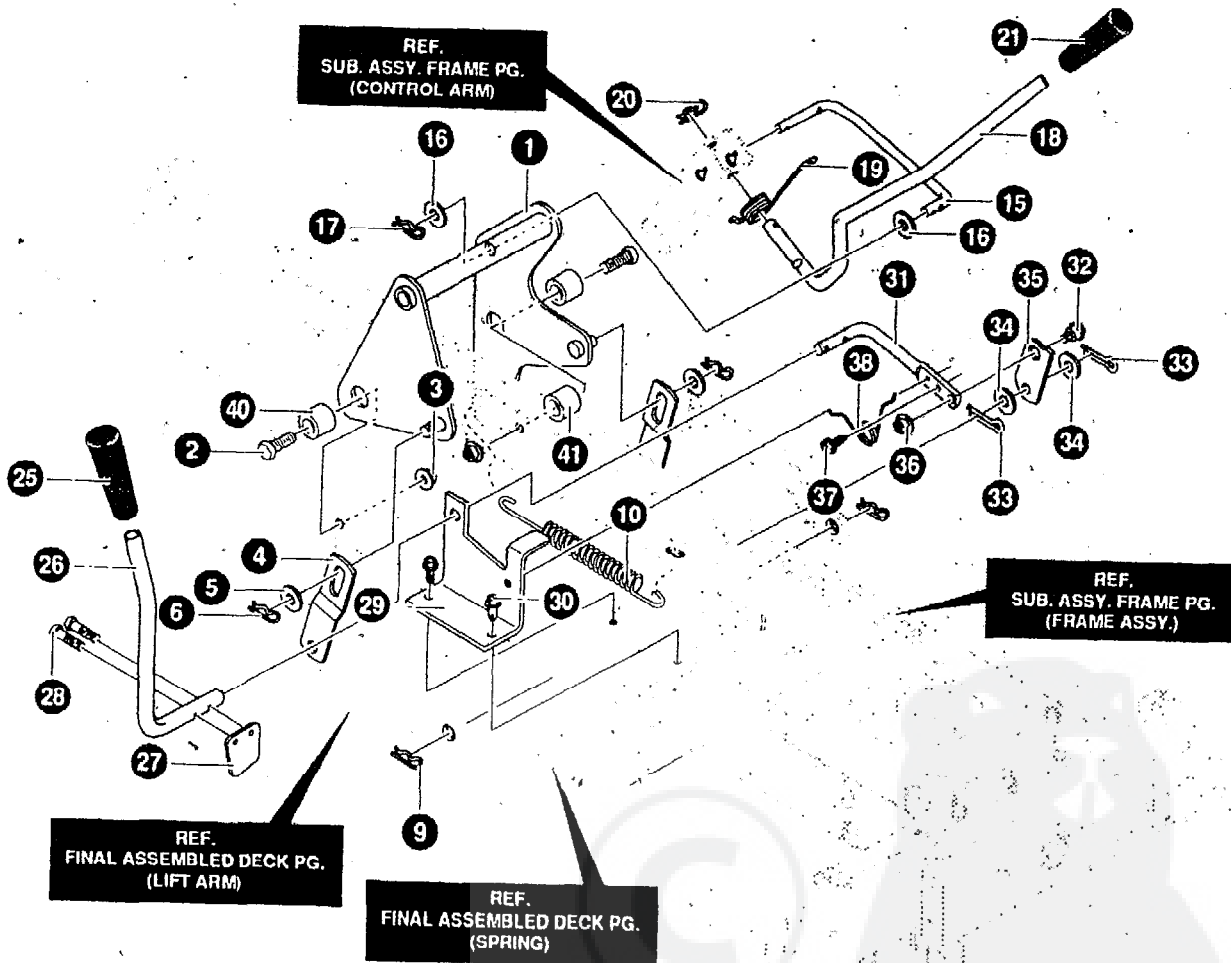

NOTE: ALWAYS USE ORIGINAL EQUIPMENT PARTS.
Use of service/replacement parts other than original
equipment parts may void your warranty

ALL UNNUMBERED
ITEMS ARE INTERCHANGEABLE
WITH OPPOSITE SIDE

340859C

KEY NO.	PART N O	DESCRIPTION	Q N
1	94299-853	LIFT ARM WELD ASSEMBLY	1
2	710222	SCREW, 1/2-13X1.50 (1X127)	2
3	710223	NUT, 1/2-13 LOCK (15X41)	2
4	94262-853	BRACKET, LIFT LINK	2
5	710119	FLATWASHER (17X91)	2
6	710343	PIN, HAIR .38DIA.X1.64LG	2
9	710108	PIN, HAIR (31X4)	2
10	710235	SPRING, EXTENSION 9.82X1.01 OD	1
15	94276	LINK, LIFT HANDLE	1
16	710119	FLATWASHER (17X91j)	2
17	710343	PIN, HAIR .38DIA.X1.64LG	1
18	94029	HANDLE, LIFT	1
19	710111	TORSION SPRING .657LG (166X40)	1
20	710108	PIN, HAIR (31 X4)	1
21	92697	GRIP, BLACK	1
25	92698	GRIP, BLACK	1
26	94826	PTO LEVER	1
27	94022	PADDLE, SWITCH	1
28	710137	SCREW, THD FORMING	2
29	94018-853	BRACKET, PTO	1
30	710079	SCREW, 5/16-18X.75HHWATAP	2
31	94017	ZINC LEVER, PTO	1
32	710098	BOLT.50X.75 HSH 3/8-16Z 9X39	1
33	36368	PIN, HAIR .072DIA X1.13LG	2
34	710115	FLATWASHER .518X.87X16	2
35	94004	LINK PTO ZINC	1
36	710140	NUT, 3/8-16HWD FLLK MACK (15X84)	1
37	710079	SCREW, 5/16-18X.75HHWATAP	1
38	710141	TORSION SPRING .33LG (166X39)	1
40	94309	SPACER.513 ID X .880 OD	2
41	56150	SPACER, SLEV .94X1.13X.531	1

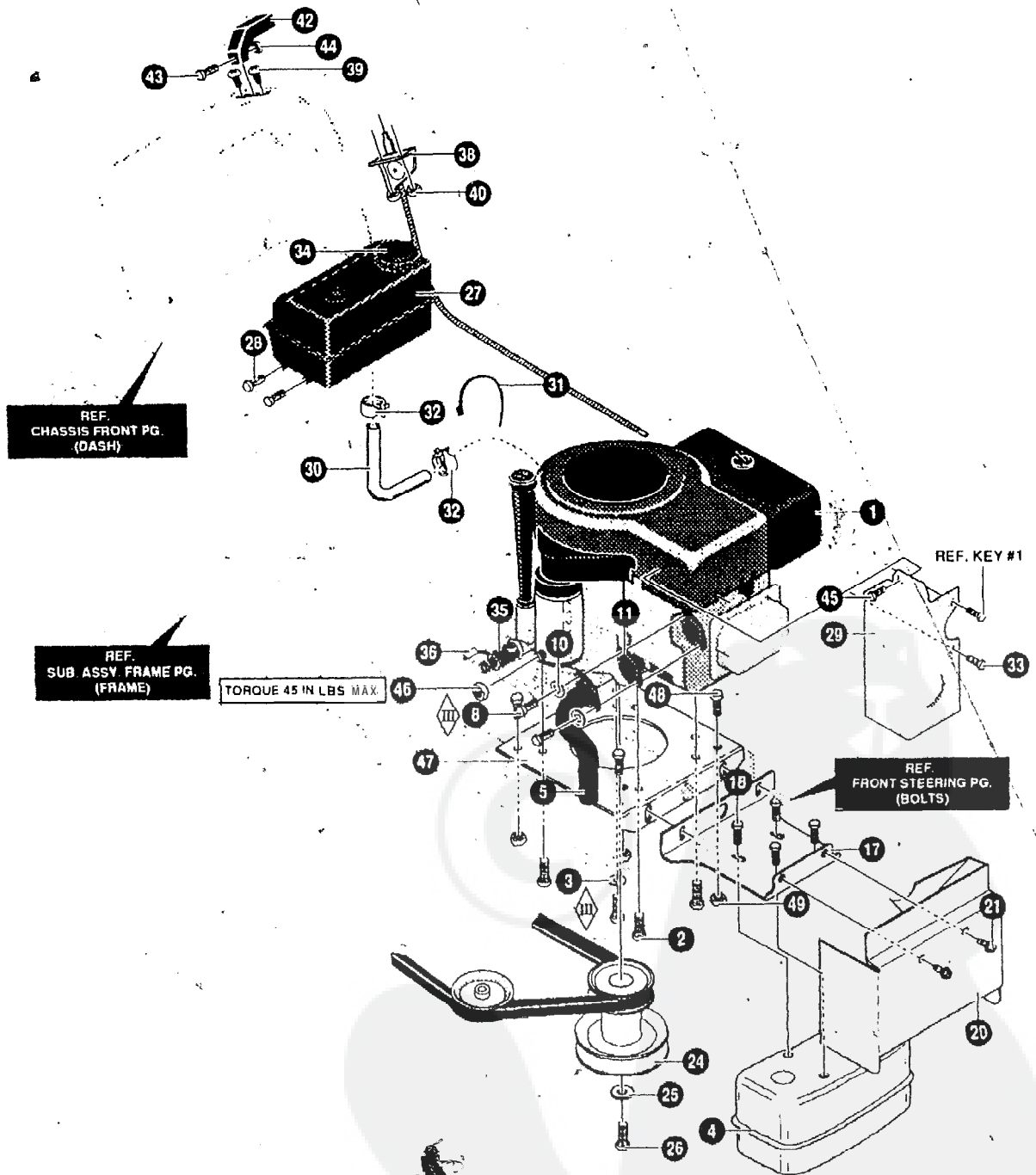

NOTE: ALWAYS USE ORIGINAL EQUIPMENT PARTS. Use of service/replacement parts other than original equipment parts may void your warranty.

ALL UNNUMBERED ITEMS ARE INTERCHANGEABLE WITH OPPOSITE SIDE

KEY PART NO.	NO.	DESCRIPTION	Q	T	Y
1	(287707-0272-01)	ENGINE	1		
2	50947	SCREW, 3/8-16X1.25 WAHHTAP	4		
3	138489	WASHER, EXLK .384X.69X.04	1		
4	94654	MUFFLER, SINGLE-CYLINDER	1		
5	94657	EXHAUST TUBE	1		
8	180077	SCREW, 5/16-18X.75	2		
10	120638	WASHER, HVSPTLK.328X.60X.09	2		
11	46708	GASKET, MUFFLER	1		
17	94306-853	BRACKET, MUFFLER MOUNT	1		
18	44811	SCREW 1/4-20X.75 WAHHTAP	4		
20	95439-853	SHIELD, HEAT LOWER FRONT	1		
21	710079	SCREW 5/16-18X.75HHWATAP	2		
24	94308	PULLEY, ENGINE	1		
25	120383	WASHER, REGSPTLK.	1		
26	433146	SCREW 7/16-20X4.25	1		
27	309853	FUEL TANK 1.5 GALWO/SENSOR	1		
28	710246	SCREW, .15TPIX	4		
29	333772-853	HEAT SHIELD	1		
30	42258	TUBING, .25X.50 GAS' LINE	12.00	IN.	
31	5 7 4 4 4	CABLE TIE	1		
32	47345	CLAMP, FUEL LINE YELLOW	2		
33	710264	SCREW, 1/4-20X.50 WAHHTAP	1		
34	12501	FUEL CAP	1		
35	325547	OIL DRAIN VALVE ASSEMBLY	1		
36	327422	CAP.OIL DRAIN VALVE ASM.YELLOW	1		
38	96906	THROTTLE CONTROL	1		
39	155941	SCREW. 1 O-24X.63 PHFLTMA	2		
40	308459	NUT #10-24 HXHDNYLK	2		
42	94931	THROTTLE CONTROL KNOB	1		
43	159585	SCREW, #8-32X.38 PHPNMA	1		
44	120622	NUT, #8-32 REGHX	1		
45	57366	SCREW 10-16X.50 DRILLTITE	1		
46	124818	NUT, 1/4-20 REGHXJAM	1		
47	94006-853	PLATE, ENGINE	1		
48	710079	SCREW, 5/16-18X.75 HHWATAP	4		
49	710205	NUT, 5/16-18 WDFLLK (15X88)	4		
50	94951	SPEED CLIP	1		

40366X40

REPAIR PARTS

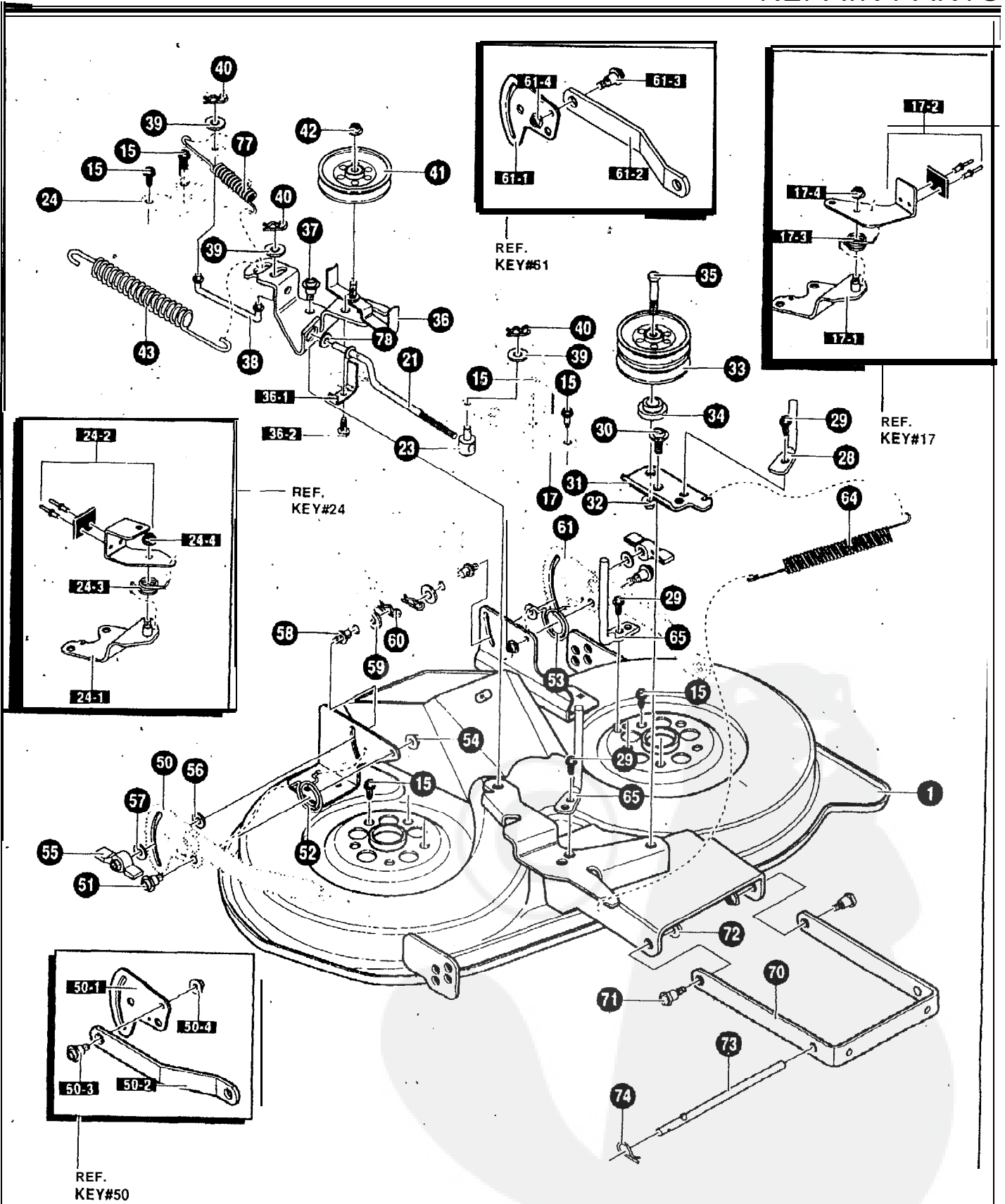

NOTE: ALWAYS USE ORIGINAL EQUIPMENT PARTS, Use of service/replacement parts other than original equipment parts may void your warranty.

ALL UNNUMBERED ITEMS ARE INTERCHANGEABLE WITH OPPOSITE SIDE

340977A

KEY NO.	PART NO.	DESCRIPTION	QTY
1	94303-853	WELD ASSEMBLY DECK,	
15	710265	SCREW, 3/8-16X1 .00 WAHHSPTAPPL	10
17	94665-653	BRAKE ARM ASSEMBLY LH	
17-1	94293	BRAKE SUPPORT ASSEMBLY LH	
17-2	94291	BRAKE ARM ASSEMBLY LH	
17-3	710110	SPRING, TORSION (166X27)	
17-4	710205	NUT, 5/16-18 WDFLLK (15X88)	
21	94277	LINK, BRAKE LH	
23	21920	NUT, 3/8-16TAP	
24	94664-853	BRAKE ARM ASSEMBLY RH	
24-1	94294	BRAKE SUPPORT ASSEMBLY RH	1
24-2	94292	BRAKE ARM ASSEMBLY RH	1
24-3	710077	SPRING, TORSION	1
24-4	710205	NUT, 5/16-18 WDFLLK (15X88)	1
28	94274	GUIDE, BELT REBA	1
29	710114	SCREW, 5/16-18 .50HHTAP	3
30	710098	BOLT, 50X.75 HSH 3/8-16Z 9X39	
31	94261-853	ARM, DOUBLE IDLER	
32	710140	NUT, 3/8-16HWDFLLK MACK 15X84	
33	94279	PULLEY, IDLER DOUBLE VEE	
34	94269	SPACER, REBA DECK	
35	180138	SCREW, 3/8-1 6X3.00 HHC	1
36	94973-853	IDLER ARM ASSEMBLY	
36-1	94312	SPRING, -GUIDE BELT	
36-2	710264	SCREW, 1/4-20X.50 WAHHTAP	
37	710098	BOLT, 50X.75 HSH 3/8-16Z 9X39	
38	94270	LINK, BRAKE RH	
39	316079	WASHER, FLAT .406X .82X.040	
40	710343	PIN, HAIR .038DIA X1.64LG	3
41	94280	PULLEY, V IDLER 4"	1
42	710140	NUT, 3/8-16HWDFLLK MACK 15X84	
43	710234	SPRING, EXTN 5.40X.714OD	
50	341593-853	PLATE - SUSPENSION ASSY	1
50-1	94128	PLATE - SUSPENSION	
50-2	94055	SUSPENSION BRKT REAR	
50-3	710095	SHOULDER BOLT 3/8-16 (9X52)	1
50-4	710140	NUT, 3/8-16 MACK (15X84)	
51	710094	BOLT, SHOULDER .375(9X51)	2
52	710112	SPRING, TORSION .68LG RH (166X42)	1
53	710113	SPRING, TORSION .68LG LH (166X43)	
54	710140	NUT, 3/8-16HWDFLLK MACK (15X84)	2
55	94068	KNOB	2
56	94137	PAD, FRICTION	2
57	710195	WASHER (17X45)	2
58	94064	PIN, HANGER	2
59	710116	WASHER, FLAT .550X1.00X11 (17X103)	2
60	710343	PIN, HAIR	2
61	341594-853	ASM. PLATE REAR SUS BRKT LH	1
61-1	94128	PLATE - SUSPENSION	1
61-2	94055	SUSPENSION BRKT REAR	1
61-3	710095	SHOULDER BOLT 3/8-16 (9X52)	
61-4	710140	NUT, 3/8-16 MACK (15X84)	
64	710233	SPRING, EXTN 4.20X.75OD	
65	94275	GUIDE BELT	2
66	710930	PIN, CIRCLE	2
70	94058-853	BRACKET, FRT SUSPENSION	1
71	710094	BOLT, SHOULDER .375(9X51)	2
72	710140	NUT, 3/8-16HWDFLLK MACK (15X84)	2
73	94158	ZINC ROD, HANGER	1
74	710108	PIN, HAIR (31X4)	1
77	710658	SPRING, EXTENSION	1
78	996416	WASHER, FLAT .391X1.00X.125	1

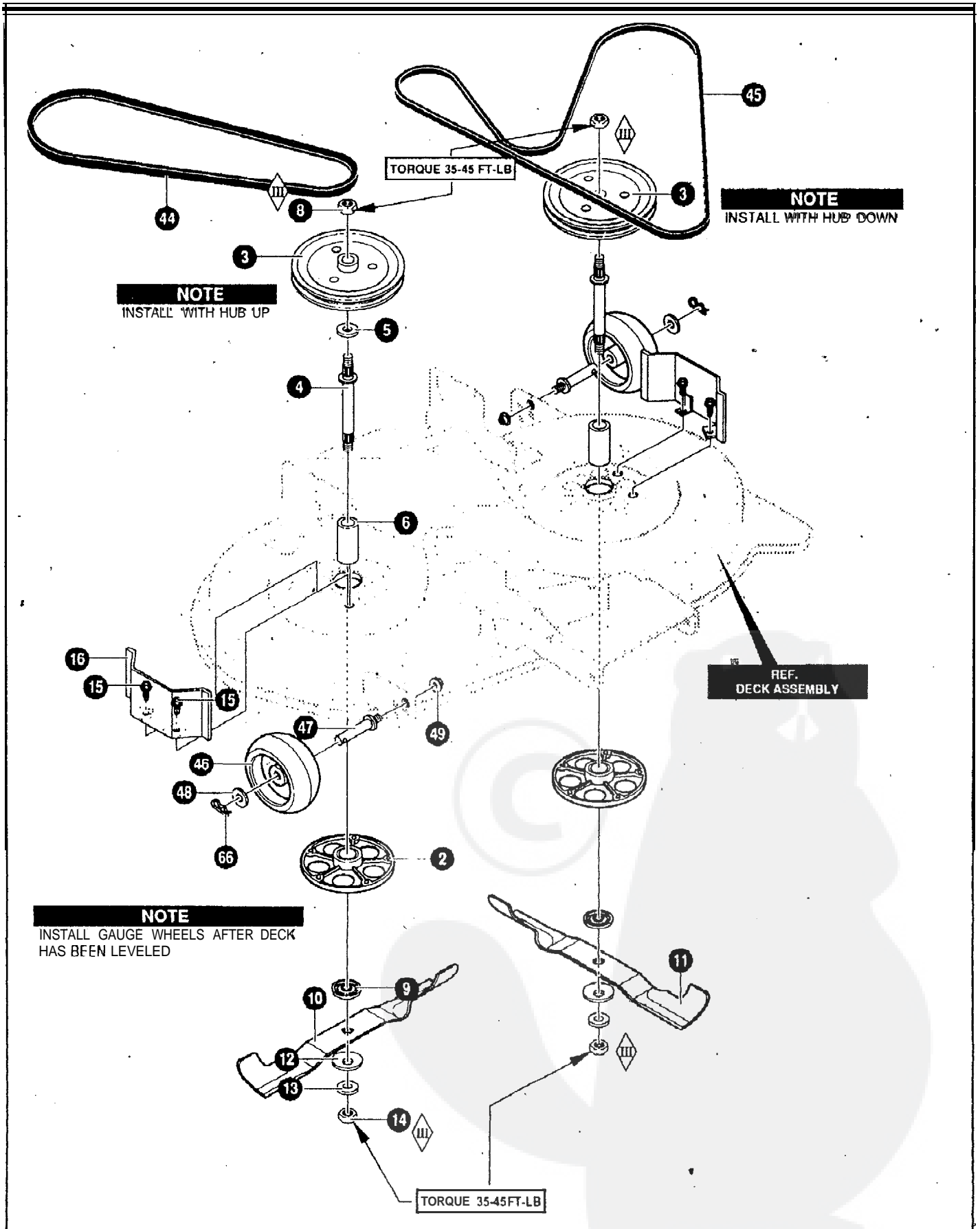

NOTE
INSTALL WITH HUB UP

NOTE
INSTALL WITH HUB DOWN

NOTE
INSTALL GAUGE WHEELS AFTER DECK HAS BEEN LEVELLED

REF.
DECK ASSEMBLY

TORQUE 35-45 FT-LB

NOTE: ALWAYS USE ORIGINAL EQUIPMENT PARTS. Use of service/replacement parts other than original equipment parts may void your warranty.

ALL UNNUMBERED ITEMS ARE INTERCHANGEABLE WITH OPPOSITE SIDE

KEY NO.	PART NO.	DESCRIPTION	QTY
2	94305	ASM.JACKSHAFT HOUSING W/-VENTS	2
3	92425	PULLEY, DECK REBA	2
4	91922	JACKSHAFT, 7.76LG-9/16-18TH	2
5	710117	WASHER,FLAT .625X1.00X.188	1
6	91903.	SPACER	2
8	710408	NUT, 9/16-18 CTLK (15X101)	2
9	94207	ADAPTER, DECK/BLADE	2
10	94208	BLADE, 40" RH REAR DISCHARGE	1
11	94209	BLADE, 40" LH REAR DISCHARGE	1
12	710118	WASHER, FLAT.625X1.75 17X166	2
13	710117	WASHER,FLAT .625X1.00X.188	2
14	710408	NUT, 9/16 REGHEX	2
15	710265	SCREW, 3/8-16X1.00 WAHHSPTAPPL	10
16	94288-853	COVER PULLEY	2
44	710231	BELT, V	1
45	710232	BELT, V- 40" DECK	1
46	92683	GAUGE WHEEL,4.94 DIA.	2
47	94025	BOLT, SPSH 3/8-16X.63SH3.00LG	2
48	710115	WASH ER,FLAT.518X.87X16 17X102	2
49	710140	NUT,3/8-16HWDFLK MACK 15X84	2

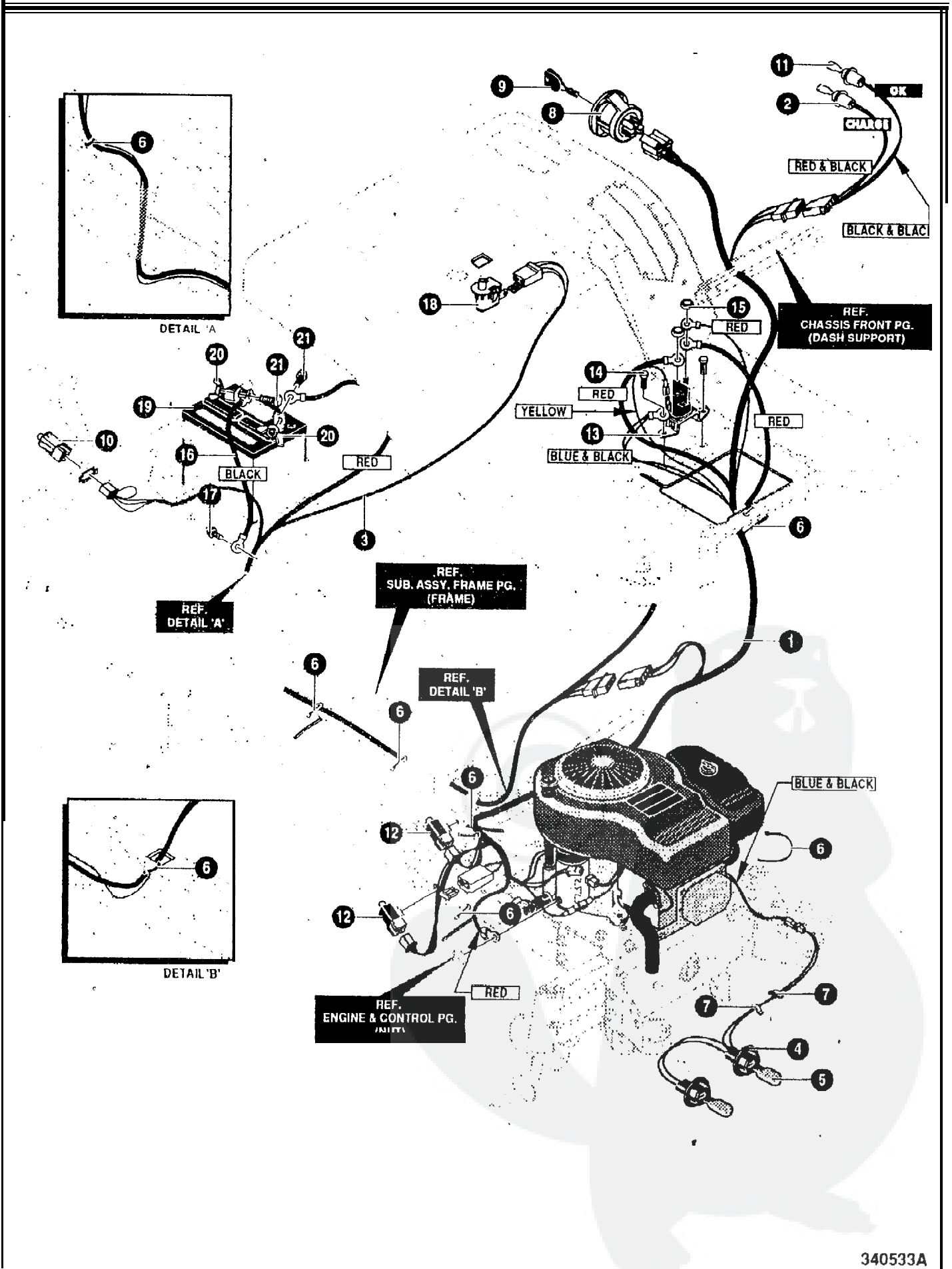

KEY NO.	PART NO.	DESCRIPTION	QTY
1	94745	HARNÉSS 14BS OHVL,H25,REBA,SUS	1
2	94740	HARNÉSS ADAPTER,OK/CHARGE IL	1
3	94742	HARNÉSS, REAR-BATTERY REBA	1
4	303064	ASSY,LIGHT WIRE-1/4 TURN	1
5	52572	BULB, HEADLAMP	2
6	57444	TIE, CABLE BLACK NYLON 5.62L	5
7	41482	PRESS CLIP,1.380LG.255ID	2
8	94762	SWITCH,IGNITION DELTA 7 TERM	1
9	327350	KEY,IGNITION GENERIC DELTA	1
10	320082	SWITCH,DOUBLE POLE NO/NC GRAY	1
11	57769	BULB, INDICATOR	2
12	94136	SWITCH LIMIT DELTA	2
13	94613	SOLENOID	1
14	710133	SCREW,HHWATAP 114X.50	2
15	710203	NUT, 1/4-20 HEXNYL 15X116	2
16	95420	WIRE, GROUND, 20.0"	1
17	710133	SCREW,HHWATAP 114X.50	1
18	94159	SWITCH, SEAT	1
19	302257	BATTERY 12V 7 PLATE	1
20	710225	NUT,WING 1/4-20 (14X79)	2
21	710226	BOLT, 1/4-20X.63 CARR. (2X82)	2

SCHEMATIC WIRING

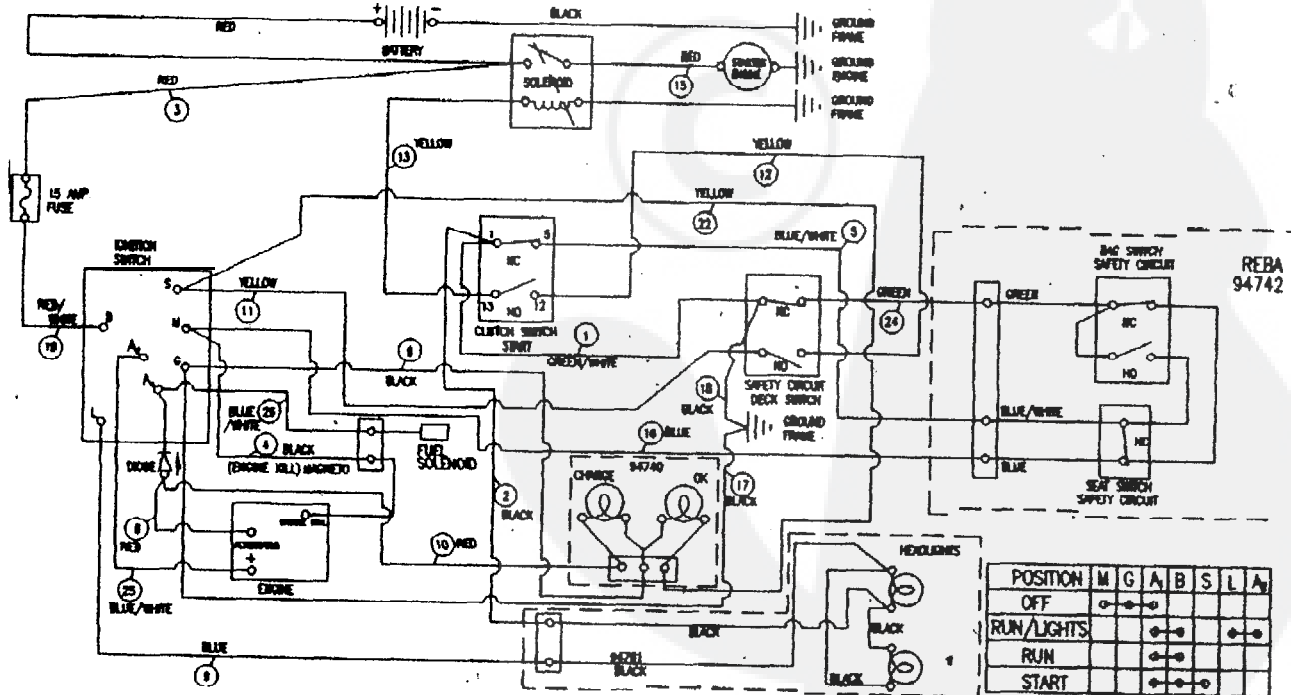

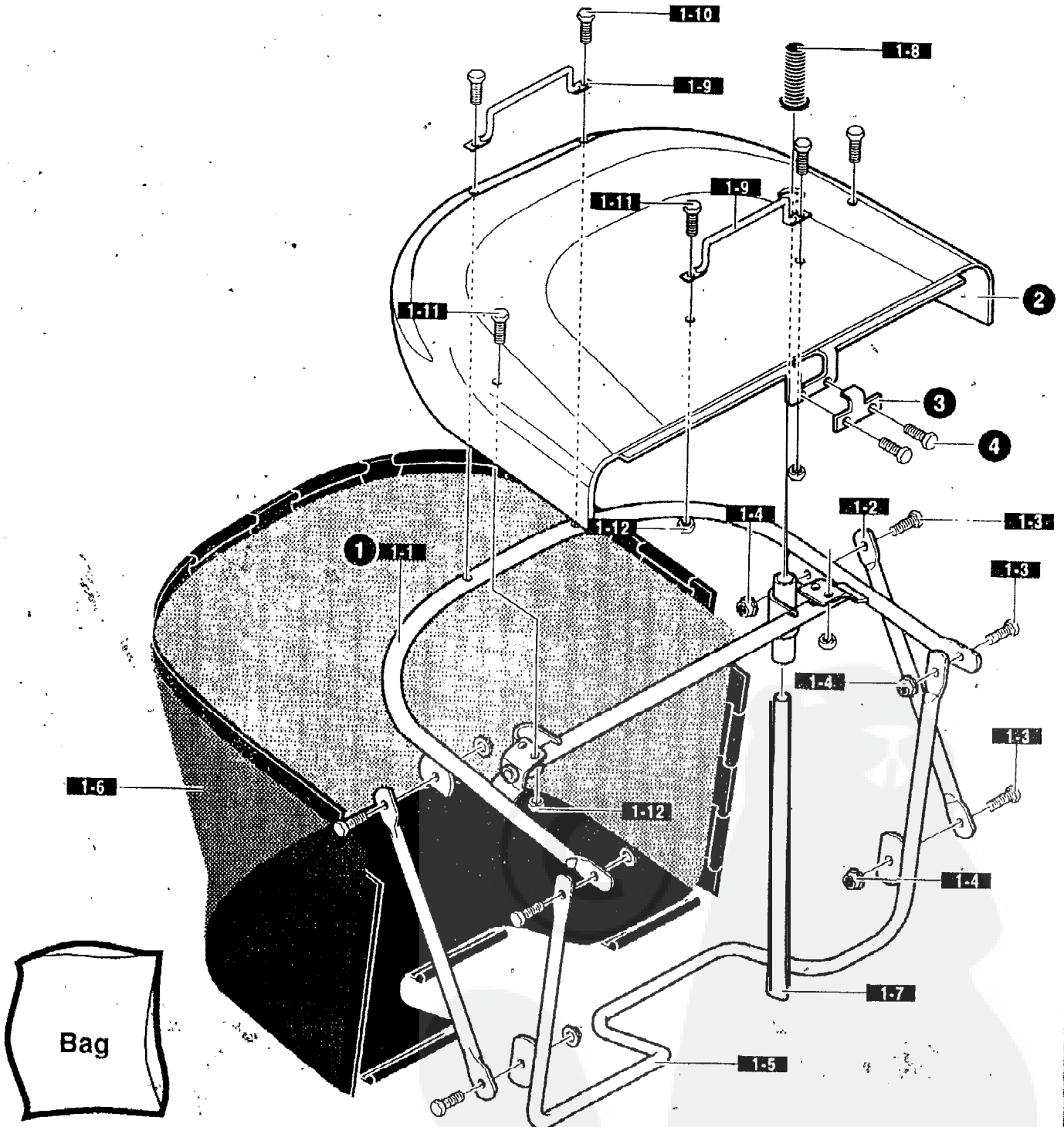

KEY NO.	PART NO.	DESCRIPTION	QTY
1	94560	ASM.GRASS COLLECTOR REBA	1
1-1	94849	ASSY., UPPER FRAME	1
1-2	94850	BRACE, FRAME COLLECTOR REBA	2
1-3	180020	SCREW, 114-20X.75	6
1-4	780029	NUT, 1/4-20 HEX NYLOCK #71035	6
1-5	94851	ASSY., FRONT FRAME REBA COLLECT	1
1-6	94852	BAG, REBA COLLECTOR	1
1-7	94853	HANDLE, DUMP REBA COLLECT.	1
1-8	94854	RUBBER GRIP 7/8" REBA'	1
1-9	94855	HANDLE, REBA COLLECTOR	2
1-10	710266	SCREW, 1 O-24X.38 SLHWATAP	2
1-11	710266	SCREW, 1 O-24X.38 SLHWATAP	4
1-12	308459	NUT, #1O-24 HXHDNYLK	4
2	94908-860	TOP COVER, COLLECTOR REBA	1
3	94244	BRACKET, SWITCH	1
4		POP RIVET (NON SERVICEABLE PART)	

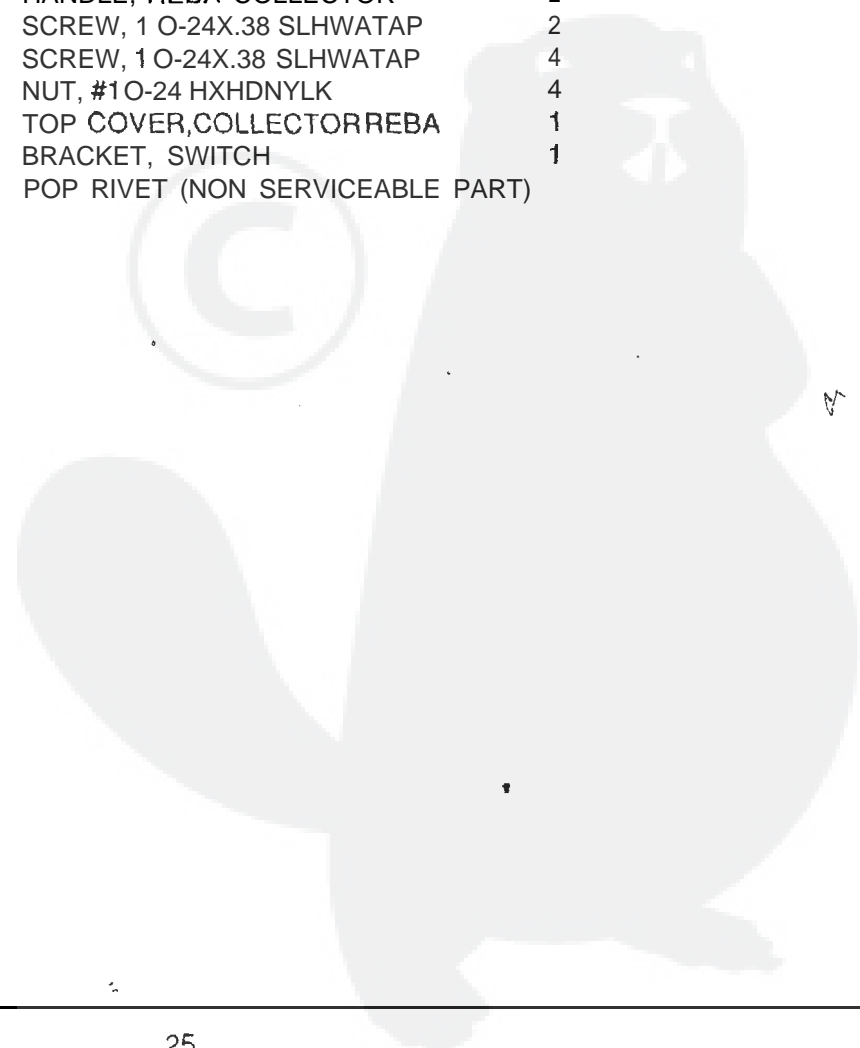

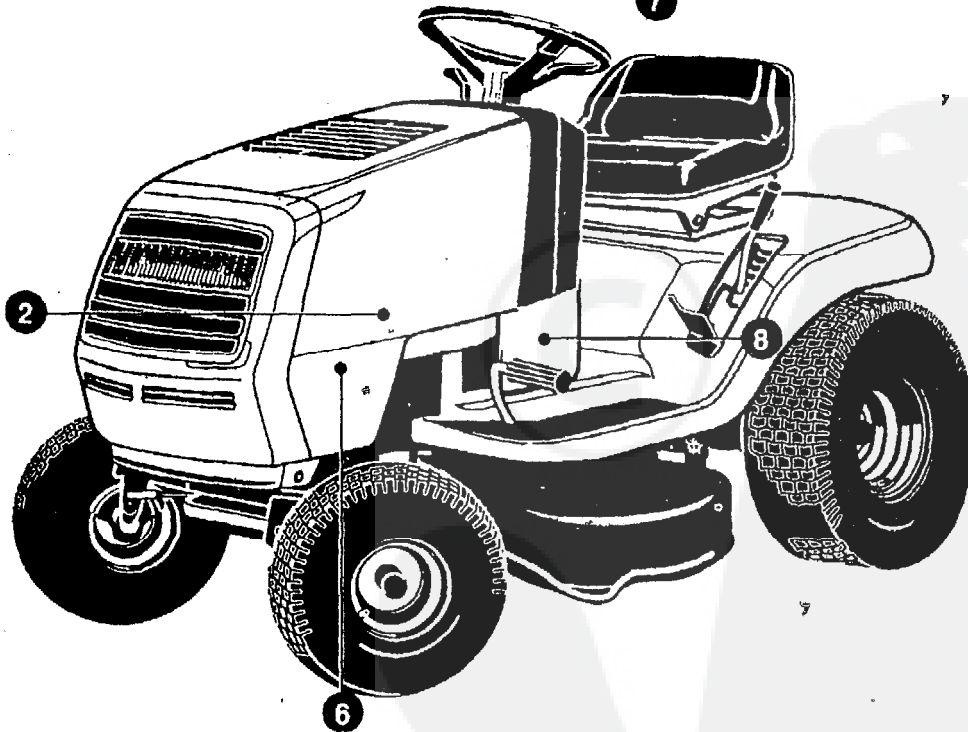
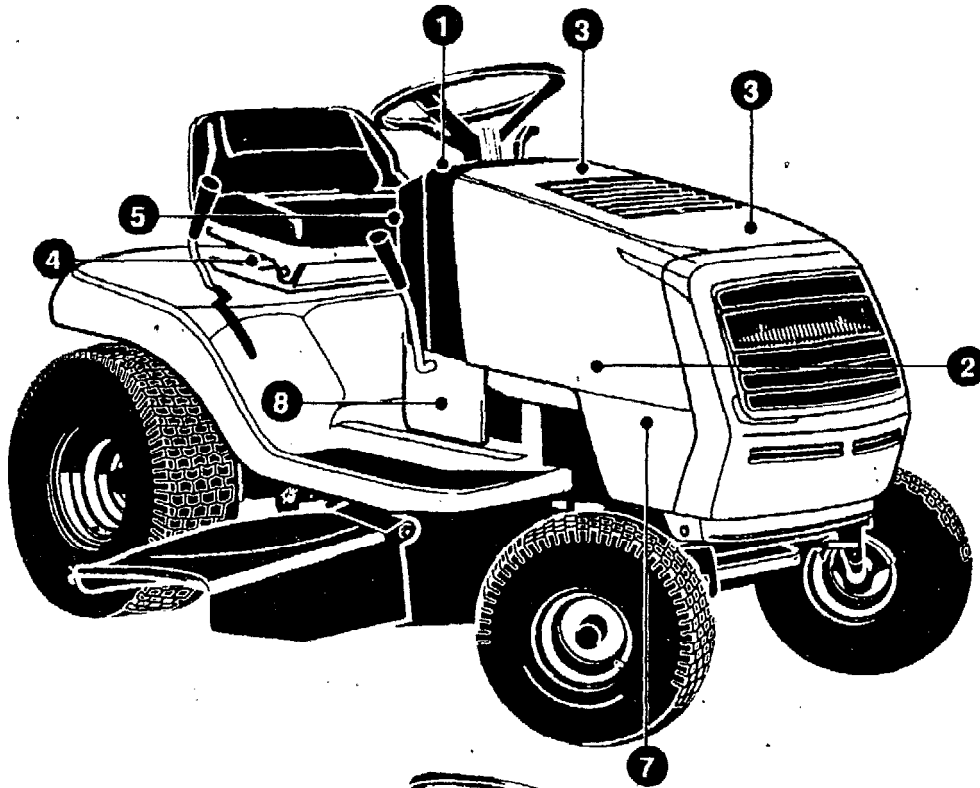

KEY PART NO.	PART NO.	DESCRIPTION	QTY
1	334963	DECAL, DASH	1
2	305602	PAD, FOAM HOOD 4X15	2
3	305603	PAD, FOAM HOOD 18X6	2
4		NOT A SERVICEABLE PART	
5	71069-i	DECAL, PARK BRAKE (P)	1
6	711003	DECAL, HOOD TURBOGREEN LH	1
7	711004	DECAL, HOOD TURBOGREEN RH	1
8	711337	DECAL, 145/1 02 AUTOMATIC DRIVE	2

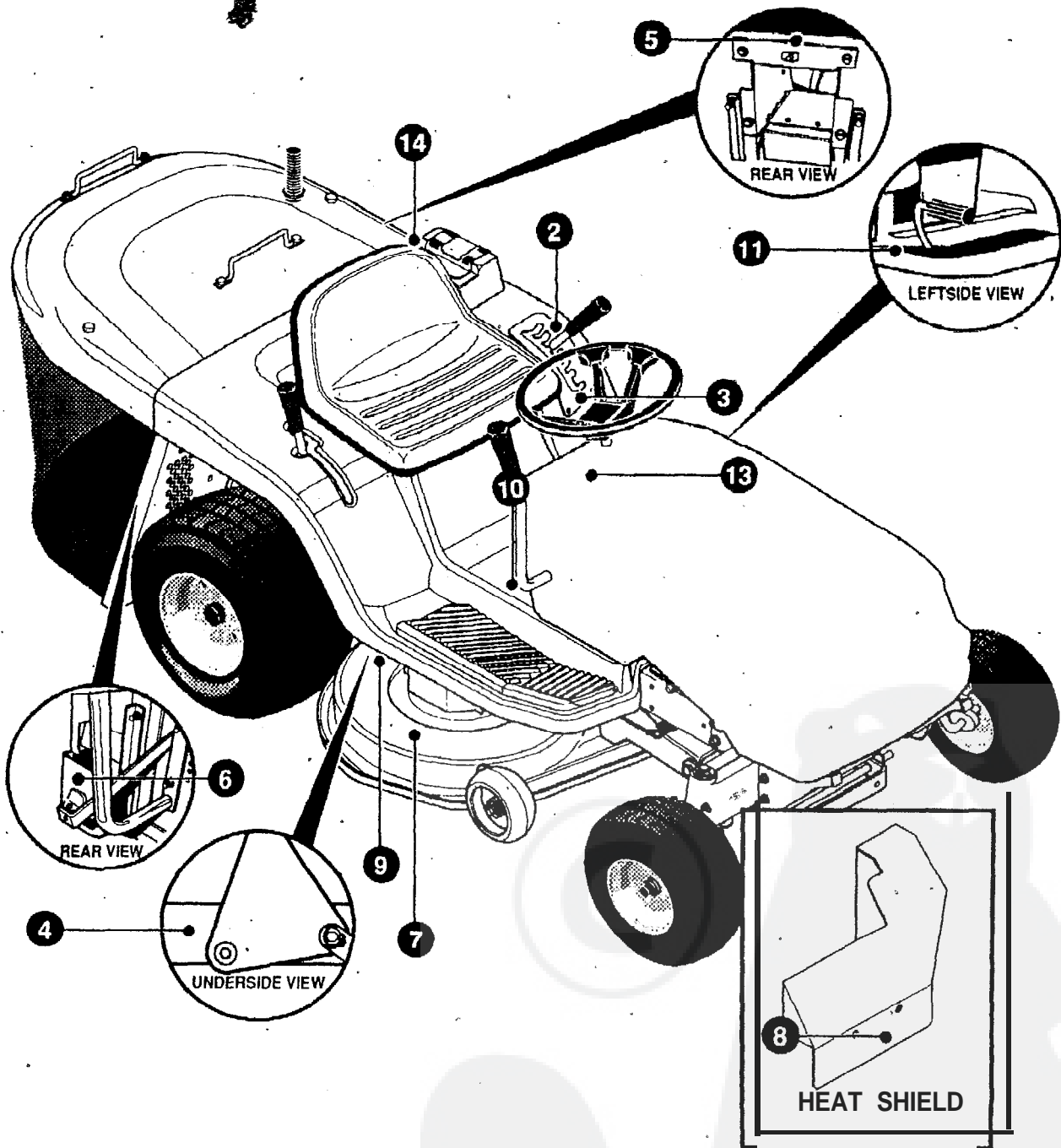

**KEY PART
NO. NO.**

2	
3	710638 710683
5	710523
6	338541
	338542
7	
8	402700 338543
9	710684
10	710534
11	402702
13	710270
14	710771

DESCRIPTION

DECAL, HEIGHT ADJUST 1-6
DECAL, DECK LEVEL REBA/NLT EXP
DECAL, PINCH POINTS WARNING
DECAL, BAGGER "CE" M344X5939
DECAL, DRAWBAR WARN M#44X6138
DECAL, CAUTION DECK LH
DECAL, HOT SURF WARN M#44X5936
DECAL, DECK BELT ROUTE REBA
DECAL, CONS CAUT. M#44X6815
DECAL, BRAKE/CLUTCH PICTOGRAM
DECAL, AUTODRIVE INSTR DASH RT
DECAL, REBA HYDRO DUMP VALVE

QTY

1
1
1
1
1
2
1
1
1
1
1
1