

**NOTE: ALWAYS USE ORIGINAL EQUIPMENT PARTS.**  
Use of service/replacement parts other than original equipment parts may void your warranty.

ALL UNNUMBERED  
ITEMS ARE INTERCHANGEABLE  
WITH OPPOSITE SIDE

343748A

# FRONT CHASSIS' ASSEMBLY

KEY NO.	PART NO.	DESCRIPTION	QTY
1	94212-853	BRACKET, HOOD RH	1
2	94213-853	BRACKET, HOOD LH	1
3	711606	SCREW, 5116-1 8X.75	4
4	94842	DASH	1
5	711629	SCREW, 1/4-14X.50	4
6	94214	BEARING	1
7	710197	SCREW, 1/4-14 X .50 PAN	2
8	94211-853	PLATE-DASH PANEL	61
9	711629	SCREW, 10-24 X .5	1
10	690104	ASSY, LOWER CONSOLE	1
10-1	95323	SUPPORT DASH	1
10-2	94215	SUPPORT CHANNEL	1
11	711606	SC-18 X.75 HHWATAP	4
13	94972-860	HOOD	1
14	92367	GRILL ASSY	1
15	711679	SCREW, .230 X .135 PANTAP	4
16	690093	ROD, HOOD-PIVOT	1
17	7 1 1 6 7 6	HAIR PIN	1
18	94313	BELLOWS	1
19	712063	WASHER, BEVILLE	1
20	95366-860	PANEL, ACCESS	1
21	710196	SCREW; 10-24 X .50	2
	712205	OPERATOR'S MANUAL(NOT SHOWN)	

**NOTE**  
APPLY KEY# 80 TO INSIDE OF KEY# 16.

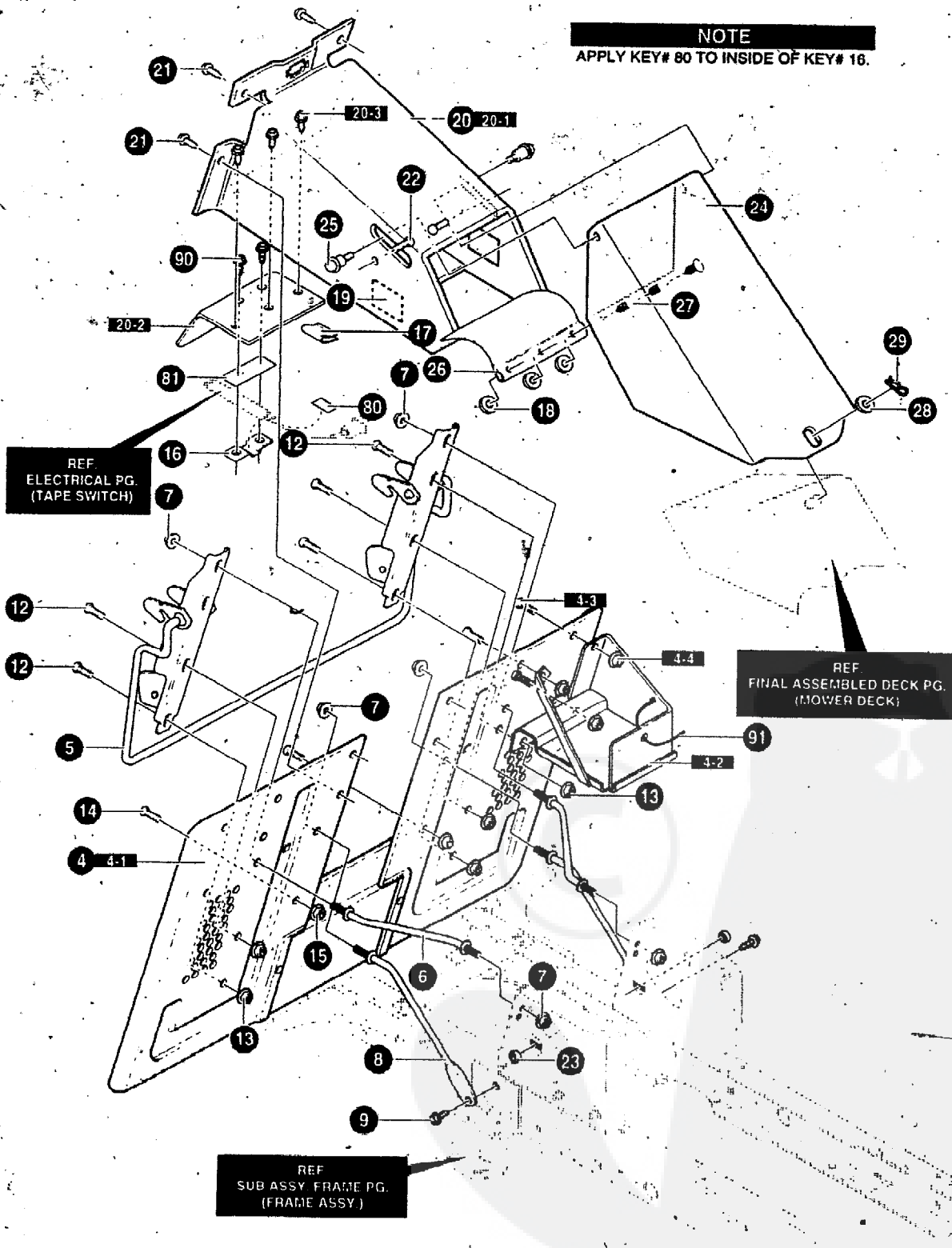

**NOTE:** ALWAYS USE ORIGINAL EQUIPMENT PARTS. Use of service/replacement parts other than original equipment parts may void your warranty.

ALL UNNUMBERED ITEMS ARE INTERCHANGEABLE WITH OPPOSITE SIDE

# REAR CHASSIS ASSEMBLY

KEY PART NO.	PART NO.	DESCRIPTION	QTY
4	343678-953	ASSY, BACK PLATE/BATTERY	1
4-1	95162	ASM. BACKPLATE FLAT	1
4-2	9 4 5 6 3	BATTERY TRAY ASM.	1
4-3	180073	SCREW, 5/16-18X.50 HHC	3
4-4	4 5 1 7 4	NUT, 5/16-18 HEXWDFLLK WHIZ	3
5	95359-853	WELDMENT-LATCH LEVER	1
6	690097	ROD, BRACE	2
7	7 1 1 9 0 6	NUT, 3/8-16 HWDFL WHIZ-LOCK	5
8	94231	ROD, BRACE	2
9	711606	SCREW, 5/16-18X.75 HHWATAP	2
12	711907	SCREW 5/16-18X.75 HXWDFL	5
13	710026	NUT, 5/16-18 HEXWDFLLK WHIZ	5
14	711606	SCREW 5/16-18X.75 HHWATAP	2
15	710026	NUT, 5/16-18 HEXWDFLLK WHIZ	2
16	95390-853	BRACKET, FLEX. SWITCH MOUNTING	1
17	55939	WIRE CLIP, ADHESIVE	1
18	711666	WASHER, FLAT .203X.56X.040	3
19	318197	PAD, ADHESIVE 1.00X1.50X.12	2
20	690102-853	ASM., T/A SHIELD & UPPER CHUTE	1
20-1	94350	CHUTE WELD ASM. UPPER	1
20-2	95367	SHIELD, TRANSAXLE	1
20-3	711642	SCREW, 1/4-20X.63 HHWATAP	4
21	711606	SCREW, 5/16-18X.75 HHC	4
22	711688	BOLT, 5/16-18X.75 CARR	2
23	710026	NUT, 5/16-18 HEXWDFLLK WHIZ	2
24	94296-853	MIDDLE CHUTE ASSY	1
25	711908	BOLT, .500X.453 3/8-16	2
26	94264	FLAP, CHUTE	1
27	309235	FASTENER, RATCHET	3
28	711617	FLATWASHER	1
29	711682	PIN, HAIR .38DIA X 1.64LG	1
80	712009	TAPE, DOUBLE SIDED FOAM 3/4" WD	0.560
81	712009	TAPE, DOUBLE SIDED FOAM 3/4" WD	3
90	711642	SCREW, 1/4-20X.63 HHWATAP	2
91	57444	CABLE TIE	1

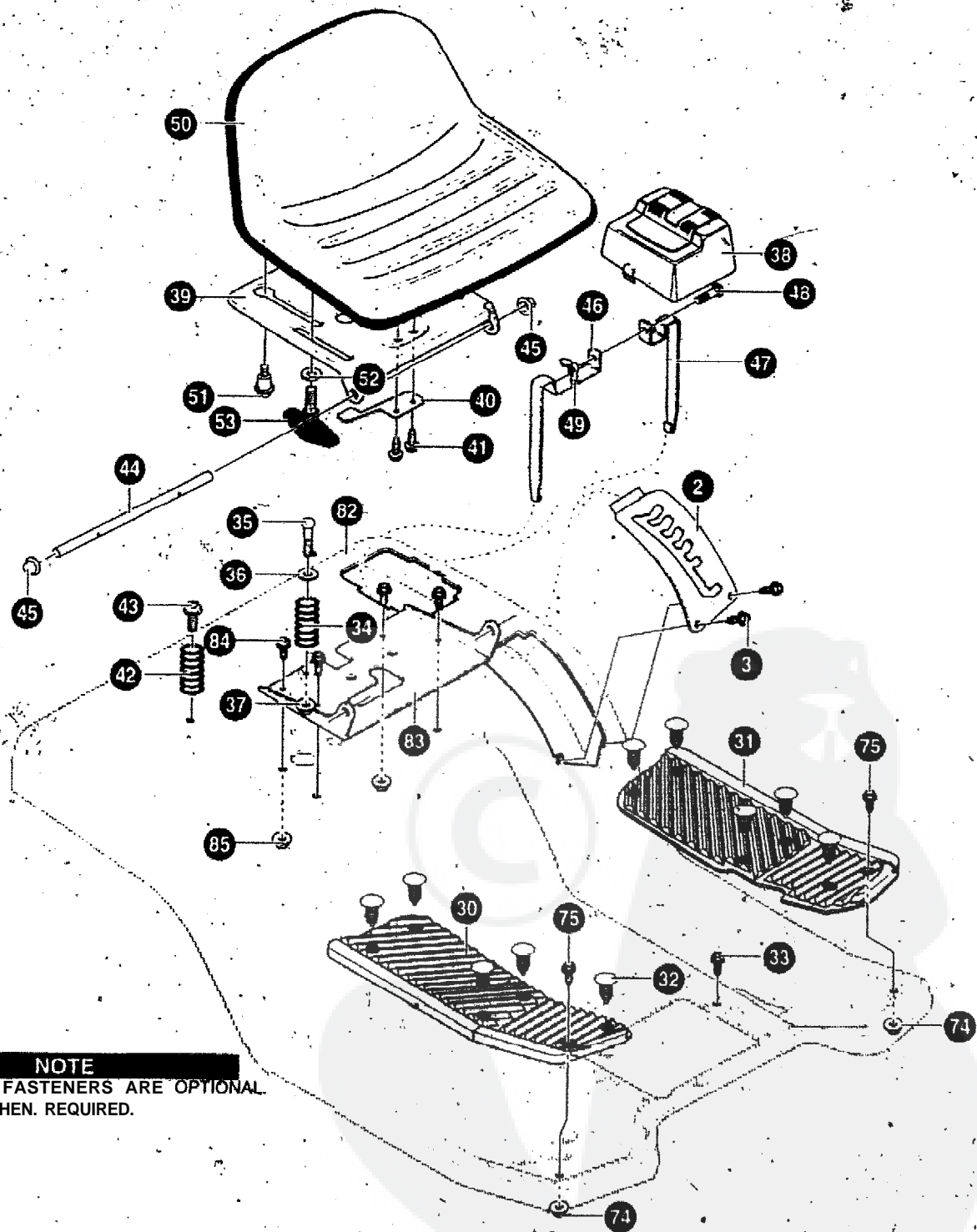

**NOTE**  
 FOOTPAD & FASTENERS ARE OPTIONAL.  
 ONLY USE WHEN REQUIRED.

**NOTE:** ALWAYS USE ORIGINAL EQUIPMENT PARTS.  
 Use of service/replacement parts other than original  
 equipment parts may void your warranty.

ALL UNNUMBERED  
 ITEMS ARE INTERCHANGEABLE  
 WITH OPPOSITE SIDE

# REAR CHASSIS ASSEMBLY

KEY NO.	PART NO.	DESCRIPTION	QTY
2	95190-853	PLATE, LIFT DETENT	1
3	711741	SCREW, #12X.50 PHPNHTAP	2
30	95409	FOOTREST PAD RH	1
31	95408	FOOTREST PAD LH	1
82	309235	RATCHET FASTENER	10
33	711606	SCREW, 5/16-18X.75HHWATAP	3
34	710136	SPRING, COMPRESSION 4.57LGX1.17	1
35	711610	BOLT, SHOULDER 1/4-20	1
36	95293	ZINC WASHER C U P	1
3 7	4 6 9 3 1	NUT, 1/4-20 WDFLLK	1
38	94200	COVER, BATTERY	1
39	94154-860	SUPPORT, SEAT	1
40	94057	SPRING-LEAF	1
41	7 1 1 5 9 2	SCREW, 1/4-20X.50 WAHHTAP	2
42	710109	SPRING, COMPRESSION 2.43LG 164X30	2
43	711606	SCREW, 5/16-18X.75 HHWATAP	2
44	95294	ZINC HINGE SEAT PIVOT	1
4 5	711627	NUT, PUSH CAP, 375	2
46	95393-853	BATTERY BRACKET L.H.	1
47	95394-853	BATTERY BRACKET R.H.	1
48	711680	BOLT, 1/4-20X.63 CARR.	1
49	711638	NUT, WING 1/4-20 14X79	1
50	95415	SEAT	1
5 1	7 1 1 6 5 4	BOLT, SHOULDER 5/16-18	2
52	7 1 1 6 4 4	WASHER, FLAY. .344X.62X.06	2
53	711747	BOLT, WING 5/16-18X.50	2
74	710026	NUT, 5/16-18 HEXWDFLLK WHIZ	2
75	711891	BOLT, 5/16-18X.7A5 CARR.	2
82	9431 i-860	ASM., SEAT DECK PEDAL HYDRO	1
83	94153-860	BRACKET, PIVOT SEAT	1
84	711606	SCREW, 5/16-18X.75 HHWATAP	4
85	711634	NUT, 5/16-18 WDFLLK	2

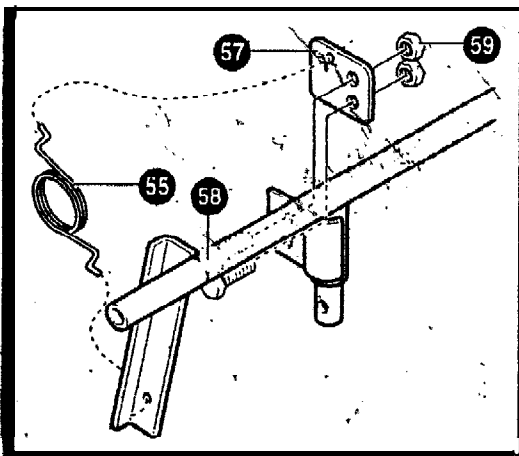
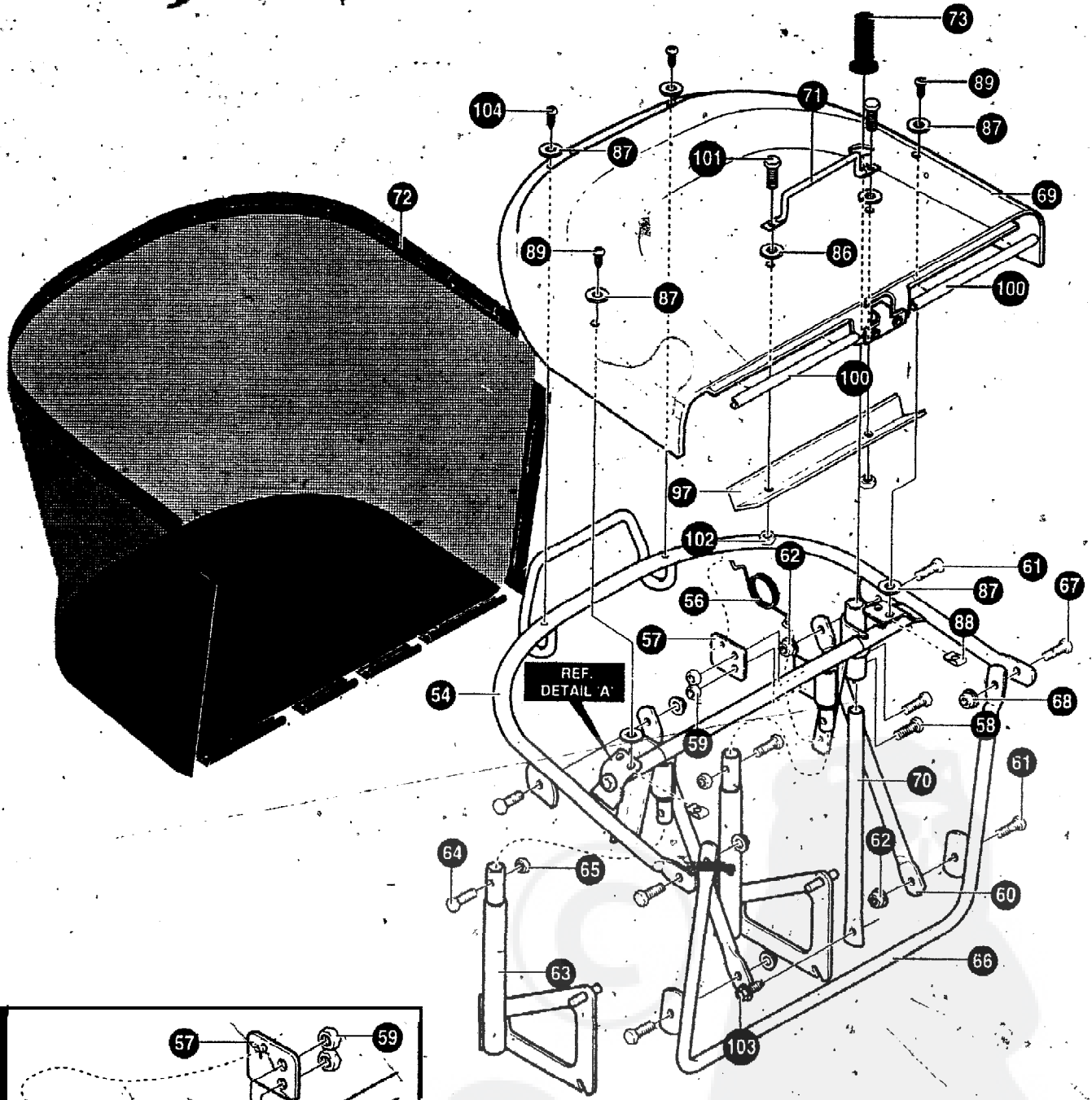

DETAIL 'A'

NOTE: ALWAYS USE ORIGINAL EQUIPMENT PARTS. Use of service/replacement parts other than original equipment parts may void your warranty.

A L L UNNUMBERED ITEMS ARE INTERCHANGEABLE WITH OPPOSITE SIDE

343655B

# REAR CHASSIS ASSEMBLY

KEY NO.	PART NO.	DESCRIPTION	QTY
54	690044-853	ASM: WELD UPPER FRAME	1
55	690003	SPRING, TORSION RH	1
56	690004	SPRING, TORSION LH	1
57	95339-853	BRACKET, SPRING COLLECTOR	2
58	180016	SCREW, 1/4-20X.50 HHC	4
59	7 8 2 5 8 5	NUT, 1/4-20 REGHEXCTRLK	4
60	94850-853	BRACE, FRAME COLLECTOR	2
61	711909	SCREW, 1/4-20X.62 HHC	4
6 2	711632	NUT, 1/4-20HEXNYL	4
63	95343-853	WELD ASM., SUPPORT COLLECTOR	2
64	180034	SCREW, 1/4-20X1.50	2
6 5	782585	NUT, 1/4-20 REGHEXCTRLK	2
66	95349-853	WELD ASM., FRONT FRAME COLLECT.	1
67	711909	S C R E W , 1/4-20X.62 HHC	2
68	711632	NUT, 1/4-20 MEXNYL	2
69	94908-860	TOP COLLECTOR ASM.	2
70	94853	HANDLE, DUMP COLLECTOR	1
71	94855-853	HANDLE, REBA COLLECTOR	1
72	95389	REBA COLLECTOR BAG	1
73	94854	RUBBER GRIP	1
86	7 1 2 1 2 9	WASHER, .281X1.25X.06	2
87	711921	WASHER, .328X1.06X.062	6
88	578107	NUT, 1/4-20 TINN U	2
8 9	711674	SCREW, 1/4-20X.63 PHPNHD	2
97	690010-853	B R A C E , B A G G E R	1
1 0 0	55023	TRIM 77.5 INCHES	22 IN.
101	712088	SCREW 1/4-20X1.50 PHPNHD	2
102	711632	NUT, 1/4-20 HEXNYL	2
103	710266	SCREW, 10,24X.38 SLHWATAP	1
104	711741	SCREW, #12X.50 PHPNHTAP	2



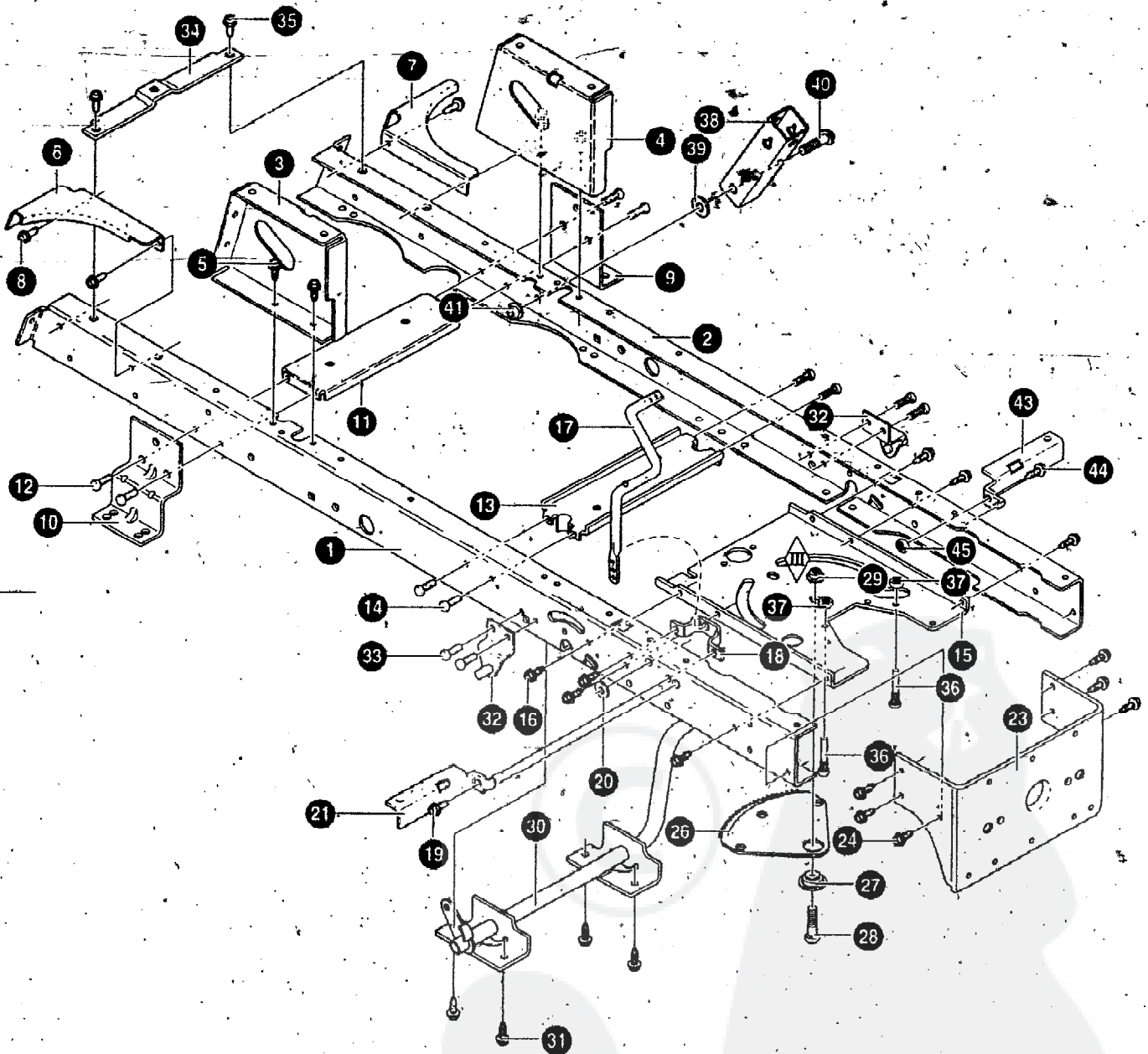

NOTE: ALWAYS USE ORIGINAL EQUIPMENT PARTS.  
Use of service/replacement parts other than original  
equipment parts may void your warranty.

ALL UNNUMBERED  
ITEMS ARE INTERCHANGEABLE  
WITH OPPOSITE SIDE

343768A

# FRAME ASSEMBLY

KEY NO.	PART NO.	DESCRIPTION	QTY
1	94564	FRAME, RAIL RH	1
2	94565	FRAME, RAIL LH	1
3	9 4 6 3 4	SUPPORT, SEAT. RH	1
4	94633..	SUPPORT, SEAT LH	1
5	710079	SCREW 5/16-1 8X.75 HHWATAP	4
6	9 4 5 6 1	BRACE, BACKPLATE RH	1
7	94562	BRACE, BACKPLATE LH	1
8	7 1 0 0 7 9	SCREW, 5/16-18X.75 HHWATAP	4
<del>9</del>	<del>94008</del>	<del>BRACKET, TRANSAXLE</del>	<del>1</del>
10	9 4 2 3 4	BRACKET, T/A RH-VST LH-MST	1
11	94236	ASM. IDLER MOUNT REAR	1
12	710079.	SCREW, 5/16-18X.75 HHWATAP	4
13	94237	ASM. IDLER MOUNT, FRONT	1
14	710079.	SCREW, 5/16-1 8X.75 HHWATAP	4
15	94003	PLATE, STERRING MOUNTING .	1
16	710079	SCREW, 5/16-18X.75 HHWATAP	6
17	94019	CRANK, PTO .	1.
18	94005	BRACKET, BELL CRANK	1
19	710079	SCREW, 5/16-18X.75 HHWATAP	2
20	120395	WASHER, FLAT .469X.92X.065	1
21	690035	BRACKET, SEAT RH.	1
23	94013	BRACKET, HANGER REAR	1
24	7 1 0 0 7 9	SCREW, 5/16-18X.75 HHWATAP	6
26.	9 4 1 2 1	GEAR, SECTOR	1
27	94123	B E A R I N G , SECTOR GEAR .	1
28	710312	SCREW, 5/16-1 8X1.00	1
29	7 1 0 1 0 5	NUT, 5/16-18 HEXKEPS 15X1 13	1
3 0	94241	ASM. CLUTCH/BRAKE PEDAL	1
31	7 1 0 0 7 9	SCREW, 5/16-1 8X.75 HHWATAP	4
3 2	94285	BRACKET, SUSPENSION	1
33	710079	SCREW, 5/16-18X.75 HHWATAP	4
3 4	94566	BRACE, RAIL	1
35	710079	SCREW, 5/16-18X.75 HHWATAP	2
36	93349.	ZINC SCREW GUIDE 5116-1 8	2
37	710204	NUT, 5/16-18 HEXWDFLLK WHIZ.	2
38	94015	PIVOT BRACKET	1
39	8 4 5	WASHER, FLAT .390X1.25X.1	19 1
40	710000	BOLT, .562X1.563 HSSH 3/8-16	1
41	710140	NUT, 3/8-16 HWDFLLK MACK 15X84	1
43	690036	BRACKET, SEAT DECK LH	1
44	710079	SCREW, 5/16-18X.75 H H W A T A P	1
45	710204	NUT, 5116-t 8 HEXWDFLLK WHIZ	1

REF.  
SUB. ASSY. FRAME PG.  
(SECTOR GEAR)

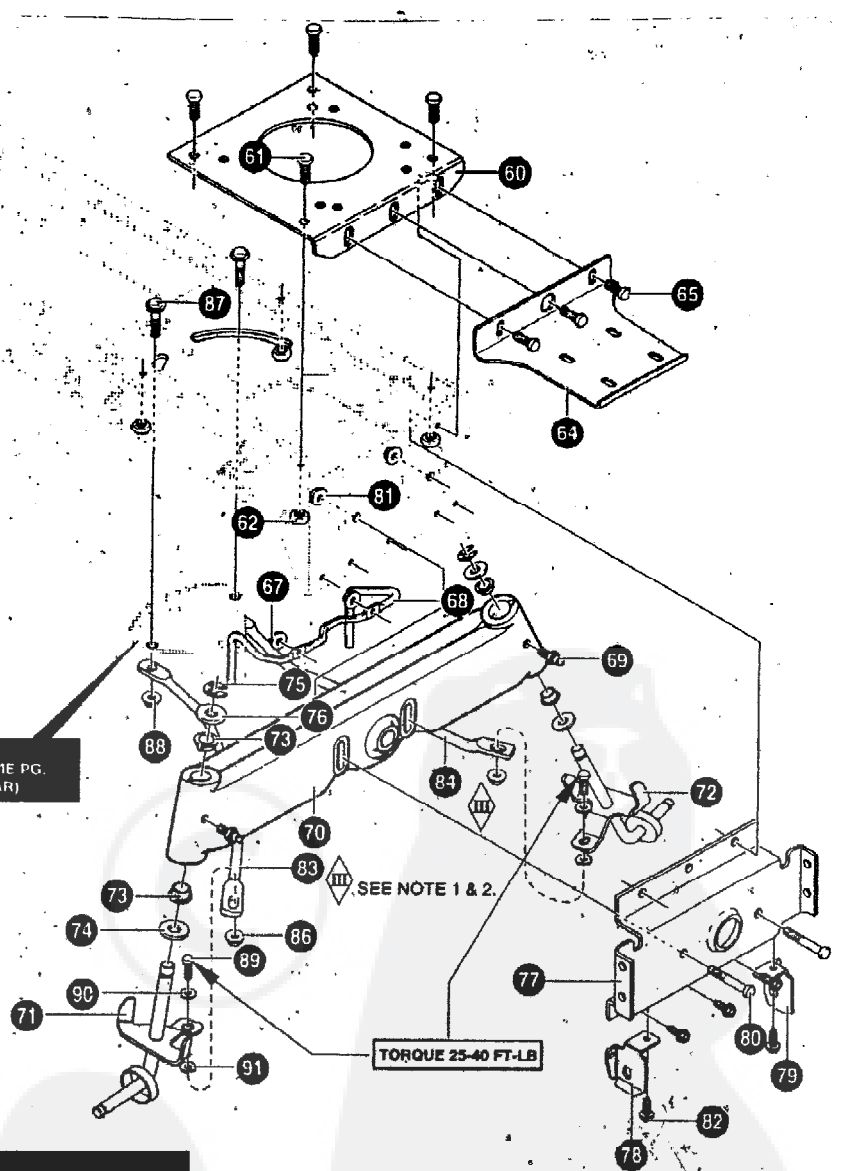

- NOTE**
1. USE FIXTURE# \_\_\_\_\_ TO ALIGN DRAGLINK AND RH FRONT AXLE SPINDLE ASSEMBLY FOR CORRECT TOE IN.
  2. USE FIXTURE1 \_\_\_\_\_ TO ALIGN DRAGLINK AND LH FRONT AXLE SPINDLE ASSEMBLY FOR CORRECT TOE IN.
  3. TOE IN TO BE .00-.30" TOTAL.

**NOTE: ALWAYS USE ORIGINAL EQUIPMENT PARTS.**  
Use of service/replacement parts other than original equipment parts may void your warranty.

ALL UNNUMBERED  
ITEMS ARE INTERCHANGEABLE  
WITH OPPOSITE SIDE

343768A

# FRAME ASSEMBLY

KEY NO.	PART NO.	DESCRIPTION	QTY
6	0 940089	PLATE, ENGINE	1
61		SCREW, 5/16-18X.75 HHWATAP	4
62	710205	NUT, 5/16-18 HEXWDFLLK WHIZ	4
64	94306	BRACKET, MUFFLER MOUNT	1
65	710079	SCREW, 5/16-1 8X.75 HHWATAP	3
67	45174	NUT, 5/16-18 HEXWDFLLK WHIZ	2
68	94310	GUIDE STACK PULLEY BELT	1
69	706	ZERK, GREASE FITTING	2
70	95405	AXLE, CAST MACHINED	1
71	95182	SPINDLE, LONG RH	1
72	95183	SPINDLE, LONG LH	1
73	92527	BEARING, SPINDLE	4
7	4 710129	WASHER	2
75	710103	WASHER, FLAT	2
76	710088	WASHER, FLAT	2
77	94007	HANGER, AXLE	1
78	94290	HANGER, DECK RH	1
79	94289	HANGER, DECK LH	1
80	180113	SCREW, 5/16-1 8X3.00	2
81	710205	NUT, 5/16-1 8	2
82	710079	SCREW, 5/16-1 8X.75	5
83	95329	DRAGLINK RH	1
84	95328	DRAGLINK LH	1
86	710140	NUT, 3/8-16 HWDFLLK MACK 15X84	2
87	710440	BOLT, SHOULDER 9X57	
88	710140	NUT, 3/8-16 HWDFLLK MACK 15X84	2
89	710082	SCREW, 3/8-16X1.5	2
90	710083	WASHER, FLAT .391 XI .00X.083	2
91	710142	WASHER, FLAT	2

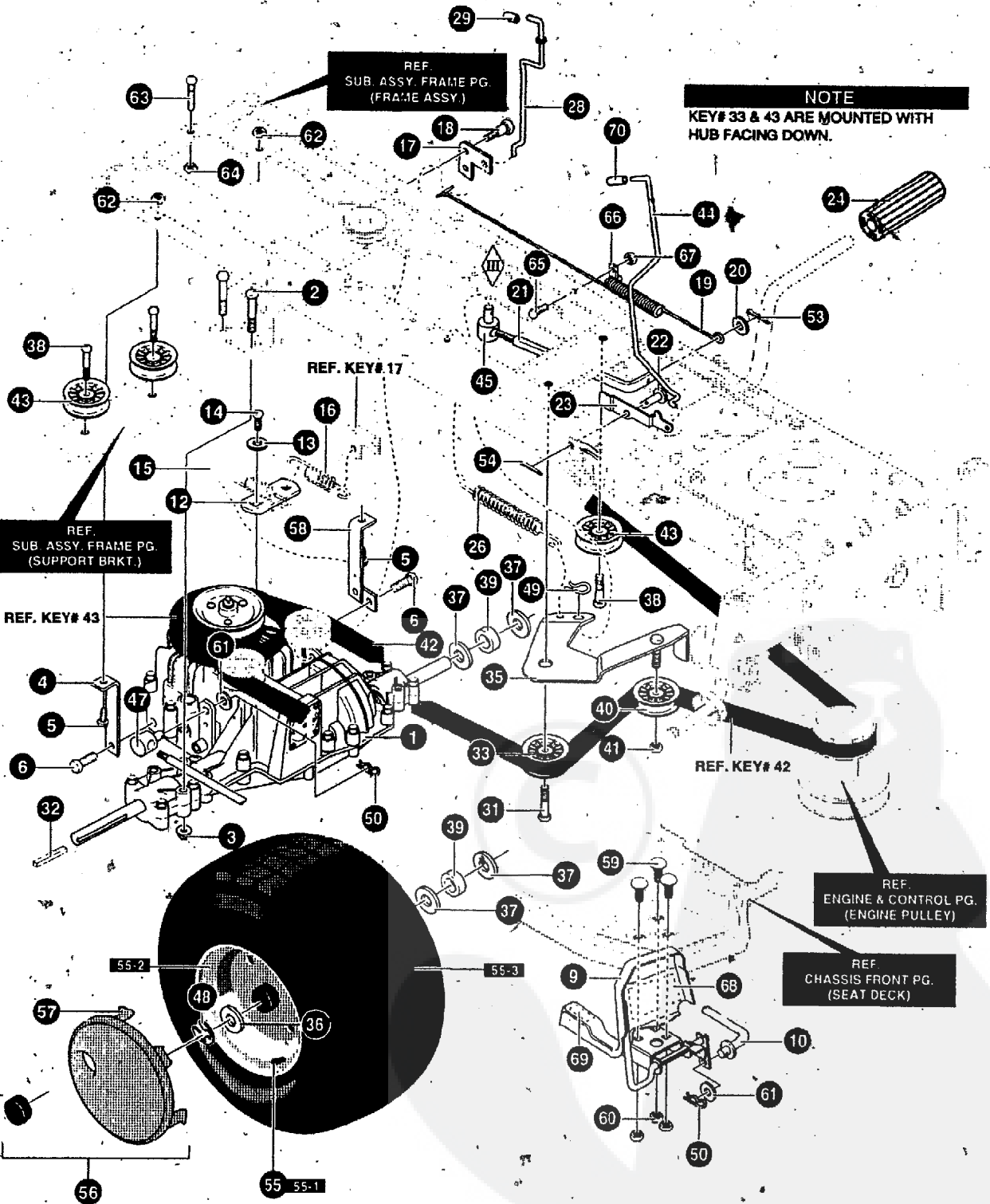

**NOTE: ALWAYS USE ORIGINAL EQUIPMENT PARTS.**  
 Use of service/replacement parts other than original equipment parts may void your warranty.

ALL UNNUMBERED  
 ITEMS ARE INTERCHANGEABLE  
 WITH OPPOSITE SIDE

# MOTION DRIVE ASSEMBLY

KEY NO.	PART NO.	DESCRIPTION	QTY
	1	TRANSAXLE HYDRO VST205-025BM	1
2	711669	SCREW, 5/16-18X2.50	4
	3	NUT, 5/16-18 WDFLLK	4
	4	BRACKET, STABILIZER HYDRO	1
	5	714893	2
	6	710268	2
	9	94422-853	1
	10	690018	1
	12	323212	1
	13	711895	1
	14	710345	1
	15	94622	1
	16	326780	1
	17	94621-853	1
	18	711896	1
	19	95424	1
	20	711921	1
	21	690016	1
	22	711903	1
	23	95290	1
	24	21544	1
	26	711522	1
	28	690015	1
	29	690032	1
	31	711905	1
	32	52928	2
	33	95531	1
	35	94238-853	1
	36	711758	2
	37	711904	4
	38	711905	3
	39	95274	2
	40	-91179	1
	41	711920	1
	42	94609	1
	43	95531	3
	44	690047	1
	45	711898	1
	47	711694	1
	48	710103	2
	49	711899	1
	50	711676	2
	53	711897	1
	54	711897	1
	55	692290	2
	55-1	338512	1
	55-2	338524	1
	55-3	338526	1
	56	94618	2
	56	-	NOT USED ON THIS UNIT
	57	-	NOT USED ON THIS UNIT
	58	94225-853	1
	59	711688	3
60	710026	NUT, 5/16-18 HEXWDFLLK WHIZ	3
	61	711894	2
	62	710026	2
	63	711745	1
	64	711633	1
	65	180016	1
	66	711742	1
	67	780285	1
	68	93248	1
	69	93249	1
	70	335980	1

\* CONTACT YOUR NEAREST TRANSAXLE DEALER FOR PARTS AND SERVICE.

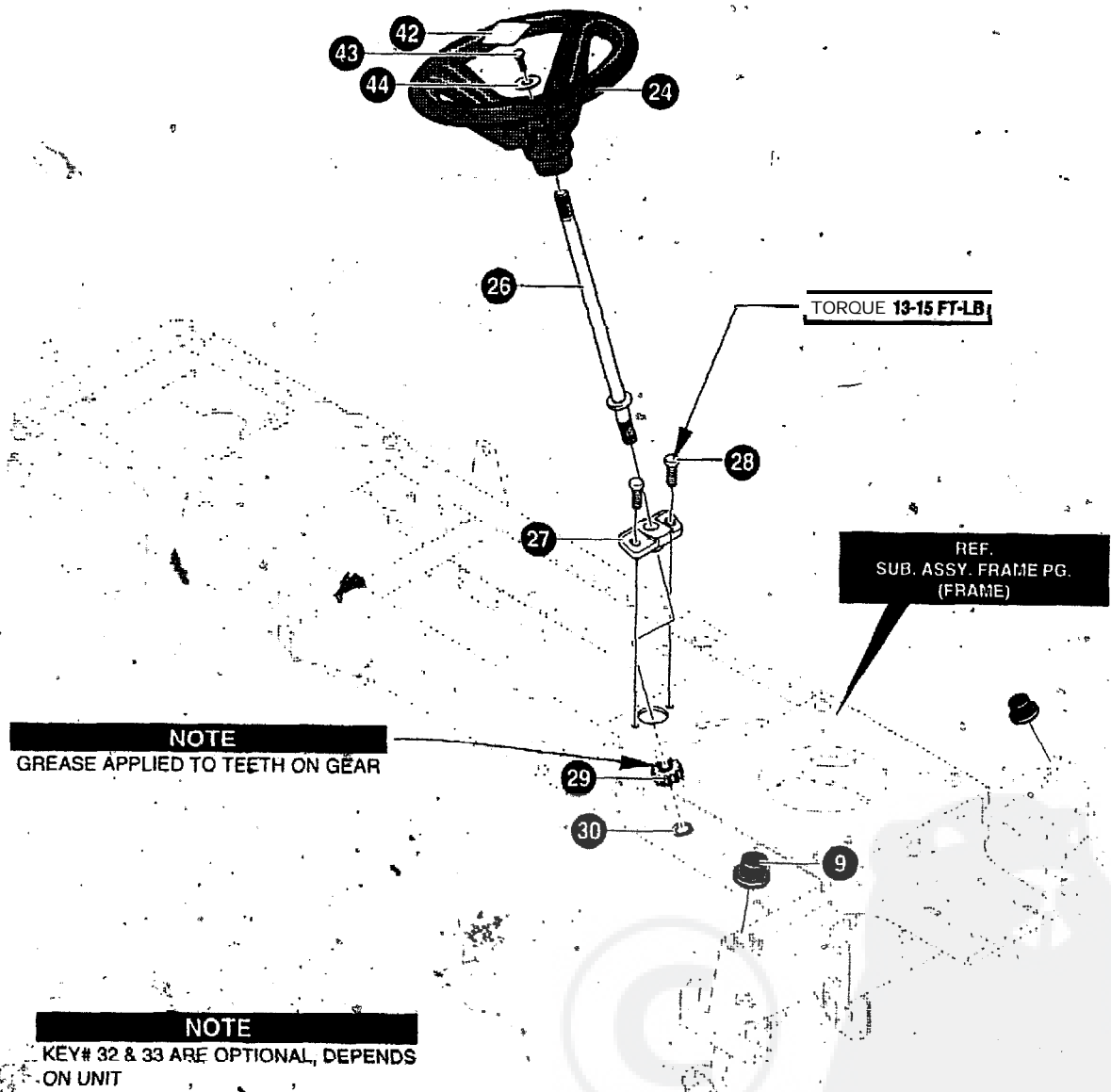

**NOTE**  
GREASE APPLIED TO TEETH ON GEAR

**TORQUE 13-15 FT-LB**

**REF.  
SUB. ASSY. FRAME PG.  
(FRAME)**

**NOTE**  
KEY# 32 & 33 ARE OPTIONAL, DEPENDS  
ON UNIT

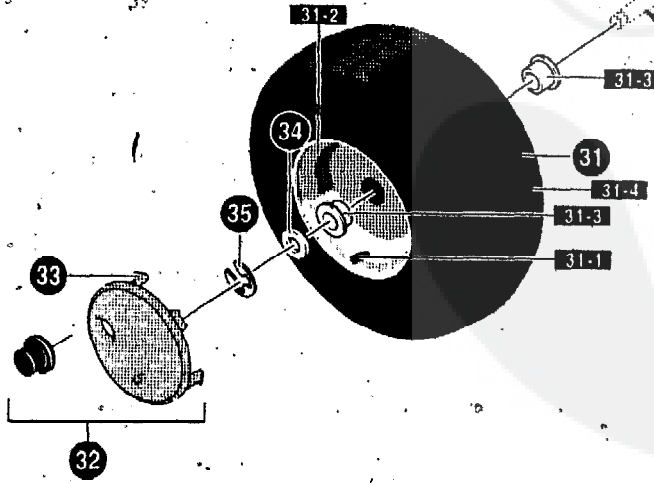

**NOTE**  
GREASE APPLIED TO SPINDLE SHAFT

**NOTE: ALWAYS USE ORIGINAL EQUIPMENT PARTS.**  
Use of service/replacement parts **other than original**  
equipment parts may void your warranty.

ALL UNNUMBERED  
ITEMS ARE INTERCHANGEABLE  
WITH OPPOSITE SIDE

# STEERING ASSEMBLY

KEY NO.	PART NO.	DESCRIPTION	QTY
9	94618	DUST HUB CAP	2
24	95185	STEERING WHEEL	1
26	94520	SHAFT, STEERING	1
27	94124	BEARING-LOWER	1
28	711606	SCREW, 506-18X.75	2
29	94122	GEAR PINNION	1
30	710102	RING, RET E.	1
31	690049	TIRE & RIM, PU	2
31-1	338512	VALVE STEM 15X6.0X6	1
39-2	338517	RIM	1
31-3	338513	BEARING	1
31-4	338516	TIRE, 15X6X6	1
32	94618	HUBCAP, AXLE SHAFT	2
32		NOT USED ON THIS UNIT	
33		NOT USED ON THIS UNIT	
34	711758	WASHER, FLAT .765X1.81X.059	2
35	710103	E-RING	2
4	2 711326	INSERT, STEERING -WHEEL HUB	1
43	711719	SCREW, 114-29X.75 HHC	1
44	711663	WASHER, FLAT	1



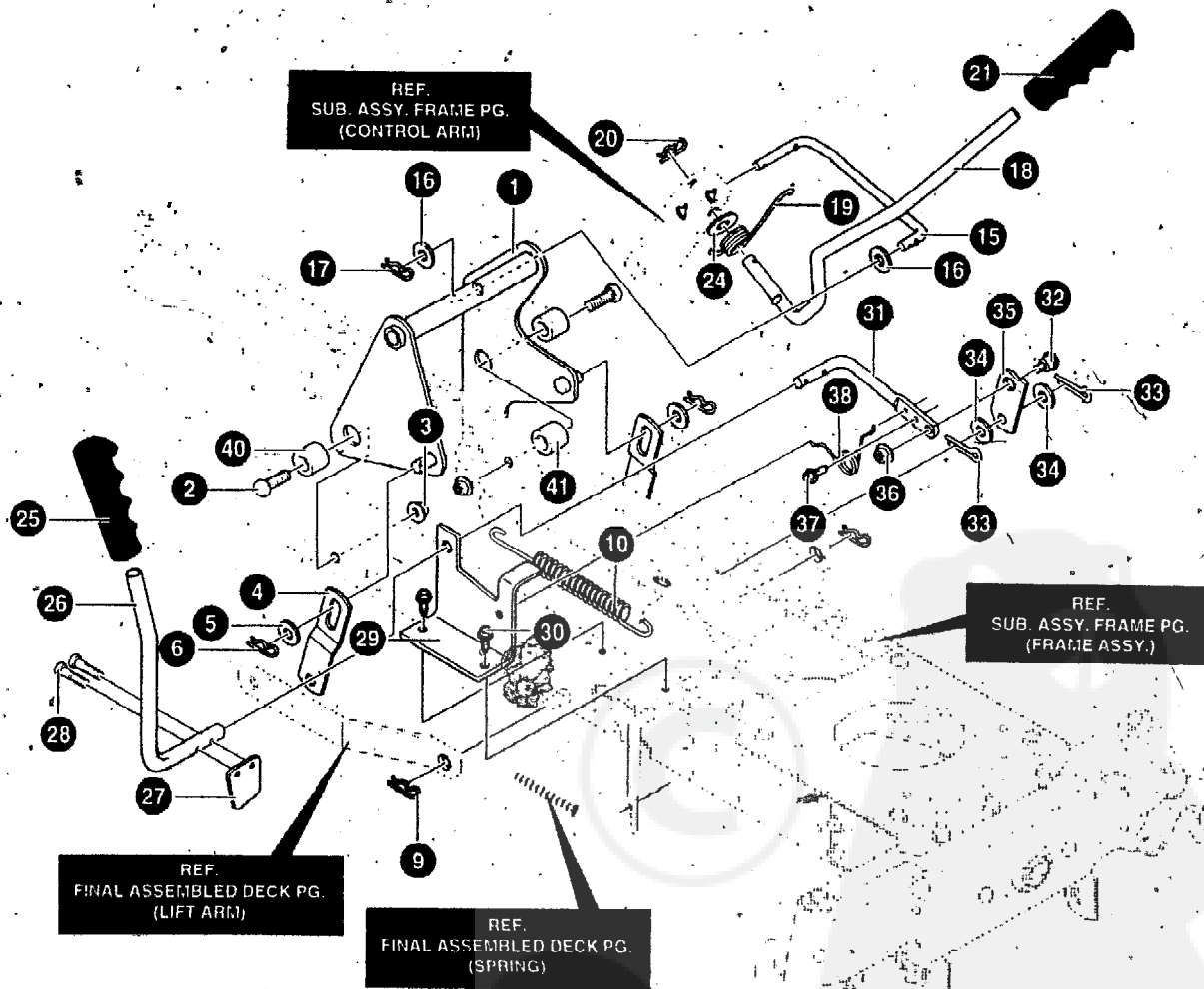

NOTE: ALWAYS USE ORIGINAL EQUIPMENT PARTS, Use of service/replacement parts other than original equipment parts may void your warranty.

ALL UNNUMBERED ITEMS ARE INTERCHANGEABLE WITH OPPOSITE SIDE

343657A

# MOWER SUSPENSION ASSEMBLY

KEY NO.	PART NO.	DESCRIPTION	QTY
1	95233-853	ASSEMBLY, LIFT ARM	1
2	711917	SCREW, 1/2-13X1.50	2
3	711018	NUT, 1/2-13	2
4	94262-853	BRACKET, LIFT LINK	2
5	711617	WASHER, FLAT	2
6	711676	PIN, HAIR	2
9	711676	PIN, HAIR	2
10	710235	SPRING, EXTN	1
15	711981	LINK - LIFT HANDLE	1
16	711617	WASHER, FLAT	2
17	711676	PIN, HAIR	1
18	95296	HANDLE, LIFT	1
19	710111	TORSION SPRING	1
20	711676	PIN, HAIR	1
21	94497	GRIP, LIFT	1
24	711616	WASHER, FLAT	1
25	94406	GRIP	1
26	712035	PTO LEVER	1
27	95284	ZINC PADDLE, SWITCH	1
28	711621	SCREW, THREAD FORM	2
29	94018-853	BRACKET, PTO	1
30	780055	SCREW; 5/16-18X.50	2
31	95283	ZINC LEVER, PTO	1
32	711613	BOLT, .50X.75 HSSH 3/8-16	1
33	711659	PIN, HAIR	2
34	711615	WASHER, FLAT	2
35	95282	ZINC LINK PTO	1
36	711622	NUT, 3/8-16	1
37	711606	SCREW, 5/16-18X.75	1
38	710141	TORSION SPRING	1
40	94309	SPACER	2
41	56150	SPACER, SLEEVE	1

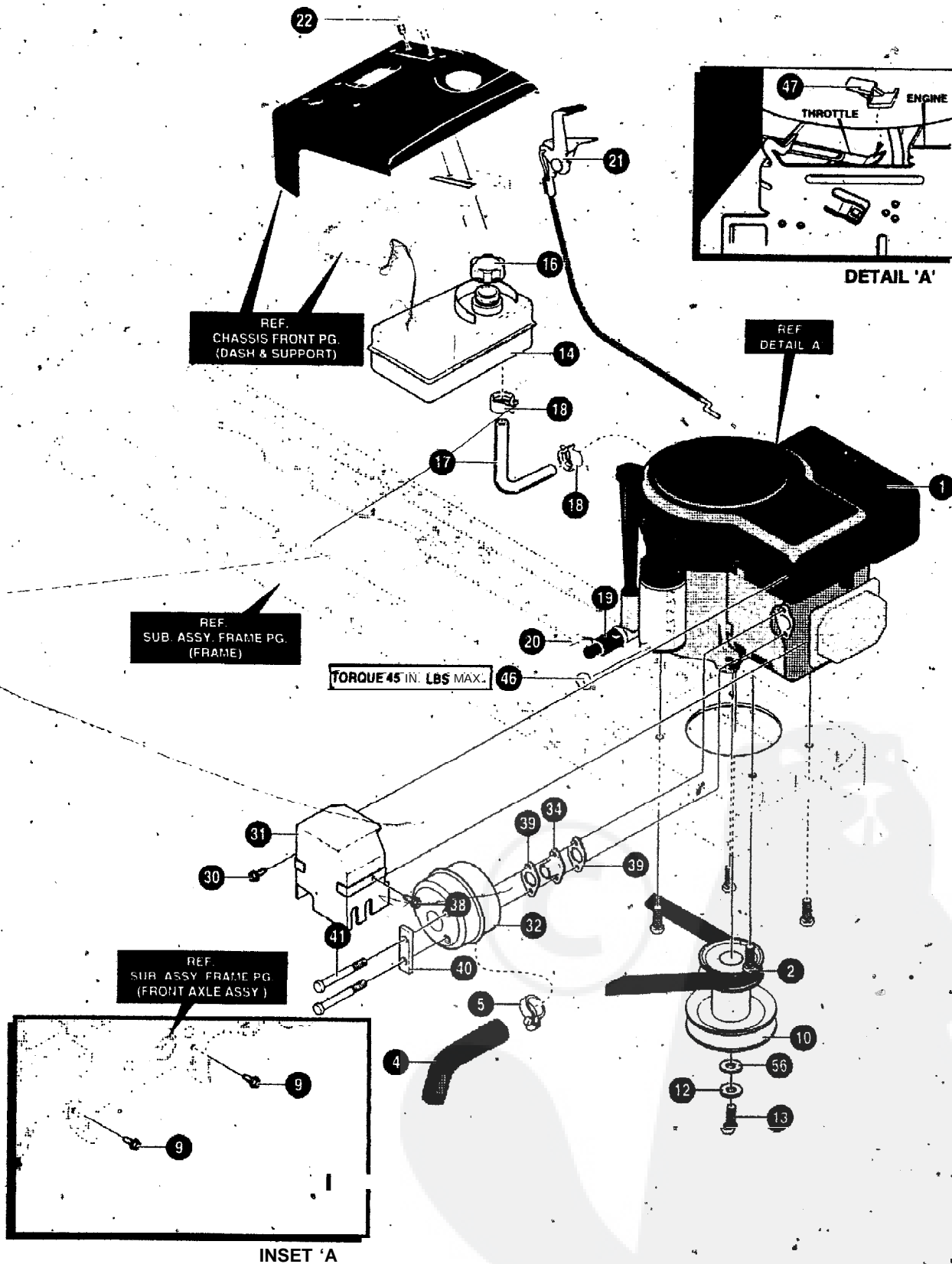

**NOTE: ALWAYS USE ORIGINAL EQUIPMENT PARTS.**  
 Use of service/replacement parts other than original equipment parts may void your warranty.

ALL UNNUMBERED  
 ITEMS ARE INTERCHANGEABLE  
 WITH OPPOSITE SIDE

343793A

# ENGINE & CONTROL ASSEMBLY

KEY NO.	PART NO.	DESCRIPTION	QTY
1	*	-ENGINE	1
2	710199	SCREW, 3/8-16X1.25	4
4	92855	PIPE EXHAUST	1
5	92558	CLAMP ASSY.	1
9	711606	SCREW, 5/16-18X.75HHWATAP	2
1 0	95383	STACK PULLEY ASSY	1
12	120383	WASHER, SPLITLOCK	1
13	710248	SCREW, 7/16-20 X .50	1
14	92342	FUEL TANK 1.4 GAL.	1
15	711681	SCREW, PANHEAD.	4
16	92317	FUEL CAP	1
17	41007	TUBING, .25 X .50	14.5
18.	47345	CLAMP, FUEL LINE	2
19	325.547	OIL DRAIN VALVE ASSY	1
20	327422	CAP, OIL DRAIN VALVE ASM.	1
21	94361	THROTTLE CONTROL	1
22	711637	SCREW, #8-16 x .38	2
30	712099	SCREW, 5/16-18X.	2
31	94324	HEAT SHIELD	1
32	95206	MUFFLER	1
33	92553	STOP BRACKET	1
34	95203	ADAPTER	1
38	711642	SCREW, 1/4-20 X .63	1
39	91309	MUFFLER GASKET	1
40	92378	SCREW, LOCK	1
41	710244	SCREW, 5/16-18X.75HHWATAP	2
46	711601	NUT, 1/4-20 REGHEXJAM	1
47	94951	CLIP, SPEED	1
56	710247	WASHER, FLAT .480X1.00X.25	1

\* SEE ENGINE MANUAL

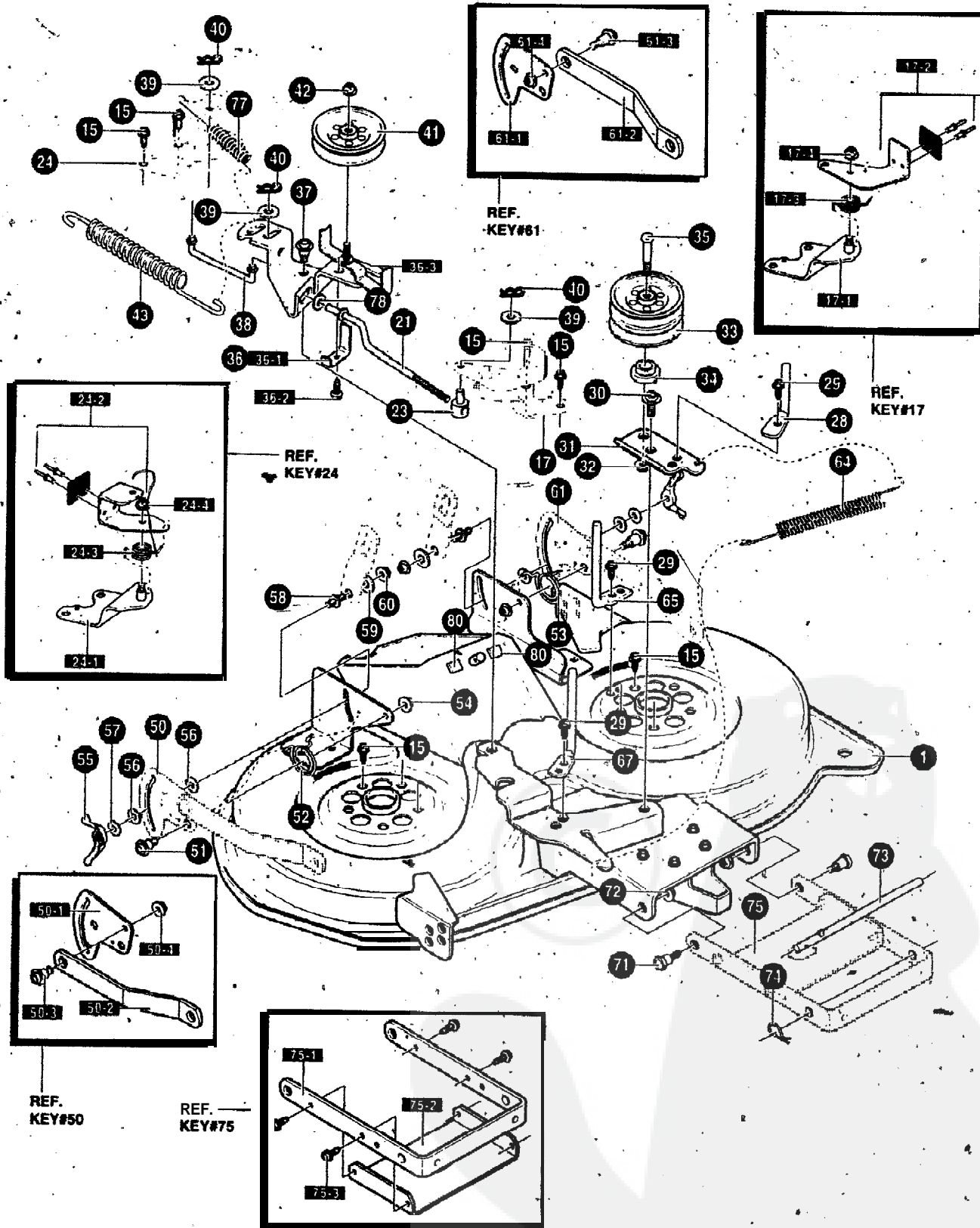

NOTE: ALWAYS USE ORIGINAL EQUIPMENT PARTS.  
 Use of service/replacement parts other than original  
 equipment parts may void your warranty.

ALL UNNUMBERED  
 ITEMS ARE INTERCHANGEABLE  
 WITH OPPOSITE SIDE

343840A

# DECK ASSEMBLY

KEY NO.	PART NO.	DESCRIPTION	QTY
1	690109-853	HOUSING, 40" D E C K	1
17	94665-853	BRAKE ARM ASSEMBLY LH	1
17-1	94293	BRAKE SUPPORT ASSEMBLY LH	1
17-2	94291	BRAKE ARM ASSEMBLY LH	1
17-3	710110	SPRING, TORSION	1
17-4	71020s	N U T , 5/16-18	1
21	690021	LINK, BRAKE LH	1
23	711591	NUT, ADJUST	1
24	94664-853	BRAKE ARM ASSEMBLY RH	1
24-1	94294	BRAKE SUPPORT ASSEMBLY RH	1
24-2	94292	BRAKE ARM ASSEMBLY RH	1
24-3	710077	SPRING, TORSION	1
244	710205	NUT, 5/16-18	1
28	711912	GUIDE, BELT	1
29	711914	SCREW, 5/16-18 X .50	3
30	711613	BOLT, SHOULDER	1
31	94261-853	A R M , DOUBLE IDLER	1
32	711622	NUT, 3/8-16	1
33	94279	PULLEY, IDLER DOUBLE VEE	1
34	94269	S P A C E R	1
35	711915	SCREW, 3/8-16X3.00	1
36	94973.853	IDLER ARM ASSY	1
36-1	94312	SPRING - GUIDE BELT	1
36-2	710264	SCREW, 1/4-20X SO	1
36-3	94298	IDLER ARM ASSEMBLY	1
37	7 1 1 8 1 3	BOLT, SHOULDER	1
36	690023	LINK, BRAKE RH	1
39	711916	WASHER, FLAT	3
40	711682	PIN, HAIR	3
41	690024	PULLEY, V IDLER 4"	1
42	711622	NUT, 3/8-16	1
43	7 1 0 2 3 4	SPRING, E&TENSION	1
59	341593-853	ASSEMBLY, PLATE, REAR SUS. BRKT. RH	1
50-1	94128	PLATE - SUSPENSION	1
50-2	94055	SUSPENSION BRACKET REAR	1
50-3	710095	BOLT, SHOULDER	1
50-4	710140	NUT, 3/8-16	1
51	71361 I	BOLT, SHOULDER	2
52	710112	SPRING, TORSION RH	1
53	710113	SPRING, TORSION LH	1
54	711622	NUT, 3/8-16	2
55	711600	WINGNUT, 5/16-18	2
56	94137	PAD, FRICTION	4
57	711628	WASHER	2
58	711595	PIN, HANGER	2
59	711616	WASHER, FLAT	2
60	711622	NUT, 3/8-16	2
61	341594-853	ASSEMBLY, PLATE, REAR SUS. BRKT. LH	1
61-1	94128	PLATE - SUSPENSION	1
61-2	94055	SUSPENSION BRACKET REAR	1
61-3	710095	BOLT, SHOULDER 3/8-16	1
61-4	710140	NUT, 3/8-16	1
64	710233	SPRING, EXTENSION	1
65	711913	GUIDE, BELT	1
67	690030	GUIDE, BELT	1
71	711611	BOLT, SHOULDER	2
72	711622	NUT, 3/8-16	2
7 3	95295	ROD, HANGER	1
74	7 1 1 6 7 6	PIN, HAIR	1
75	690058-853	ASSEMBLY, BRACKET & STIFFENER	1
75-1	94058	BRACKET, FRONT SUSPENSION	1
75-2	95057	STIFFENER	1
753	730079	SCREW, 5/16-18X.75	4
77	710658	SPRING, EXTENSION	1
78	583409	WASHER, FLAT	1
80	318197	PAD, ADHESIVE	2

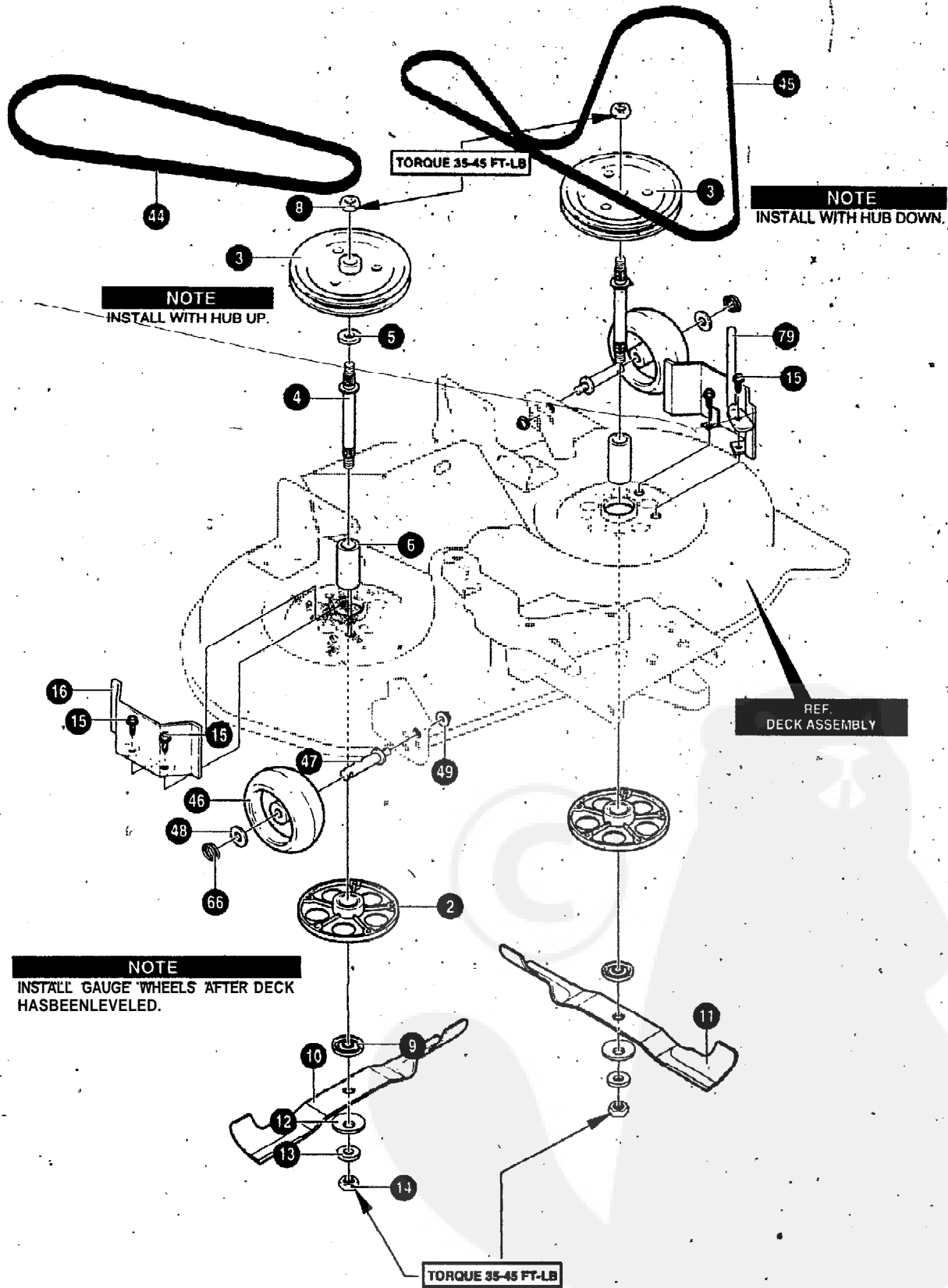

**NOTE; ALWAYS USE ORIGINAL EQUIPMENT PARTS.**  
 Use of service/replacement parts other than original equipment parts may void your warranty.

**ALL UNNUMBERED ITEMS ARE INTERCHANGEABLE WITH OPPOSITE SIDE**

343840A

# DECK ASSEMBLY

KEY NO.	PART NO.	DESCRIPTION	QTY
2	94305	ASSEMBLY, JACKSHAFT HOUSING	2
3	690020	PULLEY, DECK	2
4	91922	JACKSHAFT	2
5	710117	WASHER, FLAT	1
6	91903	SPACER, .625X.875X1.91	2
8	711910	NUT, 9/16-18	2
9	94207	ADA P T E R, DECK/BLADE 40"	2
10	95096	BLADE, RH REBA HI-LIFT	1
11	95097	BLADE, LH REBA HI-LIFT	1
12	710118	WASHER, BELLVILLE	2
13	710117	WASHER, FLAT	2
14	711910	NUT, 9/16-18	2
15	711911	SCREW, 3/8-16X1 . O O	1 0
16	94288-853	COVER PULLEY	2
44	710231	BELT, V 46.5LG	1
45	690071	BELT, DECK	1
476	92683	GAUGE WHEEL	2
48	711615 711746	BOLT, SHOULDER	2
		WASHER, FLAT	2
49	711622	NUT, 3/8-16	2
66	711764	PIN, CIRCLE	2
79	95280	ROD, BELT GUIDE	1



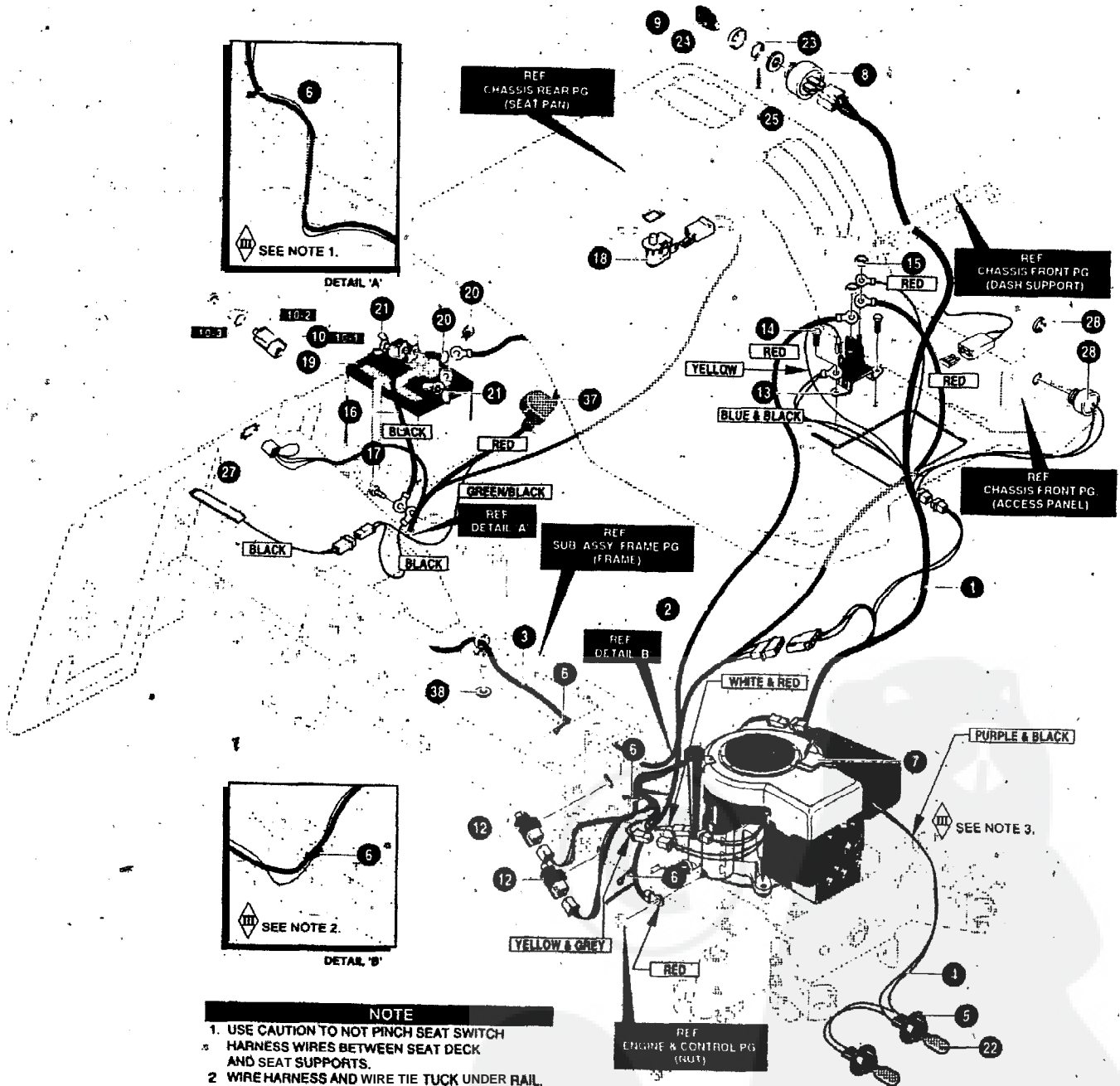

- NOTE**
1. USE CAUTION TO NOT PINCH SEAT SWITCH HARNESS WIRES BETWEEN SEAT DECK AND SEAT SUPPORTS.
  2. WIRE HARNESS AND WIRE TIE TUCK UNDER RAIL.
  3. ROUTE HEADLIGHT HARNESS BETWEEN AIR FILTER AND ENGINE COVER. TIE HEADLIGHT HARNESS TO FUEL LINE.

# ELECTRICAL ASSEMBLY

KEY NO.	PART NO.	DESCRIPTION	QTY
1	95380	WIRE HARNESS	1
2	711579	WIRE, LEAD SOLENOID TO STARTER	1
3		REAR HARNESS	1
5	95381 340513	WIRE HARNESS FOR HEADLIGHTS	1
6	57444 92372	LAMP SOCKET	2
7		TIE, CABLE BLACK NYLON 5.62L	6
8		WIRE CLIP, ADHESIVE	1
8	55939 94878	SWITCH, IGNITION	1
9	327350	KEY,IGNITION	1
10	690106	ASSY, SWITCH DOUBLE POLE DELTA	1
10-1	320062	SWITCH, DOUBLE	1
10-2	690074	BOOT, SWITCH	1
10-3	690075	CAP, SWITCH	1
12	94136	SWITCH LIMIT	2
13	94613	SOLENOID	1
14	711619	SCREW, 1/4X.50	2
15	711632	NUT, 1/4-20	2
16	95420	WIRE, GROUND	1
18	71161.9	SCREW, 1/4X.50	1
19	302257 94159	SWITCH, SEAT	1
20	711680	BATTERY 12V 7 PLATE	1
21	711636	BOLT,, 1/4-20X.63	2
22	780216	NUT, WING 1/4-20	2
23	327352	BULB, HEADLIGHT	2
24	300194	NUT, 5/8-8	1
25	1 38557	BOOT, IGNITION	1
27	95330	WASHER, REGENTLK .640 XI .1 X .05	1
28	95391	TAPE SWITCH	1
37	335417	BUZZER, FOR BAG FULL	1
38	711666	BOOT, BATTERY	1
	302031	WASHER, FLAT	1
		FUSE 15 AMP	1

## WIRING SCHEMATIC

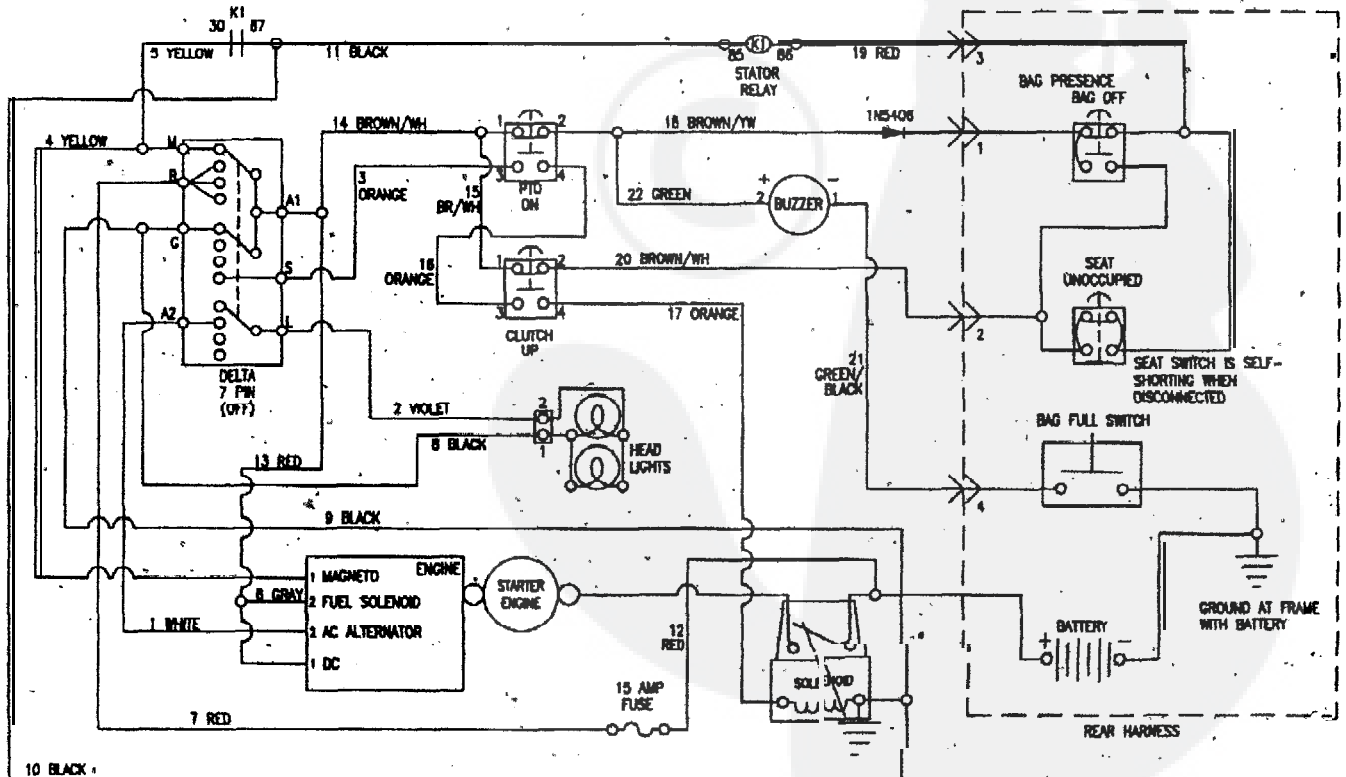

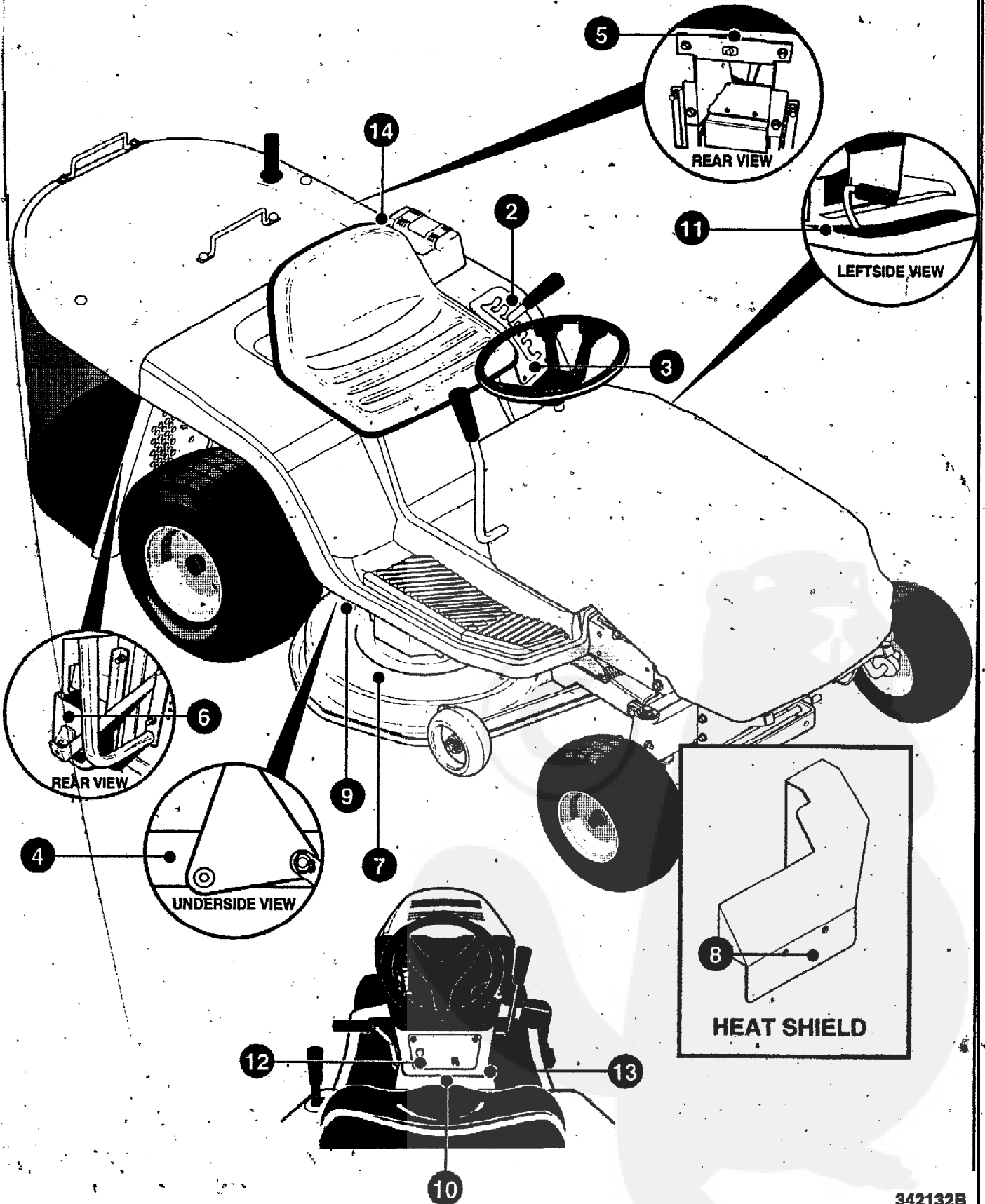

KEY NO.	PART NO.	DESCRIPTION	QTY
2	711735	DECAL, REBA 5-POSITION	1
3	711850	DECAL, DECK LEVEL POSITION	1
4	710523	DECAL, PINCH POINTS WARNING	1
5	338541	DECAL, BAGGER "CE" M#44X5939	1
6	338542	DECAL, DRAWBAR WARN M#44X6138	1
7	402700	DECAL, CAUTION DECK LH NO STEP	2
8	338543	DECAL, HOT SURF WARN M#44X5936	1
9	710684	DECAL, DECK BELT ROUTE	1
10	710534	DECAL, CONS CAUT. M#44X6815 97	1
1 1	710678	DECAL, CLUTCH BRAKE EXP WH/BLK	1
12	711766	DECAL, INSTR FOR BAG RELEASE	1
13	710720	DECAL, AUTODRIVE INST. DASH RT	1
14	710771	DECAL, HYDRO DUMP VALVE	1

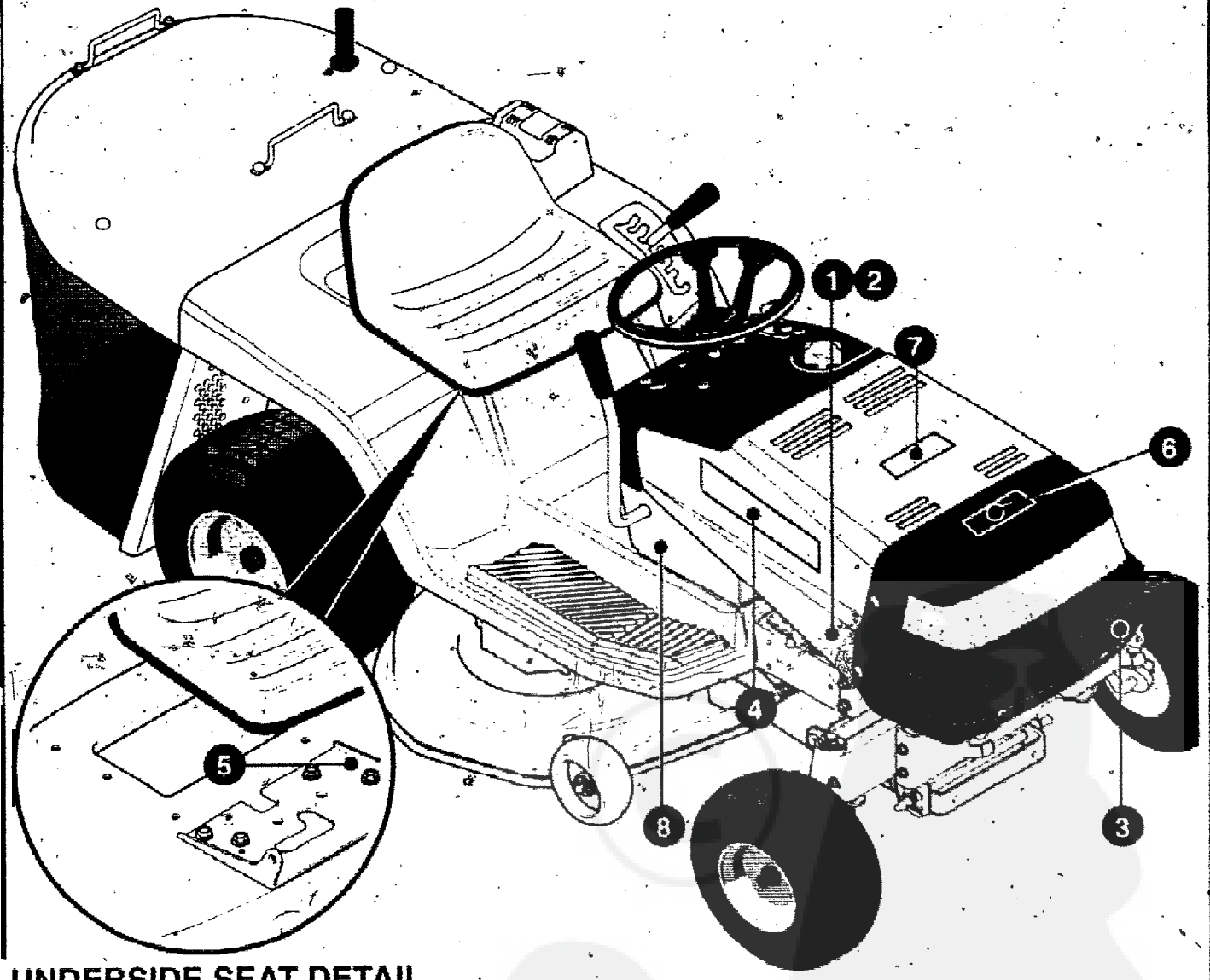

UNDERSIDE SEAT DETAIL

KEY NO.	PART NO.	DESCRIPTION	QTY
1	712190	DECAL, RH DYNAMARK	1
2	<b>712191</b>	DECAL, LH DYNAMARK	1
3	732192	DECAL, DYNAMARK FRONT GRILLE	1
4	307277	PAD, 12X4 FOAM HOOD	2
5		REFERENCE ONLY	
6	305602	PAD, 4 X15 FOAM HOOD	1
7	307276	PAD, 15X7	1
8	710772	DECAL, AUTODRIVE 155/102	2

