

**REPAIR PARTS**

**36" RIDING MOWER MODEL 5188-5100**

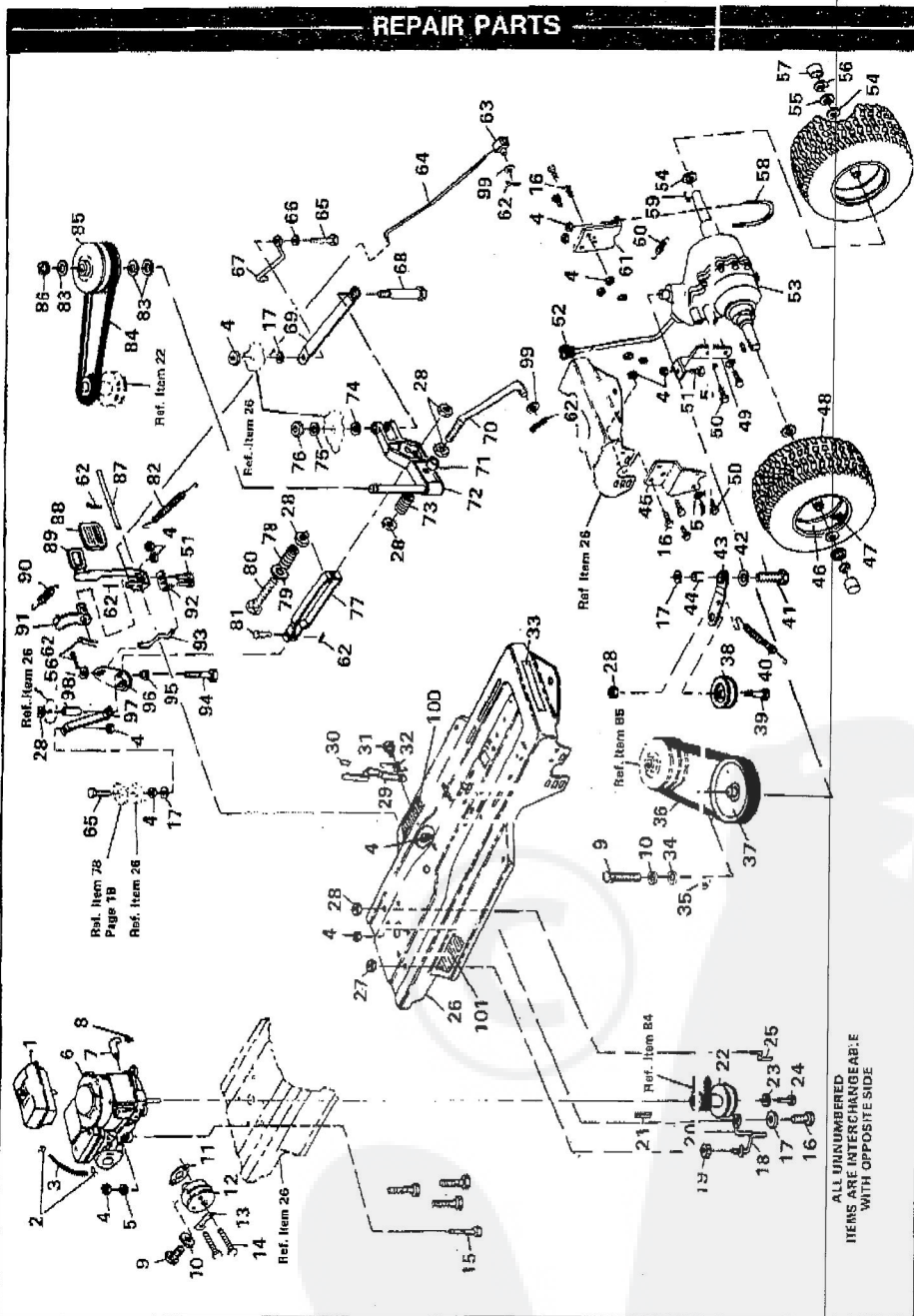

**36" RIDING MOWER MODEL 5188-5100**

ALWAYS GIVE THE FOLLOWING INFORMATION WHEN ORDERING REPAIR PARTS:

1. The PART NUMBER 2. The PART NAME 3. QUANTITY DESIRED 4. The MODEL NUMBER—(As shown on Model Plate)

SEND PART ORDERS AS PER INSTRUCTIONS ON THE FRONT PAGE

YOUR UNIT IS RIGHT HAND (RH) OR LEFT HAND (LH) AS YOU STAND BEHIND IT.

DO NOT USE KEY NUMBERS WHEN ORDERING REPAIR PARTS. ALWAYS USE PART NUMBERS.

All replacement parts will be supplied in current production colors or in a neutral color.

A handling fee is applicable to small parts orders.

Key No.	Part No.	Description	Part No.	Description	Key No.	Part No.	Description	
1	48812	Gas Tank	431787	Key, Woodruff, No. 61	69	49725	Brace, Vari-Drive	
2	41008	Clip, Gas Line	53366	V-Belt, Secondary	70	53354	Rod, Adjustment	
3	41007	Gas Line	48645	Pulley, Transaxle	71	50520	Spacer	
4	9413447	Locknut, Hex, 5/16-18 Thd.	40223	Pulley, Idler	72	50052	Support Arm & Shaft Assembly	
5	120638	Lockwasher, Split, 5/16 In.	120918	*Screw, Hex Hd, 3/16 x 1 1/2 In.	73	29170	Spring	
6	Engine	See Footnote Below	49276	Spring, Main Drive	74	49898	Washer	
7	45586	Oil Drain Tube	122207	*Screw, Hex Hd, 3/16 x 3 In.	75	120380	Nut, Hex, 1/2-13 Thd.	
8	23700	Pipe Plug, 1/4 In.	845	Flatwasher, 3/8 In.	76	9414074	Washer, 9/16 In.	
9	180020	*Screw, Hex Hd, 1/4-20 x 3/4 In.	43	49933	Bushing, Idler	77	49827	Clavis, Disengage
10	120380	*Flatwasher, Split, 1/4 In.	44	49875	Bracket, Axle, L.H.	78	49817	Spring
11	Gasket, Muffler (Engine Part)		45	49661	Wheel	79	120394	*Flatwasher, 3/8 In.
12	Muffler		46	41105	Valve Stem	80	49830	Screw, Hex Hd, Special
13	Engine Part		47	24167	Tire	81	38522	Pin, Clevis
14	*Screw, Hex Hd, 5/16-18 x 3 1/2 In.		48	41106	Bracket, Stabilizing	82	53355	Spring
15	*Screw, Hex Hd, 5/16-18 x 1 1/2 In.		49	49852	Screw, Hex Hd, 5/16-18 x 1 1/2 In.	83	49971	Washer
16	120228	*Screw, Hex Hd, 5/16-18 x 1 1/2 In.	50	180080	*Screw, Hex Hd, 5/16-18 x 3/4 In.	84	53499	V-Belt, Primary
17	446363	Flatwasher, 5/16 In.	51	122007	Knob, Gear Shift	85	49866	Pulley, Vari-Speed
18	506553	Belt Guide	52	29483	Transaxle	86	49972	Retaining Ring
19	271190	Keys Nut, 3/8-16 Thd.	53	642	Flatwasher	87	53357	Shaft, Brake-Clutch Pedal
20	45348	Belt Guide, Blade Drive	54	42815	*E" Ring	88	49940	Rubber Pad, Brake Pad
21	33200	Key, Engine Pulley	55	36625	Hub Cap	89	52640	Brake Pedal Assembly
22	53500	Pulley, Engine	56	40394	"U" Bolt	90	53351	Spring
23	120383	Lockwasher, Split	57	40124	Key, 3/16 x 3/16 x 2 1/2 In.	91	53580	Lever, Interlock Switch
24	123567	*Screw, Hex Hd, 7/16-20 x 1 In.	58	39628	Spring, Brake Return	92	49828	Bracket, Angle
25	52587	Belt Guide	59	39628	Bracket, Axle, R.H.	93	49892	Rod, Disengage
26	53359	Beam Frame	60	39650	Pin, Cotter, 3/32 x 3/4 In.	94	49819	Bearing
27	41529	Jam Nut	61	49650	*Pin, Cotter, 3/32 x 3/4 In.	95	49819	Lever, Disengage
28	9413634	Locknut, Hex, 3/8-16 Thd.	62	121222	Pivot Block	96	49824	Brace, Disengage
29	50980	Arm, Parking Brake	63	49653	Rod, Brake	97	49825	Spacer
30	67950	Decal, Parking Brake	64	49654	*Screw, Hex Hd, 5/16-18 x 1 In.	98	49825	Flatwasher
31	40974	Shoulder Bolt, Parking Brake	65	122017	Washer, 5/16 In.	99	274617	Foot Pad, R.H.
32	43968	Spring, Parking Brake	66	120393	Belt Guide	100	53852	Foot Pad, L.H.
33	67927	Decal, Gearion	67	49722	Shoulder Bolt			
34	120386	*Flatwasher, 1/4 In.	68	49730				

\*Standard Hardware Items - May Be Purchased Locally. †Contact Tecumseh/Perless authorized service dealer for parts and warranty.

Replacement engines and parts are obtainable from Engine Manufacturer's authorized Service Stations who are also to be contacted in regards to the Engine Warranty. See your Engine Manual for location of these stations.

36" RIDING MOWER MODEL 5188-5100

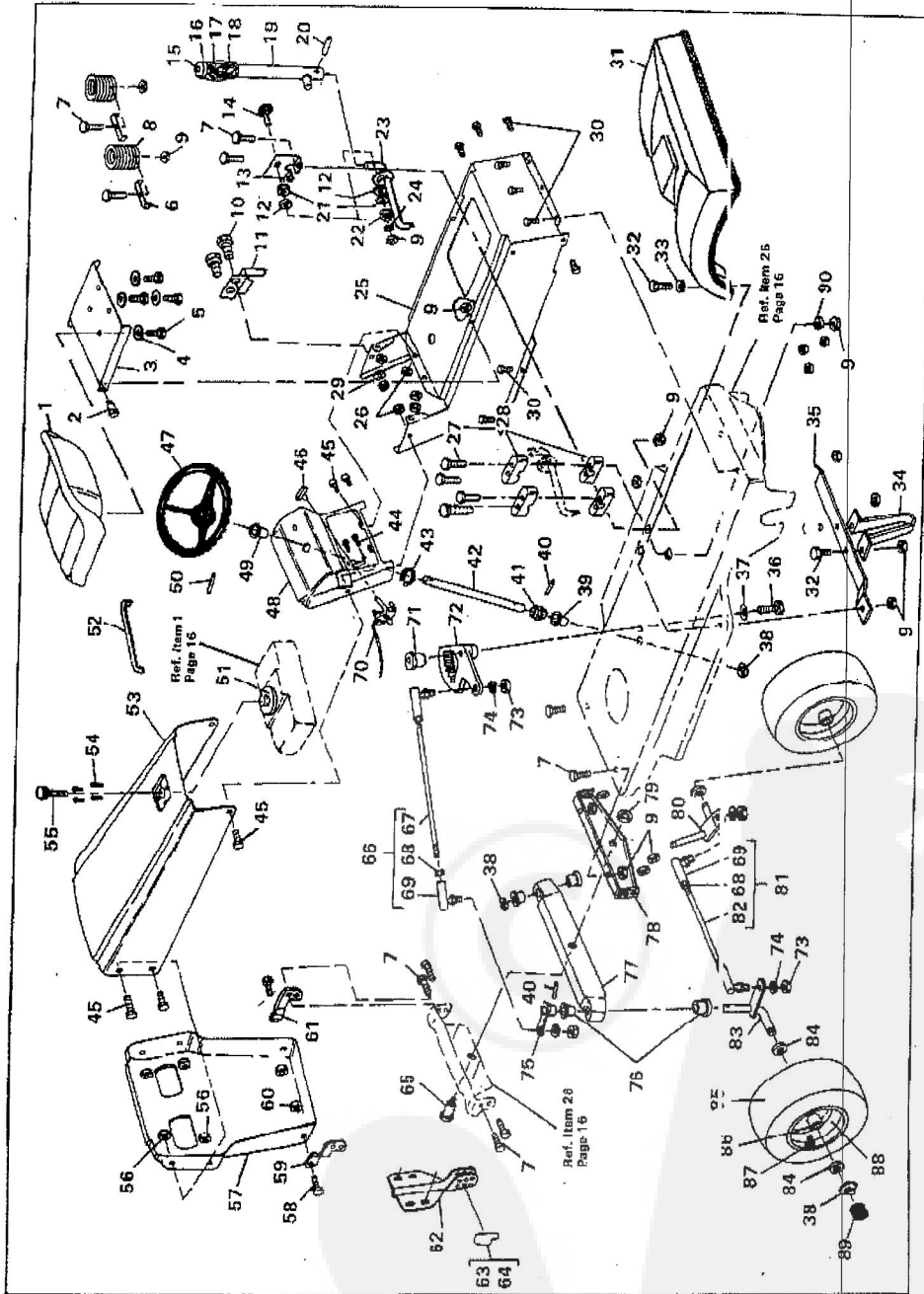

36" RIDING MOWER MODEL 5188-5100

Key No.	Part No.	Description	Key No.	Part No.	Description	Key No.	Part No.	Description
1	52656	Seat	31	52470	Fender Assembly	51	52638	Bracket, Grille Support, R.H.
2	28607	Shoulder Bolt	32	122017	*Screw, Hex Hd, 5/16-18 x 1 In.	52	50719	Bracket, Deck Hanger
3	53653	Seat Bracket	33	446363	*Flatwasher, 5/16 In.	53	68027	Decal, Hanger, L.H.
4	120638	Lockwasher, Split	34	44500	Bracket, Deck Guide	63	68026	Decal, Hanger, R.H.
5	120834	*Screw, Hex Hd, 5/16-18 x 1 1/2 In.	35	43954	Bracket, Deck Guide Support	64	50720	Shoulder Bolt, Axle Pivot
6	48339	Clip, Seat Spring	36	39573	Screw, Hex Hd Lock, 3/4-24 x 1 In	65	44059	Drag Link Assembly
7	120228	*Screw, Hex Hd, 5/16-18 x 3/8 In.	37	2483	*E" Ring	66	44060	Drag Link
8	52332	Spring, Seat	38	36625	Bearing, Steering	67	124925	Nut, Hex, 3/4-24 Thd.
9	9413447	Locknut, Hex, 3/16-18 Thd.	39	39630	Roll Pin	68	21275	Ball Joint
10	120706	*Screw, Hex Hd, 3/4-20 x 1/2 In.	40	454555	Pinion Gear	69	50117	Lever, Throttle Control
11	52922	Bracket, Speed Control	41	44009	Shaft, Steering	70	44011	Shoulder Bolt, Sector Gear
12	48922	Snubber	42	39432	Retaining Ring	71	44010	Sector Gear
13	48935	Support Bracket	43	35237	Screw, Tapite, No. 8-32 x 3/8 In.	72	120369	*Nut, Hex, 3/4-24 Thd.
14	128385	Carrier Bolt, 5/16-18 x 2 1/4 In.	44	48900	Screw, Hex Wa, Hd, 1/4-20 x 1 In.	73	120382	*Lockwasher, Split, 3/8 In.
15	48964	Cap. Rod	45	39436	Knob, Throttle Control Lever	74	49447	Arm, Steering
16	48938	Hand Grip, Control Rod	46	47033	Steering Wheel	75	50546	Bearing, Spindle
17	49539	Spring, Control Rod	47	52615	Dash Assembly	76	44062	Front Axle Assembly
18	52924	Rod, Control Release	48	39432	Bearing, Steering	77	43988	Bracket, Front Axle Support
19	52923	Control Handle	49	456896	Roll Pin	78	274654	Locknut, Hex, 1/4-20 Thd.
20	45481	Spitrol Pin	50	44863	Pad, Vibration	79	48844	Spindle, R.H.
21	845	Washer	51	42089	Hood	80	48762	Tie Rod Assembly
22	49918	Spring, Control Arm	52	52590	Edging, Hood	81	48764	Tie Rod
23	53353	Control Arm Assembly	53	49050	Screw, Plastite, 4-10 x 3/4 In.	82	48845	Spindle, L.H.
24	120393	Flatwasher	54	50988	Gas Gauge	83	642	Flatwasher
25	53315	Console Assembly	55	50352	Locknut, Wide Flange, 1/2-20 Thd.	84	41108	Flange
26	9424215	Locknut, Hex, 1/2-20 Thd.	56	52804	Grilla	85	39878	Bearing, Wheel
27	122052	*Screw, Hex Hd, 5/16-18 x 1 3/8 In.	57	120283	*Screw, Hex Hd, 3/4-16 x 1 In.	86	24167	Valve Stem
28	49836	Pillow Block	58	52639	Bracket, Grille Support, L.H.	87	39829	Wheel w/Bearing
29	120392	Flatwasher, 3/8 In.	59	9413534	Locknut, 3/4-16 Thd.	88	40394	Hub Cap
30	955346	*Screw, Tapite, 1/2-20 x 1/2 In.	60			89		
31						90	446363	

\*Standard Hardware Items - May Be Purchased Locally.

36" RIDING MOWER MODEL 5188-5100

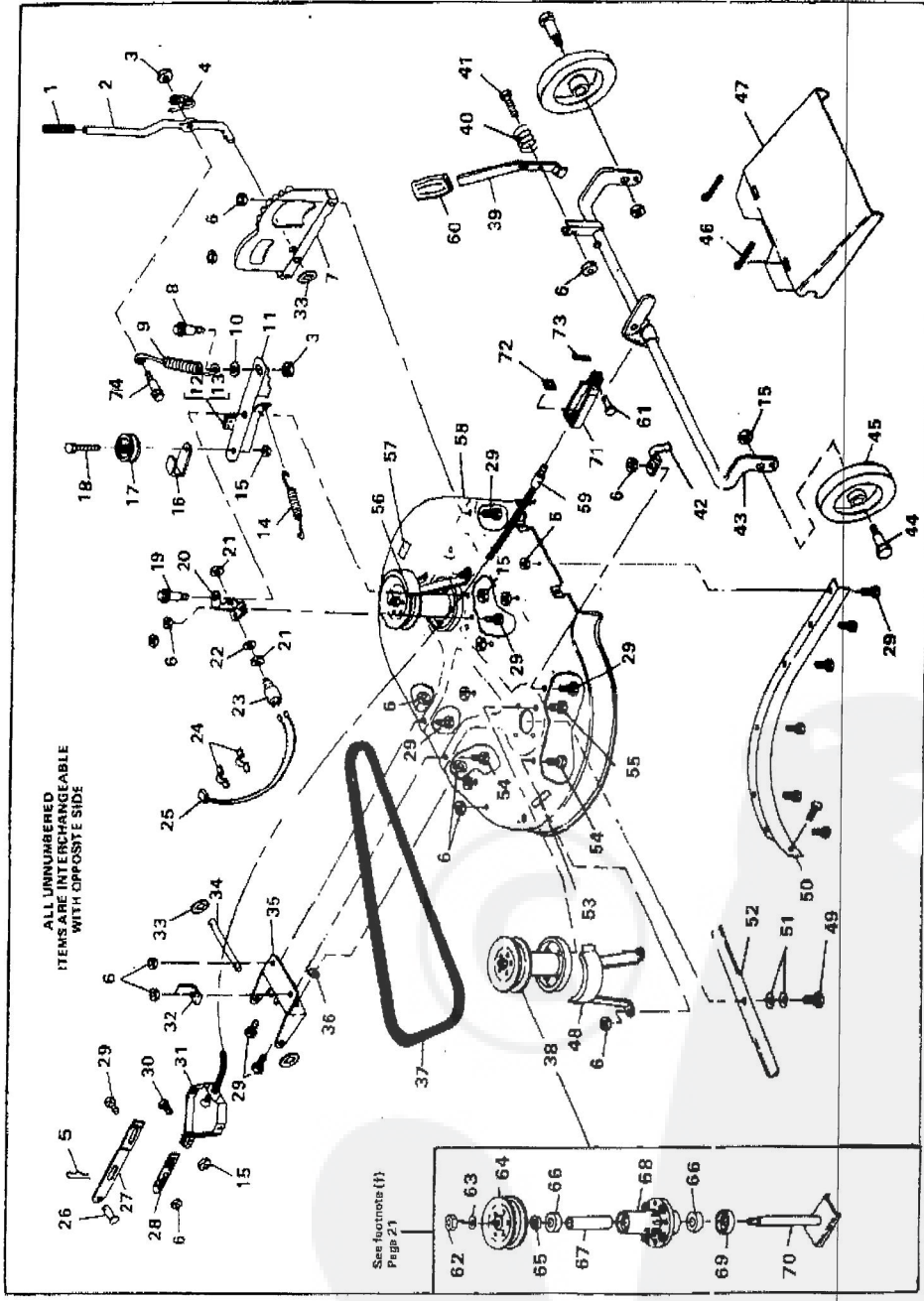

See footnote (1)  
Page 21

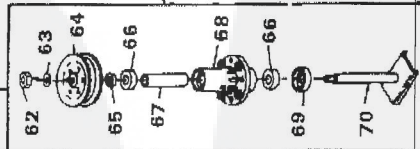

36" RIDING MOWER MODEL 5188-5100

Key No.	Description	Part No.	Description	Part No.	Description	Key No.	Description	Part No.	Description	Key No.	Description
1	45478 Hand Grip	47816	Pull Pin	51	Formed Washer	51	47816 Hand Grip	47816	Pull Pin	51	Formed Washer
2	53964 Lever, Clutch	49058	Bar Hitch	52	49058 Bar Hitch	52	53964 Lever, Clutch	49058	Bar Hitch	52	49058 Bar Hitch
3	9424215 Locknut, 1/2-20 Thd	49058	Lock Bracket	53	49058 Lock Bracket	53	9424215 Locknut, 1/2-20 Thd	49058	Lock Bracket	53	49058 Lock Bracket
4	45561 Spring, Clutch Lever	120328	*Screw, Hex Hd, 5/16-18 x 3/4 In.	54	120328 *Screw, Hex Hd, 5/16-18 x 3/4 In.	54	45561 Spring, Clutch Lever	120328	*Screw, Hex Hd, 5/16-18 x 3/4 In.	54	120328 *Screw, Hex Hd, 5/16-18 x 3/4 In.
5	8260 Hairpin Cotter	120318	*Screw, Hex Hd, 3/8-16 x 1 1/2 In.	55	120318 *Screw, Hex Hd, 3/8-16 x 1 1/2 In.	55	8260 Hairpin Cotter	120318	*Screw, Hex Hd, 3/8-16 x 1 1/2 In.	55	120318 *Screw, Hex Hd, 3/8-16 x 1 1/2 In.
6	9413447 Locknut, 5/16-18 Thd	50513	Pivot Bracket	56	50513 Pivot Bracket	56	9413447 Locknut, 5/16-18 Thd	50513	Pivot Bracket	56	50513 Pivot Bracket
7	53247 Quadrant	52588	Bracket, Upstop	57	52588 Bracket, Upstop	57	53247 Quadrant	52588	Bracket, Upstop	57	52588 Bracket, Upstop
8	46563 Shoulder Bol	53597	Push Nut	58	53597 Push Nut	58	46563 Shoulder Bol	53597	Push Nut	58	53597 Push Nut
9	52636 Spring, Clutch Lever	53815	Pin, Pivot	59	53815 Pin, Pivot	59	52636 Spring, Clutch Lever	53815	Pin, Pivot	59	53815 Pin, Pivot
10	120392 *Flatwasher, 1/2 In	48676	Lift Support, Plate Assembly	60	48676 Lift Support, Plate Assembly	60	120392 *Flatwasher, 1/2 In	48676	Lift Support, Plate Assembly	60	48676 Lift Support, Plate Assembly
11	53055 Idler Arm Assy (Incl. Nos 12 & 13)	996416	*Flatwasher, 3/8 In.	61	996416 *Flatwasher, 3/8 In.	61	53055 Idler Arm Assy (Incl. Nos 12 & 13)	996416	*Flatwasher, 3/8 In.	61	996416 *Flatwasher, 3/8 In.
12	41471 Brake Pad	49878	V-Belt	62	49878 V-Belt	62	41471 Brake Pad	49878	V-Belt	62	49878 V-Belt
13	41601 Rivet, Brake Pad	51450	Curil Assy. (Includes 62 - 70)	63	51450 Curil Assy. (Includes 62 - 70)	63	41601 Rivet, Brake Pad	51450	Curil Assy. (Includes 62 - 70)	63	51450 Curil Assy. (Includes 62 - 70)
14	35410 Spring	49131	Lever, Height Adjust	64	49131 Lever, Height Adjust	64	35410 Spring	49131	Lever, Height Adjust	64	49131 Lever, Height Adjust
15	9413534 Locknut, 3/8-16 Thd.	53246	Spring	65	53246 Spring	65	9413534 Locknut, 3/8-16 Thd.	53246	Spring	65	53246 Spring
16	52695 Belt Retainer	120895	*Screw, Hex Hd, 5/16-18 x 2 1/4 In.	66	120895 *Screw, Hex Hd, 5/16-18 x 2 1/4 In.	66	52695 Belt Retainer	120895	*Screw, Hex Hd, 5/16-18 x 2 1/4 In.	66	120895 *Screw, Hex Hd, 5/16-18 x 2 1/4 In.
17	52694 Puller, Idler	52513	Support, Pivot Tube	67	52513 Support, Pivot Tube	67	52694 Puller, Idler	52513	Support, Pivot Tube	67	52513 Support, Pivot Tube
18	122168 *Screw, Hex Hd, 3/8-16 x 1 3/4 In.	23753	Pivot Tube Assy.	68	23753 Pivot Tube Assy.	68	122168 *Screw, Hex Hd, 3/8-16 x 1 3/4 In.	23753	Pivot Tube Assy.	68	23753 Pivot Tube Assy.
19	27516 Shoulder Bolt	52654	Wheel Axle	69	52654 Wheel Axle	69	27516 Shoulder Bolt	52654	Wheel Axle	69	52654 Wheel Axle
20	47517 Bracket, Idler Arm	120123	Cotterpin	70	120123 Cotterpin	70	47517 Bracket, Idler Arm	120123	Cotterpin	70	120123 Cotterpin
21	45877 Nut Lockout switch part	49824	Chute Extension	71	49824 Chute Extension	71	45877 Nut Lockout switch part	49824	Chute Extension	71	49824 Chute Extension
22	45878 Lockwasher lockout switch part	46365	Cover, Pulley, L.H.	72	46365 Cover, Pulley, L.H.	72	45878 Lockwasher lockout switch part	46365	Cover, Pulley, L.H.	72	46365 Cover, Pulley, L.H.
23	41204 Switch, Lockout	38573	Screw, Hex Hd, 3/8-24 x 1 In.	73	38573 Screw, Hex Hd, 3/8-24 x 1 In.	73	41204 Switch, Lockout	38573	Screw, Hex Hd, 3/8-24 x 1 In.	73	38573 Screw, Hex Hd, 3/8-24 x 1 In.
24	41482 Clip, Press	46367	Ballie, L.H.	74	46367 Ballie, L.H.	74	41482 Clip, Press	46367	Ballie, L.H.	74	46367 Ballie, L.H.
25	48851 Wire Assembly						48851 Wire Assembly				

\*Standard Hardware Items - May be purchased locally.

†Your unit may have been built with welded quills. Parts in inset can not be ordered for welded quills.

36" RIDING MOWER MODEL 5188-5100

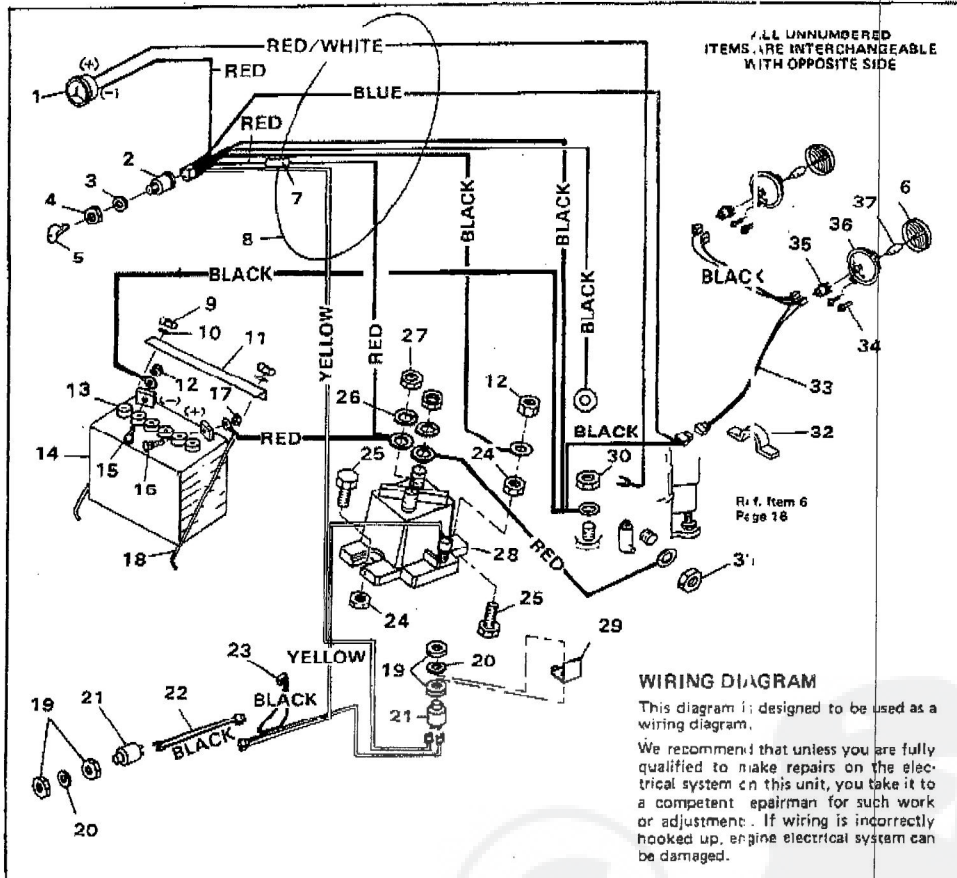

Key No.	Part No.	Description
1	39463	Ammeter
2	52583	Switch, Ignition w/Keys
3	138557	Lockwasher (Switch Part)
4	48140	Locknut (Switch Part)
5	49643	Key, Ignition
6	52570	Lens, Headlight
7	49211	Fuse
8	53362	Wire Harness Assembly
9	997208	*Wing Nut, Nylock, 1/4-20 Thd.
10	120386	*Flatwasher, 1/4 in.
11	40249	Bracket, Battery, Held Down
12	271172	Nut, Keps, 1/4-20 Thd.
13	40892	Cap, Battery
14	52936	Battery
15	126203	*Carriage Bolt, 1/4-20 x 3/4 In.
16	126216	*Carriage Bolt, 5/16-18 x 3/4 In.
17	271184	Nut, Keps, 5/16-18 Thd.
18	40234	Battery Rod
19	45877	Nut (Lockout Switch Part)

Key No.	Part No.	Description
20	45878	Lockwasher (Lockout Switch Part)
21	41204	Switch, Lockout
22	48851	Wire Assembly, Deck Switch
23	42071	Wire Assembly, By-Pass
24	9424215	Locknut, Hex, 1/4-20 Thd.
25	121900	*Screw, Hex Hd, 1/4-20 x 1 In.
26	138485	Washer, Shakeproof
27	120369	Locknut, Hex, 5/16-24 Thd
28	52323	Solenoid
29	49734	Bracket, Switch Mounting
30	9413447	Locknut, Hex, 5/16-18 Thd.
31		Engine Part
32	41482	Wire Clip, Press
33	52800	Lead Wire, Headlight
34	50668	Screw, Hex Hd, No. 10-14 x 1/2 In.
35	52573	Socket, Headlight
36	52571	Bezel, Headlight
37	52572	Bulb, Headlight

\*Standard Hardware Items - May Be Purchased Locally.

The following **Trouble Shooting Guide** (2 pages) is designed to apply to all riding type mowers manufactured by Lawn Mower Division. Some of the problems and corrections will not apply to your unit.

<b>TROUBLE SHOOTING GUIDE</b>	
<b>DANGER: ALWAYS DISCONNECT SPARK PLUG WIRE BEFORE ATTEMPTING ANY INSPECTION OR ADJUSTMENT!</b>	
PROBLEM	CORRECTION
Mower Cuts Ragged or Uneven.	<ol style="list-style-type: none"> <li>1. Make certain blades are sharp and in good condition (not bent or incorrectly mounted).</li> <li>2. Check blade mounting screw(s). Blade screw(s) must be tight.</li> <li>3. Check quill assembly(s) for damage or bearing wear. Replace if necessary.</li> <li>4. Remove any accumulation of grass clippings from underside of mower deck housing.</li> <li>5. Check for possible damage to mower deck housing. Repair or replace if necessary.</li> <li>6. Check pivot tube assembly for damage. If bent or damaged, repair or replace.</li> </ol>
Mower Leaves Unmowed Strip Between Blades	<ol style="list-style-type: none"> <li>1. Check for worn or dull blades. Replace if necessary.</li> <li>2. Check quill assembly(s) and make certain none are bent. Replace if necessary.</li> <li>3. Mowing a heavy stand of grass or grass with excessive surface moisture could allow mower to leave a unmowed strip. Mow counterclockwise (side discharge only). Do not mow wet grass.</li> <li>4. Forward speed should be adjusted to mowing conditions by gear selection. Engine should be run at full throttle.</li> <li>5. Check blade belt tension. Adjust if necessary.</li> <li>6. Check for damage to mower deck housing. Repair or replace if necessary.</li> </ol>
Mower Scals Lawn.	<ol style="list-style-type: none"> <li>1. Check for bent blade(s) or quill assembly(s). Replace if necessary.</li> <li>2. Check mower height adjustment setting and readjust if needed. Scaping is more likely on rough or uneven lawns.</li> <li>3. Check mower deck leveling adjustment and readjust if necessary.</li> </ol>
Mower Will Not Discharge Clippings.	<ol style="list-style-type: none"> <li>1. Check underside of mower deck housing for accumulation of clippings. Remove accumulated clippings.</li> <li>2. Wet conditions can cause the discharge chute and underside of mower deck to become plugged with clippings. Do not mow wet grass.</li> <li>3. If blade(s) have been replaced, make sure they have been correctly mounted.</li> </ol>
Collector Bag Does Not Billow Out as Usual.	<ol style="list-style-type: none"> <li>1. Check collector discharge chute and bag inlet opening for plugging.</li> <li>2. Check collector fan and jackshaft belts for tension and/or damage. Replace if necessary.</li> <li>3. Check for split or damaged pulley(s). Replace if necessary.</li> </ol>
Unit is Not Picking Up Grass Properly.	<ol style="list-style-type: none"> <li>1. Check collector discharge chute, mower discharge chute and bag inlet opening for plugging.</li> <li>2. Mower deck height may be too low and not allowing enough air flow. Raise cutting height.</li> <li>3. Check collector fan and jackshaft belts for tension and/or damage. Replace if necessary.</li> <li>4. Check for split or damaged pulley(s). Replace if necessary.</li> <li>5. Check collector fan housing for grass clippings build-up. Clean fan housing.</li> <li>6. Check mower deck for grass clippings build-up. Clean mower deck.</li> </ol>
Sound Level of Fan is High	<ol style="list-style-type: none"> <li>1. Remove collector discharge chute and check fan housing for build up of grass clippings. Clean inside of fan housing.</li> </ol>
Blade Drive Belt Comes Off During Use.	<ol style="list-style-type: none"> <li>1. Check belt tension. Adjust if necessary.</li> <li>2. Check all belt guides. Correct clearance is 1/16 inch from belt when blade engagement lever is engaged.</li> <li>3. Make certain mower deck leveling adjustment is correct. Adjust if necessary.</li> <li>4. Check for and remove any foreign objects interfering with belt travel.</li> <li>5. Check all pulleys on mower deck. A bent or split pulley could cause problems. Replace if necessary.</li> <li>6. Check engine drive pulley inner surface. If inner surface is rough or split, pulley should be replaced.</li> <li>7. Check blade throw-out assembly for wear. Replace necessary parts.</li> </ol>
Blade Drive Belt Slips.	<ol style="list-style-type: none"> <li>1. If grass is too high or wet, belt slippage may occur.</li> <li>2. Check belt for wear or damage. Replace if necessary.</li> <li>3. Check belt tension. Adjust if necessary.</li> <li>4. Check blade drive belt tension spring. If spring is stretched or damaged, replace spring.</li> </ol>
Blade Drive Belt Wears Excessively	<ol style="list-style-type: none"> <li>1. Check all belt guides. Correct clearance is 1/16 inch from belt when blade engagement lever is engaged.</li> <li>2. Check for and remove any foreign objects interfering with belt travel.</li> <li>3. Check pulleys for damage. Replace if necessary.</li> <li>4. Make certain belt brake is clearing belt when mower is engaged. If brake cable is too long or broken, adjust or replace.</li> <li>5. Make certain mower deck leveling adjustment is correct. Adjust if necessary.</li> </ol>
Blade(s) Will Not Engage	<ol style="list-style-type: none"> <li>1. Check belt. If worn or broken, replace. If belt is too loose, make belt adjustment.</li> <li>2. Check engagement spring on deck engagement idler. If broken or damaged, replace.</li> <li>3. Check for and remove any foreign objects interfering with engagement idler travel.</li> </ol>
Blade(s) Will Not Disengage	<ol style="list-style-type: none"> <li>1. Check belt tension. Adjust if necessary.</li> <li>2. If blade drive belt adjustment will not provide enough slack in drive belt, replace with correct <b>Original Equipment Belt</b>.</li> <li>3. Check for and remove any foreign objects interfering with engagement idler travel.</li> </ol>
Extreme Vibration Occurs When Blade is Engaged	<ol style="list-style-type: none"> <li>1. Check blade(s) and make certain they are not bent, out of balance or loose. Replace if necessary.</li> <li>2. Check belt for burn spots or irregularities that might cause vibration. Replace if necessary.</li> <li>3. Check quill assembly(s) for damage or wear. Replace if necessary.</li> <li>4. Check for worn or damaged blade engagement parts. Repair or replace as necessary.</li> <li>5. Check engine drive pulley inner surface. If inner surface is rough or split, pulley should be replaced.</li> <li>6. Check under side of mower deck housing for accumulation of clippings. Remove accumulated clippings.</li> <li>7. Check for loose or damaged engine mounts. Tighten or replace as necessary.</li> </ol>



<b>TROUBLE SHOOTING GUIDE (Continued)</b>	
<b>DANGER: ALWAYS DISCONNECT SPARK PLUG WIRE BEFORE ATTEMPTING ANY INSPECTION OR ADJUSTMENT.</b>	
PROBLEM	CORRECTION
Deck or Deck Wheel Hits Rear Wheel and Tire Assembly	<ol style="list-style-type: none"> <li>1. Deck drive belt adjustment is too tight. Readjust.</li> <li>2. Other than Original Equipment Belt is being used and is either too long or stretched. Replace belt.</li> <li>3. Belt is worn. Replace with new Original Equipment Belt.</li> <li>4. Check pivot tube assembly for damage. Repair or replace if necessary.</li> </ol>
Deck Lift Cable Broken	<ol style="list-style-type: none"> <li>1. Check operating procedure. Excessive ground speed on rough lawn may cause mower deck bounce, resulting in lift cable failure.</li> <li>2. Remove excessive clippings from underside of mower deck housing (build-up of clippings adds excessive weight to mower deck).</li> </ol>
Unit Drive Belt Slips.	<ol style="list-style-type: none"> <li>1. Check unit drive belt adjustment(s). Adjust if necessary.</li> <li>2. Check for damaged or broken clutching idler spring. Replace if necessary.</li> <li>3. Check belt(s) for wear or damage. Replace if necessary.</li> <li>4. Check vari-speed control lever adjustment.</li> <li>5. Check for and remove any foreign objects obstructing vari-speed or clutching idler mechanism.</li> </ol>
Unit Drive Belt Squeals When Brake is Applied	<ol style="list-style-type: none"> <li>1. Check brake-clutch synchronization (does not apply to vari-speed units). Adjust if necessary.</li> <li>2. Check unit drive belt adjustment(s). Adjust if necessary.</li> <li>3. Check for and remove any foreign objects obstructing vari-speed or clutching idler mechanism.</li> <li>4. Check brake adjustment.</li> </ol>
Unit Drive Belt Comes Off During Use.	<ol style="list-style-type: none"> <li>1. Check belt tension. Adjust if necessary.</li> <li>2. Check belt guides. Adjust if necessary.</li> <li>3. Check for split or damaged pulley(s). Replace if necessary.</li> <li>4. Check clutching idler pulley alignment. If out of alignment, idler bracket may be bent. Replace if necessary.</li> </ol>
Jackshaft Drive Belt Comes Off During Use.	<ol style="list-style-type: none"> <li>1. Check idler support brackets and tighten if loose.</li> <li>2. Check to make sure belt has proper twist so that "V" side of belt is in grooves on all four pulleys.</li> <li>3. Check spring on right idler pulley for damage. Replace if necessary.</li> <li>4. Adjust left idler pulley if belt is loose.</li> <li>5. Check for worn or damaged belt. Replace if necessary.</li> </ol>
Unit Will Not Propell Itself When Clutch or Vari-Speed Lever is Engaged.	<ol style="list-style-type: none"> <li>1. See Steps 1 through 6 in Unit Drive Belt Slips section of this chart.</li> <li>2. Check engine, transmission or transaxle pulley(s) for sheared or missing key. Replace if necessary.</li> <li>3. Check transmission or transaxle to make certain it is operable. Make certain chain (chain drive units only) is intact.</li> </ol>
Extrama Vibration Occurs When Clutch is Engaged (Let-Out)	<ol style="list-style-type: none"> <li>1. Check for split or damaged pulley(s). Replace if necessary.</li> <li>2. Check belt for irregularities or burned spots. Replace if necessary.</li> <li>3. Make certain belt tension is correct. Adjust if necessary.</li> <li>4. Check clutching idler assembly for wear or damage. Replace parts as necessary.</li> <li>5. On chain drive units, check sprockets for proper alignment and chain damage. Replace if necessary.</li> <li>6. Check for loose or damaged engine mounts. Tighten or replace as necessary.</li> <li>7. Check collector fan bearing. Replace damaged or worn bearing.</li> <li>8. Check collector fan mounting and number (4) of fan blades. Replace fan if necessary.</li> <li>9. Check collector fan blades for bends or unusual wear which could affect balance.</li> </ol>
Unit Will Not Shift or Shifts Hard.	<ol style="list-style-type: none"> <li>1. Check shifting procedure. Unit MUST come to a complete stop before shifting. On vari-speed units, hold firm pressure on shift lever while moving vari-speed control lever slowly forward.</li> <li>2. Check brake-clutch synchronization (does not apply to vari-speed units). Adjust if necessary.</li> <li>3. Check unit drive belt adjustment. Adjust if necessary.</li> <li>4. Have transmission or transaxle checked by a competent repairman.</li> </ol>
Steering Slips or is Loose.	<ol style="list-style-type: none"> <li>1. Check for steering sector gear and pinion looseness. If gears are loose, make sector gear adjustment.</li> <li>2. Check ball joints for wear. Replace if necessary.</li> <li>3. Check center pivot belt on front axle. If loose, tighten securely.</li> </ol>
Engine Will Not Turn Over.	<ol style="list-style-type: none"> <li>1. Check starting procedure. Make sure starting instructions are followed.</li> <li>2. Check fuse (if so equipped).</li> <li>3. Check battery for charge. Make sure battery has been activated (on new units).</li> <li>4. On new units, remove spark plug and check cylinder for accumulation of oil due to handling.</li> <li>5. Make visual check of electrical system to make sure all connections and lockout switches are secure.</li> <li>6. Check engine according to engine manufacturers instructions.</li> <li>7. Have electrical system checked by a competent repairman.</li> </ol>
Engine Turns Over But Will Not Start.	<ol style="list-style-type: none"> <li>1. Check starting procedure. Make sure starting instructions are followed.</li> <li>2. Make certain fuel tank is filled with clean, fresh gasoline.</li> <li>3. Make certain fuel shut-off is open (if so equipped).</li> <li>4. Make certain that throttle is in choke or fast position.</li> <li>5. Check engine according to engine manufacturers instructions.</li> <li>6. On recoil start unit, make visual check of wiring system to make sure all connections and lockout switches are secure.</li> <li>7. Have wiring and lockout switches (on recoil start unit) checked by a competent repairman.</li> </ol>