

UNIT REPAIR PARTS

ALWAYS GIVE THE FOLLOWING INFORMATION WHEN ORDERING REPAIR PARTS:
 1. The PART NUMBER 2. The PART NAME 3. QUANTITY DESIRED 4. The MODEL NUMBER—(As shown on Model Plate)
 SEND PART ORDERS AS PER INSTRUCTIONS ON THE FRONT PAGE
 YOUR UNIT IS RIGHT HAND (RH) OR LEFT HAND (LH) AS YOU STAND BEHIND IT
 DO NOT USE KEY NUMBERS WHEN ORDERING REPAIR PARTS, ALWAYS USE PART NUMBERS.
 All replacement parts will be supplied in current production colors or in a neutral color.
 A handling fee is applicable to small parts orders.

36" RIDING MOWER MODEL 5288-4000

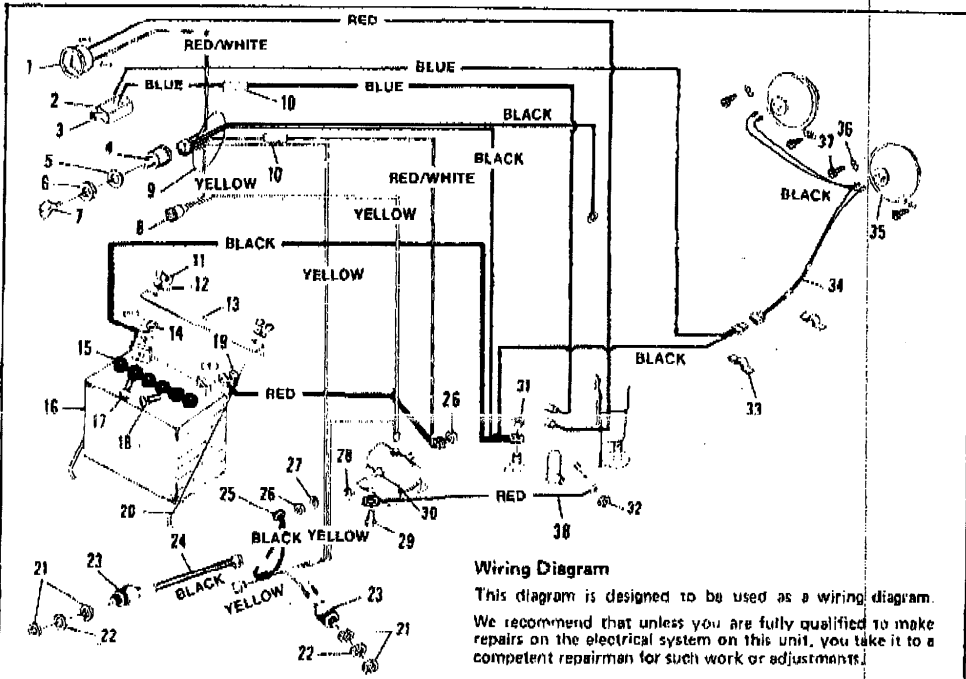

Key No.	Part No.	Description	Key No.	Part No.	Description
1	39483	Ammeter	20	40234	Battery Rod
2	40897	Switch w/Knob, Headlamp	21	45877	Nut, (Lockout Switch Part)
3	40778	Knob, Headlamp Switch	22	45878	Lockwasher, (Lockout Switch Part)
4	44745	Switch, Ignition w/Keys	23	41204	Switch, Lockout
5	138567	Lockwasher (Switch Part)	24	42030	Wire Assembly, Deck Switch
6	48140	Locknut (Switch Part)	25	42071	Wire Assembly, By-Pass
7	36285	Key, Ignition	26	120368	Locknut, Hex, 5/16-24 Thd
8	45333	Indicator Light	27	120630	*Lockwasher, Split, 5/16 In.
9	49818	Wire Harness Assembly	28	0424215	Locknut, Hex, 1/2-20 Thd
10	49211	Fuse	29	170854	*Screw, Hex Hd, 1/2-20 x 5/8 In.
11	997208	*Wing Nut, Nylock, 1/2-20 Thd	30	44429	Solenoid
12	120306	*Flatwasher, 1/4 In.	31	9413947	Locknut, Hex, 5/16-18 Thd
13	40743	Bracket, Battery Hold-Down	32		Engine Part
14	271172	Nut, Keps, 1/2-20 Thd	33	41482	Wire Clip, Press
15	40892	Cap, Battery	34	44911	Lead Wire, Headlamp
16	2938	Battery	35	44086	Headlamp
17	110356	*Carriage Bolt, 1/2-20 x 1/2 In.	36	42692	Clip, Headlamp Mounting
18	120211	*Carriage Bolt, 5/16-18 x 5/8 In.	37	9411666	*Screw, Tap, No. 10-16 x 1/2 In.
19	271184	Nut, Keps, 5/16-18 Thd	38	44879	Ground Wire

*Standard Hardware Items - May Be Purchased Locally.

36" RIDING MOWER MODEL 5288-4000

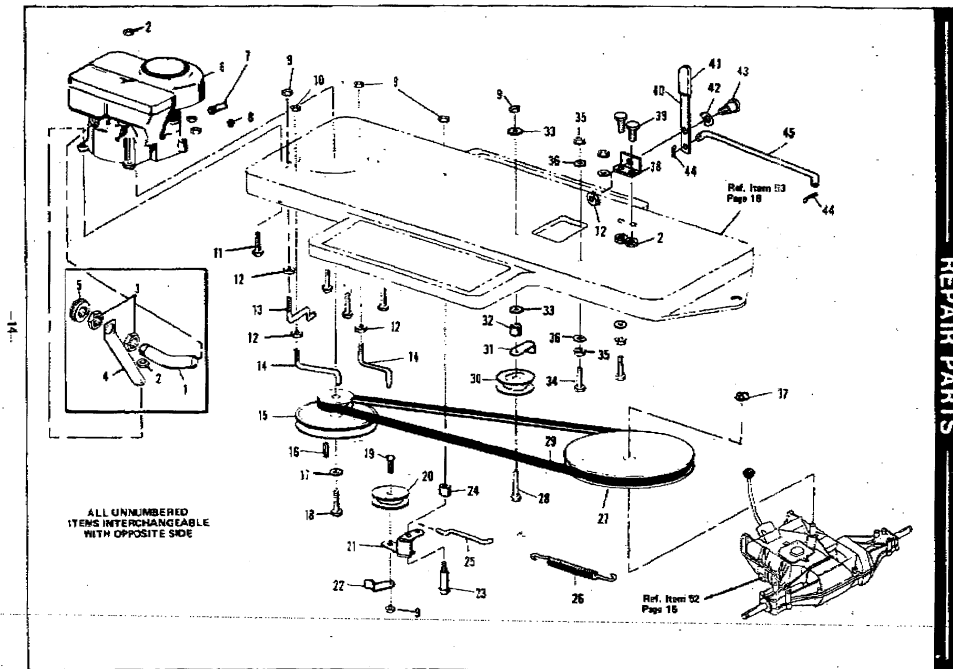

36" RIDING MOWER MODEL 5288-4000

Key No.	Part No.	Description	Key No.	Part No.	Description	Key No.	Part No.	Description
1	46896	Tube, Muffler	16	33200	Key, 1/2 x 1/4 x 1 1/2 In.	31	36314	Retainer, Drive Belt Backside Idler
2	9413447	Locknut, Hex, 5/16-18 Thd	17	120383	Lockwasher, Split, 7/16 In.	32	40208	Spacer, Backside Idler
3	46779	Locknut	18	123567	Screw, Hex Hd, 7/16-20 x 1 In.	33	120394	Flatwasher, 3/8 In.
4	46925	Muffler Support	19	120915	Screw, Hex Hd, 3/8-16 x 1 1/2 In.	34	121966	Cap screw, Hex Hd, 1/2-20 x 2 1/2 In.
5	46706	Muffler	20	35374	Pulley, Idler	35	271172	Nut, Keps, 1/2-20 Thd
6	Engine	See Footnote Below	21	40152	Arm, Drive Idler	36	120366	Flatwasher, 1/2 In.
7	47829	Tube, Oil Drain	22	39859	Retainer, Belt	37	22053	Retaining Ring
8	47828	Cap, Oil Drain Tube	23	40210	Shoulder Bolt, Drive Idler	38	49790	Bracket, Lever Pivot
9	9413694	Locknut, Hex, 3/8-16 Thd	24	40209	Spacer, Drive Idler	39	120228	Screw, Hex Hd, 5/16-18 x 5/8 In.
10	41529	Locknut, 3/16-18 Thd	25	40154	Rod, Clutch	40	49789	Shift Lever, Hi-Lo
11	122040	Screw, Hex Hd, 5/16-18 x 1 1/2 In.	26	40168	Spring, Clutch	41	49576	Grip, Hi-Lo Shift Lever
12	271190	Nut, Keps, 3/8-16 Thd	27	39268	Pulley, Transaxle	42	32327	Wash Washer
13	40977	Rod Assembly, Belt Guide	28	122194	Screw, Hex Hd, 3/8-16 x 2 1/2 In.	43	23211	Shoulder Bolt
14	44894	Rod, Belt Guide	29	39454	V-Belt, 4L-880	44	121224	Cotter Pin, 3/32 x 1 In.
15	42108	Pulley, Engine	30	40223	Pulley, Backside Idler	45	49788	Shift Rod

*Standard Hardware Items - May Be Purchased Locally.

Replacement engines and parts are obtainable from Engine Manufacturer's authorized Service Stations who are also to be contacted in regard to the Engine Warranty. See your Engine Manual for location of these stations.

36" RIDING MOWER MODEL 5288-4000

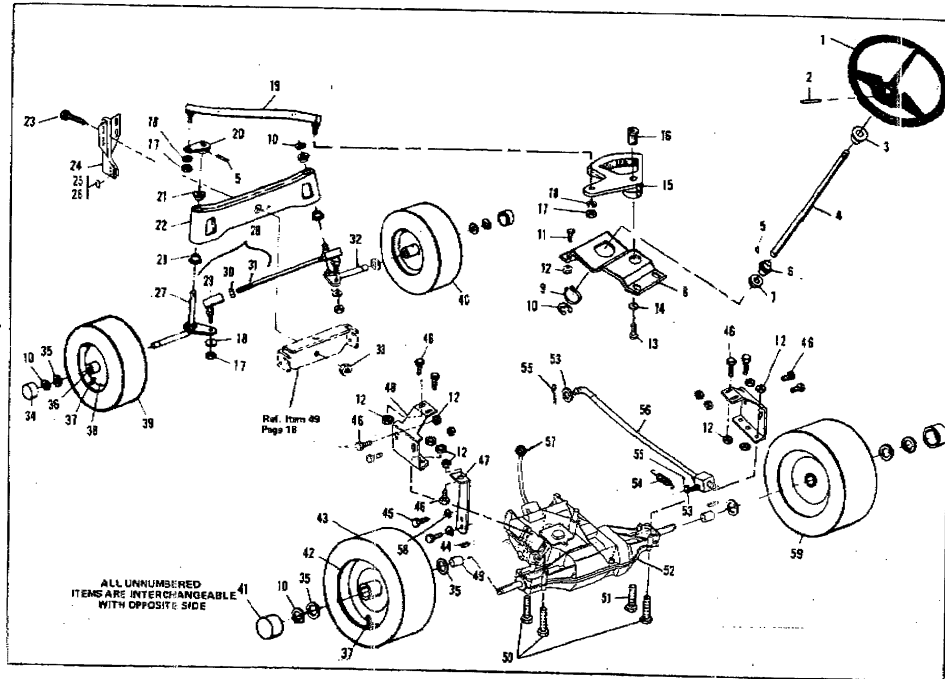

36" RIDING MOWER MODEL 5288-4000

Key No.	Part No.	Description
1	47083	Steering Wheel
2	456836	Roll Pin, 1/4 x 2 1/4 In.
3	39432	Bearing, Flanged
4	48536	Shaft, Steering Wheel
5	454565	Roll Pin, 1/2 x 1 1/4 In.
6	44009	Pinion
7	39580	Bearing
8	48542	Plate, Steering
8	39482	Retaining Ring
10	39625	"E" Ring, Tru-Arc, No. 5133-75
11	120223	*Screw, Hex Hd, 5/16-18 x 5/8 In.
12	9413447	*Locknut, Hex, 5/16-18 Thd
13	39573	Screw, Lock, Hex, 3/8-24 x 1 In.
14	2483	Spring Washer
15	48543	Sector Gear
16	44011	Shoulder Bolt, Sector Gear
17	120389	*Nut, Hex, 3/8-24 Thd
18	120382	*Lockwasher, Split, 3/8 In.
19	48536	Drag Link Assembly
20	48447	Steering Arm, Front Spindle

Key No.	Part No.	Description
21	40196	Bearing, Front Spindle
22	48786	Front Axle Assembly
23	48780	Bolt, Front Axle Pivot
24	47830	Bracket, Deck Hanger
25	68180	Decal, Deck Hanger, R.H.
25	68181	Decal, Deck Hanger, L.H.
27	40163	Front Spindle Assembly, Left
28	45763	Tie Rod Assembly
29	21275	Ball Joint
30	124925	Hex Nut
31	43264	Tie Rod
32	40164	Front Spindle Assembly, Right
33	274654	*Nut, Center Lock, 1/2-20 Thd
34	40394	Hub Cap
35	642	Flatwasher, 1/2 I.D., 1-5/16 O.D.
36	39979	Bearing, Front Wheels
37	24187	Valve Stem
38	39829	Wheel w/Bearings, Front
39	41108	Tire, Front
40	41107	Wheel & Tire Assembly, Front

Key No.	Part No.	Description
41	36832	Hub Cap
42	41105	Wheel, Rear
43	41106	Tire, Rear
44	39628	Key, 3/16 x 3/16 x 2 1/2 In.
45	35498	*Screw, Hex Wa. Tap, 5/16-18 x 3/4 In.
46	122007	*Screw, Hex Hd, 5/16-18 x 3/4 In.
47	49796	Stabilizing Bracket
48	49785	Axle Support Bracket
49	49792	Spacer
50	122083	*Screw, Hex Hd, 5/16-18 x 2 1/2 In.
51	122089	*Screw, Hex Hd, 5/16-18 x 3 In.
52	Transaxle	Footc, Model 4000-6 (See Pages 21 & 22)
53	274517	*Flatwasher, 3/8 In.
54	39395	Spring, Brake Return
55	121224	*Cotter Pin, 3/32 x 1 In.
56	49787	Rod Assembly, Brake-Clutch Knob, Shift Lever
57	29483	*Lockwasher, Split, 5/16 In.
58	120536	*Lockwasher, Split, 5/16 In.
59	41104	Wheel & Tire Assembly, Rear

*Standard Hardware Items - May Be Purchased Locally.

36" RIDING MOWER MODEL 5288-4000

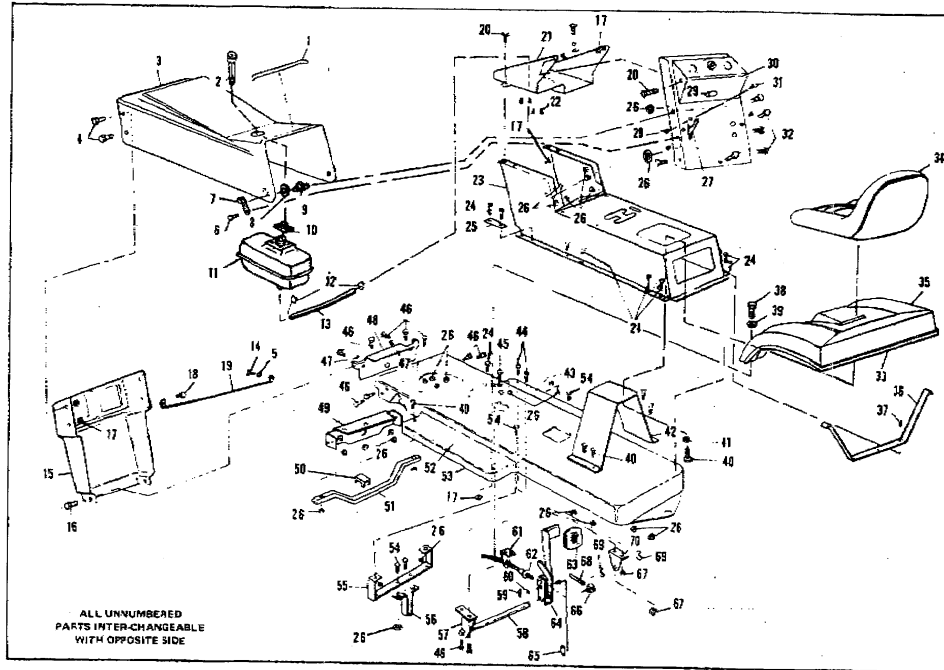

36" RIDING MOWER MODEL 5288-4000

Key No.	Part No.	Description
1	42089	Hood Strip
2	48493	Gas Gauge
3	48535	Hood Assembly
4	48900	*Screw, Hex Hd, 1/20 x 1 In.
5	120380	*Lockwasher, Split 1/4 In.
6	41924	Shoulder Bolt
7	48704	Latch, Rubber
8	48705	Pad, Hood Latch
9	48703	Pin, Hood Latch
10	43458	Pad, Gas Tank
11	48812	Gas Tank
12	41008	Clamp, Fuel Line
13	36291	Tubing, Fuel Line
14	19002C	*Screw, Hex Hd, 1/4-20 x 3/4 In.
15	49772	Grille Assembly
16	120233	*Screw, Hex Hd Cap, 3/8-16 x 1 In.
17	9424215	*Locknut, Hex, 1/2-20 Thd
18	9431758	*Screw, Taprite, 1/4-14 x 3/4 In.
19	40411	Hood Lanyard
20	120954	*Screw, Hex Hd, 1/4-20 x 5/8 In.
21	48819	Bracket, Gas Tank & Battery
22	49060	Screw, Plastic, 1/4-10 x 3/4 In.
23	49791	Console
24	995346	Screw, Taprite, 1/4-20 x 1/2 In.

Key No.	Part No.	Description
25	42385	Console Reinforcement
26	9413447	*Locknut, Hex, 5/16-18 Thd
27	49756	Throttle Control
28	271166	*Nut, Keps, Hex, No. 10-24 Thd
29	39486	Knob, Throttle Control
30	47530	Dashboard Assembly
31	35291	Screw, Hex Hd, No. 10-24 x 1/2 In.
32	48901	Screw, Hex Hd, 5/16-18 x 5/8 In.
33	49770	Edging, Fender
34	44697	Seat
35	45416	Fender Assembly
36	49522	Support Bracket, Fender
37	995338	*Screw, Taprite, 1/4-20 x 5/8 In.
38	121990	*Screw, Hex Hd, 1/4-20 x 1 In.
39	120395	*Flatwasher
40	122007	*Screw, Hex Hd, 5/16-18 x 1/2 In.
41	120638	*Lockwasher, Split, 5/16 In.
42	41084	Seat Bracket
43	48728	Foot Pad, Right
44	126211	*Carriage Bolt, 5/16-18 x 5/8 In.
45	40886	Screw, Taprite, 1/4-20 x 3/8 In.
46	120228	*Screw, Hex Hd, 5/16 x 5/8 In.
47	9413534	*Locknut, Hex, 3/8-16 Thd

Key No.	Part No.	Description
48	48782	Reinforcing Plate, Front
49	48781	Bracket, Axle Support, Front
50	43839	Bracket, Upstop
51	49389	Brace, Front Footrest
52	48729	Foot Pad, Left
53	49372	Main Frame
54	122017	*Screw, Hex Hd, 5/16-18 x 1 In.
55	49682	Guide Support, Rear Mower Deck
56	39405	Guide, Mower Rear Deck
57	49345	Clutch Rod, Bracket, Long
58	40155	Pedal Rod
59	121224	*Cotter Pin, 3/32 x 1 In.
60	274517	*Flatwasher, 25/64 I.D.
61	41203	Mounting Bracket, Frame Switch
62	41204	Lockout Switch, Frame
63	49169	Rubber Pedal Pad
64	48183	Brake Pedal Assembly
65	57950	Decal, Brake
66	49653	Pivot Block
67	271184	*Nut, Keps, 5/16-18 Thd
68	49787	Rod, Brake-Cut-Off
69	20894	"E" Ring, Tri-Arc, No. 51335D
70	48157	Bracket, Brake-Pedal

*Standard Hardware Items - May Be Purchased Locally.

36" RIDING MOWER MODEL 5288-4000

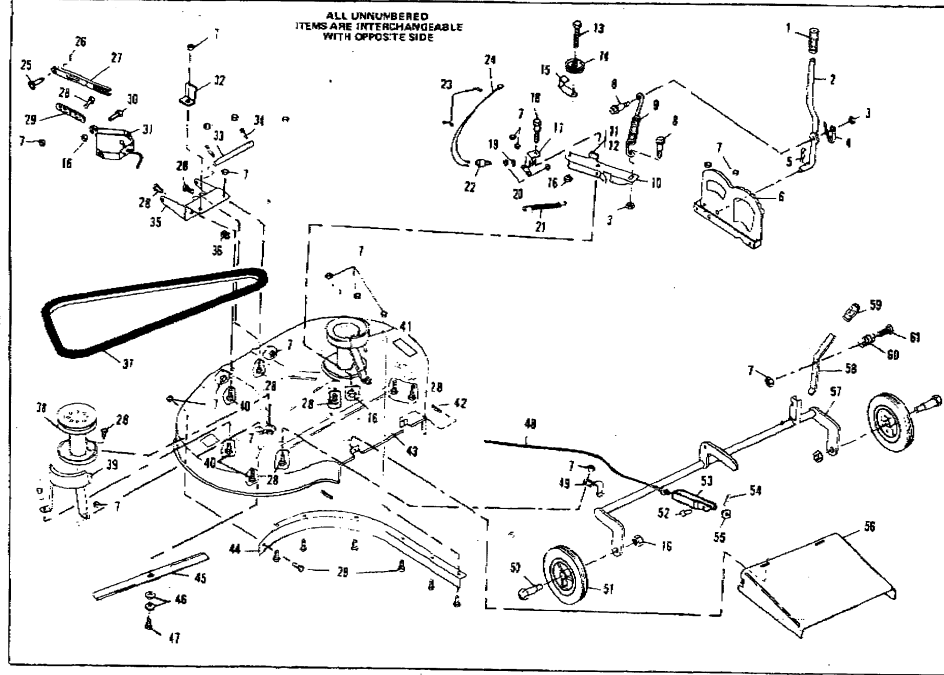

36" RIDING MOWER MODEL 5288-4000

Key No.	Part No.	Description
1	46478	Hand Grip
2	49130	Lever, Clutch
3	9424215	*Locknut, 1/4-20 Thd
4	48561	Spring, Clutch Lever
5	39521	*Hairpin Cotter
6	47515	Quadrant
7	9413447	*Locknut, 5/16-18 Thd
8	46563	Shoulder Bolt
9	46359	Spring, Clutch Lever
10	47523	Idler Arm Assy (Includes Items 11 & 12)
11	41471	Brake Pad
12	41601	Rivet, Brake Pad
13	122168	*Screw, Hex Hd, 3/8-16 x 1 1/2 In.
14	48476	Pulley, Idler
15	46477	Bell Retainer
16	9413534	*Locknut, 3/8-16 Thd
17	47511	Bracket, Idler Arm
18	47516	Shoulder Bolt
19	45878	Lockwasher, (Lockout Switch Part)
20	45877	Nut, (Lockout Switch Part)

Key No.	Part No.	Description
21	39410	Spring
22	41204	Switch, Lockout
23	41482	Press Clip
24	43038	Wire Assy
25	47816	Pull Pin
26	8290	Hairpin Cotter
27	49059	Bar Hitch
28	120228	*Screw, Hex Hd, 5/16-18 x 5/8 In.
29	49058	Lock Bracket
30	120818	*Screw, Hex Hd, 3/8-16 x 1 1/2 In.
31	46470	Pivot Bracket
32	49674	Bracket, Upstop
33	47814	Pin, Pivot
34	48675	*Cotter Pin, 3/16 x 1 1/2 In.
35	48676	Lift Support, Plate Assy
36	996416	Washer
37	48044	V-Belt
38	39493	Outill Assembly
39	48365	Cover, L.H. Pulley
40	122017	Screw, Hex Hd, 5/16-18 x 1 In.
41	46364	Cover, R.H. Pulley

Key No.	Part No.	Description
42	120123	Cotter Pin
43	46324	Mower Deck
44	46367	Bar/Hd, L.H.
45	39311	Blade, 18 In.
46	2483	Formed Washer
47	39573	*Screw, Hex Hd, 3/8-24 x 1 In.
48	46512	Lift Cable
49	42424	Support, Pivot Tube
50	23763	Wheel Axle
51	39831	Tire & Wheel, 6 In.
52	39522	Pin, Clevis
53	39404	Clevis, Lift Cable
54	121222	*Cotter Pin, 3/32 x 3/4 In.
55	120372	*Square Nut, 1/4-20 Thd
56	48381	Chute Extension
57	48573	Pivot Tube Assembly
58	49131	Lever, Height Adjust
59	20250	Hand Grip
60	29170	Spring
61	122040	*Screw, Hex Hd, 5/16-18 x 1 1/2 In.

*Standard Hardware Items - May Be Purchased Locally.