

REPAIR PARTS MANUAL

39" - 12 H.P. RIDING MOWER

MODEL A3560-180

ONE YEAR LIMITED WARRANTY

For one (1) year from date of purchase by the first consumer for residential use (thirty (30) days commercial use), NOMA Outdoor Products Incorporated warrants that it will replace free of charge, including labor, any original part of any NOMA Outdoor Products Incorporated product found to be defective by any authorized Service Dealer or the factory, except the battery which is warranted for ninety (90) days from date of purchase.

This warranty does not cover engine, transmission, transaxle or differential (these items are covered by their manufacturer's own warranty). This warranty does not cover parts that have failed due to normal wear or parts that have failed subject to misuse or abuse. Transportation of the unit or part to and from an authorized Service Dealer or factory is the responsibility of the owner.

A step by step explanation as to what procedure should be followed for this warranty is:

1. If a part becomes defective, contact the store where the unit was purchased for the name and address of the authorized Service Dealer nearest to you.
2. If you cannot locate an authorized Service Dealer, write Service Department of NOMA Outdoor Products Incorporated for the name and address of the authorized Service Dealer in your area or call the Service Department at 1-901-422-1890.
3. Return the defective product, along with proof of purchase to such authorized Service Dealer for replacement of any defective part where covered by this warranty.

There is no other express warranty. Implied warranties, including those of merchantability and fitness for a particular purpose are limited to one (1) year from date of purchase. Liability for incidental or consequential damages are excluded.

Some states do not allow limitations on how long an implied warranty lasts, so the above limitation may not apply to you. Some states do not allow the exclusion of incidental or consequential damages, so the above exclusion may not apply to you. This warranty gives you specific legal rights, and you may have other rights which vary from state to state.

NOMA Outdoor Products Incorporated

Call 8000

Jackson, TN 38305-8000

UNIT PARTS AND SERVICE

This manual contains instructions for safety, assembly and maintenance. Read this manual carefully and completely so that you will know proper assembly, use and care of your unit. Also fill in and mail the registration card packed with the unit. For service other than covered in this manual, contact an authorized service dealer. A national parts and service organization has been established to provide locally available parts and service. A list of authorized parts distributors has been included in this manual. When ordering repair parts, always give the following information: 1. The Part Name; 2. The Part Number; 3. The Quantity desired; 4. The Full (eight digit) Model Number of the unit. The model number will be found on a plate attached to the unit.

Look for this symbol.



It means - ATTENTION! BECOME ALERT! A HAZARD TO OPERATOR, BYSTANDER, PROPERTY OR EQUIPMENT MAY EXIST.

NOMA Outdoor Products Incorporated

Call 8000

Jackson, TN 38305-8000

Part No. 312808

4889



OPERATIONAL PRECAUTIONS



THESE INSTRUCTIONS ARE FOR YOUR PROTECTION. PLEASE READ THEM CAREFULLY.

1. Know the controls and how to stop quickly. READ THIS OPERATOR'S MANUAL and instructions furnished with attachments.
2. Wear safety glasses or eye shields when assembling or operating riding mower.
3. Do not allow children to operate the machine. Do not allow adults to operate it without proper instruction.
4. Do not carry passengers. Do not mow when children and others are around. Disengage power to blades(s) or attachment(s) and stop the engine while others are in the vicinity of the mower.
5. Battery fluid (electrolyte) is an ACID and is extremely dangerous. Do not smoke while servicing the battery. Do not service the battery near a open flame or spark.
6. Handle gasoline with care, it is highly flammable.
 - A. Use approved gasoline container.
 - B. Never remove the fuel cap of, or add gasoline to, a running or hot engine, or an engine that has not been allowed to cool for several minutes after running. Never fill the tank indoors and always clean up spilled fuel immediately.
 - C. Do not smoke while filling fuel tank.
 - D. Do not run the engine indoors. Open doors if engine must be run in garage. Exhaust fumes contain CARBON MONOXIDE, an ODORLESS and DEADLY GAS.
7. Check fuel supply before each use allowing space for expansion as the heat of the engine and/or sun can cause gasoline to expand.
8. Do not operate mower when barefooted. Always wear substantial footwear, preferably steel-toed shoes. Do not wear loose fitting clothing that could get caught in moving parts.
9. Clear the work area of objects (wire, rocks, etc.) which might be picked up and thrown. Check all controls for proper function.
10. Disengage all attachment clutches, shift to neutral, and set parking brake before attempting to start the engine (motor). When starting engine equipped with a pull starter, stand firm and make sure your feet are well away from the blade(s).
11. Disengage power to blade(s) or other attachment(s) and stop the engine (motor) before leaving the operator's position. Always dismount from the left side.
12. Disengage power to blade(s) or other attachment(s) and stop the engine (motor) before making any repairs or adjustments.
13. Disengage power to blade(s) or other attachment(s) when transporting or not in use.
14. Take all possible precautions when leaving the vehicle unattended, such as disengaging power to blade(s) or attachment(s), lower the attachment(s), setting the parking brake, stopping the engine (motor), and removing the key.
15. Do not stop or start suddenly when going uphill or downhill. Mow up and down the face of steep slopes; never across the face.
16. Reduce speed and exercise extreme caution on slopes and in sharp turns to prevent tipping or loss of control. Be especially cautious when changing direction on slopes.
17. Stay alert for holes, rocks, and roots in the terrain and other hidden hazards. Keep away from drop-off. Never operate your riding mower on wet or slippery grass or at a speed which could cause a skid. Exercise care when mowing around a fixed object to prevent the blade(s) from striking it. Never deliberately run over any foreign object.
18. Always disengage blade control lever before attempting to remove the mower from a hole or other obstruction.
19. Use care when pulling loads or using heavy equipment.
 - A. Use only approved drawbar hitch points.
 - B. Limit loads to those that you can safely control.
 - C. Do not turn sharply. Use care when backing.
 - D. Use counterweight(s), wheel weights or tire chains when suggested in attachment(s) instructions.
20. Watch for traffic when crossing or near roadways.
21. When using attachment(s), never direct discharge of material toward bystanders nor allow anyone near the vehicle while in operation.
22. Keep the vehicle and attachments in good operating condition, and keep safety devices in place and in working condition.
23. Keep all nuts, bolts, and screws tight to be sure the equipment is in safe working condition.
24. Never store the equipment with gasoline in the tank inside a building where fumes may reach an open flame or spark. Allow the engine to cool before storing in any enclosure.
25. To reduce fire hazard, keep the engine free of grass, leaves or excessive grease.
26. The vehicle and attachments should be stopped and inspected for damage after striking a foreign object, and the damage should be repaired before restarting and operating the equipment.
27. Do not change the engine governor settings or over-speed engine.
28. When using the vehicle with mower, proceed as follows:
 - A. Mow only in daylight or in good artificial light.
 - B. Never make a cutting height adjustment while the engine (motor) is running if the operator must dismount to do so.
 - C. Shut the engine (motor) off when removing the grass catcher or unclogging chute.
 - D. Check the blade mounting bolts for proper tightness at frequent intervals.
29. Under normal usage, the grass catcher bag material is subject to deterioration and wear. Check the bag frequently for deterioration and wear and replace worn bags. Check that replacement bags comply with the original manufacturer's recommendations or specifications.
30. Disengage power to mower before backing up. Do not mow in reverse unless absolutely necessary and then only after careful observation of the entire area behind the mower.

OWNER'S INFORMATION

Record the following information about your unit so that you will be able to provide it in case of loss or theft.

MODEL NUMBER: - (Enter complete 5 digit number from model plate on unit)

PURCHASE DATE: ___ / ___ / ___ CODE NO.: _____ SERIAL NO.: _____

DEALER'S NAME AND ADDRESS: _____

CITY: _____ STATE: _____ TELEPHONE: _____

CONTENTS OF SHIPPING CARTON

- 1 - 39 In. Riding Mower
- 1 - Operator's Manual
- 1 - Repair Parts Manual
- 1 - Engine Manual
- 1 - Steering Wheel (with roll pin partially installed)
- 1 - Seat
- 1 - Chute Deflector
- 1 - Battery
- 1 - Steering Shaft Cover
- 1 - Bag of Assembly Parts Containing:
 - 1 - Oil Drain Trough
 - 1 - Pivotal Rod (chute deflector)
 - 1 - Torsion Spring (chute deflector)
 - 1 - Battery Hold Down Rod
 - 1 - Battery Hold Down Rod, Top
 - 1 - Small Plastic Wing Nut, 1/4-20 Thd.
- 1 - Bag of Battery Cable Installation Parts Containing:
 - 2 - 1/4-20 x 5/8 inch Hex Nuts
 - 2 - 1/4 inch Keps Nuts (star washer attached)
- 1 - Bag of Seat Mounting Parts Containing:
 - 4 - 5/16 - 18 x 3/4 inch Hex Head Screws
 - 4 - 21/64 inch Split Lockwashers
 - 4 - 11/32 inch Flatwashers

HOW TO MEASURE SCREW SIZE (5/16 x 1 1/2 INCH)

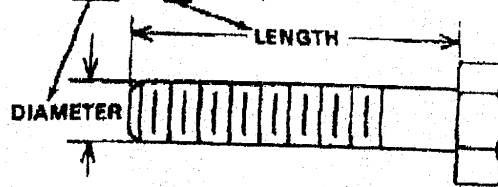

⚠ DANGER ⚠

This riding mower can be dangerous if carelessly used.

Read your Owner's Manual thoroughly before operating your riding mower.

Always wear safety glasses or eye shields while assembling or operating your riding mower.

DO NOT carry passengers at any time.

Keep your hands, feet, hair and loose clothing away from the discharge area, the underside of the mower deck or any moving parts while the engine is running.

TOOLS REQUIRED FOR ASSEMBLY

- 1 - 7/16 inch Wrench (or adjustable wrench)
- 1 - 1/2 inch Wrench (or adjustable wrench)
- 1 - Hammer

NOTICE

For packaging purposes, the knob may have been removed from the mower clutch lever and placed in the parts bag. Please screw the knob onto the mower clutch lever and tighten it securely.

For packaging purposes, the battery may have been installed on your unit. The battery must be removed from your machine to be serviced. See the Battery Removal paragraph in your Operator's Manual for removal instructions.

39" RIDING MOWER MODEL A3560-180

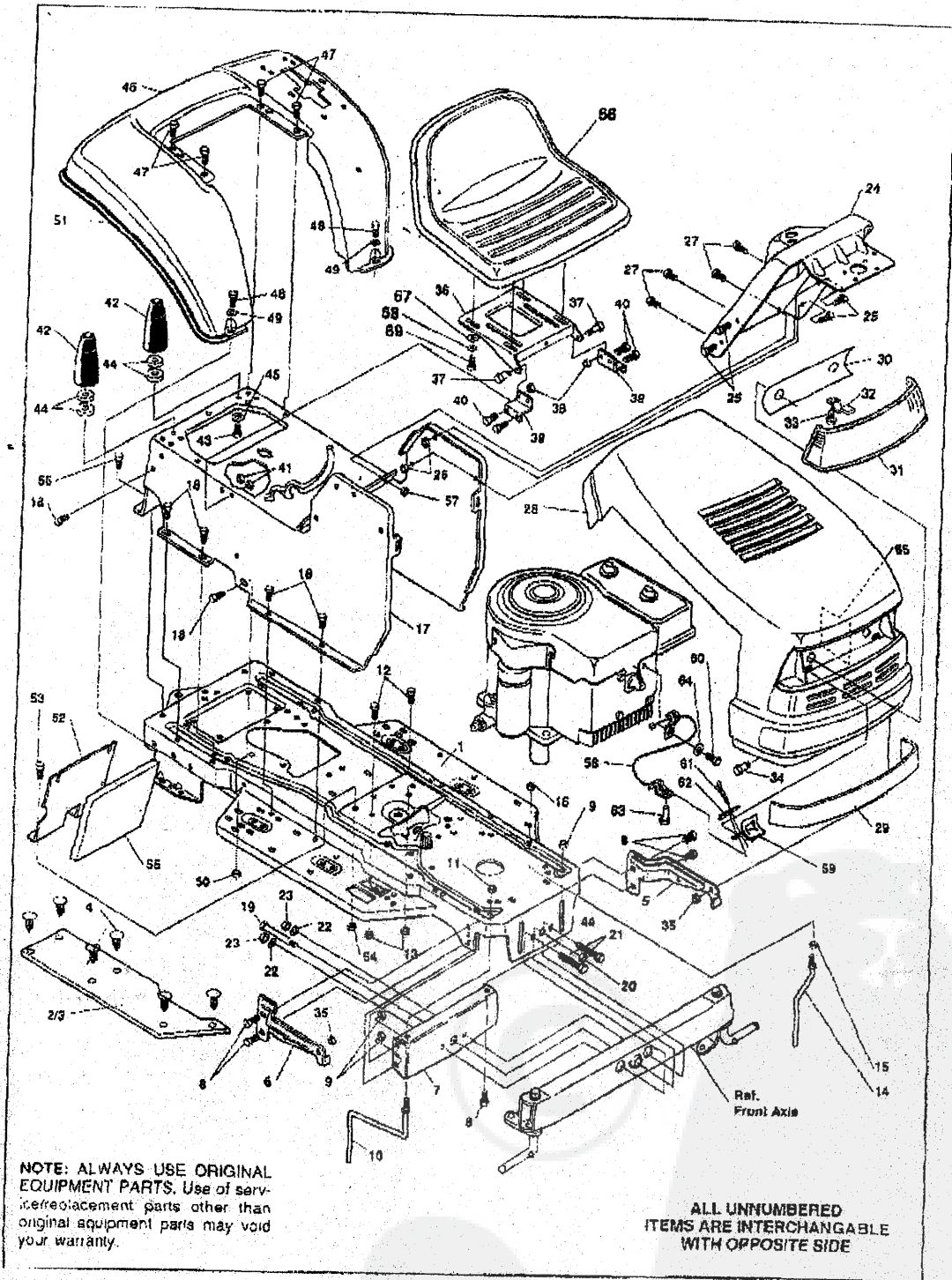

39" RIDING MOWER MODEL A3560-180

ALWAYS GIVE THE FOLLOWING INFORMATION WHEN ORDERING REPAIR PARTS:
 1. The PART NUMBER; 2. The PART NAME; 3. QUANTITY DESIRED; 4. The MODEL NUMBER (As shown on Model Plate).
SEND PART ORDERS AS PER INSTRUCTIONS ON THE FRONT PAGE.
DO NOT USE KEY NUMBERS WHEN ORDERING REPAIR PARTS, ALWAYS USE PART NUMBERS.
 All replacement parts will be supplied in current production colors or in a neutral color.
 A handling fee is applicable to small parts orders.
YOUR UNIT IS RIGHT HAND (RH) OR LEFT HAND (LH) AS YOUR STAND BEHIND IT.

Key No.	Part No.	Description	Key No.	Part No.	Description
1	310832	* Main Frame	36	58367	* Seat Plate
2	310005	Foot Pad, L.H.	37	20507	Shoulder Bolt, 5/16-18 Thd.
3	310006	Foot Pad, R.H.	38	1498	Nut, Hex Centerlock, 5/16-18 Thd.
4	309235	Fastener, Ratchet	39	310660	* Bracket, Seat Support
5	12653	Grille Bracket, L.H.	40	120228	Screw, 5/16-18 x 5/8 In.
6	12654	Grille Bracket, R.H.	41	1498	Nut, Hex Centerlock, 5/16-18 Thd.
7	56361	Bracket, Front Axle	42	310540	Seat Bumper
8	56030	Screw, Wide Flange, 5/16-18 x 3/4 In.	43	122022	Screw, Hex, 5/16-18 x 1-1/8 In.
9	55273	Wide Flange Locknut, 5/16-18 Thd.	44	41462	Spacer
10	300440	Belt Guide Retainer	45	120638	Split Lockwasher, 21/64 In.
11	1498	Nut, Hex Centerlock, 5/16-18 Thd.	46	58334	* Fender
12	120229	Screw, Hex, 5/16-18 Thd.	47	995346	Screw, Tap, 1/4-20 x 1/2 In.
13	1498	Nut, Hex Centerlock, 5/16-18 Thd.	48	122017	Screw, 5/16-18 x 1 In.
14	300635	Belt Guide	49	446363	Flatwasher, 3/8 In.
15	124824	Nut, Hex Jam, 5/16-18 Thd.	50	1498	Nut, Hex Centerlock, 5/16-18 Thd.
16	271190	Nut, Hex Keps, 3/8-16 Thd.	51	55021	Trim, Strip Black
17	309657	Footsole	52	0864	Bulkhead
18	995343	Screw, Tap, 1/4-20 x 1/2 In.	53	120226	Screw, 5/16-18 x 5/8 In.
19	58246	Shoulder Bolt, 5/8 In.	54	1498	Nut, Hex Centerlock, 5/16-18 Thd.
20	1500	Nut, Hex Centerlock, 1/2-13 Thd.	55	55539	Foam
21	122207	Screw, Hex, 3/8-16 x 3 In.	56	35497	Screw, Tap, 5/16-18 Thd.
22	2483	Washer, Belvil	57	1502	Nut, Hex Centerlock, 1/4-20 Thd.
23	1499	Nut, Hex Centerlock, 3/8-16 Thd.	58	310479	Lanyard
24	302657	* Dashboard	59	310801	Anchor
25	995338	Screw, Tap, 1/4-20 x 5/8 In.	60	180018	Screw, Hex, 1/4-20 x 5/8 In.
26	50352	Nut, Wide Flange Lock, 1/4-20 Thd.	61	121222	Cotter Pin
27	995346	Screw, Tap, 1/4-20 x 1/2 In.	62	121223	Cotter Pin
28		* Hood	63	138077	Clavis Pin
29	305738	Bumper	64	120380	Split Lockwasher, 17/64 In.
30	308492	Foil, Lens Reflector	65	301452	Reflector, Foil
31	302670	Lens	66	307661	Seat
32	41482	Press Wire Clip	67	120393	Flatwasher, 11/32 In.
33	57366	Screw, Drillite No. 10-18 x 1/2 In.	68	120638	Split Lockwasher, 21/64 In.
34	56676	Shoulder Bolt, 5/16-18 Thd.	69	122007	Screw, 5/16-18 x 3/4 In.
35	1498	Nut, Hex Centerlock, 5/16-18 Thd.	70	312418	Operator's Manual (not illustrated)
			71	310808	Parts Manual (not illustrated)

* Raw part number. For a list of Painted part numbers refer to chart on decal page.
BOLD descriptions on parts page apply to box items and/or parts bag items.

39" RIDING MOWER MODEL A3560-180

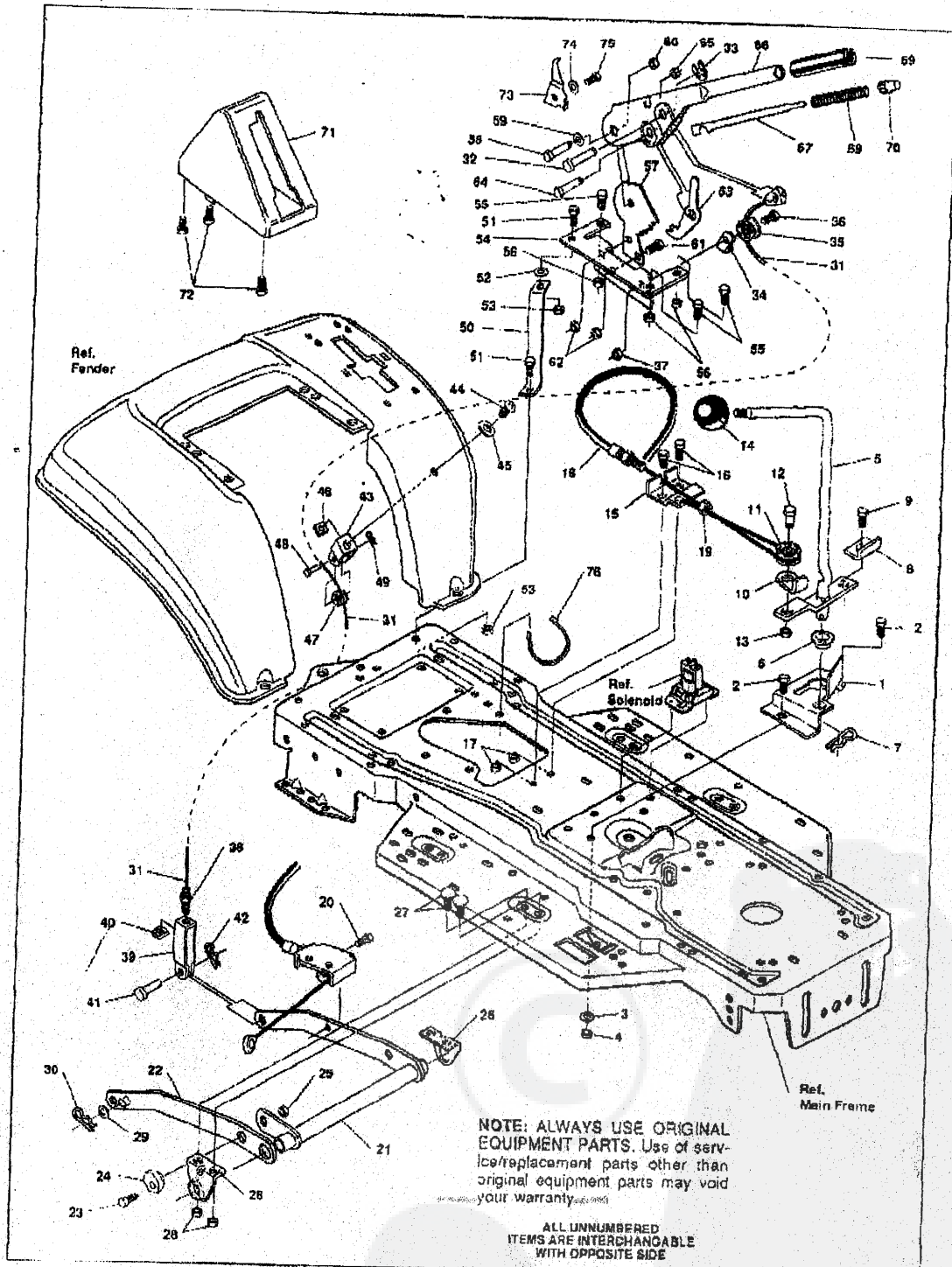

39" RIDING MOWER MODEL A3560-180

Key No.	Part No.	Description	Key No.	Part No.	Description
1	9402	Bracket, Clutch Eng. Lever	40	120372	Nut, Square, 1/4-20 Thd.
2	180079	Screw, 5/16-18 x 1 In.	41	39522	Pin, Clevis
3	120393	Washer, Flat, 11/32 In.	42	121222	Pin, Cotter
4	1498	Locknut, 5/16-18 Thd.	43	9239	Clevis
5	304791	Assy., Clutch Lever	44	439455	Screw, 5/16-18 x 1/2 In.
6	50148	Bearing, Flange	45	301551	Washer
7	8280	Pin, Hair	46	120373	Nut, Square, 5/16-18 Thd.
8	300699	Bracket, Switch Engage	47	39298	Pulley, Nylon
9	35498	Screw, Tap, 5/16-18 x 3/4 In.	48	300317	Pin, Clevis
10	1288	Bracket, Cable Retainer	49	8280	Pin, Hair
11	39298	Pulley, Nylon	50	300336	*Brace, Fender
12	58336	Shoulder Bolt, 3/8 In.	51	180079	Screw, 5/16-18 x 1 Thd.
13	1502	Locknut, 1/4-20 Thd.	52	45602	Washer, Flat
14	55514	Shift Knob	53	1498	Locknut, 5/16-18 x 3/4 In.
15	9397	Bracket, Frame Cable	54	58333	Bracket, Height Adjustment Support
16	180020	Screw, 1/4-20 x 3/4 In.	55	180077	Screw, 5/16-18 x 3/4 In.
17	1502	Locknut, 1/4-20 Thd.	56	1498	Locknut, 5/16-18 x 3/4 In.
18	301503	Assy., Blade Engage	57	301238	Quadrant, Height Adjustment
19	120613	Nut, Jam 1/4-28 Thd.	58	300171	Shoulder Bolt, 5/16-18 Thd.
20	35498	Screw, Tap, 5/16-18 x 3/4 In.	59	996418	Washer, Flat 1/2 In.
21	9185	Assy., Rear Lift	60	44108	Locknut, Wide Flange, 5/16-18 Thd.
22	9186	Assy., Link Right Side	61	180077	Screw, 5/16-18 x 3/4 In.
23	180079	Screw, 5/16-18 x 1 In.	62	1498	Locknut, 5/16-18 Thd.
24	58247	Nut, Adjusting	63	301239	Pawl, Height Adjustment
25	1498	Locknut, 5/16-18 Thd.	64	300171	Shoulder Bolt, 5/16-18 Thd.
26	9117	Bracket, Rear Hanging Suspension	65	44108	Locknut, Wide Flange, 5/16-18 Thd.
27	126211	Bolt, Carriage 5/16-18 x 5/8 In.	66	9788	Handle, Lift Short
28	1498	Locknut, 5/16-18 Thd.	67	303027	Rod, Actuator-Short
29	120396	Washer, Flat, 1/2 In.	68	59326	Spring, Height Adjustment
30	8260	Pin, Hair	69	68329	Grip
31	300341	Cable Deck Lift	70	59325	Knob, Height Adjustment Push Button
32	300310	Pin, Clevis	71	300335	Lift Cover
33	300311	E Ring, Retainer	72	300340	Screw, No. 10 x 3/4 In.
34	9149	Bracket, Cable Retainer	73	9495	Pointer
35	39298	Pulley, Nylon	74	138479	External Lockwasher
36	58336	Shoulder Bolt, 1/4-20 Thd.	75	35287	Screw, Tap, No. 8-32 x 3/8 In.
37	1502	Locknut, 1/4-20 Thd.	76	57444	Tie, Cable
38	120375	Nut, Hex, 1/4-20 Thd.			
39	9405	Clevis, Lift Cable			

* Raw part number. For a list of Painted part numbers refer to chart on decal page.

39" RIDING MOWER MODEL A3560-180

NOTE: ALWAYS USE ORIGINAL EQUIPMENT PARTS. Use of service/replacement parts other than original equipment parts may void your warranty.

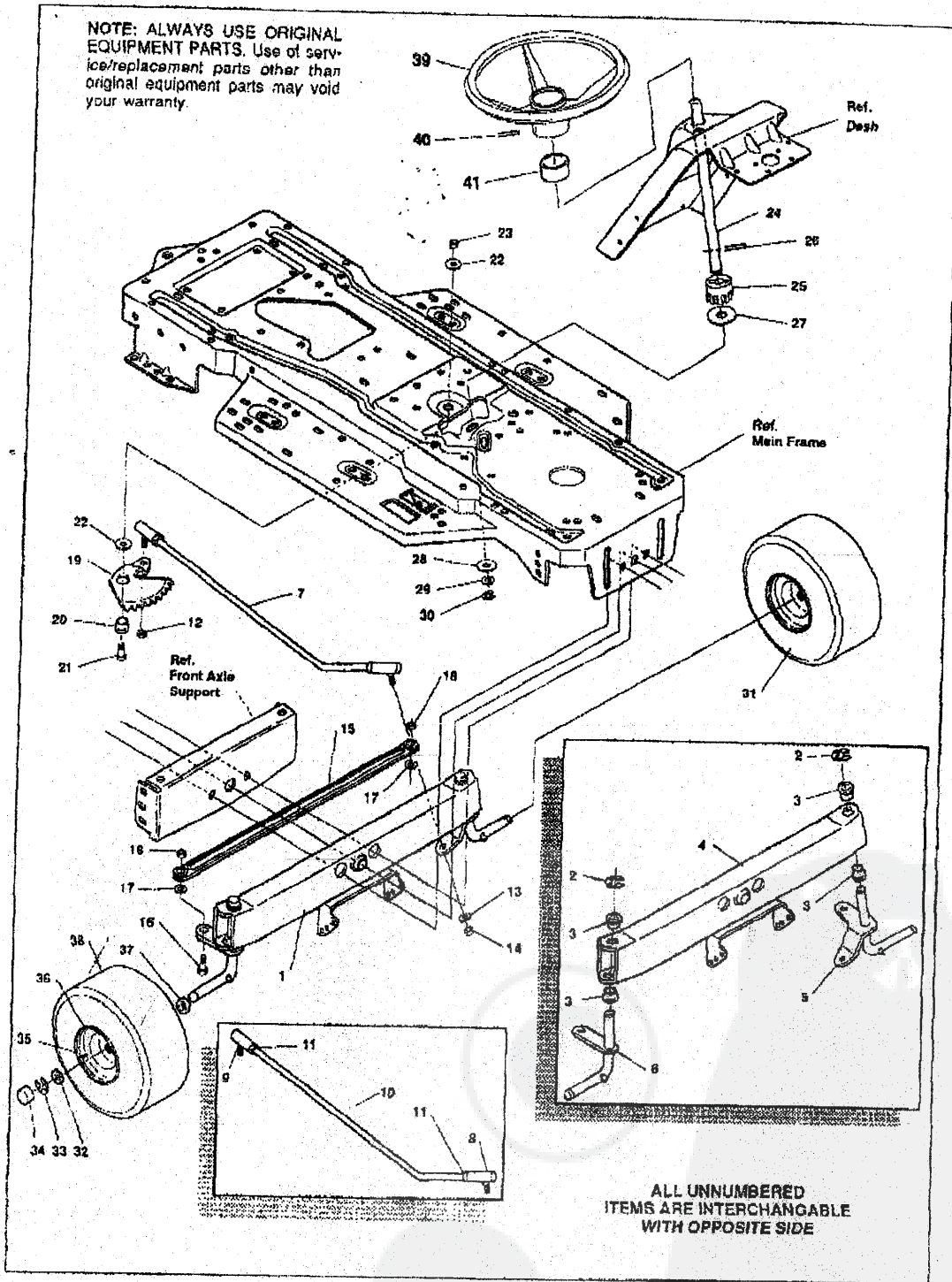

39" RIDING MOWER MODEL A3560-180

Key No.	Part No.	Description	Key No.	Part No.	Description
1	302927	* Front Axle Assy., Suspended	22	22265	Flatwasher
2	36625	Retaining Ring	23	1500	Nut, Hex Centerlock, 1/2-13 Thd.
3	52407	Spindle Bearing	24	56243	Shaft, Steering
4	300272	Front Axle Assy., Suspended	25	58244	Pinion, Steering
5	302925	Spindle Assy., L.H.	26	58274	Pin, Dowel
6	302926	Spindle Assy., R.H.	27	301410	Flanged Bearing, 3/4 In.
7	300146	Draglink Assy.	28	301398	Formed Washer
8	21275	Ball Joint	29	21682	Flatwasher
9	57158	Ball Joint	30	36625	Retaining Ring
10	58291	Steering Link	31	302828	Tire and Rim
11	124925	Nut, Hex, Jam, 3/8-24 Thd.	32	842	Flatwasher, 3/4 In.
12	46692	Locknut, Wide Flange, 3/8-24 Thd.	33	36625	Retaining Ring
13	120382	Split Lockwasher, 25/64 In.	34	40394	Hub Cap
14	120389	Nut, Hex 3/8-24 Thd.	35	24167	Valve Stem
15	304590	Tie Rod Assy.	36	39829	Wheel
16	180128	Screw, 3/8-16 x 1-3/4 In.	37	39979	Bearing
17	120382	Split Lockwasher, 25/64 In.	38	301140	Tire
18	1499	Nut, Hex Centerlock, 3/8-16 Thd.	39	301251	Steering Wheel
19	56269	Sector, Steering	40	456378	Pin, Spring
20	52406	Flanged Bearing, 1/2 In.	41	57212	Cover, Steering Shaft
21	180177	Screw, 1/2-13 x 1-1/2 In.			

* Raw part number. For a list of Painted part numbers refer to chart on decal page.
BOLD descriptions on parts page apply to box items and/or parts bag items.

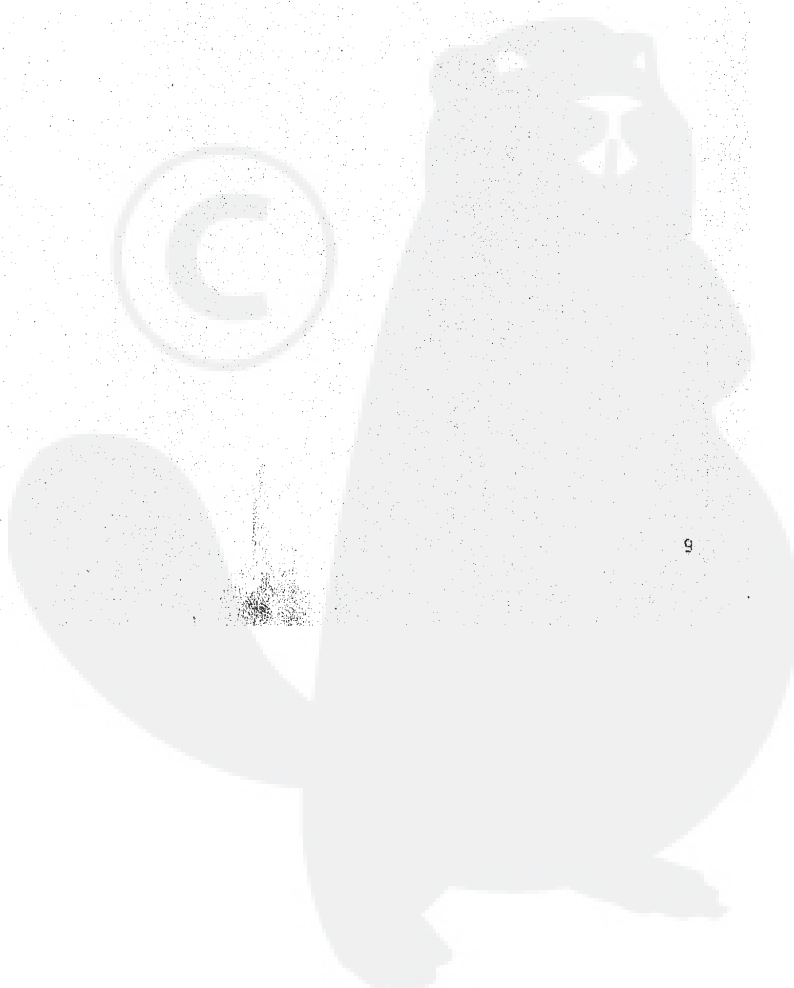

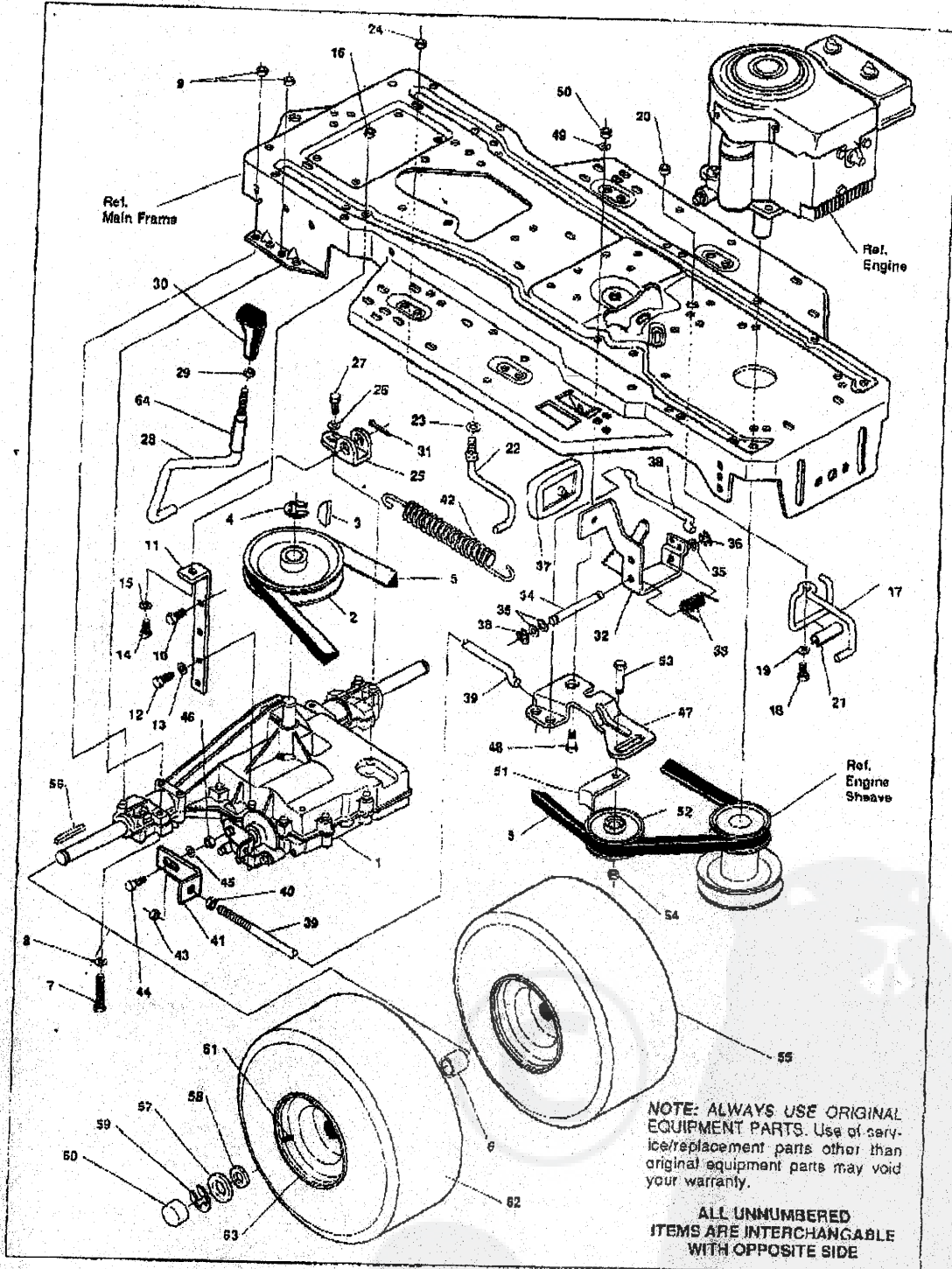

39" RIDING MOWER MODEL A3560-180

Key No.	Part No.	Description	Key No.	Part No.	Description
1	302971	Transaxle	33	57847	Spring, Brake Pedal
2	302745	Pulley	34	57196	Rod, Pivot
3	3021	Key, Woodruff No. 606	35	2988	Flatwasher, 1/2 In.
4	22053	Ring, Retaining	36	20864	Retaining Ring
5	57214	Belt	37	52785	Pad, Clutch Brake
6	57479	Spacer	38	57204	Rod, Clutch
7	180112	Screw, 5/16-18 x 2-3/4 In.	39	57203	Rod, Brake
8	120393	Flatwasher, 1 1/32 In.	40	271184	Nut, Hex Keps, 5/16-18 Thd.
9	1498	Nut, Hex Centerlock, 5/16-18 Thd.	41	57217	Bracket, Brake Rod
10	50947	Screw, Tap, 3/8-16 x 1-1/4 In.	42	56359	Spring, Clutch
11	12832	Stabilizer Bracket	43	1498	Nut, Hex Centerlock, 5/16-18 Thd.
12	35498	Screw, Tap, 5/16-18 x 3/4 In.	44	20507	Shoulder Bolt, 5/16-18 Thd.
13	120638	Nut, Hex, 5/16-24 Thd.	45	45602	Flatwasher, 21/64 In.
14	122017	Screw, 5/16-18 x 1 In.	46	1498	Nut, Hex Centerlock, 5/16-18 Thd.
15	120393	Flatwasher, 1 1/32 In.	47	300154	Idler Arm
16	1498	Nut, Hex Centerlock, 5/16-18 Thd.	48	300793	Shoulder Bolt, 5/16-18 Thd.
17	58356	Guide-Belt, Draglink	49	45602	Flatwasher, 21/64 In.
18	180079	Screw, 5/16-18 x 1 In.	50	1498	Nut, Hex Centerlock, 5/16-18 Thd.
19	45602	Flatwasher, 21/64 In.	51	39659	Retainer, Strap Belt
20	1498	Nut, Hex Centerlock, 5/16-18 Thd.	52	303031	Pulley, Idler
21	303278	Plastic Extrusion, Belt Guide	53	45892	Carriage Bolt, 3/8-16 x 1-1/2 In.
22	57259	Belt Guide, 5/16-18 Thd.	54	1498	Nut, Hex Centerlock, 3/8-18 Thd.
23	138638	Washer, Internal Lock, 5/16 In.	55	57166	Wheel & Tire Assy.
24	1498	Nut, Hex Centerlock, 5/16-18 Thd.	56	39628	Key, Square
25	57480	Shift Bracket	57	642	Flatwasher, 3/4 In.
26	57157	Washer, 3/4 In.	58	42815	Flatwasher, 3/4 In.
27	56255	Screw, 1/4-28 x 3/4 In.	59	36625	Retaining Ring
28	302743	Shift Lever	60	40394	Hub Cap
29	120238	Nut, Hex Jam, 1/2-13 Thd.	61	24187	Valve Stem
30	304438	Knob, Shift Lever	62	57164	Tire
31	137185	Cotter Pin	63	57165	Wheel
32	300308	Pedal Assy., Brake-Clutch	64	302445	Clear Plastic Tube

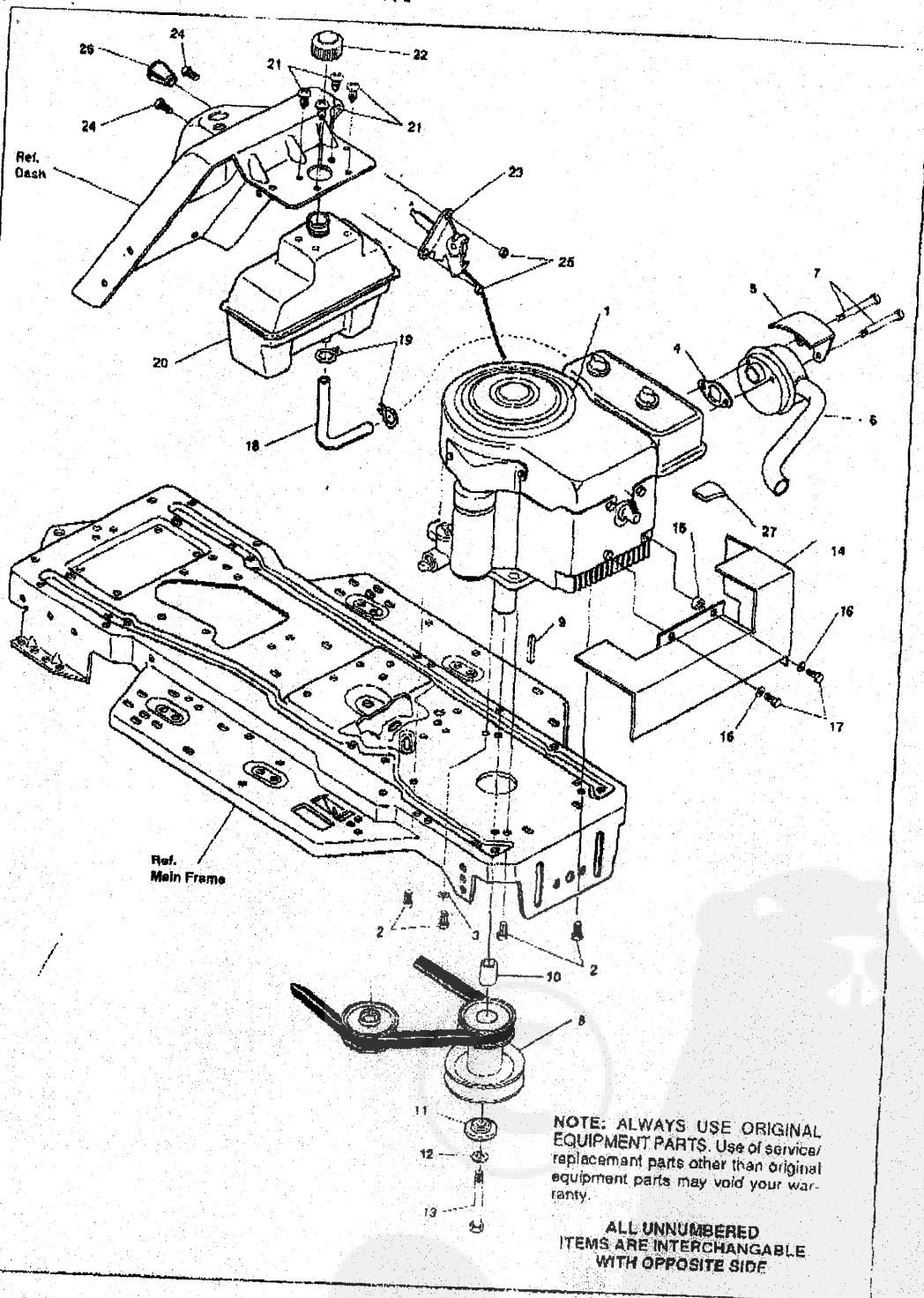

39" RIDING MOWER MODEL A3560-180

Key No.	Part No.	Description	Key No.	Part No.	Description
1	309710	Engine	15	41462	Spacer
2	50947	Screw, Tap. 3/8-16 x 1-1/4 in.	16	120380	Split Lockwasher
3	136469	External Lockwasher, 3/8 in.	17	180021	Screw Hex, 1/4-20 x 7/8 in.
4	46708	Gasket	18	47452	Gas Line
5	54767	Heat Shield	19	41008	Clamp, Gas Line
6	305367	Muffler	20	302579	Fuel Tank
7	173063	Screw, 5/16-18 x 3-1/2 in	21	49050	Screw, Tap, 1/4-10 x 3/4 in
8	58361	Pulley Assy.	22	46704	Gas Cap
9	57791	Key, Square	23	56534	Throttle Control
10	304246	Spacer, Engine Pulley	24	35291	Screw, No. 10-24 x 1/2 in.
11	56431	Pilot Washer, 63/64 in.	25	271166	Nut, Hex Keps, No. 10-24
12	120388	Split Lockwasher, 29/64 in.	26	50607	Knob, Throttle Control
13	428644	Screw, 7/16-20 x 5 in.	27	302967	Speed Reducer
14	308544	Heat Shield Assy.			

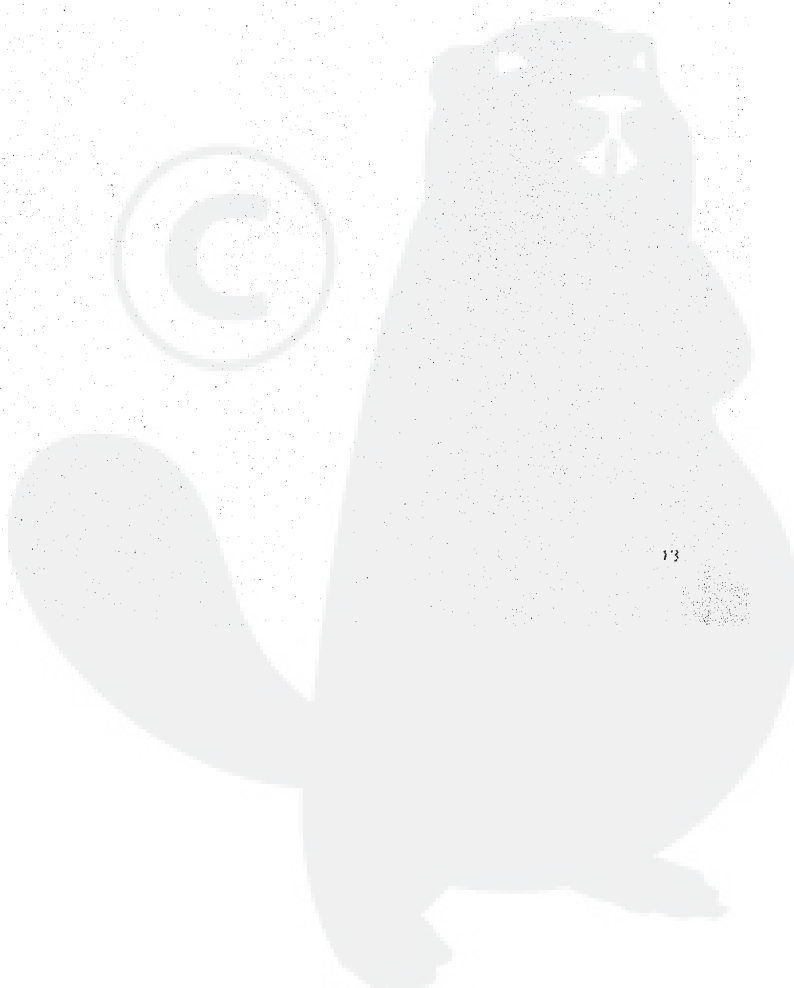

39" RIDING MOWER MODEL A3560-180

FEB 07'00 9:41 No.002 P.15

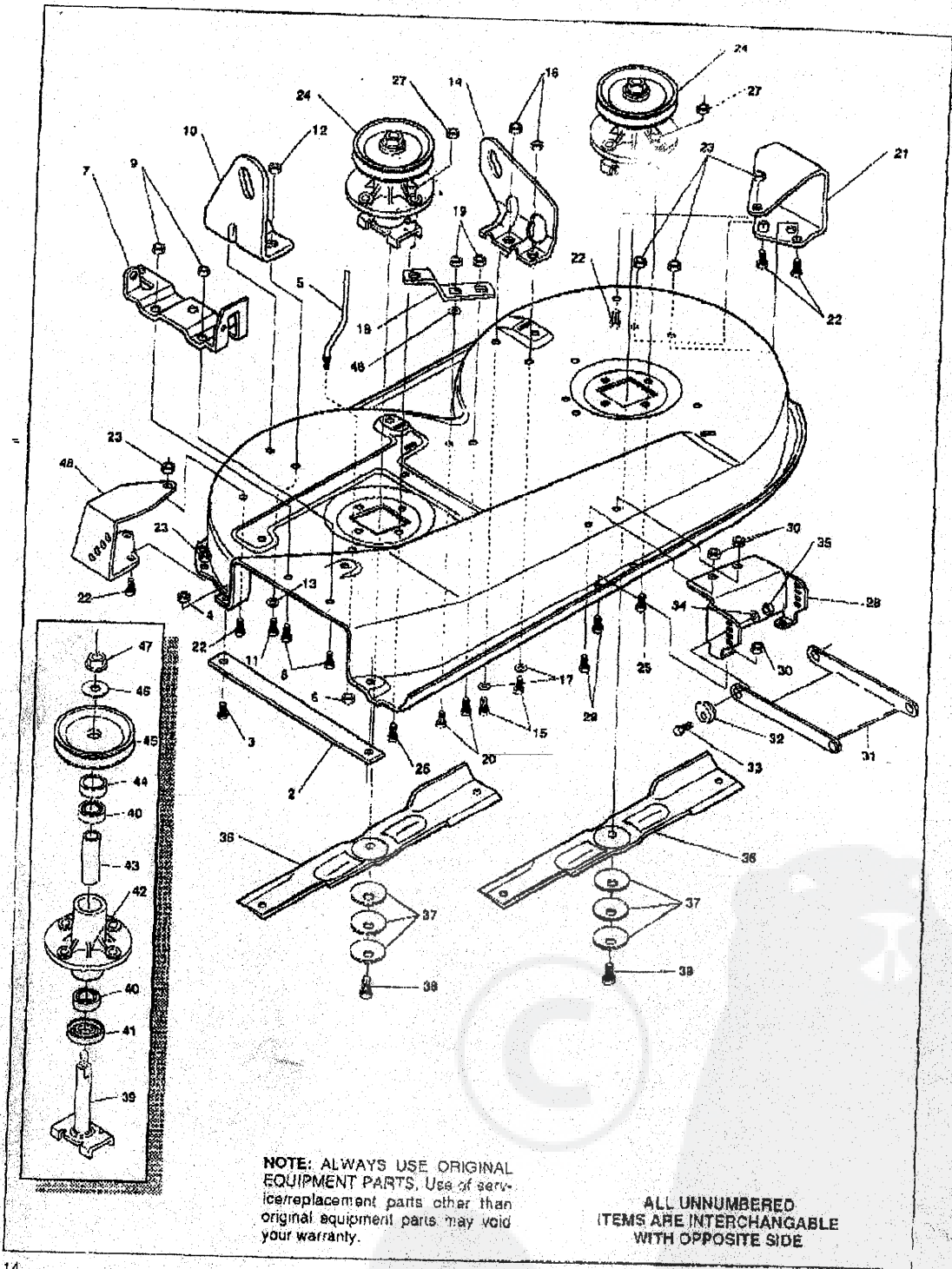

NOTE: ALWAYS USE ORIGINAL EQUIPMENT PARTS. Use of service/replacement parts other than original equipment parts may void your warranty.

ALL UNNUMBERED ITEMS ARE INTERCHANGABLE WITH OPPOSITE SIDE

39" RIDING MOWER MODEL A3560-180

Key No.	Part No.	Description	Key No.	Part No.	Description
1	302831	* Deck	26	300345	Screw, Tap, 5/16-18 x 1-3/8 In.
2	57314	Skid Bar	27	1498	Nut, Hex Centerlock, 5/16-18 Thd.
3	126216	Carriage Bolt, 5/16-18 x 3/4 In.	28	58315	Front Lift Support Bracket
4	271184	Nut, Hex Keps, 5/16-18 Thd.	29	180075	Screw, 5/16-18 x 1/2 In.
5	57318	Belt Guide, 5/16-18 Thd.	30	1498	Nut, Hex Centerlock, 5/16-18 Thd.
6	1498	Nut, Hex Centerlock, 5/16-18 Thd.	31	58305	Deck Link Bracket
7	57360	Chute Bracket	32	58247	Nut, Adjusting
8	120834	Screw, 5/16-18 x 1/2 In.	33	122017	Screw, 5/16-18 x 1 In.
9	1498	Nut, Hex Centerlock, 5/16-18 Thd.	34	35214	Flatwasher, 21/64 In.
10	58250	Bracket, Deck Lift, Right Rear	35	1498	Nut, Hex Centerlock, 5/16-18 Thd.
11	180077	Screw, 5/16-18 x 3/4 In.	36	57299	Blade
12	1498	Nut, Hex Centerlock, 5/16-18 Thd.	37	2483	Washer, Belvil
13	120393	Flatwasher, 11/32 In.	38	39573	Screw, 3/8-24 x 1 In.
14	58251	Bracket, Deck Lift, Left Rear	39	56425	Saddle & Shaft Assy.
15	180077	Screw, 5/16-18 x 3/4 In.	40	49562	Ball Bearing
16	1498	Nut, Hex Centerlock, 5/16-18 Thd.	41	50616	Dust Shield
17	120393	Flatwasher, 11/32 In.	42	55547	Quill Casting
18	300179	Bracket, Idler Support	43	50818	Spacer
19	44108	Whiz Locknut, 5/16-18 Thd.	44	51449	Spacer
20	180077	Screw, 5/16-18 x 3/4 In.	45	56390	Pulley
21	300103	Bracket, Wheel L.H.	46	56365	Special Washer
22	180075	Screw, 5/16-18 x 1/2 In.	47	1282	Nut, Wide Flange Lock, 7/16-20 Thd.
23	1498	Nut, Hex Centerlock, 5/16-18 Thd.	48	120393	Flatwasher, 11/32 In.
24	58424	Quill Assy.	49	300102	Bracket, Wheel R.H.
25	50634	Screw, Tap, 5/16-18 x 7/8 In.			

* Raw part number. For a list of Painted part numbers refer to chart on decal page.

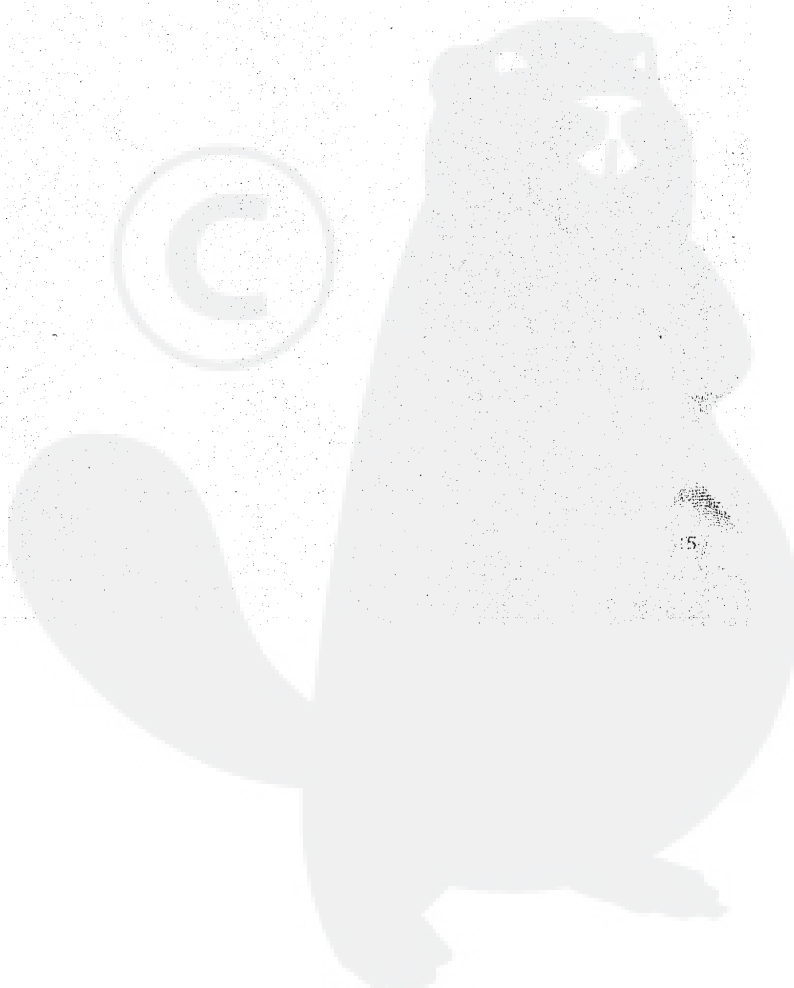

307301 - DECK ASSY. PRE-PAINT

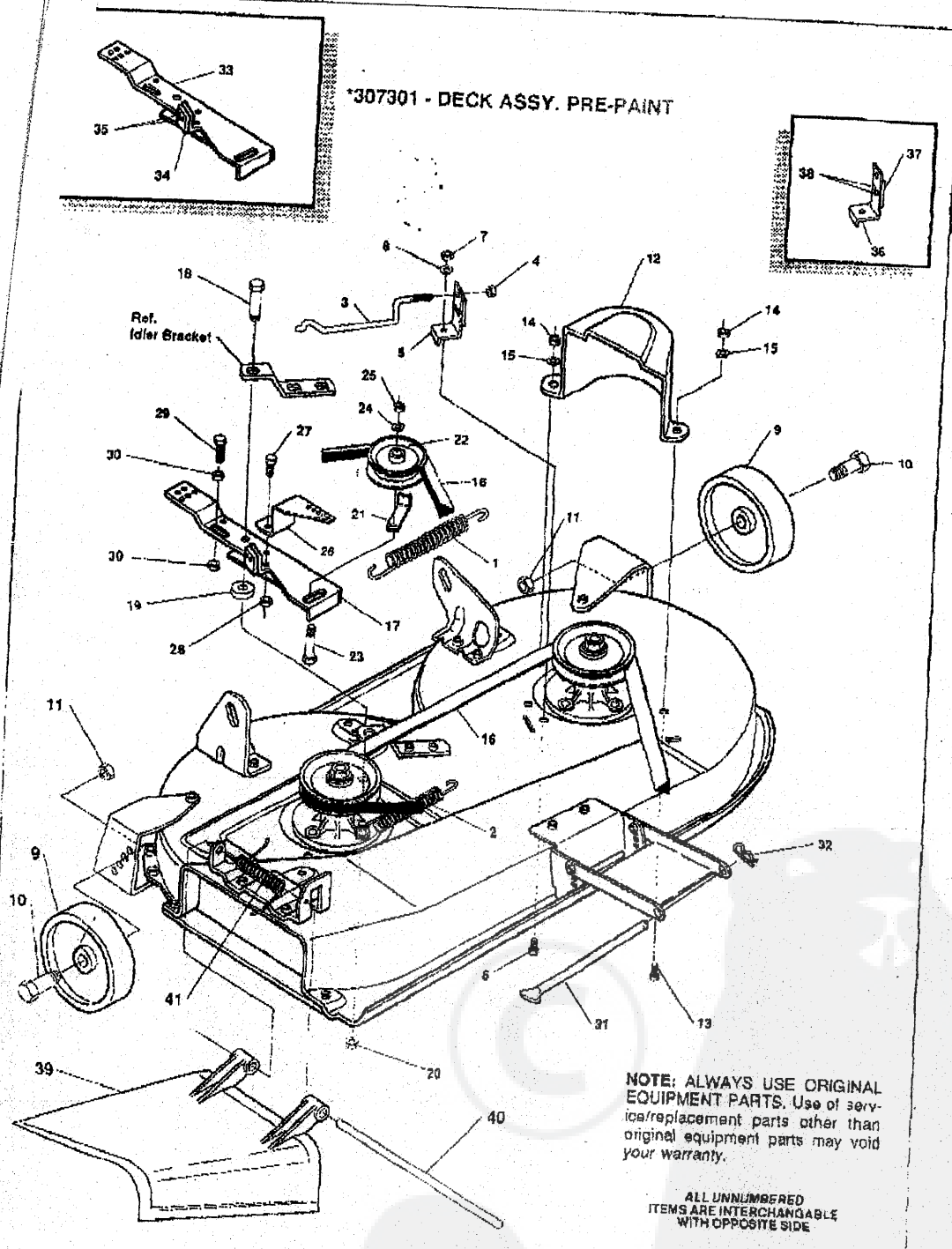

39" RIDING MOWER MODEL A3560-180

Key No.	Part No.	Description	Key No.	Part No.	Description
1	300473	Spring, Tension	22	303030	Idler Pulley
2	35410	Spring	23	57325	Bolt, 3/8-16 x 2 In.
3	300316	Rod, Brake Release	24	120382	Split Lockwasher, 25/64 In.
4	1502	Nut, Hex Centerlock, 1/4-20 Thd.	25	120377	Nut, Hex 3/8-16 Thd.
5	303247	Blade Brake Assy.	26	9401	Idler Arm Extension Bracket
6	120228	Screw, 5/16-18 x 5/8 In.	27	180077	Screw, 5/16-18 x 3/4 In.
7	1498	Nut, Hex Centerlock, 5/16-18 Thd.	28	1498	Nut, Hex Centerlock, 5/16-18 Thd.
8	120393	Flatwasher, 11/32 In.	29	121954	Screw, 1/4-20 x 2 In.
9	52584	Deck Wheel	30	271172	Nut, Hex Keps, 1/4-20 Thd.
10	23763	Shoulder Bolt, 3/8-16 Thd.	31	58306	Rod, Deck Hitch
11	1499	Nut, Hex Centerlock, 3/8-16 Thd.	32	8260	Hair Pin
12	302833	Belt Guard, Plastic	33	9282	Idler Arm
13	120228	Screw, 5/16-18 x 5/8 In.	34	306973	Brake Pad
14	1498	Nut, Hex Centerlock, 5/16-18 Thd.	35	41801	Rivet
15	120393	Flatwasher, 11/32 In.	36	12542	Brake Arm
16	300680	V-Belt	37	306973	Brake Pad
17	300491	Bracket, Idler Arm Brake Assy.	38	135624	Rivet
18	300180	Shoulder Bolt	39	57818	Chute Deflector
19	998418	Flatwasher, 25/64 In.	40	57317	Pin
20	45171	Whiz Locknut, 3/8-16 Thd.	41	55767	Spring
21	1346	Belt Retainer			

BOLD descriptions on parts page apply to box items and/or parts bag items.

39" RIDING MOWER MODEL A3560-180

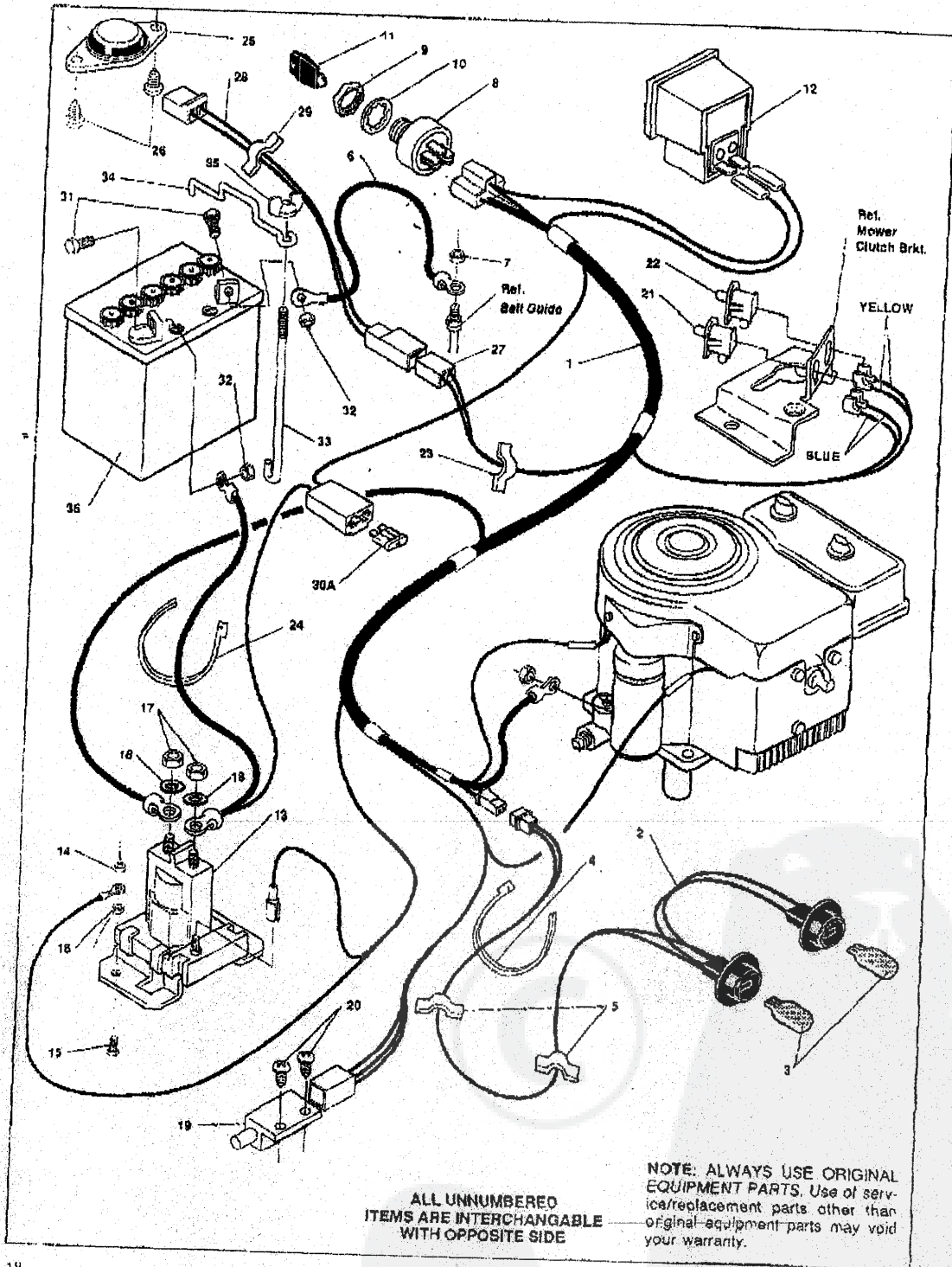

39" RIDING MOWER MODEL A3560-180

Key No.	Part No.	Description	Key No.	Part No.	Description
1	300814	Deck Wire Harness	20	57220	Screw, No. 12 x 1/2 in.
2	303064	Assy., Light Wire	21	300220	Safety Switch
3	52572	Bulb, Headlamp	22	58277	Switch
4	57444	Cable Tie	23	41482	Press Wire Clip
5	41482	Press Wire Clip	24	57444	Cable Tie
6	55511	Ground Wire	25	57547	Switch, Seat
7	1498	Nut, Hex Centerlock, 5/16-18 Thd.	26	160505	Screw, 1/4-20 x 3/8 in.
8	300667	Switch, Ignition & Lights	27	305511	Connector, Body
9	48140	Nut, Hex, 5/8-32 Thd.	28	305431	Wire Assembly, Pigtail
10	139557	Internal Lockwasher, 41/64 in.	29	41482	Press Wire Clip
11	300626	Key, Ignition Switch	30A	302031	** Fuse, 15 Amp Spade Type
12	300133	Ammeter	30B	49211	** Fuse, 15 Amp Cylindrical Type
13	53716	Solenoid	31	120854	Screw, 1/4-20 x 5/8 in.
14	271172	Nut, Hex Keps, 1/4-20 Thd.	32	271172	Nut, Hex Keps, 1/4-20 Thd.
15	187745	Screw, 1/4-20 x 3/4 in.	33	57551	Rod, Battery
16	1502	Nut, Hex Centerlock, 1/4-20 Thd.	34	57552	Rod, Battery Top
17	120368	Nut, Hex, 5/16-24 Thd.	35	310067	Wing Nut, 1/4-20 Thd.
18	138485	Washer, External Lock, 21/64 in.	36	302257	Battery
19	57211	Switch			

**Cylindrical or Spade type fuse included in wire assembly.
BOLD descriptions on parts page apply to box items and/or parts bag items.

39" RIDING MOWER MODEL A3560-180

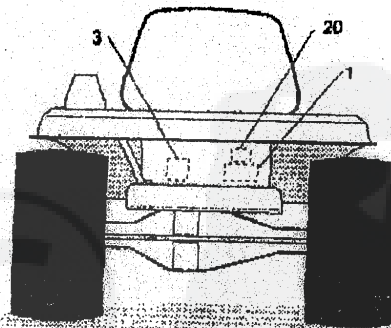
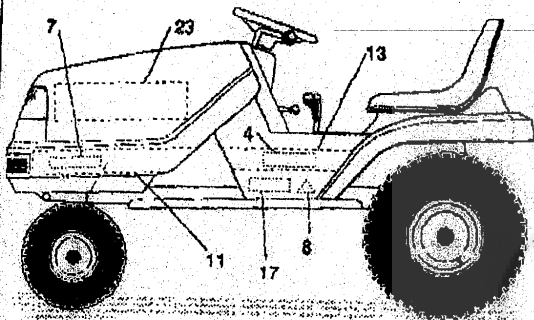
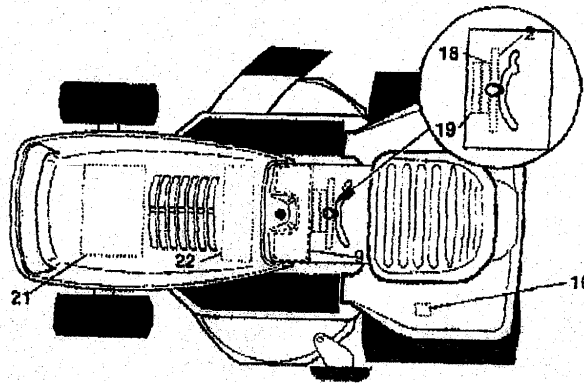
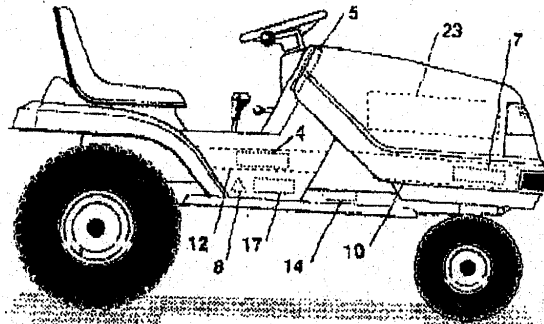
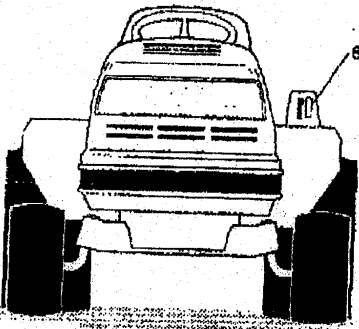

ALL UNNUMBERED
ITEMS ARE INTERCHANGABLE
WITH OPPOSITE SIDE

NOTE: ALWAYS USE ORIGINAL
EQUIPMENT PARTS. Use of service/replacement parts other than
original equipment parts may void
your warranty.

39" RIDING MOWER MODEL A3560-180

Decal List

Key No.	Part No.	Description	Key No.	Part No.	Description
1	311308	Decal, Model Plate	14	67667	Decal, Check Oil Level
2	301104	Decal, Console Top Shift 5 Speed	15	69900	Decal, Blade Engage
3	300636	Decal, Export	16	68901	Decal, Blade Height Adjustment
4	300442	Nameplate 12/39	17	68902	Decal, Warning, French/German
5	311400	Decal, Anti-Mar	18	69524	Decal, Instruction Console Top German
6	301897	Decal, Lift	19	69525	Decal, Instruction Console Top French
7	305317	Nameplate, Hood Flandria	20	310436	Decal, Fire Safety Certification
8	305770	Decal, Caution Triangle	21	307276	Foam
9	307038	Decal, Dash	22	307277	Foam
10	311856	Decal, Hood H14 RH Red LF	23	305603	Foam
11	311857	Decal, Hood H14 LH Red LF			
12	311862	Decal, Console LF RH Blue			
13	311861	Decal, Console LF LH Blue			

Painted Parts List

Unpainted Part No.	Description	Painted Part No.
310832	Main Frame	310837
309657	Console	310446
302657	Dash	304880
	Hood	311119
58367	Seat Plate	304761
58334	Fender	304758
310860	Seat Support Bracket	310444
300336	Fender Brace	304766
302927	Front Axle Assembly	9786

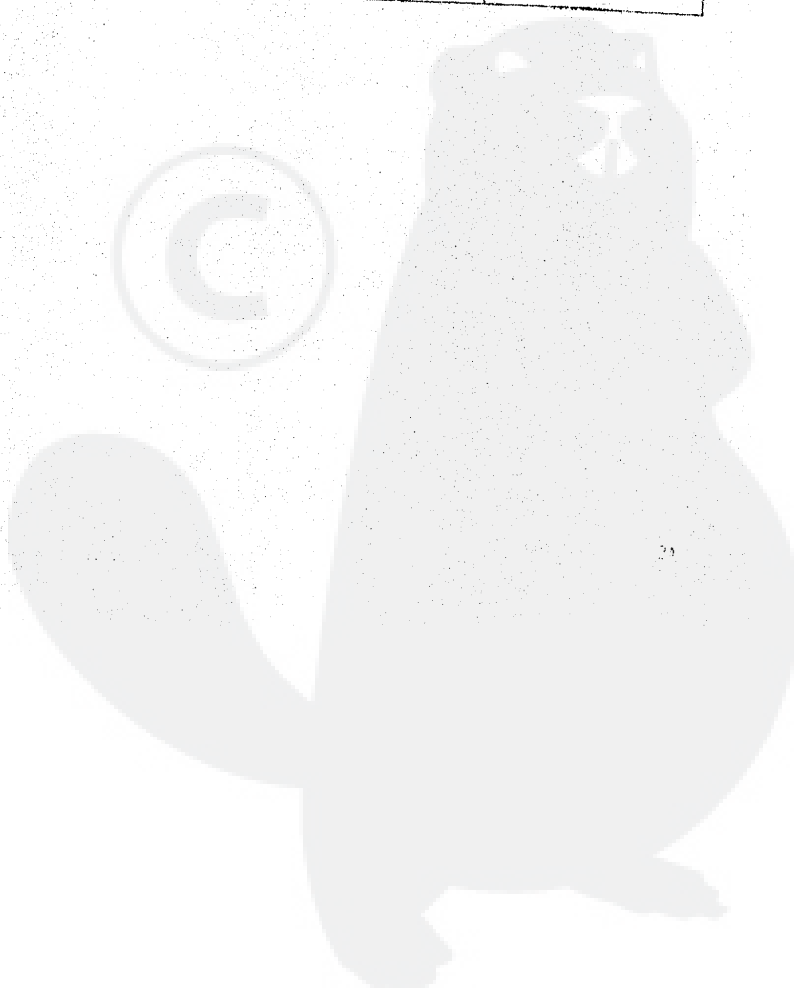

ACCESSORIES

Contact the dealer where your tractor was purchased for the available accessories. If you are unable to contact the dealer, write to the address on the front cover of this manual.

Rear Engine Rider

Model	Description
5708-16	Bagger - Fits 32" Side Discharge
5708-17	Bagger - Fits 36" Side Discharge
5709-02	Front Weight Box - holds 35 lbs.
5648-16	Lawn Sweeper w/dump Release

Lawn Tractor

Model	Description
5708-22	Bagger - Fits 30" Side Discharge
5708-13	Bagger - Fits 36", 38", 39" & 45" Side Discharge
5705-04	36" Two-Stage Snowblower - Fits 36", 38", 39", & 45" Side Discharge
5661-06	42" Snowblade - Fits 36", 38", 39", & 45"
5592-00	Tire Chains - 18" x 6.50"
5585-00	Tire Chains - 18" x 9.50" & 20" x 8"
5672-01	Wheel Weights - Front - 1 pr. w/mtg. hdw. - Fits 15" tires
5673-02	Wheel Weights - Rear - 1 pr. w/mtg. hdw. - Fits 18" & 20" tires
5709-03	Front Weights - Fits 30" & 32" Side Discharge
5648-16	Lawn Sweeper w/dump Release

Garden Tractor - Light Ground Engaging

Model	Description
5708-13	Bagger - Fits 36", 38", 39", & 45" Side Discharge
5705-04	36" Two-Stage Snowblower - Fits 36", 38", 39", & 45"
5661-06	42" Snowblade - Fits 36", 38", 39", & 45"
5672-01	Wheel Weights - Front 1 pr. w/mtg. hdw. - Fits 15" tires
5673-02	Wheel Weights - Rear - 1 pr. w/mtg. hdw. - Fits 18" & 20" tires
5648-16	Lawn Sweeper w/dump Release
5687-02	Sleeve Hitch - w/lift bar - Fits 45"
5688-01	Adaptor (sleeve hitch) for use w/23" tires
5706-00	Tire Chains - 20" x 10"
5671-00	Tire Chains - 23" x 9.50"
5672-02	Wheel Weights - Front - 1 pr. w/mtg. hdw. Fits 16" tires
5673-00	Wheel Weights - Rear - 1 pr. w/mtg. hdw. Fits 23" tires
5674-01*	10" One Bottom Moldboard Plow
5675-01*	Cultivator - 7 row - Adj. 6" - 42" width
5676-01*	Disc Harrow - 8" & 11" disc - Adj. width & disc angle
5677-02*	Tiller - 5 H.P. Self-Powered - 28" width

Four Wheel Steer

Model	Description
5708-14	Bagger - Fits 40" & 48" Side Discharge
5705-05	42" One-Stage Snowblower - Fits 40" & 48"
5661-07	48" Snowblade - Fits 40" & 48"
5709-04	Rear Weight Box for 40" & 46"
5648-16	Lawn Sweeper w/dump Release
5706-00	Tire Chains - 20" x 10"
5671-00	Tire Chains - 23" x 9.50"
5672-02	Wheel Weights - Front - 1 pr. w/mtg. hdw. Fits 16" tires
5673-00	Wheel Weights - Rear - 1 pr. w/mtg. hdw. Fits 23" tires
5672-01	Wheel Weights - Front - 1 pr. w/mtg. hdw. Fits 16" tires
5673-02	Wheel Weights - Rear - 1 pr. w/mtg. hdw. Fits 18" & 20" tires

Four Wheel Steer Garden Tractor

Model	Description
5667-04	Sleeve Hitch - w/lift bar Fits 46"
5674-01*	10" One Bottom Moldboard Plow
5675-01*	Cultivator - 7 row - Adj. 6" - 42" width
5676-01*	Disc Harrow 8" & 11" Disc. Adj. width & disc angle
5677-02*	Tiller 5 H.P. Self-Powered - 28" width
5648-16	Lawn Sweeper w/dump Release

*Requires a sleeve hitch