

REPAIR PARTS MANUAL
18 H.P. LAWN TRACTOR
With 45" Mower Deck
MODEL A3583-130

ONE YEAR LIMITED WARRANTY

For one (1) year from date of purchase by the first consumer for residential use (thirty (30) days commercial use), NOMA Outdoor Products Incorporated warrants that it will replace free of charge, including labor, any original part of any NOMA Outdoor Products Incorporated product found to be defective by any authorized Service Dealer or the factory, except the battery which is warranted for ninety (90) days from date of purchase.

This warranty does not cover engine, transmission, transaxle or differential (these items are covered by their manufacturer's own warranty). This warranty does not cover parts that have failed due to normal wear or parts that have failed subject to misuse or abuse. Transportation of the unit or part to and from an authorized Service Dealer or factory is the responsibility of the owner.

A step by step explanation as to what procedure should be followed for this Warranty is:

1. If a part becomes defective, contact the store where the unit was purchased for the name and address of the authorized Service Dealer nearest to you.
2. If you cannot locate an authorized Service Dealer, write Service Department of NOMA Outdoor Products Incorporated for the name and address of the authorized Service Dealer in your area or call the Service Department at 1-901-422-1690.
3. Return the defective product, along with proof of purchase to such authorized Service Dealer for replacement of any defective part where covered by this warranty.

There is no other express warranty. Implied warranties, including those of merchantability and fitness for a particular purpose are limited to one (1) year from date of purchase. Liability for incidental or consequential damages are excluded.

Some states do not allow limitations on how long an implied warranty lasts, so the above limitation may not apply to you. Some states do not allow the exclusion of incidental or consequential damages, so the above exclusion may not apply to you. This warranty gives you specific legal rights, and you may have other rights which vary from state to state.

NOMA Outdoor Products Incorporated Caller 8000 Jackson, TN 38308-8000

UNIT PARTS AND SERVICE

This manual contains instructions for safety, assembly and maintenance. Read this manual carefully and completely so that you will know proper assembly, use and care of your unit. Also fill in and mail the registration card packed with the unit. For service other than covered in this manual, contact an authorized service dealer. A nationwide parts and service organization has been established to provide locally available parts and service. A list of authorized parts distributors has been included in this manual. When ordering repair parts, always give the following information: 1. The Part Name; 2. The Part Number; 3. The Quantity desired; 4. The Full (eight digit) Model Number of the unit. The model number will be found on a plate attached to the unit.



Look for this symbol. It means - ATTENTION! BECOME ALERT! A HAZARD TO OPERATOR, BYSTANDER, PROPERTY OR EQUIPMENT MAY EXIST.

NOMA Outdoor Products Incorporated
Caller 8000
Jackson, TN 38308-8000

Part No.311402 /S

4589

Price \$2.00

Printed in U.S.A.



OPERATIONAL PRECAUTIONS



THESE INSTRUCTIONS ARE FOR YOUR PROTECTION. PLEASE READ THEM CAREFULLY.

1. Know the controls and how to stop quickly. **READ THIS OPERATOR'S MANUAL** and instructions furnished with attachments.
2. Wear safety glasses or eye shields when assembling or operating riding mower.
3. Do not allow children to operate the machine. Do not allow adults to operate it without proper instruction.
4. Do not carry passengers. Do not mow when children and others are around. Disengage power to blades(s) or attachment(s) and stop the engine while others are in the vicinity of the mower.
5. Battery fluid (electrolyte) is an **ACID** and is extremely dangerous. Do not smoke while servicing the battery. Do not service the battery near a open flame or spark.
6. Handle gasoline with care, it is highly flammable.
 - A. Use approved gasoline container.
 - B. Never remove the fuel cap of, or add gasoline to, a running or hot engine, or an engine that has not been allowed to cool for several minutes after running. Never fill the tank indoors and always clean up spilled fuel immediately.
 - C. Do not smoke while filling fuel tank.
 - D. Do not run the engine indoors. Open doors if engine must be run in garage. Exhaust fumes contain **CARBON MONOXIDE, an ODORLESS and DEADLY GAS.**
7. Check fuel supply before each use allowing space for expansion as the heat of the engine and/ or sun can cause gasoline to expand.
8. Do not operate mower when barefooted. Always wear substantial footwear, preferably steel-toed shoes. Do not wear loose fitting clothing that could get caught in moving parts.
9. Clear the work area of objects (wire, rocks, etc.) which might be picked up and thrown. Check all controls for proper function.
10. Disengage all attachment clutches, shift to neutral, and set parking brake before attempting to start the engine (motor). When starting engine equipped with a pull starter, stand firm and make sure your feet are well away from the blade(s).
11. Disengage power to blade(s) or other attachments(s) and stop the engine (motor) before leaving the operator's position. Always dismount from the left side.
12. Disengage power to blade(s) or other attachment(s) and stop the engine (motor) before making any repairs or adjustments.
13. Disengage power to blade(s) or other attachment(s) when transporting or not in use.
14. Take all possible precautions when leaving the vehicle unattended, such as disengaging power to blade(s) or attachment(s), lower the attachment(s), setting the parking brake, stopping the engine (motor), and removing the key.
15. Do not stop or start suddenly when going uphill or downhill. Mow up and down the face of steep slopes; never across the face.
16. Reduce speed and exercise extreme caution on slopes and in sharp turns to prevent tipping or loss of control. Be especially cautious when changing direction on slopes.
17. Stay alert for holes, rocks, and roots in the terrain and other hidden hazards. Keep away from drop-off. Never operate your riding mower on wet or slippery grass or at a speed which could cause a skid. Exercise care when mowing around a fixed object to prevent the blade(s) from striking it. Never deliberately run over any foreign object.
18. Always disengage blade control lever before attempting to remove the mower from a hole or other obstruction.
19. Use care when pulling loads or using heavy equipment.
 - A. Use only approved drawbar hitch points.
 - B. Limit loads to those that you can safely control.
 - C. Do not turn sharply. Use care when backing.
 - D. Use counterweight(s), wheel weights or tire chains when suggested in attachment(s) instructions.
20. Watch for traffic when crossing or near roadways.
21. When using attachment(s), never direct discharge of material toward bystanders nor allow anyone near the vehicle while in operation.
22. Keep the vehicle and attachments in good operating condition, and keep safety devices in place and in working condition.
23. Keep all nuts, bolts, and screws tight to be sure the equipment is in safe working condition.
24. Never store the equipment with gasoline in the tank inside a building where fumes may reach an open flame or spark. Allow the engine to cool before storing in any enclosure.
25. To reduce fire hazard, keep the engine free of grass, leaves or excessive grease.
26. The vehicle and attachments should be stopped and inspected for damage after striking a foreign object, and the damage should be repaired before restarting and operating the equipment.
27. Do not change the engine governor settings or overspeed engine.
28. When using the vehicle with mower, proceed as follows:
 - A. Mow only in daylight or in good artificial light.
 - B. Never make a cutting height adjustment while the engine (motor) is running if the operator must dismount to do so.
 - C. Shut the engine (motor) off when removing the grass catcher or unclogging chute.
 - D. Check the blade mounting bolts for proper tightness at frequent intervals.
29. Under normal usage, the grass catcher bag material is subject to deterioration and wear. Check the bag frequently for deterioration and wear and replace worn bags. Check that replacement bags comply with the original manufacturer's recommendations or specifications.
30. Disengage power to mower before backing up. Do not mow in reverse unless absolutely necessary and then only after careful observation of the entire area behind the mower.

OWNER'S INFORMATION

Record the following information about your unit so that you will be able to provide it in case of loss or theft.

MODEL NUMBER: - (Enter complete 8 digit number from model plate on unit)

PURCHASE DATE: ___ / ___ / ___ CODE NO.: _____ SERIAL NO.: _____

DEALER'S NAME AND ADDRESS: _____

CITY: _____ STATE: _____ TELEPHONE: _____

CONTENTS OF SHIPPING CARTON

- 1 - Tractor (with 45 inch deck)
- 1 - Operator's Manual
- 1 - Repair Parts Manual
- 1 - Engine Manual
- 1 - Steering Wheel (with roll pin partially installed)
- 1 - Seat
- 1 - Battery
- 1 - Battery Acid Pack
- 1 - Bag of Assembly Parts Containing:
 - 1 - Oil Drain Trough
 - 1 - Battery Hold-Down Bracket
 - 1 - Battery Hold-Down Rod
 - 1 - Bag of Battery Hold-Down Parts Containing:
 - 1 - Plastic Wing Nut
- 1 - Bag of Battery Cable Installation Parts Containing:
 - 2 - $\frac{1}{4}$ - 20 x $\frac{5}{8}$ inch Hex Head Screws
 - 2 - $\frac{1}{4}$ inch Keps, Nuts (Star Washer attached)
- 1 - Bag of Seat Mounting Parts Containing:
 - 4 - $\frac{5}{16}$ - 18 x $\frac{3}{4}$ inch Hex Head Screws
 - 4 - $\frac{5}{16}$ inch Split Lockwashers
 - 4 - $\frac{1}{32}$ inch Flatwashers

TOOLS REQUIRED FOR ASSEMBLY

- 1 - $\frac{7}{16}$ inch Wrench (or adjustable wrench)
- 1 - $\frac{1}{2}$ inch Wrench (or adjustable wrench)
- 1 - Hammer

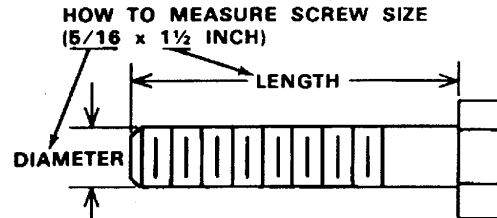

DANGER



This riding mower can be dangerous if carelessly used.

Read your Owner's Manual thoroughly before operating your riding mower.

Always wear safety glasses or eye shields while assembling or operating your riding mower.

DO NOT carry passengers at any time.

Keep your hands, feet, hair and loose clothing away from the discharge area, the underside of the mower deck or any moving parts while the engine is running.

DO NOT allow children or young teenagers to operate or be near your riding mower while it is operating.

NOTICE

For packaging purposes, the knob may have been removed from the mower clutch lever and placed in the parts bag. Please screw the knob onto the mower clutch lever and tighten it securely.

For packaging purposes, the battery may have been installed on your unit. The battery must be removed from your machine to be serviced. See the **Battery Removal** paragraph in your **Operator's Manual** for removal instructions.

Repair Parts

45" Lawn Tractor Model A3583-130

Note: Always use original equipment parts. Use of service/replacement parts other than the original equipment parts may void your warranty.

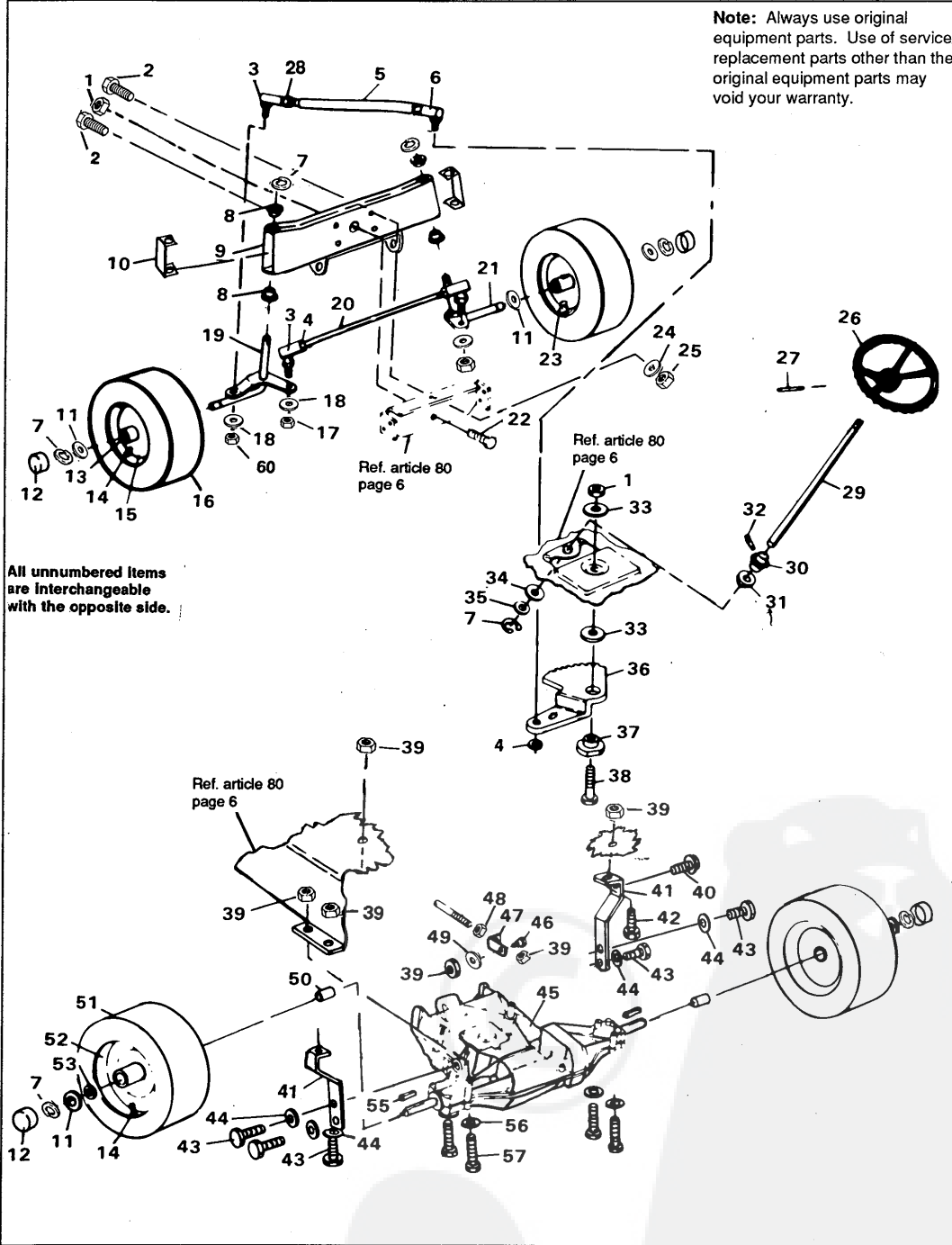

All unnumbered items are interchangeable with the opposite side.

Ref. article 80 page 6

Ref. article 80 page 6

Ref. article 80 page 6

Repair Parts

45" Lawn Tractor Model A3583-130

Always give the following information when ordering repair parts:

1. The **PART NUMBER**;
2. The **PART NAME**;
3. The **QUANTITY DESIRED**;
4. The **MODEL NUMBER** (As shown on Model Plate).

Send your part orders per the instructions on the front page.

To tell if a part is the left or right handed one, stand behind your mower.

Do not use the key numbers when ordering repair parts, **always use the part numbers.**

All replacement parts will be supplied in current production colors or in a neutral color.

A handling fee is applicable to small parts orders.

Key No.	Part No.	Description	Key No.	Part No.	Description
1	1500	Locknut, 1/2-13 Thd.	30	58244	Pinion
2	122207	* Screw, Hex Hd 3/8-16 x 3 In.	31	301410	Bushing
3	21275	Ball Joint	32	58274	Dowell Pin
4	46692	Nut, Hex Jam 3/8-24 Thd.	33	22265	Washer
5	302863	Drag Link	34	301398	Flatwasher
6	57158	Ball Joint	35	21682	Flatwasher, 3/4 In.
7	36625	"E" Ring	36	58289	Sector Gear
8	52407	Bearing, Front Spindle	37	52406	Eccentric, Steering Adjust
9	307338	Front Axle	38	180177	* Screw, Hex Hd 1/2-13 x 1-1/2 In.
10	53373	Cover, Axle End	39	1498	Locknut, Hex 5/16-18 Thd.
11	642	Flatwasher	40	50947	Screw, Wa Hex 3/8-16 x 1-1/4 In.
12	40394	Hub Cap	41	12632	Bracket, Stabilizer
13	49613	Bearing	42	122017	Screw, Hex Hd 5/16-18 x 1 In.
14	24167	Valve Stem	43	35498	Screw, Wa Hex Hd 5/16-18 x 3/4 In.
15	49401	Wheel, Front	44	120638	Washer, .328 x .60 x .11
16	57914	Tire, Front	45	Transaxle	^ Foote 4360-5 Speed
17	120369	* Nut, Hex 3/8-24 Thd.	46	20507	Bolt, 5/16-18
18	120382	* Lockwasher, Split 3/8-In.	47	57217	Bracket, Brake Rod
19	9781	Front Spindle Assembly, L.H.	48	271184	Nut, Hex Keps 5/16-18
20	300327	Tie Rod Assembly	49	45602	Washer, Flat .333 x .87 x .119
21	9180	Front Spindle Assembly, R.H.	50	57479	Spacer,
22	58246	Bolt, Front Axle Pivot	51	58276	Tire, Rear
23	706	Zerk, Grease 1/4-28 Thd	52	180112	Screw, Hex Hd Cap 5/16-18 x 2-3/4 In.
24	2483	Spring Washer	53	22053	Retaining Ring
25	1499	Locknut, 3/8-16 Thd.	54	301366	Tire, Rear
26	301251	Steering Wheel	55	39628	Square Key
27	456378	Roll Pin, 1/4-2 In.	56	120393	Washer
28	271506	Nut, Jam 7/16-20	57	308422	Operator's Manual (Not Illustrated)
29	58243	Shaft, Steering Wheel	58	311402	Parts Manual (Not Illustrated)

(*) Standard hardware items - may be purchased locally.

(^) Contact Tecumseh/Peerless authorized service dealer for parts and warranty.

Repair Parts

45" Lawn Tractor Model A3583-130

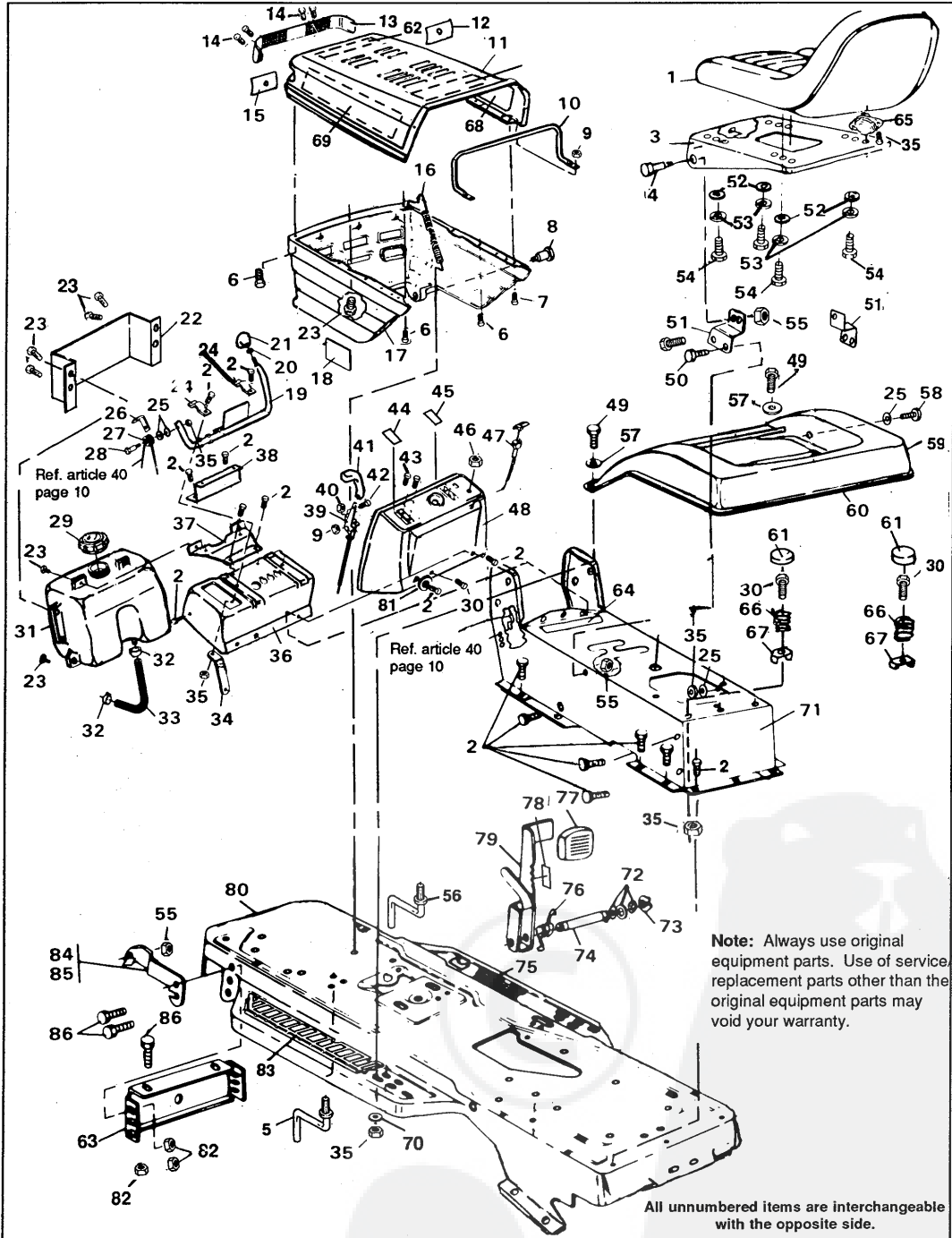

Repair Parts

45" Lawn Tractor Model A3583 - 130

Key No.	Part No.	Description	Key No.	Part No.	Description
1	307661	Seat	45	300445	Decal, Dash R.H.
2	995346	* Screw, Taptite 1/4-20 x 1/2 In.	46	300194	Boot, Ignition Switch
3	304910	Mounting Bracket, Seat	47	300425	Choke Control
4	20507	Shoulder Bolt	48	305429	Dash, Plastic Cover
5	300634	Belt Guide	49	180022	* Screw, Hex Hd 1/4-20 x 1 In.
6	300302	Screw, Taptite #10 x 1/2 In.	50	120228	* Screw, Hex Hd 5/16-18 x 5/8 In.
7	301542	Screw, Hex Hd #10-24 x 1 In.	51	311249	Bracket, Support L.H.
8	56676	Shoulder Bolt	52	120393	* Flatwasher, 11/32 In.
9	271166	Nut, Keps #10-24 Thd.	53	120638	* Lockwasher, Split 5/16 In.
10	301425	Support, Hood Brace	54	122007	* Screw, Hex Hd 5/16-18 x 3/4 In.
11	307035	Hood	55	1498	Locknut, 5/16-18 Thd.
12	301540	Reflector, Headlight, R.H.	56	300440	Belt Guide
13	302333	Lens, Headlight	57	120386	Flatwasher
14	57796	Screw, Plastite #6 x 1/2 In.	58	180020	* Screw, Hex Hd 1/4-20 3/4 In.
15	301541	Reflector, Headlight, L.H.	59	307365	Fender
16	57478	Spring, Hood	60	55021	Edging Fender
17	303037	Grille, Lower	61	56907	Cover, Spring
18	301971	Decal, Heat Reflector	62	305604	Pad, Hood Foam
19	9792	Lever, Mower Drive Control	63	56361	Bracket, Axle Support
20	120238	Jam Nut, 1/2-13 Thd.	64	305770	Decal, Caution
21	304438	Knob	65	57547	Switch
22	312489	Heat Shield	66	57153	Spring, Seat
23	300303	Screw, Plastite 1/4 x 3/4 x 3/4 In.	67	1341	Clip, Seat
24	9129	Bracket, Retaining	68	305602	Pad, Hood Foam
25	120393	Flatwasher, 1/4 In.	69	305603	Pad, Hood Foam
26	1288	Bracket, Cable Retainer	70	120386	Flatwasher
27	39298	Pulley	71	311242	Console
28	57322	Shoulder Bolt	72	2968	Spacer, Flatwasher
29	300304	Cap, Fuel Tank	73	20864	Retaining Ring
30	44811	Screw, Taptite 1/4-20 x 3/4 In.	74	57196	Rod, Clutch Pedal
31	303043	Fuel Tank, 2 Gal.	75	310006	Foot Pad, R.H.
32	41008	Clamp, Fuel Line	76	57847	Spring, Return
33	47452	Tubing, Fuel Line	77	52785	Pad, Clutch/Brake
34	9197	Brace, Dash	78	68903	Decal, Parking Brake
35	1502	Locknut, 1/4-20 Thd.	79	300308	Brake Pedal Assembly
36	9132	Dash, Metal	80	311243	Main Frame
37	9744	Bracket, Fuel Tank	81	120382	Flatwasher, 5/16 In.
38	9208	Brace, Dash & Fuel Tank	82	55273	Nut, Hex 5/16-18 Thd.
39	300510	Throttle Control	83	310005	Foot Pad, L.H.
40	120622	Nut, Hex #8-32 Thd.	84	9784	Bracket, Grille, R.H.
41	300508	Knob, Throttle Control	85	9785	Bracket, Grille, L.H.
42	159585	Screw, Pan Hd #8-32 x 3/8 In.	86	56030	Screw, Hex Hd 5/16-18 x 3/4 In.
43	159943	Screw, Pan Hd #10-24 x 5/8 In.			
44	302049	Decal, Dash L.H.			

(* Standard hardware items - may be purchased locally.

Repair Parts

45" Lawn Tractor Model A3583-130

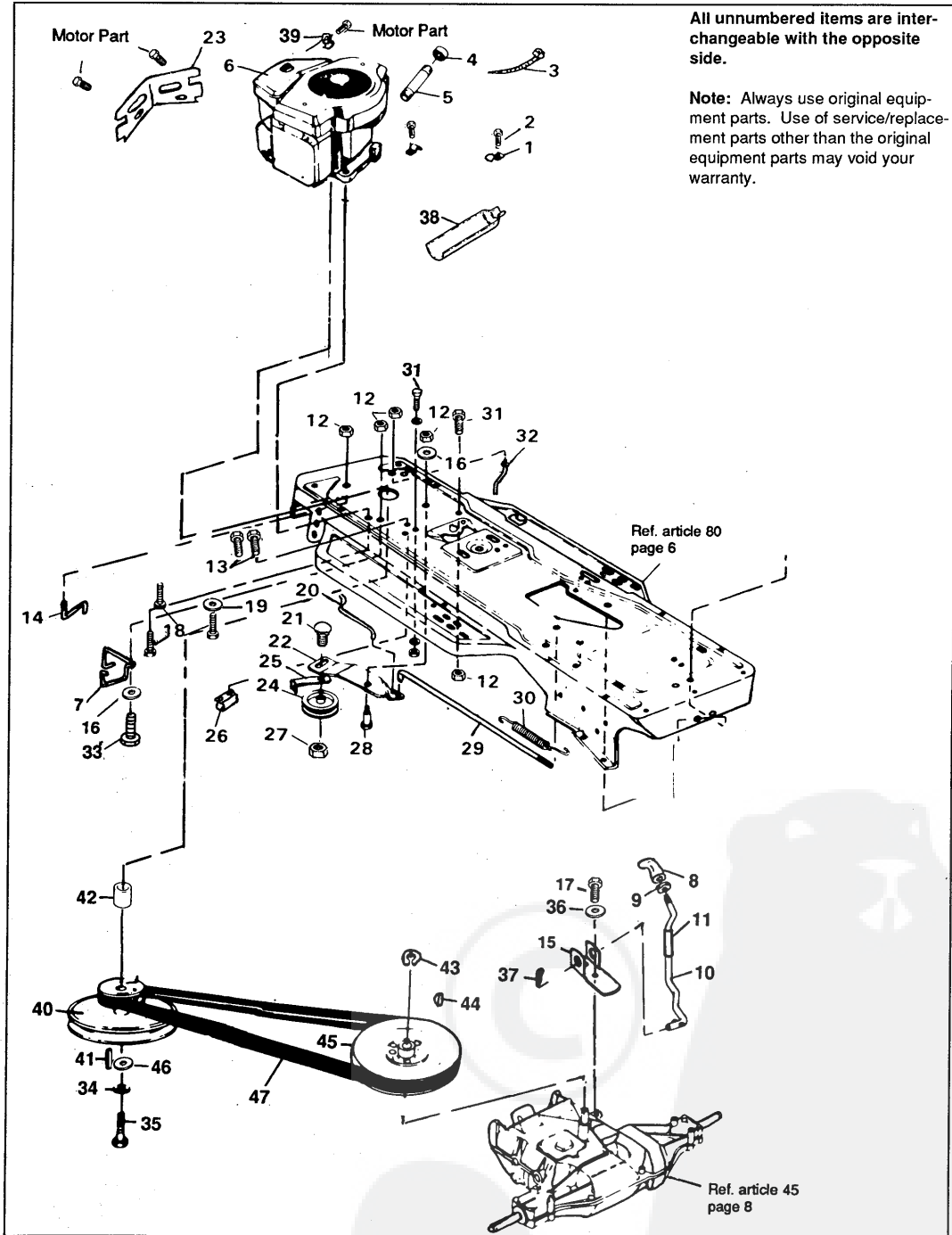

Repair Parts

45" Lawn Tractor Model A3583 - 130

Key No.	Part No.	Description	Key No.	Part No.	Description
1	56538	Clip, Cable	26	57476	Switch
2	35258	Screw, Taptite #10-24 x 3/8 In.	27	1499	Locknut, 3/8-16 Thd.
3	57444	Wire Tie	28	300793	Shoulder Bolt
4	47828	Cap, Oil Drain Tube	29	57203	Brake Rod
5	52404	Tube, Oil Drain	30	56359	Spring, Clutch
6	Engine	~ See Footnote Below	31	120229	* Screw, Hex Hd 5/16-18 x 5/8 In.
7	58356	Guide Belt/Drag Link	32	300440	Belt Guide
8	304438	Knob	33	180079	Screw, Hex Hd 5/16-18 x1 In.
9	120238	Jam Hex Nut 1/2-13	34	120383	Lockwasher, Split 7/16 In.
10	302743	Shift Lever	35	215668	Screw, Hex Hd 5/16-18 x 1 In.
11	302445	Shift Tube	36	57157	Washer, Special
12	1498	Locknut, Hex 5/16-18 Thd.	37	137185	Cotter Pin
13	57220	Screw, Taptite, #12 x 1/2 In.	38	54873	Trough, Oil Drain
14	300634	Belt Guide	39	56538	Wire Retainer
15	57480	Assembly, Shift Bracket	40	309362	Pulley, Engine
16	45602	Washer, 5/16 In.	41	57555	Key, 1/4 x 1/4 x 1-1/2 In.
17	56255	Screw, Hex Hd Nylon .14-28 x 3/4 In.	42	304246	Spacer, Engine Pulley
18	50947	Screw, Taptite 3/8-16 x 1-1/4 In.	43	22053	Ring, Retaining
19	138489	Internal Lockwasher	44	3021	Key, Woodruff
20	57204	Rod, Clutch	45	302745	Pulley, Input
21	45892	Carriage Bolt 3/8-16 x 1-1/2 In.	46	56431	Washer, Pilot
22	300154	Idler Arm	47	57214	V-Belt
23	9240	Bulkhead, Hood			
24	303031	Pulley, Idler			
25	39659	Belt Retainer			

(*) Standard hardware items - may be purchased locally.

Repair Parts

45" Lawn Tractor Model A3583-130

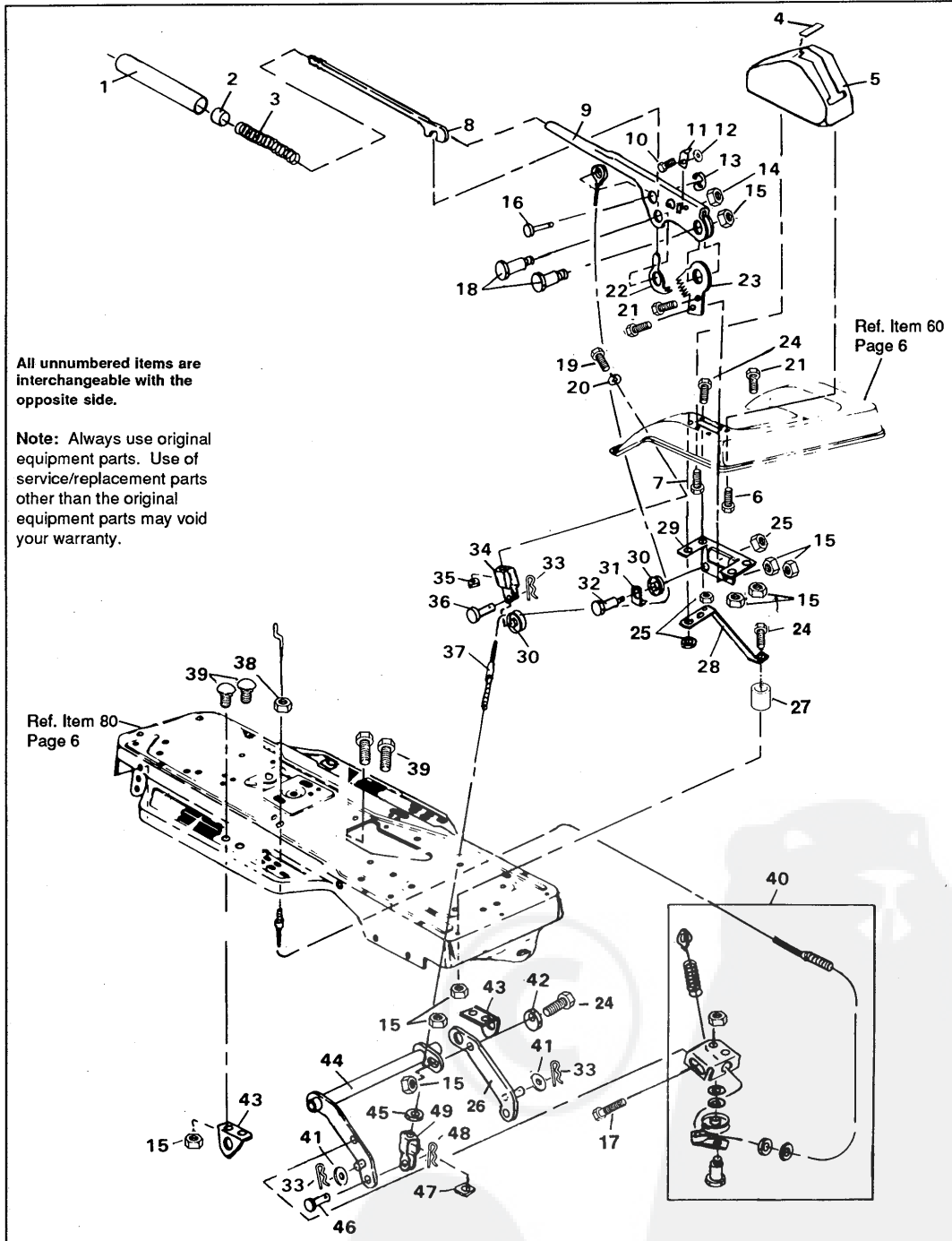

All unnumbered items are interchangeable with the opposite side.

Note: Always use original equipment parts. Use of service/replacement parts other than the original equipment parts may void your warranty.

Repair Parts

45" Lawn Tractor Model A3583 - 130

Key No.	Part No.	Description	Key No.	Part No.	Description
1	58329	Hand Grip, Height Adjust Lever	26	9186	Link Assembly, Right Slde
2	58325	Knob, Height Adjust Lever	27	57479	Spacer
3	58326	Spring, Height Adjust Lever	28	307367	Brace, Height Adjust Lever Support
4	301897	Decal, Height Adjust	29	58333	Bracket, Height Adjust Lever Support
5	300335	Cover, Height Adjust Lever	30	39298	Pulley
6	300302	Screw, #10 x 1/2 In.	31	9149	Bracket, Retainer
7	300340	Screw, #10 - 16 x 1 In.	32	58336	Shoulder Bolt
8	303027	Actuator Rod, Height Adjust Lever	33	8260	Hair Pin Cotter
9	9788	Lever Height Adjust	34	9239	Clevis
10	35287	Screw, Hex Wa Hd #8-32 x 3/4 In.	35	120373	Nut, Square 5/16-18 Thd.
11	9435	Pointer, Height Adjust Lever	36	300317	Pin, Clevis
12	138479	Lockwasher, Ext. Lock	37	301718	Cable, Deck Lift
13	300311	"E" Ring	38	120613	* Nut, Hex 1/4-28 Thd.
14	44108	Wide Flange Locknut, 5/16-18 Thd.	39	126211	* Carriage Bolt, 5/16-18 x 5/8 In.
15	1498	Locknut, Hex 5/16-18 Thd.	40	301440	Cable Assembly, Blade Engage
16	300310	Pin, Clevis	41	120396	* Flatwasher 17/32 In.
17	35497	Screw, Taptite 5/16-18 x 3/4 In.	42	58247	Nut, Adjusting
18	300171	Shoulder Bolt	43	9117	Bracket, Rear Hanger
19	439455	Screw, Pan Hd 5/16-18 x 1/2 In.	44	9569	Rear Lift Assembly
20	301551	Washer, Curved 11/32 In.	45	120375	* Nut, Hex 1/4-20 Thd.
21	180077	* Screw, Hex Hd 5/16-18 x 3/4 In.	46	39522	Clevis Pin
22	301239	Pawl, Height Adjust	47	120372	* Nut, Square 1/4-20 Thd.
23	301238	Quadrant, Height Adjust	48	121222	* Pin, Cotter 3/32 x 3/4 In.
24	180079	* Screw, Hex Hd 5/16-18 x 1 In.	49	9405	Rear Clevis, Lift Cable
25	1502	Locknut, Hex 1/4-20 Thd.			

(* Standard hardware items - may be purchased locally.

Repair Parts

45" Lawn Tractor Model A3583-130

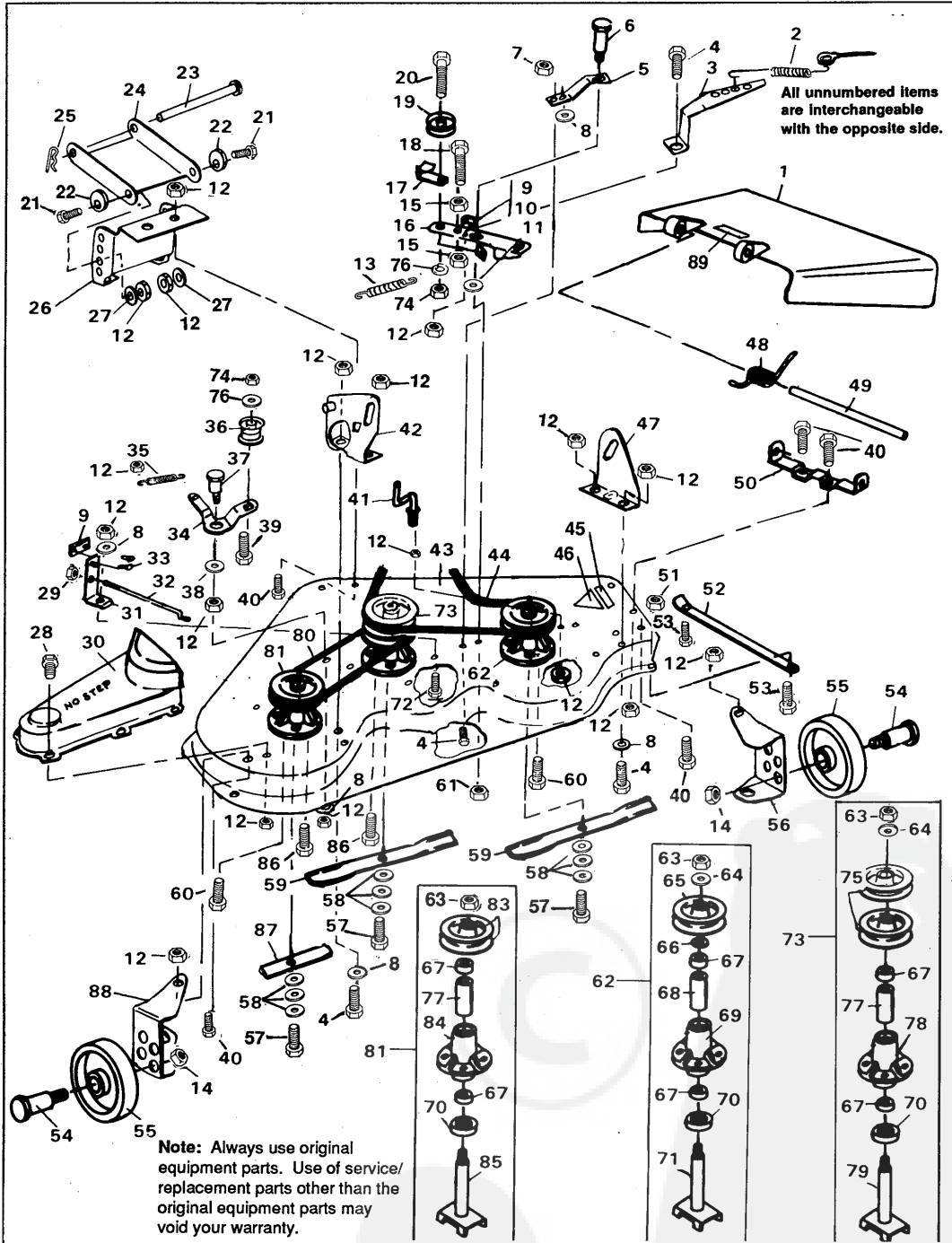

Repair Parts

45" Lawn Tractor Model A3583-130

Key No.	Part No.	Description	Key No.	Part No.	Description
1	57818	Chute Guard	46	305770	Decal, Caution
2	300473	Spring	47	58250	Bracket, Lift R.H.
3	9401	Extension, Idler Arm Bracket	48	55767	Spring, Discharge Chute
4	180077	* Screw, Hex Hd 5/16-18 x 3/4 In.	49	57317	Rod, Pivot
5	300179	Bracket, Idler	50	57360	Bracket, Pivot
6	300180	Shoulder Bolt	51	271184	* Nut, Keps 5/16-18 Thd.
7	44108	Nut, Hex Wide Flange 5/16-18 Thd.	52	57314	Skid Bar
8	120393	Flatwasher 11/32 In.	53	126216	* Carriage Bolt, 5/16-18 Thd.
9	306973	Brake Pad	54	23763	Wheel Axle
10	41601	Rivet, Brake Pad	55	52584	Wheel, Deck
11	996416	* Flatwasher 3/8 In.	56	300102	Bracket, Wheel Mount R.H.
12	1498	Locknut 5/16-18 Thd.	57	39573	Screw, Hex Hd 3/8-24 x 1 In.
13	35410	Spring	58	2483	Formed Washer
14	1499	Locknut, 3/8-16 Thd.	59	56821	Blade
15	271172	* Keps Nut, 1/4-20 Thd.	60	300345	* Screw, Hex Hd 5/16-18 x 1-3/8 In.
16	300491	Idler Arm Bracket	61	45171	Wide Flange Locknut 3/8 - 16 Thd.
17	1346	Retainer, Belt	62	56424	Quill Assembly
18	121954	* Screw, Hex Hd 1/4-20 x 2 In.	63	1282	Locknut, Flange
19	303030	Pulley, Idler	64	56365	Flatwasher
20	57325	Carriage Bolt, 3/8-16 x 2 In.	65	56390	Pulley
21	122017	* Screw, Hex Hd 5/16-18 x 1 In.	66	51449	Spacer
22	58247	Nut, Adjusting	67	49562	Bearing
23	58306	Rod, Deck Hitch	68	50818	Spacer, Tube
24	301091	Bracket, Deck Front	69	55547	Quill
25	8260	Hairpin Cotter	70	50616	Dust Shield
26	58315	Lift Support Plate	71	56425	Saddle & Shaft Assembly
27	35214	Flatwasher, 21/64 In.	72	120228	* Screw, Hex Hd 5/16-18 x 5/8 In.
28	40886	Screw, Taptite 1/4-20 Thd.	73	304076	Quill Assembly
29	1498	Locknut, 5/16-18 Thd.	74	120377	Locknut 3/8-16
30	300238	Belt Guard	75	304077	Pulley
31	303246	Brake Arm	76	120382	Lockwasher, Split 3/8
32	300315	Rod, Brake Release	77	58128	Spacer, Tube
33	135624	Rivet, Brake Pad	78	58124	Quill
34	1343	Idler Arm	79	58165	Saddle & Shaft Assembly
35	300215	Spring	80	300142	V-Belt
36	303029	Pulley, Idler	81	58125	Quill Assembly
37	41890	Shoulder Bolt	82	70613	Decal, Caution
38	4107	Flatwasher	83	300294	Pulley Half
39	45892	Shoulder Bolt	84	58162	Quill
40	120834	* Screw, Hex Hd 5/16-18 x 1/2 In.	85	58122	Saddle & Shaft Assembly
41	57318	Belt Guide	86	50634	Screw, Hex Hd 5/16-18 x 7/8 In.
42	58251	Bracket, Lift L.H.	87	303014	Blade, 9/52 In.
43	311434	Mower Deck	88	300103	Bracket, Wheel Mount L.H.
44	305667	V-Belt			
45	68622	Decal, No Step			

(*) Standard hardware items - may be purchased locally.

Repair Parts

45" Lawn Tractor Model A3583-130

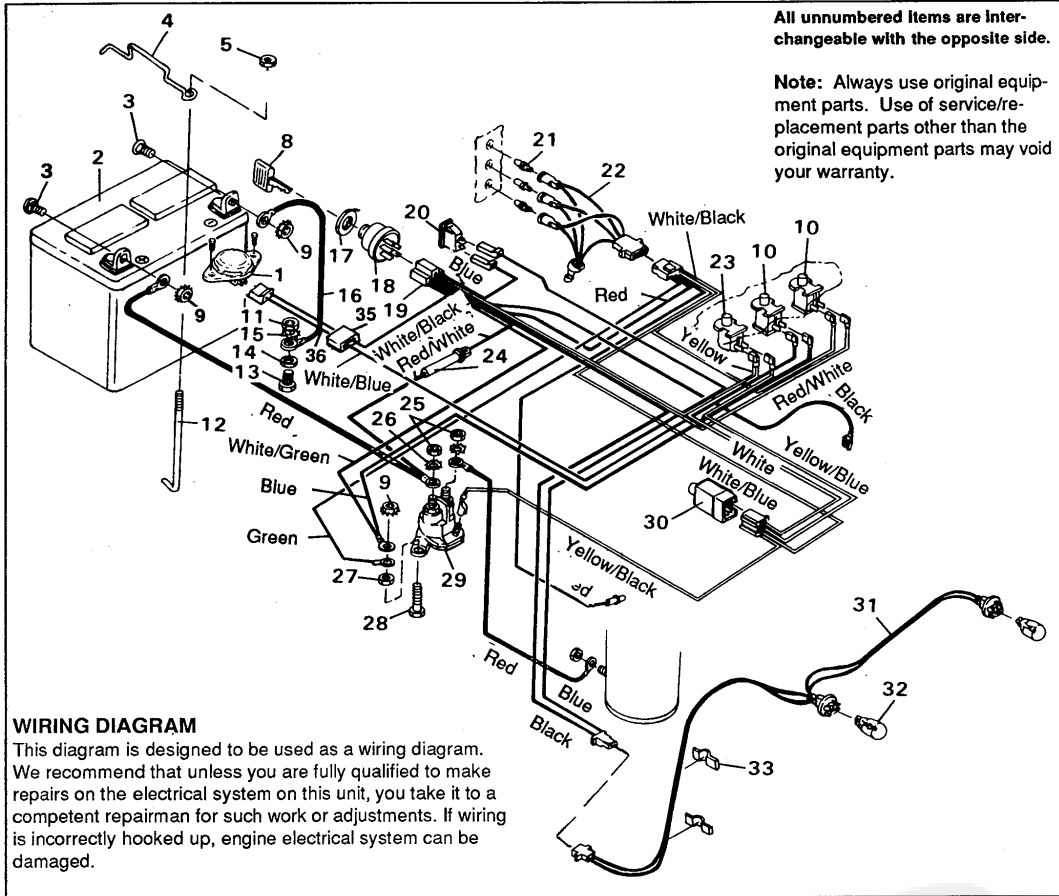

WIRING DIAGRAM

This diagram is designed to be used as a wiring diagram. We recommend that unless you are fully qualified to make repairs on the electrical system on this unit, you take it to a competent repairman for such work or adjustments. If wiring is incorrectly hooked up, engine electrical system can be damaged.

Key No.	Part No.	Description
1	57547	Switch, Seat
2	302257	Battery
3	120854	Screw, Hex Hd 1/4-20 x 5/8 In.
4	57552	Rod, Battery Top
5	310067	Wing Nut, 1/4-20
6	305431	Wire Assembly, Seat Switch
7	305511	Connector Body
8	300626	Key, Ignition
9	271172	Nut, Hex Keps 1/4-20
10	58277	Switch
11	271184	Nut, Hex Keps 5/16-18
12	57551	Rod, Battery
13	122017	Screw, 5/16-18 x 1 In.
14	1498	Locknut, Reg Hex 5/16-18
15	138538	Washer, Reg .32 x .61 x .02 In.
16	55511	Ground Wire
17	300193	Nut 5/8 - 32
18	300295	Switch

Key No.	Part No.	Description
19	300362	Wire Harness
20	300334	Light Switch
21	57769	Bulb, Indicator
22	300965	Light Harness
23	300220	Safety, Switch
24	302031	Fuse
25	120368	Nut, Reg Hex 5/16-24
26	138485	Washer, .320 x .61 x .03
27	1502	Nut, Reg Hex 1/4-2
28	187745	Screw 1/4-20 x 3/4 In.
29	53716	Solenoid
30	57476	Switch
31	303064	Assembly, Light Wire
32	52572	Bulb, Headlight
33	41482	Clip, Press Wire

ACCESSORIES

Contact the dealer where your tractor was purchased for the available accessories. If you are unable to contact the dealer, write to the address on the front cover of this manual.

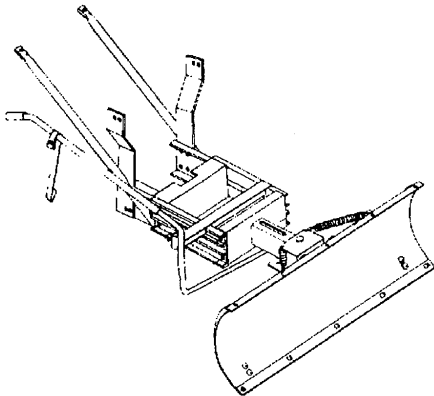

42" SNOW & GRADER BLADE

Rugged, heavy gauge steel blade. Spring loaded blade glides over uneven surfaces. Can be adjusted from seat for straight position, or 35 degrees left or right. Locks in raised position for traveling. Wheel and tire chains are recommended.

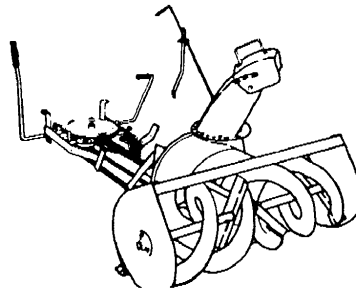

TWO STAGE SNOW THROWER

A powerful two stage snow thrower with a 1/4 inch second stage impeller capable of moving more than 70 tons of snow per hour and throwing it accurately in any direction you choose. Driver controlled discharge chute turns a 160 degree arc. Wheel weights and tire chains are recommended.

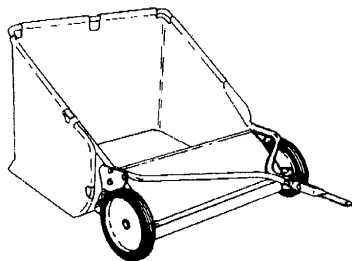

LAWN SWEEPER

Features extra heavy duty wheels and heavy duty basket. Basket is water, shrink and mildew proof with 6 bushel capacity. Dump release and height adjuster can both be operated from the tractor seat.

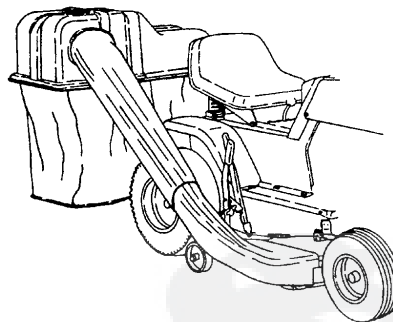

REAR MOUNT GRASS CATCHER

For 39 inch side discharge mower decks. Easy-On Easy-Off chute extension. Includes Easy-To-Dump twin grass collection containers with a 6-bushel capacity.

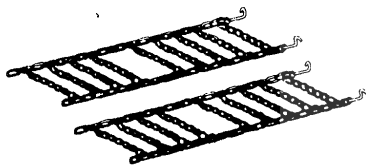

FRONT WHEEL WEIGHTS

One pair, 20 pounds each. Total weight 40 pounds. Includes mounting hardware.

TIRE CHAINS

Tire chains for added traction are available. Specify tire size when ordering.

Part No. 311402

REAR WHEEL WEIGHTS

One pair, 50 pounds each. Total weight 100 pounds. Includes mounting hardware.