

Grass Catcher 63554. 560.

REPAIR PARTS

REAR MOUNTED, SIDE DISCHARGE GRASS CATCHER MODEL 57081303

NOTE: ALWAYS USE ORIGINAL EQUIPMENT PARTS. Use of service replacement parts other than original equipment parts may void your warranty.

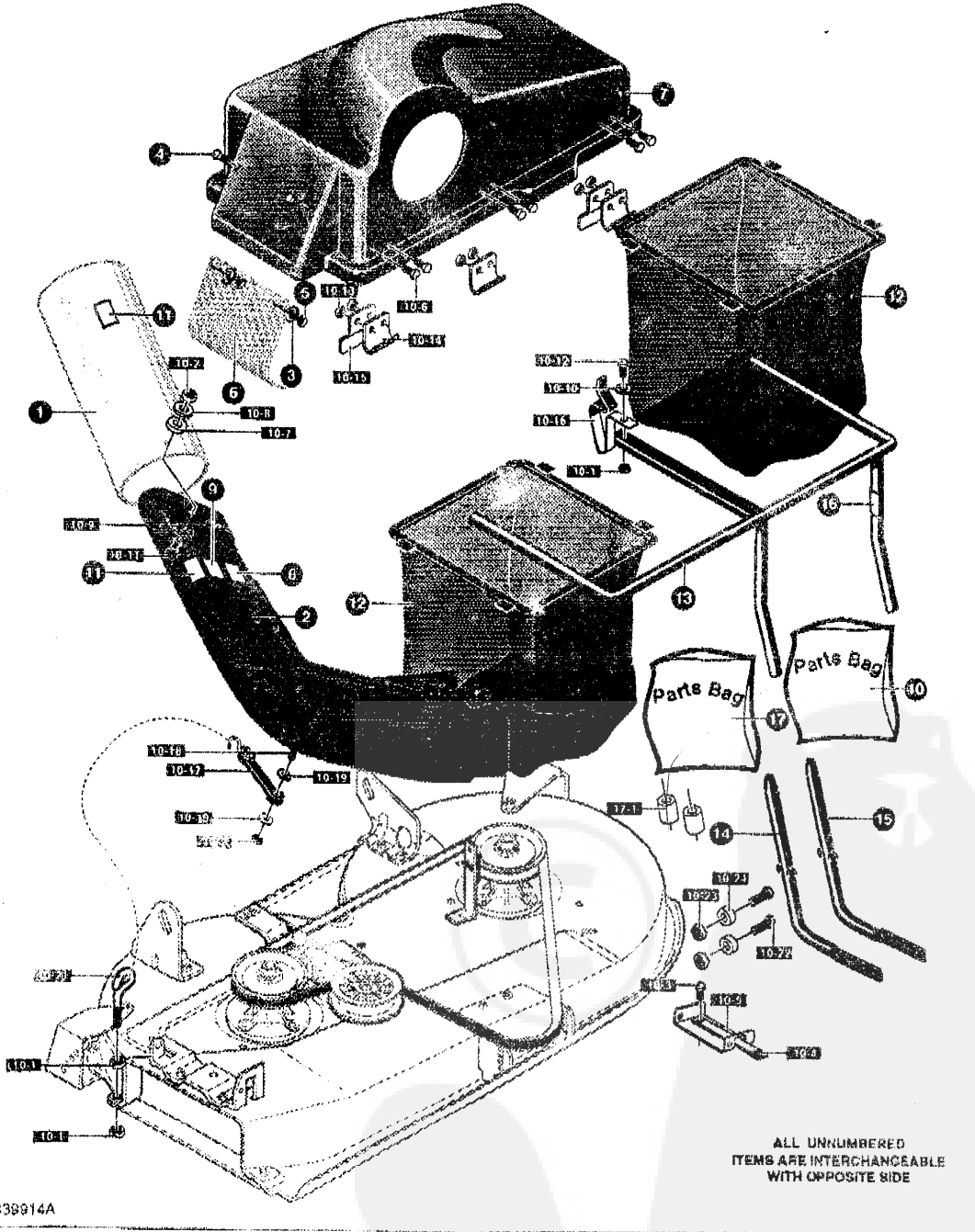

339914A

ALL UNNUMBERED
ITEMS ARE INTERCHANGEABLE
WITH OPPOSITE SIDE

REPAIR PARTS**REAR MOUNTED, SIDE DISCHARGE GRASS CATCHER MODEL 57081303**

ALWAYS GIVE THE FOLLOWING INFORMATION WHEN ORDERING REPAIR PARTS:

1. The PART NUMBER; 2. The PART NAME; 3. QUANTITY DESIRED; 4. The MODEL NUMBER (As shown on Model Plate).

SEND PART ORDERS AS PER INSTRUCTIONS ON THE FRONT PAGE.

YOUR UNIT IS RIGHT HAND (RH) OR LEFT HAND (LH) AS YOUR STAND BEHIND IT.

DO NOT USE KEY NUMBERS WHEN ORDERING REPAIR PARTS, ALWAYS USE PART NUMBERS.

All replacement parts will be supplied in current production colors or in a neutral color.

A handling fee is applicable to small parts orders.

| key# | part# | description | qty. |
|-------|------------|----------------------------------|------|
| 1 | 57667 | TUBE, UPPER 23 X 6.75 | 1 |
| 2 | 314842 | CHUTE, TRANSITION 36,39,45"DECK | 1 |
| 3 | 1501 | WASHER, FLAT .203X .56X.040 | 2 |
| 4 | 57034 | SCREW, 10-24X .63 | 2 |
| 5 | 308489 | NUT, #10-24 HXHDNYLK | 2 |
| 6 | 300115 | SCREEN, GRASS CATCHER | 1 |
| 7 | 306943 | COVER,GRASS COLLECTOR | 1 |
| 8 | 402701 | DECAL, CAUTION DECK RH CUT HAND | 1 |
| 9 | 402707 | DECAL, CE PCTOGRAM READ MANUAL | 1 |
| 10 | * | PARTS BAG | 1 |
| 10-1 | 1498 | NUT, 5/16-18 REGHEXOTRLK | 3 |
| 10-2 | 1502 | NUT, 1/4-20 REGHEXOTRLK | 3 |
| 10-3 | 35497 | SCREW, 5/16-18X .50 WAHHTAP | 1 |
| 10-4 | 42348 | GRIP-LEVER GRASS COLLECTOR | 1 |
| 10-5 | 322320-853 | LEVER ASSY (SHORT) | 1 |
| 10-6 | 55686 | SCREW, 1/4-20X .63 | 6 |
| 10-7 | 57506 | GROMMET | 2 |
| 10-8 | 57626 | WASHER, FLAT .281X1.25X.06 | 2 |
| 10-9 | 120386 | WASHER, FLAT .312X .73X.065 | 2 |
| 10-10 | 120393 | WASHER, FLAT .344X .69X.065 | 1 |
| 10-11 | 180020 | SCREW, 1/4-20X .75 HHC | 2 |
| 10-12 | 180077 | SCREW, 5/16-18X .75 HHC | 1 |
| 10-13 | 271172 | NUT, 1/4-20 REGHEXKEPS | 6 |
| 10-14 | 300278-853 | HINGE, COVER | 3 |
| 10-15 | 300624-853 | STRAP, RETAINER | 2 |
| 10-16 | 307981-853 | BAGGER LATCH | 1 |
| 10-17 | 57505 | RUBBER STRAP | 1 |
| 10-18 | 180022 | SCREW, 1/4-20X1.00 HHC | 1 |
| 10-19 | 120392 | WASHER, FLAT .281X .63X.065 | 2 |
| 10-21 | 57257 | EYE BOLT 5/16-18 | 1 |
| 10-22 | 180083 | SCREW, 5/16-18X1.50 HHC | 4 |
| 10-23 | 55273 | NUT, 5/16-18 WDFLLKLRG WHIZ | 4 |
| 10-24 | 41462 | SPACER, SLEV .328X .75X .312PM | 4 |
| 11 | - | NOT A SERVICABLE PART | 2 |
| 12 | 58283 | BAG, GRASS COLLECTOR | 2 |
| 13 | 58282-853 | SUPPORT ASSY | 1 |
| 14 | 327637-853 | ROD-GRASS COLLECTOR "A" | 1 |
| 15 | 327638-853 | ROD- GRASS COLLECTOR "B" | 1 |
| 16 | - | NOT A SERVICABLE PART | |
| 17 | 313606 | SPACERS SERVICE KIT | 1 |
| 17-1 | - | ORDER SPACERS SERVICE KIT 313606 | |
| 18 | 327716 | OWNERS MANUAL (NOT SHOWN) | 1 |

* Order individual parts