

DYNAMARK TURFMASTER

REAR BAGGER

BAC ARRIERE

OPVANGBAK

SERIAL N°

5708-2301

FOR - POUR - VOOR

40" - 42" - 43"

POUR } AIR-ASSIST
VOOR }

GRASS CATCHER FOR UNITS WITH AIR ASSIST 40-42-43"

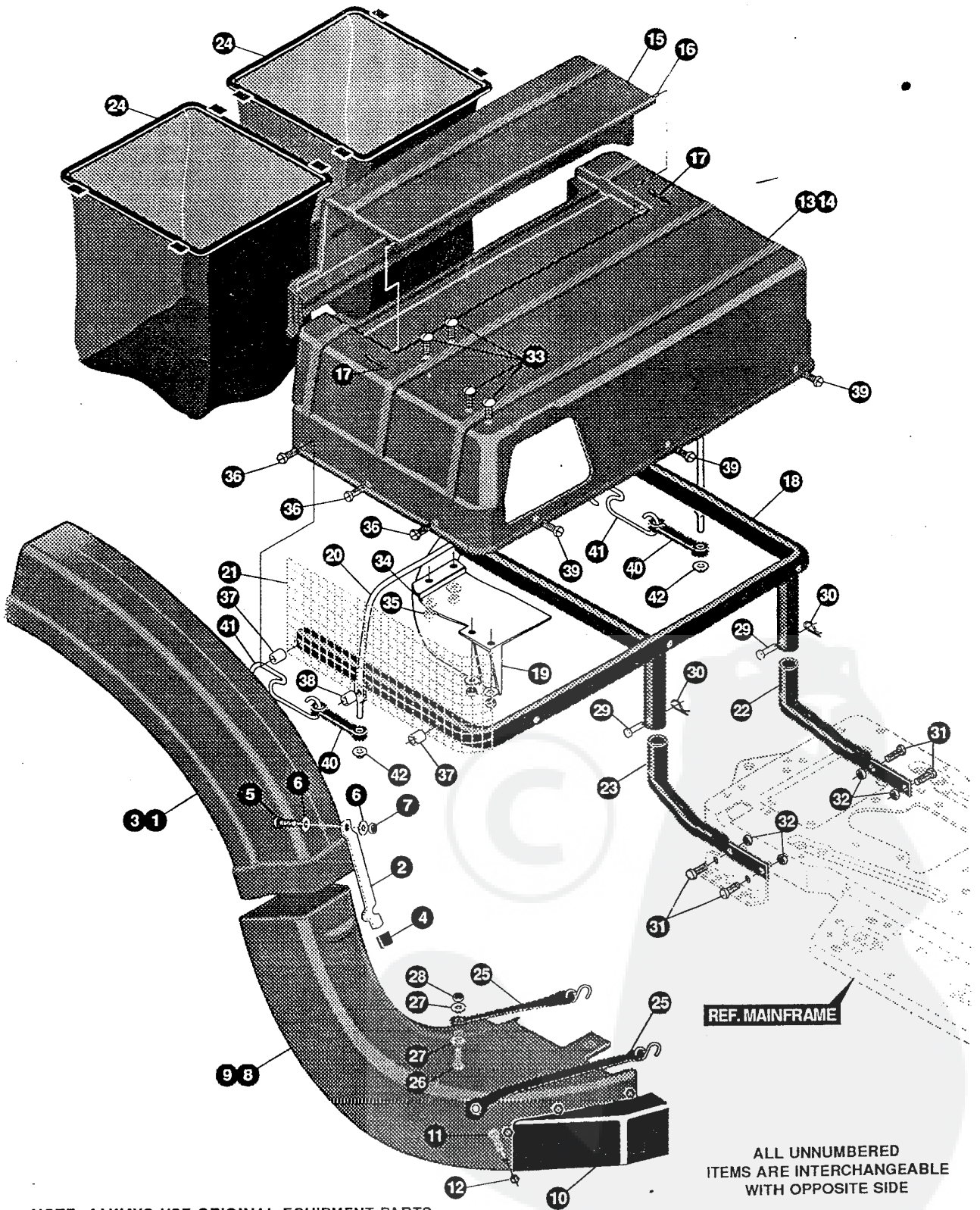

NOTE: ALWAYS USE ORIGINAL EQUIPMENT PARTS.
Use of service replacement parts other than original equipment parts may void your warranty.

ALL UNNUMBERED
ITEMS ARE INTERCHANGEABLE
WITH OPPOSITE SIDE

323907B

REPAIR PARTS

GRASS CATCHER FOR UNITS WITH AIR ASSIST

40-42-43"

key#	part#	description	qty.
1.	*	ASSY, UP CHUTE,40,43,46*BAGGER	1
2.	322494-853	LATCH CHUTE	1
3.	322495	CHUTE, UPPER 40&46 BAGGER	1
4.	42348	GRIP-LEVER GRASS COLLECTOR	1
5.	121887	SCREW, 1/4-20X .75 HHC	1
6.	57626	WASHER, FLAT .281X1.25X.06	2
7.	1502	NUT, 1/4-20 REGHEXCTRLK	1
8.	*	ASSEMBLY, LOWER CHUTE AIR ASSIST	1
9.	318073	CHUTE, LOWER	1
10.	316987	INLET	1
11.	318377	SCREW, 10-32X.50 SLWAHH	5
12.	314159	NUT, #10-32 CTRLK	5
13.	*	ASM. TOP COVER AND LID 40*43"	1
14.	309295	TOP COVER ERO BAGGER	1
15.	309320	TOP LID PIVOTING	1
16.	310194	ROD,GRASS CATCHER PIVOT	1
17.	121223	PIN, COTTER .0625X.75LG	2
18.	322980-853	TUBE ASSY, SUPPORT(DBL-GST)	1
19.	305197	BAFFLE GRASS CATCHER EURO	1
20.	309159-853	SUPPORT ROD, COVER	1
21.	306262	SCREEN, ERO BAGGER 6.0 X 18.25	1
22.	322389-853	TUBE LH. COLLECTOR SUPPORT	1
23.	322388-853	TUBE RH. COLLECTOR SUPPORT	1
24.	322157	BAG, GRASS COLLECTOR	2
25.	57505	RUBBER STRAP	2
26.	121900	SCREW, 1/4-20X1.00 HHC	2
27.	120392	WASHER, FLAT .281X .63X.065	4
28.	1502	NUT, 1/4-20 REGHEXCTRLK	2
29.	308619	PIN, CLEVIS .25X1.656X1.75	2
30.	56180	PIN, HAIR .091 DIA X1.62LG	2
31.	180081	SCREW, 5/16-18X1.25 HHC	4
32.	1498	NUT, 5/16-18 REGHEXCTRLK	4
33.	55686	SCREW, 1/4-20X .63 SLTRMA	4
34.	120392	WASHER, FLAT .281X .63X.065	4
35.	271172	NUT, 1/4-20 REGHEXKEPS	4
36.	306487	SCREW, 1/4-20X1.50 HHTAP	3
37.	306079	SPACER, BAGGER .87X7/16X.060	2
38.	309296	SPACER ERO BAGGER .69X.44X.06	1
39.	44811	SCREW, 1/4-20X .75 HXWATAP	6
40.	57505	RUBBER STRAP	2
41.	309648	MF HOLD DOWN, RUBBER STRAP	2
42.	73664	NUT, PUSH ON 3/8"	2
43.	327627	OWNER'S MANUAL	1

* ORDER INDIVIDUAL PARTS

