

REPAIR PARTS MANUAL

45" - 18 H.P. LAWN TRACTOR

MODEL B4518-040

TWO YEAR LIMITED WARRANTY

For two (2) years from date of purchase by the first consumer for residential use (thirty (30) days commercial use), NOMA Outdoor Products Incorporated warrants that it will replace free of charge, including labor, any original part of any NOMA Outdoor Products Incorporated product found to be defective by any authorized Service Dealer or the factory, except the battery which is warranted for ninety (90) days from date of purchase.

This warranty does not cover engine, transmission, transaxle or differential (these items are covered by their manufacturer's own warranty). This warranty does not cover parts that have failed due to normal wear or parts that have failed subject to misuse or abuse. Transportation of the unit or part to and from an authorized Service Dealer or factory is the responsibility of the owner.

A step by step explanation as to what procedure should be followed for this warranty is:

1. If a part becomes defective, contact the store where the unit was purchased for the name and address of the authorized Service Dealer nearest to you.
2. If you cannot locate an authorized Service Dealer, write Service Department of NOMA Outdoor Products Incorporated for the name and address of the authorized Service Dealer in your area or call the Service Department at 1-801-422-1690.
3. Return the defective product, along with proof of purchase to such authorized Service Dealer for replacement of any defective part where covered by this warranty.

There is no other express warranty. Implied warranties, including those of merchantability and fitness for a particular purpose are limited to two (2) years from date of purchase. Liability for incidental or consequential damages are excluded.

Some states do not allow limitations on how long an implied warranty lasts, so the above limitation may not apply to you. Some states do not allow the exclusion of incidental or consequential damages, so the above exclusion may not apply to you. This warranty gives you specific legal rights, and you may have other rights which vary from state to state.

NOMA Outdoor Products Incorporated

Call 800

Jackson, TN 38308-8000

UNIT PARTS AND SERVICE

This manual contains instructions for safety, assembly and maintenance. Read this manual carefully and completely so that you will know proper assembly, use and care of your unit. Also fill in and mail the registration card packed with the unit. For service other than covered in this manual, contact an authorized service dealer. A nationwide parts and service organization has been established to provide locally available parts and service. A list of authorized parts distributors has been included in this manual. When ordering repair parts, always give the following information: 1. The Part Name; 2. The Part Number; 3. The Quantity desired; 4. The Full (eight digit) Model Number of the unit. The model number will be found on a plate attached to the unit.

Look for this symbol.



It means - ATTENTION! BECOME ALERT! A HAZARD TO OPERATOR, BYSTANDER, PROPERTY OR EQUIPMENT MAY EXIST.

NOMA Outdoor Products Incorporated
Call 800
Jackson, TN 38308-8000

Part No. 317839

4780

45" LAWN TRACTOR MODEL B4518-040

CHASSIS & HOOD ASSEMBLY

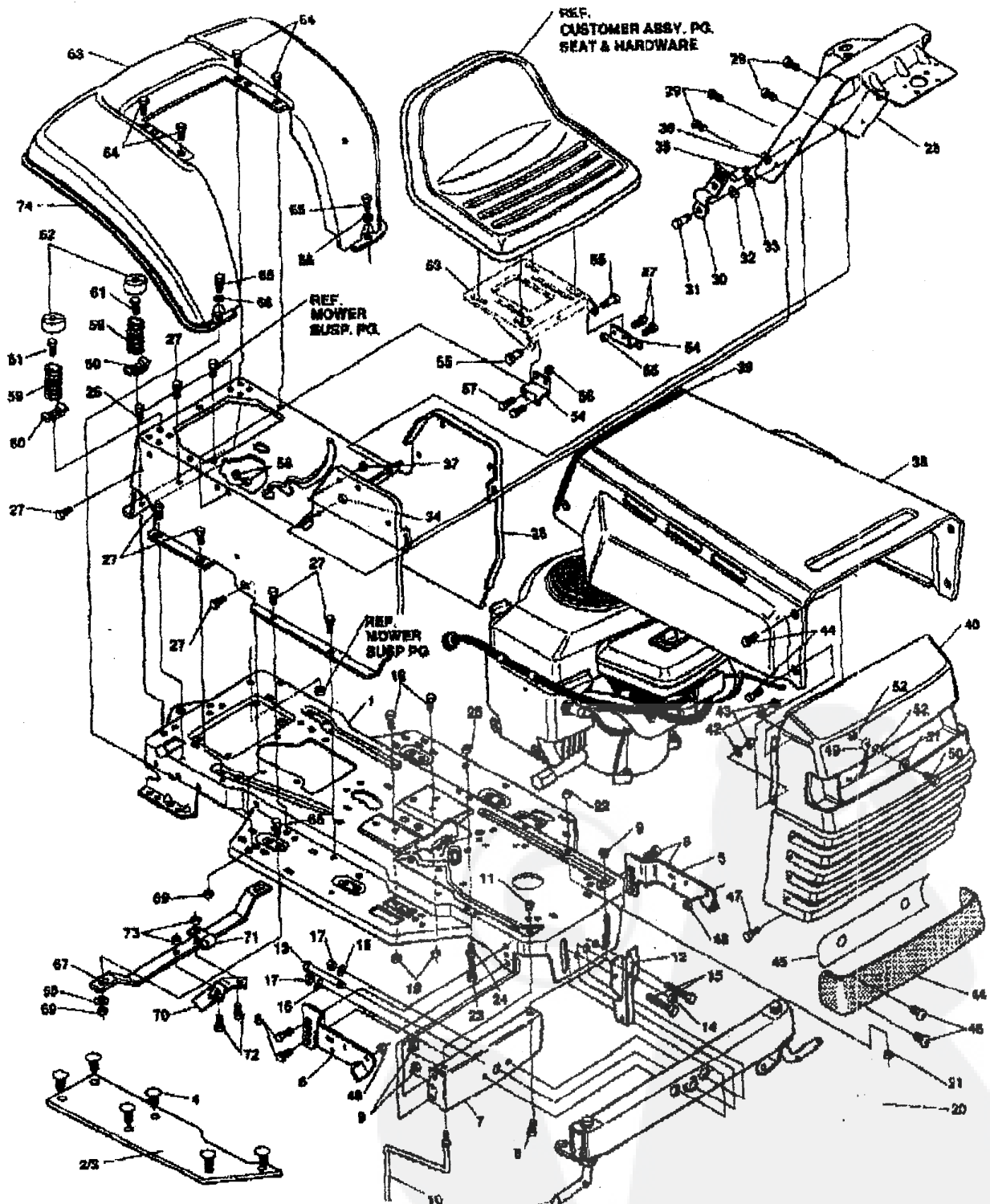

NOTE: ALWAYS USE ORIGINAL EQUIPMENT PARTS. Use of service/replacement parts other than original equipment parts may void your warranty.

REF. STEERING PG. FRONT AXLE ASSY.

ALL UNNUMBERED ITEMS ARE INTERCHANGABLE WITH OPPOSITE SIDE

317403C

Part No. 317839

45" LAWN TRACTOR MODEL B4518-040

key#	part#	description	qty.
1	315967	FRAME, MAIN RIDER	1
2	310005	FOOTPAD,LH	1
3	310006	FOOTPAD,RH	1
4	309295	FASTENER, RATCHET	12
5	313047	BRKT,GRILL LH	1
6	313048	BRKT,GRILL RH	1
7	58861	BACKET, FRONT AXLE	1
8	068030	SCREW, 5/16-18X.75WDFLLK	5
9	055273	NUT, 5/16-18 HXWDFLLK	5
10	300440	GUIDE, BELT RIDER	1
11	01498	NUT, 5/16-18 REGHEXCTRLK	1
12	317489	BRACKET, FRONT HANGER	1
13	52408	BOLT, .625X2.180 HHSX 1/2-18	1
14	01500	NUT, 1/2-18 REGHOTRLK	1
16	0122207	SCREW, 3/8-18X.50 HHC	2
16	2483	WASHER, 3/16DX1.25DX.07 BELLVIL	2
17	01499	NUT, 3/8-18 REGHXCTRLK	2
18	0120229	SCREW, 5/16-18X .88 HHC	2
19	01498	NUT, 5/16-18 REGHEXCTRLK	2
20	300635	GUIDE, BELT SHORT 15" WHEEL	1
21	0124824	NUT, 5/16-18 HEXJAM	1
22	0271190	NUT, 3/8-18 HEXKEPS	1
23	301713	ROD, UPSTOP	1
24	01499	NUT, 3/8-18 REGHXCTRLK	2
25	310446	CONSOLE	1
26	036497	SCREW, 5/16-18X .50 WAHNTAP	1
27	0995346	SCREW, 1/4-20X .50 WAHNTAP	13
28	9773	DASH	1
29	0995346	SCREW, 1/4-20X .50 WAHNTAP	4
30	57159	LATCH, .94WDX.047 ASSY HOOD	2
31	8482	BOLT, .375X .156 HHSX 5/16-18	2
32	0120384	WASHER, FLAT .408X .81X.065	2
33	0120393	WASHER, FLAT .344X .69X.065	2
34	01498	NUT, 5/16-18 REGHEXCTRLK	2
35	53448	PIN, 5/16-18 HOOD LATCH	2
36	0138538	WASHER, REGINTLK.320X.81X.03	2
37	045174	NUT, 5/16-18 HEXWDFLLK	2
38	316527	HOOD, LF H-20 DYNA/PRO	1
39	47453	EDGING,WIDE	27.5'
40	314476	GRILLE DYNA-PRO	1
41	0274572	SCREW, 1/4-20X .63 WAHHC	4
42	0120393	WASHER, FLAT .344X .69X.065	4
43	01502	NUT, 1/4-20 REGHEXCTRLK	4
44	302333	LENS, SMOKED	1
45	314848	FOIL, LENS DYNA-PRO REFLECTOR	1
46	057796	SCREW, #8 X .60 PLASTITE	4
47	36149	BOLT, .375X .500 HHSX 5/16-18	2
48	01498	NUT, 5/16-18 REGHEXCTRLK	2
49	310748	LANYARD,HOOD	1
50	048900	SCREW, 1/4-20X .100 HHC	1
51	0120392	WASHER, FLAT .281X .63X.065	1
52	01502	NUT, 1/4-20 REGHEXCTRLK	2
53	305857	PLATE, SEAT F-5 SF & LF	1
54	312810	BRACKET, F-5 SEAT SUPPORT	1
55	20507	BOLT, .437X .156 HHSX 5/16-18	2
56	01498	NUT, 5/16-18 REGHEXCTRLK	2
57	0120228	SCREW, 5/16-18X .63 HHC	4
58	01498	NUT, 5/16-18 REGHEXCTRLK	4
59	57159	SPRING,SEAT 2.63LG.1.48OD	2
60	1341	CLAMP,SPRING 1.17ID	2
61	044811	SCREW, 1/4-20X .75 HXWATAP	2
62	58907	COVER,SEAT SPRING 1.61DX1.0LG	2
63	8782	FENDER, F-5 GROUND SUPT LF	1
64	0995346	SCREW, 1/4-20X .50 WAHNTAP	4
65	0122017	SCREW, 5/16-18X1.00 HHC	4
66	0446369	WASHER, FLAT .375X .68X.088	2
67	43364	SUPPORT, GUIDE	1
68	0448883	WASHER, FLAT .375X .88X.082	2
69	01498	NUT, 5/16-18 REGHEXCTRLK	4
70	49777	GUIDE, REAR DECK	1
71	57569	RETAINER, .31DX.62X.08 WIRE	1
72	0122017	SCREW, 5/16-18X1.00 HHC	2
73	01498	NUT, 5/16-18 REGHEXCTRLK	2
74	55021	TRIM,STRIP,BLACK-	77.5'

*STANDARD HARDWARE ITEMS

45" LAWN TRACTOR MODEL B4518-040

STEERING ASSEMBLY

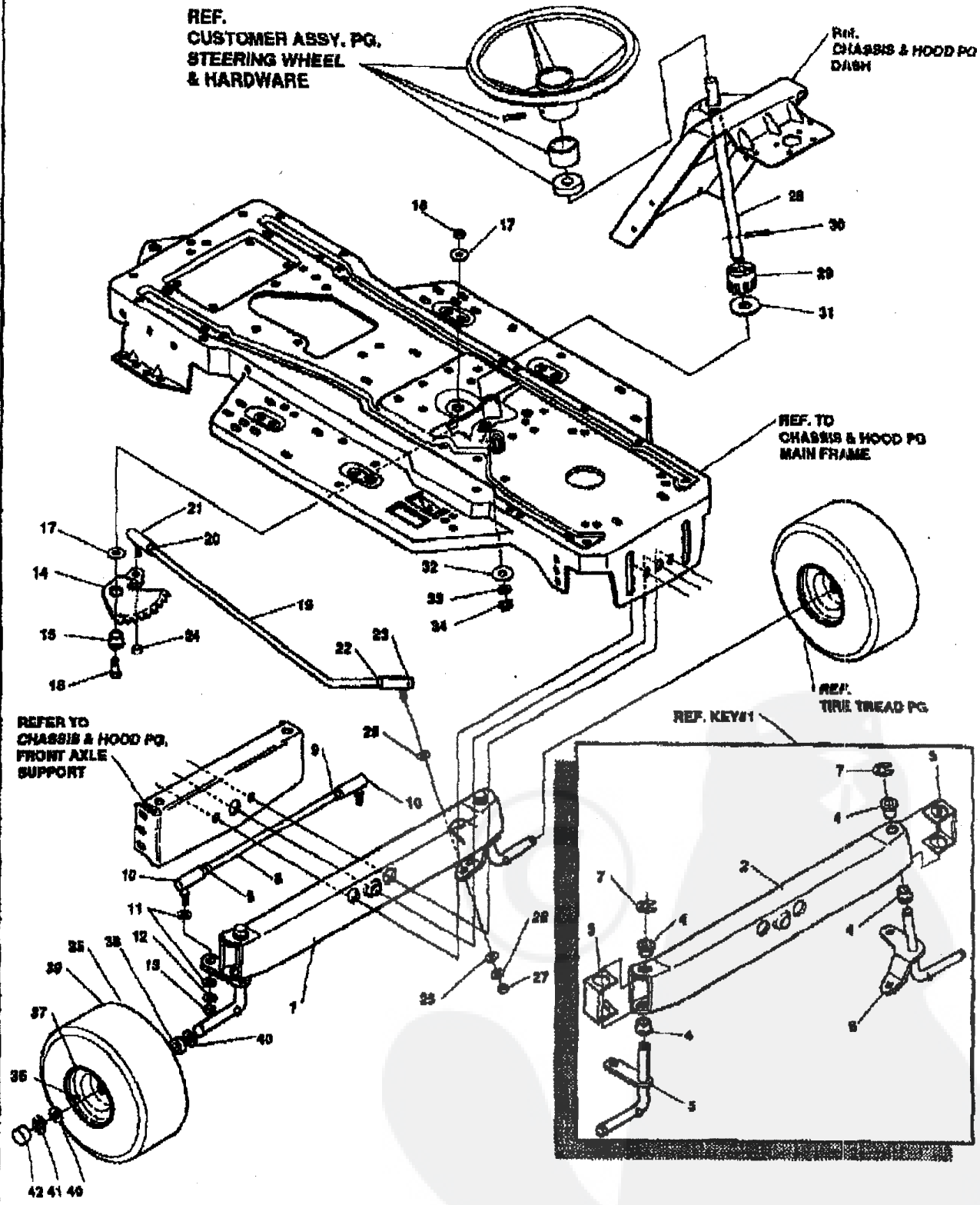

REFER TO CHASSIS & HOOD PG. FRONT AXLE SUPPORT

REF. CUSTOMER ASSY. PG. STEERING WHEEL & HARDWARE

REF. CHASSIS & HOOD PG. DASH

REF. TO CHASSIS & HOOD PG. MAIN FRAME

REF. KEY#1

REF. TIRE TREAD PG.

ALL UNNUMBERED ITEMS ARE INTERCHANGABLE WITH OPPOSITE SIDE

NOTE: ALWAYS USE ORIGINAL EQUIPMENT PARTS. Use of service/replacement parts other than original equipment parts may void your warranty.

317446A

45" LAWN TRACTOR MODEL B4518-040

key#	part#	description	qty.
1	*	AXLE,FRONT ASSY	1
2	55730	AXLE, FRONT	1
3	53373	AXLE COVER	2
4	52407	SPINDLE BEARING	4
5	9180	ASSY,SPINDLE,RH	1
6	314088	ASSY,SPINDLE,LM	1
7	36625	RING, RETEX .57X.05TRU5133-75	2
8	300325	TIE ROD 3/8 ROLLED TH'D	1
9	0124925	NUT, 3/8-24 REGHEXJAM	2
10	21275	BALL JOINT 3/8 TH'D	2
11	0120382	WASHER, REGSPTLK.393X.68X.10	2
12	0120385	WASHER, FLAT .489X.92X.085	2
13	0120389	NUT, 3/8-24 REGHEX	2
14	58289	SECTOR, STEERING	1
15	52408	BRNG,FL ECC.510IDX .998ODX .56	1
16	0180177	SCREW, 1/2-13X1.50 HHC	1
17	022255	WASHER, FLAT .515X1.38X.119	2
18	01500	NUT, 1/2-13 REGHOTRLK	1
19	302853	DRAG LINK .625 DIA	1
20	0124925	NUT, 3/8-24 REGHEXJAM	1
21	57158	BALL JOINT 3/8 TH'D SHORT STUD	1
22	072125	NUT, 7/16-20 HXJAM	1
23	302855	JOINT, BALL ASSY 7/16-20	1
24	646502	NUT, 3/8-24 WDFLHLK WHIZ	1
25	0120398	WASHER, FLAT .591X1.06X.095	1
26	120393	WASHER, REGSPTLK .489X.78X.12	2
27	0271506	NUT, 7/16-20 REGHEX	1
28	58249	SHAFT, STEERING	1
29	58244	PINION, STEERING	1
30	58274	PIN,DOWEL .2500 OD+1.75LG	1
31	301410	BRNG, FL .752IDX1.081ODX .24	1
32	301398	WASHER, FORMED1.135X1.53X.12	1
33	021682	WASHER, FLAT .765X1.26X.042	1
34	36625	RING, RETEX .57X.05TRU5133-75	1
35	300809	TIRE&RIM,15X6.00-8 TURF S1L330	2
36	24167	VALVE STEM	1
37	39829	WHEEL W/BRG.	1
38	39979	BEARING,FL1.38OD+.753ID	2
39	313952	TIRE, PU 15X6.0X8 TURF ROSH	1
40	542	WASHER, FLAT .765X1.31X.075	4
41	36625	RING, RETEX .57X.05TRU5133-75	2
42	40394	CAP, 1.600ID X 7/8LG HUB	2

* Order Individual Parts.

* Indicates STANDARD HARDWARE ITEMS.

45" LAWN TRACTOR MODEL 84518-040

MOTION DRIVE ASSEMBLY

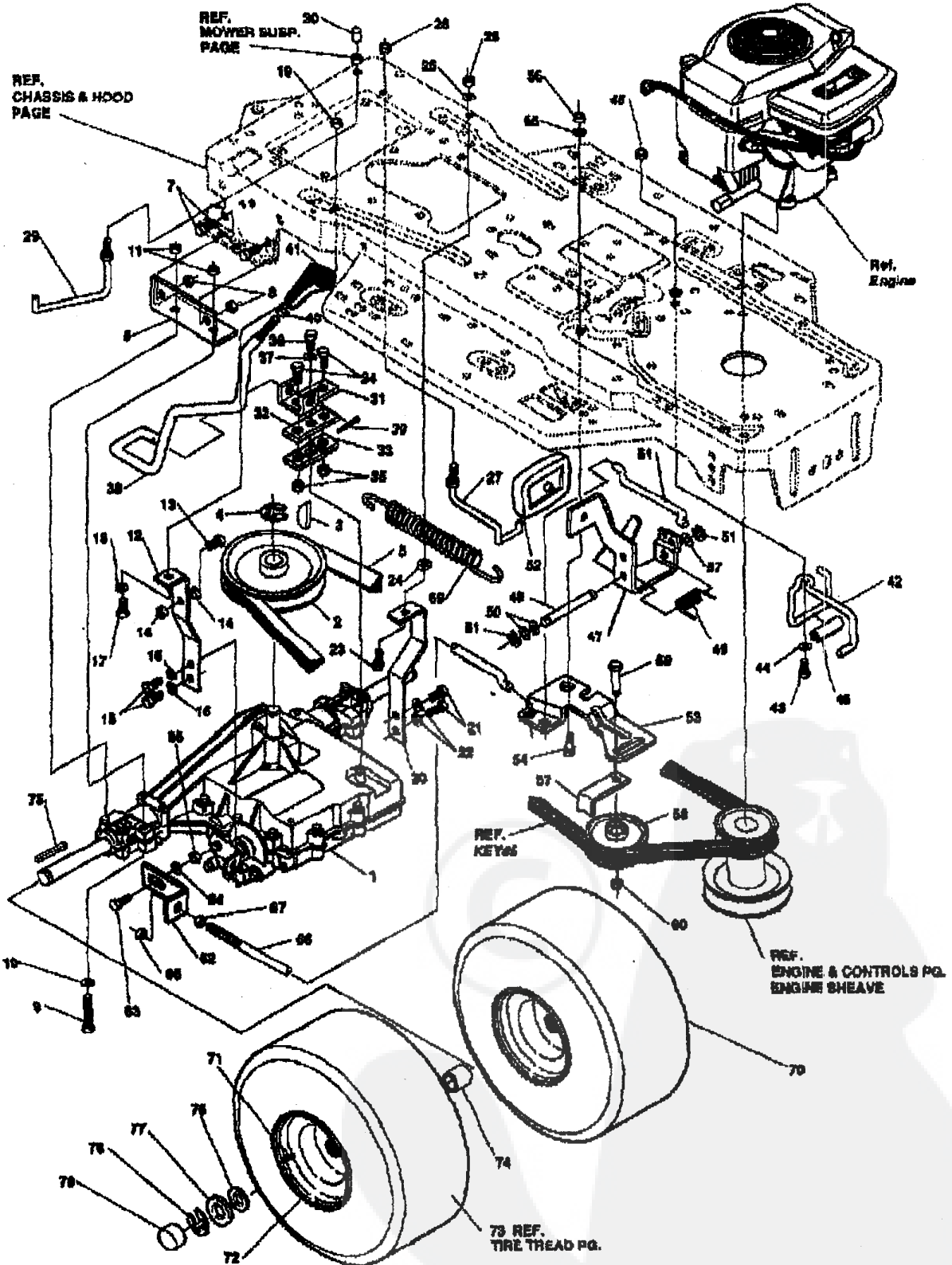

NOTE: ALWAYS USE ORIGINAL EQUIPMENT PARTS.
 Use of service/replacement parts other than original equipment parts may void your warranty.

ALL UNNUMBERED ITEMS ARE INTERCHANGABLE WITH OPPOSITE SIDE

317473A

45" LAWN TRACTOR MODEL B4518-040

key#	part#	description	qty.
1		TRANSAXLE (CONTACT NEAREST DEALER)	1
2	54892	PULLEY, V&L 8.00X .80 180A	1
3	3021	KEY, WDRF 806 .750X .187X .312	1
4	22059	RING, RETEX .58X .04TRU5100-62	1
5	301589	BELT, V 4L 88.8	1
6	317343	BRACKET, TRANSAXLE SUPT	2
7	0180077	SCREW, 5/16-18X .75 HHC GR5	4
8	01498	NUT, 5/16-18 REGHEXCTRLK	4
9	0180112	SCREW, 5/16-18X2.75 HHC GR5	4
10	0120303	WASHER, FLAT .344X .89X .085	4
11	01498	NUT, 5/16-18 REGHEXCTRLK	4
12	57563	BRACKET, STABILIZER RH	1
13	0180080	SCREW, 5/16-18X2.25 HHC GR5	1
14	055273	NUT, 5/16-18 HXWDFLLK	2
16	035498	SCREW, 5/16-18X .75 WAHHTAP	1
18	0120638	WASHER, HVSPTLK 328X.80X.08	1
17	0122017	SCREW, 5/16-18X1.00 HHC GR2	1
18	0138538	WASHER, REGINTLK 320X.61X.03	1
19	01498	NUT, 5/16-18 REGHEXCTRLK	1
20	52848	BRACKET, STABILIZER LH	1
21	035498	SCREW, 5/16-18X .75 WAHHTAP	2
22	120638	WASHER, HVSPTLK 328X.80X.08	2
23	0122017	SCREW, 5/16-18X1.00 HHC GR2	1
24	21882	SPACER, 406 X .625 X .375	1
25	0138538	WASHER, REGINTLK 320X.61X.03	1
26	01498	NUT, 5/16-18 REGHEXCTRLK	1
27	308609	GUIDE, BELT 5/16-18THD 820/801	1
28	01498	NUT, 5/16-18 REGHEXCTRLK	1
29	312124	GUIDE, BELT 801/820 REAR PULLEY	1
30	318198	COVER, THREAD, PLASTIC 5/16 THD	1
31	55517	BRACKET, SHIFT	1
32	56518	BRKT, ADJ	1
33	54685	SHIFT BRKT	1
34	0120229	SCREW, 5/16-18X .88 HHC GR2	2
35	01498	NUT, 5/16-18 REGHEXCTRLK	2
36	056255	SCREW, 1/4-28X .75 NYLHHCGR8	1
37	57157	WASHER, .750X .250 SP-TRANSAXLE	1
38	57850	LEVER, SHIFT, 801PA	1
39	187185	PIN, COTTER .125 DIA X 1.00LG	1
40	0120238	NUT, 1/2-13 HEXIAM	1
41	304488	KNOB, SHIFT NOMA 1/2-13	1
42	58358	GUIDE-BELT/DRAGLINK	1
43	0180079	SCREW, 5/16-18X1.00 HHC GR5	1
44	045802	WASHER, FLAT .333X .87X .119	1
45	01498	NUT, 5/16-18 REGHEXCTRLK	1
46	303278	PLASTIC EXTRUSION-BELT GUIDE	1
47	300308	PEDAL ASSY, BRAKE/CLUTCH LF	1
48	57196	ROD, PIVOT .50 OD+4.44LG	1
49	57847	SPRING, BRAKE PEDAL	1
50	02998	WASHER, FLAT .504X .75X .059	3
61	20864	RING, RET E 39X.04TRU5133-20	2
62	48160	PAD, CLUTCH BRAKE W/PAINING	1
63	300184	ARM, IDLER TRACTION DR, LF	1
64	300793	BOLT, 625X .125 HSSH 5/16-18	1
65	045802	WASHER, FLAT .333X .87X .119	1
66	01498	NUT, 5/16-18 REGHEXCTRLK	1
67	30059	RETAINER, BELT	1
68	35974	PULLEY, IDLER V4L 3.06X .82	1
69	45892	BOLT, 3/8-16X1.50 CARR GR2	1
80	01498	NUT, 3/8-16 REGHXCTRLK	1
81	57204	ROD, CLUTCH	1
82	57217	BRACKET, BRAKE ROD	1
83	20307	BOLT, .497X .185 HSSH 5/16-18	1
84	045802	WASHER, FLAT .333X .87X .119	1
85	01498	NUT, 5/16-18 REGHEXCTRLK	1
86	301588	ROD, BRAKE, 20.7	1
87	0271184	NUT, 5/16-18 HEXKEPS	1
88	01498	NUT, 5/16-18 REGHEXCTRLK	1
89	56359	SPRING, CLUTCH .113X.780X8.75	1
70		TIRE&RIM, PU 20X10-8TURF	2
71	24167	VALVE STEM	1
72	301386	RIM, WHEEL 20X8.00	1
73	313654	TIRE, PU 21X10X8 RDSH	1
74	57744	SPACER, 78 X 1.25 X 1.64	2
75	38828	KEY, SQUARE .18750X2.50LG	2
76	0642	WASHER, FLAT .765X1.31X.075	4
77	042815	WASHER, FLAT .755X1.58X.07	2
78	38825	RING, RETEX .67X.06TRU5133-75	2
79	40394	CAP, 1.500ID X 7/8LG HUB	2

* Order Individual Parts.
 † indicates STANDARD HARDWARE ITEMS.

45" LAWN TRACTOR MODEL B4518-040

ENGINE & CONTROL ASSEMBLY

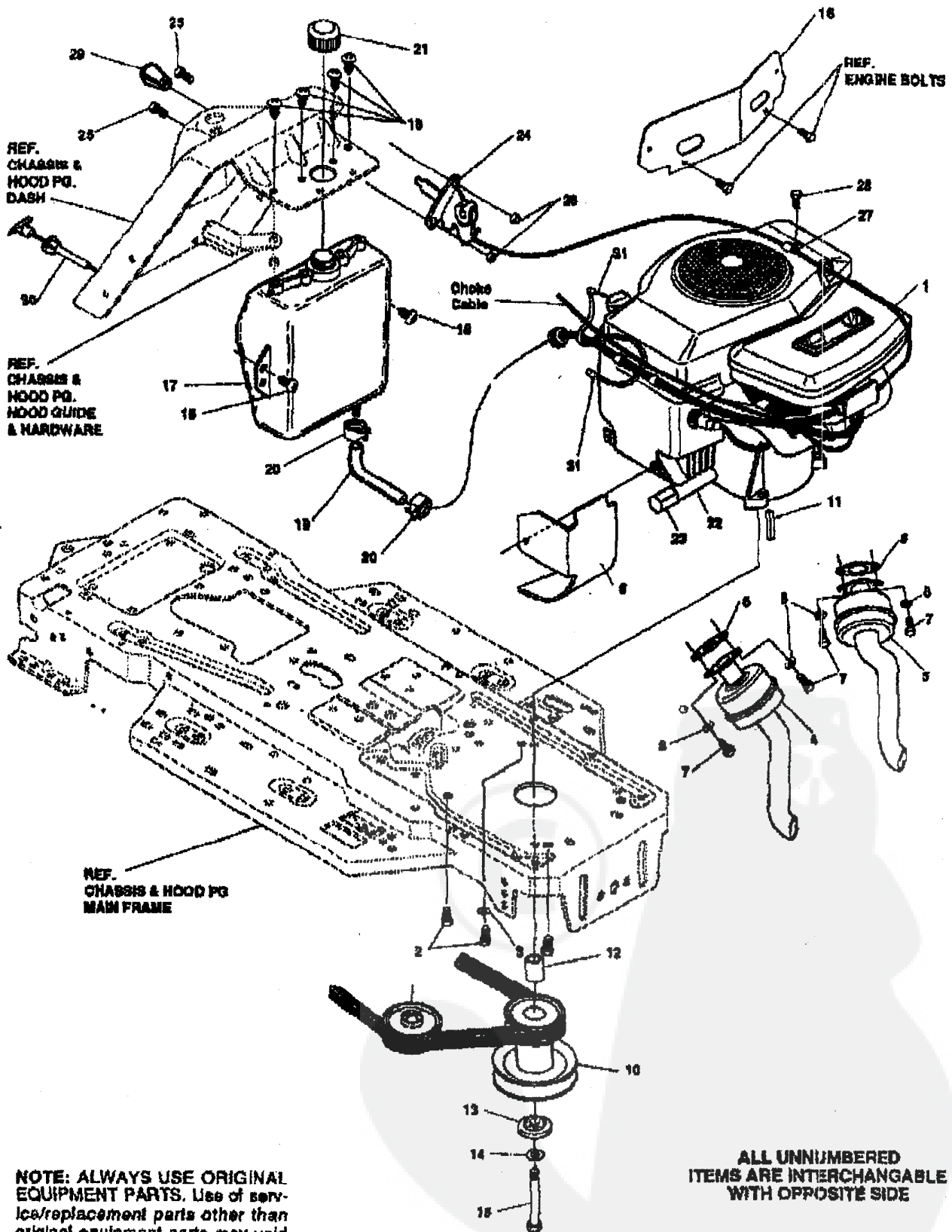

REF. CHASSIS & HOOD PG. DASH

REF. CHASSIS & HOOD PG. HOOD GUIDE & HARDWARE

REF. CHASSIS & HOOD PG. MAIN FRAME

REF. ENGINE BOLTS

Choke Cable

NOTE: ALWAYS USE ORIGINAL EQUIPMENT PARTS. Use of service/replacement parts other than original equipment parts may void your warranty.

ALL UNNUMBERED ITEMS ARE INTERCHANGABLE WITH OPPOSITE SIDE

317446A

ID:

JUL 12'00 15:21 No.018 P.09

45" LAWN TRACTOR MODEL B4518-040

key#	part#	description	qty.
1		ENGINE 18 HP 1/0(SEE ENGINE MANUAL)	1
2	050947	SCREW, 3/8-18X1.25 WAHTAP	4
3	138489	WASHER, EXLK .384X.89X.04	1
4	58144	MUFFLER, RH	1
5	58145	MUFFLER, LH	1
6	58640	GASKET, MUFFLER	2
7	0180020	SCREW, 1/4-20X .75 HHC	4
8	120380	WASHER, REGSPTLK.283X.49X.07	4
9	8820	DEFLECTOR	1
10	58361	PULLEY ASSY.4.75OFFS 5.5DIA	1
11	57791	KEY, SQUARE .250SQX5.00	1
12	904246	SPACER, 1.01X1.484	1
13	58451	WASHER, .980DX1.380DX.437PILOT	1
14	120383	WASHER, REGSPTLK.450X.78X.12	1
15	0425844	SCREW, 7/16-20X5.00 HHC	1
16	7399	BULKHEAD HOOD H-7,8	1
17	314992	TANK,FUEL	1
18	49050	SCREW, 1/4-10X .75PHPNTAP	8
19	47452	GAS LINE .25ID	15.50'
20	48672	CLAMP, FUEL LINE	2
21	46704	GAS CAP 1-1/2-7 THD	1
22	52404	TUBE, OIL DRAIN 3/8-18NPT X 5"	1
23	47825	CAP, PIPE 3/8-18 NPT	1
24	300456	CONTROL, THROTTLE	1
25	158943	SCREW, 10-24X .63PHPNMA	2
26	0271166	NUT, #10-24 HEXKEPS	2
27	58638	RETAINER, WIRE	1
28	35268	SCREW, 10-24X.38 SLHWATAP	1
29	50607	KNOB, ROUND THROTTLE	1
30	300432	CONTROL, CHOKE 47.13LG	1
31	57444	TIE, CABLE	2

0 Indicates STANDARD HARDWARE ITEMS.

ID:

JUL 12'00 15:22 No.018 P.10

45" LAWN TRACTOR MODEL B4518-040

PRE-PAINTED DECK ASSEMBLY

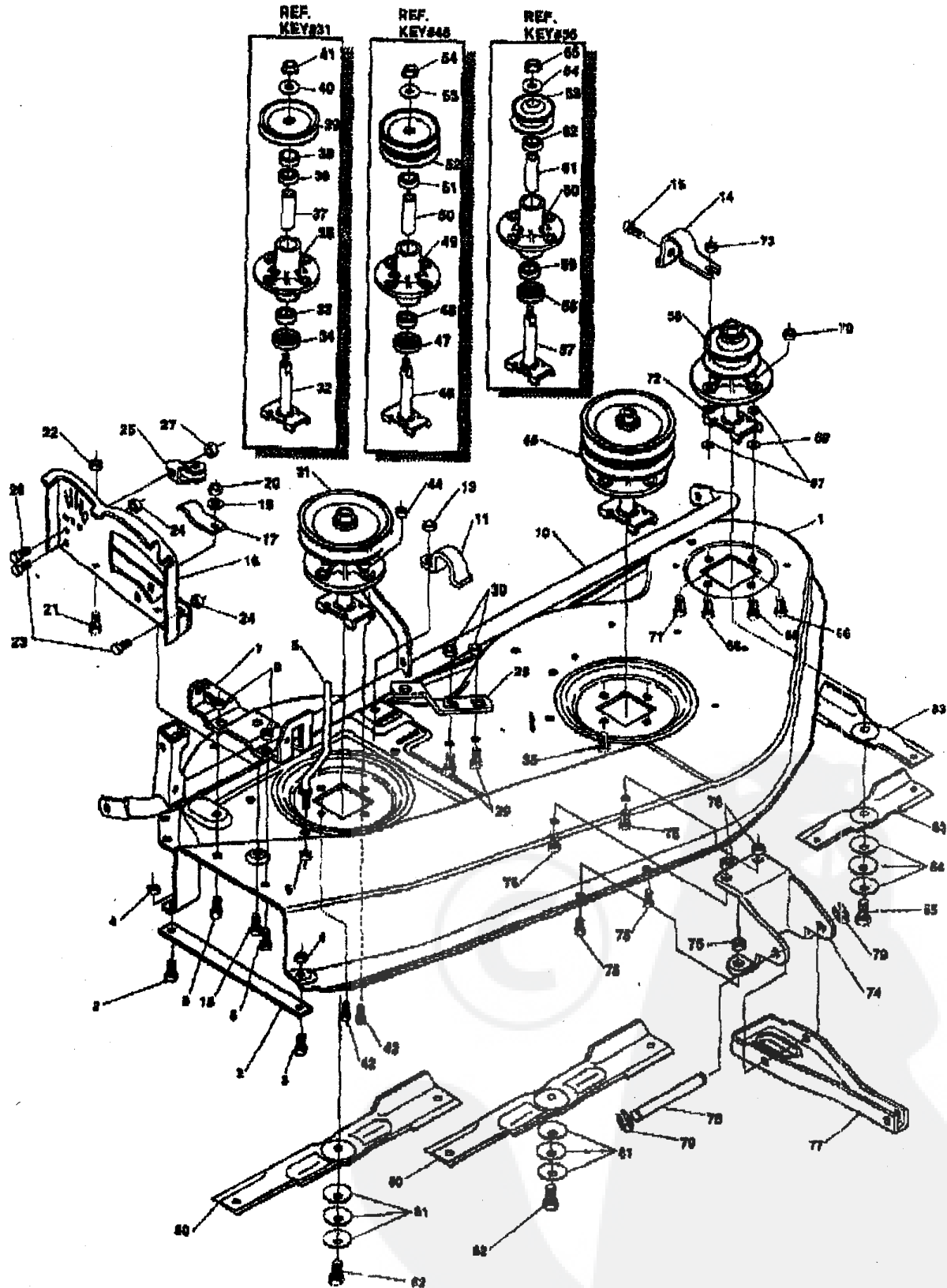

NOTE: ALWAYS USE ORIGINAL EQUIPMENT PARTS. Use of service/replacement parts other than original equipment parts may void your warranty.

ALL UNNUMBERED ITEMS ARE INTERCHANGABLE WITH OPPOSITE SIDE

305675D

45" LAWN TRACTOR MODEL B4518-040

key#	part#	description	qty.
1	311324	DECK	1
2	57314	BAR, SKID	1
3	126216	BOLT, 5/16-18X .75 CARB	1
4	271184	NUT, 5/16-18 HEXEKS	2
5	57318	GUIDE, BELT 5/16-18 THD	2
6	1498	NUT, 5/16-18 REGHEXCTRLK	1
7	57360	BRACKET, CHUTE	1
8	180075	SCREW, 5/16-18X .83 HHC	1
9	1498	NUT, 5/16-18 REGHEXCTRLK	2
10	300322	TUBE, 48" ASSY TORQUE	1
11	51895	SUPPORT PIVOT TUBE	1
12	180076	SCREW, 5/16-18X .83 HHC	1
13	1498	NUT, 5/16-18 REGHEXCTRLK	1
14	300316	BRACKET, TORQUE BAR	1
15	300314	SCREW, 1/4-20X .88 WHTAP	1
16	57337	QUADRANT HEIGHT ADJUST	1
17	57321	SPRING CLUTCH HANDLE RETAIN	1
18	122007	SCREW, 5/16-18X .75 HHC	1
19	120388	WASHER, FLAT .312X .70X .005	1
20	1498	NUT, 5/16-18 REGHEXCTRLK	1
21	122007	SCREW, 5/16-18X .75 HHC	1
22	1498	NUT, 5/16-18 REGHEXCTRLK	1
23	122040	SCREW, 5/16-18X1.50 HHC	2
24	1498	NUT, 5/16-18 REGHEXCTRLK	2
25	49320	CABLE, PULLEY SUPPORT	1
26	120228	SCREW, 5/16-18X .83 HHC	1
27	1498	NUT, 5/16-18 REGHEXCTRLK	1
28	300179	BRACKET, IDLER SUPPORT	1
29	180077	SCREW, 5/16-18X .75 HHC	1
30	44108	NUT, 3/16-18 HWDFLCTRLK	1
31	58424	QUILL ASSY, 30/30/40/43	1
32	58425	SHAFT/SADDLE	1
33	49562	BRNG, BALL	1
34	50818	DUST SHIELD	1
35	55547	QUILL CASTING	1
36	49562	BRNG, BALL	1
37	50818	SPACER, 7/16GX.88HDX.840D	1
38	51449	SPACER, 43/8GX.882ODX.872D-PM	1
39	56390	PULLEY, 20/26" QUILL	1
40	56385	SPECIAL WASHER	1
41	1282	NUT, 7/16-20 WDFLLK	1
42	50634	SCREW, 5/16-18X .88 WHTAP	3
43	300345	SCREW, 5/16-18X1.38 WATAP	1
44	1498	NUT, 5/16-18 REGHEXCTRLK	1
45	304078	ASSY, QUILL-45SD MIDDLE	1
46	58166	SHAFT/SADDLE, RH QUILL	1
47	50818	DUST SHIELD	1
48	49562	BRNG, BALL	1
49	58124	QUILL CASTING RH	1
50	58128	SPACER, L/RH QUILL	1
51	49562	BRNG, BALL	1
52	304077	ASSY, PULLEY-DOUBLE	1
53	56385	SPECIAL WASHER	1
54	1282	NUT, 7/16-20 WDFLLK	1
55	50634	SCREW, 5/16-18X .88 WHTAP	4
56	58125	QUILL, 48" ASSY LH	1
57	58122	SADDLE & SHAFT	1
58	50818	DUST SHIELD	1
59	49562	BRNG, BALL	1
60	58162	QUILL CASTING LH	1
61	58128	SPACER, L/RH QUILL	1
62	49562	BRNG, BALL	1
63	300294	PULLEY HALF, LH QUILL	2
64	56385	SPECIAL WASHER	1
65	1282	NUT, 7/16-20 WDFLLK	1
66	50634	SCREW, 5/16-18X .88 WHTAP	2
67	78757	WASHER, FLAT .330X .75X.1700	2
68	300345	SCREW, 5/16-18X1.38 WATAP	1
69	78787	WASHER, FLAT .330X .75X.1700	1
70	1498	NUT, 5/16-18 REGHEXCTRLK	1
71	300345	SCREW, 5/16-18X1.38 WATAP	1
72	78787	WASHER, FLAT .330X .75X.1700	1
73	120376	NUT, 5/16-18 REGHEX	1
74	57327	BRACKET, FRONT	1
75	120228	SCREW, 5/16-18X .83 HHC	4
76	1498	NUT, 5/16-18 REGHEXCTRLK	4
77	57340	BRACKET, FRONT LIFT	1
78	57198	ROD, PIVOT .50 OD+1.44LG	1
79	20664	RING, RET E .38X.04TRUS183-50	2
80	58212	BLADE, 18.13 HIGH-LIFT	2
81	2488	WASHER, 3/16X1.25OX.D7 BELLVH	6
82	38573	SCREW, 3/8-24X1.00 NYLHHC	2
83	300323	BLADE, 8.41 BARON MED-LIFT	2
84	2483	WASHER, 3/16X1.25OX.D7 BELLVH	3
85	38573	SCREW, 3/8-24X1.00 NYLHHC	1

0 indicates STANDARD HARDWARE ITEMS.

45" LAWN TRACTOR MODEL B4518-040

FINAL DECK ASSEMBLY

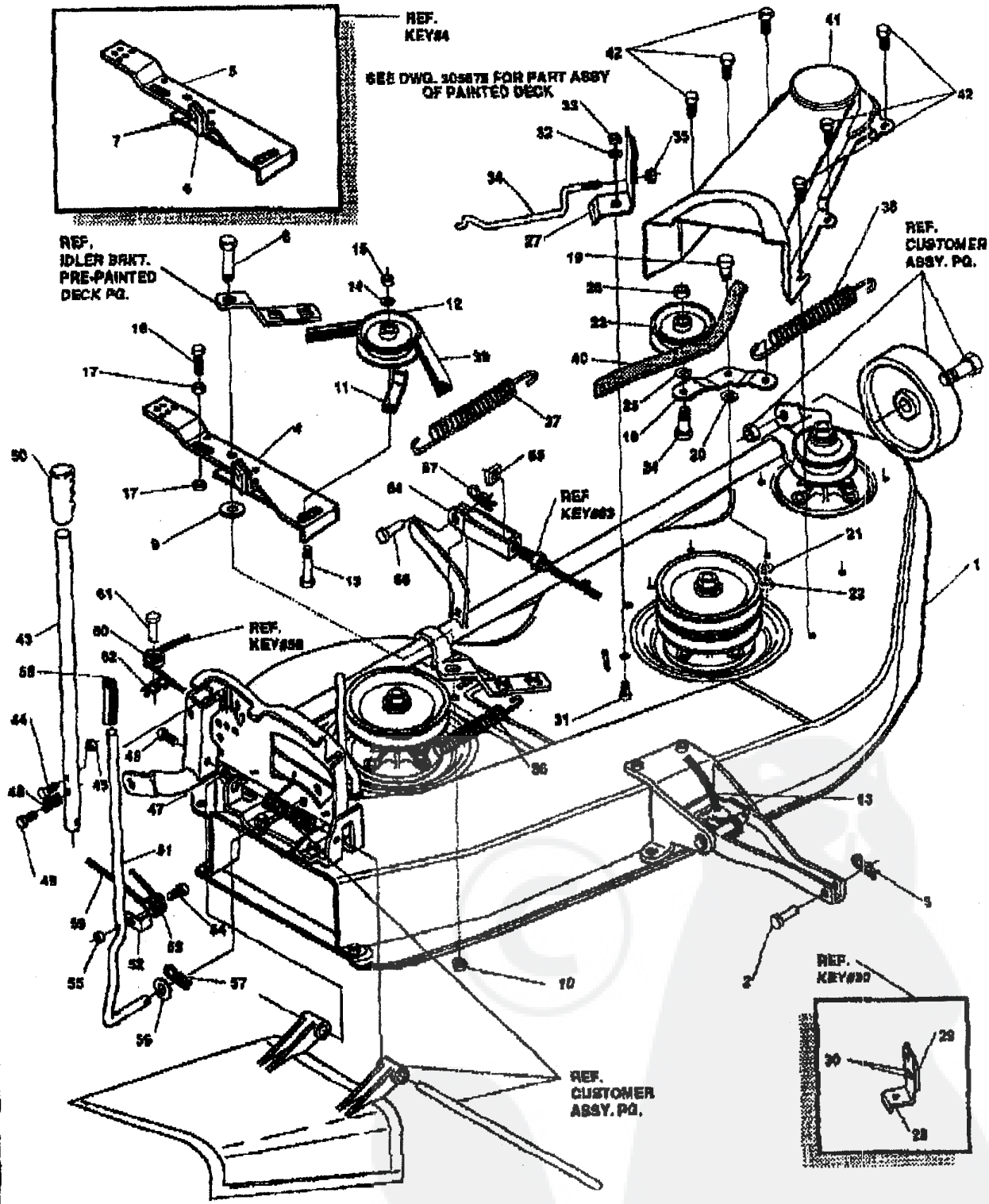

NOTE: ALWAYS USE ORIGINAL EQUIPMENT PARTS.
 Use of service/replacement parts other than original equipment parts may void your warranty.

ALL UNNUMBERED ITEMS ARE INTERCHANGABLE WITH OPPOSITE SIDE

3056501

ID:

JUL 12 '00 15:24 No.018 P.13

45" LAWN TRACTOR MODEL B4518-040

key#	part#	description	qty.
1	*	DECK ASSEMBLY	1
2	47816	PIN, .495X1.750 CLEVIS-SHORT	1
3	56180	PIN, HAIR .091 DIA X1.62LG	1
4	300491	BRACKET, IDLER ARM/BRAKE	1
5	9282	IDLER ARM	1
6	306973	BRAKE PAD	1
7	135624	RIVET, TRSET .185DIA X .41	2
8	900180	BOLT, .50 X1.88 HSH 3/8-16	1
9	996416	WASHER, FLAT .391X1.00X.125	1
10	45171	NUT, 3/8-16 HWD FL WHIZ-LOCK	1
11	1346	BELT RETAINER 2.56 OD	1
12	310326	PULLEY, IDLER BFF 4.00 WIDE FL	1
13	57325	BOLT, 3/8-16X2.00 CARR	1
14	0120382	WASHER, REGSPTLK.393X.68X.10	1
15	0120377	NUT, 3/8-16 REGHX	1
16	0121954	SCREW, 1/4-20X2.00 HHC	1
17	0271172	NUT, 1/4-20 REGHEXKEPS	2
18	1343	IDLER ARM	1
19	41890	BOLT, .625X .216 HHSH 5/16-18	1
20	4107	WASHER, FLAT .635X1.31X.07	1
21	120393	WASHER, FLAT .344X .69X.085	1
22	01488	NUT, 5/16-18 REGHEXOTRKL	1
23	300920	PULLEY, IDLER BFF	1
24	45892	BOLT, 3/8-16X1.50 CARR	1
25	0120392	WASHER, REGSPTLK.393X.68X.10	1
26	0120377	NUT, 3/8-16 REGHX	1
27	303247	ASSY, BLADE BRAKE	1
28	12542	BRAKE ARM	1
29	306973	BRAKE PAD	1
30	135624	RIVET, TRSET .185DIA X .41LG ST	2
31	0120228	SCREW, 5/16-18X .63 HHC	1
32	120393	WASHER, FLAT .344X .69X.065	1
33	01488	NUT, 5/16-18 REGHEXCTRLK	1
34	300315	ROD, BRAKE RELEASE 35845 DECKS	1
35	01502	NUT, 1/4-20 REGHEXCTRLK	1
36	35410	SPRING .071 X .62 X 4.97	1
37	300683	SPRING, .75X6.3X.105 TENSION	1
38	300215	SPRING, TENSION 4.75LG 28LB/IN	1
39	58170	BELT, V 6L 75.25 36/45 8D	1
40	300142	BELT, V 4L 40.50 RAW EDGE GLAS	1
41	300238	COVER, BELT, 45" DECK	1
42	40886	SCREW, 1/4-20X .35 WAHTAP	6
43	318837	LEVER, DECK HEIGHT ADJUST	1
44	57324	BOLT, 5/16-18X.56 SPCLHD LATCH	1
45	0271184	NUT, 5/16-18 HEXKEPS	1
46	0122040	SCREW, 5/16-18X1.50 HHC	1
47	01488	NUT, 5/16-18 REGHEXCTRLK	1
48	57319	SPRING, .70X.85X.091 COM HANDLE	1
49	995338	SCREW, 1/4-20X .63 HHWATAP	1
50	58924	GRIP, .75 X 4.25 HANDLE	1
51	313636	LEVER, CLUTCH	1
52	1288	BRKT, CABLE RETAINER	1
53	39298	PULLEY, .906X.305 NYLON	1
54	57322	BOLT, .375X .375 HSH 1/4-20	1
55	01502	NUT, 1/4-20 REGHEXCTRLK	1
56	120396	WASHER, FLAT .531X1.06X.095	1
57	8260	PIN, HAIR .091 DIA X1.69LG	1
58	48478	GRIP, HAND .50ID 8.37LG	1
59	57326	CABLE, CLUTCH 17.5"	1
60	39298	PULLEY, .906X.305 NYLON	1
61	49332	PIN, CLEVIS .375DX.81LG	1
62	121222	PIN, COTTER .090X.088X.78LG	1
63	58166	CABLE, DECK LIFT, 21.28"	1
64	9405	CLEVIS, LIFT CABLE	1
65	0120372	NUT, 1/4-20 REGSD	1
66	39522	PIN, CLEVIS .312 X .812	1
67	56160	PIN, HAIR .091 DIA X1.62LG	1

* ORDER INDIVIDUAL PARTS.
 o STANDARD HARDWARE ITEMS

45" LAWN TRACTOR MODEL B4518-040

ELECTRICAL ASSEMBLY

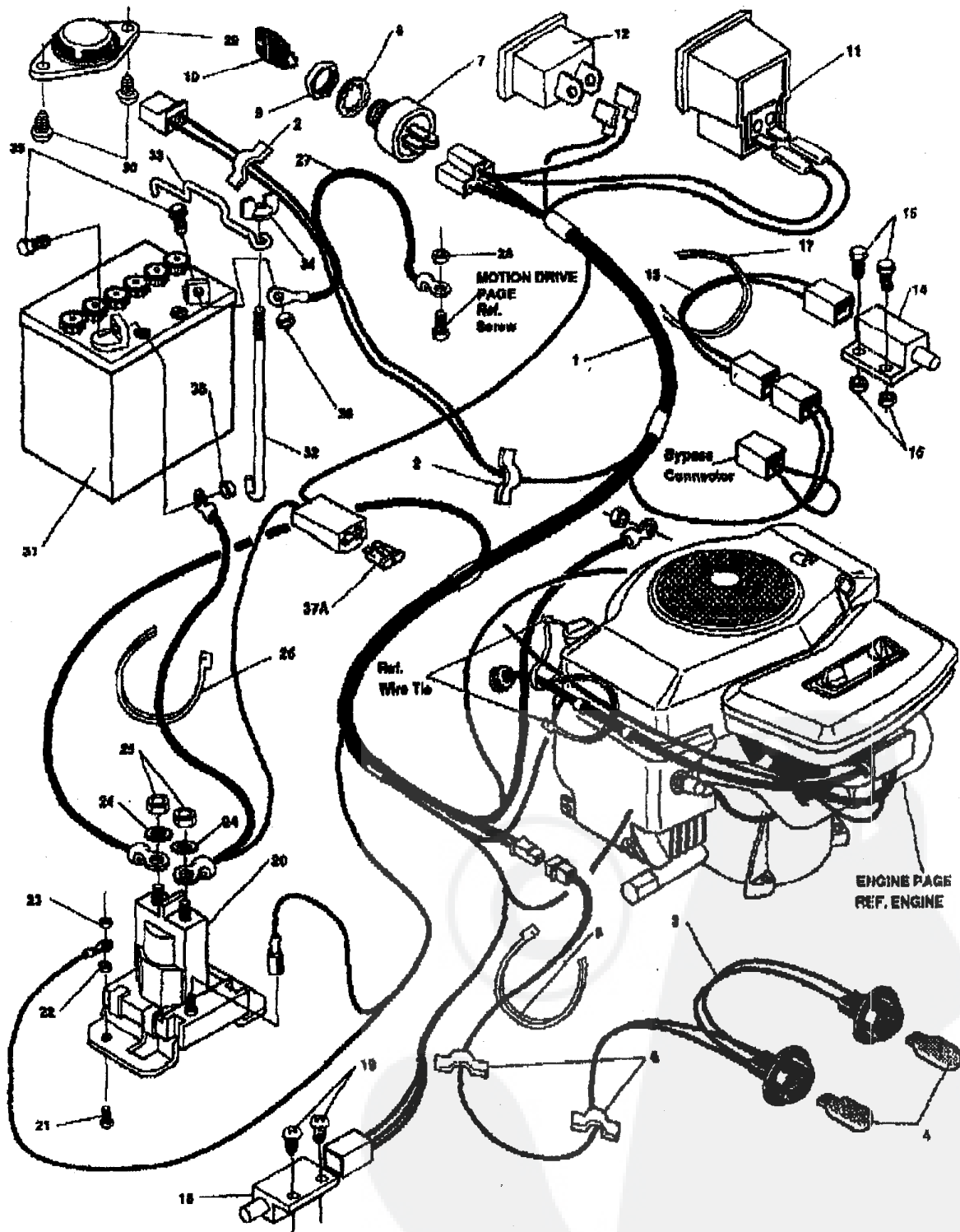

NOTE: ALWAYS USE ORIGINAL EQUIPMENT PARTS.
 Use of service/replacement parts other than original equipment parts may void your warranty.

**ALL UNNUMBERED
 ITEMS ARE INTERCHANGABLE
 WITH OPPOSITE SIDE**

3177706

45" LAWN TRACTOR MODEL B4518-040

key#	part#	description	qty.
1	301917	WIRE HARNESS TWIN B&S GS	1
2	41482	CLIP, 1.380LG .255ID PRESS WIRE	2
3	303064	ASSY, LIGHT WIRE-1/4 TURN	1
4	52572	BULB, HEADLAMP	2
5	57444	TIE, CABLE BLACK NYLON 5.62L	1
6	41482	CLIP, 1.380LG .255ID PRESS WIRE	2
7	300697	SWITCH, IGNITION & LIGHTS	1
8	138557	WASHER, REGINTLK.840X1.1X.05	1
9	48140	NUT, 5/8-32 HXHD IGN SWIT	1
10	300828	KEY, IGNITION SWITCH	2
11	300133	AMMETER, PANEL MOUNT	1
12	300255	LIGHT, INDICATOR PANEL	1
13	57588	HARNESS, DECK WIRE	1
14	57476	SWITCH, SCR MNT DP NC NO	1
15	159943	SCREW, 10-24X .53PHPNMA	2
16	271186	NUT, #10-24 HEXKEPS	2
17	57444	TIE, CABLE BLACK NYLON 5.62	1
18	57211	SWITCH, SCR MNT 8P	1
19	57220	SCREW, #12 X .50 PHPNHTAP	2
20	53718	SOLENOID, NEW CLUM	1
21	187745	SCREW, 1/4-20X .75 HXSEMMA	2
22	1502	NUT, 1/4-20 REGHEXOTRLK	2
23	271172	NUT, 1/4-20 REGHEXKEPS	1
24	138485	WASHER, EXLK.320X.81X.03	2
25	120368	NUT, 5/16-24 REGHEX	2
26	57444	TIE, CABLE BLACK NYLON 5.62L	1
27	56611	WIRE, GROUND, 12.5"	1
28	271184	NUT, 5/16-18 HEXKEPS	1
29	57547	SWITCH, SEAT	1
30	180505	SCREW, 1/4-20X .38PHPNHMA	2
31	302257	BATTERY 12V 7 PLATE	1
32	57851	ROD, BATTERY	1
33	57552	ROD, BATTERY, TOP	1
34	310067	NUT, WRNG 1/4-20 SMALL PLASTIC	1
35	120854	SCREW, 1/4-20X .63 HHC	2
36	271172	NUT, 1/4-20 REGHEXKEPS	2
37A	** 302031	FUSE, 15 AMP SPADE TYPE	1
37B	** 48211	FUSE, 15 AMP CYLINDRICAL TYPE	1

**Cylindrical or Spade type fuses included with the wire harness.

45" LAWN TRACTOR MODEL B4518-040

DECALS

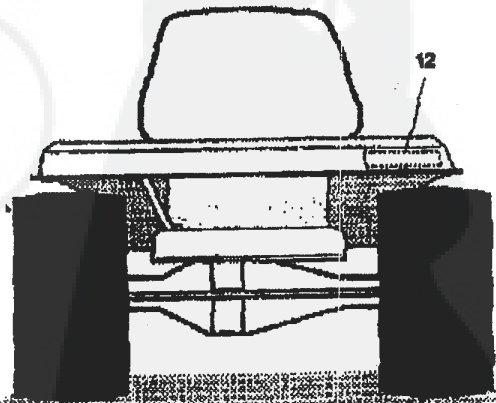
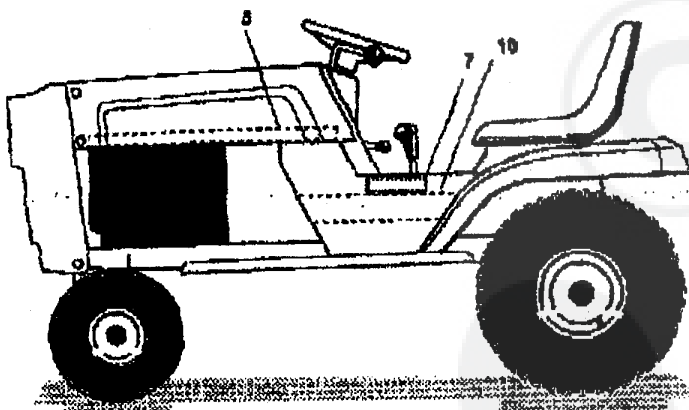
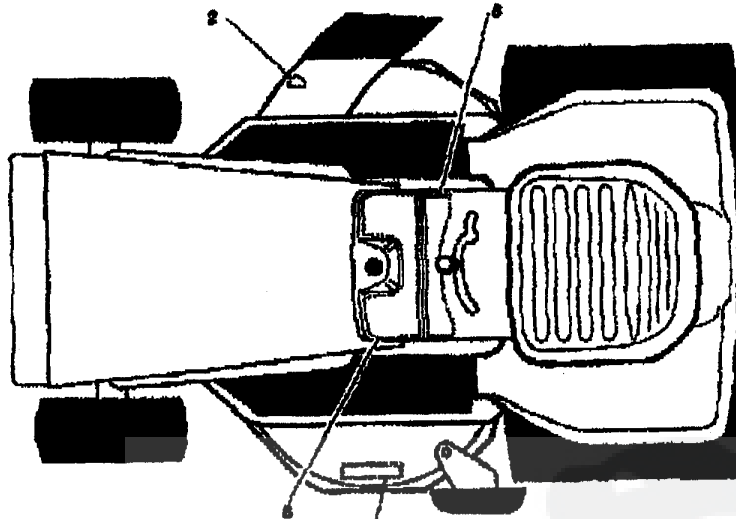
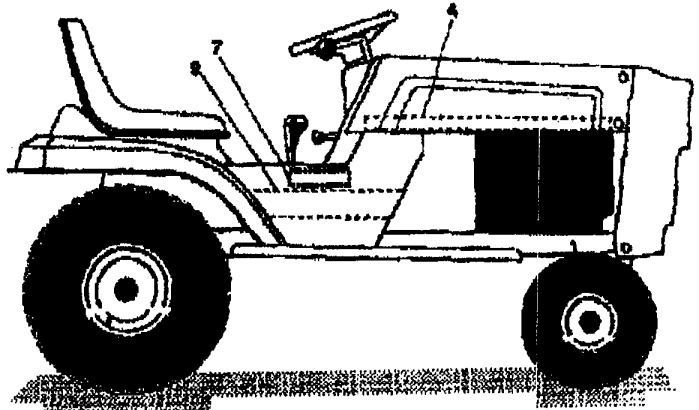
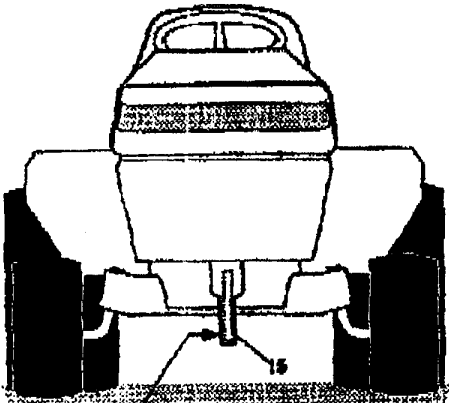

NOTE: ALWAYS USE ORIGINAL EQUIPMENT PARTS.
 Use of service/replacement parts other than original equipment parts may void your warranty.

**ALL UNNUMBERED
 ITEMS ARE INTERCHANGABLE
 WITH OPPOSITE SIDE**

3151270

45" LAWN TRACTOR MODEL B4518-040

key#	part#	description	qty.
1	68249	DECAL, NO STEP	1
2	68547	DECAL, CUT-HAND WARNING LABEL	1
3		REFERENCE ONLY	1
4	314456	DECAL, HOODSIDE RH	1
5	314457	DECAL, HOODSIDE LH	1
6	302862	DECAL, DASH CHOKE, I, L, M, M, G, S	1
7	300444	NAMEPLATE, 18/45	2
8	302866	DECAL, CONSOLE P801-5&F4360-6SP	1
9	314462	DECAL, CONSOLE RH LARGE FRAME	1
10	314463	DECAL, CONSOLE LH LARGE FRAME	1
11		REFERENCE ONLY	1
12	302866	NAME PLATE, SM. DYNAMARK	1
13	68180	DECAL, HANGER RH ENGLISH	1
14	68181	DECAL, HANGER LH ENGLISH	1
15	70574	DECAL, CAUTION DECK HARNESS	1

45" LAWN TRACTOR MODEL B4518-040

CUSTOMER ASSEMBLY

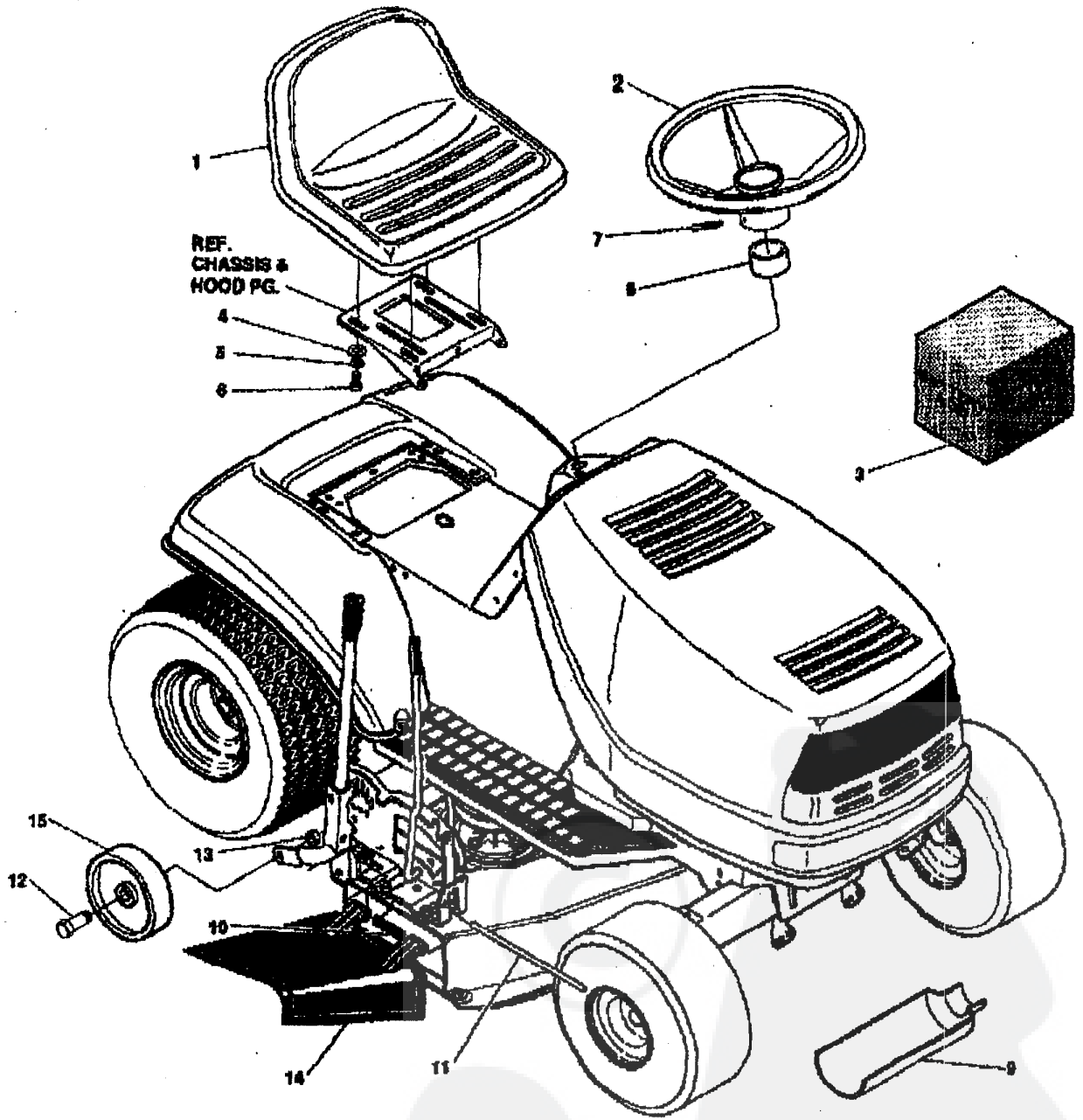

317370B

45" LAWN TRACTOR MODEL B4518-040

CUSTOMER ASSEMBLY VIEW

317371 PARTS BAG ASSY QTY1

key#	part#	description	qty
1	67454	SEAT MV450	1
2	301251	STEERING WHEEL	1
3	52778	BATTERY ACID PACK	1
4	120393	WASHER, FLAT .344X.69X.065	4
5	120638	WASHER, HV5PTLK .328X.60X.09	4
6	122007	SCREW, 5/16-18X.75 RHC	4
7	456378	PIN, SPRING .250DIA X2.00LG	1
8	57212	COVER, STEERING SHAFT	1
9	64873	OIL TROUGH	1
10	314973	TORSION SPRING	1
11	57317	ROD, PIVOT	1
12	23783	BOLT, .500X1.380 HHSH 3/8-18	2
13	1495	NUT, 3/8-18 REGHXCTRLK	2
14	57818	CHUTE DEFLECTOR	1
15	52584	DECK WHEEL	2