

# TRACTEUR TONDEUSE 36" MODELE C3554-300

## ENSEMBLE CRASSIS & CAPOT

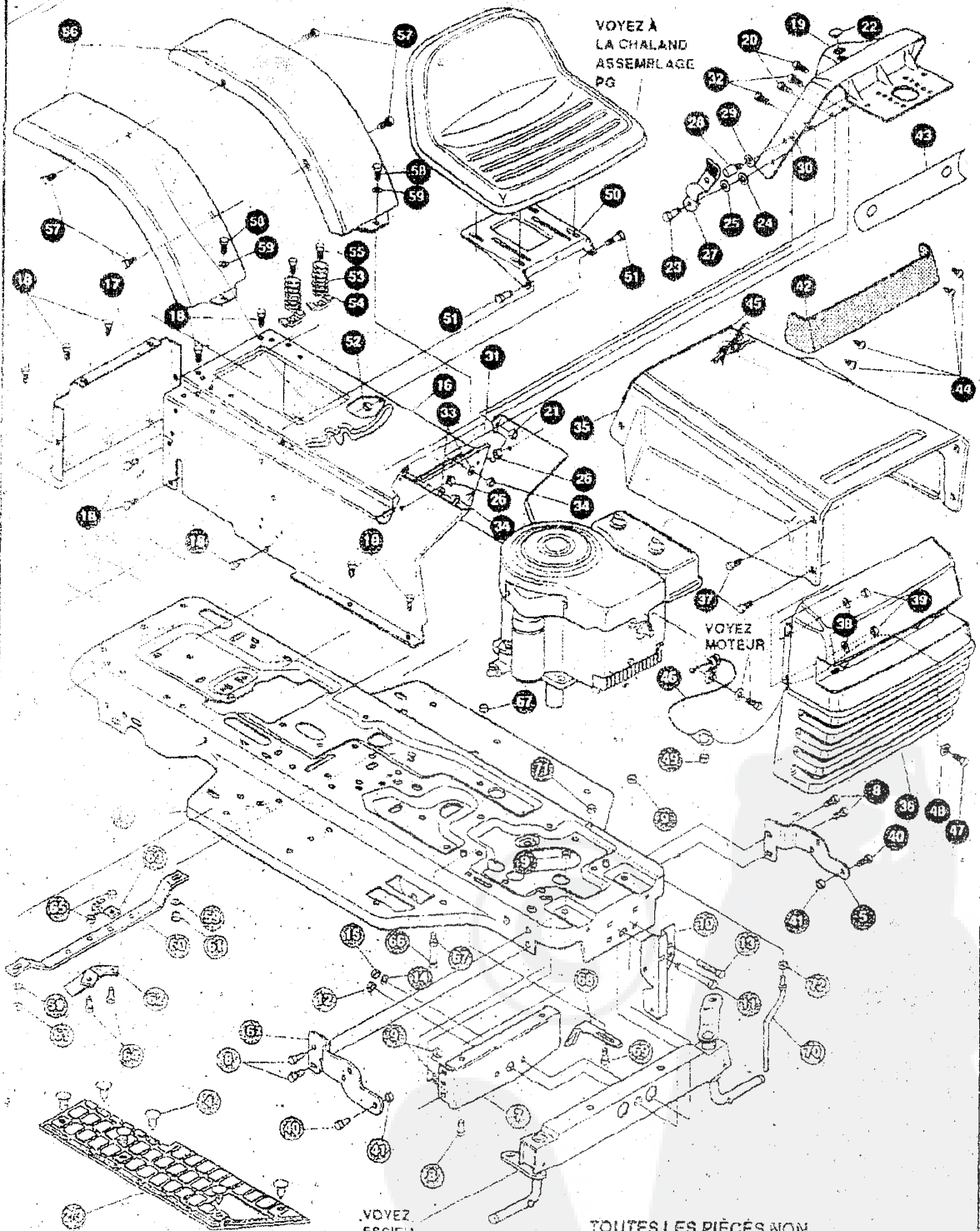

VOYEZ A LA CHALAND ASSEMBLAGE PG

VOYEZ MOTEUR

VOYEZ ESSIEU AVANT

UTILISEZ DES PIÈCES D'ORIGINE POUR CONSERVER L'APPLICATION DE LA GARANTIE.

TOUTES LES PIÈCES NON REFEREES SONT INTERCHANGEABLES AVEC LEURS OPPOSEES.

324047A

# TRACTEUR TONDEUSE 36" MODELE C3554-090

Key#	Part#	Description	Qty.
1	314883-854	FRAME MAIN SF R DER	1
2	310003	FOOTPAD, LH	1
3	310004	FOOTPAD, RH	1
4	309235	FASTENER, RATCHET	12
5	314579-853	BRACKET, GRILLE L.H.	1
6	314578-853	BRACKET, GRILLE R.H.	1
7	56362-853	BRKT, SUPT FRT AXLE	1
a	56030	SCREW, 5/16-18X.75WDFLLK	6
9	55273	NUT, 5/16-18 HXWDFLLK	6
10	56261-853	HANGER BRKT	1
11	50720	BOLT, .625X2.875 SPSH 1/2-20	1
12	274854	NUT, 1/2-20 REGHXCTRLK	1
13	122201	SCREW, 3/8-16X2.75 HHC	1
14	2483	WASHER, .391DX1.25DX.07BELLVIL	1
15	1499	NUT, 3/8-16REGHXCTRLK	1
16	319929-854	CONSOLE, SF DYNA STYLE TOPSH	1
17	56235-854	CONSOLE, REAR COVER	1
18	995346	SCREW, 1/4-20X.50 WAHHTAP	15
19	320466-853	DASH, SF NOMA DYNA STYLING	1
20	995338	SCREW, 1/4-20X.63 HHWATAP	2
21	50352	NUT 1/4-20 WDFLLK TOP LOCK	2
22	318202	PLUG DOME	1
23	8482	BOLT, .375X .156 HSSH 5/16-18	2
24	120394	WASHER, FLAT .406X .81X.065	2
25	120393	WASHER, FLAT .344X .69X.065	2
26	1498	NUT, 5/16-18 REGHEXCTRLK	2
27	57159	LATCH, .94WDX.047 ASSY HOOD	2
28	53446	PIN, 5/16-18 HOOD LATCH	2
29	138538	WASHER, REGINTLK.320X.61X.03	2
30	45174	NUT, 5/16-18HEXWDFLLK WHIZ	2
31	312306	BAFFLE, CONSOLE SGUNDEXPORT	1
32	995338	SCREW, 1/4-20X.63WAHHTAP	2
33	120393	WASHER, FLAT- .344X .69X.065	2
34	1502	NUT, 1/4-20 REGHEXCTRLK	2
35	314538-854	HOOD	1
36	314476	GRILLE, DYNA-PRO	1
37	274672	SCREW, 1/4-20X.63 WAHHC	4
38	120392	WASHER, FLAT .281X .63X.065	4
39	1502	NUT, 1/4-20 REGHEXCTRLK	4
40	36149	BOLT, .375X .500 HSSH 5/16-18	2
41	1498	NUT, 5/16-18 REGHEXCTRLK	2
42	302333	LENS, HEADLAMP	1
43	314948	FOIL, LENS DYNA-PRO REFLECTOR	1
44	57796	SCREW, #6 X .50 PLASTITE	4
45	47453	EDGING, WIDE BLK	25
46	310749	LANYARD, HOOD	1
47	121887	SCREW, 1/4-20 X .75 HHC	1
48	120392	FLATWASHER, .281X .63 X .055	1
49	1502	LOCKNUT 1/4-20	1
50	58367-853	PLATE, SEAT F-5 SF 8 LF	1
51	20507	BOLT, .437X.156 HSSH 5/16-18	2
52	1498	NUT, 5/16-18 REGHEXCTRLK	2
53	56220	SPRING, 1.43X2.38X.162 COM SEAT	2
54	1341	CLAMP, SPRING 1.17"ID	2
55	995346	SCREW, 1/4-20X.50 WAHHTAP	2
56	43970-854	FENDER	2
57	995346	SCREW, 1/4-20X.50 WAHHTAP	4
58	122017	SCREW, 5/16-18X1.00 HHC	2
59	446363	WASHER, FLAT .375X .88X.082	4
60	43964	SUPPORT GUIDE	1
61	1498	NUT, 5/16-18 REGHEXCTRLK	1
62	44500	REAR DECK GUIDE	1
63	57569	RETAINER, .311D X .62 X .03 WIRE	1
64	122017	SCREW, 5/16-18 X 1.00 HHC GR2	2
65	1498	NUT, 5/16-18 REGHEXCTRLK	2
66	49930	SCREW, 3/8-16X 7.50 HHC	1
67	1498	NUT, 3/8-16 REGHEXCTRLK	2
68	30261 O-a53	BRACKET, SWITCH MOUNT	1
69	995346	SCREW, 1/4-20X.50 WAHHTAP	1
70	50653	GUIDE, BELT	1
71	41529	NUT, 3/8-16 HXCTRLKJAM	1
72	271190	NUT, 3/8-16 HEXKEPS	1
73	324266	OPERATOR'S MANUAL FRENCH	1
74	324549	PARTS MANUAL FRENCH	1

- STANDARD HARDWARE ITEMS.

**TRACTEUR TONDEUSE 36" MODÈLE C3554-090**

**ENSEMBLE DIRECTION AVANT**

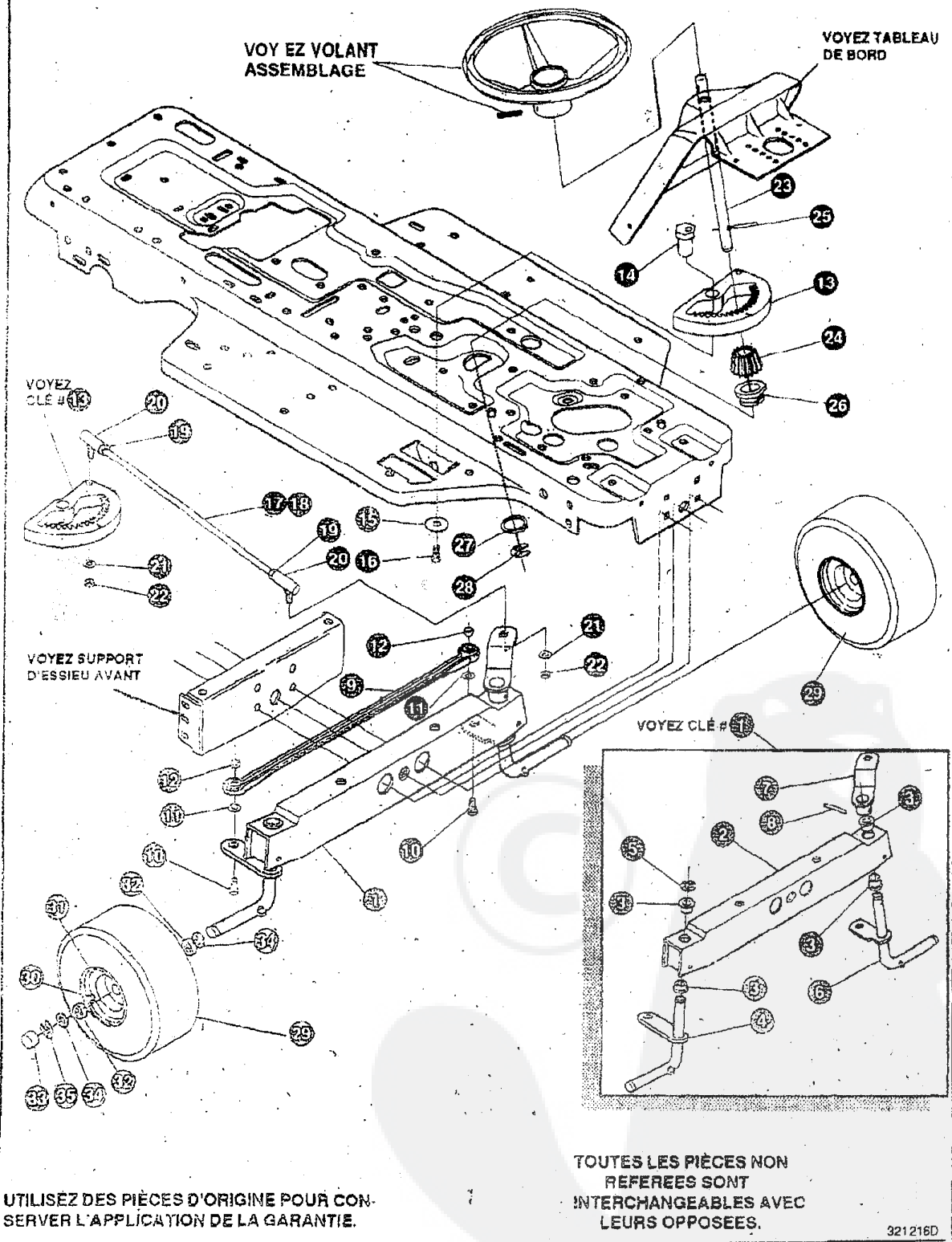

# TRACTEUR TONDEUSE 36" MODELE C3554-090

## CARTER DE TONDEUSE

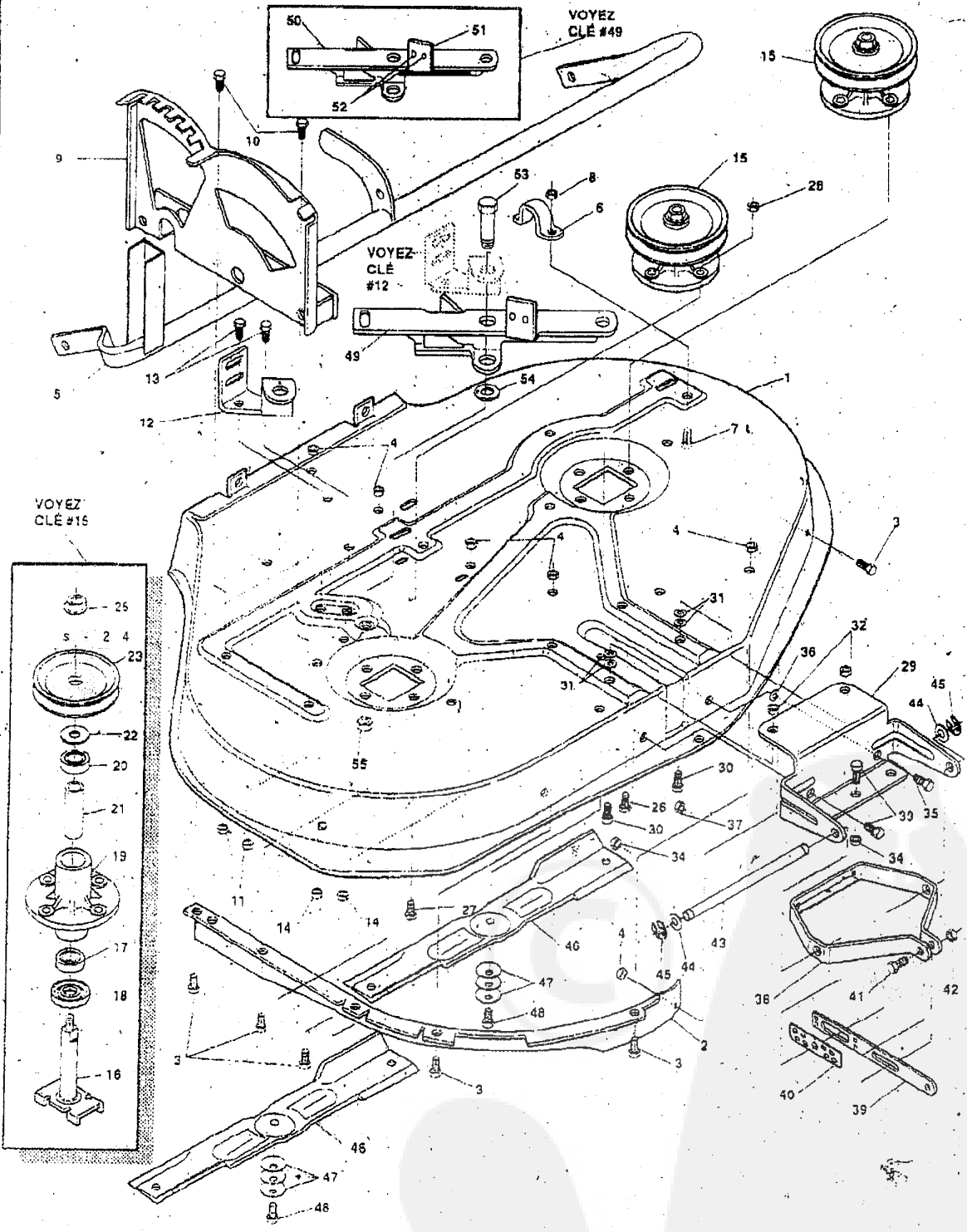

UTILISEZ DES PIÈCES D'ORIGINE POUR CONSERVER L'APPLICATION DE LA GARANTIE.

TOUTES LES PIÈCES NON REFERÉES SONT INTERCHANGEABLES AVEC LEURS OPPOSÉS.

316030B

**TRACTEUR TONDEUSE 36" MODELE C3554-090**

Key#	Part#	Description	Qty.
1	55663-1 73	DECK, 36WH RDMOWER	1
2	55655	BAFFLE, 36RD LH DECK	1
3	0 1 2 0 2 2 8	SCREW, 5/16-18X.63 HHC	6
4	01498	NUT, 5/16-18 REGHEXCTRLK	6
5	52613	ASSY TORQUE TUBE	1
6	51985	SUPPORT, PIVOT TUBE	1
7	0 1 2 0 8 3 4	SCREW, 5/16-18X.50 HHC	1
8	01498	NUT, 5/16-18 REGHEXCTRLK	1
9	53247	QUADRANT	1
10	0120834	SCREW, 5/16-18X.50 HHC	2
11	0 1498	NUT, 5/16-18 REGHEXCTRLK	2
12	57514	BRACKET, IDLER	1
13	0 120228	SCREW, 5/16-18X.63 HHC	2
14	0 1498	NUT, 5/16-18 REGHEXCTRLK	2
15	56424	QUILL ASSY, 36/39/40/43	2
16	56425	SHAFT/SADDLE 36"	1
17	49562	BRNG, BALL	1
18	5 0 6 1 6	DUST SHIELD	1
19	55547	QUILL CASTING	1
20	49562	BRNG, BALL	1
21	50818	SPACER, 3.797LGX.669IDX.88	1
22	51449	S P A C E R , .438LGX.932ODX.672	1
23	56390	PULLEY, 26/36" QUILL	1
24	.56365	SPECIAL WASHER	1
25	01282	NUT, 7/16-20 WDFLLK	1
26	050634	SCREW, 5/16-18X.88 WAHHTAP	7
27	0 300345	SCREW, 5/16-18X1.38 WATAP	1
28	01498	NUT, 5/16-18 REGHEXCTRLK	1
29	46676	LIFT PLATE	1
30	0 1 2 2 0 0 7	SCREW, 5/16-18X.75 HHC	2
31	9 9 6 4 1 6	WASHER, FLAT .391X1.00X.125	4
32	01498	NUT, 5/16-18 REGHEXCTRLK	2
33	0 120228	SCREW, 5/16-18X.63 HHC	2
34	01498	NUT, 5/16-18 REGHEXCTRLK	2
35	0 122017	SCREW, 5/16-18X1.00 HHC	1
36	996416	WASHER, FLAT .391X1.00X.125	1
37	0 1 4 9 8	NUT, 5/16-18 REGHEXCTRLK	1
38	50613	BRACKET, PIVOT	1
39	49059	BAR, HITCH	1
40	49058	BRACKET, LOCK	1
41	0 120918	SCREW, 3/8-16X1.50HHC	1
42	0 1499	NUT, 3/8-16 REGHXCTRLK	1
43	5 57.24	PIN, PIVOT ROD .50DX7.55	1
44	996425	WASHER, FLAT .515X.88X.064	2
45	2 0 8 6 4	RING, RETE .39X.04TRU5133-50	2
46	56821	BLADE, 36" STD-LIFT 18	2
47	2483	WASHER, .39IDX1.25DX.07BELLVIL	6
48	039573	SCREW, 3/8-24X1.00 NYLHHC	2
49	3 1 1 4 2 7	IDLER ASSY, PIVOT ARM	1
50	311425-853	PIVOT ARM IDLER	1
51	306973	BRAKE PAD-HARD-232 AF	1
52	41607	RIVET, OVSET .187 DIA X .50 LG	2
53	47516	BOLT, .5001.950HHSH 3/8-16	1
54	996416	WASHER, FLAT .391X1.00X.125	1
55	0 1 4 9 9	NUT, 3/8-16 REGHXCTRLK	1

0 Indicates STANDARD HARDWARE ITEMS.

**TRACTEUR TONDEUSE 36" MODELE C3554-090**

**CARTER DE TONDEUSE**

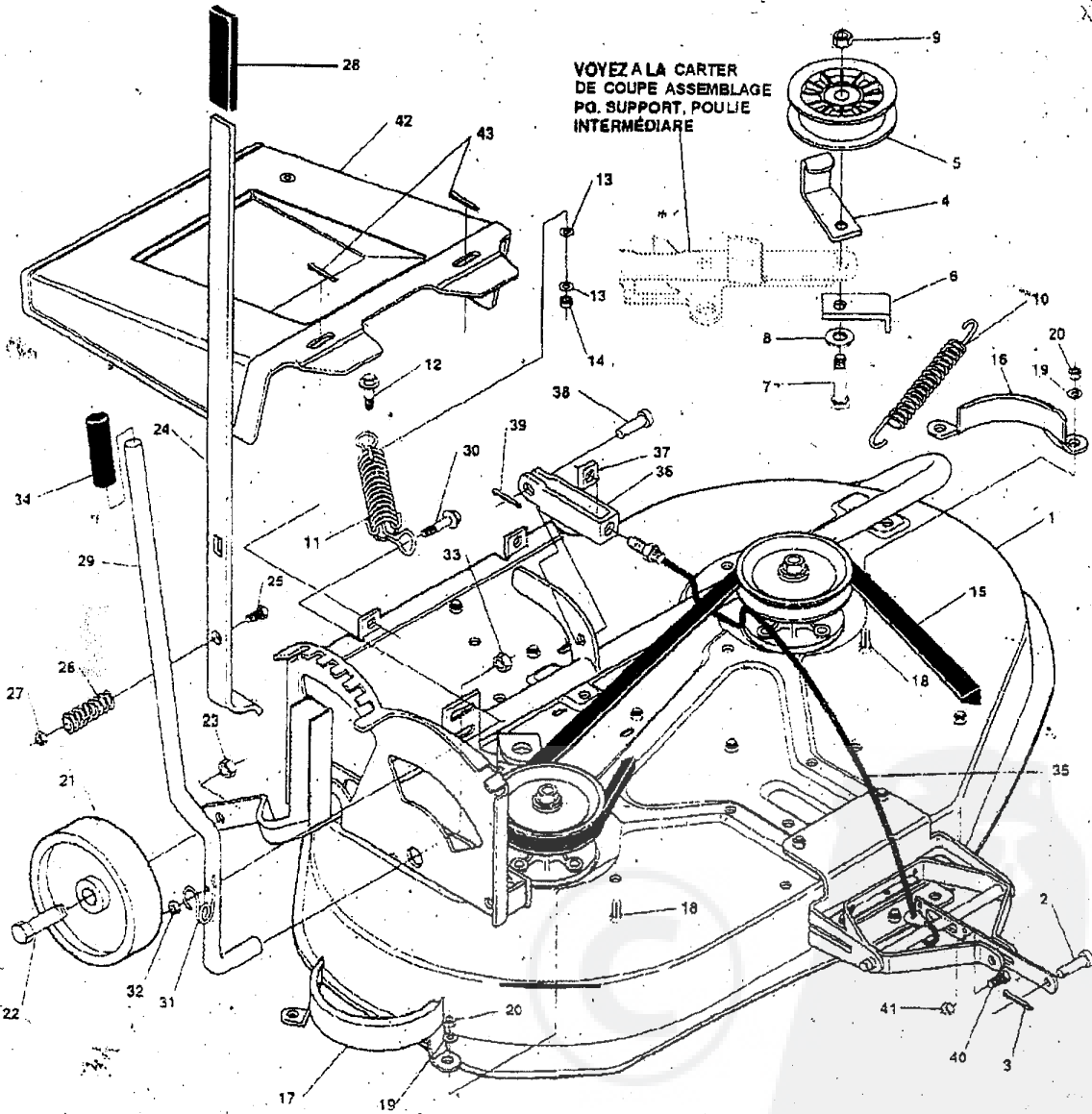

VOYEZ LA CARTER DE COUPE ASSEMBLAGE PO. SUPPORT, POULIE INTERMÉDIAIRE

UTILISEZ DES PIÈCES D'ORIGINE POUR CONSERVER L'APPLICATION DE LA GARANTIE.

TOUTES LES PIÈCES NON REFÉREES SONT INTERCHANGEABLES AVEC LEURS OPPOSEES.

316835C

**TRACTEUR TONDEUSE 36" MODELE C3554-090**

Key#	Part#	Description	Qty.
1		PAINTED DECK NOTE, SEE DWG#316030 FOR PARTS ASSEMBLY	
2	47816	P I N .495X1.750 CLEVIS-SHORT-	1
3	56180	P I N . HAIR .091 DIA X 1.62 LG	1
4	7354	RETAINER BELT	1
5	303028	PULLEY, IDLER BFF 3.13 DIA	1
6	57217-853	BRACKET, L-SHAPED BRAKE ROD	1
7	122166	SCREW, 3/8-16 X 1.75 HHC	1
8	448363	WASHER, FLAT .375 X .88 X .082	1
9	1499	NUT, 3/8-16 REGHXCTRLK	1
10	35410	SPRING .071 X .62 X 4.37	1
11	52636	SPRING	1
12	46563	BOLT, .375 X .250 SHWA 1/4-20	1
13	120392	WASHER, FLAT .281 X .63 X .065	2
14	1502	NUT, 1/4-20 REGHEXCTRLK	1
15	308701	BELT, V 5L 80.00 DECK 36RD EXP	1
16	46365-853	COVER QUILL LH	1
17	46364-853	COVER, QUILL RH	1
18	120228	SCREW, 5/16-18 X 1.00 HHC	4
19	120393	WASHER, FLAT .344 X .69 X .065	4
20	1498	NUT, 5/16-18 REGHEXCTRLK	4
21	302611	WHEEL, SD 6.00 O D X 1.38 W D	2
22	23763	BOLT, .500 X 1.390 H H S H 3/8-16	2
23	1499	NUT, 3/8-16 REGHXCTRLK	2
24	307050	LEVER HEIGHT ADJ	1
25	120696	SCREW, 5/16-18 X 2.25 HHC	1
26	53246	SPRING	1
27	1498	NUT, 5/16-18 REGHEXCTRLK	1
28	20250	GRIP, HAND .75 X 4.87	1
29	305383	LEVER, BLADE ENGAGE 32RD & 36RD	1
30	1289	BOLT, .375 X .250 SHWA 1/4-20	1
31	46561	SPRING, TORSION 36RD, 32RD	1
32	1502	NUT, 1/4-20 REGHEXCTRLK	1
33	53697	NUT, 1/2 PUSHON	1
34	46478	GRIP, HAND .50 I D X .37 L G B L K .	1
35	30034 i	CABLE, LIFT 21.70 F-5 20X8-8'	1
36	9405	CLEVIS, LIFT CABLE	1
37	120372	NUT, 1/4-20 REGSQ	1
38	39522	PIN, CLEVIS .312 X .812	1
39	56180	PIN, HAIR .091 DIA X 1.62 LG	1
40	120228	SCREW, 5/16-18 X .63 HHC	1
41	1498	NUT, 5/16-18 REGHEXCTRLK	1
42	50993	CHUTE EXTENSION PLASTIC 36"RD	1
43	120123	PIN, COTTER .125 DIA X 1.25 LG	2

0 Indicates STANDARD HARDWARE ITEMS.  
\* ORDER INDIVIDUAL PARTS

**TRACTEUR TONDEUSE 36" MODELE C3554-090**

**FAISCEAU ELECTRIQUE**

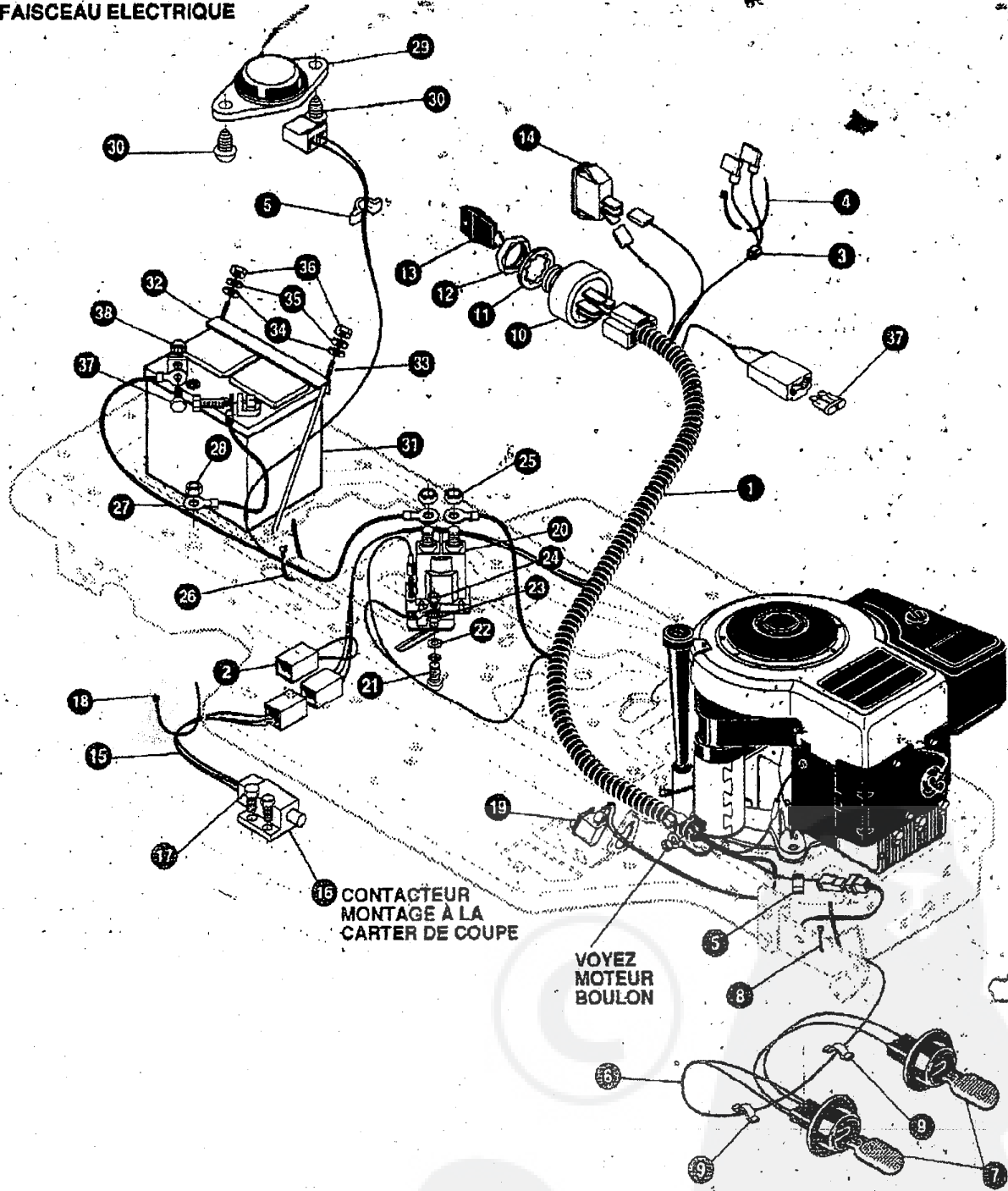

**16 CONTACTEUR  
MONTAGE A LA  
CARTER DE COUPE**

**VOYEZ  
MOTEUR  
BOULON**

**UTILISEZ DES PIÈCES D'ORIGINE POUR CON-  
SERVER L'APPLICATION DE LA GARANTIE.**

**TOUTES LES PIÈCES NON  
REFEREES SONT  
INTERCHANGEABLES AVEC  
LEURS OPPOSEES.**

324048A



# TRACTEUR TONDEUSE 36" MODELE C3554-090

Key#	Part#	Description	Qty.
1.	320048	WIRE HARNESS SF 12B&S IC	1
2.	322296	BY-PASS FOR GROUND SUPPORT	1
3.	322298	SPLICER	1
4.	57444	TIE, CABLE BLACK NYLON 5.62L	1
5.	41488	PRESS CLIP, 1.380LG 255ID	2
6.	303064	ASSY, LIGHT WIRE-1/4 TURN	1
7.	52572	BULB, HEADLAMP	2
8.	57444	TIE, CABLE BLACK NYLON 5.62L	1
9.	41482	PRESS CLIP, 1.380LG 255ID	2
10.	305720	SWITCH-IGN (AFTER FIRE) 3 POSN	1
11.	138557	WASHER, REGINTLK.640X1.1X.05	1
12.	48140	NUT, 5/8-32HXHD IGN SWIT	1
13.	49643	2 KY'S & RING, ASSY BLANK	1
14.	300334	LIGHTSWITCH ON/OFF PANEL MNT	1
18.	57588	HARNESS, DECK WIRE-SHORT d WIRE	1
16.	57476	SWITCH, SCR MNT DP NC NO BLK	1
17.	57220	SCREW, #12 X .50 PHPNHTAP BLK	2
18.	57444	TIE, CABLE BLACK NYLON 5.62L	1
19.	300220	SWITCH, SN&PMNT-NO.055/116BLK	1
29.	53716	SOLENOID	1
21.	187745	SCREW, 1/4-20X.75 HXSEMMA	2
22.	1084	WASHER, FLAT 281X1.00X.063PL	1
23.	1502	NUT, 1/4-20 REGHEXDTRELK	2
24.	271172	NUT, 1/4-20 REGHEXKEPS	1
25.	271187	NUT, 5/16-24 HKEPS	2
26.	57444	TIE, CABLE BLACK NYLON 5.62L	1
27.	55511	WIRE, GROUND, 12.5'	1
28.	271184	NUT, 5/16-18 HEXKEPS	1
24.	57547	SWITCH, SEAT	1
30.	160505	SCREW, 1/4-20X .38PHPNHMGAR2	2
31.	37486	BATTERY, YUASA 12V 5-PLATE	1
32.	56360	MF BATTERY BRACKET	1
33.	40234	BATTERY ROD	2
34.	120392	WASHER FLAT .281X .63X.065	2
35.	120381	WASHER, REGSPTLK.263X.49X.07	2
36.	120375	NUT, 1/4-20 REGHEX	2
37.	120854	SCREW, 1/4-20X .63 HHC GR2	2
38.	271172	NUT, 1/4-20 REGHEXKEPS	2

## SCHEMATIC WIRING:

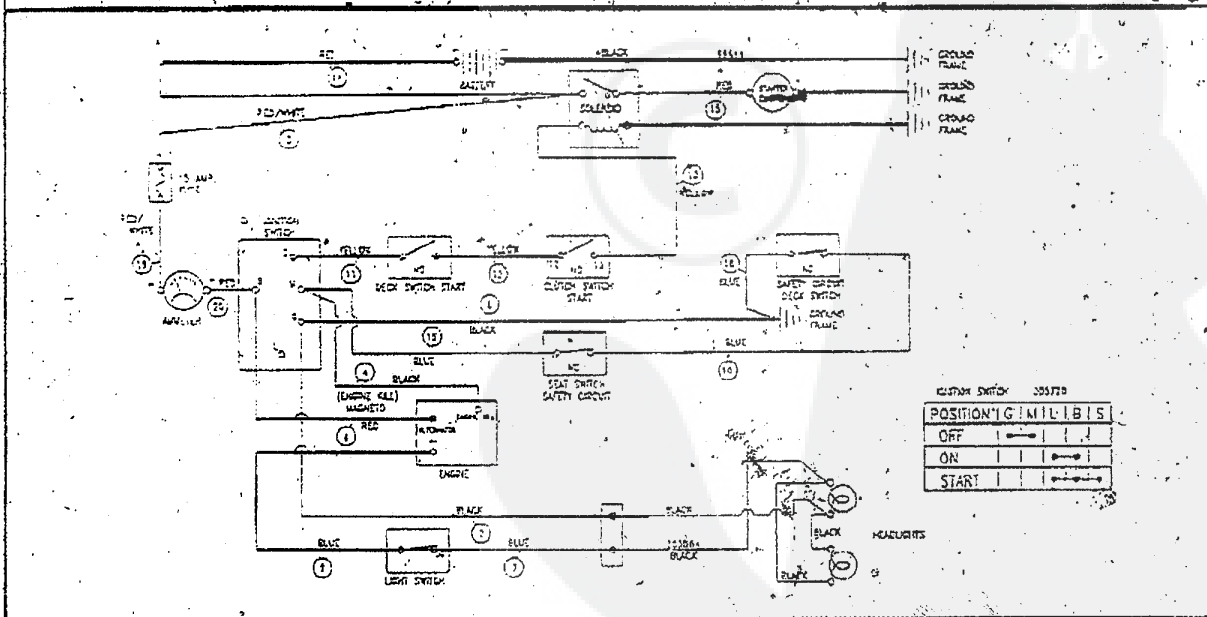

TRACTEUR-TONDEUSE 36" MODELE C3554-090

CHALAND ASSEMBLAGE

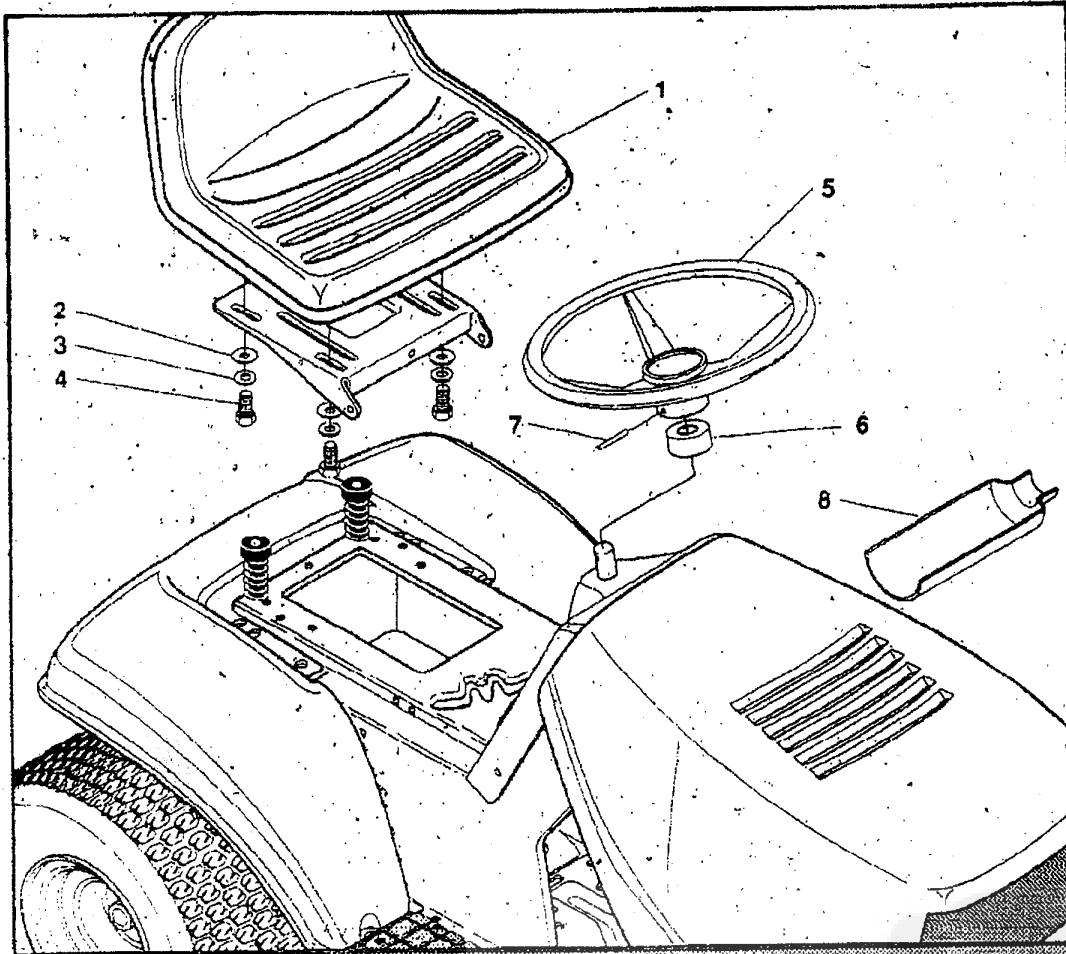

CUSTOMER ASSEMBLY VIEW

315134 PARTS BAG ASSY QTY1

Key#	Part#	Description	Qty
1	57452	SEAT MV350	1
2	1 2 0 3 9 3	WASHER, FLAT .344X.69X.065	4
3	120638	WASHER, HV SPL TLK .328X.60X.109	4
4	422007	SCREW, 5/16-18X.75 HHC	4
5	3 0 1 2 5 1	STEERING WHEEL	1
6	\$23758	STEERING, SLEEVE	1
7	456378	ROLL PIN .250DIA X 2.0LG	1
8	54873	OIL TROUGH	1

3162358

# TRACTEUR TONDEUSE 36" MODELE C3554-090

Key#	Part#	Description	Qty
1.		FRONT AXLE ASSEMBLY SF	1
2.	56400	AXLE FRONT	1
3.	50546	BEARING FLANGE	4
4.	310368	SPINDLE,RH	1
5.	36625	RING,RETEX	1
6.	310367	SPINDLE,LH	1
7.	49447	ARM,STEERING LH	1
8.	454565	PIN,SPRING	1
9.	302691	T I E R O D	1
10.	122145	SCREW, 318-16X1.25 HHC	2
11.	120382	WASHER, .393X.68X.10 REGSPTLK	2
12.	1499	NUT, 3/8-16 REGHCTRLK	2
13.	304245	SECTOR GEAR	1
14.	44011	BOLT, .750X1.40 SPSH	1
15.	2483	WASHER, .391DX1.25ODX.07	1
16.	39573	SCREW, 318-24X1.00 NYL	1
17.	56191	DRAG LINK ASSEMBLY	1
18.	56190	DRAG LINK	1
19.	124925	NUT, 3/8-24 REGHEXJAM	2
20.	21275	BALL JOINT	2
21.	120382	WASHER, EGSPTLK	2
22.	120369	NUT, 3/8-24 REGHEX	2
23.	323098	STEERING SHAFT	1
24.	44009	PINION,STEERING SHAFT	1
25.	454565	PIN,SPRING	1
26.	54902	BEARING, 1.370X.50 FLANGE STEERING	1
27.	38492	RING,RETEX 1.27X.05	1
28.	36625	RING,RETEX .57X.05	1
29.	319680	ASSEMBLY, TIRE	2
30.	24167	VALVE STEM	1
31.	39937	WHEEL W/BEARING	1
32.	39979	BEARING, 1.380DX.753ID FLANGE	2
33.	40394	HUB CAP	2
34.	642	WASHER,FLAT .755X1.31X.075	4
35.	36625	RING,RETEX .57X.05	2

STANDARD HARDWARE ITEMS.  
 \* ORDER INDIVIDUAL PARTS.

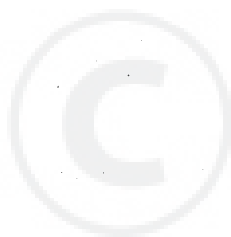

**TRACTEUR TONDEUSE 36" MODELE C3554-090**

**TRANSMISSION**

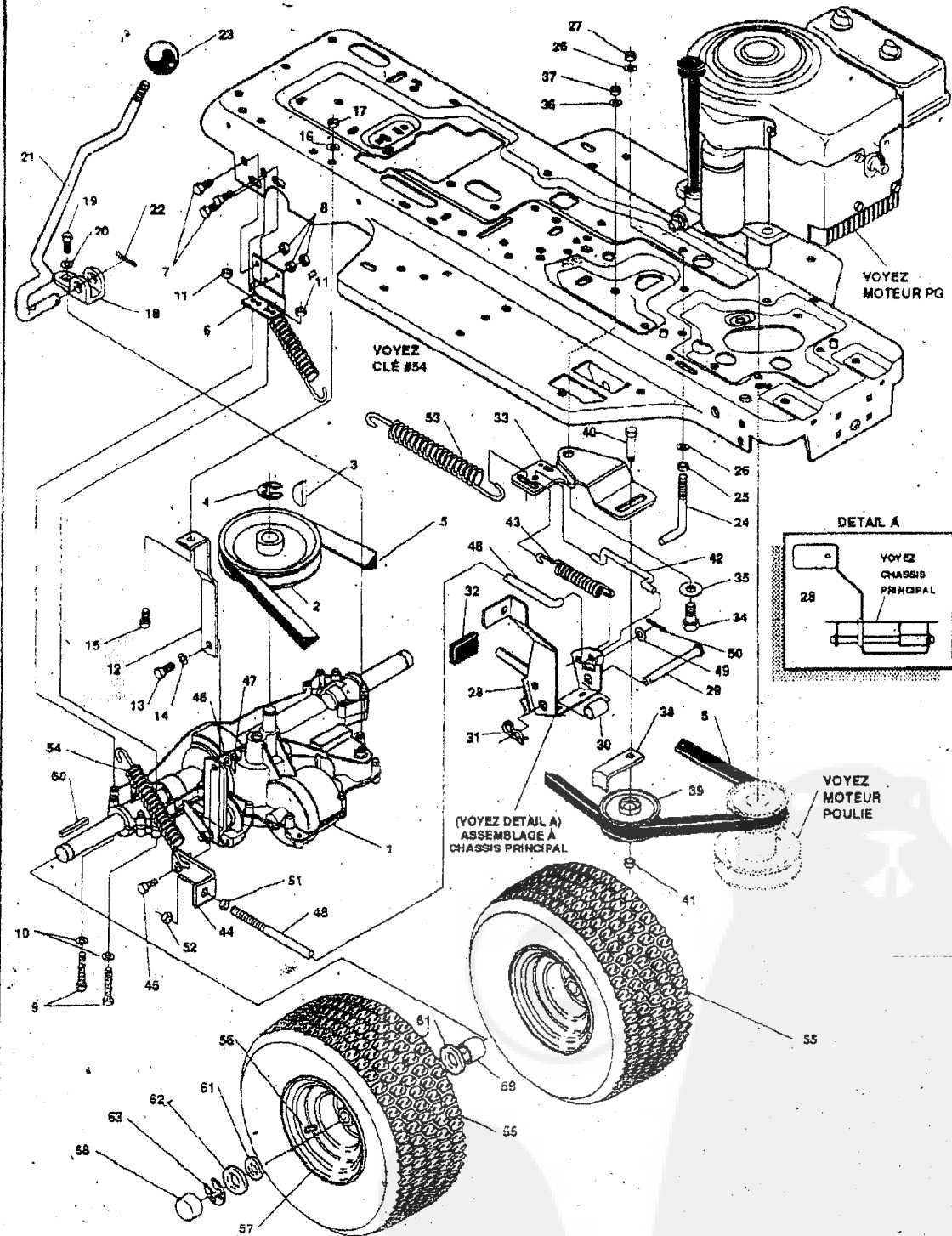

UTILISEZ DES PIÈCES D'ORIGINE POUR CONSERVER L'APPLICATION DE LA GARANTIE.

TOUTES LES PIÈCES NON REFERÉES SONT INTERCHANGEABLES AVEC LEURS OPPOSÉS.

320345C

TRACTEUR TONDEUSE 36" MODELE C3554-090

Key#	Part#	Description	Qty.
1		TRANSAXLE	FOOTE 4360-5
2	302745	V PULLEY	8.60 OD
3	3021	KEY, WDRF	606.750X.187X.312
4	22053	RING, RETEX	.56X.04TRUS100-52
5	54756	BELT, V 4L	82.00 SF DRIVE
6	7707	BRACKET, TRANSAXLE	BLK
7	120228	SCREW, 5/16-18X .63	HHC
8	1498	NUT, 5/16-18	REGHEXCTRLK
9	180112	SCREW, 5/16-18X2.75	HHC
10	120393	WASHER, FLAT	.344X .69X.065
11	1498	NUT, 5/16-18	REGHEXCTRLK
12	309770	BRKT, STABILIZER	
13	35499	SCREW, 5/16-18X .75	WAHTAP
14	120638	W A S H E R	HVSP TLK .322X .60X.09
15	122017	SCREW, 5/16-18X1.00	HHC
16	138485	WASHER, EXLK	.320X.61X.03
17	1498	NUT, 5/16-18	REGHEXCTRLK
18	57480	BRKT, SHIFT	
19	56255	SCREW, 1/4-28X .75	NYLHHC
20	57157	W A S H E R	.750X.250 SP-TRANSAXLE
21	302283	SHIFT-LEVER	
22	137185	PIN, COTTER	.125 DIA X1.00LG
23	55514	KNOB, SHIFT	ROUND 1/2-13
24	49896	BELT	GUIDE
25	271184	NUT, 5/16-18	HEXKEPS
26	120393	WASHER, FLAT	.344X .69X.065 Z
27	1498	NUT, 5/16-18	REGHEXCTRLK
28	302603	ASSY, BRAKE	PEDALS.F
29	319676	ROD, PIVOT	
30	302601	SPACER, 53IDX.62DX1.406	S L E E V E
31	56180	PIN, HAIR	
32	48761	PAD, CLUTCH/BRAKE	PEDAL
33	1306	IDLER ARM BRKT,	TRACTION
34	41890	BOLT, .625X .218	HSSH 5/16-18
35	4107	WASHER, FIAT	635X1.31X.07
36	4560898	WASHER, 5/16-18	REGHEXCTRLK19
38	39659	RETAINER, STRAP	BELT
39	35374	PULLEY, IDLER	V4L 3.66X .62
40	45892	BOLT, 3/8-16X1.50	CARR
41	1498	NUT, 3/8-16	REGHXCTRLK
42	43980	ROD, .268	DIA CLUTCH
43	50562	SPRING, 3/8ODX1.625X.055	
44	54723	BRACKET, BRAKE	ROD
45	120393	WASHER, 3/4X1.50	344X .69X.065
47	1498	NUT, 5/16-18	REGHEXCTRLK
48	310189	BRAKE ROD	RIDER
49	120393	WASHER, FLAT	.344X .69X.065
50	121222	PIN, C5/16-18	.090/.086X.75LG
		NUT,	HEXKEPS
52	1498	NUT, 5/16-18	REGHEXCTRLK
53	49276	SPRING, 3/4	ODX6.75X.091
54	35410	SPRING .071 X .62	X 4.37
55	317400	TIRE P.U	18X8-8.5 TURWHI
56	24167	VALVE	STEM
57	41105	WHEEL&HUB	ASSY 9.50X8 WHITE
58	40394	CAP, 1.500IDX7/8LG	HUB
59	57479	SPACER, .75 X 1.25	X 1.32
60	52928	KEY, SQUARE	187SQX2.25LG
61	642	WASHER, FLAT	.755X1.31X.075
62	42815	WASHER, FLAT	.755X1.53X.07
63	36625	RING, RETEX	.57X.05

\* Indicates STANDARD HARDWARE ITEMS.  
 \* CONTACT YOUR NEAREST FOOTE TRANSAXLE DEALER FOR PARTS & SERVICE.

TRACTEUR TONDEUSE 36" MODELE C3554-090

MOTEUR ENSEMBLE

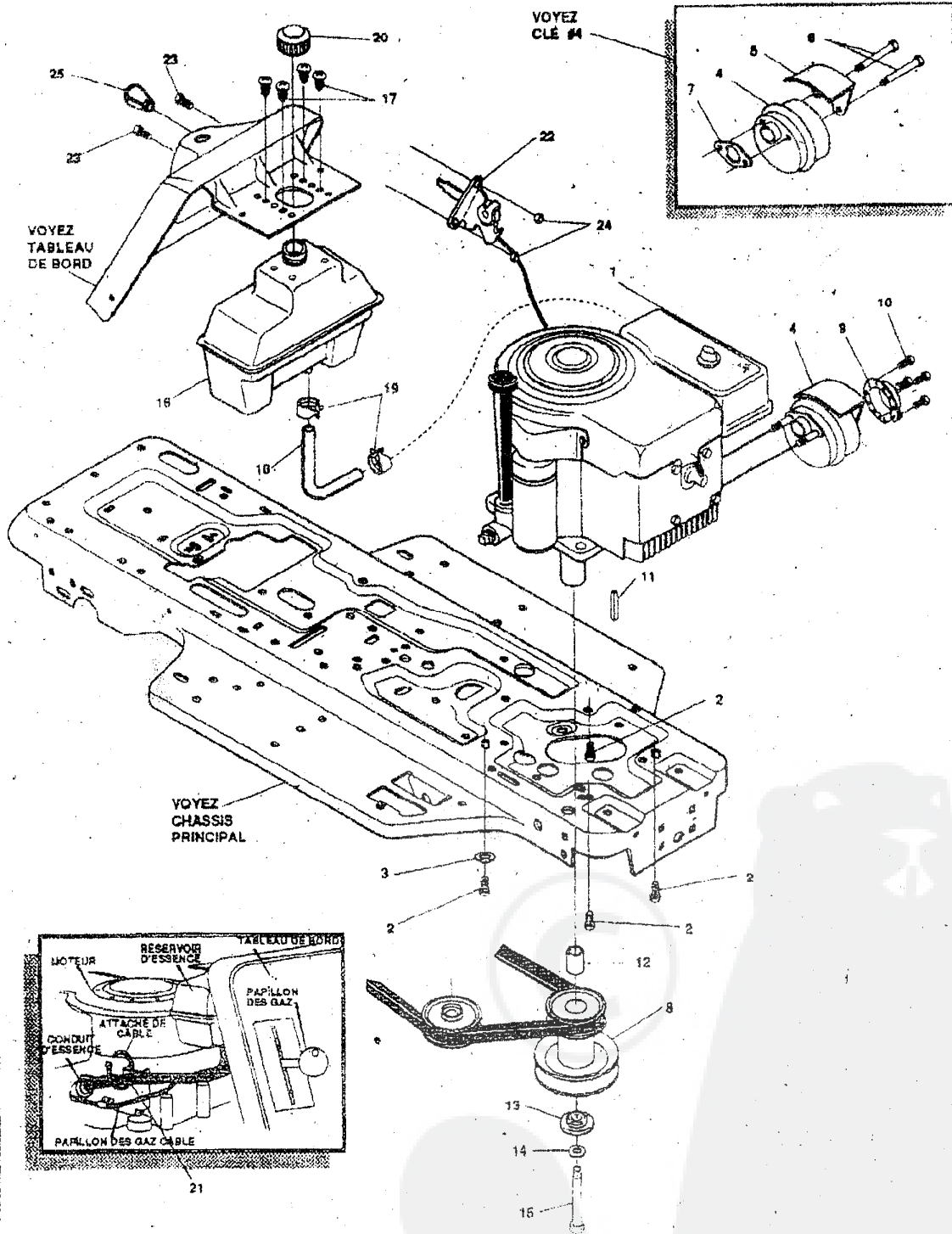

VOYEZ  
TABLEAU  
DE BORD

VOYEZ  
CLÉ #4

VOYEZ  
CHASSIS  
PRINCIPAL

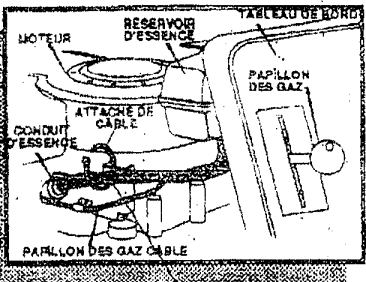

UTILISEZ DES PIÈCES D'ORIGINE POUR CON-  
SERVER L'APPLICATION DE LA GARANTIE.

TOUTES LES PIÈCES NON  
REFERÉES SONT  
INTERCHANGEABLES AVEC  
LEURS OPPOSÉS.

319818A

TRACTEUR TONDEUSE 36" MODELE C3554-090

Key#	Part#	Description	Qty.	
1	ENGINE	12 HP BASIC (SEE ENGINE MANUAL)	1	
2	060947	SCREW, 3/8-16X1.25 WAHTAP	4	
3	0 1 3 6 4 6 9	WASHER, EXLK 3/8X.69X.04	1	
4	57908	MUFFLER-LO TONE	1	
5	54767	SHIELD, HEAT, FOR ROUND MUFFLES	1	
6	0 1 7 3 9 6 3	SCREW, 5/16-18X3.50 HHC	2	
7	46708	GASKET, MUFFLER	1	
8	315317	PULLEY, ENGINE, 4.00 OFFSET	1	
9	323423	DEFLECTOR, MUFFLER PARTIAL	1	
10	35297	SCREW, 6-32X.36 HHWATAP GR2	3	
11	303151	KEY, SQUARE .249SQX4.50LG	1	
12	394246	SPACER, 1.01X1.484 ENGINPULLEY	1	
13	56431	W A S H E R , 9/80IDX1.38ODX.437PILOT	1	
14	0129353	W A S H E R , REGSPTLK 459X.73X.12	1	
15	0433146	SCREW, 7/16-20X4.25 HHC	1	
16	314989	TANK, FUEL 1 GAL	1	
17	049650	SCREW, 1/4-10X.75PHNTAP	4	
18	47452	GAS LINE .25ID	12	
19	48672	CLAMP, FUEL LINE	2	
20	46794	GAS CAP, 1-1/2-7 THD	1	
21	57444	TIE, CABLE	1	
2	2	320031	THROTTLE CONTROL	1
23	035291	SCREW, 10-24X.50 SLHHMA	2	
24	0 2 7 1 1 6 6	NUT, #10-24 HEXKEPS	2	
25	50607	KNOB ROUND THROTTLE	1	

0 Indicates STANDARD HARDWARE ITEMS.