

REPAIR PARTS MANUAL

39" - 12 H.P. LAWN TRACTOR

MODEL D3554-120

ONE YEAR LIMITED WARRANTY

For one (1) year from date of purchase by the first consumer for residential use (thirty (30) days commercial use), NOMA Outdoor Products Incorporated warrants that it will replace free of charge, including labor, any original part of any NOMA Outdoor Products Incorporated product found to be defective by any authorized Service Dealer or the factory, except the battery which is warranted for ninety (90) days from date of purchase.

This warranty does not cover engine, transmission, transaxle or differential (these items are covered by their manufacturer's own warranty). This warranty does not cover parts that have failed due to normal wear or parts that have failed subject to misuse or abuse. Transportation of the unit or part to and from an authorized Service Dealer or factory is the responsibility of the owner.

A step by step explanation as to what procedure should be followed for this warranty is:

1. If a part becomes defective, contact the store where the unit was purchased for the name and address of the authorized Service Dealer nearest to you.
2. If you cannot locate an authorized Service Dealer, write Service Department of NOMA Outdoor Products Incorporated for the name and address of the authorized Service Dealer in your area or call the Service Department at 1-901-422-1690.
3. Return the defective product, along with proof of purchase to such authorized Service Dealer for replacement of any defective part where covered by this warranty.

There is no other express warranty. Implied warranties, including those of merchantability and fitness for a particular purpose are limited to one (1) year from date of purchase. Liability for incidental or consequential damages are excluded.

Some states do not allow limitations on how long an implied warranty lasts, so the above limitation may not apply to you. Some states do not allow the exclusion of incidental or consequential damages, so the above exclusion may not apply to you. This warranty gives you specific legal rights, and you may have other rights which vary from state to state.

NOMA Outdoor Products Incorporated

Call 8000

Jackson, TN 38308-8000

UNIT PARTS AND SERVICE

Fill in and mail the registration card packed with the unit. For service other than covered in this manual, contact an authorized service dealer. A nationwide parts and service organization has been established to provide locally available parts and service. A list of authorized parts distributors has been included in this manual. When ordering repair parts, always give the following information: 1. The Part Name; 2. The Part Number; 3. The Quantity desired; 4. The Full (eight digit) Model Number of the unit. The model number will be found on a plate attached to the unit.

Look for this symbol.  It means - ATTENTION! BECOME ALERT! A HAZARD TO OPERATOR, BYSTANDER, PROPERTY OR EQUIPMENT MAY EXIST.

NOMA Outdoor Products Incorporated
Call 8000
Jackson, TN 38308-8000

Part No. 329842A

8/93

Price \$5.00

Printed in U.S.A.

**SAFETY RULES**

THESE INSTRUCTIONS ARE FOR YOUR PROTECTION. PLEASE READ THEM CAREFULLY.

**IMPORTANT**

THIS CUTTING MACHINE IS CAPABLE OF AMPUTATING HANDS AND FEET AND THROWING OBJECTS. FAILURE TO OBSERVE THE FOLLOWING SAFETY INSTRUCTIONS COULD RESULT IN SERIOUS INJURY OR DEATH.

I. GENERAL OPERATION:

- Know controls and how to stop quickly.
- Read, understand, and follow all instructions in the manual and on the machine before starting.
- Only allow responsible adults, who are familiar with instructions, to operate the machine.
- Wear safety glasses or eye shields when assembling or operating the machine.
- Do not operate machine when barefooted. Always wear substantial footwear, preferably steel-toed shoes.
- Do not wear loose fitting clothing that could get caught in moving parts.
- Clear the area of objects such as rocks, toys, wire, etc., which could be picked up and thrown by the blade(s).
- Be sure the area is clear of other people before mowing. Stop machine if anyone enters the area.
- Never carry passengers.
- Do not mow in reverse unless absolutely necessary. Always look down and behind before and while backing.
- Be aware of the mower discharge direction and do not point it at anyone. Do not operate the mower without either the entire grass catcher or the guard in place.
- Slow down before turning.
- Never leave a running machine unattended. Always turn off blades, set parking brake, stop engine, and remove keys before dismounting.
- Turn off blade(s) when not mowing.
- Stop engine before removing grass catcher or unclogging chute.
- Mow only in daylight or good artificial light.
- Do not operate the machine while under the influence of alcohol or drugs.
- Watch for traffic when operating near or crossing roadways.
- Use care when mowing around a fixed object to prevent the blade(s) from striking it. Never deliberately run over any foreign object.
- Use extra care when loading or unloading the machine into a trailer or truck.
- Use care when pulling loads or using heavy equipment.
 - a. Use only approved drowber hitch points.
 - b. Limit loads to those that you can safely control.
 - c. Do not turn sharply. Use care when backing.
 - d. Use counterweight(s), wheel weight or tire chains when suggested in attachment(s) instructions.

II. SLOPE OPERATION:

Slopes are a major factor related to loss-of-control and tip-over accidents, which can result in severe injury or death. All slopes require extra caution. If you cannot back up the slope or if you feel uneasy on it, do not mow it.

DO

- Mow up and down slopes, not across.
- Remove obstacles such as rocks, tree limbs, etc.
- Watch for holes, ruts, or bumps. Uneven terrain could overturn the machine. Tall grass can hide obstacles.
- Use slow speed. Choose a low gear so that you will not have to stop or shift while on the slope.
- Follow the manufacturer's recommendations for wheel weights or counterweights to improve stability.
- Use extra care with grass catchers or other attachments. These can change the stability of the machine.
- Keep all movement on the slopes slow and gradual. Do not make sudden changes in speed or direction.
- Avoid starting or stopping on a slope. If tires lose traction, turn off the blade(s) and proceed slowly straight down the slope.

DO NOT

- Do not turn on slopes unless necessary, and then slowly and gradually downhill, if possible.
- Do not mow near drop-offs, ditches or embankments. The

mower could suddenly turn over if a wheel is over the edge of a cliff or ditch, or if an edge caves in.

- Do not mow on wet grass. Reduced traction could cause sliding.
- Do not try to stabilize the machine by putting your foot on the ground.
- Do not use grass catcher on steep slopes.

III. CHILDREN:

Tragic accidents can occur if the operator is not alert to the presence of children. Children are often attracted to the machine and the mowing activity. Never assume that children will remain where you last saw them.

- Keep children out of the mowing area and under the watchful care of another responsible adult.
- Be alert and turn machine off if children enter the area.
- Before and when backing, look behind and down for small children.
- Never carry children. They may fall off and be seriously injured or interfere with safe machine operation.
- Never allow children to operate the machine.
- Use extra care when approaching blind corners, shrubs, trees, or other objects that may obscure vision.

IV. SERVICE:

- Use extra care in handling gasoline and other fuels. They are flammable and vapors are explosive.
 - a. Use only an approved container.
 - b. Never remove gas cap or add fuel with the engine running. Allow engine to cool before refueling. Do not smoke.
 - c. Never refuel the machine indoors.
 - d. Never store the machine or fuel container inside where there is an open flame, such as in a water heater.
- Check fuel supply before each use allowing space for expansion as the heat of the engine and/or sun can cause gasoline to expand and overflow the tank.
- Use extra care when handling battery acid. Acid contact with skin may cause severe burns. Eye contact may cause blindness.
- Use extra care when servicing the battery. Explosive gas is produced in the battery. Do not service the battery while smoking or near an open spark or flame. This may cause the battery to explode causing serious injury.
- Never run a machine inside a closed area. Exhaust fumes contain CARBON MONOXIDE, an ODORLESS and DEADLY GAS.
- Keep nuts and bolts, especially blade attachment bolts, tight and keep equipment in good condition.
- Never tamper with safety devices. Check their operation regularly.
- Do not change the engine governor settings or overspeed engine.
- Reduce fire hazards. Keep machine free of grass, leaves, or other debris build-up. Clean up oil or fuel spillage. Allow machine to cool before storing.
- Stop and inspect the equipment if you strike an object. Repair, if necessary, before restarting.
- Never make adjustments or repairs with the engine running.
- Grass catcher components are subject to wear, damage, and deterioration, which could expose moving parts or allow objects to be thrown. Frequently check components and replace with manufacturer's recommended parts, when necessary.
- Mower blade(s) are sharp and can cut. Wrap the blade(s) or wear gloves, and use extra caution when servicing them.
- Check brake operation frequently. Adjust and service as required.



LOOK FOR THIS SYMBOL TO POINT OUT IMPORTANT SAFETY PRECAUTIONS. IT MEANS-- ATTENTION!!! BECOME ALERT!!! YOUR SAFETY IS INVOLVED.

OWNER'S INFORMATION

Record the following information about your unit so that you will be able to provide it in case of loss or theft.

MODEL NUMBER: - (Enter complete 8 digit number from model plate on unit)

PURCHASE DATE: ___ / ___ / ___ CODE NO.: _____ SERIAL NO.: _____

DEALER'S NAME AND ADDRESS: _____

CITY: _____ STATE: _____ TELEPHONE: _____

CONTENTS OF SHIPPING CARTON

- 1 - Lawn Tractor with 39 inch Mower Deck
- 1 - Operator's Manual
- 1 - Repair Parts Manual
- 1 - Engine Manual
- 1 - Steering Wheel (see Note)
- 1 - Seat (see Note)
- 1 - Bag of Assembly Parts Containing (see Note):
 - 4 - 5/16 x 3/4 inch Hex Head Screws
 - 4 - 5/16 inch Split Lockwashers
 - 4 - 11/32 inch Flatwashers
 - 1 - Roll Pin

NOTE: Refer to page 28 (Customer Assembly Parts) for more detailed description.

TOOLS REQUIRED FOR ASSEMBLY

- 2 - 7/16 inch Wrenches (or adjustable wrench)
- 1 - 1/2 inch Wrench (or adjustable wrench)
- 1 - Small Phillips Screwdriver with a 1/4 inch shank
- 1 - Hammer

HOW TO MEASURE SCREW SIZE (5/16 x 1 1/2 INCH)

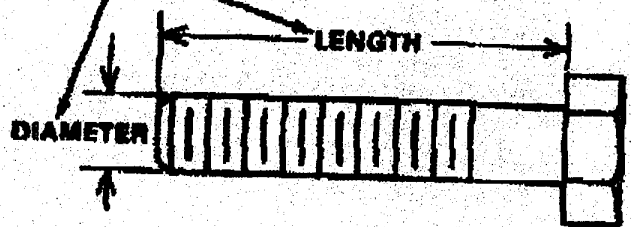

DANGER



This lawn tractor can be dangerous if carelessly used.

Read your Operator's Manual thoroughly before operating your lawn tractor.

Always wear safety glasses or eye shields while assembling or operating your lawn tractor.

DO NOT carry passengers at any time.

Keep your hands, feet, hair and loose clothing away from the discharge area, the underside of the mower deck or any moving parts while the engine is running.

DO NOT allow children or young teenagers to operate or be near your lawn tractor while it is operating.

ALWAYS GIVE THE FOLLOWING INFORMATION WHEN ORDERING REPAIR PARTS:

1. The PART NUMBER; 2. The PART NAME; 3. QUANTITY DESIRED; 4. The MODEL NUMBER (As shown on Model Plate).

SEND PART ORDERS AS PER INSTRUCTIONS ON THE FRONT PAGE.

DO NOT USE KEY NUMBERS WHEN ORDERING REPAIR PARTS. ALWAYS USE PART NUMBERS.

All replacement parts will be supplied in current production colors or in a neutral color.

A handling fee is applicable to small parts orders.

YOUR UNIT IS RIGHT HAND (RH) OR LEFT HAND (LH) AS YOU STAND BEHIND IT.

39" LAWN TRACTOR MODEL D3554-120

CHASSIS & HOOD ASSEMBLY

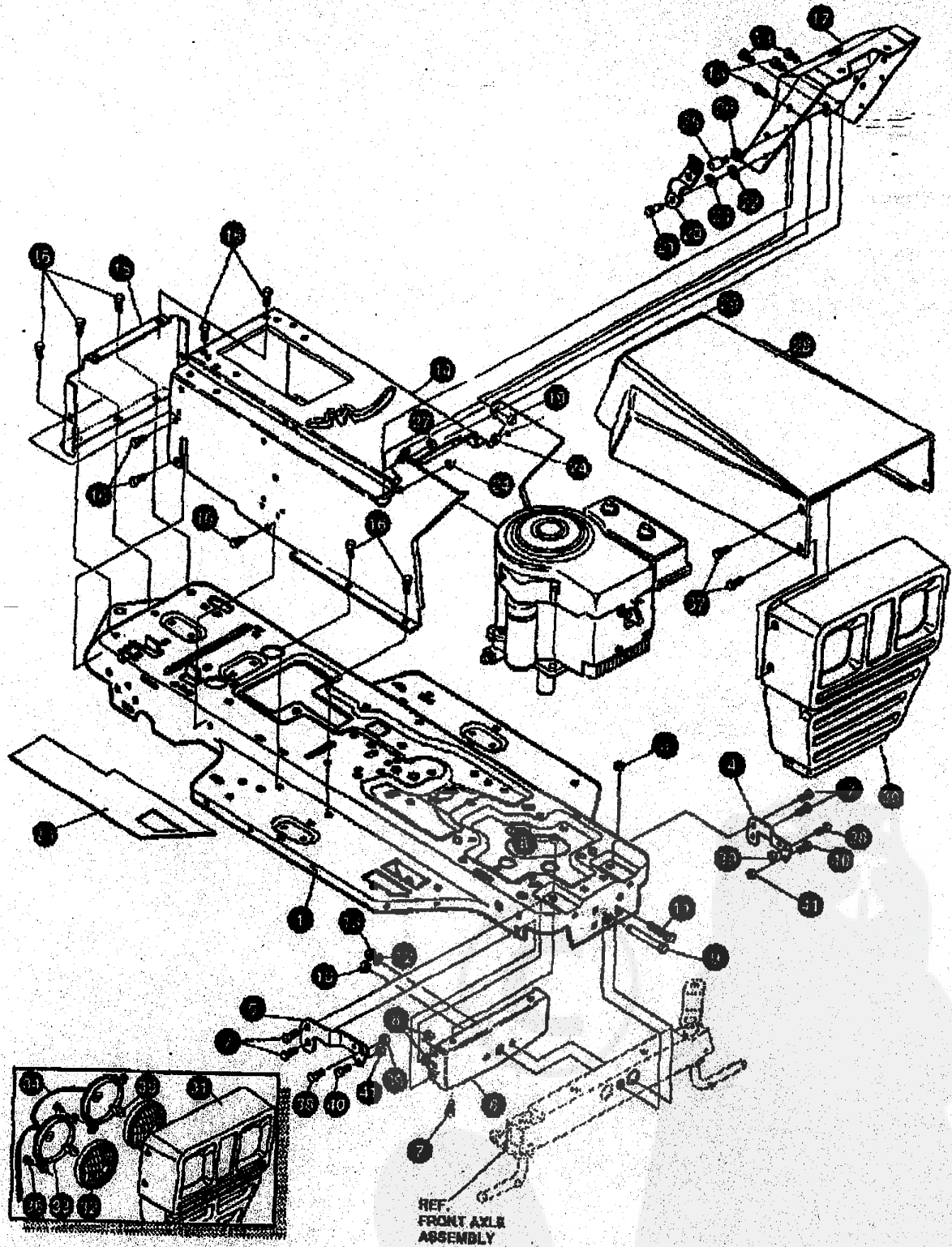

NOTE: ALWAYS USE ORIGINAL EQUIPMENT PARTS.
 Use of service/replacement parts other than original equipment parts may void your warranty.

**ALL UNNUMBERED
 ITEMS ARE INTERCHANGEABLE
 WITH OPPOSITE SIDE**

328340C

39" LAWN TRACTOR MODEL D3554-120

KEY#	PART#	DESCRIPTION	QTY.
1	528865-860	FRAME, MAIN SF RIDER TUV	1
2	302917	FOOTPAD, LH SF GRIT	1
3	302916	FOOTPAD, RH SF GRIT	1
4	56259-863	BRACKET GRILLE L.H.	1
5	56260-863	BRACKET GRILLE R.H.	1
6	56362-863	BRKT, SUPT FRT AXLE-SF	1
7	326154	SCREW, 5/16-18X1.00WDFLLK	6
8	56273	NUT, 5/16-18 HXWDFLLK	6
9	28616	BOLT, .825X2.875 SPSH 1/2-20	1
10	274654	NUT, 1/2-20 REGHXCTRLK	1
11	122201	SCREW, 3/8-16X2.75 HHC	2
12	2483	WASHER, 39DX1.26DX.07 BELLVIL	2
13	1499	NUT, 3/8-16 REGHXCTRLK	2
14	321968-860	CONSOLE, SF GPWR	2
15	56236-860	CONSOLE, REAR COVER	1
16	995346	SCREW, 1/4-20X .50 WAHTAP	15
17	321950-860	DASH NO ILL/AMMETER ELEC	1
18	995338	SCREW, 1/4-20X .63 HHWATAP	4
19	50352	NUT, 1/4-20 WDFLLK TOPLOCK	2
20	57159	LATCH, .94WDX.047 ASSY HOOD	2
21	8482	BOLT, .375X .156 HSSH 5/16-18	2
22	120394	WASHER, FLAT .406X.81X.065	2
23	120393	WASHER, FLAT .344X.89X.065	2
24	1498	NUT, 5/16-18 REGHEXCTRLK	2
25	53446	PIN, 5/16-18 HOOD LATCH GR2	2
26	138538	WASHER, REGINTLK.320X.61X.03	2
27	45174	NUT, 5/16-18 HEXWDFLLK WHIZ	2
28	63954-860	HOOD	1
29	55040	TRIM, STRIP, BLACK	23.760 IN
30	56732	GRILLE ASSY G-9	1
31	30868	SCREW, 10-14X .50 WAHTAP	4
32	52570	LAMP LENS	2
33	52571	LAMP BEZEL	2
34	52572	BULB, HEADLAMP	2
35	"	GRILLE	2
36	56189	WIRE ASSY, HEADLAMP	1
37	57216	SCREW, 5/16-18X .75 WAHTPLAS	4
38	120283	BOLT, 3/8-16 X 1.00 HHC GR2	2
39	1499	NUT, 3/8 - 16 REGHEXCTRLK	2
40	180075	SCREW, 5/16-18 X .63	2
41	1498	NUT, 5/16-18 REGHEXCTRLK	2
42	329842	PARTS MANUAL	1
43	329848	OPERATORS MANUAL (GERMAN)	1
44	328195	AIR ASSIST MANUAL	1
45	327717	GRASS CATCHER MANUAL	1

^ REFERENCE ONLY

39" LAWN TRACTOR MODEL D3554-120

CHASSIS & HOOD ASSEMBLY

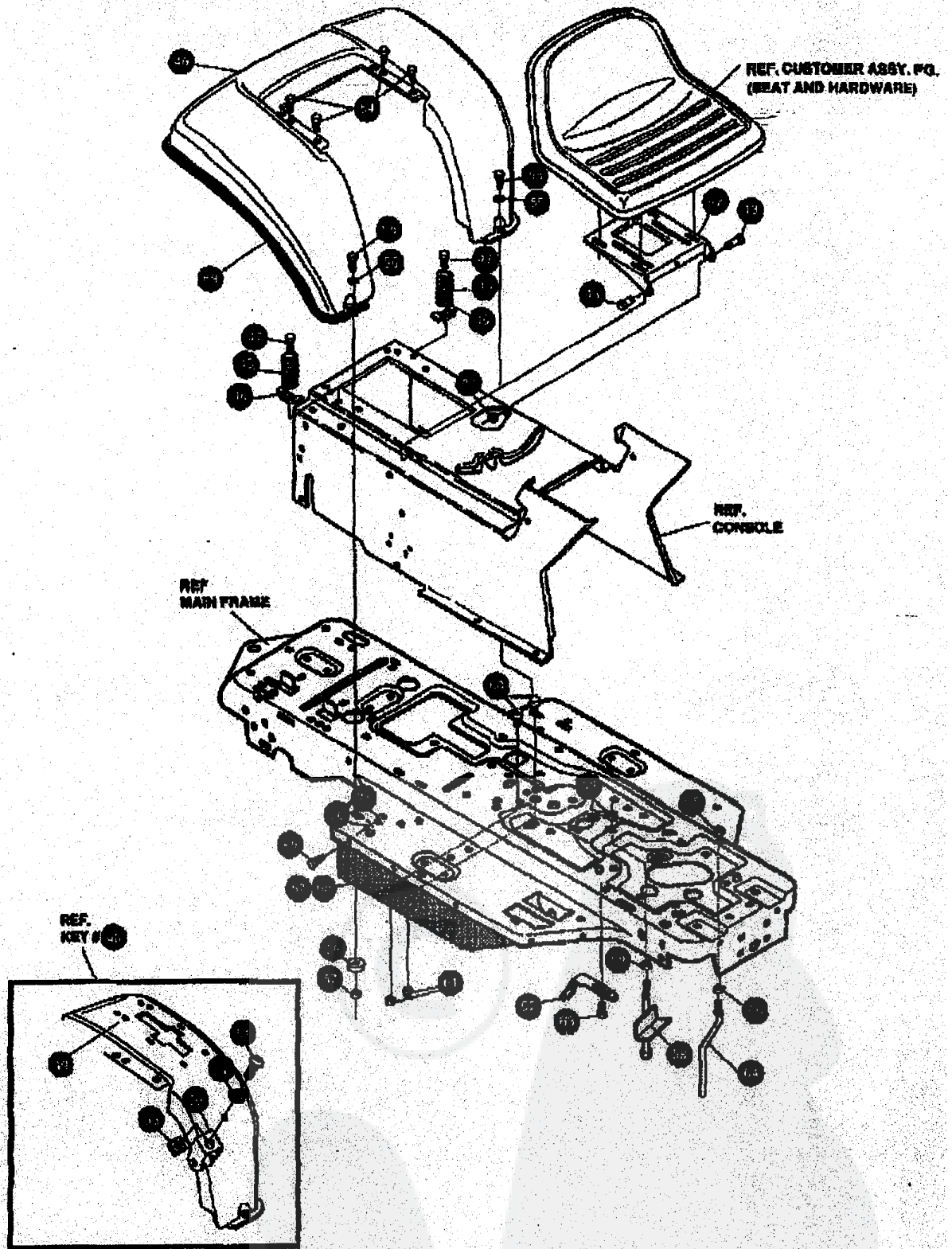

NOTE: ALWAYS USE ORIGINAL EQUIPMENT PARTS.
Use of service/replacement parts other than original equipment parts may void your warranty.

**ALL UNNUMBERED
ITEMS ARE INTERCHANGEABLE
WITH OPPOSITE SIDE**

39" LAWN TRACTOR MODEL D3554-120

KEY#	PART#	DESCRIPTION	QTY.
42.	58367-860	MP PLATE SEAT F5 SF LF	1
43.	20607	BOLT, .437X .188 HSH 5/16-18	2
44.	1498	NUT, 5/16-18 REGHEXOTRLK	2
45.	58220	SPRING, 1.43X2.38X.162 COM SEAT	2
46.	1341	ML CLAMP, SPRING 1.17"ID	2
47.	995346	SCREW, 1/4-20X .50 WAHHTAP	2
48.	^	SP. ASM FENDER F-5 SF 80FKOF	1
49.	321156-860	MP FENDER F-5 SF S.O.F.L.O.F.	1
50.	8239	CLEVIS	1
51.	439455	SCREW, 5/16-18X.68 PHPNMA	1
52.	301551	WASHER, .344IDX1.50.09	1
53.	120373	NUT, 5/16-18 SQ.	1
54.	995346	SCREW, 1/4-20X .50 WAHHTAP	4
55.	122007	SCREW, 5/16-18X.76HHC GR2	2
56.	446369	WASHER, FLAT .375X .88X.082	4
57.	1498	NUT, 5/16-18 REGHEXOTRLK	2
58.	328630	ASSY UPSTOP WHOSE PLATE	1
59.	1499	NUT, 3/8-16 REGHXOTRLK	2
60.	53448	PIN, 5/16-18 HOOD LATCH GR2-	2
61.	271184	NUT, 5/16-18 HEXKEPS	2
62.	902610-853	MP BRACKET SWITCH MOUNTING	1
63.	995346	SCREW, 1/4-20X .50 WAHHTAP	1
64.	60853	GLIDE, BELT	1
65.	41529	NUT, 3/8-16 HXOTRLKJAM GRD B.	1
66.	271190	NUT, 3/8-16 HEXKEPS	1
67.	305385	BELT GUARD RH	2
69.	57034	SCREW, 10-24X.83 TRHMA	12
70.	1501	WASHER, FLAT	12
71.	271166	NUT, 10-24 HEXKEPS	12

^ ORDER INDIVIDUAL PARTS.

39" LAWN TRACTOR MODEL D3554-120

MOWER SUSPENSION

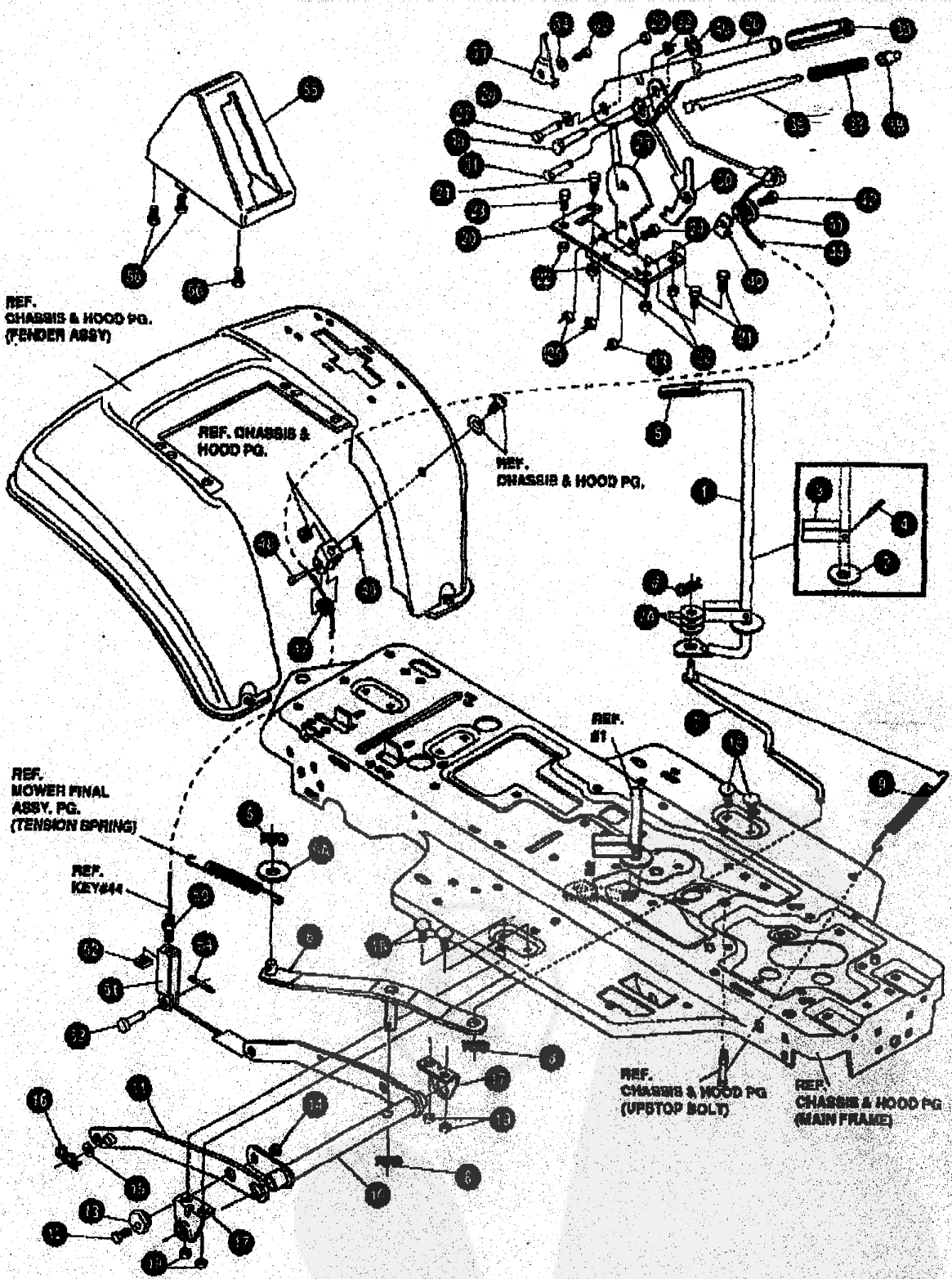

NOTE: ALWAYS USE ORIGINAL EQUIPMENT PARTS.
 Use of service/replacement parts other than original equipment parts may void your warranty.

ALL UNNUMBERED ITEMS ARE INTERCHANGEABLE WITH OPPOSITE SIDE

322358H

39" LAWN TRACTOR MODEL D3554-120

KEY#	PART#	DESCRIPTION	QTY.
1	325592	HANDLE, RH PTO NOMA DASH SF	1
2	22265	WASHER, FLAT .519X1.39X.119PL	1
3	305225	ML STOP, PTO ENGAGEMENT	1
4	326986	PIN, SPRING, 1.67DIA X 1.00LG HVPL	1
5	46478	GRIP, HAND .50ID 3.87 LG BLK	1
6	325597-953	WS STRAP ASSY, PTO BELCRANK	1
7	325590	ROD, BELCRANK LINK	1
7A	274517	WASHER, FLAT .408X.73X.082	3
8	8260	HAIR PIN	4
8A	25210	FLAT WASHER, .392X1.25X.09	1
9	325802	SPRING, .63X7.75X.0987 TENSION	1
10	326114-863	WP LIFT ASSY, LH	1
11	325130-853	WP LIFT ASSY, RH	1
12	180079	SCREW, 5/16-18X1.00 HHC GR5Z	1
13	58247	NUT, ADJUST	1
14	1498	NUT, 5/16-18 REGHEXOTRLK	1
15	417098	WASHER, FLAT .5391X1.06X.083Z	2
16	8260	PIN, HAIR .091 DIA X 1.88LG	2
17	325495-853	MP BRACKET, REAR HANG SUSP	2
18	126211	BOLT, 5/16-18X.83 CARR GR2Z	4
19	1498	NUT, 5/16-18 REGHEXOTRLK	4
20	319928	MP BRACKET, HEIGHT ADJUST	1
21	180077	SCREW, 5/16-18X .75 HHC GR5Z	4
22	1498	NUT, 5/16-18 REGHEXOTRLK	4
23	301238	QUADRANT, HEIGHT ADJUST	1
24	180077	SCREW, 5/16-18X .75 HHC GR5Z	2
25	1498	NUT, 5/16-18 REGHEXOTRLK	2
26	322292-863	MP HANDLE, LIFT SHORT(30" S.F.)	1
27	300171	BOLT, .800X .270 HHSH 5/16-18Z	1
28	988418	WASHER, FLAT .508X .75X.084Z	1
29	44108	NUT, 5/16-18 HWDFLCTRLK	1
30	301239	HF PAWL, SQUARE HTTR955	1
31	300171	BOLT, .800X .270 HHSH 5/16-18Z	1
32	44108	NUT, 5/16-18 HWDFLCTRLK	1
33	9435	ML POINTER	1
34	138479	WASHER, EXLK .195X.41X.03Z	1
35	36287	SCREW, #8-32X .38 HHWATAPGR2	1
36	303027	ROD, ACTUATOR SHORT	1
37	58326	SPRING, HEIGHT ADJUST	1
38	58325	KNOB, HEIGHT ADJ PUSH BUTTON	1
39	58329	GRIP, .750 OD W/ HOLE BLACK	1
40	9149	ML CABLE RETAINING BRACKET	1
41	48306	PULLEY, POWDER METAL	1
42	68338	BOLT, .375X .375 HHSH 1/4-20	1
43	1602	NUT, 1/4-20 REGHEXOTRLK	1
44	321430	CABLE, LIFT 21.60-30" S.F.	1
45	300310	PIN, CLEVIS .310 DIA + .475 LG ZPL	1
46	300311	RING, RET E .31X .25TRUXB193-81	1
47	48306	PULLEY, POWDER METAL	1
48	300317	PIN, CLEVIS .375 DIA. X .81 LG	1
49	8260	PIN, HAIR .091 DIA. X 1.66 LG	1
50	120375	NUT, 1/4-20 REGHEX	1
51	9405	ML CLEVIS, LIFT CABLE	1
52	120372	NUT, 1/4-20 REGSQ	1
53	39522	PIN, CLEVIS .312 X .812	1
54	121222	PIN, COTTER .090X.085X.75LG	1
55	300395	LIFT COVER-39" F5	1
56	300940	SCREW, #10 X .75 HHPLAST BLK	3

39" LAWN TRACTOR MODEL D3554-120

STEERING ASSEMBLY

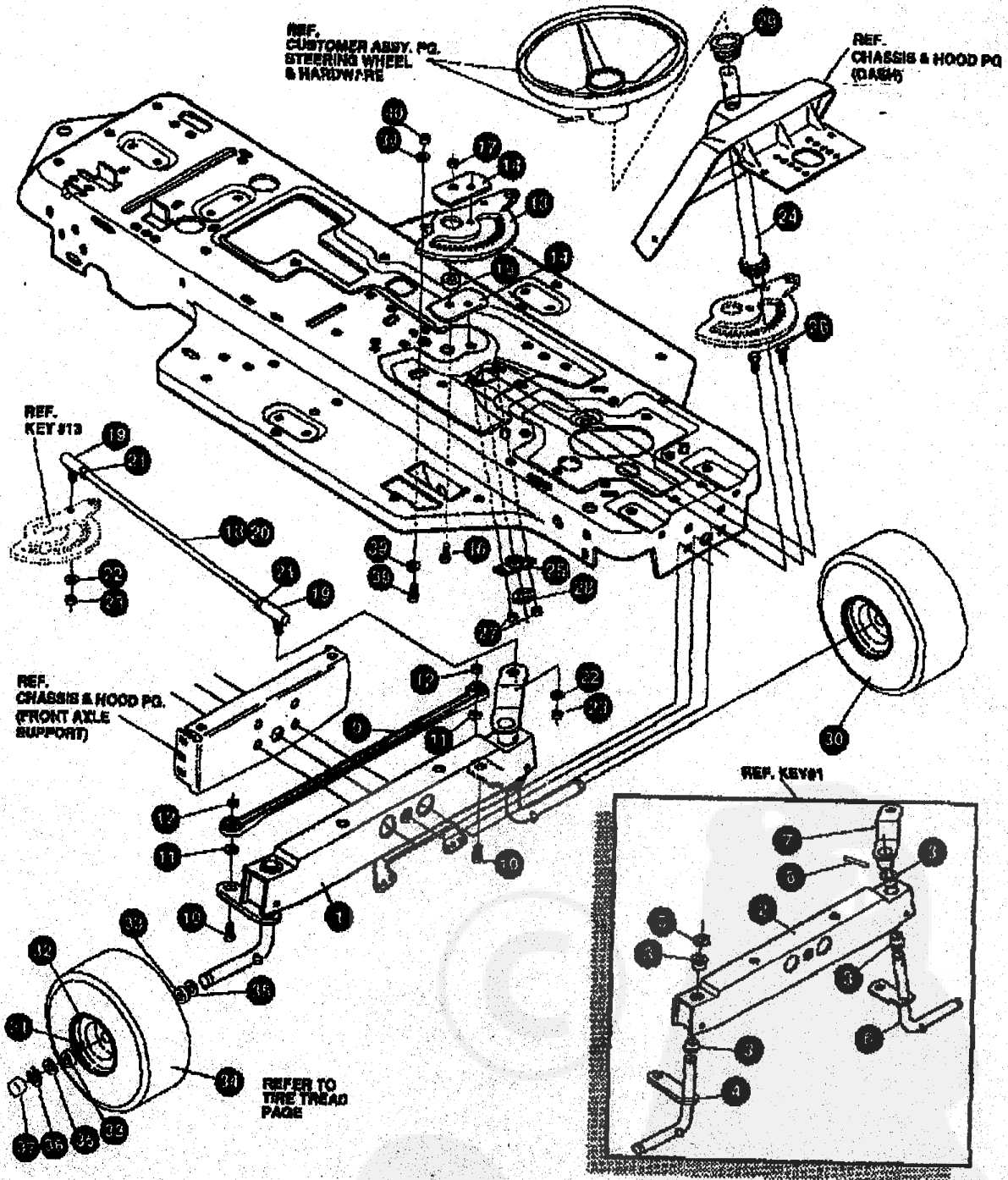

NOTE: ALWAYS USE ORIGINAL EQUIPMENT PARTS.
Use of service/replacement parts other than original equipment parts may void your warranty.

**ALL UNNUMBERED
ITEMS ARE INTERCHANGEABLE
WITH OPPOSITE SIDE**

327692D

39" LAWN TRACTOR MODEL D3554-120

KEY#	PART#	DESCRIPTION	QTY.
1	A	FRONT AXLE ASSEMBLY SF	1
2	324915-853	AXLE, FRONT	1
3	50546	BEARING, FLANGE	4
4	310368	SPINDLE, RH	1
5	36825	RING, RETEX	1
6	310367	SPINDLE, LH	1
7	327619-853	ARM, STEERING LH	1
8	454535	PIN, SPRING	1
9	302688	TIE ROD	1
10	122145	SCREW, 3/8-16X1.25 MMC	2
11	120392	WASHER, 3/8X.68X.10 REGSPTLK	2
12	1499	NUT, 3/8-16 REGHCTRLK	2
13	324752	SECTOR, GEAR	1
14	327633	PLATE SECTOR SF 4WS	2
15	324753	BUSHING SECTOR GEAR SF 4WS	1
16	180124	SCREW, 3/8-16X1.25	1
17	1499	NUT, 3/8-16 REGHCTRLK	1
18	326808	DRAGLINK ASSEMBLY	1
19	57158	BALL JOINT	2
20	58190	DRAGLINK	1
21	124925	NUT, 3/8-24 REGHEXJAM	2
22	120392	WASHER, REGSPTLK	2
23	120399	NUT, 3/8-24 REGHEX	2
24	327690	SHAFT PINION STEERING	1
25	325892	BRG. FL	1
26	326505	SCREW, 1/4-20X.75 GRD 5	2
27	46931	NUT, 1/4-20 FLLK NUT SIDE LOCK	2
28	20864	RING RET E	1
29	54802	RING, FL .763IDX1.370DX.50	1
30	A	ASSEMBLY TIRE	2
31	24187	VALVE STEM	1
32	38829	WHEEL W/BEARING	1
33	314416	BEARING, 1.380DX.759ID FLANGE	2
34		REFER TO TIRE TREAD PAGE	
35	842	WASHER, FLAT .765X1.31X.075	4
36	36825	RING, RETEX .57X.05	2
37	40994	HUB CAP	2
38	122145	SCREW, 3/8-16X1.25 GRD2	1
39	120394	WASHER, FLAT .406X.81X.065	2
40	44974	NUT, 3/8-16 HXWDFLLK	1

* ORDER INDIVIDUAL PARTS.

39" LAWN TRACTOR MODEL D3554-120

MOTION DRIVE ASSEMBLY

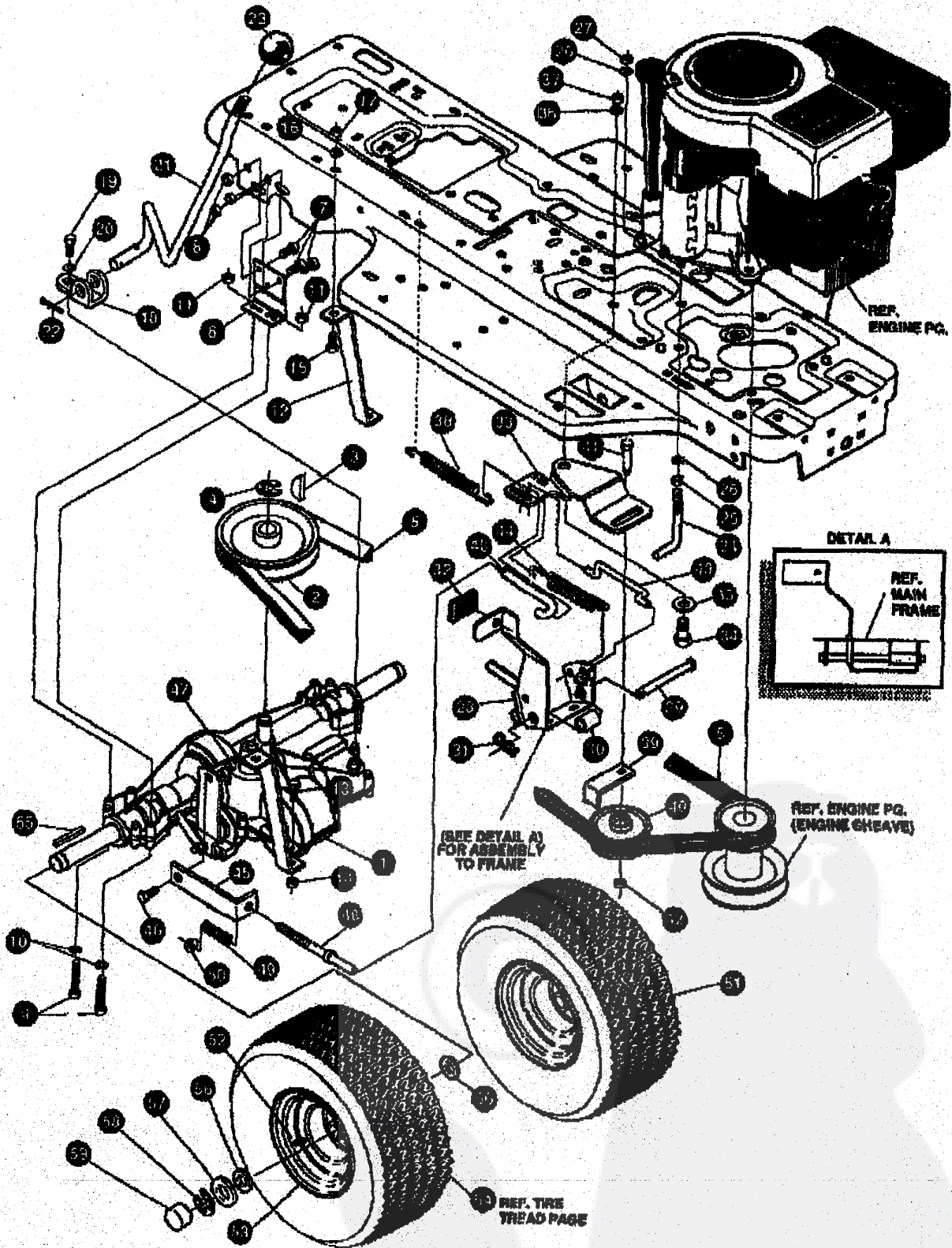

NOTE: ALWAYS USE ORIGINAL EQUIPMENT PARTS.
Use of service/replacement parts other than original equipment parts may void your warranty.

**ALL UNNUMBERED
ITEMS ARE INTERCHANGEABLE
WITH OPPOSITE SIDE**

327141C

KEY#	PART#	DESCRIPTION	QTY.
1.	^	TRANSAXLE P940-6SP SF FER	
2.	302745	PULLEY, IDLER V4L 6.60	1
3.	3021	KEY, WDRF 506 .750X.167X.312	1
4.	22053	RING, RETEX .58X.035TRU5100-82	1
5.	54758	BELT, V 4L 82.00 SF DRIVE	1
6.	53768-853	MF BRACKET, TRANSAXLE	1
7.	190075	SCREW, 5/16-18X .83 HHC	2
8.	1498	NUT, 5/16-18 REGHEXCTRLK	6
9.	180089	SCREW, 5/16-18X2.25 HHC	6
10.	120393	WASHER, FLAT .344X .69X.065	4
11.	1498	NUT, 5/16-18 REGHEXCTRLK	4
12.	923213	MF BRACKET, T/A TORQ. 915 S/F	1
13.	180087	SCREW, 5/16-18X2.00 HHC	1
14.	1498	NUT, 5/16-18 REGHEXCTRLK	1
15.	122017	SCREW, 5/16-18X1.00 HHC	1
16.	139485	WASHER, EXLK .320X.61X.03	1
17.	1498	NUT, 5/16-18 REGHEXCTRLK	1
18.	12616	MH BRACKET, SHIFT P920-3SP	1
19.	58255	SCREW, 1/4-20X .75 NYL.HHC	1
20.	57157	WASHER, .750X.250 SP-TRANSAXLE	1
21.	313934	LEVER, SHIFT 919 T/A S/F	1
22.	137185	PIN, COTTER .125 DIA X 1.00LG	1
23.	65514	KNOB, ROUND 1.60 DIA BLACK	1
24.	49596	MF BELT GUIDE	1
25.	271184	NUT, 5/16-18 HEXKEPS	1
26.	120393	WASHER, FLAT .344X .69X.065	1
27.	1498	NUT, 5/16-18 REGHEXCTRLK	2
28.	302803-853	SF ASSY, BRAKE PEDAL S.F.	1
29.	319576	PIN, CLEVIS .5 DIA, 4.87LG, ZN PL	1
30.	302801	SPACER, SLEV .53 X .82X1.406	1
31.	66180	PIN, HAIR .091 DIA X 1.62LG	1
32.	48761	PAD, CLUTCH/BRAKE PEDAL	1
33.	321959	MF IDLER ARM BRKT TRACTION SF	1
34.	41990	BOLT, .625X .218 HHS 5/16-18Z	1
35.	4107	WASHER, FLAT .695X1.31X.07	1
36.	45602	WASHER, FLAT .333X .67X.119	1
37.	1498	NUT, 5/16-18 REGHEXCTRLK	1
38.	327867	SPRING, 3/4 CDX7.75X.091 TENSIO	1
39.	39659	MF RETAINER, BELT	1
40.	35974	PULLEY, IDLER V4L 3.06X .62	1
41.	45892	BOLT, 3/8-16X1.50 CARR	1
42.	1499	NUT, 3/8-16 REGHXCTRLK	1
43.	49880	ROD, .258 DIA CLUTCH	1
44.	50562	SPRING, 3/80DX1.825X.055 TENSIO	1
45.	323210	BRACKET, TRACTION BRAKE S/F	1
46.	46824	BOLT, .500X .188 HHS 5/16-18Z	1
47.	1498	NUT, 5/16-18 REGHEXCTRLK	1
48.	323211	ROD, BRAKE 915 T/A SF	1
49.	313981	SPRING, CLUTCH .625 OD	1
50.	50852	NUT, 1/4-20 WDFLLK TOPLOCK	1
51.	*	TIRE & FRM, PU 20X8.0-8 TURWHI	1
52.	24167	VALVE STEM	2
53.	326362	WHEEL & HUB ASSY 20X8 WHITE	1
54.		REFER TO TIRE TREAD PAGE	1
55.	62928	KEY, SQUARE .18750X2.25LG	2
56.	642	WASHER, FLAT .765X1.31X.075	4
57.	42615	WASHER, FLAT .765X1.53X.07	2
58.	36626	RING, RETEX .57X.05TRU5133-75	2
59.	40394	HUB CAP, 1.500ID X 7.6LG	2

* CONTACT YOUR NEAREST TRANSAXLE DEALER FOR PARTS AND SERVICE.
 * ORDER INDIVIDUAL PARTS.

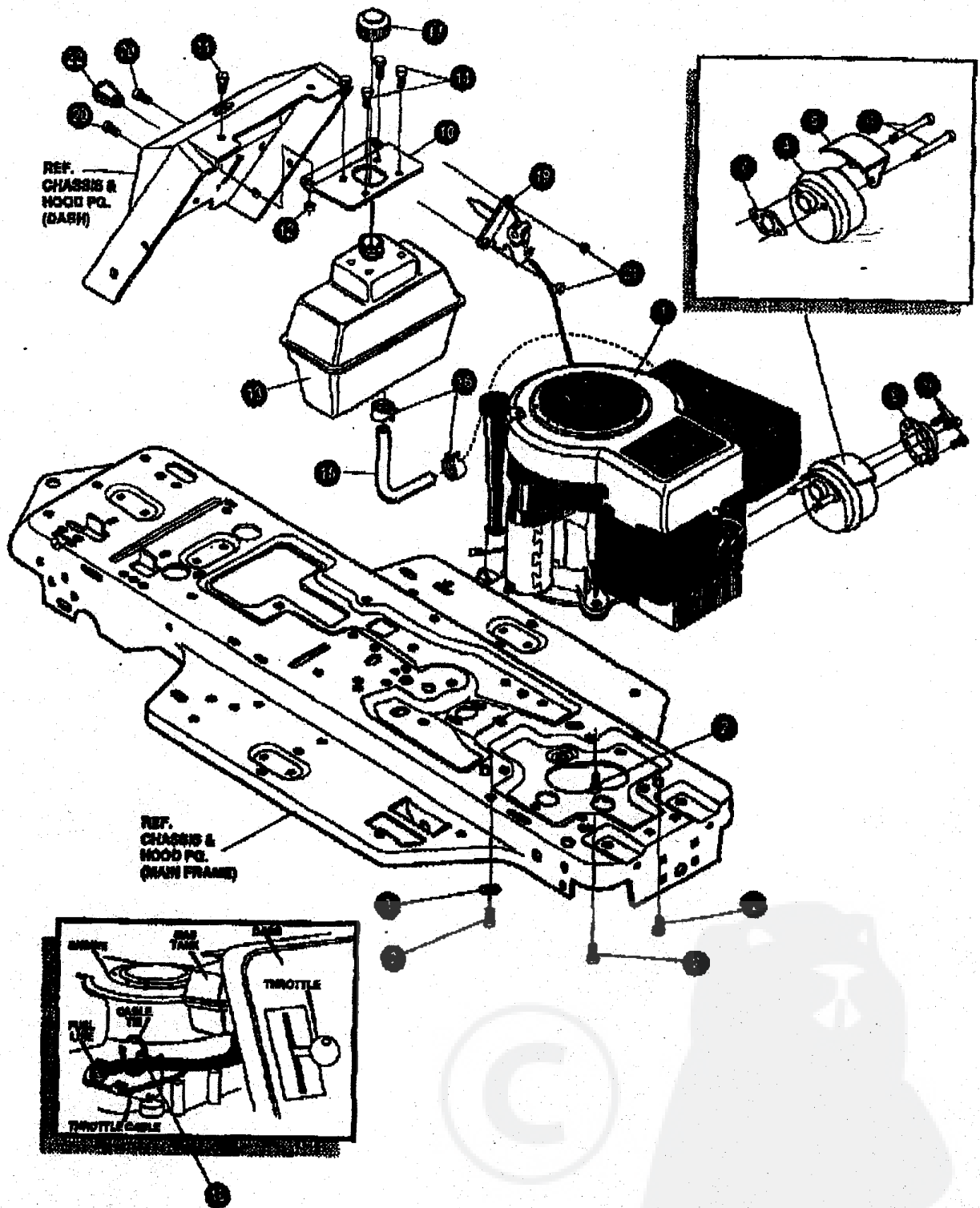

NOTE: ALWAYS USE ORIGINAL EQUIPMENT PARTS.
 Use of service/replacement parts other than original equipment parts may void your warranty.

**ALL UNNUMBERED
 ITEMS ARE INTERCHANGEABLE
 WITH OPPOSITE SIDE**

325610C

PRE-PAINTED DECK

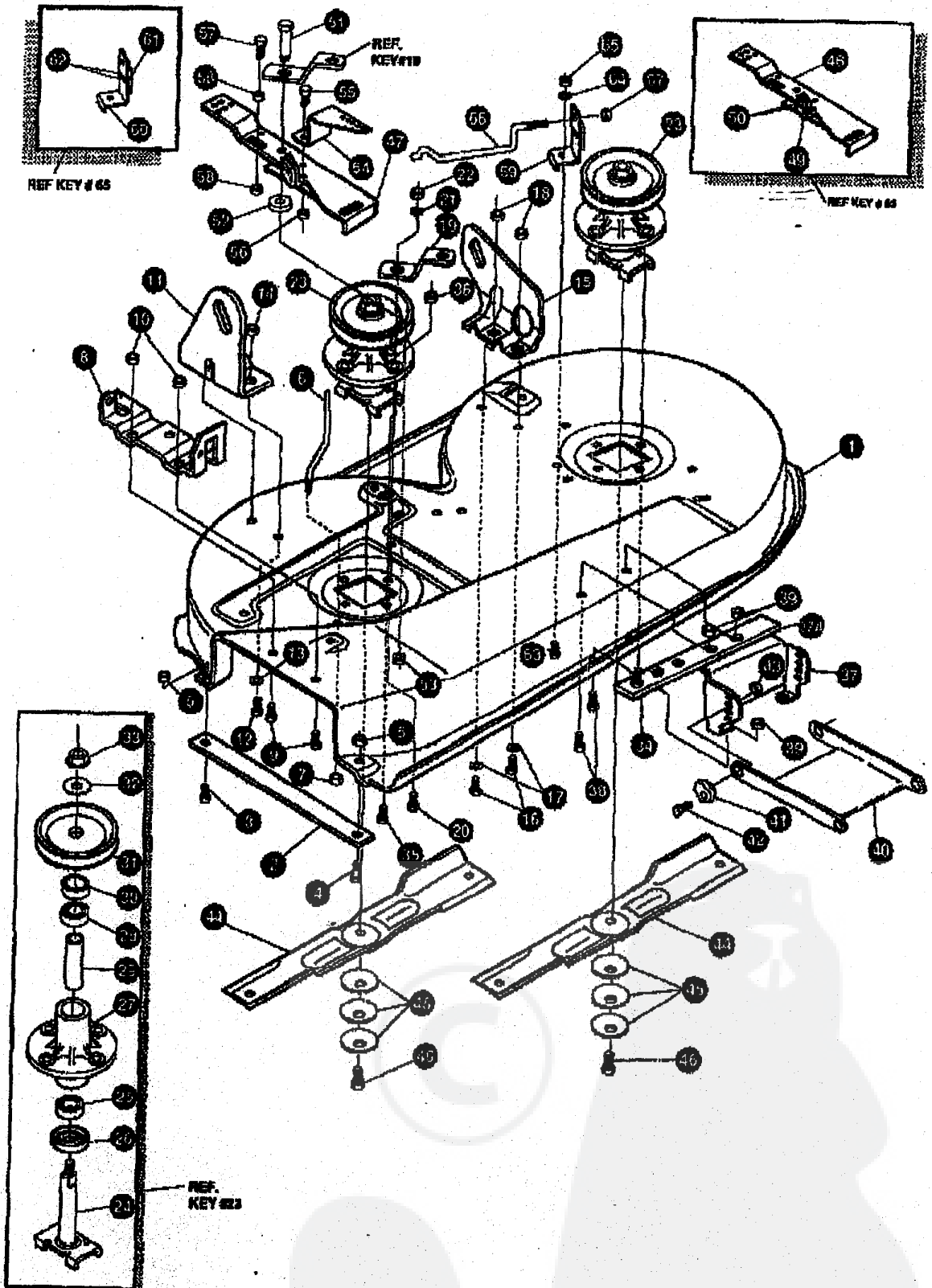

NOTE: ALWAYS USE ORIGINAL EQUIPMENT PARTS.
Use of service/replacement parts other than original equipment parts may void your warranty.

ALL UNNUMBERED ITEMS ARE INTERCHANGEABLE WITH OPPOSITE SIDE

328650D

KEY#	PART#	DESCRIPTION	QTY.
1	325106-853	DECK,38"SD MOWER	1
2	328295-853	BAR, SKID	1
3	126216	BOLT, 5/16-18X.75 CARR	1
4	120290	BOLT, 5/16-18X1.25 CARR	1
5	271184	NUT, 5/16-18 HEXKEPS	2
6	57318	GUIDE, BELT 5/16-18 THD	1
7	1498	NUT, 5/16-18 REGHEXCTRLK	1
8	313929	BRACKET, CHUTE	1
9	180079	SCREW, 5/16-18X.50 HHC	2
10	1498	NUT, 5/16-18 REGHEXCTRLK	2
11	313929	LIFT BRACKET, REAR,RH	1
12	180077	SCREW, 5/16-18X.75 HHC	2
13	120393	WASHER, FLAT .344X.89X.065	2
14	1498	NUT, 5/16-18 REGHEXCTRLK	2
15	310667	BRACKET,DECK LIFTREAR LH	1
16	180077	SCREW, 5/16-18X.75 HHC	2
17	120393	WASHER, FLAT .344X.89X.065	2
18	1498	NUT, 5/16-18 REGHEXCTRLK	2
19	315302-853	BRACKET, IDLER SUPPORT	1
20	300345	SCREW, 5/16-18X1.38 WATAP	1
21	120393	WASHER, FLAT .344X.89X.065	1
22	1498	NUT, 5/16-18 REGHEXCTRLK	1
23	56424-853	QUILL ASSY, 36/38/40/43	2
24	56425	SHAFT/SADDLE 36"	1
25	49562	BRNG, BALL	1
26	50816	DUST SHIELD	1
27	55547	QUILL CASTING	1
28	49562	BRNG, BALL	1
29	50818	SPACER,3.797LGX.668DX.89OD	1
30	51449	SPACER, 4.38LGX.832ODX.672ID-PM	1
31	318898	PULLEY,26/36" QUILL	1
32	58965	SPECIAL WASHER	1
33	1282	NUT, 7/16-20 WDFLLK	1
34	50834	SCREW, 5/16-18X.88 WAMHTAP	6
35	300345	SCREW, 5/16-18X1.38 WATAP	1
36	1498	NUT, 5/16-18 REGHEXCTRLK	1
37	312526	LIFT SUPPORT FRONT DECK	1
37A	328155-853	MOUNTING PLATE	1
38	180076	SCREW, 5/16-18X.89 HHC	4
39	1498	NUT, 5/16-18 REGHEXCTRLK	4
40	58965-853	LINK BRACKET,DECK FR	1
41	58247	ADJUSTING NUT	2
42	122017	SCREW, 5/16-18X1.00 HHC	2
43	1498	NUT, 5/16-18 REGHEXCTRLK	2
44	308932	BLADE, 19.69 HI-LIFT	2
45	2489	WASHER,.39IDX1.25DX.07 BELL VL.	6
46	39573	SCREW, 3/8-24X1.00 NYLMHC	2
47	320565-853	IDLER ARM ASSY.	1
48	300480-853	IDLER ARM	1
49	308973	BRAKE PAD	1
50	41601	RIVET,TRSET .187 DIAx.50LG	2
51	800180	BOLT,.50 X .186 HSSH3/8-16	1
52	986416	WASHER,FLAT .391 X 1.-- X .125	1
53	45171	NUT,5/16-18 X .75 HHC WHIZ-LOCK	1
54	326249-853	BRACKET EXTENSION IDLER	1
55	180077	SCREW,5/16-18 X .75 HHC	1
56	1498	NUT, 5/16-18 REGHEXCTRLK	1
57	121954	SCREW,1/4-20X2.00 HHC	1
58	271172	NUT,1/4-20 REGHEXKEPS	2
59	303247-853	ASSY BLADE BRAKE	1
60	303246-853	BRAKE ARM	1
61	308973	BRAKE PAD	1
62	135624	RIVET,TRSET .185 DIAx.41	2
63	180075	SCREW,5/16-18X.69 HHC	1
64	120393	WASHER,FLAT .344 X .69 X .65	1
65	1498	NUT, 5/16-18 REGHEXCTRLK	1
66	315306	ROD BRAKE	1
67	1502	NUT, 1/4-20 REGHEXCTRLK	1

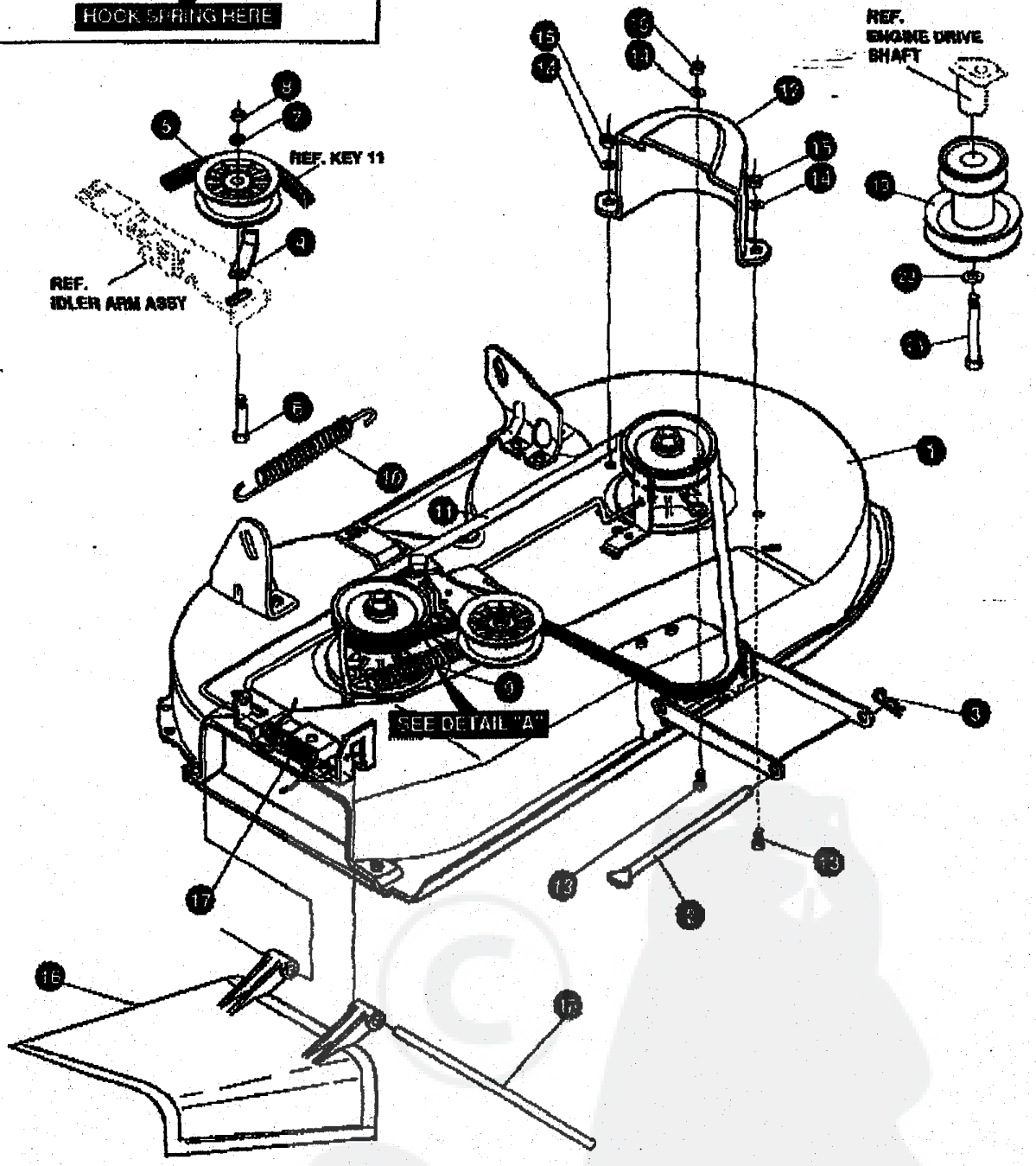
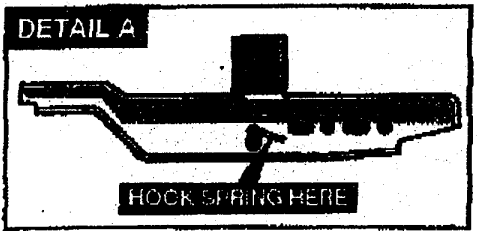

NOTE: ALWAYS USE ORIGINAL EQUIPMENT PARTS.
 Use of service/replacement parts other than original
 equipment parts may void your warranty.

**ALL UNNUMBERED
 ITEMS ARE INTERCHANGEABLE
 WITH OPPOSITE SIDE**

328678C

	PART#	DESCRIPTION	QTY.
1	A	ASSY DECK 35" SUS FOR AIR	1
2	58306	ROD, DECK HITCH	1
3	8260	PIN, HAIR .081 DIA X 1.65	1
4	1346	BELT RETAINER 2.55 OD	1
5	910926	PULLEY, IDLER BFF 4.00	1
6	57325	BOLT, 3/8-16 X 2.00 CARR	1
7	120392	WASHER, REGSPTLK.393X.68X.10	1
8	120377	NUT, 5/8-16 REGHX	1
9	322064	SPRING .071 X .62 X 4.37	1
10	326256	SPRING, TENSION	1
11	300680	BELT, V 6L 77.75	1
12	328257	GUARD, BELT LH	1
13	180075	SCREW, 5/16-16 X .63 HHC	3
14	120993	WASHER, FLAT .344X.69X.065	3
15	1498	NUT, 5/16-18 REGHEXOTRLK	3
16	57818	CHUTE-3680,38SD	1
17	314975	SPRING, TORSION	1
18	57317	PIVOT BAR, CHUTE	1



KEY#	PART#	DESCRIPTION	QTY.
1.	325084	WIRE HARNESS SF	
2.	322298	SPLICER	1
3.	57444	CABLE TIE	1
4.	41482	PRESS CLIP, 1.380LG .255ID	1
5.	41482	PRESS CLIP, 1.380LG .255ID	2
6.	327355	SWITCH-IGN. (AFTER FIRE) 3 POS	2
7.	327352	NUT, 5/8-8 ACME DELTA FOR BOOT	1
8.	327350	KEY IGNITION SWITCH STL DELTA	1
9.	300334	LIGHT SWITCH ON/OFF PANEL MNT	1
10.	67476	SWITCH SCR MNT DP NC	1
11.	57220	SCREW, #12 X .50 PHPNTAP	1
12.	326653	SWITCH, SNPMNT NO. .055/116	2
13.	53716	SOLENOID	1
14.	187745	SCREW, 1/4-20X.75 HXSEMMA	1
15.	1084	WASHER, FLAT .281X1.00X.063	2
16.	1502	NUT, 1/4-20 REGHEXCTRLK	1
17.	271172	NUT, 1/4-20 REGHEXKEPS	2
18.	281187	NUT, 5/16-24 HKEPS	1
19.	57444	TIE, CABLE 5.62L	2
20.	56511	WIRE, GROUND, 12.5"	1
21.	271184	NUT, 5/16-18 HEXKEPS	1
22.	67547	SWITCH SEAT	1
23.	160505	SCREW, 1/4-20X.38 PHPNHMAGR2	1
24.	302257	BATTERY 12V 7 PLATE	2
25.	56360	BATTERY BRACKET	1
26.	40234	ROD, BATTERY	1
27.	120392	WASHER, FLAT.281X.63X.055	2
28.	325232	NUT, WING 1/4-20	2
29.	120854	SCREW, 1/4-20X.63 HHC	2
30.	271172	NUT, 1/4-20 REGHEXKEPS	2
31.	302031	FUSE, 15 AMP SPAPE TYPE	1

**Spade type fuse included with the wire harness.

SCHEMATIC DRAWING

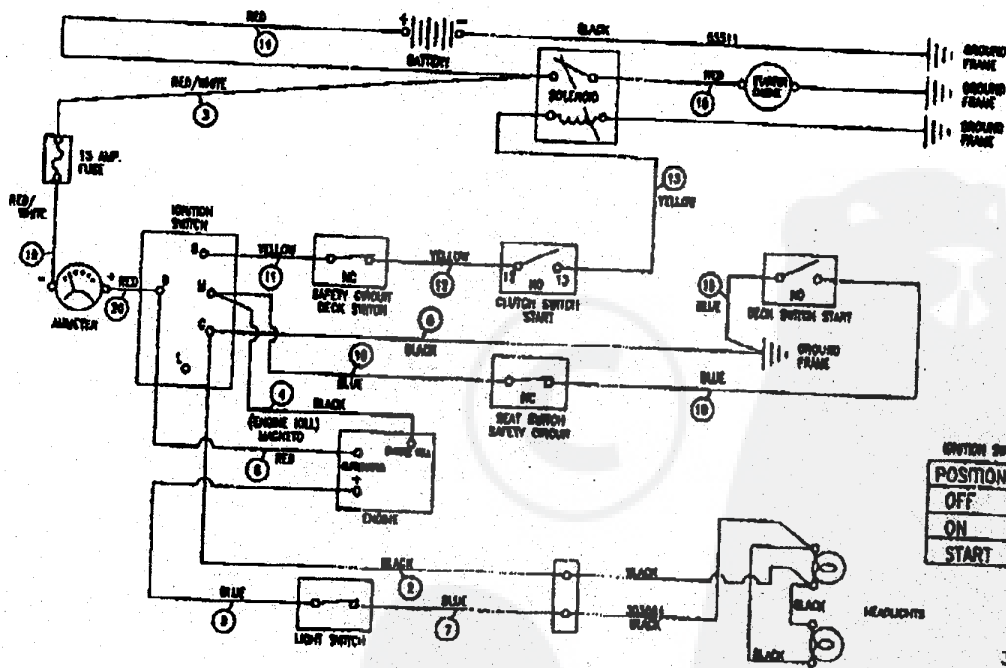

DECALS (DECORATIVE)

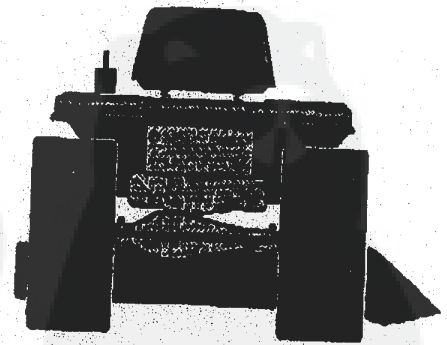
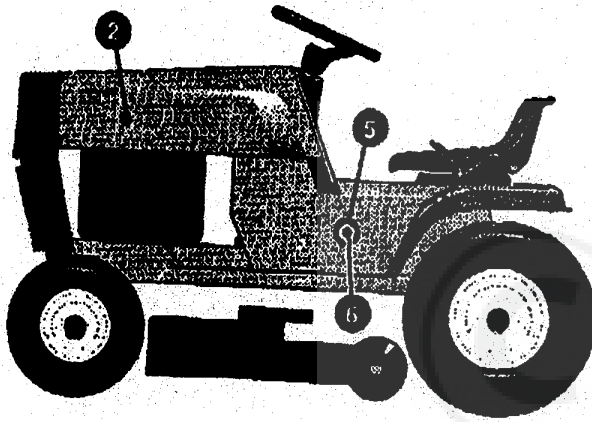
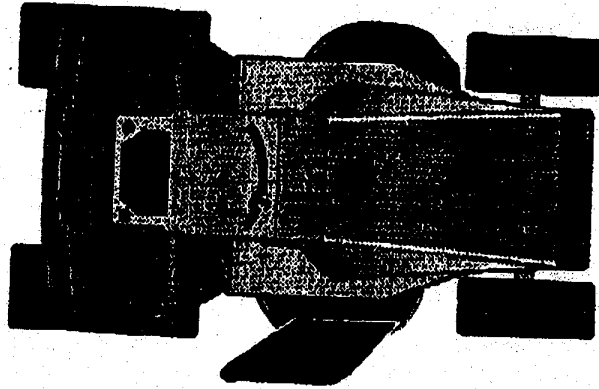
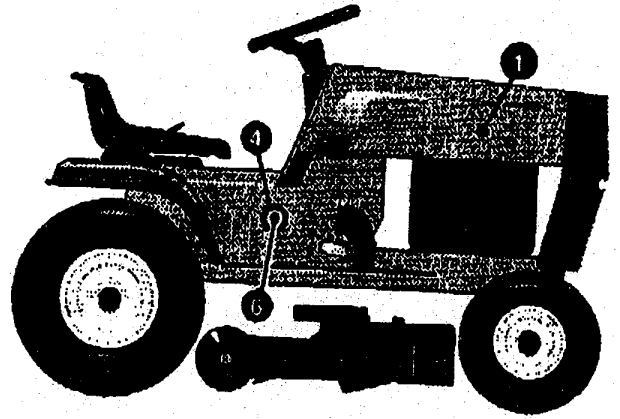
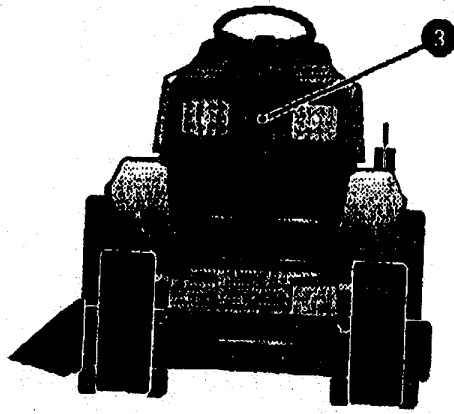

328379C

KEY#	PART#	DESCRIPTION	QTY.
1.	70684	DECAL, HOOD RH	1
2.	70685	DECAL, HOOD LH	1
3.	312002	DECAL, GRILLE INSERT	1
4.	70682	DECAL, CONSOLE RH	1
5.	70683	DECAL, CONSOLE LH	1
6.	314208	NAMEPLATE, 12/38 WHT/BLK	2
7.		REFERENCE ONLY	1

DECALS (INSTRUCTIONAL)

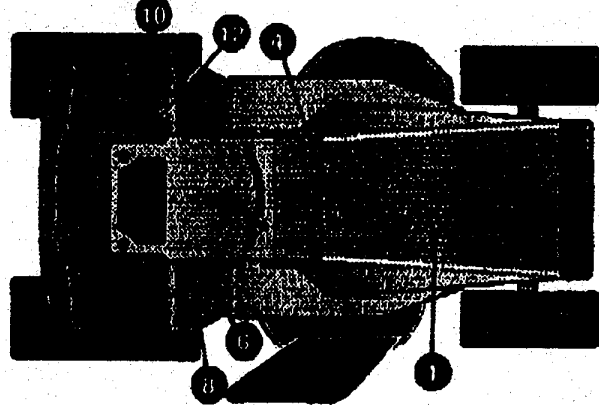
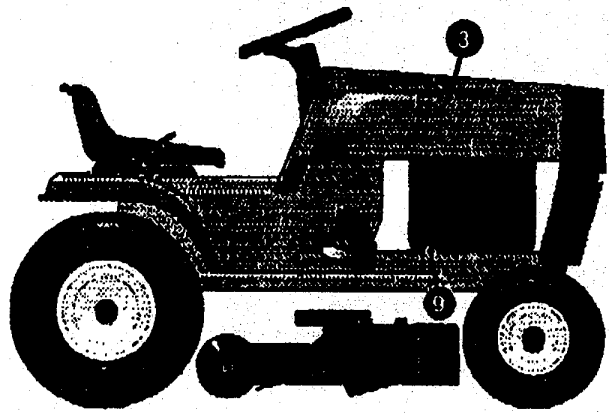
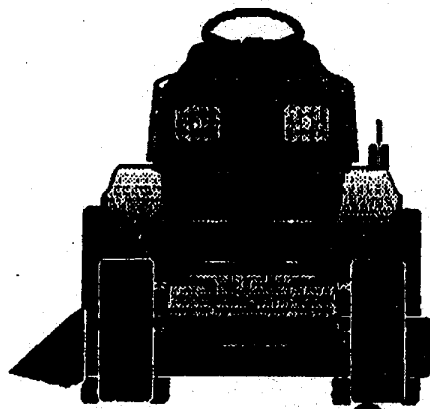

CONSOLE DETAIL

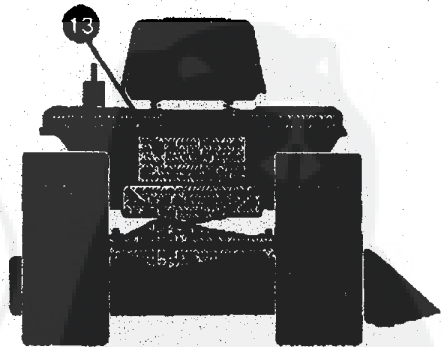
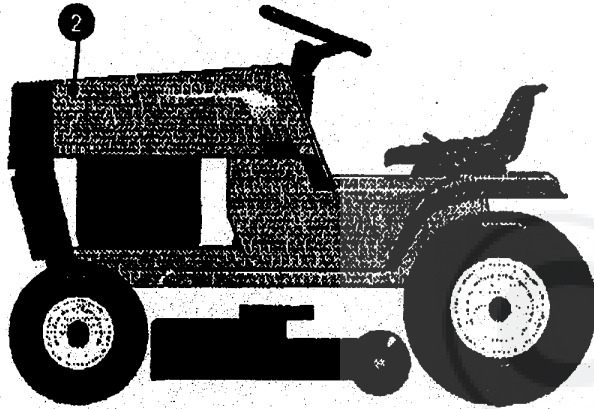
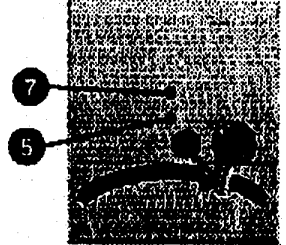

328372B

KEY#	PART#	DESCRIPTION	QTY.
1.	55832	PAD, FOAM TOP HOOD	1
2.	66833	PAD, FOAM HOOD SIDE LH	1
3.	65834	PAD, FOAM HOOD SIDE RH	1
4.	320717	DECAL, DASH PLAIN EXPORT	1
5.	301104	DECAL, CONSOLE TOP SHIFT 5-SP	1
6.	305770	DECAL, CAUTION TRIANGLE, EUROPE	1
7.	69524	DECAL, INSTRUCT CONSOLE TOP GER	1
8.	68902	DECAL, WARNING, FRENCH/GERMAN	1
9.	68903	DECAL, BRAKE/CLUTCH ISO	1
10.	301897	DECL, LIFT DECK BLADE HEIGHT	1
11.		REFERENCE ONLY	1
12.	68901	DECAL, BLADE HEIGHT ADJ. EUROPE	1
13.	318010	DECAL, TUV GS	1