

10. MKR 05 '00 9:25 NO.005 P.02

PARTS MANUAL

Lawn Tractors

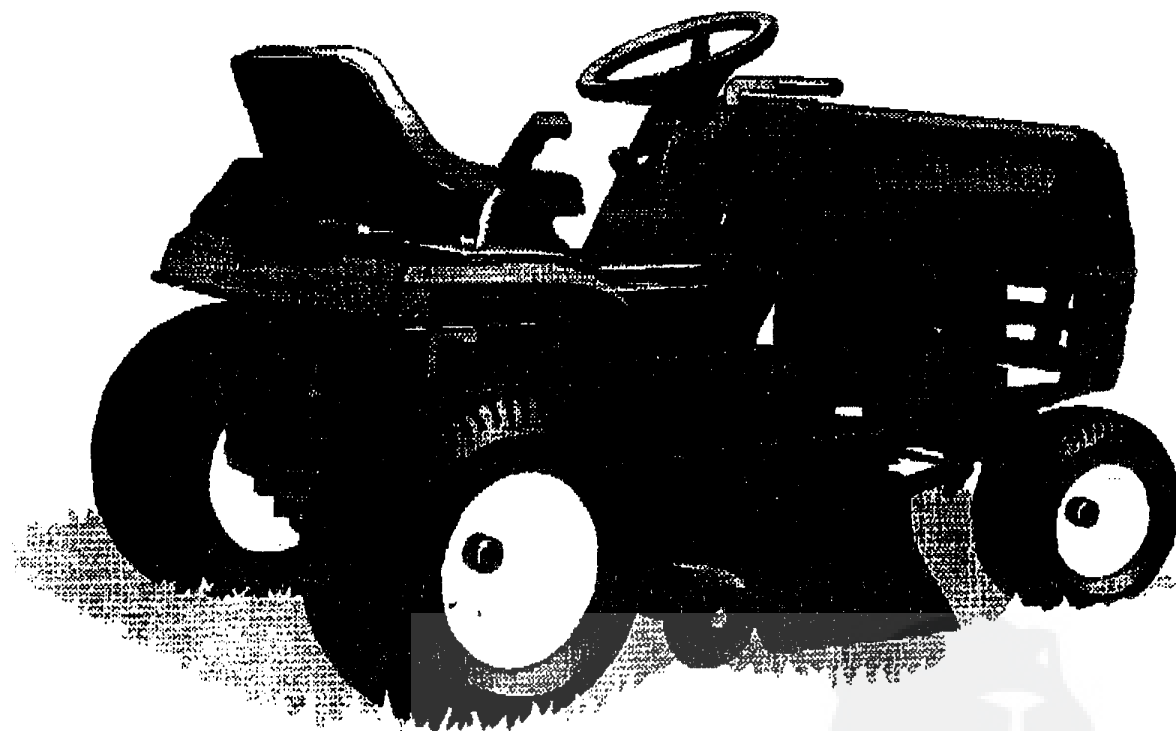

Model E3554-120

333247 A

12-21-60

Price 65.00



SAFETY RULES

THESE INSTRUCTIONS ARE FOR YOUR PROTECTION. PLEASE READ THEM CAREFULLY.



IMPORTANT

THIS CUTTING MACHINE IS CAPABLE OF AMPUTATING HANDS AND FEET AND THROWING OBJECTS. FAILURE TO OBSERVE THE FOLLOWING SAFETY INSTRUCTIONS COULD RESULT IN SERIOUS INJURY OR DEATH.

I. GENERAL OPERATION:

- Know controls and how to stop quickly.
- Read, understand, and follow all instructions in the manual and on the machine before starting.
- Only allow responsible adults, who are familiar with instructions, to operate the machine.
- Wear safety glasses or eye shields when assembling or operating the machine.
- Do not operate machine when barefooted. Always wear substantial footwear, preferably steel-toed shoes.
- Do not wear loose fitting clothing that could get caught in moving parts.
- Clear the area of objects such as rocks, toys, wire, etc., which could be picked up and thrown by the blade(s).
- Be sure the area is clear of other people before mowing. Stop machine if anyone enters the area.
- Never carry passengers.
- Do not mow in reverse unless absolutely necessary. Always look down and behind before and while backing.
- Be aware of the mower discharge direction and do not point it at anyone. Do not operate the mower without either the snike grass catcher or the guard in place.
- Slow down before turning.
- Never leave a running machine unattended. Always turn off blades, set parking brake, stop engine, and remove keys before dismounting.
- Turn off blade(s) when not mowing.
- Stop engine before removing grass catcher or unlogging chute.
- Mow only in daylight or good artificial light.
- Do not operate the machine while under the influence of alcohol or drugs.
- Watch for traffic when operating near or crossing roadways.
- Use care when mowing around a fixed object to prevent the blade(s) from striking it. Never deliberately run over any foreign object.
- Use extra care when loading or unloading the machine into a trailer or truck.
- Use care when pulling loads or using heavy equipment.
 - a. Use only approved drawbar hitch points.
 - b. Limit loads to those that you can safely control.
 - c. Do not turn sharply. Use care when backing.
 - d. Use counterweight(s), wheel weight or tire chains when suggested in attachment(s) instructions.

II. SLOPE OPERATION:

Slopes are a major factor related to loss-of-control and tip-over accidents, which can result in severe injury or death. All slopes require extra caution. If you cannot back up the slope or if you feel uneasy on it, do not mow it.

DO

- Mow up and down slopes, not across.
- Remove obstacles such as rocks, tree limbs, etc.
- Watch for holes, ruts, or bumps. Uneven terrain could overturn the machine. Tall grass can hide obstacles.
- Use slow speed. Choose a low gear so that you will not have to stop or shift while on the slope.
- Follow the manufacturer's recommendations for wheel weights or counterweights to improve stability.
- Use extra care with grass catchers or other attachments. These can change the stability of the machine.
- Keep all movement on the slopes slow and gradual. Do not make sudden changes in speed or direction.
- Avoid starting or stopping on a slope. If tires lose traction, turn off the blade(s) and proceed slowly straight down the slope.

DO NOT

- Do not turn on slopes unless necessary, and then slowly and gradually downhill, if possible.
- Do not mow near drop-offs, ditches or embankments. The

mower could suddenly turn over if a wheel is over the edge of a cliff or ditch, or if an edge caves in.

- Do not mow on wet grass. Reduced traction could cause sliding.
- Do not try to stabilize the machine by putting your foot on the ground.
- Do not use grass catcher on steep slopes.

III. CHILDREN:

Tragic accidents can occur if the operator is not alert to the presence of children. Children are often attracted to the machine and the mowing activity. Never assume that children will remain where you last saw them.

- Keep children out of the mowing area and under the watchful care of another responsible adult.
- Be alert and turn machine off if children enter the area.
- Before and when backing, look behind and down for small children.
- Never carry children. They may fall off and be seriously injured or interfere with safe machine operation.
- Never allow children to operate the machine.
- Use extra care when approaching blind corners, shrubs, trees, or other objects that may obscure vision.

IV. SERVICE:

- Use extra care in handling gasoline and other fuels. They are flammable and vapors are explosive.
 - a. Use only an approved container.
 - b. Never remove gas cap or add fuel with the engine running. Allow engine to cool before refueling. Do not smoke.
 - c. Never refuel the machine indoors.
 - d. Never store the machine or fuel container inside where there is an open flame, such as in a water heater.
- Check fuel supply before each use allowing space for expansion as the heat of the engine and/or sun can cause gasoline to expand and overflow the tank.
- Use extra care when handling battery acid. Acid contact with skin may cause severe burns. Eye contact may cause blindness.
- Use extra care when servicing the battery. Explosive gas is produced in the battery. Do not service the battery while smoking or near an open spark or flame. This may cause the battery to explode causing serious injury.
- Never run a machine inside a closed area. Exhaust fumes contain CARBON MONOXIDE, an odorless and DEADLY GAS.
- Keep nuts and bolts, especially blade attachment bolts, tight and keep equipment in good condition.
- Never tamper with safety devices. Check their operation regularly.
- Do not change the engine governor settings or overspeed engine.
- Reduce fire hazards. Keep machine free of grass, leaves, or other debris build-up. Clean up oil or fuel spillage. Allow machine to cool before storing.
- Stop and inspect the equipment if you strike an object. Repair, if necessary, before restarting.
- Never make adjustments or repairs with the engine running.
- Grass catcher components are subject to wear, damage, and deterioration, which could expose moving parts or allow objects to be thrown. Frequently check components and replace with manufacturer's recommended parts, when necessary.
- Mower blade(s) are sharp and can cut. Wrap the blade(s) or wear gloves, and use extra caution when servicing them. Check brake operation frequently. Adjust and service as required.



LOOK FOR THIS SYMBOL TO POINT OUT IMPORTANT SAFETY PRECAUTIONS. IT MEANS... ATTENTION!!! BECOME ALERT!!! YOUR SAFETY IS INVOLVED.

OWNER'S INFORMATION

Record the following information about your unit so that you will be able to provide it in case of loss or theft.

MODEL NUMBER: - (Enter complete 8 digit number from model plate on unit)

PURCHASE DATE: ___ / ___ / ___ CODE NO.: _____ SERIAL NO.: _____

DEALER'S NAME AND ADDRESS: _____

CITY: _____ STATE: _____ TELEPHONE: _____

TOOLS REQUIRED FOR ASSEMBLY

- 2 - 7/16 inch Wrenches (or adjustable wrench)
- 1 - 1/2 inch Wrench (or adjustable wrench)
- 1 - Small Phillips Screwdriver with a 1/4 inch shank
- 1 - Hammer

NOTE: See page 24 (CUSTOMER ASSY) for Seat & Hardware

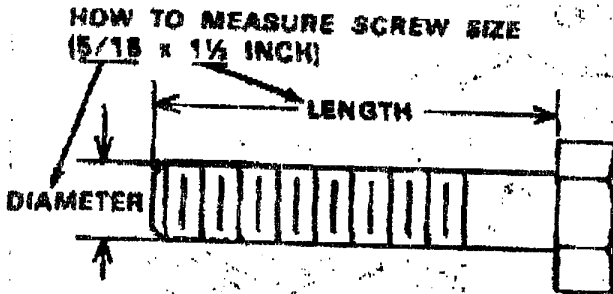

DANGER

This lawn tractor can be dangerous if carelessly used.

Read your Operator's Manual thoroughly before operating your lawn tractor.

Always wear safety glasses or eye shields while assembling or operating your lawn tractor.

DO NOT carry passengers at any time.

Keep your hands, feet, hair and loose clothing away from the discharge area, the underside of the mower deck or any moving parts while the engine is running.

DO NOT allow children or young teenagers to operate or be near your lawn tractor while it is operating.

ALWAYS GIVE THE FOLLOWING INFORMATION WHEN ORDERING REPAIR PARTS:

1. The PART NUMBER; 2. The PART NAME; 3. QUANTITY DESIRED; 4. The MODEL NUMBER (As shown on Model Plate).

SEND PART ORDERS AS PER INSTRUCTIONS ON THE FRONT PAGE.

DO NOT USE KEY NUMBERS WHEN ORDERING REPAIR PARTS. ALWAYS USE PART NUMBERS.

All replacement parts will be supplied in current production colors or in a neutral color.
A handling fee is applicable to airtal parts orders.

YOUR UNIT IS RIGHT HAND (RH) OR LEFT HAND (LH) AS YOU STAND BEHIND IT.

REPAIR PARTS

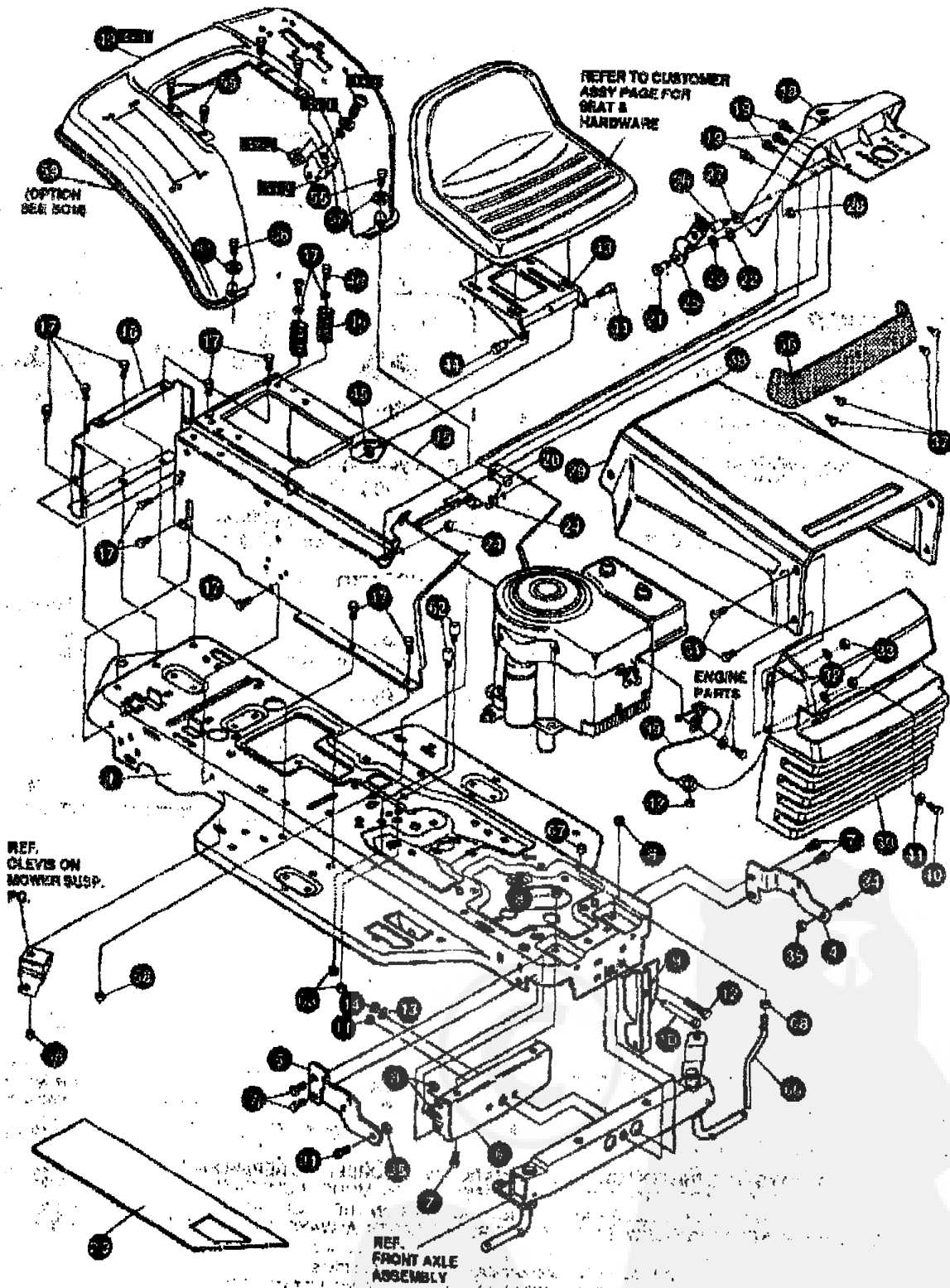

NOTE: ALWAYS USE ORIGINAL EQUIPMENT PARTS. Use of service/replacement parts other than original equipment parts may void your warranty.

ALL UNNUMBERED ITEMS ARE INTERCHANGEABLE WITH OPPOSITE SIDE

329799 A

CHASSIS & HOOD ASSEMBLY

| KEY# | PART# | DESCRIPTION | QTY |
|------|------------|--------------------------------|------|
| 1 | 331173-860 | FRAME, MAIN SF RIDER | |
| 2 | 331834 | FOOT PAD, RH SF, FULL WIDTH | 1 |
| 3 | 331836 | FOOT PAD, LH SF, FULL WIDTH | 1 |
| 4 | 314579-853 | BRACKET, GRILLE LH SF, W/ARM | 1 |
| 5 | 314578-853 | BRACKET, GRILLE RH SF | 1 |
| 6 | 56362-859 | BRKT, SUPPORT, FRONT AXLE SF | 1 |
| 7 | 328154 | SCREW, 5/16-18X1.0WDFLLK | 2 |
| 8 | 55273 | NUT, 5/16-18 HXWDFLLK | 6 |
| 9 | 321138-860 | BRACKET, HANGER 30" S.F. | 1 |
| 10 | 50720 | BOLT, 3/8X2.875 9PH 1/2-20 | 1 |
| 11 | 274654 | NUT, 1/2-20 REGHXCTRLK | 1 |
| 12 | 180138 | SCREW, 3/8-16X3.00 HHC | 1 |
| 13 | 2483 | WASHER, 3/8DX1.25DX.07 BELL VL | 4 |
| 14 | 1499 | NUT, 3/8-16 REGHXCTRLK | 4 |
| 15 | 324748-860 | CONSOLE, SF DYNA FNDR SHFT | 1 |
| 16 | 58235-860 | CONSOLE, REAR COVER | 1 |
| 17 | 995346 | SCREW, 1/4-20X .50 WAHTAP | 1 |
| 18 | 320486-860 | DASH, SF NOMA DYNA STYLING | 15 |
| 19 | 995338 | SCREW, 1/4-20X .50 WAHTAP | 1 |
| 20 | 50352 | NUT, 1/4-20 WDFLLK TOPLOCK | 4 |
| 21 | 8482 | BOLT, 3/8X .186 HHSH 5/16-18 | 2 |
| 22 | 120394 | WASHER, FLAT, 3/8X .88X.065 | 2 |
| 23 | 120393 | WASHER, FLAT, 3/8X .88X.065 | 2 |
| 24 | 1499 | NUT, 5/16-18 REGHEXCTRLK | 2 |
| 25 | 57159 | LATCH, .84WDX.047 ASSY HOOD | 2 |
| 26 | 53446 | PIN, 5/16-18 HOOD LATCH | 2 |
| 27 | 138538 | WASHER, REGINTLK 3/8X.61X.05 | 2 |
| 28 | 45174 | NUT, 5/16-18 HEXWDFLLK WHIZ | 2 |
| 29 | 314538-860 | HOOD SF 17-21 | 2 |
| 30 | 325401 | GRILLE G17 | 1 |
| 31 | 274872 | SCREW, 1/4-20X .50 WAHHC | 1 |
| 32 | 120392 | WASHER, FLAT, 281X .83X.065 | 4 |
| 33 | 1502 | NUT, 1/4-20 REGHEXCTRLK | 4 |
| 34 | 36149 | BOLT, 3/8X .500 HHSH 5/16-18 | 4 |
| 35 | 1499 | NUT, 5/16-18 REGHEXCTRLK | 2 |
| 36 | 302333 | LENS, SMOKED W/TAB NO LOGO | 1 |
| 37 | 57786 | SCREW, #8 X .50 PLASTITEAM LO | 4 |
| 38 | 52151 | EDGING (78"-47458) WIDE BLK | 4 |
| 39 | 311094 | LANYARD, HOOD 11.75LG H15 VANG | 25.0 |
| 40 | 180020 | SCREW, 1/4-20X .75 HHC | 1 |
| 41 | 120392 | WASHER, FLAT, 281X .83X.065 | 1 |
| 42 | 1502 | NUT, 1/4-20 REGHEXCTRLK | 1 |
| 43 | 58367-860 | PLATE, SEAT F5 SF LF | 1 |
| 44 | 20507 | BOLT, 3/8X .186 HHSH 5/16-18 | 1 |
| 45 | 1499 | NUT, 5/16-18 REGHEXCTRLK | 2 |
| 46 | 330483 | SPRING, SEAT 1.800DX2 25LG | 2 |
| 47 | 120392 | WASHER, FLAT, 281X .83X.065 | 2 |
| 48 | 995346 | SCREW, 1/4-20X .50 WAHTAP | 2 |
| 49 | | ASM FENDER F-5 SF S.O.F.L.O.F | 1 |
| 49-1 | 332423-860 | FENDER, F-5 SF S.O.F.L.O.F | 1 |
| 49-2 | 9239 | CLEVIS | 1 |
| 49-3 | 439455 | SCREW, 5/16-18X .56PHPNMA BKPH | 1 |
| 49-4 | 301541 | WASHER, 3/4DX1.50DX.09 CU | 1 |
| 49-5 | 120373 | NUT, 5/16-18 SQ | 1 |
| 55 | 995346 | SCREW, 1/4-20X .50 WAHTAP | 1 |
| 56 | 190081 | SCREW, 5/16-10X1.25 HHC | 4 |
| 57 | 446363 | WASHER, FLAT, 3/8X .88X.062 | 2 |
| 58 | 55273 | NUT, 5/16-18 HXWDFLLK | 12 |
| 59 | 55023 | TRIM, 77.5" BLACK NARROW | 77.5 |
| 62 | 53446 | PIN, 5/16-18 HOOD LATCH | 2 |
| 63 | 271184 | NUT, 5/16-18 HEXKEPS | 2 |
| 66 | 50653 | GUIDE, BELT | 2 |
| 67 | 41529 | NUT, 3/8-16 HXCTRLKJAM | 1 |
| 68 | 271190 | NUT, 3/8-16 HEXKEPS | 1 |
| 69 | 333247 | PARTS MANUAL | 1 |
| 70 | 323000 | OPERATOR'S MANUAL (ENGLISH) | 1 |
| 71 | 323207 | OPERATOR'S MANUAL (FRENCH) | 1 |
| 72 | 323208 | OPERATOR'S MANUAL (GERMAN) | 1 |

ORDER INDIVIDUAL PARTS

ALWAYS USE ORIGINAL PARTS

E3554-120

REPAIR PARTS

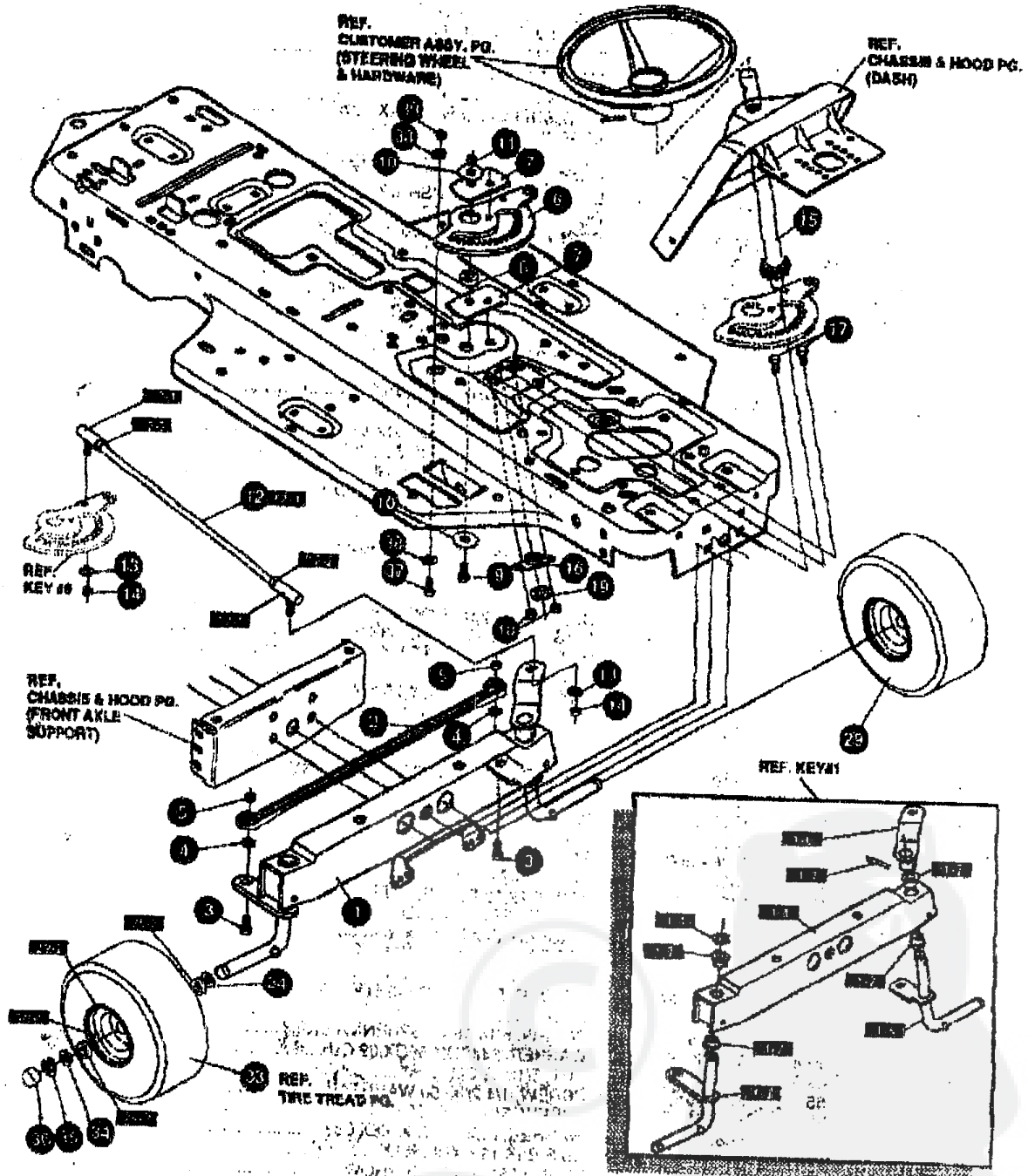

NOTE: ALWAYS USE ORIGINAL EQUIPMENT PARTS. Use of service/replacement parts other than original equipment parts may void your warranty.

ALL UNNUMBERED ITEMS ARE INTERCHANGEABLE WITH OPPOSITE SIDE

326426 G

STEERING ASSEMBLY

| KEY# | PART# | DESCRIPTION | QTY |
|------|------------|---------------------------------|-----|
| 1 | A | | |
| 1-1 | 312280 | AXLE FRONT ASSY, LONG | 1 |
| 1-2 | 50516 | FRONT AXLE ASSY | 1 |
| 1-3 | 310368 | BRNG, FL 759IDX1.002ODX .75 | 4 |
| 1-4 | 36625 | SPINDLE ASSY, RH LONG | 1 |
| 1-5 | 310367 | RING, RETEX .57X.05TRU8133-75 | 1 |
| 1-6 | 327619-863 | SPINDLE ASSY, LH LONG | 1 |
| 1-7 | 454565 | ARM ASSY 4WS FRNT STRNG | 1 |
| 2 | 302688 | PIN, SPRING 260DIA X1.25LG HVPL | 1 |
| 3 | 180124 | SF ASSY, TIE ROD 19.31 LG | 1 |
| 4 | 120382 | SCREW, 3/8-16X1.25 HHC | 2 |
| 5 | 1499 | WASHER, REGSPTLK .893X.68X.10 | 2 |
| 6 | 324752 | NUT, 3/8-16 REGHKOTRLK | 2 |
| 7 | 330789 | GEAR, SECTOR HT | 1 |
| 8 | 330021 | PLATE, SECT 4WS | 2 |
| 9 | 181843 | BUSHING, SECTOR GEAR 4WS | 1 |
| 10 | 845 | SCREW, 3/8-24X1.50 HHC | 1 |
| 11 | 412349 | WASHER, FLAT .890X1.25X.119 | 1 |
| 12 | 328808 | NUT, 3/8-24 HKOTRLK | 1 |
| 12-1 | 57159 | DRAG LINK ASSY 17.80LG | 1 |
| 12-2 | 124925 | BALL JOINT 3/8 THD SHORT STUD | 2 |
| 12-3 | 56190 | NUT, 3/8-24 REGHEXJAM | 2 |
| 13 | 120382 | DRAG LINK | 1 |
| 14 | 120369 | WASHER, REGSPTLK .893X.68X.10 | 2 |
| 15 | 327894 | NUT, 3/8-24 REGHEX | 2 |
| 16 | 325882 | LF SHAFT, PIN-STEER BLK | 1 |
| 17 | 328505 | BRNG, FL 50 IDX1.3700DX | 1 |
| 18 | 46931 | SCREW, 1/4-20X.75 (TO 30-35 FT) | 2 |
| 18 | 20864 | NUT, 1/4-20 WDFL MAC-LOCK | 2 |
| 19 | 41059 | RING, RET E .39X.04TRU8133-50 | 1 |
| 20 | 24167 | TIRE & RIM, PU 15X5.0X6 TUR | 2 |
| 20-1 | 39937 | VALVE STEM | 1 |
| 20-2 | 314416 | RIM, WHEEL | 1 |
| 20-3 | | BEARING, FL | 1 |
| 21 | | REFER TO TIRE TREAD PAGE | |
| 22 | 642 | WASHER, FLAT .755X1.31X.075 | 4 |
| 23 | 36625 | RING, RETEX .57X.05TRU8133-75 | 2 |
| 24 | 40394 | HUB CAP, 1.500ID X 76LG | 2 |
| 25 | 180124 | SCREW, 3/8-16X1.25 HHC | 1 |
| 26 | 120394 | WASHER, FLAT .405X .81X.085 | 2 |
| 27 | 45171 | NUT, 3/8-16 HWDFL WHIZ-LOCK | 1 |

* ORDER INDIVIDUAL PARTS

ALL INFORMATION IS FOR REFERENCE ONLY. THE USER SHALL BE RESPONSIBLE FOR OBTAINING THE NECESSARY PERMITS AND APPROVALS FOR THE USE OF THIS INFORMATION.

NOTES: ALWAYS USE ORIGINAL EQUIPMENT PARTS TO MAINTAIN SAFETY AND PERFORMANCE. ALWAYS USE ORIGINAL EQUIPMENT PARTS TO MAINTAIN SAFETY AND PERFORMANCE.

REPAIR PARTS

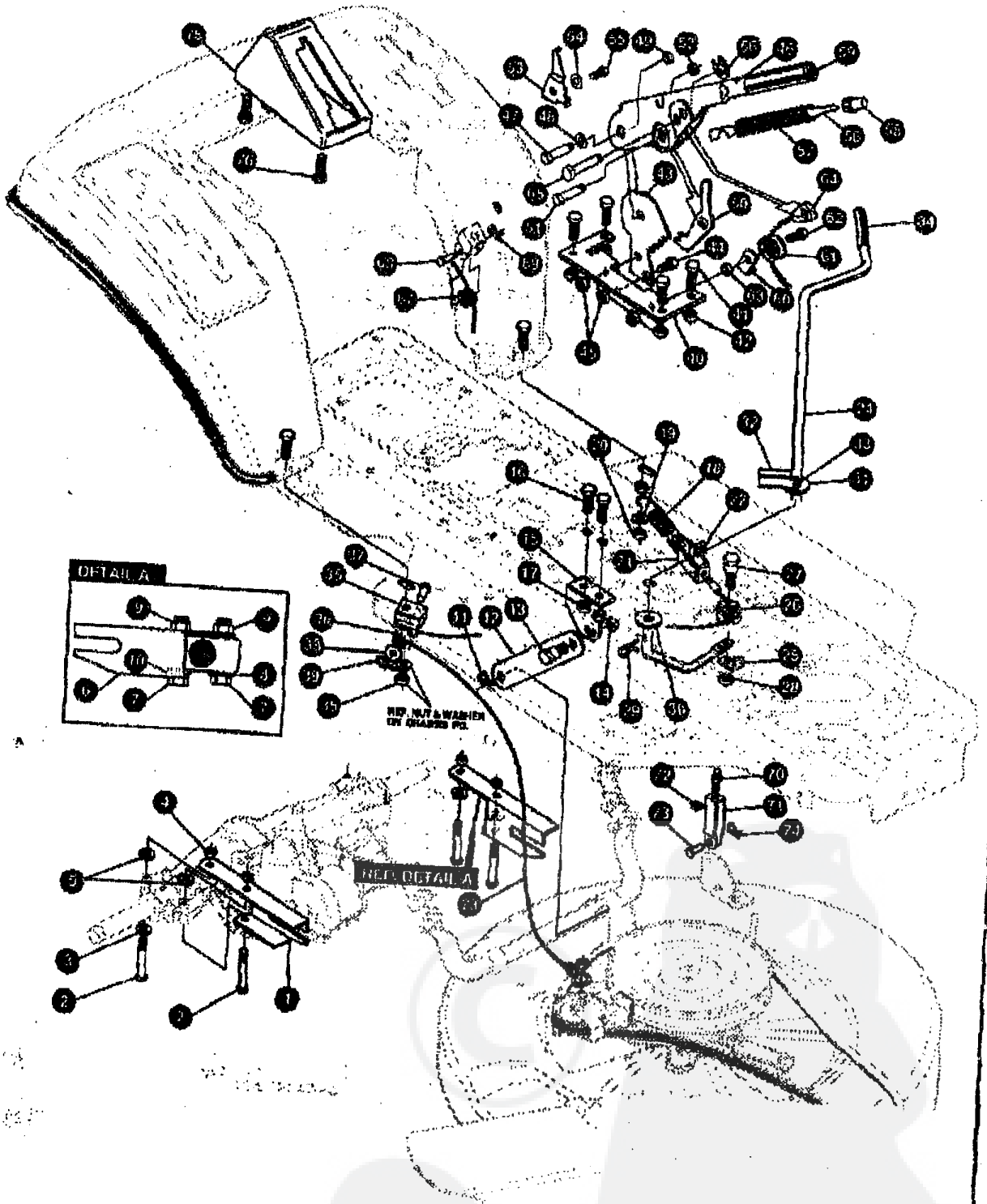

NOTE: ALWAYS USE ORIGINAL EQUIPMENT PARTS. Use of service/replacement parts other than original equipment parts may void your warranty.

ALL UNNUMBERED ITEMS ARE INTERCHANGEABLE WITH OPPOSITE SIDE

331231 A

MOWER SUSPENSION ASSEMBLY

| KEY# | PART# | DESCRIPTION | QTY |
|------|------------|---------------------------------|-----|
| 1 | 821371 | BRACKET, REAR SUPT RH | 1 |
| 2 | 180118 | SCREW, 5/16-18X3.00 HHC | 1 |
| 3 | 120383 | WASHER, FLAT .344X.68X.066 | 2 |
| 4 | 1498 | NUT, 5/16-18 REGHEXCTRLK | 1 |
| 5 | 314702 | SPACER, SLEV .344X1.00X .500PM | 2 |
| 6 | 321370 | BRACKET, REAR SUPT LH | 2 |
| 7 | 180118 | SCREW, 5/16-18X3.00 HHC | 1 |
| 8 | 120383 | WASHER, FLAT .344X.68X.066 | 2 |
| 9 | 1498 | NUT, 5/16-18 REGHEXCTRLK | 1 |
| 10 | 314702 | SPACER, SLEV .344X1.00X .500PM | 2 |
| 11 | 56180 | PIN, HAIR .091 DIA X 1.62LG | 1 |
| 12 | 323889 | BRACKET, LINK LOWER BLK | 1 |
| 13 | 318560 | BOLT, 500X .225 HHSH 5/16-18 | 1 |
| 14 | 1498 | NUT, 5/16-18 REGHEXCTRLK | 1 |
| 15 | 320605-853 | BRACKET, LIFT BAR 80° | 1 |
| 16 | 180077 | SCREW, 5/16-18X .75 HHC | 1 |
| 17 | 1498 | NUT, 5/16-18 REGHEXCTRLK | 2 |
| 18 | 300473 | SPRING, TENSION 7.92LG+17LB/IN | 1 |
| 19 | 418824 | WASHER, FLAT .344X1.13X.062 | 1 |
| 20 | 1498 | NUT, 5/16-18 REGHEXCTRLK | 1 |
| 21 | 9405 | CLEVIS, LIFT CABLE | 1 |
| 22 | 120372 | NUT, 1/4-20 REGSQ | 1 |
| 23 | 322261 | CABLE, CLUTCH 31.31 LG (30° SF) | 1 |
| 24 | 314877 | LEVER, CLUTCH 5F 30° SUB ZINC | 1 |
| 25 | 1288 | LF BRKT, CABLE RETAIN | 1 |
| 26 | 48306 | PULLEY, POWDER METAL | 1 |
| 27 | 68336 | BOLT, 375X .375 HHSH 1/4-20 | 1 |
| 28 | 1502 | NUT, 1/4-20 REGHEXCTRLK | 1 |
| 29 | 8280 | PIN, HAIR .091 DIA X 1.68LG | 1 |
| 30 | 896426 | WASHER, FLAT .516X.88X.064 | 1 |
| 31 | 22866 | WASHER, FLAT .516X1.38X.119PL | 1 |
| 32 | 305225 | STOP, PTO ENGAGE | 1 |
| 33 | 325388 | PIN, SPRING .187DIA X 1.19LG HD | 1 |
| 34 | 65514 | KNOB, ROUND 1.50DIA OR GRIP SF | 1 |
| 35 | 321285-853 | CLEVIS, P.T.O. PULLY | 1 |
| 36 | 45306 | PULLEY, POWDER METAL | 1 |
| 37 | 300917 | PIN, CLEVIS .375DIA X .81 LG | 1 |
| 38 | 896416 | WASHER, FLAT .391X1.00X.125 | 1 |
| 39 | 8280 | PIN, HAIR .091 DIA X 1.68LG | 1 |
| 40 | 313926 | BRACKET, HGT/ADJUST SUPPORT | 1 |
| 41 | 180077 | SCREW, 5/16-18X .75 HHC | 4 |
| 42 | 1498 | NUT, 5/16-18 REGHEXCTRLK | 4 |
| 43 | 301238 | QUADRANT, HEIGHT ADJUST | 1 |
| 44 | 180077 | SCREW, 5/16-18X .75 HHC | 2 |
| 45 | 1498 | NUT, 5/16-18 REGHEXCTRLK | 2 |
| 46 | 322292-853 | HANDLE, LIFT SHORT (30° S.F.) | 1 |
| 47 | 300171 | BOLT, 500X .270 HHSH 5/16-18 | 1 |
| 48 | 896416 | WASHER, FLAT .508X .78X.024 | 1 |
| 49 | 44108 | NUT, 5/16-18 HWDFLCTRLK | 1 |
| 50 | 301238 | PAWL, SQUARE | 1 |
| 51 | 300171 | BOLT, 500X .270 HHSH 5/16-18 | 1 |
| 52 | 44108 | NUT, 5/16-18 HWDFLCTRLK | 1 |
| 53 | 9426 | POINTER, HEIGHT ADJ | 1 |
| 54 | 138470 | WASHER, EXLK .188X.41X.03 | 1 |
| 55 | 35287 | SCREW, #8-32X .38 HHWATAP | 1 |
| 56 | 303027 | ROD, ACTUATOR SHORT | 1 |
| 57 | 68326 | SPRING, HEIGHT ADJUST | 1 |
| 58 | 68325 | KNOB, HEIGHT ADJ PUSH BUTTON | 1 |
| 59 | 68329 | GRIP, .750 OD W/ HOLE, BLACK | 1 |
| 60 | 9149 | LF BRKT, CABLE RETAIN | 1 |
| 61 | 48306 | PULLEY, POWDER METAL | 1 |
| 62 | 68336 | BOLT, 375X .375 HHSH 1/4-20 | 1 |
| 63 | 1502 | NUT, 1/4-20 REGHEXCTRLK | 1 |
| 64 | 321430 | CABLE, LIFT 21.50 - 50° | 1 |
| 65 | 300310 | PIN, CLEVIS .310DIA X .75LG | 1 |
| 66 | 300311 | RING, RET E .31X.26TRIX8133-31 | 1 |
| 67 | 48306 | PULLEY, POWDER METAL | 1 |
| 68 | 300317 | PIN, CLEVIS .375DIA X .81 LG | 1 |
| 69 | 8280 | PIN, HAIR .091 DIA X 1.68LG | 1 |
| 70 | 120375 | NUT, 1/4-20 REGHEX | 1 |
| 71 | 9406 | LF CLEVIS, LIFT CABLE | 1 |
| 72 | 120372 | NUT, 1/4-20 REGSQ | 1 |
| 73 | 39522 | PIN, CLEVIS .312 X .812 | 1 |
| 74 | 121222 | PIN, COTTER .090 DIA X .75LG | 1 |
| 75 | 300336 | LIFT COVER | 1 |
| 76 | 300340 | SCREW, #10 X .75 HHPLAST BLK | 1 |

REPAIR PARTS

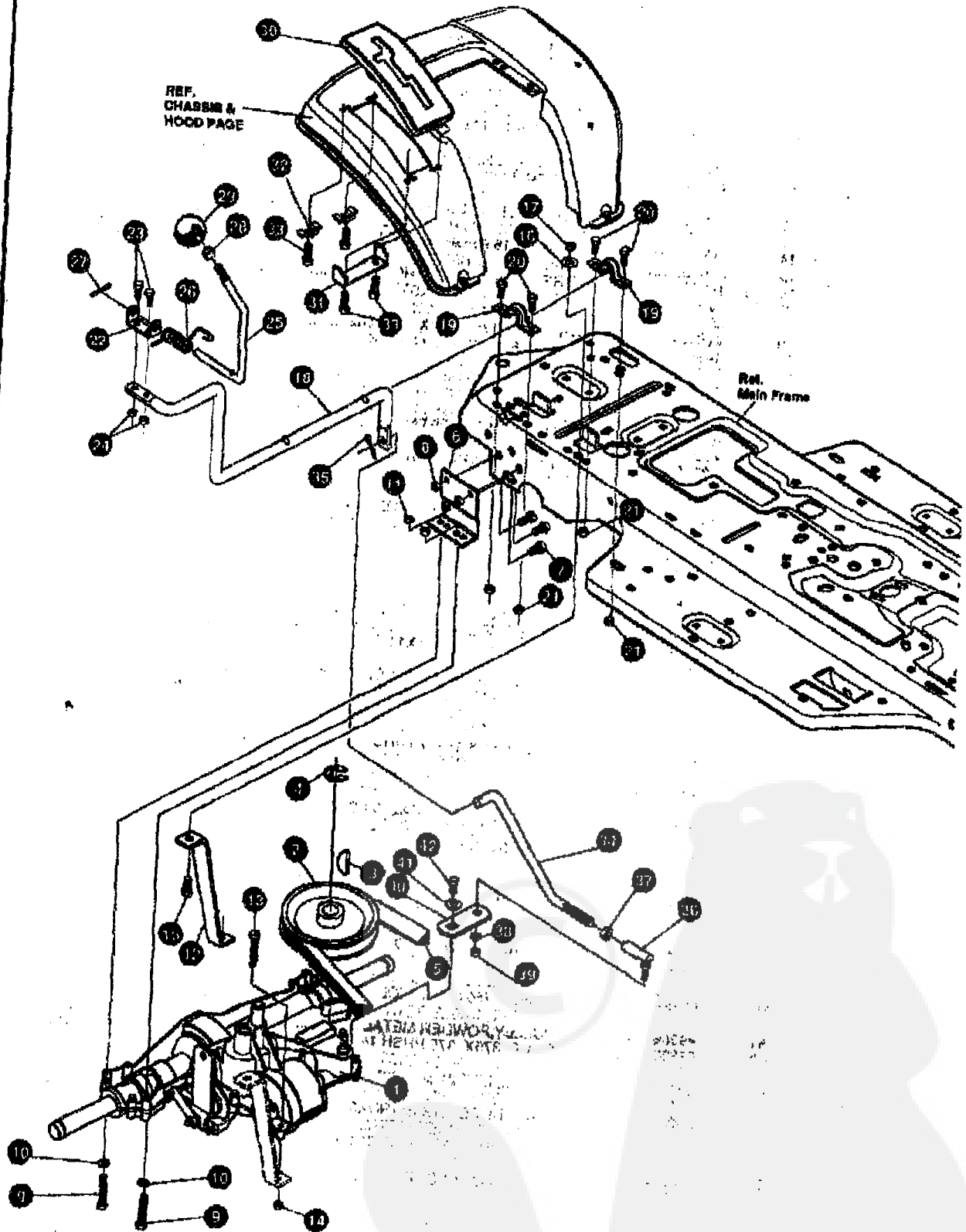

NOTE: ALWAYS USE ORIGINAL EQUIPMENT PARTS. Use of service/replacement parts other than original equipment parts may void your warranty.

ALL UNNUMBERED ITEMS ARE INTERCHANGEABLE WITH OPPOSITE SIDE

332252 B

MOTION DRIVE ASSEMBLY

| KEY# | PART# | DESCRIPTION | QTY |
|------|------------|----------------------------------|-----|
| 1 | A | TRANSAXLE 940-007 2WS LF SF | 1 |
| 2 | 303109 | PULLEY, 6.8 OD VAL T/A | 1 |
| 3 | 60795 | KEY, HI-PRO 606 .780DIA X 1.87WD | 1 |
| 4 | 22053 | RING, RETEX .58X.035THUS100-62 | 1 |
| 5 | 64769 | BELT, V 4L 82.00 SF DRIVE | 1 |
| 6 | 63788-859 | BRACKET, TRANSAXLE | 1 |
| 7 | 180077 | SCREW, 5/16-18X .75 HHC | 2 |
| 8 | 1498 | NUT, 5/16-18 REGHEXCTRLK | 6 |
| 9 | 180091 | SCREW, 5/16-18X2.50 HHC | 6 |
| 10 | 120369 | WASHER, FLAT .344X .88X.065 | 4 |
| 11 | 1498 | NUT, 5/16-18 REGHEXCTRLK | 4 |
| 12 | 323213 | LF BRKT, T/A TORQ. BLK | 4 |
| 13 | 180097 | SCREW, 5/16-18X2.00 HHC | 1 |
| 14 | 1498 | NUT, 5/16-18 REGHEXCTRLK | 1 |
| 15 | 180079 | SCREW, 5/16-18X1.00 HHC | 1 |
| 16 | 139485 | WASHER, EXLK .920X.61X.03 | 1 |
| 17 | 1498 | NUT, 5/16-18 REGHEXCTRLK | 1 |
| 18 | 321849 | LEVER, SHIFT LOW SF FMSFT 915 | 1 |
| 19 | 902760 | CLAMP .825DIA | 1 |
| 20 | 180077 | SCREW, 5/16-18X .75 HHC | 2 |
| 21 | 1498 | NUT, 5/16-18 REGHEXCTRLK | 4 |
| 22 | 310356 | LF BRKT, PIVOT SH LEV | 1 |
| 23 | 180020 | SCREW, 1/4-20X .75 HHC | 4 |
| 24 | 1502 | NUT, 1/4-20 REGHEXCTRLK | 2 |
| 25 | 309636 | LEVER, SHIFT UPPER SOF 1/2-13 | 2 |
| 26 | 310285 | SPRING, TORQ. .58X.96X.085 | 1 |
| 27 | 137185 | PIN, COTTER .125 DIA X 1.00LG | 1 |
| 28 | 331310 | NUT, 1/2-13 HEXJAM | 1 |
| 29 | 53514 | KNOB, ROUND 1.50DIA OR GRIP SF | 1 |
| 30 | 311209 | COVER PLASTIC LF P930/F4360-6 | 1 |
| 31 | 311257-853 | BRACKET COVER F-5 FNDR SHIFT | 1 |
| 32 | 1341 | LF CLAMP, SPRG 1.17-ID | 2 |
| 33 | 311391 | SCREW, 1/4-15X.44/.59 HILOHWA | 2 |
| 34 | 321844 | ROD, CONNECTING, SHIFT ZINC | 4 |
| 35 | 137185 | PIN, COTTER .125 DIA X 1.00LG | 1 |
| 36 | 57155 | BALL JOINT 3/8 THD SHORT STUD | 1 |
| 37 | 124925 | NUT, 3/8-24 REGHEXJAM | 1 |
| 38 | 120382 | WASHER, REGSPTLK .393X.68X.10 | 1 |
| 39 | 120369 | NUT, 3/8-24 REGHEX | 1 |
| 40 | 323212 | LF BRKT, SHIFT SF BLK | 1 |
| 41 | 57157 | WASHER, .750X.290 SF-TRANSAXLE | 1 |
| 42 | 56255 | SCREW, 1/4-28X .75 NYLHHC | 1 |

* CONTACT YOUR NEAREST TRANSAXLE DEALER FOR PARTS AND SERVICE



REPAIR PARTS

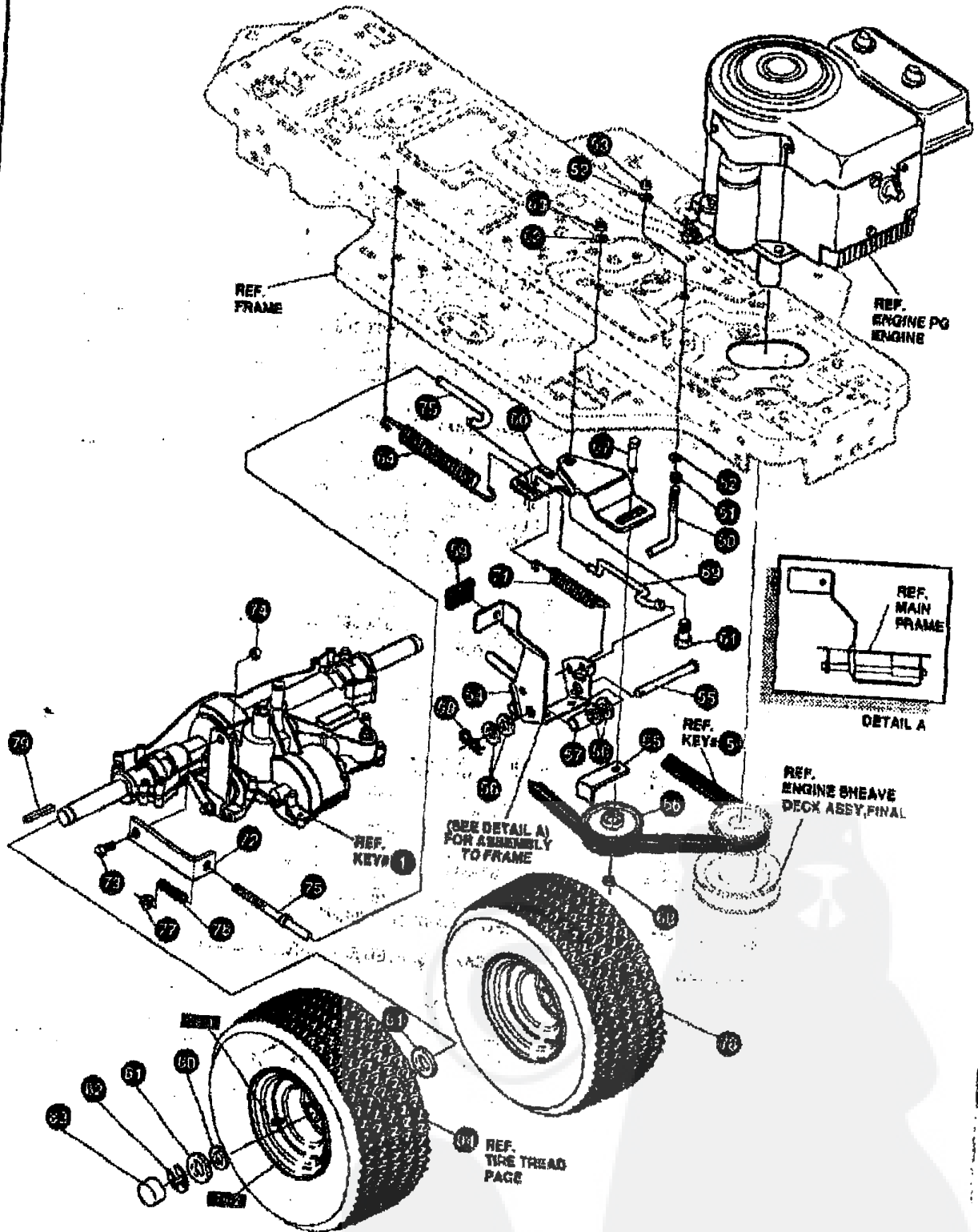

NOTE: ALWAYS USE ORIGINAL EQUIPMENT PARTS. Use of service/replacement parts other than original equipment parts may void your warranty.

ALL UNNUMBERED ITEMS ARE INTERCHANGEABLE WITH OPPOSITE SIDE

332252 B

MOTION DRIVE ASSEMBLY

| KEY# | PART# | DESCRIPTION | QTY |
|------|--------|-----------------------------------|-----|
| 50 | 48886 | BELT GUIDE | 1 |
| 51 | 271184 | NUT, 5/16-18 HEXKERS | 1 |
| 52 | 120393 | WASHER, FLAT .344X.89X.066 | 2 |
| 53 | 1498 | NUT, 5/16-18 REGHEXCTRLK | 1 |
| 54 | 331838 | ASSY, PEDAL, BRAKE, CLUTCH SF | 1 |
| 55 | 318876 | PIN, CLEVIS .800DX4.87LG | 1 |
| 56 | 2868 | WASHER, FLAT .504X.75X.058 | 4 |
| 57 | 391972 | SPACER, SLEV .59 X .62X1.240 | 1 |
| 58 | 56180 | PIN, HAIR .091 DIA X 1.62LG | 1 |
| 59 | 48761 | PAD, CLUTCH/BRAKE PEDAL | 1 |
| 60 | 321969 | IDLER ARM BRKT TRACTION SF | 1 |
| 61 | 329989 | BOLT, .625X .135 HHSH 5/16-18 | 1 |
| 62 | 45602 | WASHER, FLAT .333X .87X.119 | 1 |
| 63 | 1498 | NUT, 5/16-18 REGHEXCTRLK | 1 |
| 64 | 327867 | SPRING, 3/4 CDX7.75X.091 TENSION | 1 |
| 65 | 38859 | RETAINER, BELT | 1 |
| 66 | 36374 | PULLEY, IDLER V4L 9.08X .82 | 1 |
| 67 | 45892 | BOLT, 3/8-16X1.50 CARRSN | 1 |
| 68 | 1498 | NUT, 3/8-16 REGHEXCTRLK | 1 |
| 69 | 333175 | CLUTCH ROD ASSY, .288 DIA 3.92 | 1 |
| 71 | 326780 | SPRING, 3/8 CDX2.18 X.056 TENSION | 1 |
| 72 | 323210 | LF BRKT, TRCTN S/F BLK | 1 |
| 73 | 48824 | BOLT, .600X.188 HHSH 5/16-18 | 1 |
| 74 | 1498 | NUT, 5/16-18 REGHEXCTRLK | 1 |
| 75 | 323211 | LF ROD, BRAKE 915 BLK | 1 |
| 76 | 313881 | CLUTCH SPRING | 1 |
| 77 | 50352 | NUT, 1/4-20 WDFLLK TOPLOCK | 1 |
| 78 | 42090 | TIRE & RIM, PU 18X6.50TURFWHI | 2 |
| 78-1 | 24187 | VALVE STEM | 1 |
| 78-2 | 36182 | RIM, WHEEL | 2 |
| 79 | 52928 | KEY, SQUARE .1875X2.25LG | 2 |
| 80 | 642 | WASHER, FLAT .765X1.81X.075 | 4 |
| 81 | 42515 | WASHER, FLAT .765X1.59X.07 | 2 |
| 82 | 36625 | RING, RETEX .87X.05TRUS193-75 | 2 |
| 83 | 40394 | HUB CAP, 1.500ID X 7/8LG | 2 |
| 84 | | REFER TO TIRE TREAD PAGE | |



ALL INFORMATION CONTAINED HEREIN IS UNCLASSIFIED EXCEPT WHERE SHOWN OTHERWISE

FOR YOUR PROTECTION, ALWAYS USE ORIGINAL EQUIPMENT PARTS AND MATERIALS

REPAIR PARTS

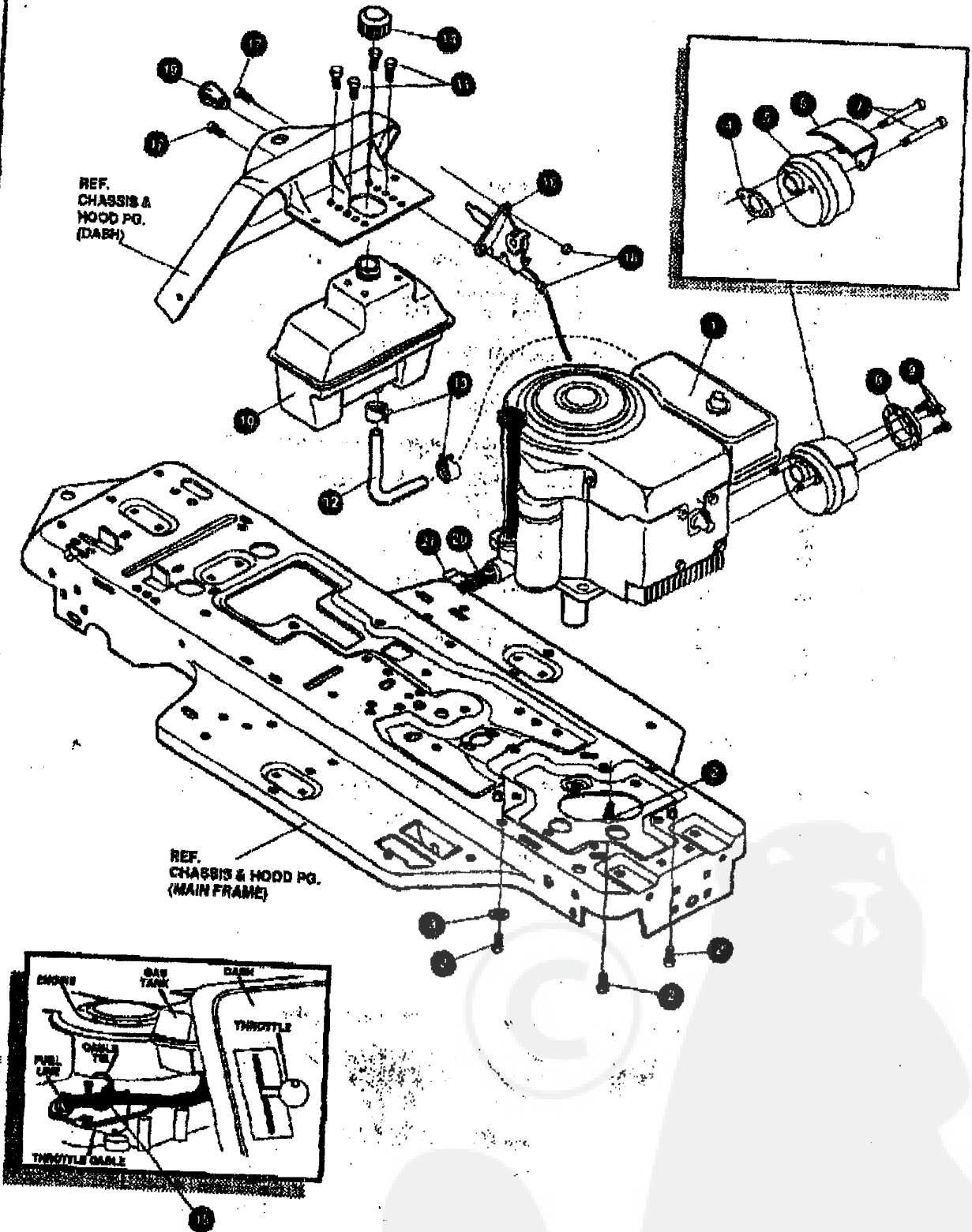

NOTE: ALWAYS USE ORIGINAL EQUIPMENT PARTS. Use of service/replacement parts other than original equipment parts may void your warranty.

ALL UNNUMBERED ITEMS ARE INTERCHANGEABLE WITH OPPOSITE SIDE

332431 A

ENGINE & CONTROL ASSEMBLY

| KEY# | PART# | DESCRIPTION | QTY |
|------|--------|-----------------------------------|------|
| 1 | ENGINE | 10-12HP B&S 3A(SEE ENGINE MANUAL) | 1 |
| 2 | 50947 | SCREW, 3/8-16X1.25 WAHHTAPBLKP | 4 |
| 3 | 138499 | WASHER, EXLK 3/8X.89X.04 | 1 |
| 4 | 48708 | GASKET, MUFFLER | 1 |
| 5 | 57909 | MUFFLER-DOME/EXP ROUND | 1 |
| 6 | 54787 | SHIELD, HEAT FOR ROUND MUFFLER | 1 |
| 7 | 54990 | SCREW, 5/16-10X3.80 HMC | 2 |
| 8 | 323423 | DEFLECTOR, MUFFLER PARTIAL | 1 |
| 9 | 35287 | SCREW, #8-32X .38 HHWATAP | 3 |
| 10 | 314999 | TANK, FUEL 1 GAL CLEAR | 1 |
| 11 | 900309 | SCREW, .25X.75X.51HHWAPLASTITE | 4 |
| 12 | 42258 | TUBING, .25X.50X BULK GAS LINE | 12.0 |
| 13 | 47345 | CLAMP, HOSE SCREW TYPE | 2 |
| 14 | 48704 | CAP, GAS 1-1/2-7 THD BLK | 1 |
| 15 | 57444 | TIE, CABLE BLACK NYLON 5.62L | 1 |
| 16 | 320091 | THROTTLE CONTROL | 1 |
| 17 | 274707 | SCREW, 10-24X .50 WAHHTMA | 2 |
| 18 | 308459 | NUT, #10-24 HXHDNYLK | 2 |
| 19 | 50607 | KNOB, ROUND THROTTLE BLACK | 1 |
| 20 | 325547 | OIL DRAIN VALVE ASSEMBLY | 1 |
| 21 | 327422 | CAP, OIL DRAIN VALVE ASM, YELLOW | 1 |



PRE-PAINTED DECK ASSEMBLY

| KEY# | PART# | DESCRIPTION | QTY |
|------|--------|---------------------------------|-----|
| 1 | 321992 | DECK, MOWER 30" S.F./RER | 1 |
| 2 | 57318 | GUIDE, BELT 5/16-18 THD | 1 |
| 3 | 1498 | NUT, 5/16-18 REGHEXCTRLK | 1 |
| 4 | 317017 | BRACKET CHUTE MOUNT BLACK | 1 |
| 5 | 314702 | SPACER, SLEV .344X1.00X .500PM | 1 |
| 6 | 120230 | BOLT, 5/16-18X1.25 CARRLN | 1 |
| 7 | 1498 | NUT, 5/16-18 REGHEXCTRLK | 1 |
| 8 | 45602 | WASHER, FLAT .333X .67X.119 | 1 |
| 9 | 128218 | BOLT, 5/16-18X .75 CARRLN | 1 |
| 10 | 1498 | NUT, 5/16-18 REGHEXCTRLK | 1 |
| 11 | 311237 | BRACKET, MOUNTING, FRONT | 1 |
| 12 | 57072 | BOLT, 5/16-18X .63 CARRLN | 1 |
| 13 | 120393 | WASHER, FLAT .344X .69X.085 | 3 |
| 14 | 1498 | NUT, 5/16-18 REGHEXCTRLK | 3 |
| 15 | 311238 | BRACKET, BAR, TOW, FRONT | 1 |
| 16 | 180079 | SCREW, 5/16-18X1.00 HHC | 2 |
| 17 | 58247 | NUT, ADJUST | 2 |
| 18 | 1498 | NUT, 5/16-18 REGHEXCTRLK | 2 |
| 19 | 313372 | ASSY. TUBE, PIVOT | 2 |
| 20 | 310672 | SUPPORT PIVOT TUBE BLK | 1 |
| 21 | 180077 | SCREW, 5/16-18X .75 HHC | 2 |
| 22 | 1498 | NUT, 5/16-18 REGHEXCTRLK | 2 |
| 23 | 314119 | ASSY LIFT BRKT. | 1 |
| 24 | 180077 | SCREW, 5/16-18X .75 HHC | 2 |
| 25 | 120393 | WASHER, FLAT .344X .69X.085 | 2 |
| 26 | 1498 | NUT, 5/16-18 REGHEXCTRLK | 2 |
| 27 | 313588 | ASSEMBLY, QUILL | 1 |
| 27-1 | 314272 | QUILL, MACHINED CASTING | 1 |
| 27-2 | 314274 | TUBE, SPACER, STEEL | 1 |
| 27-3 | 313576 | BRNG. BALL 8204-2AA-CS | 2 |
| 29 | 138485 | WASHER, EXLK .320X.61X.03 | 5 |
| 30 | 321146 | SPACER, SLEV .790X1.250X .500 | 1 |
| 31 | 314273 | PULLEY ASSEMBLY | 1 |
| 32 | 22265 | WASHER, FLAT .515X1.38X.119 | 1 |
| 33 | 1500 | NUT, 1/2-13 REGHCTRLK | 1 |
| 34 | 321144 | SHAFT, QUILL 30" MOWER - S.F. | 1 |
| 35 | 313577 | SHIELD, DUST BEARING | 1 |
| 36 | 313584 | HUB, BLADE ADAPTOR | 1 |
| 37 | 329988 | BLADE, 30" TD MOWER 0.7 WING | 1 |
| 38 | 22265 | WASHER, FLAT .515X1.38X.119 | 1 |
| 39 | 1500 | NUT, 1/2-13 REGHCTRLK | 1 |
| 40 | 12229 | BRACKET, IDLER ASSEMBLY | 1 |
| 40-1 | 313510 | BRACKET, ARM, IDLER | 1 |
| 40-2 | 308873 | BRAKE PAD - HARD - 238AF | 1 |
| 40-3 | 41601 | RIVET, OVSET .187DIA X .30LG ST | 2 |
| 41 | 180113 | SCREW, 5/16-18X3.00 HHC | 1 |
| 42 | 45602 | WASHER, FLAT .333X .67X.119 | 1 |
| 43 | 321146 | SPACER, SLEV .322X .53X2.310 | 1 |
| 44 | 44108 | NUT, 5/16-18 HWDFLCTRLK | 1 |
| 45 | 180081 | SCREW, 5/16-18X1.25 HHC | 1 |
| 46 | 44108 | NUT, 5/16-18 HWDFLCTRLK | 1 |
| 47 | 35410 | SPRING .071 X .62 X 4.97 | 1 |
| 48 | 302357 | LINK | 1 |
| 49 | 1498 | NUT, 5/16-18 REGHEXCTRLK | 1 |
| 50 | 50520 | SPACER | 1 |
| 51 | 128218 | BOLT, 5/16-18X .75 CARRLN | 1 |
| 52 | 1498 | NUT, 5/16-18 REGHEXCTRLK | 1 |
| 53 | 314099 | BRACKET, BAR, REAR STABIL | 1 |
| 54 | 180079 | SCREW, 5/16-18X1.00 HHC | 2 |
| 55 | 58247 | NUT, ADJUST | 4 |
| 56 | 1498 | NUT, 5/16-18 REGHEXCTRLK | 2 |
| 57 | 51940 | BOLT, .500X .437 HSSH 3/8-16 | 4 |
| 58 | 1498 | NUT, 3/8-16 REGHXCTRLK | 2 |
| 59 | 320605 | BRACKET, LIFT BAR 30" SF | 2 |
| 60 | 1498 | NUT, 5/16-18 REGHEXCTRLK | 1 |
| 61 | 180077 | SCREW, 5/16-18X .75 HHC | 2 |

REPAIR PARTS

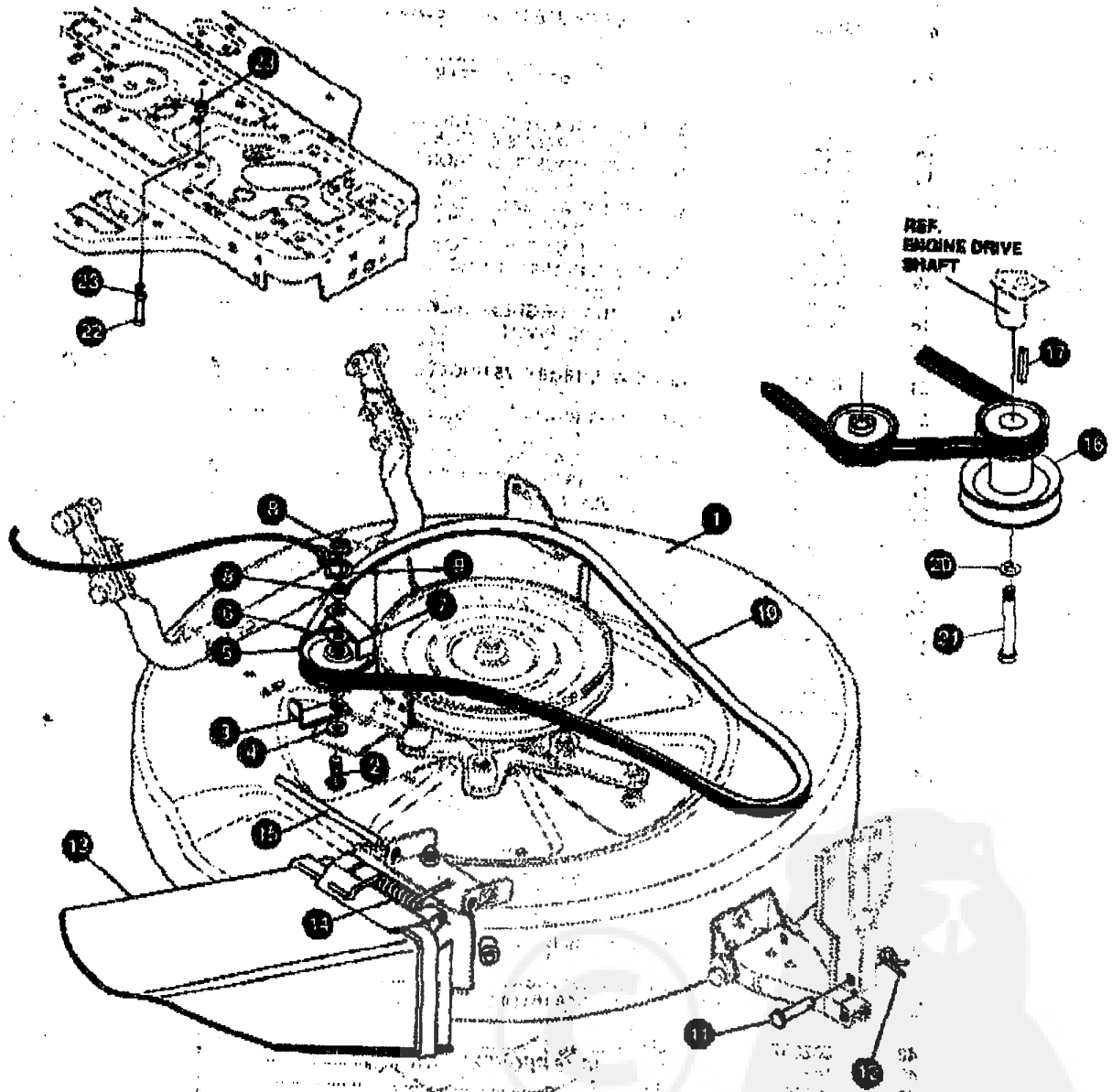

REF. ENGINE DRIVE SHAFT

NOTE: ALWAYS USE ORIGINAL EQUIPMENT PARTS. Use of service/replacement parts other than original equipment parts may void your warranty.

ALL UNNUMBERED ITEMS ARE INTERCHANGEABLE WITH OPPOSITE SIDE

325643 C

DECAL ASSEMBLY

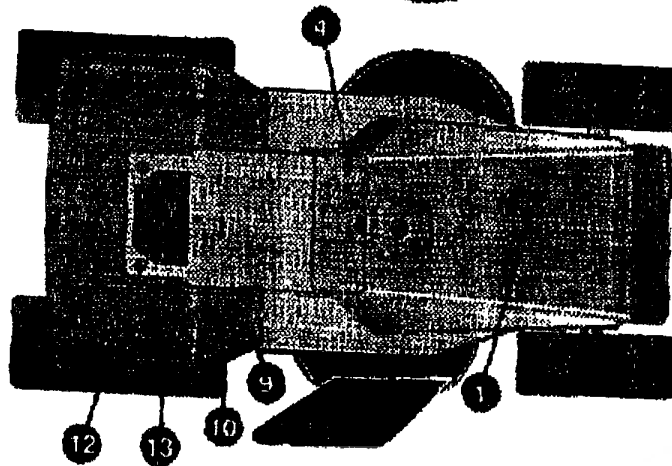
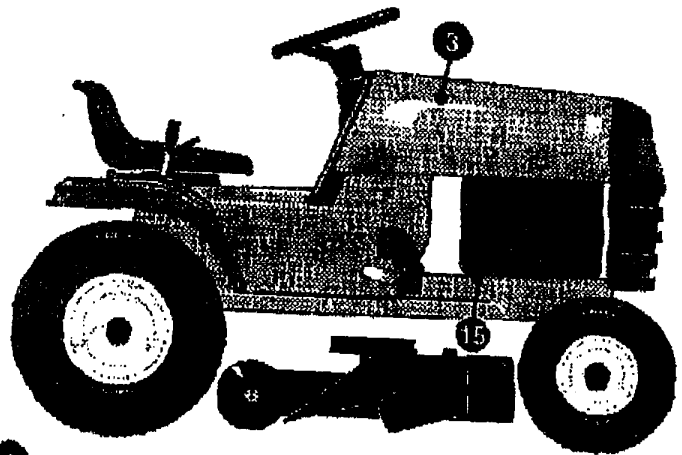
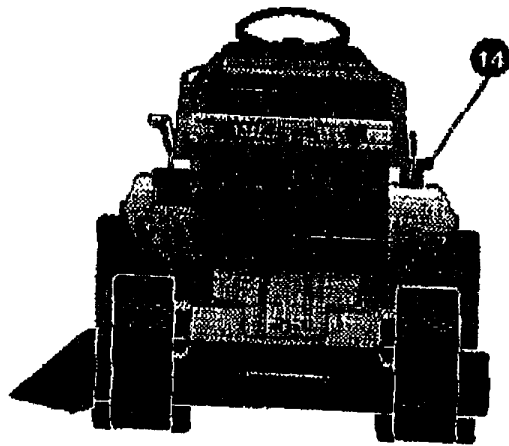

CONSOLE DETAIL

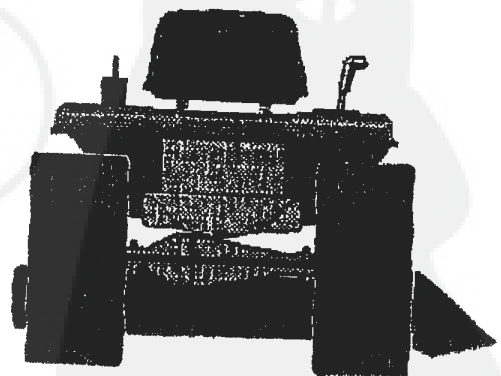
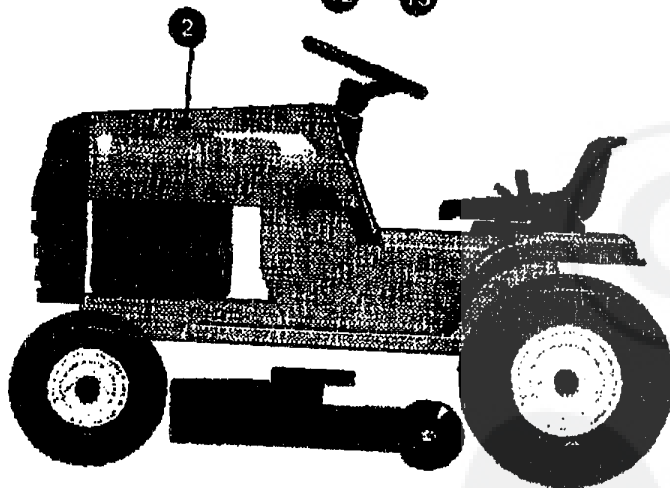
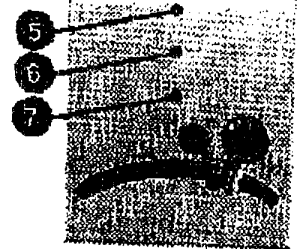

DECAL ASSEMBLY

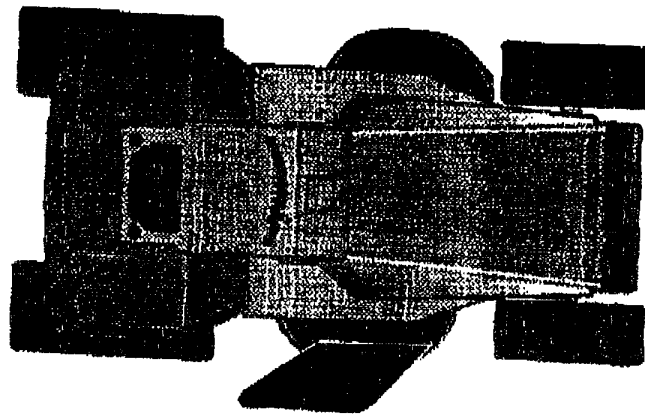
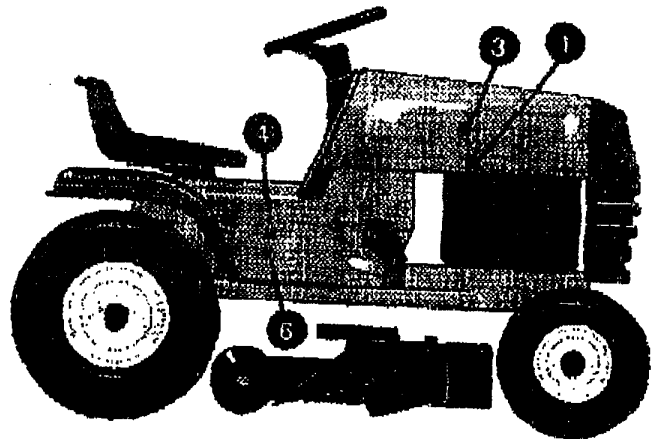
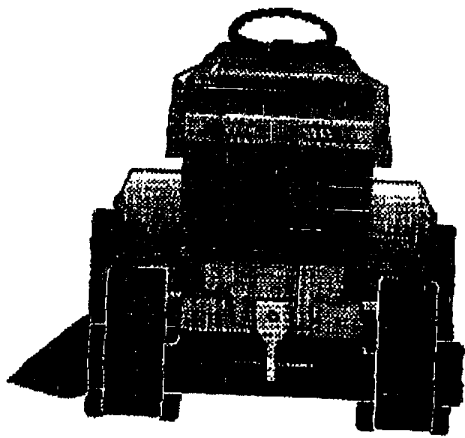

CONSOLE DETAIL

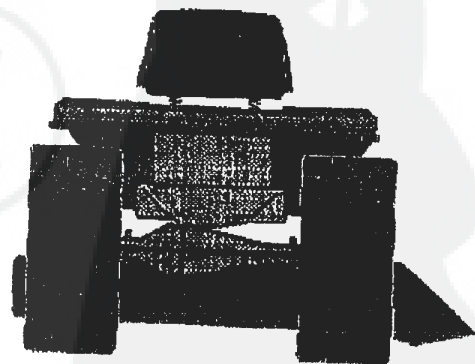
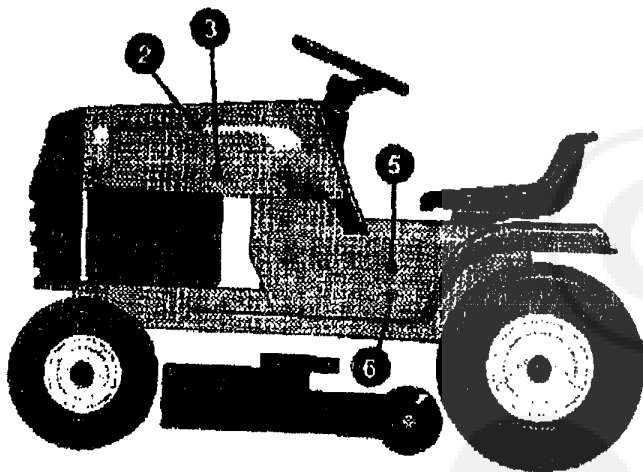
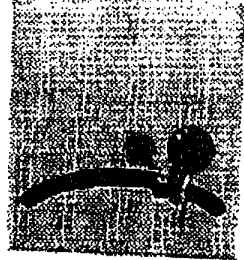

DECAL ASSEMBL

| KEY# | PART# | DESCRIPTION | QTY |
|------|--------|-------------------------------------|-----|
| 1 | 320714 | DECAL, HOODSIDE RH H-21 | 1 |
| 2 | 320713 | DECAL, HOODSIDE LH H-21 | 1 |
| 3 | 402142 | NAMEPLATE, TURFMASTER WHT/BLK..... | 2 |
| 4 | 320872 | DECAL, PRO CONSOLE(LONGER) RH | 1 |
| 5 | 320873 | DECAL PRO CONSOLE(LONGER) LH | 1 |
| 6 | 320799 | NAME PLATE, 10.5/30 OHR/BLK..... | 2 |

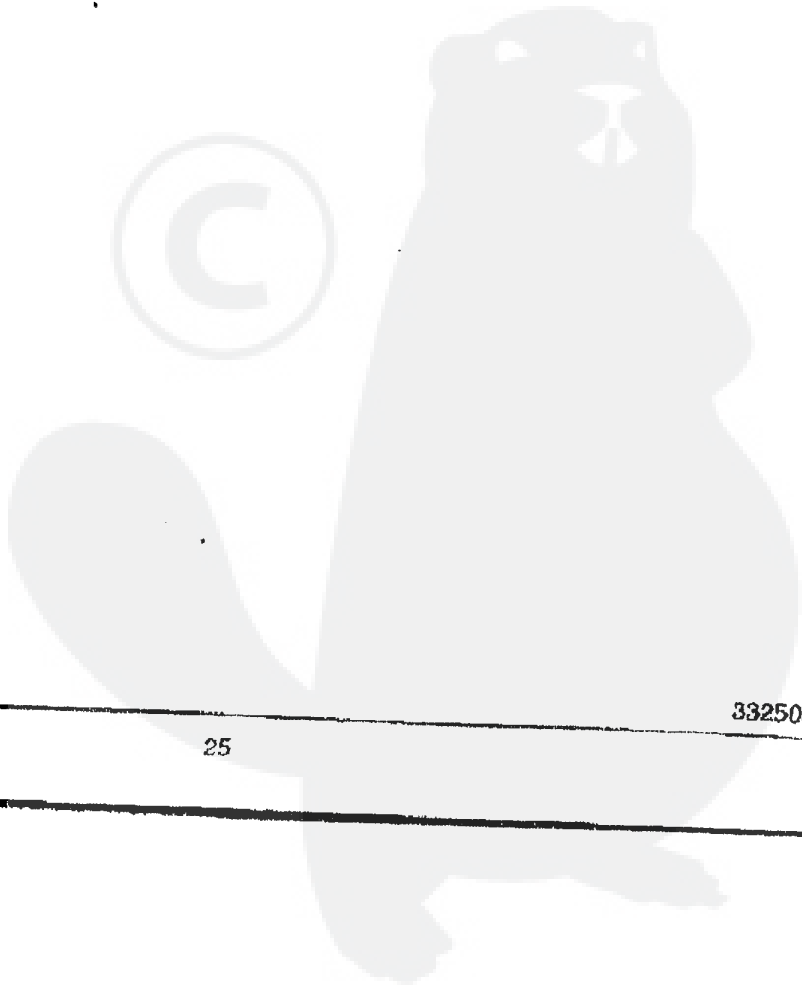
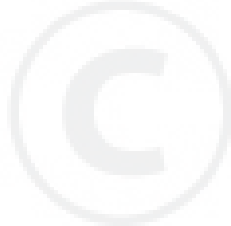

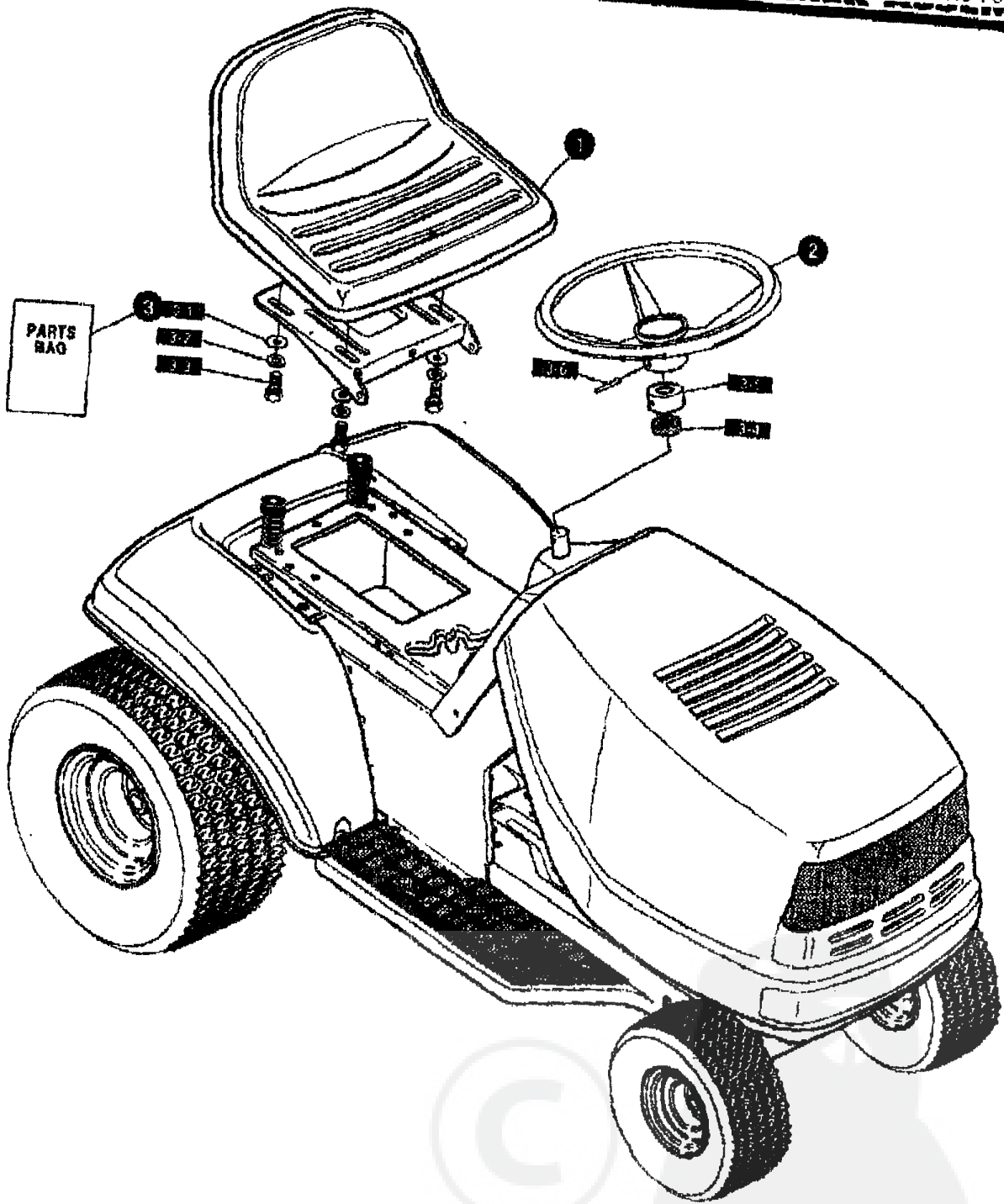

| KEY# | PART# | DESCRIPTION | QTY |
|------|--------|-----------------------------------|-----|
| 1 | 304914 | SEAT, MICHIGAN GEN. W/SW HOLE | 1 |
| 2 | 830510 | STEERING WHEEL | 1 |
| 3 | 331424 | SF PARTS BAG, ASSY SEAT/STEER | 1 |
| 1 | 120383 | WASHER, FLAT 3/4X .89X.065 | 1 |
| 2 | 120638 | WASHER, HVSP TLK 3/28X.60X.09 | 4 |
| 3 | 123007 | SCREW, 5/16-18X 75 HHC | 4 |
| 4 | 331322 | COVER, STEERING SHAFT | 1 |
| 5 | 301413 | SPACER, STEERING SHAFT | 1 |
| 6 | 455378 | PIN, SPRING, 250DIA X 2.00LG HVPL | 1 |

TREAD PATTERNS

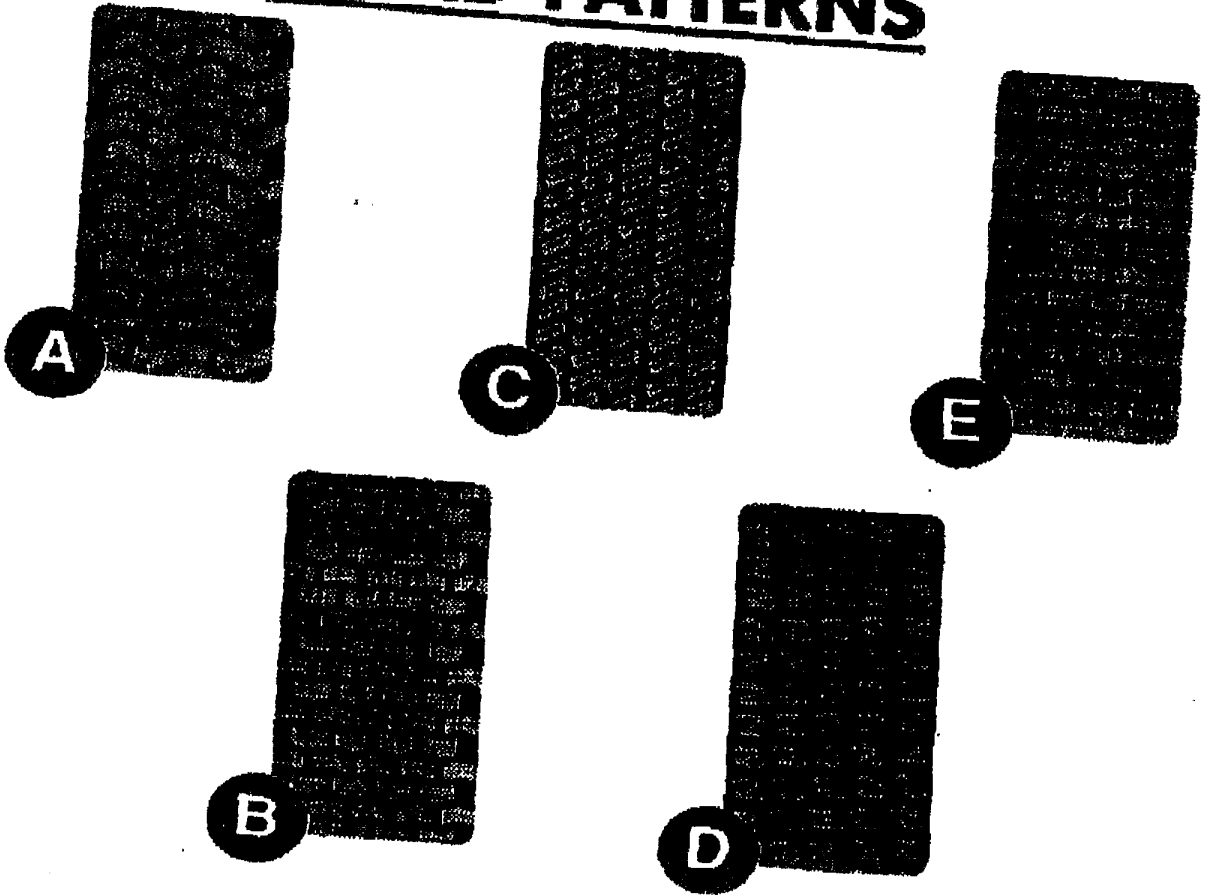

| TIRE SIZE | "A" | "B" | "C" | "D" | "E" |
|-----------------|--------|--------|--------|--------|--------|
| 11 X 4.00 - 5 | 42295 | 319679 | | | |
| 13 X 5.00 - 6 | 41060 | 319680 | | | |
| 15 X 6.00 - 6 | 39830 | 316702 | 301140 | 313952 | |
| 16 X 4.80 - 8 | | 305035 | | | |
| 16 X 6.50 - 8 | 41081 | 319682 | | 314539 | |
| 18 X 6.50 - 8 | | 42091 | | | |
| 18 X 8.50 - 8 | 319683 | 317400 | | | |
| 18 X 9.50 - 8 | 41106 | 316701 | | 313950 | |
| 20 X 8.00 - 8 | 319685 | 319684 | 57164 | 314584 | 331606 |
| 20 X 10.00 - 8 | 58276 | 319686 | | 313654 | |
| 20 X 10.00 - 10 | 55893 | 319687 | | | |
| 23 X 9.50 - 12 | 53655 | 319690 | 319689 | 314370 | |

Contact the dealer where your tractor was purchased for the available accessories.
are unable to contact the dealer, write to the address on the front cover of this man

30" Standard Lawn Rider

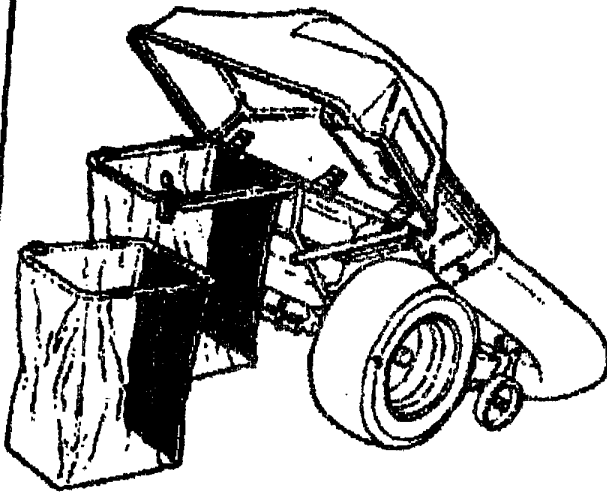

Model #5708-17
Grass Collector (30" decks)

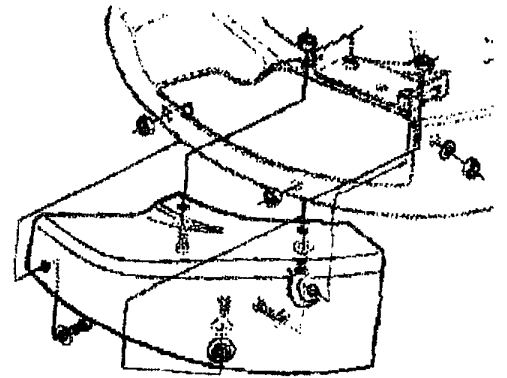

5714-00 Mulching Kit (30" Deck)

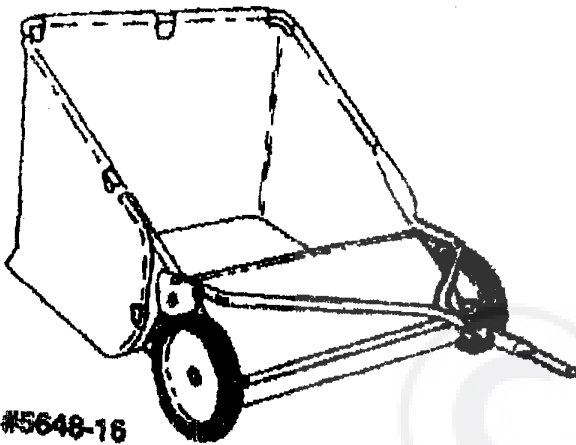

Model #5648-16
Tow Behind Lawn Sweeper for Grass and Leaves

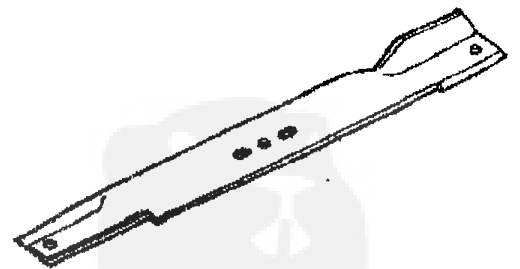

314275 -30" Standard LIR Blade

OTHER ACCESSORIES

| Model | Description |
|---------|----------------------------------|
| 5708-02 | Front Weight Box - holds 35 lbs. |
| 322397 | 30" Mulching blade |