

PARTS MANUAL

Lawn Tractors



Model E3554-190



SAFETY RULES

THESE INSTRUCTIONS ARE FOR YOUR PROTECTION. PLEASE READ THEM CAREFULLY.



IMPORTANT

THIS CUTTING MACHINE IS CAPABLE OF AMPUTATING HANDS AND FEET AND THROWING OBJECTS. FAILURE TO OBSERVE THE FOLLOWING SAFETY INSTRUCTIONS COULD RESULT IN SERIOUS INJURY OR DEATH.

I. GENERAL OPERATION:

- Know controls and how to stop quickly.
- Read, understand, and follow all instructions in the manual and on the machine before starting.
- Only allow responsible adults, who are familiar with instructions, to operate the machine.
- Wear safety glasses or eye shields when assembling or operating the machine.
- Do not operate machine when barefooted. Always wear substantial footwear, preferably steel-toed shoes.
- Do not wear loose fitting clothing that could get caught in moving parts.
- Clear the area of objects such as rocks, toys, wire, etc., which could be picked up and thrown by the blade(s).
- Be sure the area is clear of other people before mowing. Stop machine if anyone enters the area.
- Never carry passengers.
- Do not mow in reverse unless absolutely necessary. Always look down and behind before and while backing.
- Be aware of the mower discharge direction and do not point it at anyone. Do not operate the mower without either the entire grass catcher or the guard in place.
- Slow down before turning.
- Never leave a running machine unattended. Always turn off blades, set parking brake, stop engine, and remove keys before dismounting.
- Turn off blade(s) when not mowing.
- Stop engine before removing grass catcher or unclogging chute.
- Show only in daylight or good artificial light.
- Do not operate the machine while under the influence of alcohol or drugs.
- Watch for traffic when operating near or crossing roadways.
- Use care when mowing around a fixed object to prevent the blade(s) from striking it. Never deliberately run over any foreign object.
- Use extra care when loading or unloading the machine into a trailer or truck.
- Use care when pulling loads or using heavy equipment.
 - a. Use only approved drawbar hitch points.
 - b. Limit loads to those that you can safely control.
 - c. Do not turn sharply. Use care when backing.
 - d. Use counterweight(s), wheel weight or tire chains when supported in attachment's instructions.

II. SLOPE OPERATION:

Slopes are a major factor related to loss of control and tip-over accidents, which can result in severe injury or death. All slopes require extra caution. If you cannot back up the slope or if you feel uneasy on it, do not mow it.

DO

- Mow up and down slopes, not across.
- Remove obstacles such as rocks, tree limbs, etc.
- Watch for holes, ruts, or bumps. Uneven terrain could overturn the machine. Tall grass can hide obstacles.
- Use slow speed. Choose a low gear so that you will not have to stop or shift while on the slope.
- Follow the manufacturer's recommendations for wheel weights or counterweights to improve stability.
- Use extra care with grass catchers or other attachments. These can change the stability of the machine.
- Keep all movement on the slopes slow and gradual. Do not make sudden changes in speed or direction.
- Avoid starting or stopping on a slope. If tires lose traction, turn off the blade(s) and proceed slowly straight down the slope.

DO NOT

- Do not turn on slopes unless necessary, and then slowly and gradually downhill, if possible.
- Do not mow near drop-offs, ditches or embankments. The

mower could suddenly turn over if a wheel is over the edge of a cliff or ditch, or if an edge caves in.

- Do not mow on wet grass. Reduced traction could cause sliding.
- Do not try to stabilize the machine by putting your feet on the ground.
- Do not use grass catcher on steep slopes.

III. CHILDREN:

Tragic accidents can occur if the operator is not alert to the presence of children. Children are often attracted to the machine and the mowing activity. Never assume that children will remain where you last saw them.

- Keep children out of the mowing area and under the watchful care of another responsible adult.
- Be alert and turn machine off if children enter the area.
- Before and when backing, look behind and down for small children.
- Never carry children. They may fall off and be seriously injured or interfere with safe machine operation.
- Never allow children to operate the machine.
- Use extra care when approaching billboards, signs, trees, or other objects that may obscure vision.

IV. SERVICE:

- Use extra care in handling gasoline and other fuels. They are flammable and vapors are explosive.
 - a. Use only an approved container.
 - b. Never remove gas cap or add fuel with the engine running. Allow engine to cool before refueling. Do not smoke.
 - c. Never refuel the machine indoors.
 - d. Never store the machine or fuel container inside where there is an open flame, such as in a water heater.
- Check fuel supply before each use allowing space for expansion as the heat of the engine and/or sun can cause gasoline to expand and overflow the tank.
- Use extra care when handling battery acid. Acid contact with skin may cause severe burns. Eye contact may cause blindness.
- Use extra care when servicing the battery. Explosive gas is produced in the battery. Do not service the battery while smoking or near an open spark or flame. This may cause the battery to explode causing serious injury.
- Never run a machine inside a closed area. Exhaust fumes contain CARBON MONOXIDE, an odorless and DEADLY GAS.
- Keep nuts and bolts, especially blade attachment bolts, tight and keep equipment in good condition.
- Never tamper with safety devices. Check their operation regularly.
- Do not change the engine governor settings or overspeed engine.
- Reduce fire hazards. Keep machine free of grass, leaves, or other debris build-up. Clean up oil or fuel spillage. Allow machine to cool before storing.
- Stop and inspect the equipment if you strike an object. Repair, if necessary, before restarting.
- Never make adjustments or repairs with the engine running.
- Grass catcher components are subject to wear, damage, and deterioration, which could expose moving parts or allow objects to be thrown. Frequently check components and replace with manufacturer's recommended parts, when necessary.
- Mower blade(s) are sharp and can cut. Wrap the blade(s) or wear gloves, and use extra caution when servicing them.
- Check brake operation frequently. Adjust and service as required.



LOOK FOR THIS SYMBOL TO POINT OUT IMPORTANT SAFETY PRECAUTIONS. IT MEANS... ATTENTION!!! BECOME ALERT!!! YOUR SAFETY IS INVOLVED.

Record the following information about your unit so that you will be able to provide it in case of loss or theft.

MODEL NUMBER: - (Enter complete 8 digit number from model plate on unit)

PURCHASE DATE: ___ / ___ / ___ CODE NO.: _____ SERIAL NO.: _____

DEALER'S NAME AND ADDRESS: _____

CITY: _____ STATE: _____ TELEPHONE: _____

TOOLS REQUIRED FOR ASSEMBLY

- 2 - 7/16 inch Wrenches (or adjustable wrench)
- 1 - 1/2 inch Wrench (or adjustable wrench)
- 1 - Small Phillips Screwdriver with a 1/4 inch shank
- 1 - Hammer

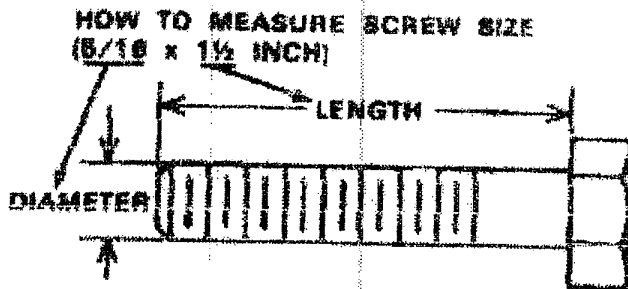

⚠ DANGER ⚠

This lawn tractor can be dangerous if carelessly used.

Read your Operator's Manual thoroughly before operating your lawn tractor.

Always wear safety glasses or eye shields while assembling or operating your lawn tractor.

DO NOT carry passengers at any time.

Keep your hands, feet, hair and loose clothing away from the discharge area, the underside of the mower deck or any moving parts while the engine is running.

DO NOT allow children or young teenagers to operate or be near your lawn tractor while it is operating.

ALWAYS GIVE THE FOLLOWING INFORMATION WHEN ORDERING REPAIR PARTS:
 1. The PART NUMBER; 2. The PART NAME; 3. QUANTITY DESIRED; 4. The MODEL NUMBER (As shown on Model Plate).
 SEND PART ORDERS AS PER INSTRUCTIONS ON THE FRONT PAGE.
DO NOT USE KEY NUMBERS WHEN ORDERING REPAIR PARTS. ALWAYS USE PART NUMBERS.
 All replacement parts will be supplied in current production colors or in a neutral color.
 A handling fee is applicable to small parts orders.
 YOUR UNIT IS RIGHT HAND (RH) OR LEFT HAND (LH) AS YOU STAND BEHIND IT.

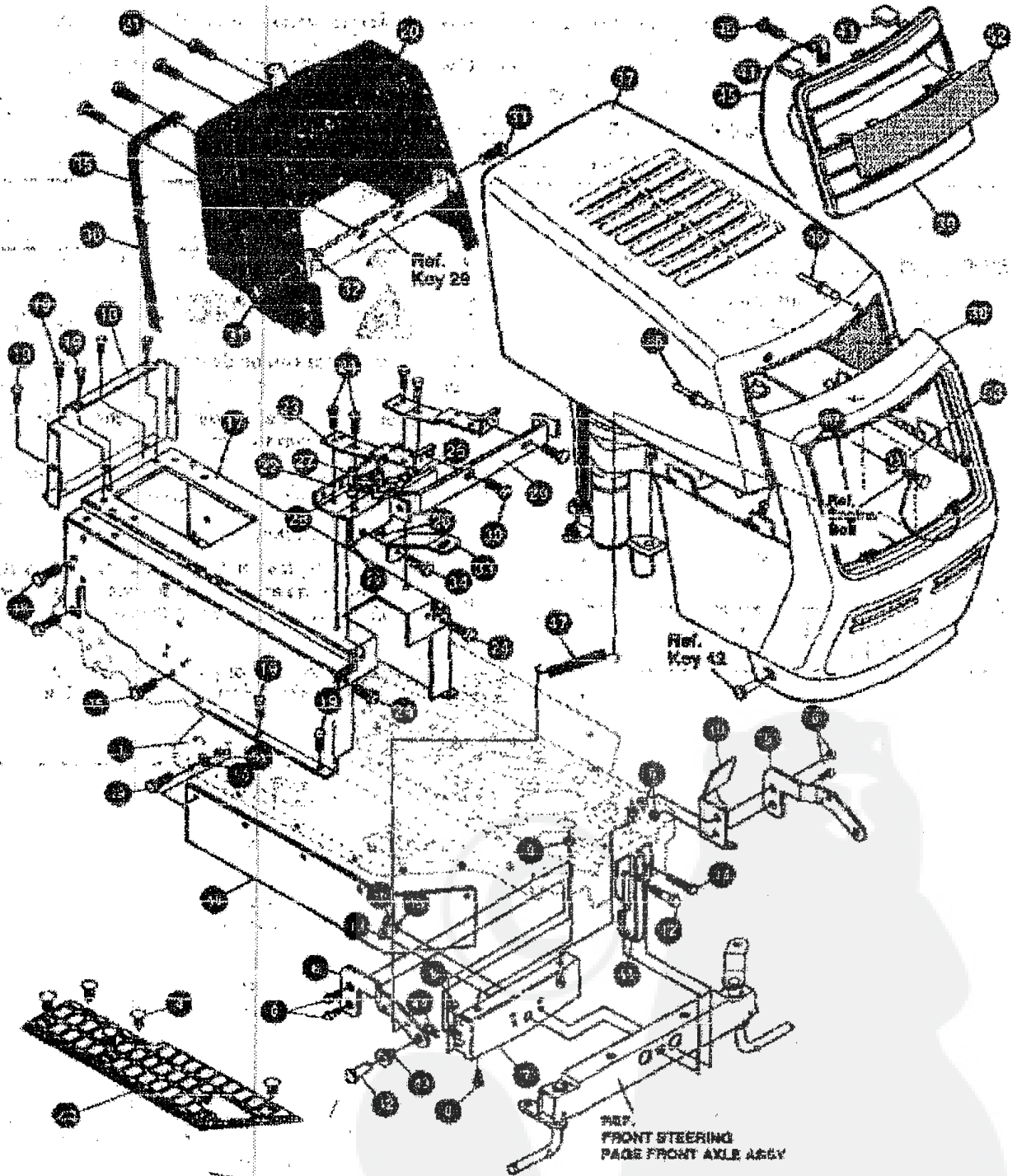

NOTE: ALWAYS USE ORIGINAL EQUIPMENT PARTS. Use of service/replacement parts other than original equipment parts may void your warranty.

ALL UNNUMBERED ITEMS ARE INTERCHANGEABLE WITH OPPOSITE SIDE

329120E

KEY #	PART #	DESCRIPTION	QTY.
1	332319-879	MAIN FRAME	1
2	310000	FOOT PAD, LH	1
3	310004	FOOT PAD, RH	1
4	300235	FASTENER, RATCHET	12
6	328473-853	BRACKET, GRILLE LH	1
6	328474-853	BRACKET, GRILLE RH	1
7	58362-853	BRKT. SUPPORT, FRONT AXLE	1
8	328164	SCREW, 5/16-18X1.0WDFLK	8
9	55273	NUT, 5/16-18 HXWDFLK	6
10	327687-853	SHIELD HEAT SF B&S	1
11	321138-873	BRACKET, HANGER 30"	1
12	68720	BOLT, 3/8X2.875 SPBH 1/2-20	1
13	274654	NUT, 1/2-20 REGHXCTRLK	1
14	180138	SCREW, 3/8-18X3.00 HHC	4
15	2485	WASHER, 3/8DX1.25DX.07 BELLVIL	4
16	1456	NUT, 3/8-18 REGHXCTRLK	4
17	324998-890	CONSOLE, MOLDED DASH	1
18	58235-830	CONSOLE, REAR COVER	1
19	683346	SCREW, 1/4-20X.50 WAHHTAP	16
20	325786	DASH	1
21	305850	SCREW, 1/4-20X.50PHPTAP	4
22	327583-853	SUPPORT, SF MLD DSH	2
23	327584-853	SUPPORT, SF MLD DSH GAS TANK	2
24	683346	SCREW, 1/4-20X.50 WAHHTAP	5
25	327444	BRNG FL. 75510, 226 MTNG HOLES	1
26	180020	SCREW, 1/4-20X.76 HHC	4
27	46931	NUT, 1/4-20 WDFL MAC LOCK	4
28	327390	BRNG FL. 5800, 226 MTG HOLES	1
29	327078-853	STRAP, DASH SUPPORT	1
30	683346	SCREW, 1/4-20X.50 WAHHTAP	2
31	165941	SCREW, 10-24X.63 PHFLTMA	2
32	308458	NUT, #10-24 HXHDNYLK	2
33	328824-853	CONSOLE SUPPORT BRKT	2
34	683346	SCREW, 1/4-20X.50 WAHHTAP	2
35	326141	BUMPER, HOOD/DASH TOP & CORNER	2
36	326142	BUMPER, HOOD/DASH SIDE STRIP	2
37	328145	HOOD	1
38	328178	GRILLE	1
39	328144	INSERT, GRILLE	1
40	328236	RIVET, POP 3/16DIA X .76 LG FLG	2
41	306857	CLIP, TINNEMAN VER II HOOD	7
42	323044	PIN, CLEVIS 500 R .48X.61LGTH	2
43	326522	BRNG HOOD .6051DX.6250DX1.12FL	2
44	3260	PIN, HAIR .091 DIA X1.86LG	2
46	315899	LANYARD, HOOD 15.00 LG	1
45	49050	SCREW, 1/4-18X.75PHPTAP	1
47	304784	SPRING, HOOD LATCH	1
48	305385	BELT GUARD SF RUBBER 7 X 25.46	2
49	57034	SCREW, 10-24X.63 TRHMM	12
50	1501	WASHER, FLAT .203X.56X.045	12
51	308459	NUT, #10-24 HXHDNYLK	12
52	325194	LENS	1
53	301452	FOIL, HEAT REFLECTOR	1
56	333223	RIVET, POP 3/16DIA X1.0LS FLG	2
57	1501	FLATWASHER .203X.56X.040	2
	333383	ENGLISH OPERATOR MANUAL	1
	333384	FRENCH OPERATOR MANUAL	1
	333385	GERMAN OPERATOR MANUAL	1
	333388	ENGLISH PARTS MANUAL	1
	323000	ENGLISH GRASS CATCHER MANUAL	1
	323207	FRENCH GRASS CATCHER MANUAL	1
	323208	GERMAN GRASS CATCHER MANUAL	1

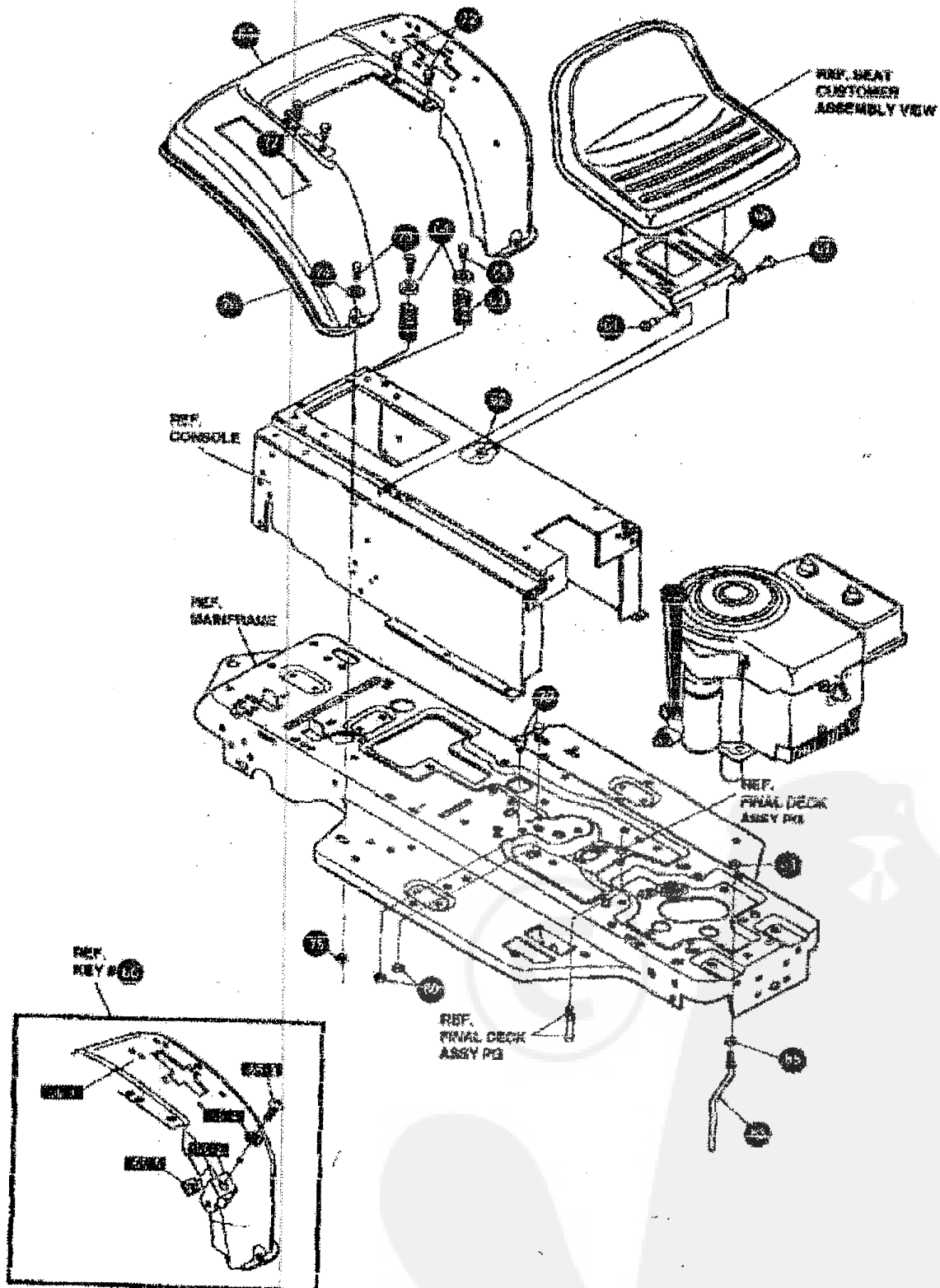

NOTE: ALWAYS USE ORIGINAL EQUIPMENT PARTS. Use of service/replacement parts other than original equipment parts may void your warranty.

ALL UNNUMBERED ITEMS ARE INTERCHANGEABLE WITH OPPOSITE SIDE

329120E

KEY #	PART #	DESCRIPTION	QTY.
60	58367-87D	SEAT PLATE	1
61	20507	BOLT, .437X.188 HMSH 5/16-18	2
62	1488	NUT, 5/16-18 REGHEXCTRLK	2
63	330463	SPRING, SEAT 1.5000X2 25LG	2
64	120372	FLATWASHER, .251X.23X.085	2
65	988345	SCREW 1/4-20X.50 WASH/TAP	2
66		ASSEMBLY, FENDER	1
66-1	332423-87D	FENDER	1
66-2	9289	CLEVIS	1
66-3	439455	SCREW, 5/16-18X.56PHNMA BKPH	1
66-4	201551	WASHER, .344IDX1.60DX.09 CU ZN	1
66-5	120373	NUT, 5/16-18 SQ	1
72	988345	SCREW, 1/4-20X.50 WASH/TAP	4
73	180081	SCREW, 5/16-18X1.25 HHO	2
74	446383	WASHER, FLAT .375X .89X.085	2
75	55273	NUT, 5/16-18 HXWDFLK	2
76	55023	TRIM STRIP, BLACK—SMALL, W ADH	75IN.
79	53445	FIN, 5/16-18 HOOD LATCH	2
80	271184	NUT, 5/16-18 HEXKEPS	2
83	60853	GUIDE, BELT	1
84	41526	NUT, 3/8-16 HXCTRLKJAM	1
86	271190	NUT, 3/8-16 HEXKEPS	1

* ORDER INDIVIDUAL PARTS.



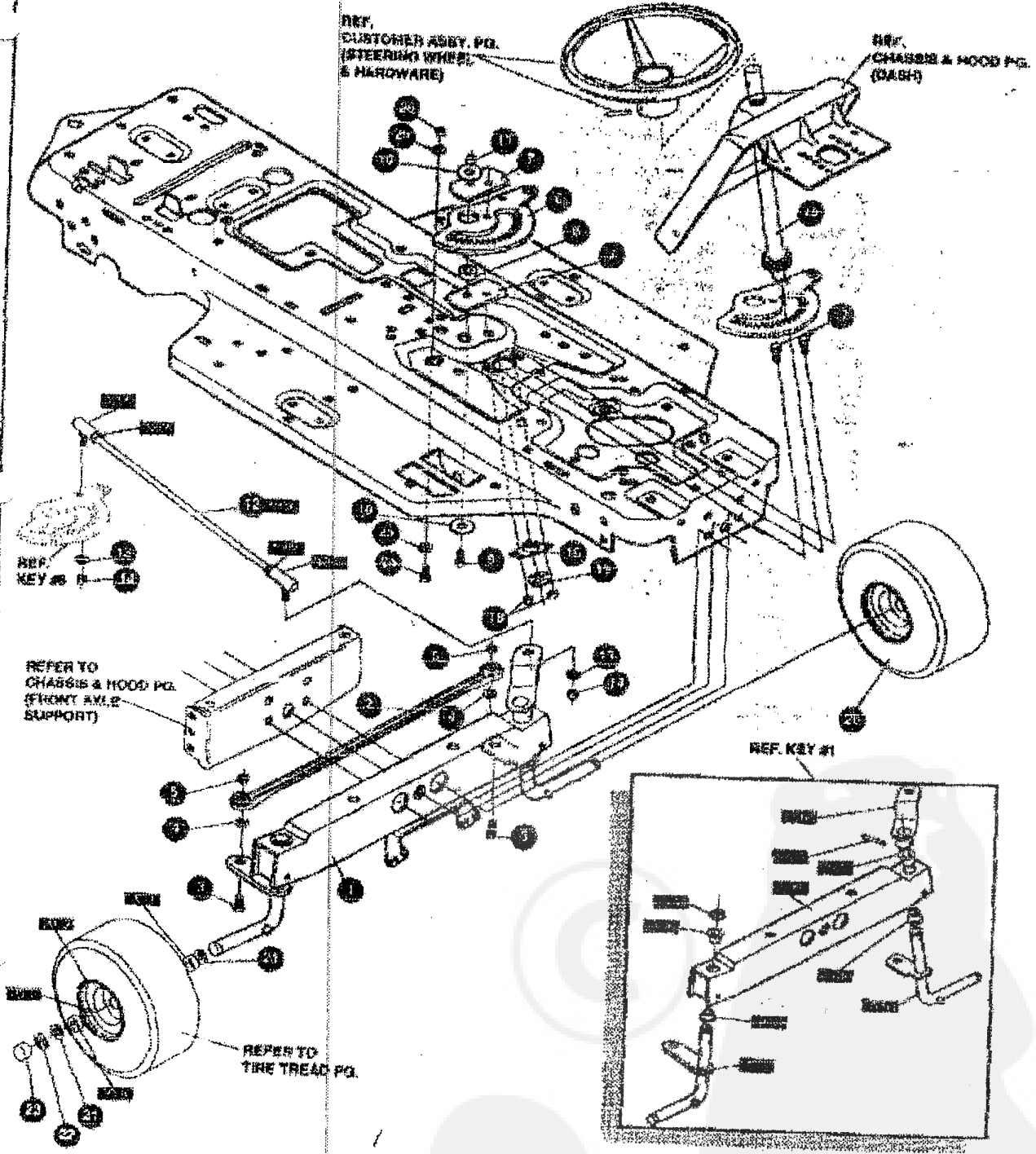

NOTE: ALWAYS USE ORIGINAL EQUIPMENT PARTS. Use of service/replacement parts other than original equipment parts may void your warranty.

ALL UNNUMBERED ITEMS ARE INTERCHANGEABLE WITH OPPOSITE SIDE

329283D

KEY #	PART #	DESCRIPTION	QTY.
1		AXLE FRONT ASSY, SF LONG	1
1-1	312280-879	FRONT AXLE	1
1-2	50546	BEARING, FL .759IDX1.002ODX .75	4
1-4	36626	RING, RETEX .37X.05TRUS133-75	1
1-5	310267	SPINDLE ASSY, LM LONG	1
1-6	327619	ARM ASSY, FRONT STEERING	1
1-7	454565	PN. SPRING, 2500DIA X 1.25LG HVPL	1
2	302688	TIE ROD, STAMPED 19.31LG W-SEC	1
3	100124	SCREW, 3/8-16X1.25 HHC	2
4	120382	WASHER, REGSPTLK.38X.65X.10	2
5	1459	NUT, 3/8-16 REGHXCTRLK	2
6	324762	GEAR, SECTOR SF4WS HT	1
7	333280	PLATE SECTOR	2
8	335021	BUSHING, SECTOR GEAR	1
9	181643	SCREW, 3/8-24X1.50 HHC	1
10	845	WASHER, FLAT .360X1.25X.119	2
11	412349	NUT, 3/8-24 HXCOTLK	1
12	326800	DRAG LINK ASSY 17.59LG	1
12-1	57158	BALL JOINT 3/8 THD SHORT STUD	2
12-2	124925	NUT, 3/8-24 REGHEXJAM	2
12-3	56190	DRAG LINK	1
13	120382	WASHER, REGSPTLK.38X.65X.10	2
14	120369	NUT, 3/8-24 REGHEX	2
15	327395	SHAFT, PIN-STR	1
16	326892	BRNG, FL .50 IDX1.370ODX	1
17	326505	SCR 1/4-20X.75 (TO 30-35 FT#)	2
18	46931	NUT, 1/4-20 WDFL MAC-LOCK	2
19	20864	RING, RETE .38X.04TRUS133-50	1
20	41058	TIRE & RIM, PU 13X5.0MS TUR	2
		SEE TIRE TREAD PAGE	
20-1	24167	VALVE STEM	2
20-2	35937	HUB	2
20-3	314416	BEARING	4
21	842	WASHER, FLAT .755X1.91X.076	4
22	36626	RING, RETEX .37X.05TRUS133-75	2
23	40394	HUB CAP, 1.500ID X 7.8LG	2
24	100124	SCREW, 3/8-16X1.25 HHC	1
25	120394	WASHER, FLAT .408X.51X.065	2
26	43171	NUT, 3/8-16 HWDFL WHIZ-LOCK ZN	1

* ORDER INDIVIDUAL PARTS.

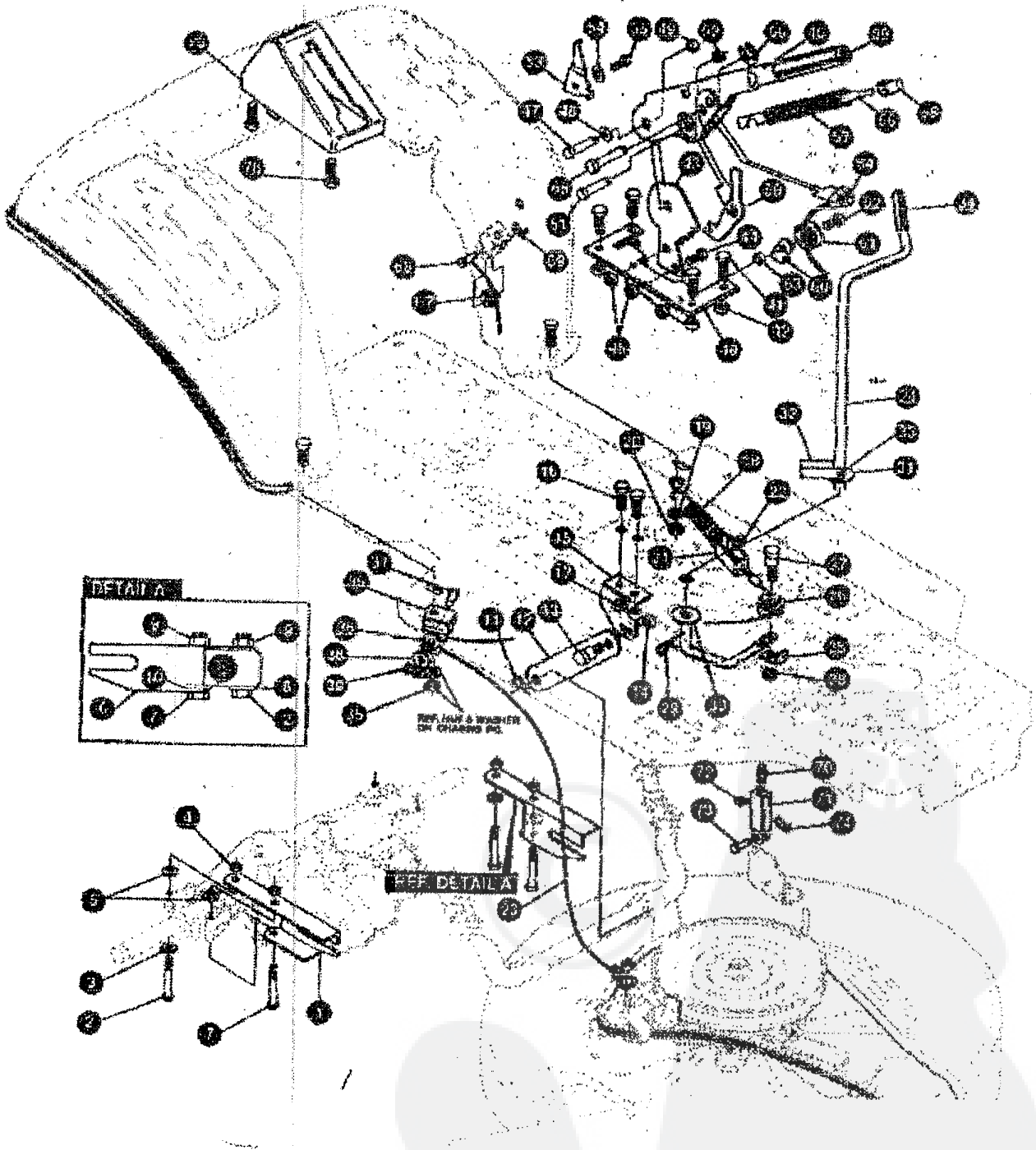

NOTE: ALWAYS USE ORIGINAL EQUIPMENT PARTS. Use of service/replacement parts other than original equipment parts may void your warranty.

ALL UNNUMBERED ITEMS ARE INTERCHANGEABLE WITH OPPOSITE SIDE

331231B

E3554-190

MOWER SUSPENSION ASSEMBLY

REV #	PART #	DESCRIPTION	QTY
1	321371	BRKT, REAR SUPT RH	1
2	180091	SCREW, 5/16-18X2.50 HHC	2
3	120393	WASHER, FLAT .344X.89X.065	1
4	1499	NUT, 5/16-18 REGHEXCTRK	2
5	314702	SPACER, SLEV .344X1.00X .500PM	2
6	321370	BRKT, REAR SUPT LH	1
7	180119	SCREW, 5/16-18X2.00 HHC	2
8	120393	WASHER, FLAT .344X.89X.065	1
9	1498	NUT, 5/16-18 REGHEXCTRK	2
10	314702	SPACER, SLEV .344X1.00X .500PM	1
11	56180	PIN, HAIR .091 DIA X1.62LG	1
12	323899	BRKT, LINK LOWER BLKPHDS	1
13	313560	BOLT, .500X .225 HHSH 5/16-18	1
14	1498	NUT, 5/16-18 REGHEXCTRK	1
15	320605	BRACKET, LIFT BAR 30"	1
16	180077	SCREW, 5/16-18X .75 HHC	2
17	1498	NUT, 5/16-18 REGHEXCTRK	2
18	300473	SPRING, TENSION 7.52LG-17LBN	1
19	418224	WASHER, FLAT .344X1.13X.082	1
20	1498	NUT, 5/16-18 REGHEXCTRK	1
21	9406	CLEVIS, LIFT CABLE	1
22	120372	NUT, 1/4-20 REGSO	1
23	322261	CABLE, CLUTCH 31.91 LG (30" SF)	1
24	328139	LEVER, CLUTCH SF 30" SUB ZINC	1
25	1288	BRKT, CABLE RETAIN	1
26	48306	PULLEY, POWDER METAL	1
27	58335	BOLT, .375X .375 HHSH 1/4-20	1
28	1502	NUT, 1/4-20 REGHEXCTRK	1
29	9260	PIN, HAIR .091 DIA X1.66LG	1
30	986425	WASHER, FLAT .515X.88X.064	1
31	22265	WASHER, FLAT .515X1.36X.119PL	1
32	305225	STOP, PTO ENGAGE	1
33	326396	PIN, SPRING 1.67DIA X1.15LG HD	1
34	391624	KNOB, ROUND 1.50DIA OR GRIP	1
35	321295-853	CLEVIS, P.T.O. PULLEY	1
36	48306	PULLEY, POWDER METAL	1
37	300317	PIN, CLEVIS .375DIA X .81 LG	1
38	986415	WASHER, FLAT .351X1.00X.125	1
39	9260	PIN, HAIR .091 DIA X1.66LG	1
40	313926	BRACKET, HEIGHT ADJUST	1
41	180077	SCREW, 5/16-18X .75 HHC	4
42	1498	NUT, 5/16-18 REGHEXCTRK	4
43	301239	QUADRANT, HEIGHT ADJUST	1
44	180077	SCREW, 5/16-18X .75 HHC	2
45	1498	NUT, 5/16-18 REGHEXCTRK	2
46	322292-852	HANDLE, LIFT SHORT(30" S.F.)	1
47	300171	BOLT, .500X .270 HHSH 5/16-18	1
48	986415	WASHER, FLAT .500X .75X.084	1
49	64108	NUT, 5/16-18 HWDFLCTRK	1
50	301239	PAWL, SQUARE	1
51	300171	BOLT, .500X .270 HHSH 5/16-18	1
52	44108	NUT, 5/16-18 HWDFLCTRK	1
53	6438	POINTER, HEIGHT ADJ	1
54	138476	WASHER, EXLK 1.95X.41X.03	1
55	35287	SCREW, #8-32X .38 HHWATAP	1
56	303027	ROD, ACTUATOR-SHORT	1
57	58326	SPRING, HEIGHT ADJUST	1
58	58325	KNOB, HEIGHT ADJ PUSH BUTTON	1
59	58329	GRIP, .750 OD W/ HOLE BLACK	1
60	9149	BRKT, CABLE RETAIN	1
61	48306	PULLEY, POWDER METAL	1
62	58336	BOLT, .375X .375 HHSH 1/4-20	1
63	1502	NUT, 1/4-20 REGHEXCTRK	1
64	321430	CABLE, LIFT 21.50 - 30"	1
65	300310	PIN, CLEVIS .310DIA X .475LG	1
66	300311	RING, RET E .31X.25TRUX139-31	1
67	48306	PULLEY, POWDER METAL	1
68	300317	PIN, CLEVIS .375DIA X .81 LG	1
69	9260	PIN, HAIR .091 DIA X1.66LG	1
70	120375	NUT, 1/4-20 REGHEX	1
71	9405	CLEVIS, LIFT CABLE	1
72	120372	NUT, 1/4-20 REGSO	1
73	30522	PIN, CLEVIS .312 X .812	1
74	121222	PIN, CUTTER .290 DIA X .75LG	1
75	300335	LIFT COVER	1
76	300340	SCREW, #10 X .75 HHPLAST	3

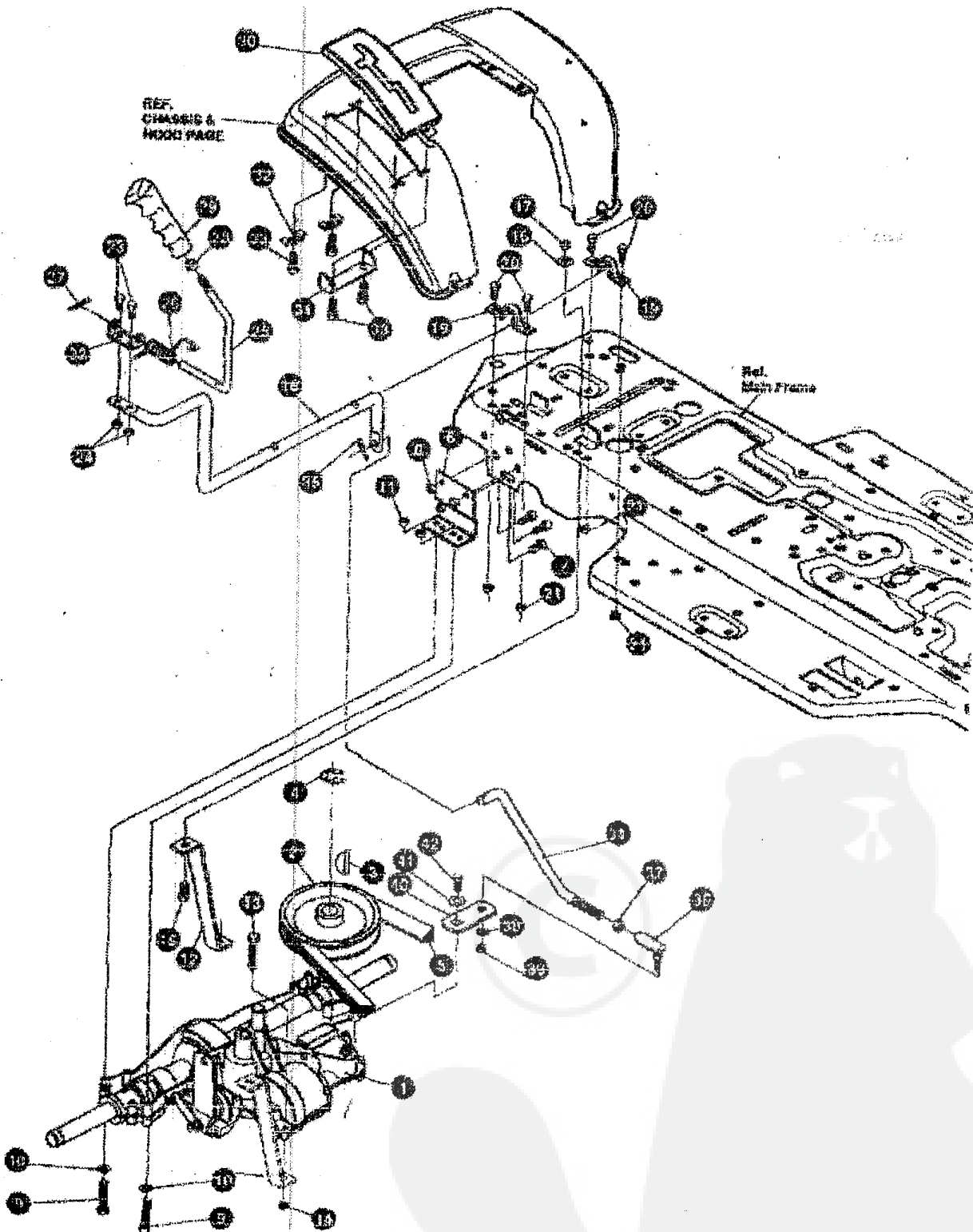

NOTE: ALWAYS USE ORIGINAL EQUIPMENT PARTS. Use of service/replacement parts other than original equipment parts may void your warranty.

ALL UNNUMBERED ITEMS ARE INTERCHANGEABLE WITH OPPOSITE SIDE

333369A

KEY #	PART #	DESCRIPTION	QTY
1		TRANSAXLE 940-001 2WS	1
2	903109	PULLEY, 6.6 OD V4L TIA	1
3	50795	KEY, H-PRD 906 .75DIA X 1.87WD	1
4	32052	RING, RETEN .58X.025TRU15100-52	1
5	54758	BELT, V 4L 92.00 SF DRIVE	1
6	53768-853	BRACKET, TRANSAXLE	2
7	180077	SCREW, 5/16-18X .75 HHC	6
8	1498	NUT, 5/16-18 REGHEXOTRLK	6
9	180091	SCREW, 5/16-18X2.50 HHC	4
10	120393	WASHER, FLAT .344X .69X.086	4
11	1498	NUT, 5/16-18 REGHEXOTRLK	4
12	323219	BRKT, TIA TORQ. BLKPHOS	1
13	180087	SCREW, 5/16-18X2.00 HHC	1
14	1498	NUT, 5/16-18 REGHEXOTRLK	1
15	180079	SCREW, 5/16-18X1.00 HHC	1
16	138485	WASHER, EXLK 320X.81X.05	1
17	1498	NUT, 5/16-18 REGHEXOTRLK	1
18	321849	LEVER, SHIFT LOW SF FNSFT	1
19	902760	CLAMP, 535DIA	2
20	180077	SCREW, 5/16-18X .75 HHC	4
21	1498	NUT, 5/16-18 REGHEXOTRLK	4
22	310956	BRKT, PIVOT ON LEV	1
23	180020	SCREW, 1/4-20X .75 HHC	2
24	1502	NUT, 1/4-20 REGHEXOTRLK	2
25	324798	LEVER, SHIFT UPPER SOP 1/2-13	1
26	810255	SPRING, TORQ. .55X.95X.016	1
27	137185	PIN, COTTER .125 DIA X 1.00LG	1
28	120238	NUT, 1/2-13 HEXJAM	1
29	55514	KNOB, ROUND 1.50DIA OR GRIP	1
30	911209	COVER PLASTIC LF P930/F4980-6	1
31	311257-853	BRACKET COVER F-5 FNDR SHIFT	1
32	1941	CLAMP, SPRG 1.17"ID	2
33	911331	SCREW, 1/4-15X .44.53 HILONHWA	4
34	321844	ROD, CONNECTING, SHIFT	1
35	137185	PIN, COTTER .125 DIA X 1.00LG	1
36	57158	BALL JOINT 3/8 THD 8" SHORT STUD	1
37	124925	NUT, 3/8-24 REGHEXJAM	1
38	120382	WASHER, REGSPYLK.393X.08X.10	1
39	120368	NUT, 3/8-24 REGHEX	1
40	323212	BRKT, SHIFT	1
41	57157	WASHER, 750X.250 SF-TRANSAXLE	1
42	36255	SCREW, 1/4-28X .75 NYLHHC	1

E3554-190

MOTION DRIVE ASSEMBLY

KEY #	PART #	DESCRIPTION	QTY
50	49808	BELT GUIDE	1
51	271184	NUT, 5/16-18 HEXKEPS	1
52	120303	WASHER, FLAT .344X .69X.065	1
53	1498	NUT, 5/16-18 REGHEXCTRLK	2
54	331836	ASSY, PEDAL, BRAKE, CLUTCH	1
55	310676	PIN, CLEVIS .500DX4.87LG	1
56	2998	WASHER, FLAT .504X .75X.050	1
57	331972	SPACER, SLEV .53 X .62X1.240	1
58	56180	PIN, HAIR .091 DIA X 1.62LG	1
59	49761	PAD, CLUTCH/BRAKE PEDAL	1
60	321969	IDLER ARM BRKT TRACTION	1
61	329989	BOLT, .625X .135 HSH 5/16-18	1
62	46602	WASHER, FLAT .830X .87X.110	1
63	1498	NUT, 5/16-18 REGHEXCTRLK	1
64	327897	SPRING 3/4 CDX7.75X.091 TENSION	1
65	33659	RETAINER, BELT	1
66	35374	PULLEY, IDLER V4L 3.09X .62	1
67	40892	BOLT, 3/8-16X1.50 CAPHSN	1
68	1498	NUT, 5/16-18 REGHEXCTRLK	1
69	330175	CLUTCH ROD ASSY, .259 DIA 3.92	1
70	325780	SPRING 3/800X2.18 X.055 TENSION	1
71	323210	BRKT, TRCTN 5/8 BLKPHOS	1
72	46624	BOLT, .500X .199 HSH 5/16-18	1
73	1498	NUT, 5/16-18 REGHEXCTRLK	1
74	333263	ROD, BRAKE 940 BLKPHOS	1
75	313681	SPRING, CLUTCH .625 CD	1
76	50352	NUT, 1/4-20 WDFLLK TOPLOCK	1
77	42090	TIRE 3 PUM, PU 18X6 5X0TURFWH	2
78		SEE TIRE TREAD PAGE	2
78-1	34187	VALVE STEM	2
78-2	34182	HUB	2
79	32628	KEY, SQUARE .18750X2.28LG	2
80	642	WASHER, FLAT .765X1.31X.076	4
81	42615	WASHER, FLAT .765X1.63X.07	2
82	36825	RING, RETEX .57X.05TRUS189-75	2
83	40394	HUB CAP, 1.500IO X 76LG	2

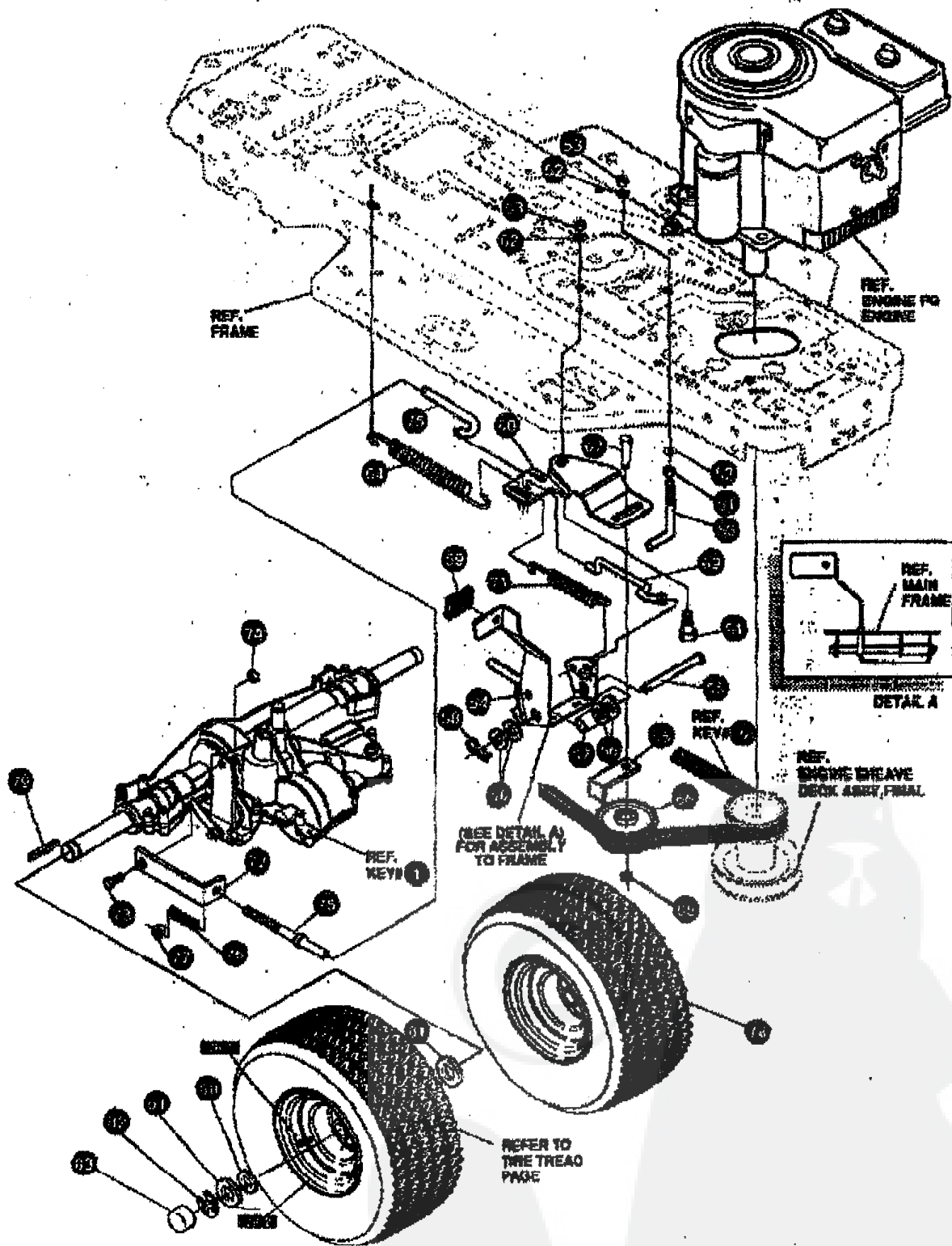

NOTE: ALWAYS USE ORIGINAL EQUIPMENT PARTS. Use of service/replacement parts other than original equipment parts may void your warranty.

ALL UNNUMBERED ITEMS ARE INTERCHANGEABLE WITH OPPOSITE SIDE

333359A

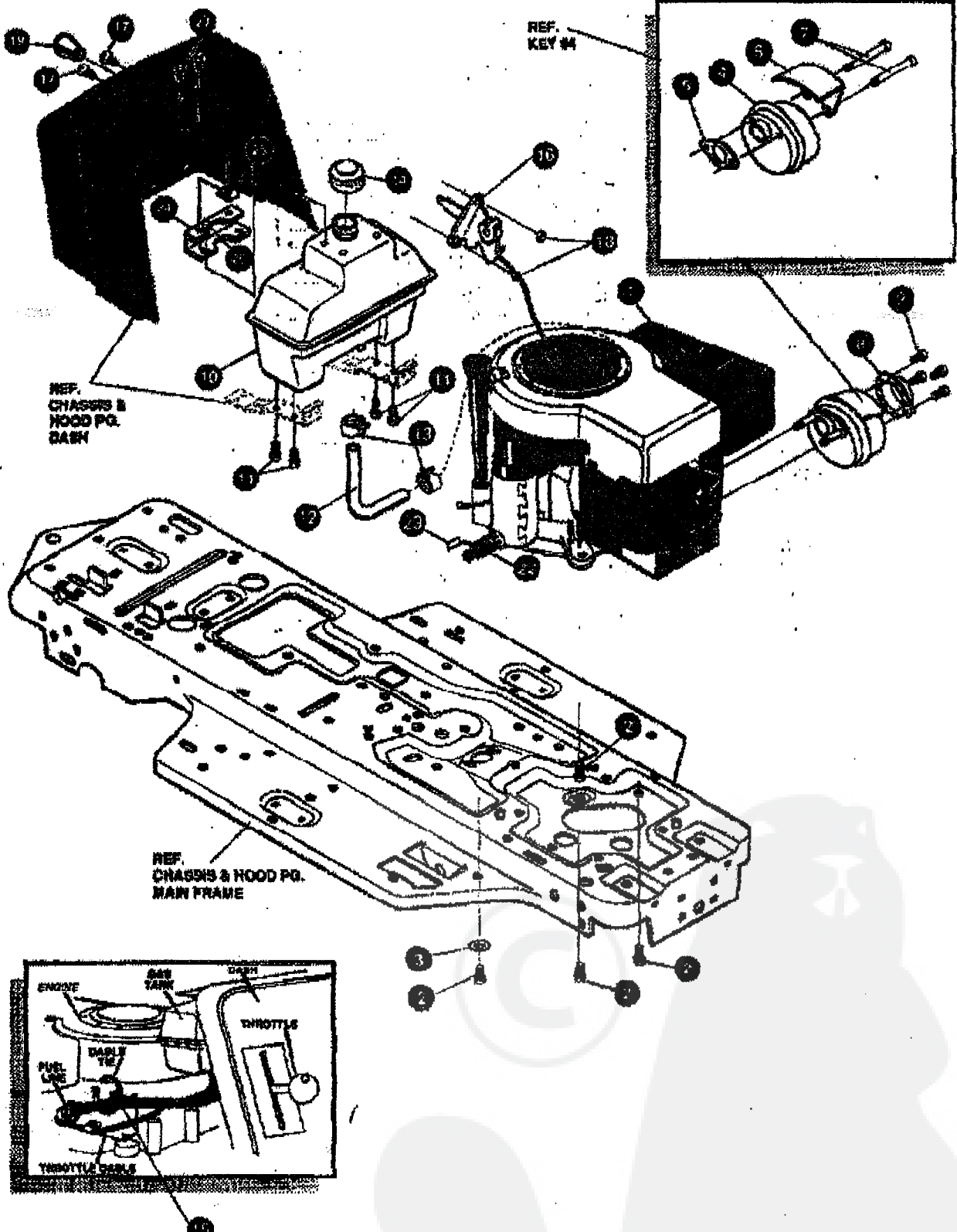

NOTE: ALWAYS USE ORIGINAL EQUIPMENT PARTS. Use of service/replacement parts other than original equipment parts may void your warranty.

ALL UNNUMBERED ITEMS ARE INTERCHANGEABLE WITH OPPOSITE SIDE

331113B

KEY #	PART #	DESCRIPTION	QTY
1	ENGINE	10-12HP B&S 3A (SEE ENGINE MANUAL)	1
2	50047	SCREW, 3/8-16X1.25 WAHHTAPBLKP	4
3	128489	WASHER, EXLK 384X.69X.04	1
4	57908	MUFFLER, CONVEYR ROUND	1
5	48708	GASKET, MUFFLER	1
6	54757	SHIELD, HEAT FOR ROUND MUFFLER	1
7	54980	SCREW, 5/16-18X3.50 HHC	2
8	55472	DEFLECTOR SIDE OUT (BS222573)	1
9	35287	SCREW, #8-32X.25 HHWTAP	4
10	314989	TANK, FUEL 1 GAL CLEAR	1
11	300908	SCREW, 25X.75X.51HHWAPLASTITE	4
12	42258	TUBING, .25X.50X BULK GAS LINE	12 IN.
13	47345	CLAMP, FUEL LINE RED	2
14	45704	CAP, GAS 1-1/2-T THD BLK	1
15	57444	TIE, CABLE BLACK NYLON 5.62L	1
16	58534	CONTROL, THROTTLE LF 12HP 20.5	1
17	155941	SCREW, 10-24X.63 PHFLTMA	2
18	308459	NUT, #10-24 HXHDNYLK	2
19	50607	KNOB, ROUND THROTTLE BLACK	1
20	325547	OIL DRAIN VALVE ASSEMBLY	1
21	327422	CAP, OIL DRAIN VALVE ASM YELLOW	1
22	328342-853	CENTER SUPPORT, PLASTIC DASH	1
23	328685	TINNERMAN CLIP CB114-1024-4	2
24	300303	SCREW, 25X.75X.51HHWAPLASTITE	2
25	274707	SCREW, 10-24X.50 WAHMA	2

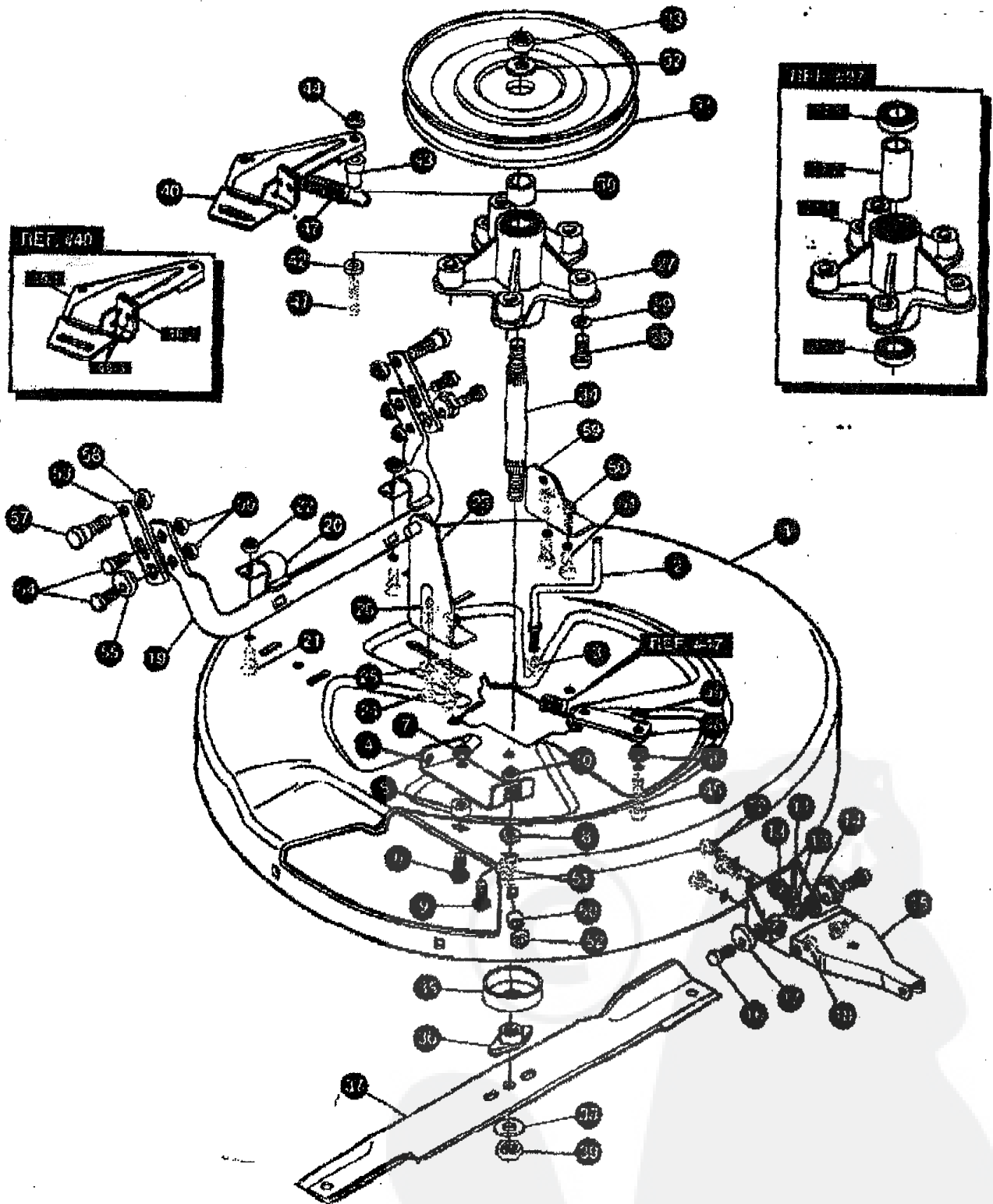

NOTE: ALWAYS USE ORIGINAL EQUIPMENT PARTS. Use of service/replacement parts other than original equipment parts may void your warranty.

ALL UNNUMBERED ITEMS ARE INTERCHANGEABLE WITH OPPOSITE SIDE

321244C

KEY #	PART #	DESCRIPTION	QTY
1	321982-853	DECK, MOWER 30"	1
2	57318	GUIDE, BELT 5/16-18 THD	1
3	1498	NUT, 5/16-18 REGHEXCTRLK	1
4	317017	BRACKET CHUTE MOUNT	1
5	314702	SPACER, SLEV .344X1.00X.500PM	1
6	120230	BOLT, 5/16-18X1.25 CARPLN	1
7	1498	NUT, 5/16-18 REGHEXCTRLK	1
8	45602	WASHER, FLAT .333X .87X.119	1
9	126216	BOLT, 5/16-18X .75 CARPLN	1
10	1498	NUT, 5/16-18 REGHEXCTRLK	1
11	311237-853	BRACKET, MOUNTING, FRONT	1
12	67072	BOLT, 5/16-18X .63 CARPLN	3
13	120393	WASHER, FLAT .344X .89X.065	3
14	1498	NUT, 5/16-18 REGHEXCTRLK	3
15	311236-853	BRACKET, BAR, TOW, FRONT	1
16	180079	SCREW, 5/16-18X1.00 HHC	2
17	58247	NUT, ADJUST	2
18	1498	NUT, 5/16-18 REGHEXCTRLK	2
19	313372-853	ASSY, TUBE, PIVOT	1
20	310672	SUPPORT, PIVOT TUBE	2
21	180077	SCREW, 5/16-18X .75 HHC	2
22	1498	NUT, 5/16-18 REGHEXCTRLK	2
23	314119-853	ASSY LIFT BRKT	1
24	180077	SCREW, 5/16-18X .75 HHC	2
25	120393	WASHER, FLAT .344X .89X.065	2
26	1498	NUT, 5/16-18 REGHEXCTRLK	2
27	315598	ASSEMBLY, CHILL	1
27-1	314272	CHILL, MACHINED CASTING	1
27-2	314274	TUBE, SPACER, STEEL	1
27-3	313576	BRNG, BALL 8204-2AA-CS	2
28	35495	SCREW, 5/16-18X .75 WAHTAP	5
29	138485	WASHER, EXLK .320X.81X.03	5
30	321148	SPACER, SLEV .700X1.250X.500	1
31	314273	PULLEY ASSEMBLY	1
32	22265	WASHER, FLAT .518X1.38X.119PL	1
33	1600	NUT, 1/2-13 REGHCTRLK	1
34	321144	SHAFT, CHILL 30" MOWER	1
35	318577	SHELD, DUST, BEARING	1
36	313584	HUB, BLADE ADAPTOR	1
37	325751	BLADE, 30" JD MOWER 14 WING	1
38	22265	WASHER, FLAT .518X1.38X.119PL	1
39	1500	NUT, 1/2-13 REGHCTRLK	1
40	12229-853	BRACKET, IDLER ASSEMBLY	1
40-1	313510-853	BRACKET, ARM, IDLER	1
40-2	306973	BRAKE PAD - HARD - 232AF	1
40-3	41601	RIVET, OVBST 187YAX .50LS ST	2
41	180113	SCREW, 5/16-18X1.00 HHC	1
42	45602	WASHER, FLAT .333X .87X.119	1
43	321145	SPACER, SLEV .322X .83X2.310	1
44	44108	NUT, 5/16-18 HWOFLCTRLK	1
45	180081	SCREW, 5/16-18X1.25 HHC	1
46	44108	NUT, 5/16-18 HWOFLCTRLK	1
47	35410	SPRING .071 X .62 X 4.37	1
48	302357	LINK	1
49	1498	NUT, 5/16-18 REGHEXCTRLK	1
50	50520	SPACER	1
51	126216	BOLT, 5/16-18X .75 CARPLN	1
52	1498	NUT, 5/16-18 REGHEXCTRLK	1
53	314099-853	BRACKET, BAR, REAR STABIL	2
54	180079	SCREW, 5/16-18X1.00 HHC	4
55	58247	NUT, ADJUST	2
56	1498	NUT, 5/16-18 REGHEXCTRLK	4
57	51940	BOLT, .500X .437 HSH 3/8-16	2
58	1498	NUT, 3/8-16 REGHCTRLK	2
59	320505-853	BRACKET, LIFT BAR 30"	1
60	1498	NUT, 5/16-18 REGHEXCTRLK	1
61	180077	SCREW, 5/16-18X .75 HHC	2

SEE DWG #321244 FOR PARTS
ASSY OF PAINTED DECK

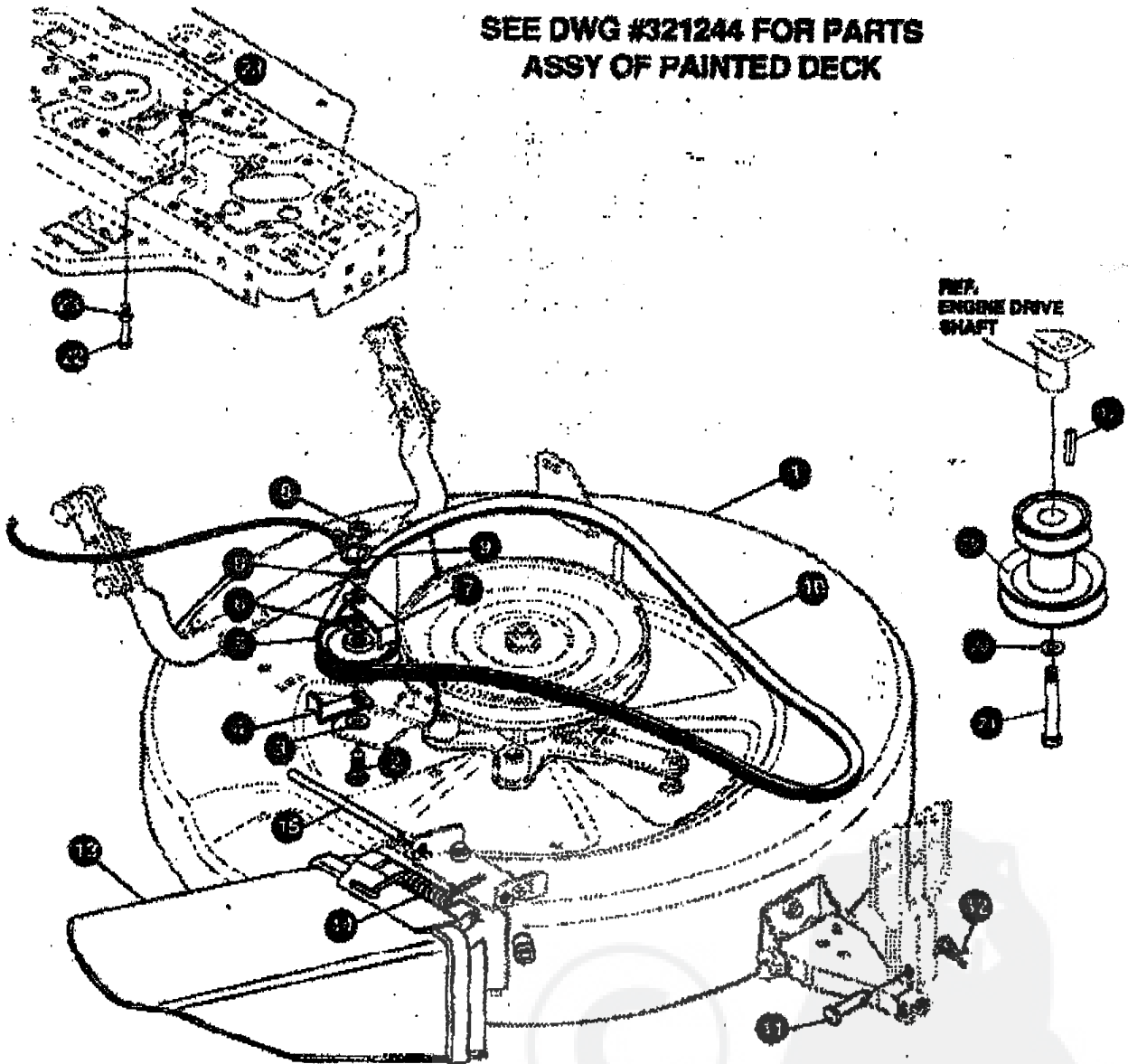

NOTE: ALWAYS USE ORIGINAL EQUIPMENT PARTS. Use of service/replacement parts other than original equipment parts may void your warranty.

ALL UNNUMBERED ITEMS ARE INTERCHANGEABLE WITH OPPOSITE SIDE

325842C

KEY #	PART #	DESCRIPTION	QTY
1		DECK 90° ASSY	1
2	301340	BOLT, 3/8-16X2.50 CARR	1
3	22265	WASHER, FLAT .515X1.58X.119PL	1
4	30650	RETAINER, BELT	1
5	45074	PULLEY, IDLER V4L 3.06X.72	1
6	25210	WASHER, FLAT .386X1.25X.08MTZ	1
7	30659	RETAINER, BELT	1
8	1486	NUT, 3/8-16 REGHXCTRLK	2
9	310754	HOOK, S, 10 GA. STEEL	1
10	321147	BELT, V 4L 54.0 - MOD SEC	1
11	47817	PIN, .495X1.750 CLEVIS SHORT	1
12	06190	PIN, HAIR .081 DIA X1.52 LG	1
13	315314	CHUTE DEFLECTOR 30° DECK	1
14	314975	SPRING, TORSION CHUTE DEFLECTOR	1
15	304424	ROD, PIVOT DECK .312DX7.25	1
16	328035	PULLEY, ENG 2.940FS.50X3.000	1
17	28953	KEY, SQUARE .2808X2.50 LG	1
20	120383	WASHER, REGSPTLK .489X.78X.12	1
21	182764	SCREW, 7/16-20X3.25 MMC	1
22	49030	SCREW, 3/8-16X7.50 MMC	1
23	1499	NUT, 3/8-16 REGHXCTRLK	2

* ORDER INDIVIDUAL PARTS.

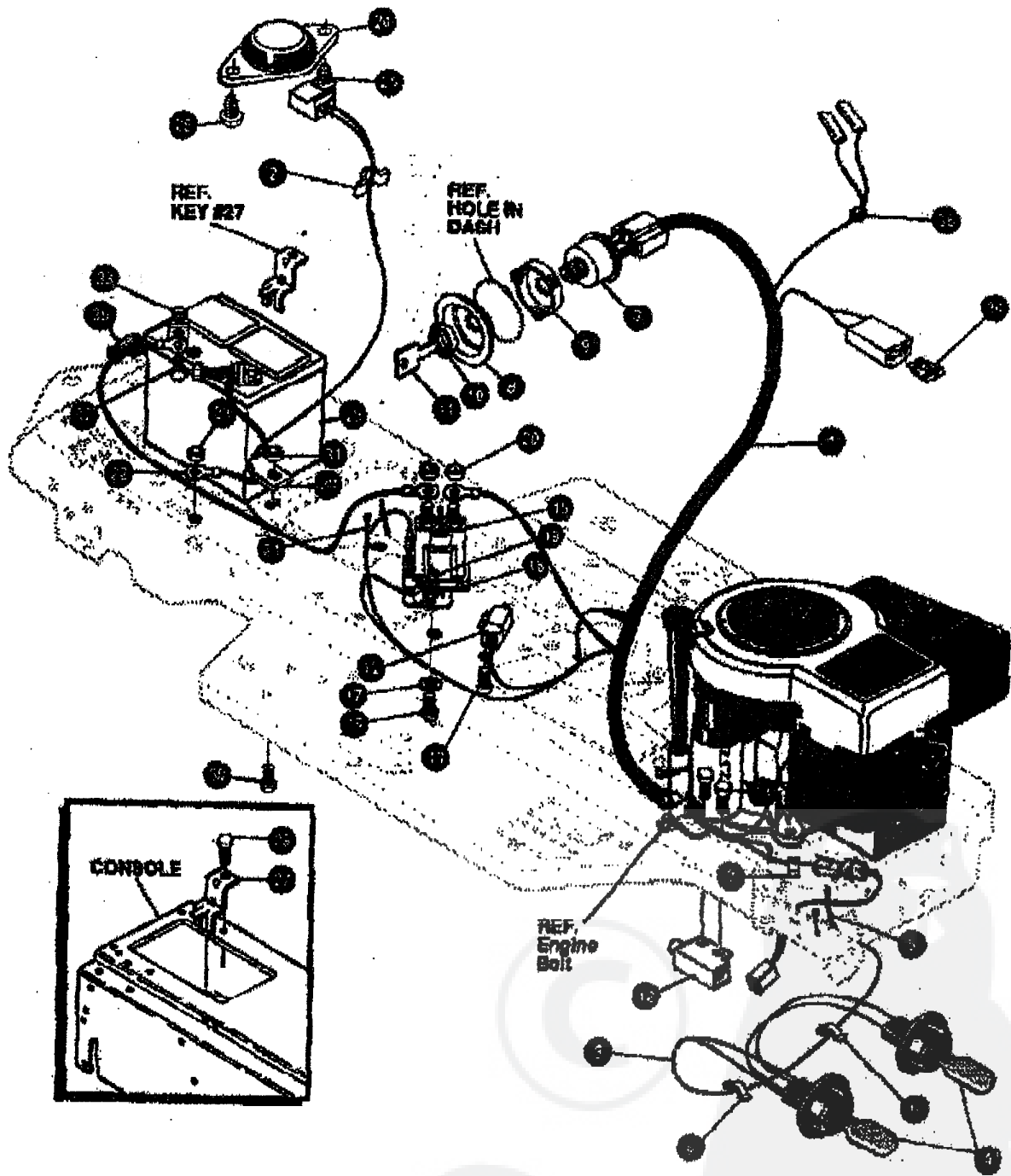

NOTE: ALWAYS USE ORIGINAL EQUIPMENT PARTS. Use of service/replacement parts other than original equipment parts may void your warranty.

ALL UNNUMBERED ITEMS ARE INTERCHANGEABLE WITH OPPOSITE SIDE

332051C

KEY #	PART #	DESCRIPTION	QTY
1	331453	WIRE HARNESS SF 6-12BAS WIAMM	1
2	41452	PRESS CLIP, 1.380LG .255ID	2
3	803054	ASSY LIGHT WIRE-1/4 TURN	1
4	82578	BULB, HEADLAMP	1
5	57444	TIE, CABLE BLACK NYLON 5.62L	2
6	41482	PRESS CLIP, 1.390LG .255ID	2
7	327354	SWITCH,IGNITION & LIGHTS DELTA	1
8	327234	CUP-IGN (OFF-LIGHT-ON-START)	1
9	327238	CAP-IGN INSIDE	1
10	327352	NUT, 5/8-BACME DELTA FOR BOOT	1
11	327350	KEY,IGNITION	1
12	57476	SWITCH,SCR MNT DP NO NO BLK	1
13	900302	SCREW, #10 X .50 HHTAPPST BLK	2
14	53716	SOLENOID	1
15	187745	SCREW, 1/4-20X .75 HXSEMMA	2
16	1084	WASHER, FLAT .281X1.00X.088	2
17	1502	NUT, 1/4-20 REGHEXCTRLK	2
18	271172	NUT, 1/4-20 REGHEXKEPS	1
19	271187	NUT, 5/16-24 HXKEPS	2
20	57444	TIE, CABLE BLACK NYLON 5.62L	2
21	55511	WIRE, GROUND, 12.5'	1
22	271184	NUT, 5/16-18 HXKEPS	1
23	57547	SWITCH, SEAT	1
24	180305	SCREW, 1/4-20X .38PHN-MA	2
25	302257	BATTERY, 12V	1
26	829175	BATTERY BRACKET	1
27	905346	SCREW, 1/4-20X .50 WAHHTAP	1
28	9149	BRACKET, CABLE RETAINER	1
29	197745	SCREW, 1/4-20X .75 HXSEMMA	1
30	1802	NUT, 1/4-20 REGHEXCTRLK	1
31	150020	SCREW, 1/4-20X .75 HHC	2
32	271172	NUT, 1/4-20 REGHEXKEPS	2
33	302031	FUSE SPADE TYPE 32V 15A	1
34	308201	INSULATOR, BATTERY BOOT EURO	1
35	322298	SPLICER	1

WIRING SCHEMATIC

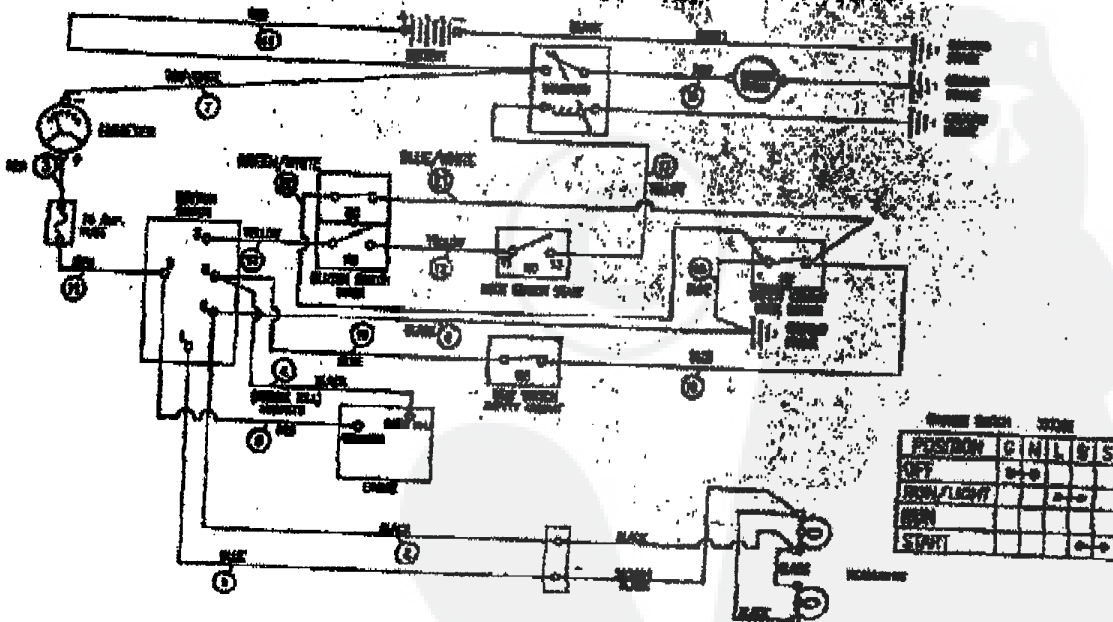

130451

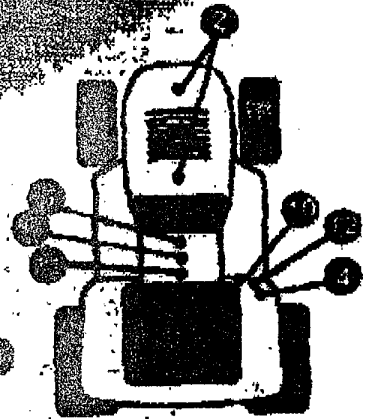
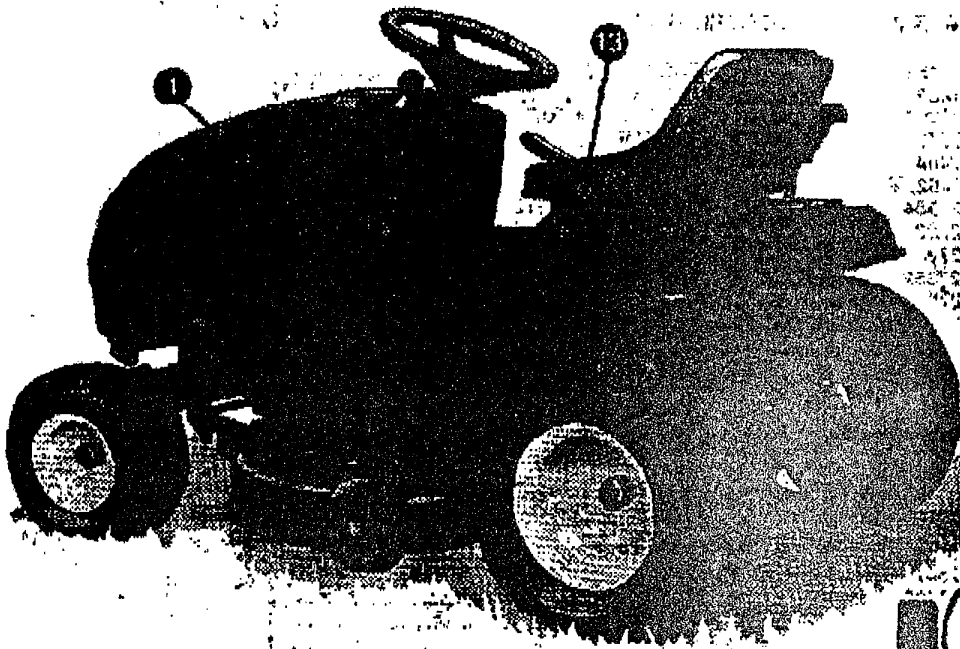

339059A

KEY #	PART #	DESCRIPTION	QTY
1	305802	FOAM HOOD 4X18	2
2	305803	PAD, 18 X 6 FOAM HOOD	2
3	329371	DECAL, DASH PLAIN EXPORT	1
4	33902	DECAL, WARNING, FRENCH/GERMAN	1
5	33924	DECAL, INSTRUCT CONSOLE TOP GER	1
6	33928	DECAL, INSTRUCT CONSOLE TOP FR	1
8	332399	DECAL, CERT DE CONFORMITE 1984	1
9	318010	DECAL, TUV GS	1
10	305770	DECAL, CAUTION TRIANGLE EUROPE	1
11	307383	DECAL, INSTR. CONSOLE TOP ENGL	1
12	310593	DECAL, DANGER ENGLISH	1
13	402214	DECAL, HEIGHT ADJUST	1
14	311304	DECAL, SHIFTER REV/NEUTRAL	1
15	331013	DECAL, SHIFTER POSITION	1
16	33903	DECAL, BRAKE/CLUTCH 150	1

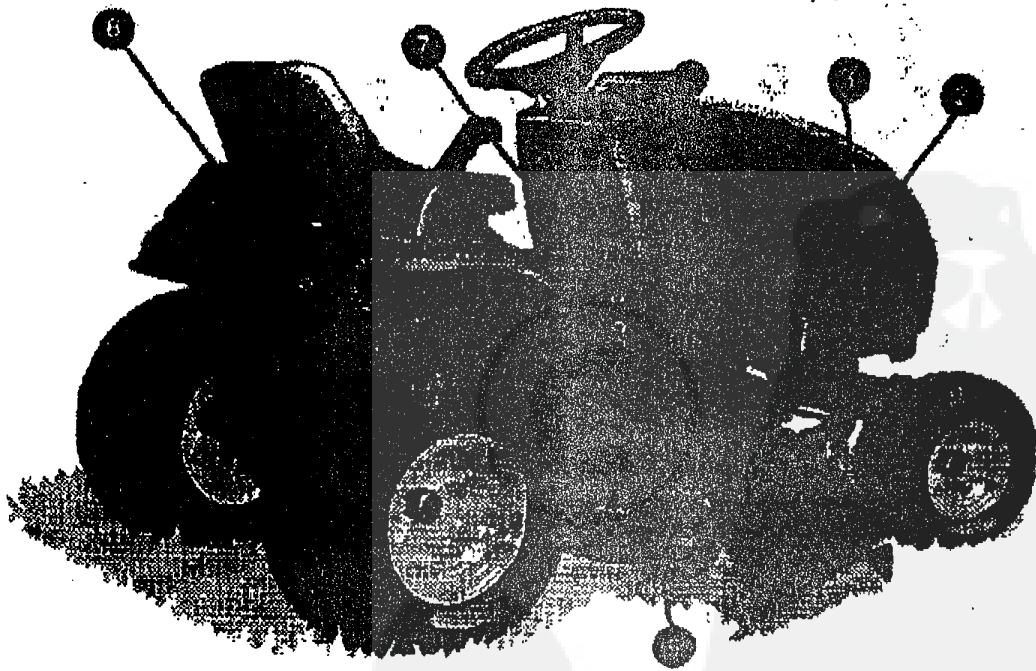
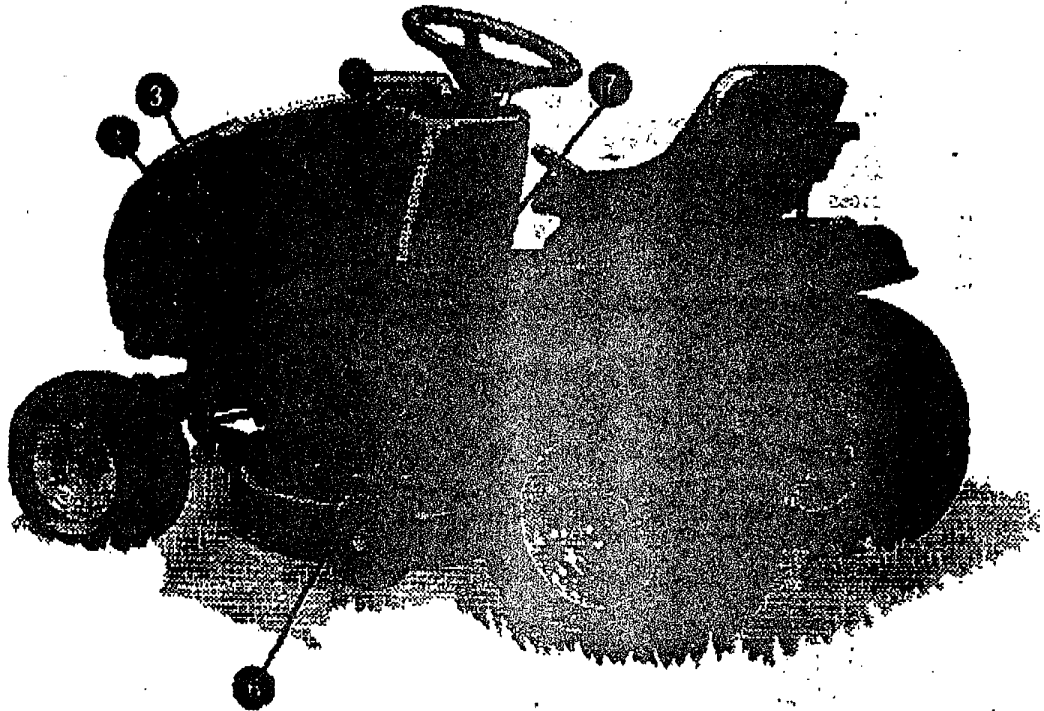

KEY #	PART #	DESCRIPTION	QTY
1	320853	DECAL, ECO-TRAC HOOD LH.....	1
2	320854	DECAL, ECO-TRAC HOOD RH.....	1
3	402137	NAMEPLATE UNITECH MEDIUM BL.....	2
5	320858	DECAL, CONSOLE RH.....	1
6	320857	DECAL, CONSOLE LH.....	1
7	307846	NAMEPLATE 11/30 WHITE.....	2
8	402136	NAMEPLATE UNITECH SMALL.....	1

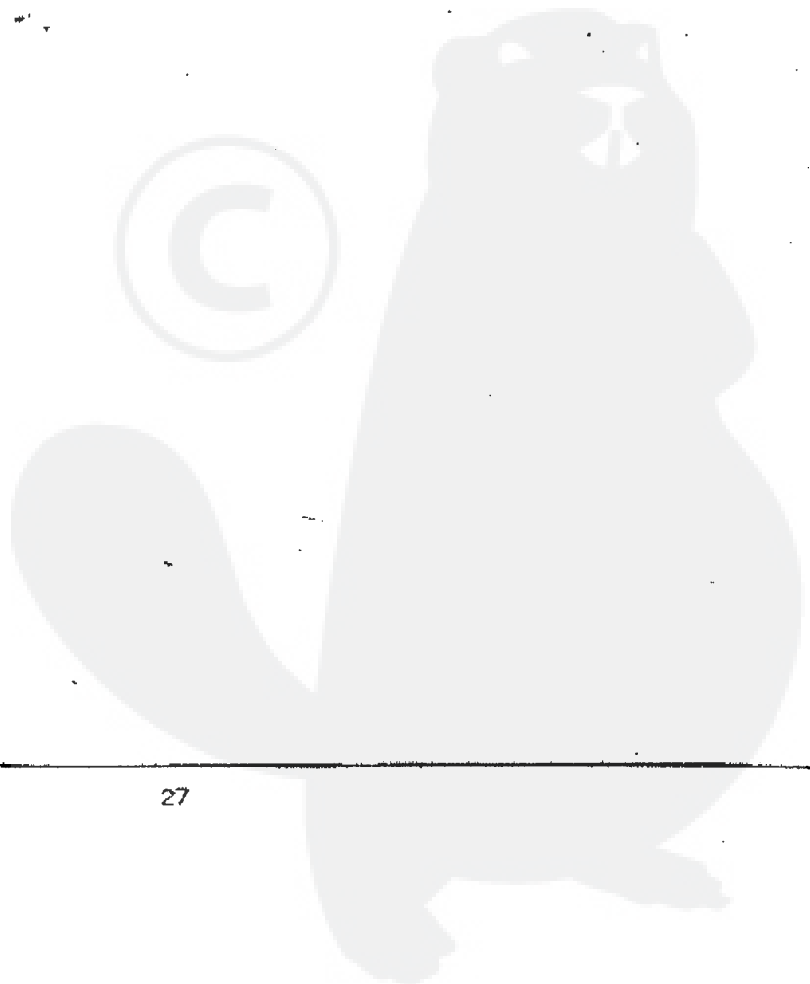
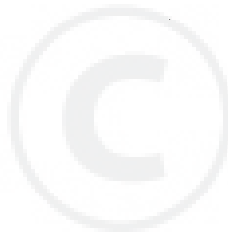



KEY #	PART #	DESCRIPTION	QTY
1	310384	SEAT, MICHIGAN, W/SW HOLE	1
2	330847	STEERING WHEEL	1
3		PARTS BAG, ASSY SEAT/STEER	1
3-1	120393	WASHER, FLAT .344X .69X .065	4
3-2	120338	WASHER, HVSP/TLK .328X .60X .09	4
3-3	180077	SCREW, 5/16-18X .75 HHC	4
3-4	458378	PIN, SPRING .250 DIA X 2.00 LG HVPL	1
		BATTERY ACID PACK, 80 OZ	1

BATTERY ACID MAY BE PURCHASED AT YOUR LOCAL HARDWARE STORES.

330669A

Contact the dealer where your tractor was purchased for the available accessories. If you are unable to contact the dealer, write to the address on the front cover of this manual.

30" Standard Lawn Rider

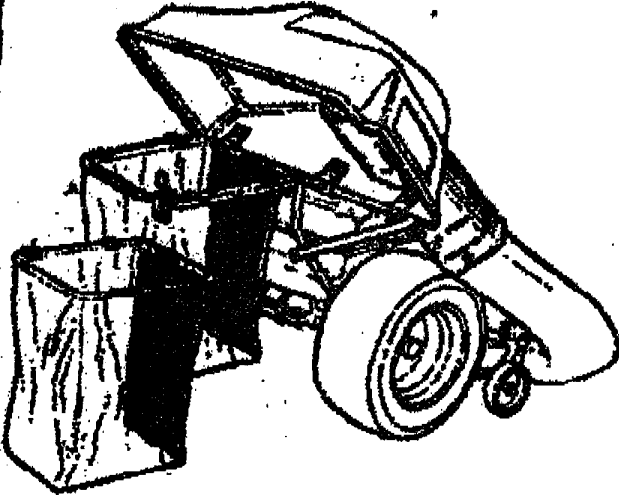

**Model #5708-17
Grass Collector (30" decks)**

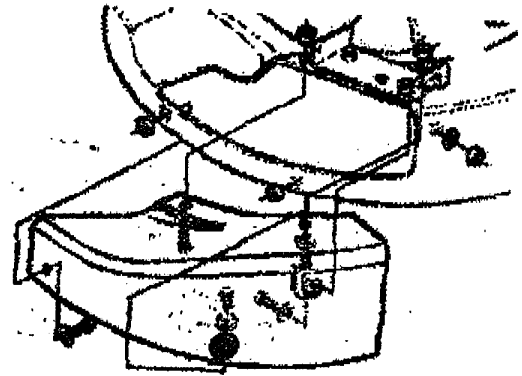

5714-00 Mulching Kit (30" Deck)

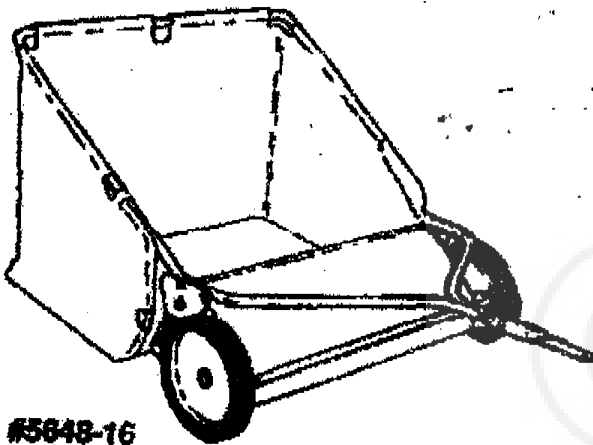

**Model #5848-16
Tow Behind Lawn Sweeper for Grass and Leaves**



314276 -30" Standard Lift Blade

OTHER ACCESSORIES

Model	Description
5709-02 322397	Front Weight Box - holds 35 lbs. 30" Mulching blade