

NOTE: ALWAYS USE ORIGINAL EQUIPMENT PARTS. Use of service/replacement parts other than original equipment parts may void your warranty.

ALL UNNUMBERED ITEMS ARE INTERCHANGEABLE WITH OPPOSITE SIDE

325876 E

KEY#	PART#	DESCRIPTION	QTY
1	326569-853	BRACKET, GRILLE LH	1
2	326568-853	BRACKET, GRILLE RH	1
3	313541-853	BRACKET, FRONT AXLE	1
4	56030	SCREW, 5/16-18 X 75WDFLLK	5
5	55273	NUT, 5/16-18 HXWDFLLK	5
6	300440	GUIDE, BELT RIDER	1
7	1498	NUT, 5/16-18 REGHEXCTRLK	1
8	308207	BOLT, 625 X 2.18 HSH 1/2-13	1
9	309008	NUT, 1/2-13 HEXJAM CTRLK	1
10	180138	SCREW, 3/8-16 X 3.00 HHC	2
11	2483	WASHER, .39 ID X 1.25 D X .07 BELLVIL	2
12	1499	NUT, 3/8-16 REGHXCTRLK	2
13	300635	GUIDE, BELT SHORT 15" WHEEL	1
14	124824	NUT, 5/16-18 HEXJAM	1
15	271190	NUT, 3/8-16 WEXKEPS	1
16	46763	RIVET, POP, .187 DIA X .450 LG ST	3
17	35497	SCREW, 5/16-18 X .50 WAHTAP	2
18	995346	SCREW, 1/4-20 X .50 WAHTAP	10
19	58312-853	SUPPORT, DASH STEEL	1
20	300303	SCREW, .25 X .75 X .51 HHWAPLASTITE	2
21	300201-853	BRACE, DASH SUPPORT LOWER	1
22	1502	NUT, 1/4-20 REGHEXCTRLK	1
23	302530-853	BRACKET, GAS TANK	1
24	995346	SCREW, 1/4-20 X .50 WAHTAP	2
25	300264-853	BRACE, DASH SUPPORT UPPER	1
26	995346	SCREW, 1/4-20 X .50 WAHTAP	2
27	305428	DASH, GP W/O GRAPHIC, SUS BLK	1
28	995346	SCREW, 1/4-20 X .50 WAHTAP	4
29	316868	WASHER, SHOULDER NYLON, .255 X .46	4
30	44811	SCREW, 1/4-20 X .75 WAHTAP	1
31	1502	NUT, 1/4-20 REGHEXCTRLK	1
32	333680	HOOD, H-11 PLASTIC	1
33	318197	PAD, ADHESIVE 1.00 X 1.50 X .12	4
34	328044	GRILL, LOWER GPWR LG G-T4	1
35	300302	SCREW, #10 X .50 HHTAPPST BLK	4
36	310203	CLIP, HOG RING C-SHAPED	1
37	301425	BRACE, HOOD SUPPORT H-11 GP	1
38	301542	SCREW, 10-24 X 1.00 HWATAPBLK	4
39	308459	NUT, #10-24 HXHDNYLK	4
40	302333	LENS, SMOKED W/TAB NO LOGO	1
43	57796	SCREW, #6 X .50 PLASTITE/MI-LO	4
44	56676	BOLT, .375 X .580 HSH 5/16-18	2
45	1498	NUT, 5/16-18 REGHEXCTRLK	2
46	57478	SPRING, HOOD LATCH	2
47	301452	FOIL, HEAT REFLECTOR	1
48	180079	SCREW, 5/16-18 X 1.00 HHC	2
49	1498	NUT, 5/16-18 REGHEXCTRLK	2
50	330847	STEERING WHEEL	1
61	456378	PIN, SPRING, 250 DIA X 2.00 LG	1
52	301413	SPACER, STEERING SHAFT	2
53	301541	FOIL, REFLECTOR LENS H-11 LH	1
54	301540	FOIL, REFLECTOR LENS H-11 RH	1
55	333348	PARTS MANUAL	1
56	327627	GRASS CATCHER MANUAL	1
57	328195	AIR ASSIST MANUAL	1
58	332212	OPERATOR'S MANUAL (ENGLISH)	1
59	332214	OPERATOR'S MANUAL (GERMAN)	1

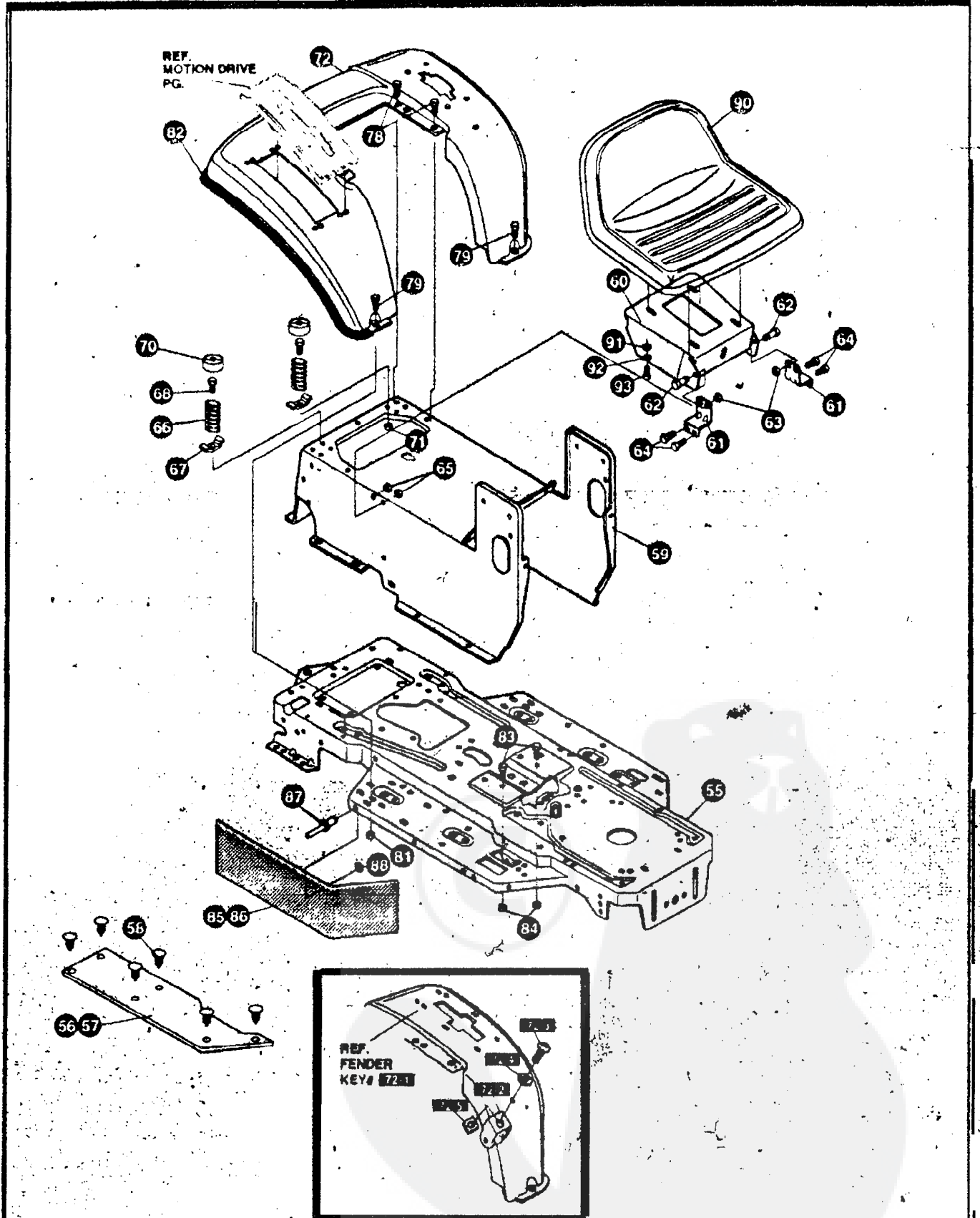

NOTE: ALWAYS USE ORIGINAL EQUIPMENT PARTS. Use of service/replacement parts other than original equipment parts may void your warranty.

A U UNNUMBERED ITEMS ARE INTERCHANGEABLE WITH OPPOSITE SIDE

329231 C

KEY#	PART#	DESCRIPTION	QTY
55	326579-879	FRAME, LF DRILLED P920/F4360	1
56	310005	FOOT PAD, LH 22 12 LG F-5	1
57	310006	FOOT PAD, RH 22 12 LG F-5	1
58	309235	FASTENER, RATCHET BLACK	12
59	327575-830	CONSOLE, NON-WALK THRU, LF, SOF	1
60	58221-879	PLATE, SEAT LF, F4, F5-SOG	1
61	53746-879	BRACKET, SEAT SUPPORT F4, F5-SOG	2
62	20507	BOLT, 437 X .156 HSSH 5/16-18	2
63	1 4 9 8	NUT, 5/16-18 REGHEXCTRLK	2
64	48901	SCREW, 5/16-18 X .63 WAHHC	4
65	1498	NUT, 5/16-18 REGHEXCTRLK I	4
66	49335	SPRING, .250 X 1.75 X 4.50	2
67	7686	CLAMP, SPRING	2
68	44811	SCREW, 1/4-20 X .75 WAHTAP	2
70	56907	COVER, SEAT SPRING 1.5 ID X 1.0 LG	2
71	1502	NUT, 1/4-20 REGHEXCTRLK	2
72	A	ASSEMBLY, FENDER F5 LF, SOF, SUSPENSION	1
72-1	332185-879	FENDER, F5, SUS, LF, SOF	1
72-2	9239	CLEVIS	1
72-3	439455	SCREW, 5/16-18 X .56 PHPNMA	1
72-4	301551	WASHER, .344 ID X 1.50 D X .09 CU	1
72-5	120373	NUT, 5/16-18 SQ	1
78	995345	SCREW, 1/4-20 X .50 WAHTAP	4
79	1 8 0 0 7 9	SCREW, 5/16-18 X 1.00 HHC	2
81	55273	NUT, 5/16-18 HXWDFLLK	2
82	55023	TRIM, 77.5" BLACK NARROW	77.5"
83	180079	SCREW, 5/16-18 X 1.00 HHC	2
84	1498	NUT, 5/16-18 REGHEXCTRLK	2
85	305388	SKIRT, TUV LF RUBBER 7 X 28.03	1
86	3 0 5 3 5 4	SKIRT, TUV LF RUBBER 7 X 15.64	1
87	3 2 9 2 3 8	RIVET, POP 3/16 DIA X .75 LG FLG	10
88	1501	WASHER, FLAT .203 X .35 X .040	10
90	310384	SEAT, MICHIGAN GEN, W/SW HOLE	1
91	120393	WASHER, FLAT .344 X .69 X .065	4
92	120638	WASHER, HVSPTLK .328 X .60 X .09	4
93	180077	SCREW, 5/16-18 X .75 HHC	4

ORDER INDIVIDUAL PARTS

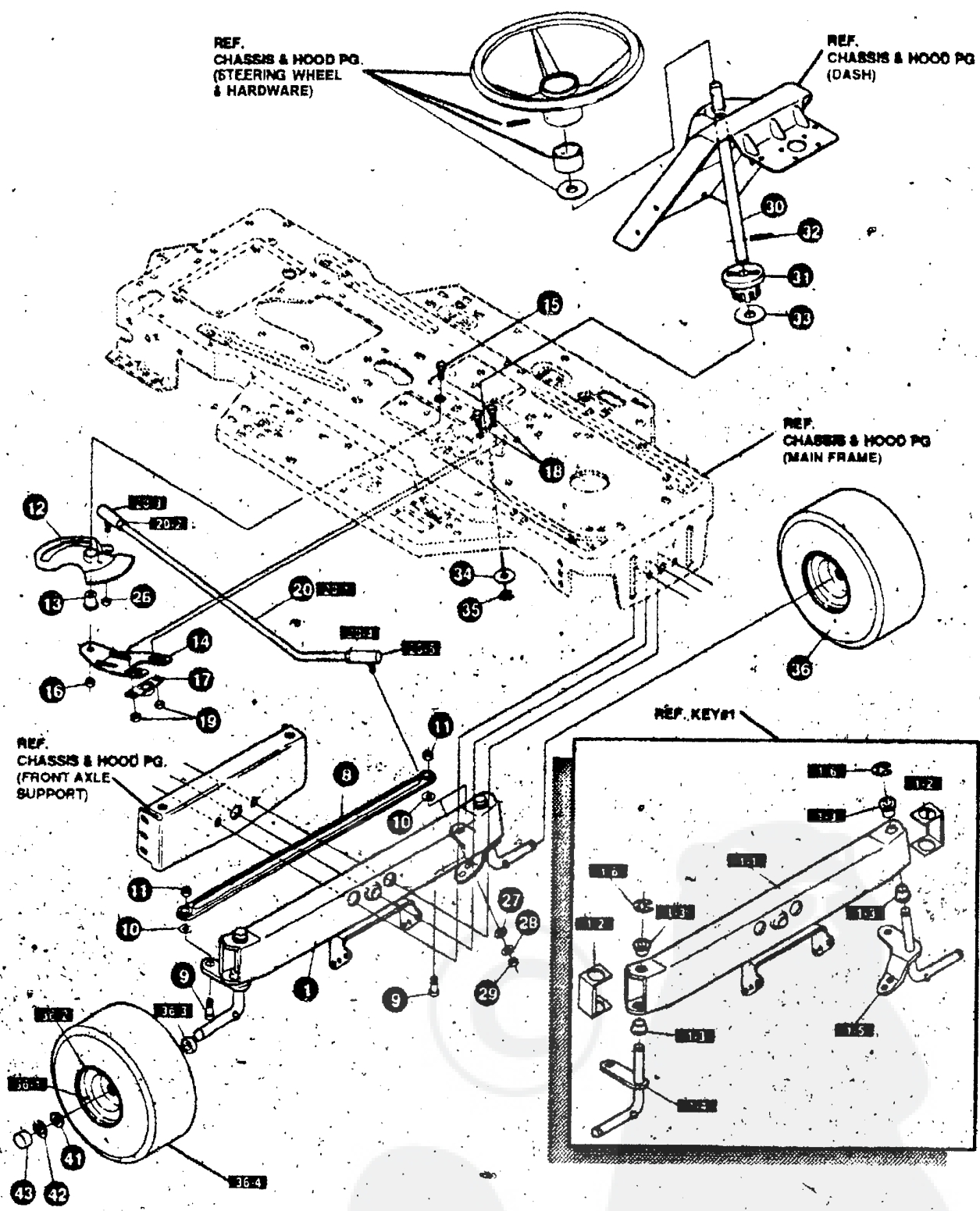

NOTE: ALWAYS USE ORIGINAL EQUIPMENT PARTS. Use of service/replacement parts other than original equipment parts may void your warranty.

ALL UNNUMBERED ITEMS ARE INTERCHANGEABLE WITH OPPOSITE SIDE

317887 F

KEY#	PART#	DESCRIPTION	QTY
	A	ASSEMBLY, AXLE FRONT 4WS SUSPENDED	1
1-1	310170	AXLE, FRONT	1
1-2	53373	AXLE COVER	1
1-3	52407	SPINDLE BEARING	4
1-4	302926	ASSEMBLY, SPINDLE RH	1
1-5	315866	ASSEMBLY, SPINDLE LH	1
1-6	36625	RING, RETEX .57 X .05 JRU 5133-B	2
8	304590	TIE ROD ASSEMBLY, 19.81 LG	1
9	180126	SCREW, 3/8-16 X 1.75 HHC	2
10	120382	WASHER, REGSPTLK .393 X .68 X .10	2
11	120377	NUT, 3/8-16 REGHX	2
12	313634	ASSEMBLY, SECT GEAR BLK	1
13	313629	BEARING, SLEEVE	1
14	313671-853	SUPPORT, SECTOR GEAR 4WS LF	1
15	315196	SCREW, 1/2-20 X 3.00 HHC	1
16	274654	NUT, 1/2-20 REGHXCTRLK	1
17	302498	BEARING, SFAL 500 ID X .OD X .75	1
18	323731	SCREW, 5/16-24 X .75 (TO 30-35 FT#)	2
19	71100	NUT, 5/16-24 HEXWDFLLK	2
20	323752	ASSEMBLY, DRAG LINK 4WS GEAR LF	1
20-1	321449	DRAG LINK, .625 DIA FOR 4WS LF	1
20-2	124925	NUT, 3/8-24 REGHEXJAM	1
20-3	57158	BALL JOINT, 3/8 THD SHORT STUD	1
20-4	272123	NUT, 7/16-20 HXJAM	1
20-5	302865	BALL JOINT, 7/16-20	1
26	46692	NUT, 3/8-24 WDFLHK WHIZ	1
27	120396	WASHER, FLAT 531 X 1.06 X .095	2
28	120383	WASHER, REGSPTLK .459 X .78 X .12	1
29	271506	NUT, 7/16-20 REGHX	1
30	332530	SHAFT, STEERING 4WS, LF	1
31	302314	PINION, STEERING	1
32	302524	PIN, DOWEL STEER EROLT	1
33	315194	WASHER, FLAT 51 X 1.38 X .043	1
34	2968	WASHER, FLAT 504 X .75 X .059	1
35	20864	RING, RET E .39 X .04 TRU 5133-50	1
36	321515	TIRE & RIM, PU-15 X 6.0 X 6	2
36-1	24167	VALVE STEM	
36-2	321518	RIM, WHEEL	
36-3	314416	BEARING, L/R	
36-4	TIRE	REFER TO TIRE TREAD PAGE	
41	642	WASHER, FLAT .755 X 1.31 X .075	4
42	36625	RING, RETEX .57 X .05 TRU 5133-75	2
43	40394	HUB CAP, 1.500 ID X 7/8 LG	2

ORDER INDIVIDUAL PARTS

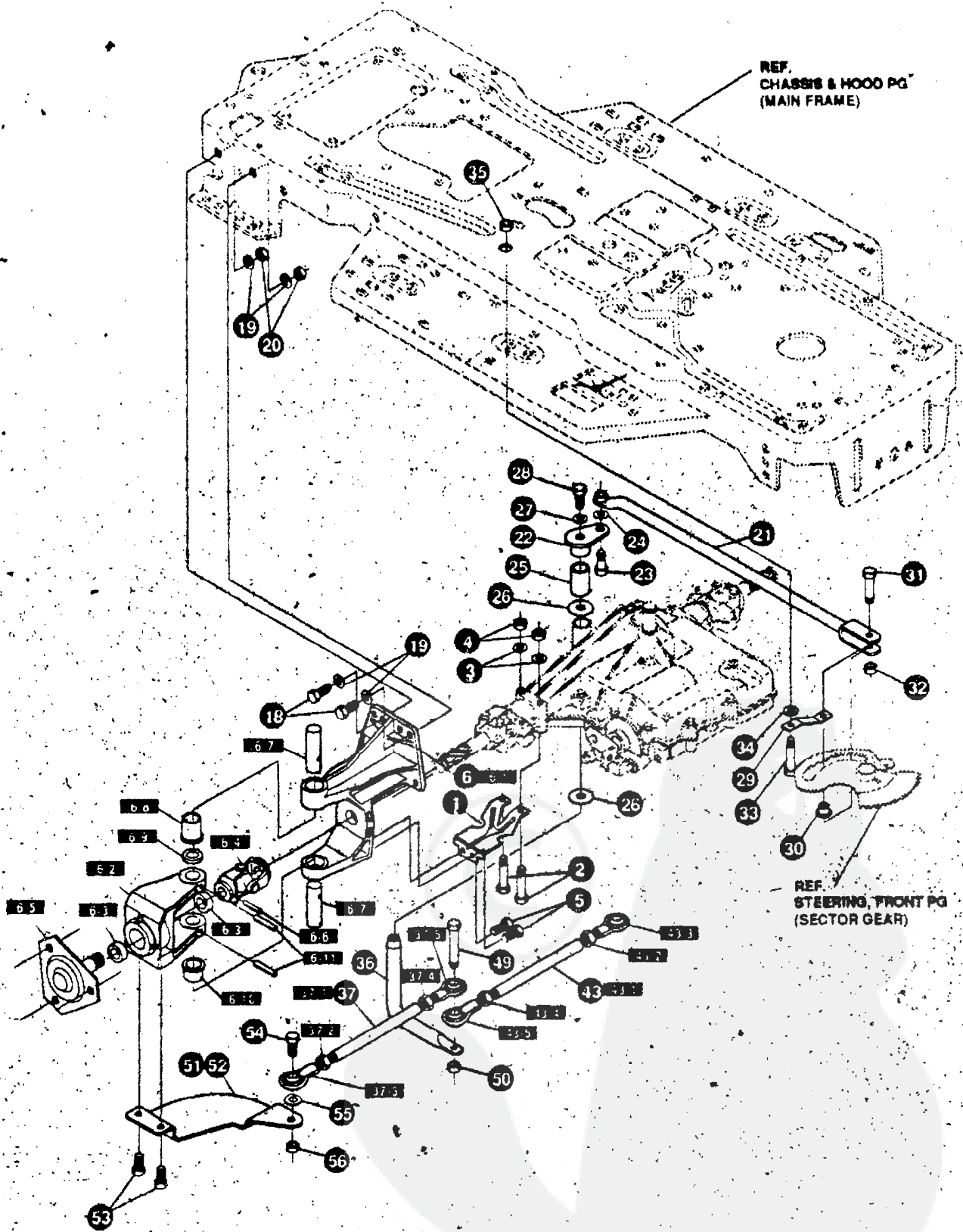

NOTE: ALWAYS USE ORIGINAL EQUIPMENT PARTS. Use of service/replacement parts other than original equipment parts may void your warranty.

ALL NUMBERED ITEMS ARE INTERCHANGEABLE WITH OPPOSITE SIDE

317291 M

KEY#	PART#	DESCRIPTION	QTY
1	303222-853	BRACKET, X-AXLE MTG 4WS	2
2	180091	SCREW, 5/16-18 X 2.50 HHC	1
3	120393	WASHER, FLAT .344 X .69 X .065	4
4	1498	NUT, 5/16-18 REGHEXCTRLK	4
5	35498	SCREW, 5/16-18 X .75 WAHTAP	4
6	323766	U-JOINT, ASSEMBLY 4-WS LD LF	2
6-1	314267	BRACKET, STEERING PIVOT DRILLED	1
6-2	12465	BRACKET, STEERING PIVOT	1
6-3	12325	BEARING, BALL 6203-2AA-3/4	1
6-4	12290	U-JOINT ASSEMBLY (SIM TO 320531)	1
6-5	12280-853	HUB ASSEMBLY	1
6-6	36311	PIN, GROOVED 250 DIA X 1.50 LG	1
6-7	12289	PIN, STEERING HINGE	2
6-8		NON-SERVICEABLE (ORDER PART#324758)	1
6-9	21682	WASHER, FLAT .765 X 1.25 X .042	1
6-10		NON-SERVICEABLE (ORDER PART#324758)	1
6-11	456722	PIN, SPRING .250 DIA X 1.50 LG	2
18	180079	SCREW, 5/16-18 X 1.00 HHC	8
19	120393	WASHER, FLAT .344 X .69 X .065	16
20	1498	NUT, 5/16-18 REGHEXCTRLK	8
21	324514	ROD ASSEMBLY, DRAGLINK 4WS LF BLK	1
22	308719	PIVOT, STEERING	1
23	12319	BOLT, .562 X .340 HSSH 3/8-24	1
24	120394	WASHER, FLAT .406 X .81 X .065	1
25	304115	SPACER, STEERING SHAFT	1
26	25177	WASHER, FLAT .765 X 1.19 X .048	2
27	45602	WASHER, FLAT .333 X .87 X .119	1
28	421051	SCREW, 5/16-24 X 1.00 HHC	1
29	302594	FOLLOWER, ROLLER	1
30	304116	CAM YOKE ROLLER	1
31	304122	BOLT, .625 X 1.175 HSSH	1
32	274654	NUT, 1/2-20 REGHXCTRLK	1
33	3 2 4 6 3 6	BOLT, .265 X .960 HSSH 3/8-24	1
34	996307	WASHER, FLAT .391 X 1.00 X .209	1
35	412349	NUT, 3/8-24 HXCTRLK	1
36	308720	SHAFT, STEERING PIVOT	1
37	323634	TIE ROD, ASSEMBLY RH EURO 4WS & LF STD	1
37-1	308447	ROD, TIE 1/2" D X 8.12 LG	1
37-2	308399	NUT, 3/8-24 LH THD REGHJAM	1
37-3	308384	BALL JOINT, LH 3/8-24	1
37-4	124925	NUT, 3/8-24 REGHEXJAM	1
37-5	304260	BALL JOINT, RH 3/8-24	1
43	323636	TIE ROD, ASSEMBLY LH EURO 4WS & LF STD	1
43-1	308446	ROD, TIE 1/2" D X 9.75 LG	1
43-2	308399	NUT, 3/8-24 LH THD REGHJAM	1
43-3	308384	BALL JOINT, LH 3/8-24	1
43-4	124925	NUT, 3/8-24 REGHEXJAM	1
43-5	304260	BALL JOINT, RH 3/8-24	1
49	181646	SCREW, 3/8-24 X 1.75 HHC	1
50	412349	NUT, 3/8-24 HXCTRLK	1
51	304120-853	ARM, REAR WHEEL STEER (FER) RH	1
52	304121-853	ARM, REAR WHEEL STEER LH	1
53	39728	SCREW, 3/8-16 X .75 WAHTAP	4
54	181639	SCREW, 3/8-24 X 1.25 HHC	2
55	120382	WASHER, REGSPTLK .393 X .68 X .10	2
56	412349	NUT, 3/8-24 HXCTRLK	2

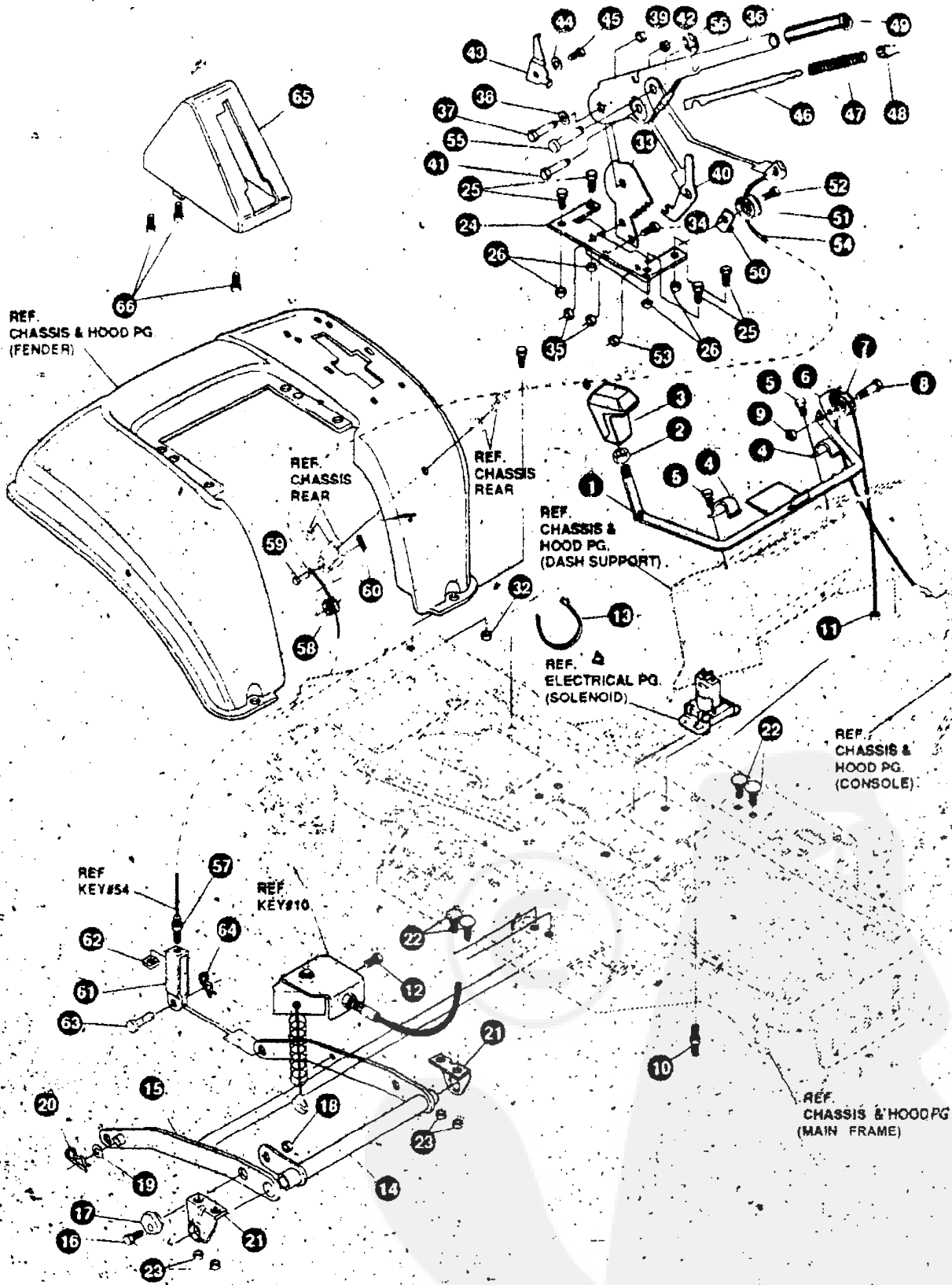

NOTE: ALWAYS USE ORIGINAL EQUIPMENT PARTS. Use of service/replacement parts other than original equipment parts may void your warranty.

ALL UNNUMBERED ITEMS ARE INTERCHANGEABLE WITH OPPOSITE SIDE

315597 G

KEY#	PART#	DESCRIPTION	QTY
1	303044-853	ASSEMBLY, WELD CLUTCH HANDLE	1
2	120238	NUT, 1/2-13 HEXJAM	1
3	304438	KNOB, SHIFT NOMA 1/2-13 BLK	1
4	9129	CLIP, RETAIN BRACKET	2
5	44811	SCREW, 1/4-20 X .75 WAHTAP	2
6	288	BRACKET, CABLE RETAIN	1
7	48306	PULLEY, POWDER METAL	1
8	57322	BOLT, .375 X .375 HSSH 1/4-20	1
9	1502	NUT, 1/4-20 REGHEXCTRLK	1
10	3 0 1 4 9 1	ASSEMBLY, CL UTCH CABLE GEN PWR	1
11	120613	NUT, 1/4-28 HJAM	1
12	35498	SCREW, 5/16-18 X .75 WAHTAP	1
13	57444	TIE, CABLE BLACK NYLON 5.62 L	1
14	300158-853	LIFT ASSEMBLY, LH	1
15	300169-853	LIFT ASSEMBLY, RH	1
16	180079	SCREW, 5/16-18 X 1.00 HHC	1
17	5 8 2 4 7	NUT, ADJUST	1
18	1498	NUT, 5/16-18 REGHEXCTRLK	1
19	4 1 7 0 9 8	WASHER, FLAT .531 X 1.06 X .063	2
20	8260	PIN, HAIR .091 DIA X 1.66 LG	2
21	58248-853	BRACKET, REAR HANG SUSPENSION	2
22	5 7 0 7 2	BOLT, 5/16-18 X .63 CARRLN	4
23	1498	NUT, 5/16-18 REGHEXCTRLK	4
24	313926	BRACKET, HEIGHT/ADJUST SUPPORT	1
25	180077	SCREW, 5/16-18 X .75 HHC	4
26	1498	NUT, 5/16-18 REGHEXCTRLK	4
31	180077	SCREW, 5/16-18 X .75 HHC	1
32	1498	NUT, 5/16-18 REGHEXCTRLK	1
33	301238	QUADRANT, HEIGHT ADJUST	1
34	180077	SCREW, 5/16-18 X .75 HHC	2
35	1498	NUT, 5/16-18 REGHEXCTRLK	2
36	322292-853	HANDLE, LIFT SHORT (30" S.F.)	1
37	300171	BOLT, .500 X .270 HSSH 5/16-18	1
38	996418	WASHER, FLAT .506 X .75 X .024	1
39	44108	NUT, 5/16-18 MWDFLCTRLK	1
40	301239	PAWL, SQUARE	1
41	300171	BOLT, .500 X .270 HSSH 5/16-18	1
42	44108	NUT, 5/16-18 MWDFLCTRLK	1
43	9 4 3 5	POINTER, HEIGHT ADJ	1
44	138479	WASHER, EXLK, 195 X .41 X .03	1
45	35287	SCREW, #8-32 X .38 HHWATAP	1
46	303027	ROD, ACTUATOR-SHORT	1
47	58326	SPRING, HEIGHT ADJUST	1
48	58325	KNOB, HEIGHT ADJUST PUSH BUTTON	1
49	58829	GRIP, .750 OD W/HOLE BLACK	1
50	9 1 4 9	BRACKET, CABLE RETAIN	1
51	48306	PULLEY, POWDER METAL	1
52	58336	BOLT, .375 X .375 HSSH 1/4-20	1
53	1502	NUT, 1/4-20 REGHEXCTRLK	1
54	314177	CABLE, LIFT 22.92 F-5 20X8-8	1
55	300310	PIN, CLEVIS 310 DIA X .475 LG	1
56	300911	RING, RET E 31 X .25 TRU X 5133-31	1
57	120375	NUT, 1/4-20 REGHEX	1
58	4 8 3 0 6	PULLEY, POWDER METAL	1
59	300317	PIN, CLEVIS .375 DIA X .81 LG	1
60	8260	PIN, HAIR .091 DIA X 1.66 LG	1
61	9405	CLEVIS, LIFT CABLE	1
62	120372	NUT, 1/4-20 REGSQ	1
63	39522	PIN, CLEVIS 312 X 812	1
64	1 2 1 2 2 2	PIN, COTTER .090 DIA X .75 LG	1
65	300335	LIFT COVER, 40" F5	1
66	300340	SCREW, #10 X .75 HHPLAST BLK	3

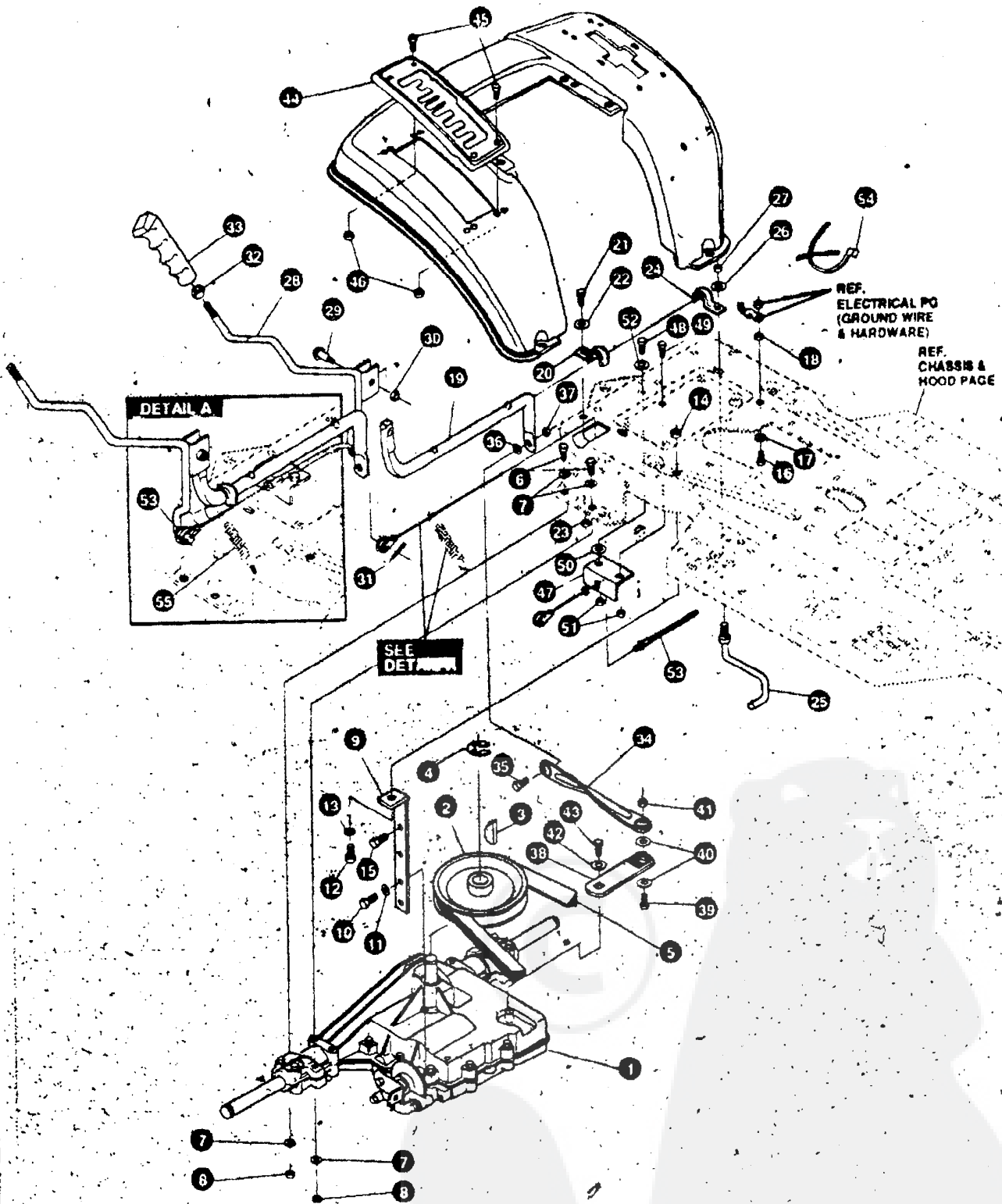

NOTE: ALWAYS USE ORIGINAL EQUIPMENT PARTS. Use of service/replacement parts other than original equipment parts may void your warranty.

ALL UNNUMBERED ITEMS ARE INTERCHANGEABLE WITH OPPOSITE SIDE

327805 C

KEY#	PART#	DESCRIPTION	QTY
1		TRANSAXLE, FOOTE 6SP 4WS LF	1
2	303109	PULLEY, 6.6 OD V4L T/A	1
3	50795	KEY, HI-PRO 606 .75 DIA X .187 WD	1
4	22053	RING, RETEX .58 X .035 TRU 5100-62	1
5	314120	BELT, V 4L 87.25 4WS LF	1
6	160091	SCREW, 5/16-18 X 2.50 HHC	4
7	120393	WASHER, FLAT .344 X .69 X .065	8
8	1498	NUT, 5/16-18 REGHEXCTRLK	4
9	323739	BRACKET, STABILIZER BLK	1
	35498	SCREW, 5/16-18 X .75 WAHTAP	1
10	120638	WASHER, HVSPTLK .328 X .60 X .09	1
12	100079	SCREW, 5/16-18 X 1.00 HHC	1
13	120393	WASHER, FIAT .344 X .69 X .065	1
14	1498	NUT, 5/16-18 REGHEXCTRLK	1
15	50947	SCREW, 3/8-16 X 1.25 WAHTAPBLK	1
36	180077	SCREW, 5/16-18 X .75 HHC	1
17	136536	WASHER, REGINTLK .320 X .61 X .03	1
18	1 4 9 8	NUT, 5/16-18 REGHEXCTRLK	1
19	319208	LEVER, SHIFT-LOWER, SHIFT N GO LF	1
20	310347-853	CLIP- SHIFT LEVER .625 ROD	1
	180077	SCREW, 5/16-18 X .75 HHC	1
22	996416	WASHER, FLAT .391 X 1.00 X .125	1
23	1498	NUT, 5/16-18 REGHEXCTRLK	1
24	310347-853	CUP- SHIFT LEVER .625 ROD	1
25	57259	GUIDE, BELT 5/16-18 THD	1
2 6	996416	WASHER, FLAT .391 X 1.00 X .125	1
27	1498	NUT, 5/16-18 REGHEXCTRLK	1
28	3 2 0 3 6 3	UPPER SHIFT LEVER ASSEMBLY	1
29	321092	BOLT, .380 X .500 HSSH 1/4-20	1
3 0	50352	NUT, 1/4-20 WDFLLK TOPLOCK	1
31	137165	PIN, COTTER .125 DIA X 1.00 LG	1
32	120377	NUT, 3/8-16 REGHX	1
33	306689	HANDLE, 3/8-16 MOLDED BLACK	1
34	3 1 6 5 5 7	LINK, TIE ROD SHIFT 7.477C/L	1
35	180124	SCREW, 3/8-16 X 1.25-HHC	1
36	120382	WASHER, REGSPTLK .393 X .68 X .10	1
37	1499	NUT, 3/8-16 REGHXCTRLK	1
38	309637	BRACKET, SHIFT 5SP SF	1
39	180124	SCREW, 3/8-16 X 1.25 HHC	1
40	120394	WASHER, FLAT .406 X .41 X .065	2
41	1499	NUT, 3/8-16 REGHXCTRLK	1
42	57157	WASHER, .750 X .250 SP-TRANSAXLE	1
43	56255	SCREW, 1/4-28 X .75 NYLHHC	1
44	319806-853	QUADRANT, SHIFT FOOTE F4360-6HD	1
45	305850	SCREW, 1/4-20 X .50 PHPNTAP	4
46	1502	NUT, 1/4-20 REGHEXCTRLK	4
47	321517	BRACKET, FRAME SHIFT	1
48	180022	SCREW, 1/4-20 X 1.00 HHC	1
49	57038	BOLT, 1/4-20 X .63 CARBLN	1
50	316080	SPACER .328 X .50 X .38	1
51	1502	NUT, 1/4-20 REGHEXCTRLK	2
52	120392	WASHER, FLAT .281 X .63 X .065	1
53	319803	CABLE, SHIFT N'GO	1
54	57444	TIE, CABLE BLACK NYLON 5.62 L	1
55	314837	SPRINGS, MEMORY	1

CONTACT YOUR NEAREST TRANSAXLE DEALER FOR PARTS & SERVICE

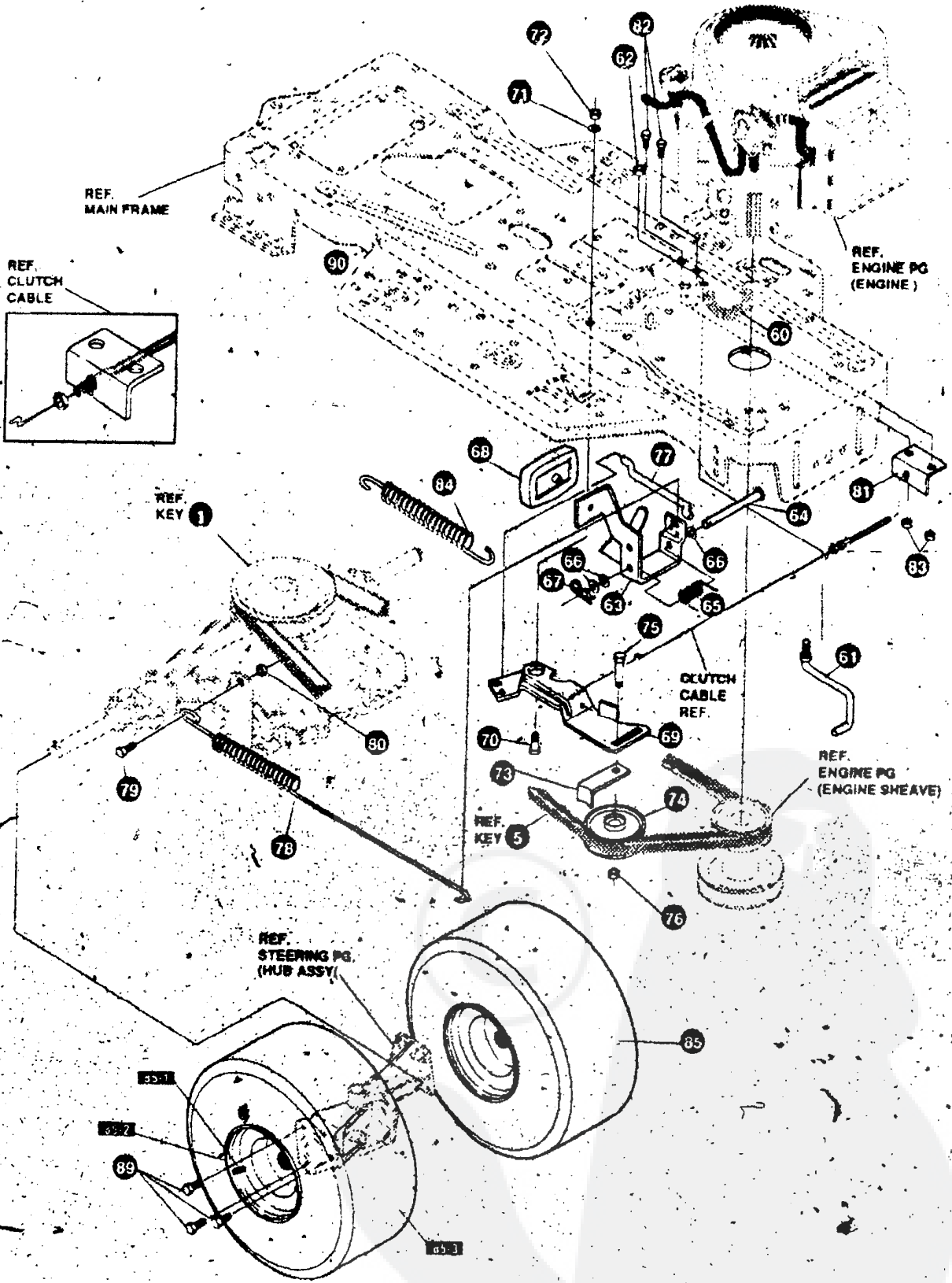

NOTE: ALWAYS USE ORIGINAL EQUIPMENT PARTS. Use of service/replacement parts other than original equipment parts may void your warranty.

ALL UNNUMBERED ITEMS ARE INTERCHANGEABLE WITH OPPOSITE SIDE

327805 C

KEY#	PART#	DESCRIPTION	QTY
60	321514	SPRING, DRAG LINK BIAS	1
61	304016	GUIDE, BELT RH	1
62	1498	NUT, 5/16-18 REGHEXCTRLK	1
63	325942	PEDAL ASSEMBLY, BRAKE/CLUTCH LF	1
64	319675	PIN, CLEVIS .500 D X 4.53 LG	1
65	57847	SPRING, BRAKE PEDAL	1
66	2968	WASHER, FLAT .504 X .75 X .059	3
67	56180	PIN, HAIR .091 DIA X 1.82 LG	1
68	48160	PAD, CLUTCH BRAKE W/PRINTING	1
69	320381	ARM, IDLER TRACTION, SOG LF	1
70	329989	BOLT, 625 X .135 HSSH 5/16-18	1
71	45602	WASHER, FLAT .333 X .87 X .119	1
72	1498	NUT, 5/16-18 REGHEXCTRLK	1
73	39659	RETAINER, BELT	1
74	35374	PULLEY, IDLER V4L 3.06 X .62	1
75	45892	BOLT, 3/8-16 X 1.50 CARRSN	1
76	1499	NUT, 3/8-16 REGHXCTRLK	1
77	57204	ROD, CLUTCH 3.92"	1
78	325937	SPRING, BRAKE 28.80 930, 4360	1
79	326131	BOLT, 495 X .31 HSSH5/16-18	1
80	1498	NUT, 5/16-18 REGHEXCTRLK	1
81	321517	BRACKET, FRAME SHIFT	1
82	180020	SCREW, 1/4-20 X .75 HHC	1
83	1502	NUT, 1/4-20 REGHEXCTRLK	2
84	322608	SPRING, CLUTCH	1
85	316665	TIRE & RIM, 20 X 10.00-8	2
85-1	24167	VALVE STEM	
85-2	316667	RIM, WHEEL	
85-3	TIRE	REFER TO TIRE TREAD PAGE	
89	181683	SCREW, 1/2-20 X .50 HHC	6
90	313039	DECAL, 4WS PATENT NO. 5048853	1

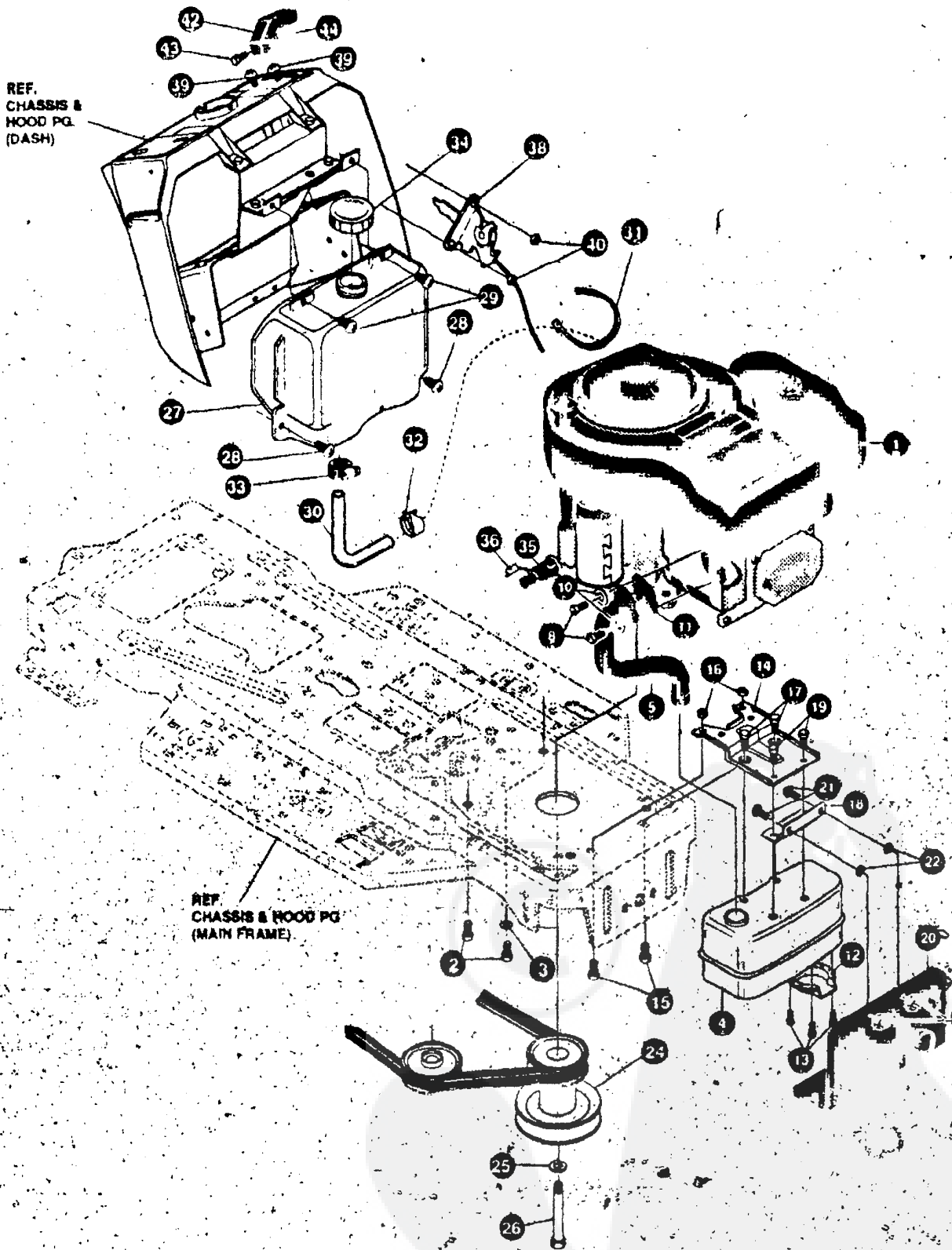

NOTE: ALWAYS USE ORIGINAL EQUIPMENT PARTS. Use of service/replacement parts other than original equipment parts may void your warranty.

ALL UNNUMBERED ITEMS ARE INTERCHANGEABLE WITH OPPOSITE SIDE. 332573 A

KEY#	PART#	DESCRIPTION	QTY
1	A	15.0 BS VANGARD SINGLE	1
2	50947	SCREW, 3/8-16 X 1.25 WAHHTAPBLKP	4
3	138489	WASHER, EXLK .384 X .69 X .04	1
4	326324	MUFFLER, 12/14 HP LOW BACK FIRE	1
5	332406	TUBE, MUFFLER EXHUST BS-OHV SINGLE	1
8	180077	SCREW, 5/16-18 X .75 HHC	2
10	120638	WASHER, HVSP TLK 328 X .60 X .09	2
11	46708	GASKET, MUFFLER	1
12	5 6 4 7 2	DEFLECTOR SIDE OUT (BS222573)	1
13	3 5 2 6 7	SCREW, #8-32 X .38 HHWATAP	4
14	304709-853	BRACKET, MUFFLER	1
15	56030	SCREW, 5/16-18 X .75 WDFLLK	2
16	55273	NUT, 5/16-18 HXWDFLLK	2
17	995346	SCREW, 1/4-20 X .50 WAHHTAP	2
18	9796	BRACKET, TRANSAXLE	1
19	44811	SCREW, 1/4-20 X .75 WAHHTAP	2
20	332421-853	HEAT SHIELD, FRONT LF/EURO	1
21	57072	BOLT, 5/16-18 X .63 CARRLN	2
22	309436	PUSHNUT, 5/16 BOLT RETAINER	2
23	55273	NUT, 5/16-18 HXWDFLLK	2
24	328028	PULLEY, ENGINE 3.0 D X 4.0 LG X 5.0 D	1
25	120383	WASHER, REGSPTLK .459 X .78 X .12	1
26	433146	SCREW, 7/16-20 X 4.25 HHC BLK	1
27	314991	TANK, FUEL 2-GAL GPWR CLEAR	1
28	300303	SCREW, .25 X .75 X .51 HHWAPLASTITE	2
29	995346	SCREW, 1/4-20 X .50 WAHHTAP	2
30	50118	TUBING, .25 X .50 X BULK GAS LINE	14 0'
31	57444	TIE, CABLE BLACK NYLON 5 62 L	1
32	47345	CLAMP, HOSE SCREW TYPE	1
33	47345	CLAMP, HOSE SCREW TYPE	1
34	300304	CAP, GAS - 2.0 THROAT	1
35	325547	OIL DRAIN VALVE ASSEMBLY	1
36	327422	CAP, OIL DRAIN VALVE ASSEMBLY, YELLOW 1	1
38	303159	THROTTLE, CONTROL 11HP BS GP	1
39	320553	SCREW, 10-24 X .63 PHPNMA	2
40	308459	NUT, #10-24 HXHDNYLK	2
42	300508	KNOB, THROTTLE CONTROL GP STYLE	1
43	159585	SCREW, #8-32 X .38 PHPNMA	1
44	120622	NUT, #8-32 REGHX	1

^ SEE ENGINE MANUAL

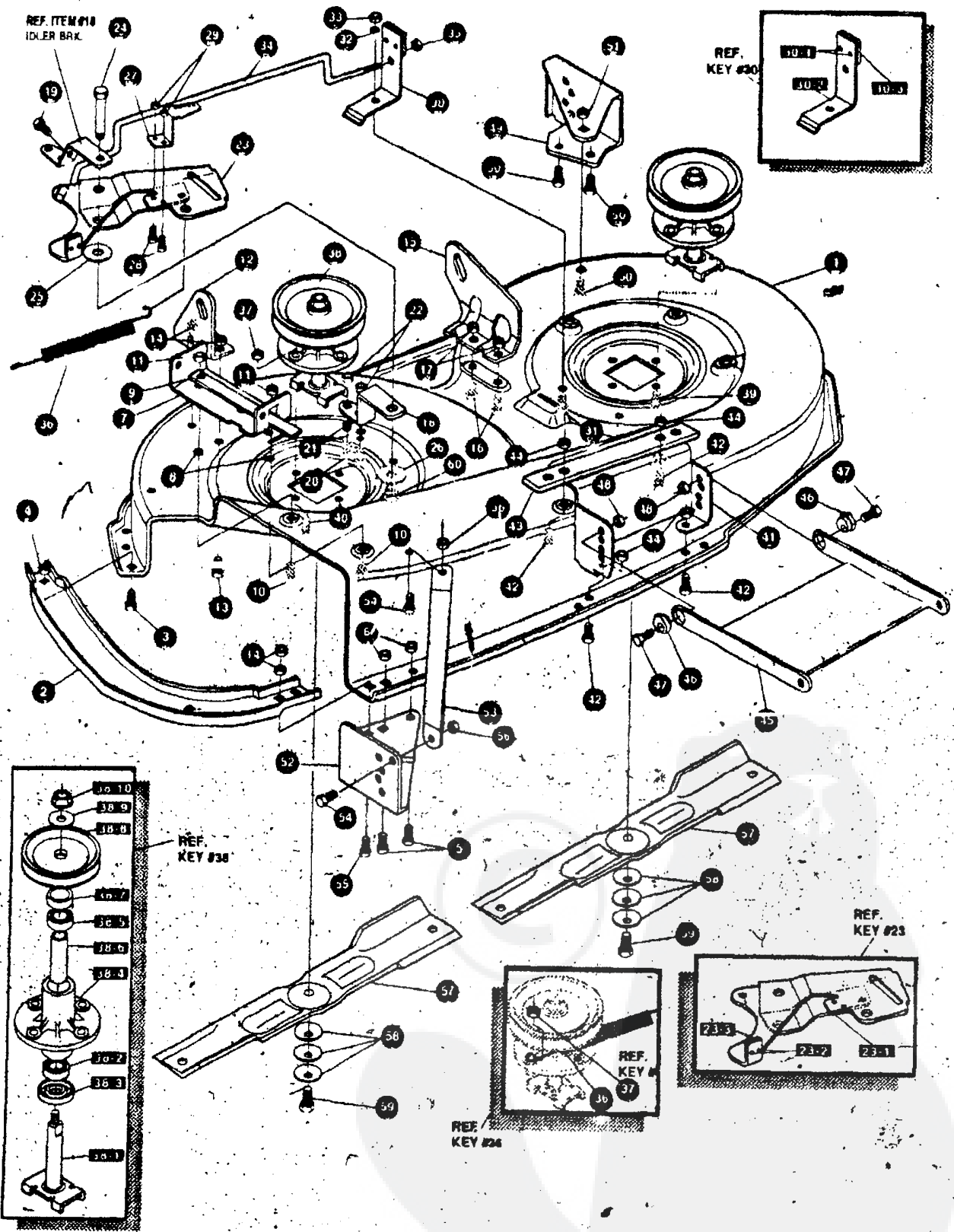

NOTE: ALWAYS USE ORIGINAL EQUIPMENT PARTS. Use of service/replacement parts other than original equipment parts may void your warranty.

ALL UNNUMBERED ITEMS ARE INTERCHANGEABLE WITH OPPOSITE SIDE

331147 C

E3560-870

PRE-PAINTED DECK ASSEMBLY

KEY#	PART#	DESCRIPTION	QTY
	325103	40" DECK KIT	1
2	326480-853	TOE GUARD - MULCHER	1
3	180077	SCREW, 5/16-18 X .75 HHC	1
4	1498	NUT, 5/16-18 REGHEXCTRLK	1
5	160077	SCREW, 5/16-18 X .75 HHC	1
6	1490	NUT, 5/16-18 REGHEXCTRLK	2
7	317013	BRACKET, CHUTE MOUNT BLACK	1
8	120393	WASHER, FLAT 344 X .69 X .065	2
9	322320-853	LEVER ASSEMBLY (SHORT)	1
9-1	58319	PIN	1
9-2	322319	LEVER, CHUTE LATCH (SHORT)	1
10	180077	SCREW, 5/16-18 X .75 HHC	2
11	1498	NUT, 5/16-18 REGHEXCTRLK	2
12	313929	LIFT BRACKET, REAR RH BLK 853	1
13	180077	SCREW, 5/16-18 X .75 HHC	2
14	1498	NUT, 5/16-18 REGHEXCTRLK	2
15	310667	BRACKET, DECK LIFT REAR LH BLK	1
16	180077	SCREW, 5/16-18 X .75 HHC	2
17	1498	NUT, 5/16-18 REGHEXCTRLK	2
18	326893-853	BRACE IDLER SUPPORT 40" 43"	1
19	308231	SCREW, 1/4-20 X 1.25 HHWATAP	1
20	180077	SCREW, 5/16-18 X .75 HHC	2
21	120393	WASHER, FLAT 344 X .69 X .065	2
22	44108	NUT, 5/16-18 HWDFLCTRLK	2
23	320576-853	IDLER ARM ASSEMBLY	1
23-1	322116-853	ARM, IDLER 40/43" DECK	1
23-2	41601	RIVET, OVSET, 187 DIA X .50 LG ST	2
23-3	306973	BRAKE PAD - HARD - 232AF	1
24	3 0 4 4 2 0	BOLT, 500 X 2.15 HSSH	1
25	996307	WASHER, FLAT 391 X 1.00 X .209	1
26	996416	WASHER, FLAT 391 X 1.00 X .125	2
27	326249853	BRACKET, EXTENSION IDLER	1
28	180077	SCREW, 5/16-18 X .75 HHC	1
29	1498	NUT, 5/16-18 REGHEXCTRLK	2
30	321828	BLADE BRAKE ASSEMBLY	1
30-1	13624	RIVET, TRSET, 185 DIA X .41 LG ST	2
30-2	304119853	BRAKE ARM	1
30-3	306973	BRAKE PAD - HARD - 232AF	1
31	180077	SCREW, 5/16-18 X .75 HHC	1
32	120393	WASHER, FLAT 344 X .69 X .065	1
33	1498	NUT, 5/16-18 REGHEXCTRLK	1
34	315396	ROD, BRAKE 40" DECK	1
35	1502	NUT, 1/4-20 REGHEXCTRLK	1
36	35410	SPRING, .071 X .62 X 4 37	1
37	1498	NUT, 5/16-18 REGHEXCTRLK	1
38	56424-853	QUILL ASSEMBLY, 36/39/40/43	2
38-1	56425	SHAFT/SADDLE 36"	1
38-2	49562	BEARING, BALL 6203-2AA (SEALS)-C3	1
38-3	50616	DUST SHIELD	1
38-4	55547	QUILL CASTING (1046)	1
38-5	49562	BEARING, BALL 6203-2AA(SEALS)-C3	1
38-6	50818	SPACER, SLEEVE 669 X .88 X 3.797	1
38-7	51449	SPACER, SLEEVE 672 X .93 X 4.38PM	1
38-8	313898	PULLEY ASSEMBLY	1
38-9	56365	WASHER, SPECIAL QUILL	1
38-10	1282	NUT, 7/16-20 WDFLLK	1
39	35498	SCREW, 5/16-18 X .75 WAHHTAP	7
40	300345	SCREW, 5/16-18 X 1.38 WAHHTAP	1
41	318445-853	BRACKET, 40 LF FRONT DECK	1
42	180077	SCREW, 5/16-18 X .75 HHC	4
43	328155-853	PLATE MOUNTING	1
44	1498	NUT, 5/16-18 REGHEXCTRLK	4
45	58305-853	BRACKET, LINK DECK FRONT	1
46	58247	NUT, ADJUST	2
47	1 8 0 0 7 9	SCREW, 5/16-18 X 1.00 HHC	2
48	1498	NUT, 5/16-18 REGHEXCTRLK	2
49	317041	BRACKET, GAGE WHEEL LH BLACK	1
50	180077	SCREW, 5/16-18 X .75 HHC	3
51	1498	NUT, 5/16-18 REGHEXCTRLK	3
52	322464-853	BRACKET, GAGE WHEEL RH FRONT	1
53	314282-853	BRACKET, STABILIZER	1
54	180077	SCREW, 5/16-18 X .75 HHC	1
55	12685	SCREW, 5/16-18 X 1.50 HHCFT	1
56	309070	BLADE, 20 32 HIGH-LIFT 853	2
57	2483	WASHER, 39 ID X 1.25 D X .07 BELLVIL	6
58	39573	SCREW, 3/8-24 X 1.00 NYLHHC	2
59	45171	NUT, 3/8-16 HWDFL WHIZ-LOCK	1

E3560-870

REPAIR PARTS

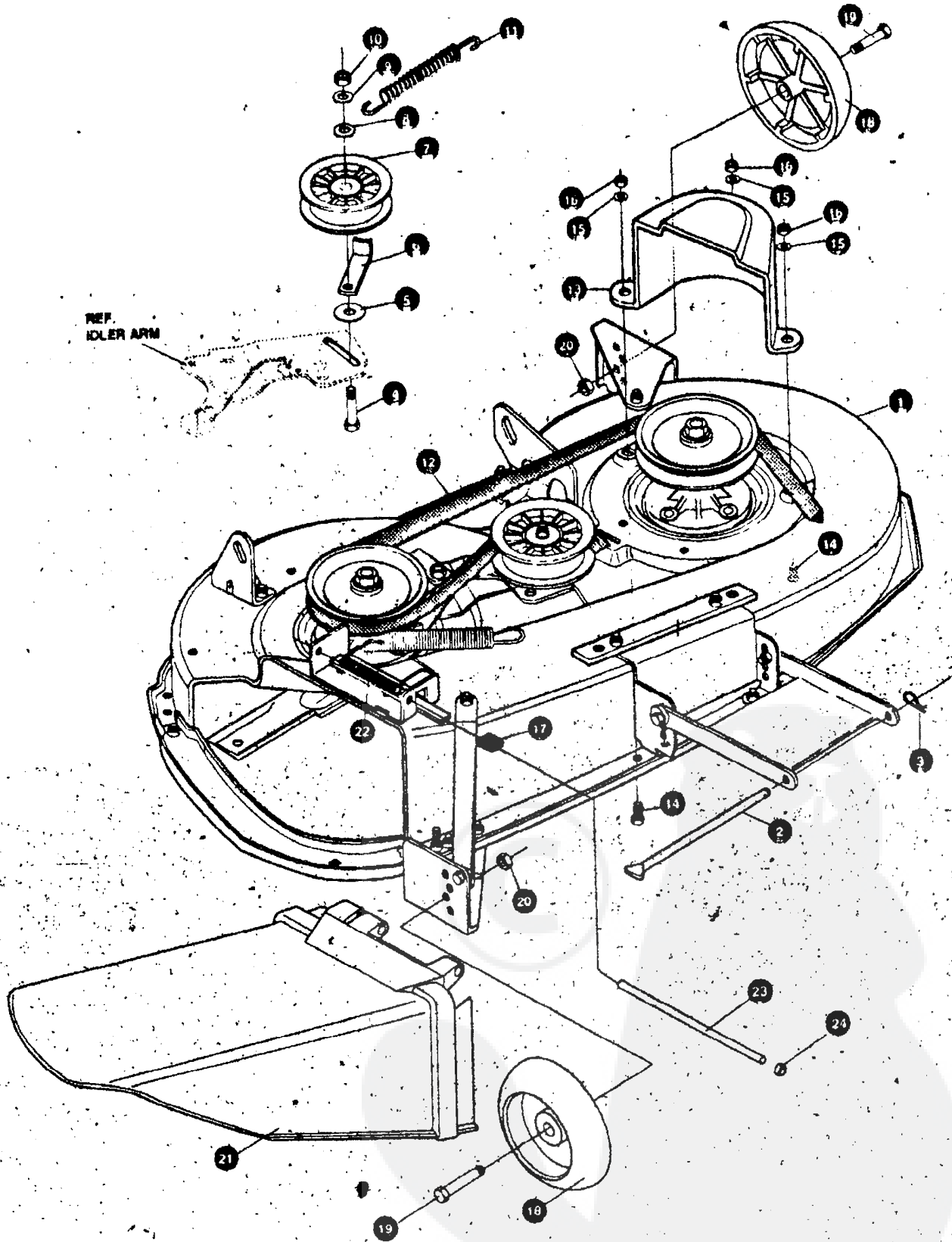

NOTE: ALWAYS USE ORIGINAL EQUIPMENT PARTS. Use of service/replacement parts other than original equipment parts may void your warranty.

ALL UNNUMBERED ITEMS ARE INTERCHANGEABLE WITH OPPOSITE SIDE

326415 B

KEY#	PART#	DESCRIPTION	WY
1	329035	ASSEMBLY, 40" DECK FOR AIR ASSIST	1
2	58306	ROD, DECK HITCH	1
3	8260	PIN, "AIR .091 DIA X 1.66 LG	1
4	57325	BOLT, 3/8-16 X 2.00 CARRSN	1
5	25210	WASHER, FIAT .386 X 1.25 X .09 HT	1
6	1346	RETAINER, BELT	1
7	310328	PULLEY, IDLER BFF 4.00 WIDE FL	1
8	9 9 6 3 0 7	WASHER, FLAT .391 X 1.00 X .209	1
9	120362	WASHER, REGSPTLK .393 X .68 X .10	1
10	320377	NUT, 3/8-16 REGHX	1
11	300473	SPRING, TENSION 7.52 LG-17LB/IN	1
12	319005	BELT, V 5L 81.00 DECK 40 LF	1
13	328257	GUARD, BELT LH PLASTIC	1
14	180077	SCREW, 5/16-18 X .75 HHC	3
15	120393	WASHER, FLAT .344 X .69 X .065	3
1 6	1496	NUT, 5/16-18 REGHEXCTRLK	3
17	4 2 3 4 6	GRIP-LEVER GRASS COLLECTOR	1
18	302611	GAUGE WHEEL, EURO 6.00 OD X 1.36 WD	2
1 9	23763	BOLT, 5/8 X 1.390 "SH 3/8-16	2
20	1499	NUT, 3/8-16 REGHXCTRLK	2
21	304422	CHUTE DEFLECTOR 40", 42" & 43"	1
22	314975	SPRING, TORSION CHUTE DEFLECTOR	1
23	304424	ROD, PIVOT DECK .312 D X 7.25	1
24	3535	NUT, PUS" ON CAP .312 OD	1

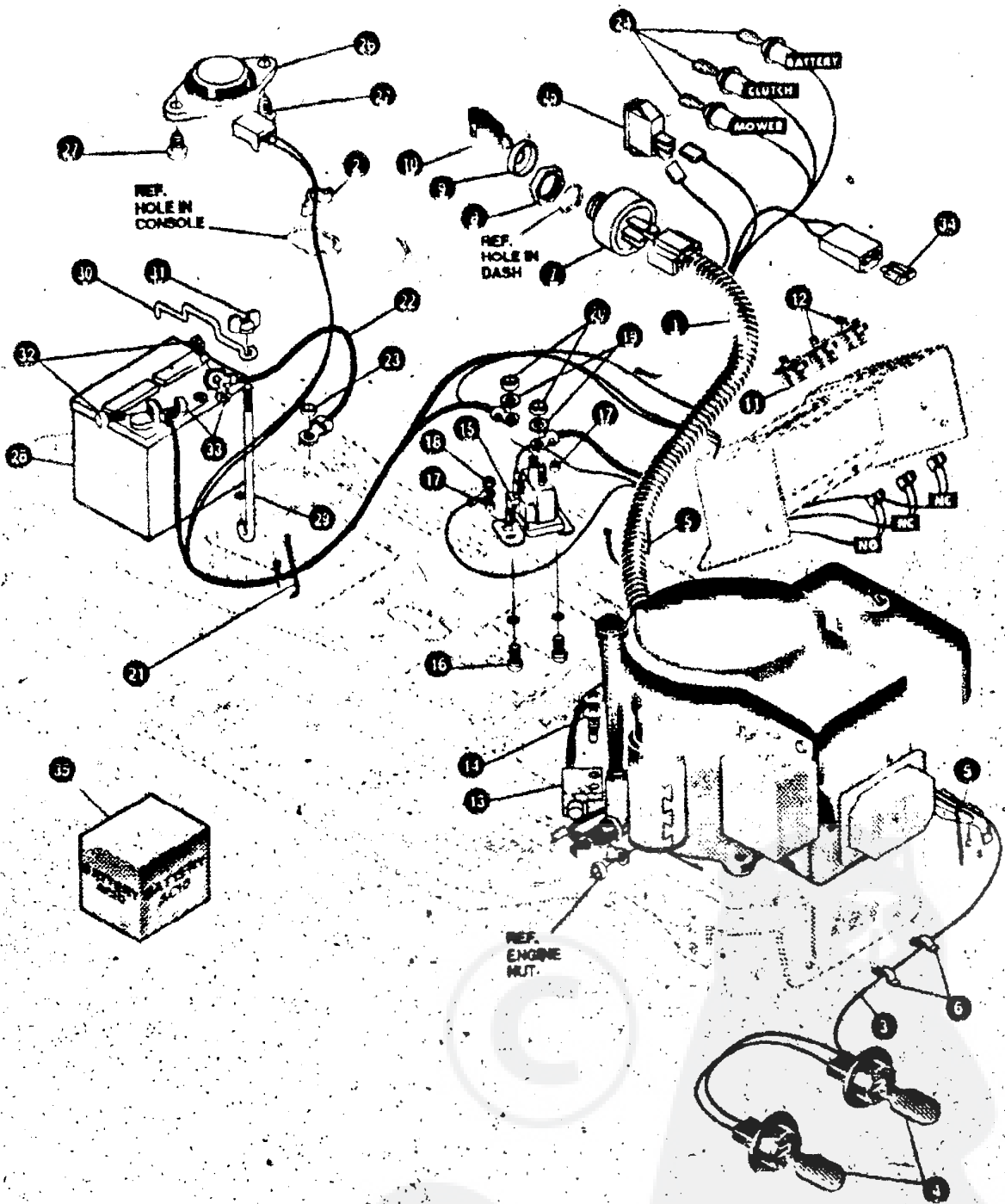

NOTE: ALWAYS USE ORIGINAL EQUIPMENT PARTS. Use of service/replacement parts other than original equipment parts may void your warranty.

ALL UNNUMBERED ITEMS ARE INTERCHANGEABLE WITH OPPOSITE SIDE

332572 B

KEY#	PART#	DESCRIPTION	QTY
1	332226	HARNES, 14 OHV, 8S H11G14, WRAP, LF	1
2	4 1 4 6 2	PRESS CLIP, 1380 LG, 255 ID	1
3	303064	ASSEMBLY, LIGHT WIRE-1/4 TURN	1
4	52572	BULB, HEADLAMP	2
5	57444	TIE, CABLE BLACK NYLON 5/62 L	2
6	41462	PRESS CLIP, 1380 LG, 255 ID	1
7	327355	SWITCH-IGNITION AFTER FIRE, 3 POSITION	1
8	327352	NUT, 5/8-8 ACME DELTA FOR BOOT	1
9	300194	BOOT, IGNITION SWITCH	1
10	327350	KEY, IGNITION DELTA	2
11	3 2 6 6 5 3	SWITCH, SNAP MOUNT NO. 055, 116GRY	1
12	326654	SWITCH, SNAP MOUNT NO. 140 BLUE	2
13	5 7 4 7 6	SWITCH, SCREW MOUNT DP NC NO BLK	1
14	57220	SCREW, #12 X 50 PHPNTAP BLK	2
15	53716	SOLENOID	2
16	187745	SCREW, 1/4-20 X .75 HXSEMMA	2
17	1502	NUT, 1/4-20 REGHEXCTRLK	2
18	271172	NUT, 1/4-20 REGHEXKEPS	1
19	138485	WASHER, EXLK 320 X 61 X .03	2
20	1 2 0 3 6 6	NUT, 5/16-24 REGHEX	2
21	57444	TIE, CABLE BLACK NYLON 5/62 L	1
22	55511	WIRE, GROUND, 12.5	1
23	2 7 1 1 8 4	NUT, 5/16 18 HEXKEPS	3
24	57769	BULB, INDICATOR	1
25	300334	LIGHT SWITCH ON/OFF PANEL MOUNT	1
26	57547	SWITCH, SEAT	2
27	160506	SCREW, 1/4-20 X .38 PHPNHMA	1
28	302257	BATTERY, 12V	1
29	57551	ROD, BATTERY	1
30	57552	ADD, BATTERY, TOP	1
31	325232	NUT, WING 1/4-20 NYLON	1
32	180020	SCREW, 1/4-20 X .75 HHC	2
33	271172	NUT, 1/4-20 REGHEXKEPS	2
35	A	BATTERY ACID PACK, 80 OZ.	1

* CAN BE PURCHASED LOCALLY

WIRING SCHEMATIC

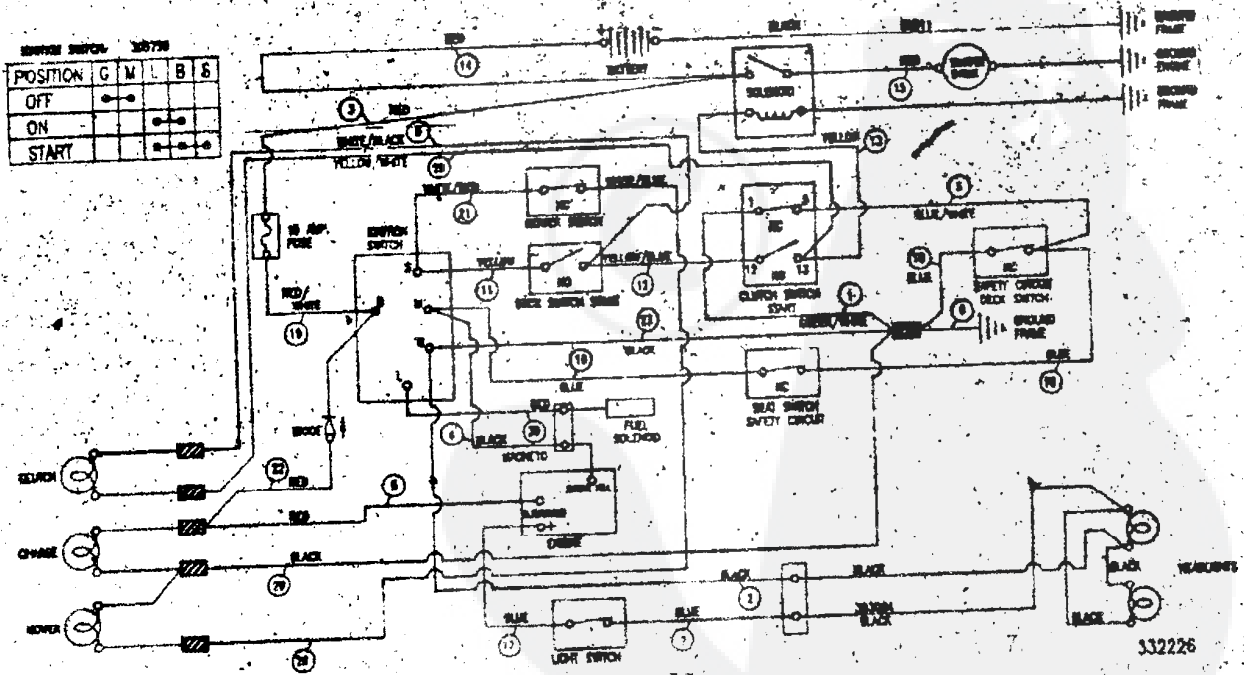

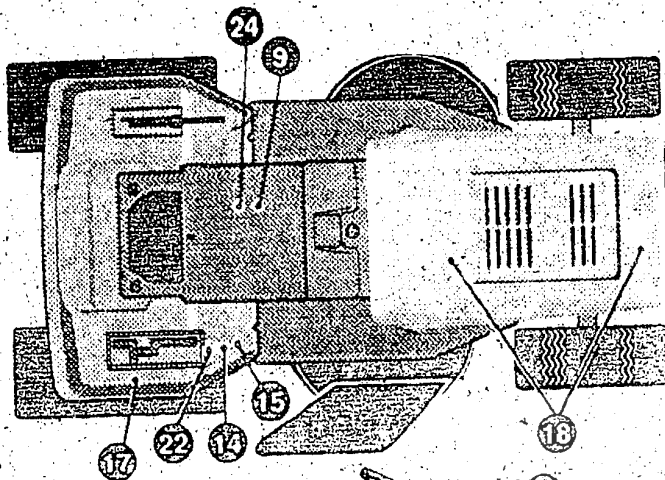
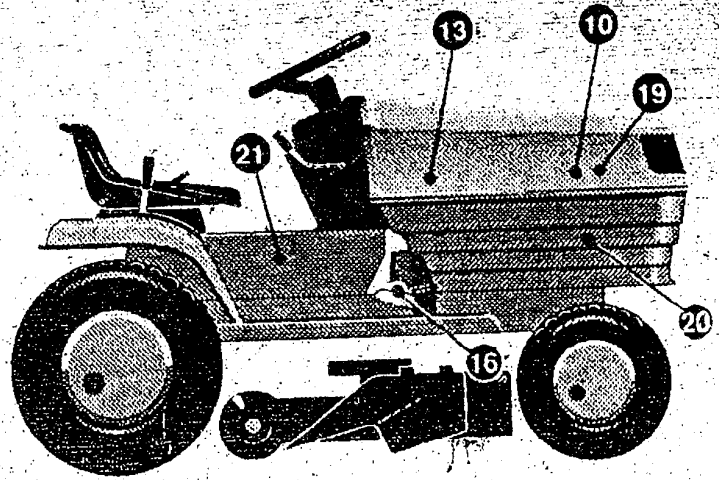
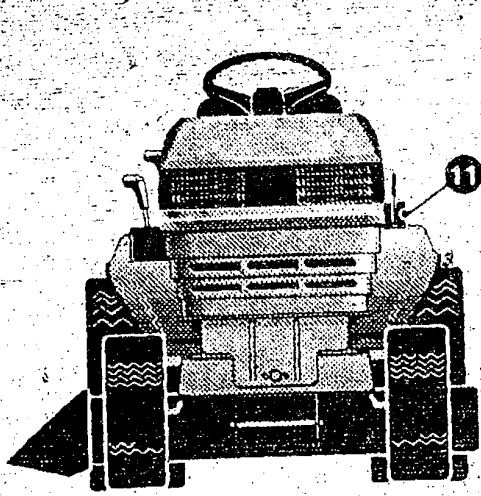

DASH OVERVIEW

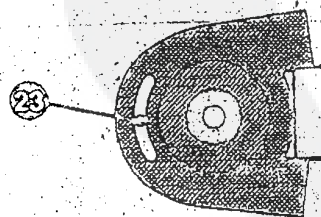
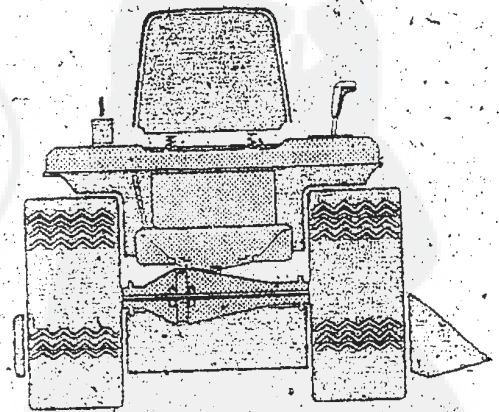
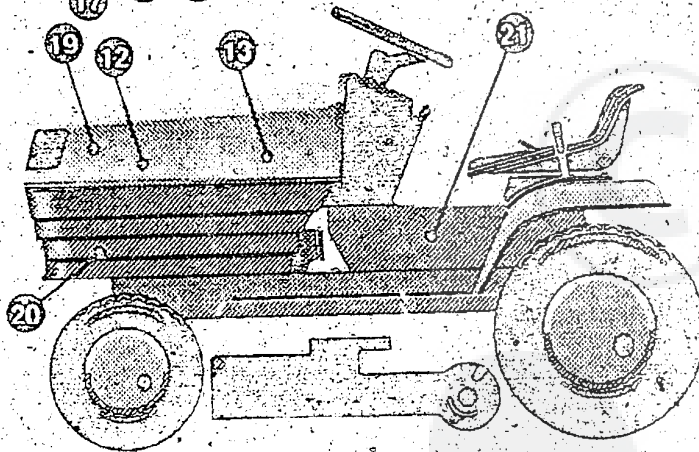
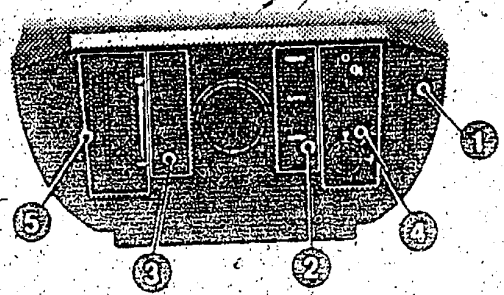

ENGINE DETAIL

KEY#	PART#	DESCRIPTION	QTY
1	68900	DECAL, BLADE ENGAGE EUROPE	1
2	300445	DECAL, DASH RH TRANSLUCENT	1
3	3 0 2 0 4 9	DECAL, DASH LH PLAIN	1
4	305766	DECAL, DASH RH IGNITION	1
5	305767	DECAL, DASH LH	1
9	69524	DECAL, INSTRUCT CONSOLE TOP GERMAN	1
10	402492	DECAL, HOOD CADY 4WS R/H	1
11	402214	DECAL, HEIGHT ADJUST	1
1 2	402493	DECAL, HOOD CAOPY 4WS LH	1
13	402138	NAMEPLATE, UNITECH SMALL SILVER	2
14	311066	DECAL, DANGER GERMAN	1
15	305770	DECAL, CAUTION TRIANGLE EUROPE	1
16	68903	DECAL, BRAKE/CLUTCH ISO	1
17	322169	DECAL, FENDER 6 SPEED SOG	1
18	305602	FOAM, HOOD 4 X 15	2
19	305604	FOAM, HOOD 7 X 12	2
20	305603	PAD, 18 X 6 FOAM HOOD	2
21	402496	NAMEPLATE, 13/40	2
22	310553	DECAL, DANGER ENGLISH	1
23	332231	DECAL, 13HP VAN OHV BLOWER HOUSING	1
2 4	307383	DECAL, INSTRUCT CONSOLE TOP ENGLISH	1

TREAD PATTERNS

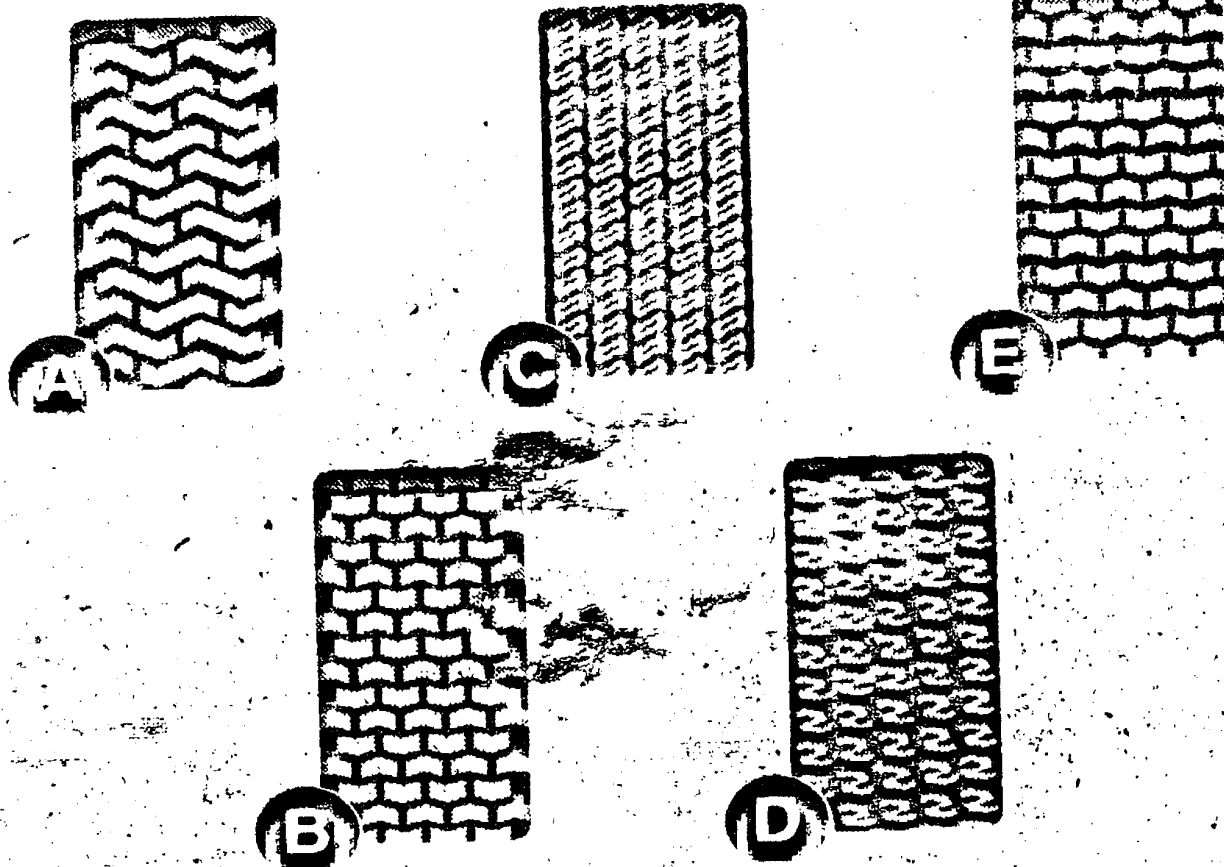

TIRE SIZE	"A"	"B"	"C"	"D"	"E"
11 X 4.00 - 5	42295	319679			
13 X 5.00 - 6	41060	319680			
15 X 6.00 - 6	39830	316702	301140	313952	
16 X 4.80 - 8		305035			
16 X 6.50 - 8	41081	319682		314539	
18 X 6.50 - 8		42091			
18 X 8.50 - 8	319683	317400			
18 X 9.50 - 8	41106	316701		313950	
20 X 8.00 - 8	319685	319684	57164	314584	331606
20 X 10.00 - 8	58276	319686		313654	
20 X 10.00 - 10	55893	319687			
23 X 9.50 - 12	53655	319690	319689	314370	

Contact the dealer where your tractor was purchased for the available accessories. If you are unable to contact the dealer, write to the address on the front cover of this manual.

Large L a w n T r a c t o r

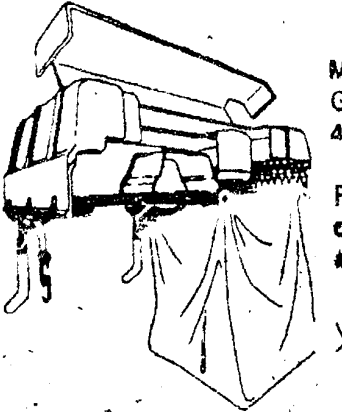

Model # 5708-34
Grass Collector for
40, 42, 43" decks

For heavy duty grass
collection order Model
#5709-10 Air Assist



5717-00
Mulching Kit (42/43" Deck)
5716-00
Mulching Kit (40" Deck)

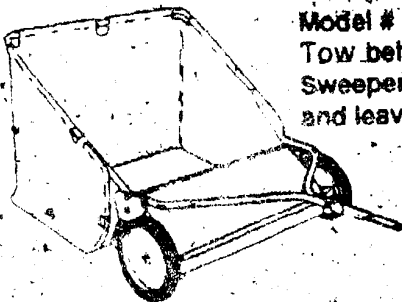

Model # 5548-16
Tow behind Lawn
Sweeper for grass
and leaves

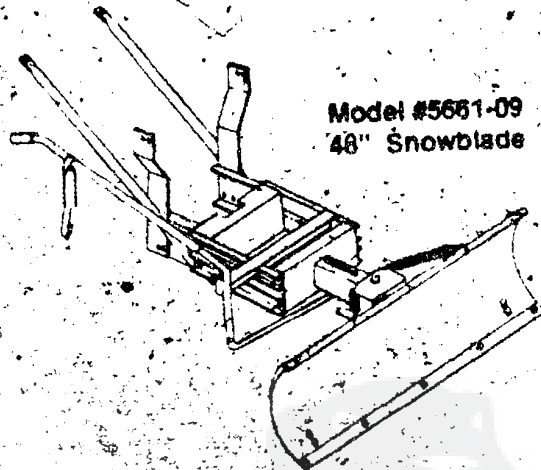

Model #5561-09
48" Snowblade

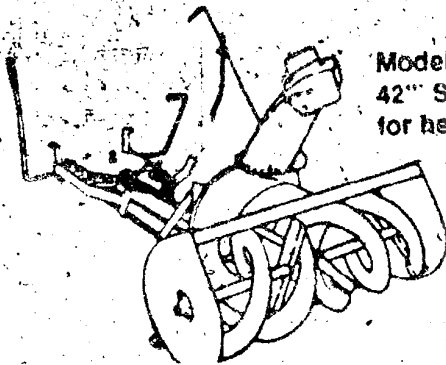

Model #5705-06
42" Snowthrower
for heavy snowfall

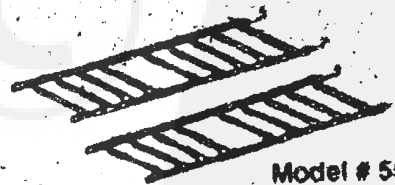

Model # 5585-00
Tire Chains - 20" x 8.0" tires
Model # 5706-00
Tire Chains - 20" x 10.0" tires

OTHER ACCESSORIES

Model	Description
5672-01	Wheel Weights - Front - 1 pr. w/mtg hdw. - Fits 15" tires
5673-02	Wheel Weights - Rear - 1 pr. w/mtg hdw. - Fits 18" & 20" tires
316608	43" High Lift Blade for bagging or Side Discharge. (Requires 2)
325762	43" Mulching Blade (Requires 2)