

ACTUAL PARTS  
 MAY NOT APPEAR  
 AS SHOWN

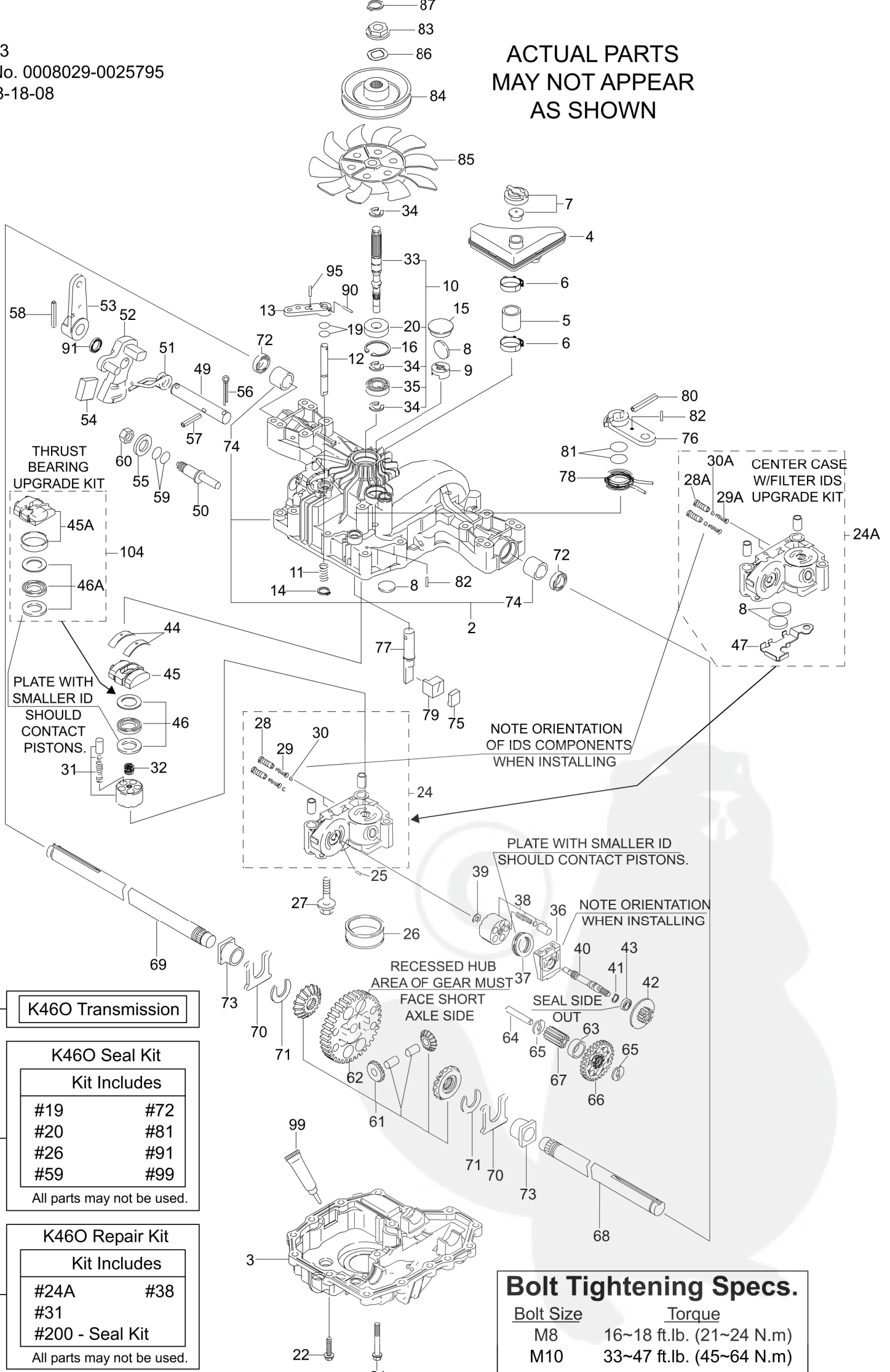

1 - K460 Transmission

200 - K460 Seal Kit

Kit Includes	
#19	#72
#20	#81
#26	#91
#59	#99

All parts may not be used.

201 - K460 Repair Kit

Kit Includes	
#24A	#38
#31	
#200 - Seal Kit	

All parts may not be used.

**Bolt Tightening Specs.**

Bolt Size	Torque
M8	16~18 ft.lb. (21~24 N.m)
M10	33~47 ft.lb. (45~64 N.m)

**K46O 0019127-0025795**  
(K46O-GP JAROMER / KARSIT / 7A646024330)

ITEM No.	TUFF TORQ P/N	DESCRIPTION	U/M PRICE	QTY
	1115	5W50 SYNTHETIC OIL		1
24A	1A646099240	CENTER CASE W/FILTER SERV. KIT		1
1	7A646024330	K46O GPJ TRANSAXLE		1
2	1A646084001	UPPER CASE KIT		1
3	1A646024163	LOWER CASE		1
4	1A646024190	RESERVOIR TANK		1
5	1A646024201	TUBE		1
6	1A646024120	COBRA CLAMP		1
7	168T2024250	VENT VALVE		1
8	19216324360	MAGNET		1
9	1A646029000	MAGNET HOLDER		1
10	1A646099950	PUMP SHAFT/BEARING KIT		1
11	19215427281	SPRING 25		1
12	1A646089510	BYPASS SHAFT B		1
13	1A632029520	BYPASS LEVER		1
14	19216829570	SNAP RING 10		1
15	1C655036300	SEALING CAP 30		1
16	22252000350	SNAP RING C 35		1
21	26476080302	TAPPING SCREW 8 * 30		1
22	26476080552	TAPPING SCREW 8 * 55		1
24	1A646099710	CENTER CASE W/BALL IDS KIT		1
25	19216824760	PIN 3 * 9.8		1
26	168T2025220	FILTER 105		1
27	26106100752	BOLT 10 * 75		1
28	1A646024830	IDS VALVE 1.0		1
29	1A646024810	IDS SPRING		1
30	24190060001	BALL 3/16		1
31	168T2025090	CYLINDER BLOCK (PUMP) KIT		1
32	1A646025200	SPRING		1
33	1A646025251	PUMP SHAFT, STANDARD		1
34	19215485310	E-RING 15		1
35	24101062020	BEARING 6202C3		1
36	19216824210	MOTOR HOUSING		1
37	1A646034750	THRUST BEARING 51106		1

38	168T2025080	CYLINDER BLOCK KIT (MOTOR)	1
39	19216825230	WASHER 12 * 24 * 1	1
40	1A646025271	MOTOR SHAFT	1
41	19215425310	SNAP RING S15	1
42	1A646025400	BRAKE DISC/MOTOR GEAR (11T)	1
43	168T2025280	BEARING 6202	1
44	19216327051	THRUST METAL	1
49	1A646029911	CONTROL SHAFT	1
50	1A646029920	FULCRUM	1
51	168T2029800	TORSION SPRING	1
52	168T2029740	CONTROL ARM A	1
53	1A646029400	CONTROL LEVER F	1
54	168T2029360	JERKY PLATE	1
55	22137120000	WASHER 12	1
56	1A646029940	COTTER PIN 1/8" * 3/4"	1
57	22351060036	SPRING PIN 6 * 36	1
58	22351060040	ROLL PIN 6 * 40	1
60	26776120002	NUT 12	1
61	1A646031570	DIFFERENTIAL GEAR KIT	1
62	1A646033520	FINAL GEAR (54T)	1
63	1A646033250	FINAL PINION COLLAR	1
64	1A646033410	REDUCTION SHAFT	1
65	19216833420	WASHER 12 * 32 * 3.2	1
66	1A646033450	REDUCTION GEAR (37T)	1
67	1A646033531	FINAL PINION GEAR (10T)	1
68	1A646034111	AXLE SHAFT, LEFT	1
69	1A646034121	AXLE SHAFT, RIGHT	1
70	19216334261	THRUST WASHER	1
71	19216834270	RING 17	1
72	19216334280	SEAL 19 * 32 * 8	1
73	19216834350	BUSHING 19 * 25	1
74	168T2034240	BUSHING 19.05	1
75	1A646036121	BRAKE SHOE	1
76	1A646036160	BRAKE LEVER	1
77	1A646036171	BRAKE SHAFT	1
78	1A646036180	BRAKE RETURN SPRING	1
79	1A646036200	BRAKE ACTUATOR	1
80	22351050032	SPRING PIN 5 * 32	1

82	22351040016	SPRING PIN 4 * 16	1
83	1A646025300	SPLINE COLLAR	1
84	1A646025780	PULLEY D	1
85	1A646083050	FAN WHITE	1
86	1A646083060	WAVE WASHER	1
87	19215489090	SNAP RING	1
90	22351030020	SPRING PIN 3.0A * 20	1
93	22351030016	SPRING PIN 3.0A * 16	1
99	1A646099500	SEALANT	1
104	1A646099630	THRUST BEARING/SWASH PLATE KIT	1
200	1A646099140	SEAL KIT (K46 & T40)	1
201	1A646099550	REPAIR KIT K46 EXTENDED DESC	1

