

ACTUAL PARTS
 MAY NOT APPEAR
 AS SHOWN

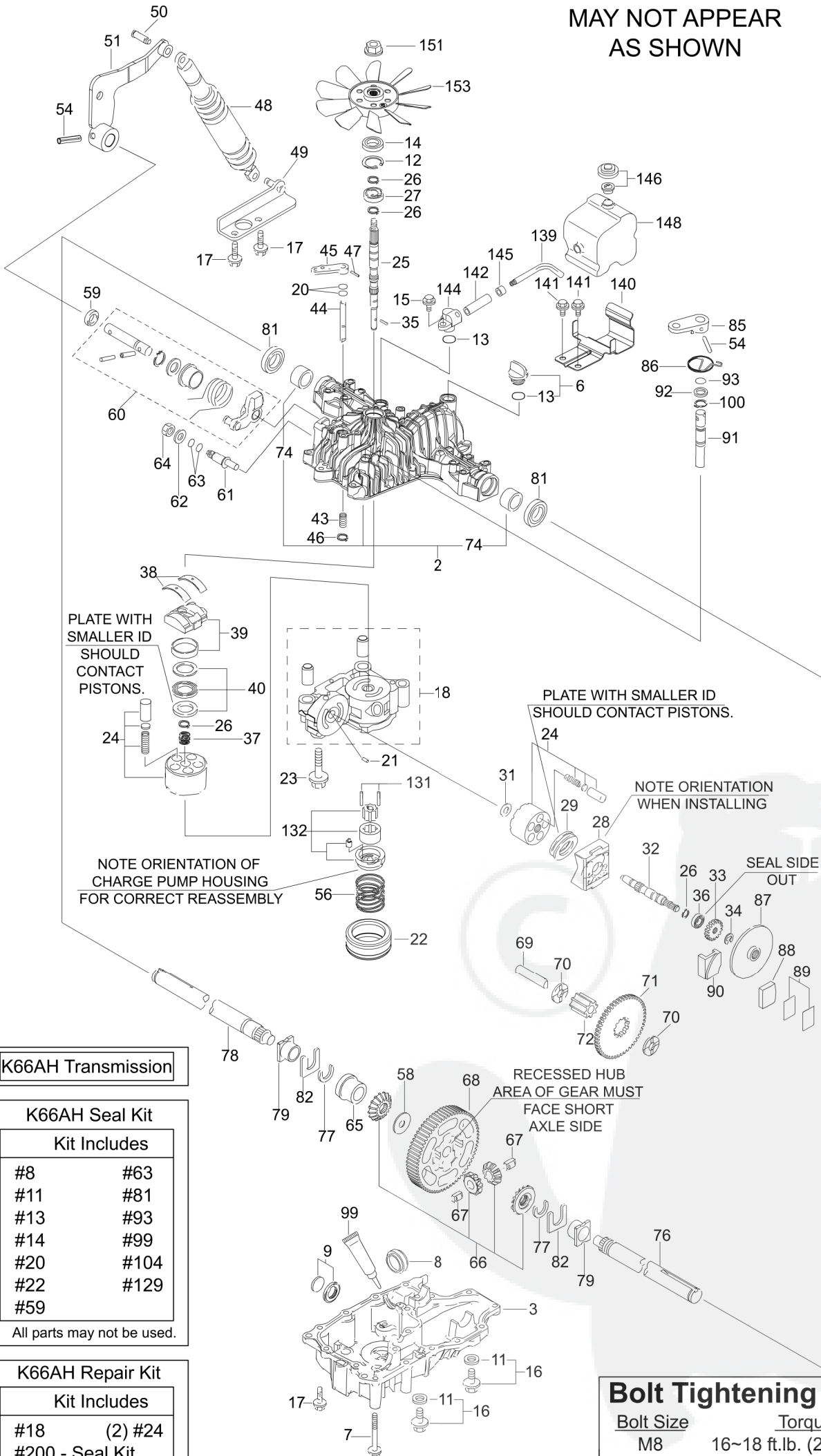

PLATE WITH SMALLER ID SHOULD CONTACT PISTONS.

PLATE WITH SMALLER ID SHOULD CONTACT PISTONS.

NOTE ORIENTATION OF CHARGE PUMP HOUSING FOR CORRECT REASSEMBLY

NOTE ORIENTATION WHEN INSTALLING

SEAL SIDE OUT

RECESSED HUB AREA OF GEAR MUST FACE SHORT AXLE SIDE

1- K66AH Transmission

K66AH Seal Kit

Kit Includes

#8	#63
#11	#81
#13	#93
#14	#99
#20	#104
#22	#129
#59	

All parts may not be used.

K66AH Repair Kit

Kit Includes

#18	(2) #24
#200 - Seal Kit	

All parts may not be used.

Bolt Tightening Specs.

Bolt Size	Torque
M8	16~18 ft.lb. (21~24 N.m)
M10	33~47 ft.lb. (45~64 N.m)

K66AH 0000001-9999999

(K66AH-ISEKI / 7A632084680 & 81 & 82 & 83)

ITEM No.	TUFF TORQ P/N	DESCRIPTION	U/M	QTY
		1115	5W50 SYNTHETIC OIL (LITER)	EA 1
1	7A632084683	K66AH ISEKI TRANSAXLE	EA	1
2	1A632024121	UPPER CASE KIT	EA	1
3	1A632024161	LOWER CASE	EA	1
6	1A632024300	OIL CAP M20B PLASTIC	EA	1
7	1A632010310	M8 * 75 SCREW CAP	EA	1
8	1A632024320	FILTER	EA	1
9	19216324350	MAGNET	EA	1
11	22190100000	WASHER SEAL 10	EA	1
12	22252000350	SNAP RING C 35	EA	1
13	24311000180	O-RING P18	EA	1
14	24421153507	SEAL TC 153507	EA	1
15	1A632010020	M8 * 20 FLANGE BOLT	EA	1
16	1A632099320	DRAIN BOLT KIT	EA	1
17	26476080302	TAPPING SCREW 8 * 30	EA	1
18	1A632024850	CENTER CASE BB	EA	1
20	24311240100	O-RING 1A P10A	EA	1
21	19216824760	PIN 3 * 9.8	EA	1
22	19215488211	FILTER	EA	1
23	1A632010650	M10 * 65 BOLT	EA	1
24	1A632025510	CYLINDER BLOCK KIT	EA	1
25	1A632025301	PUMP SHAFT	EA	1
26	19215425310	SNAP RING S15	EA	1
27	24101062020	BEARING 6202C3	EA	1
28	1A632024210	MOTOR HOUSING	EA	1
29	19215424240	THRUST BEARING	EA	1
31	19216825230	WASHER 12 * 24 * 1	EA	1
32	1A632025270	MOTOR SHAFT	EA	1
33	1A632085420	MOTOR GEAR	EA	1
35	19215488330	PIN 3 * 13.8	EA	1
36	24102063020	BEARING 6302 DUC3	EA	1
37	19215425200	PUMP SPRING	EA	1
38	19215427051	THRUST METAL	EA	1
39	1A632027100	SWASH PLATE ASSEMBLY	EA	1

40	1A632099270	THRUST BEARING KIT	EA	1
43	19215427281	SPRING 25	EA	1
44	1A632029510	BYPASS SHAFT	EA	1
45	1A632029520	BYPASS LEVER	EA	1
46	22242000100	RING,10	EA	1
47	22351030020	SPRING PIN 3.0A * 20	EA	1
48	19215489150	SHOCK ABSORBER K65	EA	1
49	1A632029550	SHOCK STAY	EA	1
50	1A632029640	PIN	EA	1
51	1A632029910	CONTROL LEVER	EA	1
54	22351060040	ROLL PIN 6 * 40	EA	1
56	19215488380	CHARGE SPRING	EA	1
58	1A632096110	WASHER 17 * 36 * 6.4	EA	1
59	19406527270	SEAL TC 162606	EA	1
60	1A632029801	CONTROL SHAFT KIT	EA	1
62	22137120000	WASHER 12	EA	1
63	24311000140	O-RING 1A P14	EA	1
64	26776120002	NUT 12	EA	1
65	1A632034270	COLLAR 25.4	EA	1
66	1A632081510	DIFFERENTIAL GEAR KIT	EA	1
67	1A632081860	PIN 17*24	EA	1
68	1A632099060	FINAL GEAR	EA	1
69	1A632083310	FINAL PINION SHAFT	EA	1
70	1A632033420	WASHER 15 * 35 * 32	EA	1
71	1A632083690	REDUCTION GEAR (53T)	EA	1
72	1A632083360	FINAL PINION	EA	1
74	19215434240	BUSHING 25.4	EA	1
76	1A632099130	AXLE SHAFT,LEFT	EA	1
77	19216734160	RETAINING RING 23	EA	1
78	1A632034250	AXLE SHAFT,RIGHT	EA	1
79	19216734240	BUSHING	EA	1
81	19215434270	SEAL S 25.4 * 42 * 8	EA	1
82	1A632034290	THRUST WASHER	EA	1
85	1A632029940	BRAKE LEVER	EA	1
86	1A632029891	BRAKE RETURN SPRING	EA	1
87	1A632036110	BRAKE DISC	EA	1
88	1A632036120	BRAKE SHOE	EA	1
89	1A632036170	SHIM KIT	EA	1

90	1A632036201	BRAKE	EA	1
91	1A632036160	BRAKE SHAFT	EA	1
92	1A632036190	WASHER 16 * 23 * 1.6	EA	1
93	24311000120	O-RING 1A P12	EA	1
99	1A646099500	SEALANT	EA	1
100	22242000160	SNAP RING	EA	1
131	22351040018	SPRING PIN 4 * 18	EA	1
132	19215488240	CHARGE PUMP KIT	EA	1
139	1A632084990	PIPE 8	EA	1
140	1A632084900	BRACKET	EA	1
141	26476080202	TAPPING SCREW 8 * 20	EA	1
142	1A632084810	TANK SUPPORT	EA	1
144	1A632084040	FITTING	EA	1
145	1A632084960	SEAL	EA	1
146	1A632024250	VENT VALVE 15	EA	1
148	1A632084930	RESERVOIR TANK	EA	1
151	19216829860	LOCK NUT 10	EA	1
153	187Q0083200	FAN	EA	1
200	1A632099300	SEAL KIT66A,L,Y62E,F,G,J,K,M,Q	EA	1
201	1A632099230	REPAIR KIT (K66C,L,S,&Y)	EA	1

