

ACTUAL PARTS
 MAY NOT APPEAR
 AS SHOWN

ITEM #120 IS AN UPGRADE
 KIT FOR THIS SECTION.
 NOTE ORIENTATION OF
 PARTS WHEN INSTALLING.

PUMP SHAFT UPGRADE KIT

CENTER CASE
 W/FILTER IDS
 UPGRADE KIT

THRUST BEARING
 UPGRADE KIT

PLATE WITH
 SMALLER ID
 SHOULD
 CONTACT
 PISTONS.

NOTE ORIENTATION
 OF IDS COMPONENTS
 WHEN INSTALLING

PLATE WITH SMALLER ID
 SHOULD CONTACT PISTONS.

NOTE ORIENTATION
 WHEN INSTALLING

RECESSED HUB
 AREA OF GEAR MUST
 FACE SHORT
 AXLE SIDE

SEAL SIDE
 OUT

1- K46A1 Transmission

K46A1 Seal Kit

Kit Includes

- | | |
|-----|-----|
| #17 | #59 |
| #19 | #72 |
| #20 | #81 |
| #26 | #91 |
| #30 | #99 |

All parts may not be used.

K46A1 Repair Kit

Kit Includes

- | | |
|-----------------|-----|
| #24 | #38 |
| #31 | |
| #200 - Seal Kit | |

All parts may not be used.

Bolt Tightening Specs.

Bolt Size	Torque
M8	16~18 ft.lb. (21~24 N.m)
M10	33~47 ft.lb. (45~64 N.m)

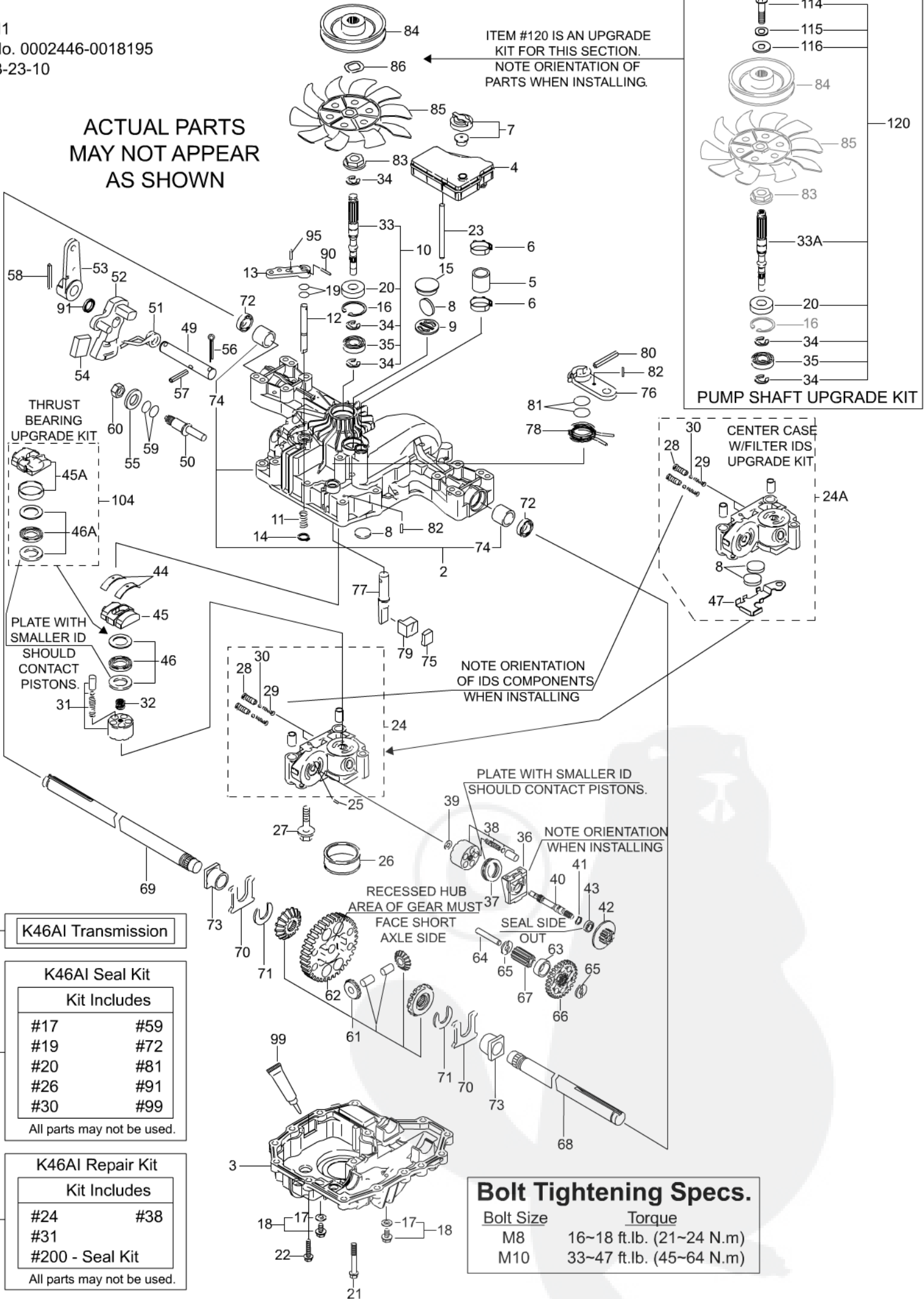

K46AI 0002446-0018195
(K46AI-AGS / 7A646084030)

ITEM No.	TUFF TORQ P/N	DESCRIPTION	U/M	QT	Y
	1115	5W50 SYNTHETIC OIL (LITER)	EA		<input type="text" value="1"/>
24A	1A646099240	CENTER CASE W/IDS FILTER KIT	EA		<input type="text" value="1"/>
1	7A646084400	K46AI AGS TRANSAXLE	EA		<input type="text" value="1"/>
2	1A646084500	UPPER CASE WITH MAGNET KIT	EA		<input type="text" value="1"/>
3	1A646084163	LOWER CASE	EA		<input type="text" value="1"/>
4	1A646024460	RESERVOIR TANK 310	EA		<input type="text" value="1"/>
5	1A646024201	TUBE	EA		<input type="text" value="1"/>
6	1A646024120	COBRA CLAMP	EA		<input type="text" value="1"/>
7	168T2024250	VENT VALVE	EA		<input type="text" value="1"/>
8	19216324360	MAGNET	EA		<input type="text" value="1"/>
9	1A646029000	MAGNET HOLDER	EA		<input type="text" value="1"/>
11	19215427281	SPRING 25	EA		<input type="text" value="1"/>
12	1A646089510	BYPASS SHAFT B	EA		<input type="text" value="1"/>
13	1A632029520	BYPASS LEVER	EA		<input type="text" value="1"/>
14	22242000100	RING,10	EA		<input type="text" value="1"/>
15	168T2036300	SEALING CAP 30	EA		<input type="text" value="1"/>
16	22252000350	SNAP RING C 35	EA		<input type="text" value="1"/>
17	22190080000	SEAL WASHER 8	EA		<input type="text" value="1"/>
18	187Q0399940	DRAIN BOLT KIT	EA		<input type="text" value="1"/>
21	26476080552	TAPPING SCREW 8 * 55	EA		<input type="text" value="1"/>
22	26476080302	TAPPING SCREW 8 * 30	EA		<input type="text" value="1"/>
23	1A646024480	TANK SUPPORT	EA		<input type="text" value="1"/>
25	19216824760	PIN 3 * 9.8	EA		<input type="text" value="1"/>
26	168T2025220	FILTER 105	EA		<input type="text" value="1"/>
27	168T2099990	BOLT 10 * 75	EA		<input type="text" value="1"/>
28	1A646024752	IDS VALVE	EA		<input type="text" value="1"/>
29	1A646024761	IDS SPRING	EA		<input type="text" value="1"/>
30	1A646024790	IDS FILTER 300	EA		<input type="text" value="1"/>
31	168T2025090	CYLINDER BLOCK (PUMP) KIT	EA		<input type="text" value="1"/>
32	1A646025200	SPRING	EA		<input type="text" value="1"/>
33	1A646025251	PUMP SHAFT, STANDARD	EA		<input type="text" value="1"/>
34	22272000120	E-RING 12	EA		<input type="text" value="1"/>
35	24101062020	BEARING 6202C3	EA		<input type="text" value="1"/>
36	19216824210	MOTOR HOUSING	EA		<input type="text" value="1"/>

37	1A646034750	THRUST BEARING 51106	EA	<input type="text" value="1"/>
38	168T2025080	CYLINDER BLOCK KIT (MOTOR)	EA	<input type="text" value="1"/>
39	19216825230	WASHER 12 * 24 * 1	EA	<input type="text" value="1"/>
40	1A646025271	MOTOR SHAFT	EA	<input type="text" value="1"/>
41	19215425310	SNAP RING S15	EA	<input type="text" value="1"/>
43	168T2025280	BEARING 6202	EA	<input type="text" value="1"/>
44	187T0027060	THRUST PLASTIC	EA	<input type="text" value="1"/>
47	1A646029010	MAGNET HOLDER	EA	<input type="text" value="1"/>
49	1A646029911	CONTROL SHAFT	EA	<input type="text" value="1"/>
50	168T2029920	FULCRUM	EA	<input type="text" value="1"/>
51	1A646029800	TENSION SPRING-STANDARD	EA	<input type="text" value="1"/>
52	168T2029740	CONTROL ARM A	EA	<input type="text" value="1"/>
53	1A646089831	CONTROL LEVER	EA	<input type="text" value="1"/>
54	168T2029360	JERKY PLATE	EA	<input type="text" value="1"/>
55	22137120000	WASHER 12	EA	<input type="text" value="1"/>
56	1A646029940	COTTER PIN 1/8IN 3/4IN	EA	<input type="text" value="1"/>
57	22351060036	SPRING PIN 6 * 36	EA	<input type="text" value="1"/>
58	22351060040	ROLL PIN 6 * 40	EA	<input type="text" value="1"/>
60	26776120002	NUT 12	EA	<input type="text" value="1"/>
61	1A646031570	DIFFERENTIAL GEAR KIT	EA	<input type="text" value="1"/>
62	1A646033520	FINAL GEAR (54T)	EA	<input type="text" value="1"/>
63	1A646033250	FINAL PINION COLLAR	EA	<input type="text" value="1"/>
64	1A646033410	REDUCTION SHAFT	EA	<input type="text" value="1"/>
65	19216833420	WASHER 12 * 32 * 3.2	EA	<input type="text" value="1"/>
66	1A646033450	REDUCTION GEAR (37T)	EA	<input type="text" value="1"/>
67	1A646033531	FINAL PINION GEAR (10T)	EA	<input type="text" value="1"/>
68	1A646034111	AXLE SHAFT, LEFT	EA	<input type="text" value="1"/>
69	1A646034121	AXLE SHAFT, RIGHT	EA	<input type="text" value="1"/>
70	19216334261	THRUST WASHER	EA	<input type="text" value="1"/>
71	19216834270	RING 17	EA	<input type="text" value="1"/>
72	19216334280	SEAL 19 * 32 * 8	EA	<input type="text" value="1"/>
73	19216834350	BUSHING 19 * 25	EA	<input type="text" value="1"/>
74	168T2034240	BUSHING 19.05	EA	<input type="text" value="1"/>
75	1A646036121	BRAKE SHOE	EA	<input type="text" value="1"/>
76	1A646036160	BRAKE LEVER	EA	<input type="text" value="1"/>
77	1A646036171	BRAKE SHAFT	EA	<input type="text" value="1"/>
78	1A646036180	BRAKE RETURN SPRING	EA	<input type="text" value="1"/>
79	1A646036200	BRAKE ACTUATOR	EA	<input type="text" value="1"/>

80	22351050032	SPRING PIN 5 * 32	EA	<input type="text" value="1"/>
82	22351040016	SPRING PIN 4 * 16	EA	<input type="text" value="1"/>
83	1A646025300	SPLINE COLLAR	EA	<input type="text" value="1"/>
84	1A646025770	PULLEY C	EA	<input type="text" value="1"/>
85	1A646083050	FAN WHITE	EA	<input type="text" value="1"/>
86	1A646083060	WAVE WASHER	EA	<input type="text" value="1"/>
87	19215489090	SNAP RING	EA	<input type="text" value="1"/>
90	22351030020	SPRING PIN 3.0A * 20	EA	<input type="text" value="1"/>
95	22351030016	SPRING PIN 3.0A * 16	EA	<input type="text" value="1"/>
99	1A646099500	SEALANT	EA	<input type="text" value="1"/>
104	1A646099630	THRUST BEARING/SWASH PLATE KIT	EA	<input type="text" value="1"/>
114	1A646083090	BOLT	EA	<input type="text" value="1"/>
115	1A646083100	LOCK WASHER	EA	<input type="text" value="1"/>
116	1A646083110	WASHER	EA	<input type="text" value="1"/>
120	1A646099980	PUMP SHAFT/BEARING KIT	EA	<input type="text" value="1"/>
200	1A646099140	SEAL KIT (K46 & T40)	EA	<input type="text" value="1"/>
201	1A646099590	REPAIR KIT K46 EXTENDED DESCRP	EA	<input type="text" value="1"/>

