

**ACTUAL PARTS
 MAY NOT APPEAR
 AS SHOWN**

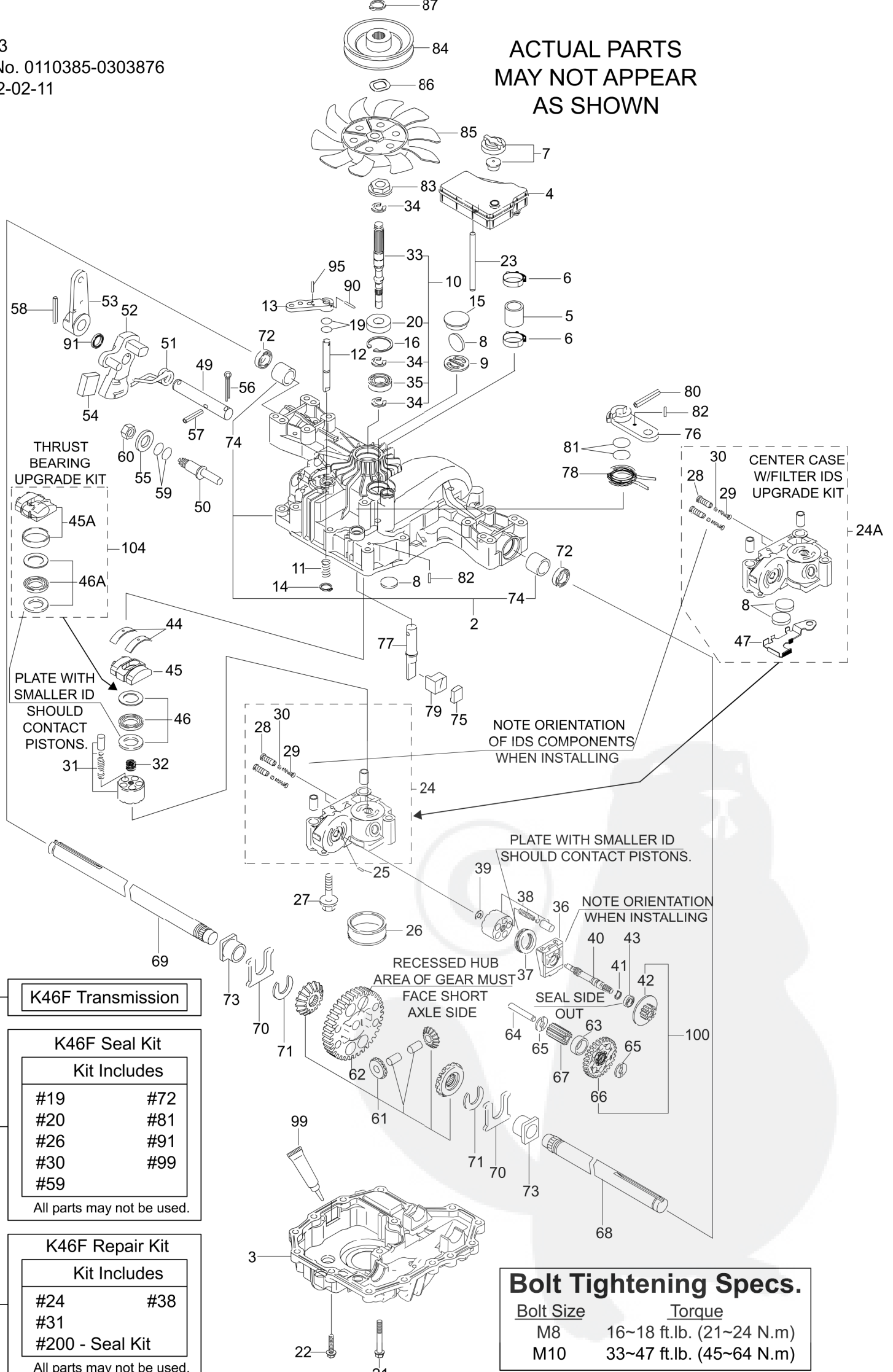

1- **K46F Transmission**

200- **K46F Seal Kit**
 Kit Includes

#19	#72
#20	#81
#26	#91
#30	#99
#59	

 All parts may not be used.

201- **K46F Repair Kit**
 Kit Includes

#24	#38
#31	
#200 - Seal Kit	

 All parts may not be used.

Bolt Tightening Specs.

Bolt Size	Torque
M8	16~18 ft.lb. (21~24 N.m)
M10	33~47 ft.lb. (45~64 N.m)

K46F 0110385-0303876
(K46F-GGP CASTELGARDEN / 7A646024050 & 51)

ITEM No.	TUFF TORQ P/N	DESCRIPTION	U/M	QTY
	1115	5W50 SYNTHETIC OIL	EA	1
24A	1A646099240	CENTER CASE W/FILTER SERV. KIT	EA	1
1	7A646024051	K46 C/G TRANSAXLE	EA	1
2	1A646084001	UPPER CASE KIT	EA	1
3	1A646024163	LOWER CASE	EA	1
4	1A646024460	RESERVOIR TANK 310	EA	1
5	1A646024201	TUBE	EA	1
6	1A646024120	COBRA CLAMP	EA	1
7	168T2024250	VENT VALVE	EA	1
8	19216324360	MAGNET	EA	1
9	1A646029000	MAGNET HOLDER	EA	1
10	1A646099950	PUMP SHAFT/BEARING KIT	EA	1
11	19215427281	SPRING 25	EA	1
12	1A646089510	BYPASS SHAFT B	EA	1
13	1A632029520	BYPASS LEVER	EA	1
14	19216829570	SNAP RING 10	EA	1
15	1C655036300	SEALING CAP 30	EA	1
16	22252000350	SNAP RING C 35	EA	1
21	26476080552	TAPPING SCREW 8 * 55	EA	1
22	26476080302	TAPPING SCREW 8 * 30	EA	1
23	1A646024480	TANK SUPPORT	EA	1
25	19216824760	PIN 3 * 9.8	EA	1
26	168T2025220	FILTER 105	EA	1
27	168T2099990	BOLT 10 * 75	EA	1
28	1A646024752	IDS VALVE	EA	1
29	1A646024761	IDS SPRING	EA	1
30	1A646024790	IDS FILTER 300	EA	1
31	168T2025090	CYLINDER BLOCK (PUMP) KIT	EA	1
32	1A646025200	SPRING	EA	1
33	1A646025251	PUMP SHAFT, STANDARD	EA	1
34	19215485310	E-RING 15	EA	1
35	24101062020	BEARING 6202C3	EA	1
36	19216824210	MOTOR HOUSING	EA	1
37	1A646034750	THRUST BEARING 51106	EA	1

38	168T2025080	CYLINDER BLOCK KIT (MOTOR)	EA	1
39	19216825230	WASHER 12 * 24 * 1	EA	1
40	1A646025271	MOTOR SHAFT	EA	1
41	19215425310	SNAP RING S15	EA	1
43	168T2025280	BEARING 6202	EA	1
44	19216327051	THRUST METAL	EA	1
47	1A646029010	MAGNET HOLDER	EA	1
49	1A646029911	CONTROL SHAFT	EA	1
50	168T2029920	FULCRUM	EA	1
51	1A646029800	TENSION SPRING-STANDARD	EA	1
52	168T2029740	CONTROL ARM A	EA	1
53	1A646029851	CONTORL LEVER C	EA	1
54	168T2029360	JERKY PLATE	EA	1
55	22137120000	WASHER 12	EA	1
56	1A646029940	COTTER PIN 1/8IN 3/4IN	EA	1
57	22351060036	SPRING PIN 6 * 36	EA	1
58	22351060040	ROLL PIN 6 * 40	EA	1
60	26776120002	NUT 12	EA	1
61	1A646031570	DIFFERENTIAL GEAR KIT	EA	1
62	1A646033520	FINAL GEAR (54T)	EA	1
63	1A646033250	FINAL PINION COLLAR	EA	1
64	1A646033410	REDUCTION SHAFT	EA	1
65	19216833420	WASHER 12 * 32 * 3.2	EA	1
67	1A646033531	FINAL PINION GEAR (10T)	EA	1
68	1A646089450	AXLE SHAFT L/B	EA	1
69	1A646089460	AXLE SHAFT R/B	EA	1
70	19216334261	THRUST WASHER	EA	1
71	19216834270	RING 17	EA	1
72	19216334280	SEAL 19 * 32 * 8	EA	1
73	19216834350	BUSHING 19 * 25	EA	1
74	168T2034240	BUSHING 19.05	EA	1
75	1A646036121	BRAKE SHOE	EA	1
76	1A646036160	BRAKE LEVER	EA	1
77	1A646036171	BRAKE SHAFT	EA	1
78	1A646036180	BRAKE RETURN SPRING	EA	1
79	1A646036200	BRAKE ACTUATOR	EA	1
80	22351050032	SPRING PIN 5 * 32	EA	1
82	22351040016	SPRING PIN 4 * 16	EA	1

83	1A646025300	SPLINE COLLAR	EA	1
84	1A646025770	PULLEY C	EA	1
85	1A646083050	FAN WHITE	EA	1
86	1A646083060	WAVE WASHER	EA	1
87	19215489090	SNAP RING	EA	1
90	22351030020	SPRING PIN 3.0A * 20	EA	1
95	22351030016	SPRING PIN 3.0A * 16	EA	1
99	1A646099500	SEALANT	EA	1
100	1A646099020	MOTOR GEAR KIT	EA	1
104	1A646099630	THRUST BEARING/SWASH PLATE KIT	EA	1
200	1A646099140	SEAL KIT (K46 & T40)	EA	1
201	1A646099590	REPAIR KIT K46 EXTENDED DESCRP	EA	1

