

ACTUAL PARTS  
 MAY NOT APPEAR  
 AS SHOWN

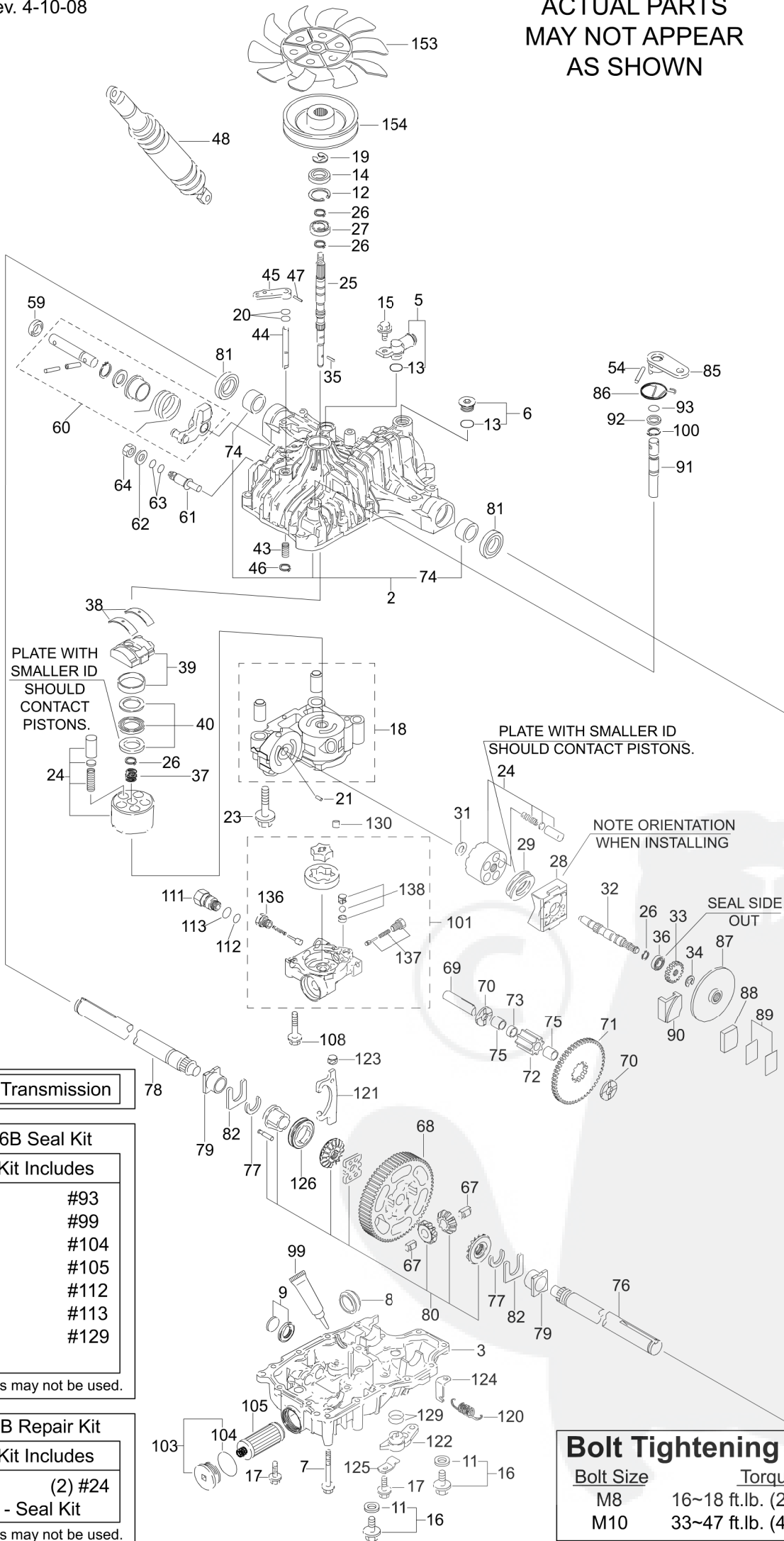

PLATE WITH  
 SMALLER ID  
 SHOULD  
 CONTACT  
 PISTONS.

PLATE WITH SMALLER ID  
 SHOULD CONTACT PISTONS.

NOTE ORIENTATION  
 WHEN INSTALLING

SEAL SIDE  
 OUT

1- **K66B Transmission**

**K66B Seal Kit**

Kit Includes

#8	#93
#11	#99
#13	#104
#14	#105
#20	#112
#59	#113
#63	#129
#81	

All parts may not be used.

**K66B Repair Kit**

Kit Includes

#18	(2) #24
#200 - Seal Kit	

All parts may not be used.

**Bolt Tightening Specs.**

Bolt Size	Torque
M8	16~18 ft.lb. (21~24 N.m)
M10	33~47 ft.lb. (45~64 N.m)

**K66B 00001-001335**  
(K66B-STIGA / 7A632084510)

ITEM No.	TUFF TORQ P/N	DESCRIPTION	U/M	PRICE	QTY
		1115	5W50 SYNTHETIC OIL		1
1	7A632084510	K66 STI TRANSAAXLE SEE NEXT SN			1
2	1A632024102	UPPER CASE KIT			1
3	1A632084500	LOWER CASE			1
5	187Q0599060	FITTING KIT			1
6	187Q0599040	OIL CAP KIT			1
7	19215424310	CAP SCREW 8 * 75			1
8	1A632024320	FILTER			1
9	19216324350	MAGNET			1
11	22190100000	WASHER SEAL 10			1
12	22252000350	SNAP RING C 35			1
14	24421153507	SEAL TC 153507			1
15	26106080202	BOLT 8 * 20			1
16	1A632099320	DRAIN BOLT KIT			1
17	26476080302	TAPPING SCREW 8 * 30			1
18	1A632024860	CENTER CASE AB			1
19	19215485310	E-RING 15			1
21	19216824760	PIN 3 * 9.8			1
23	26106100652	BOLT 10 * 65			1
24	1A632025510	CYLINDER BLOCK KIT			1
25	1A632085262	PUMP SHAFT			1
26	19215425310	SNAP RING S15			1
27	24101062020	BEARING 6202C3			1
28	1A632024210	MOTOR HOUSING			1
29	19215424240	THRUST BEARING			1
31	19216825230	WASHER 12 * 24 * 1			1
32	1A632025270	MOTOR SHAFT			1
33	1A632085400	MOTOR GEAR (14T)			1
35	19215488330	PIN 3 * 13.8			1
37	19215425200	PUMP SPRING			1
38	19215427051	THRUST METAL			1
39	1A632027100	SWASH PLATE ASSEMBLY			1
40	19215427000	THRUST BEARING KIT			1
43	19215427281	SPRING 25			1

44	1A632029510	BYPASS SHAFT	1
45	1A632029520	BYPASS LEVER	1
46	19216829570	SNAP RING 10	1
47	22351030020	SPRING PIN 3.0A * 20	1
48	19215489150	SHOCK ABSORBER K65	1
54	22351060040	ROLL PIN 6 * 40	1
60	1A632029801	CONTROL SHAFT KIT	1
61	168T2029920	FULCRUM	1
62	22137120000	WASHER 12	1
64	26776120002	NUT 12	1
67	1A632081810	DIFFERENTIAL PINION PIN	1
68	1A632083540	FINAL GEAR	1
69	1A632033410	FINAL PINION SHAFT	1
70	1A632033420	WASHER 15 * 35 * 32	1
71	1A632083470	REDUCTION GEAR (51T)	1
72	1A632083550	FINAL PINION GEAR (11T)	1
73	1A632083430	COLLAR	1
74	19215434240	BUSHING 25.4	1
75	1A632083420	NEEDLE BEARING 151814	1
76	1A632089130	AXLE SHAFT, LEFT	1
77	19216734160	RETAINING RING 23	1
78	1A632089230	AXLE SHAFT, RIGHT	1
79	19216734240	BUSHING	1
80	1A632087360	DIFFERENTIAL LOCK KIT	1
81	19215434270	SEAL S 25.4 * 42 * 8	1
82	1A632034290	THRUST WASHER	1
85	1A632089870	BRAKE LEVER	1
86	1A632089900	BRAKE RETURN SPRING	1
87	1A632036110	BRAKE DISC	1
88	1A632036120	BRAKE SHOE	1
89	1A632036170	SHIM KIT	1
90	1A632036201	BRAKE	1
91	1A632036160	BRAKE SHAFT	1
92	1A632036190	WASHER 16 * 23 * 1.6	1
99	1A646099500	SEALANT	1
100	22242000160	SNAP RING	1
101	1A632096150	PUMP CASE KIT	1
103	1A637094450	CAP KIT	1

104	24351240400	O-RING 1A 2040	1
105	1A632026450	FILTER	1
108	26106080452	BOLT 8 * 45	1
111	1A637026420	CONNECTOR	1
120	19215333130	DIFFERENTIAL RETURN SPRING	1
121	1A632087120	DIFFERENTIAL LOCK FORK	1
122	1A632087151	DIFFERENTIAL LOCK ARM	1
123	1A632087160	LEVER PIVOT	1
124	1A632087170	SPRING HOOK	1
125	1A632087180	LEVER CLIP	1
130	19452141570	ALIGNMENT SLEEVE 11 * 7	1
136	19216726300	CHARGE RELIEF VALVE	1
137	19216726250	IMPLEMENT RELIEF VALVE	1
138	1A637026350	3RD CHECK VALVE	1
153	1A646083050	FAN WHITE	1
154	1A632085110	PULLEY, STIGA (3.125)	1
200	1A632099250	SEAL KIT(K66 K,M,I,D,B)	1
201	1A632099240	REPAIR KIT (K66AC,B,D,I,M,V)	1

